



18V LITHIUM ION

HYBRID INFLATOR / DEFLATOR

INSTRUCTION MANUAL

SPECIFICATIONS

Input:	18V (DC) or 230-240V (AC)
No Load Speed:	16,000/min
Max Pressure:	160PSI (11Bar)
Flow Rate:	10L/min @ 30PSI
Weight:	2.2kg

ozito.com.au

5 YEAR
REPLACEMENT WARRANTY

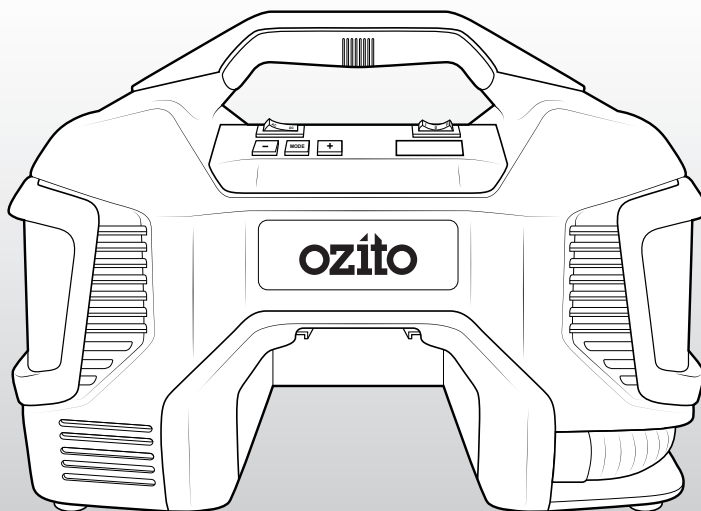

WHAT'S IN THE BOX



Hybrid Inflator / Deflator



High Volume Air Hose

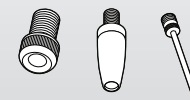

3 x Inflation Adapters

Battery & Charger sold separately

PXHDIS-240

WARRANTY

IN ORDER TO MAKE A CLAIM UNDER THIS WARRANTY YOU MUST RETURN THE PRODUCT TO YOUR NEAREST BUNNINGS WAREHOUSE WITH YOUR BUNNINGS REGISTER RECEIPT. PRIOR TO RETURNING YOUR PRODUCT FOR WARRANTY PLEASE TELEPHONE OUR CUSTOMER SERVICE HELPLINE:

Australia 1800 069 486

New Zealand 0508 069 486

TO ENSURE A SPEEDY RESPONSE PLEASE HAVE THE MODEL NUMBER AND DATE OF PURCHASE AVAILABLE. A CUSTOMER SERVICE REPRESENTATIVE WILL TAKE YOUR CALL AND ANSWER ANY QUESTIONS YOU MAY HAVE RELATING TO THE WARRANTY POLICY OR PROCEDURE.

WARNING

The following actions will result in the warranty being void.

- If the tool has been operated on a supply voltage other than that specified on the tool.
- If the tool shows signs of damage or defects caused by or resulting from abuse, accidents or alterations.
- Failure to perform maintenance as set out within the instruction manual.
- If the tool is disassembled or tampered with in any way.

The benefits provided under this warranty are in addition to other rights and remedies which are available to you at law.

Our goods come with guarantees that cannot be excluded at law. You are entitled to a replacement or refund for a major failure and for compensation for any other reasonably foreseeable loss or damage. You are also entitled to have the goods repaired or replaced if the goods fail to be of acceptable quality and the failure does not amount to a major failure.

Generally you will be responsible for all costs associated with a claim under this warranty, however, where you have suffered any additional direct loss as a result of a defective product you may be able to claim such expenses by contacting our customer service helpline above.

5 YEAR REPLACEMENT WARRANTY

Your Product is guaranteed for a period of 60 months from the original date of purchase and is intended for DIY (Do It Yourself) use only. If a product is defective it will be replaced in accordance with the terms of this warranty. **Lithium Ion batteries and chargers are covered by a 36 month warranty** and are excluded from the warranty extension. Warranty excludes consumable parts, for example: crevice tool.

KNOW YOUR PRODUCT

HYBRID INFLATOR / DEFLATOR

- | | |
|------------------------------|--------------------------|
| 1 Adapter Compartment | 5 Operation Mode Switch |
| 2 Power Mode Switch | 6 Carry Handle |
| 3 Pressure Selection Buttons | 7 Power Cord Compartment |
| 4 Battery Seating | 8 High Volume Air Hose |

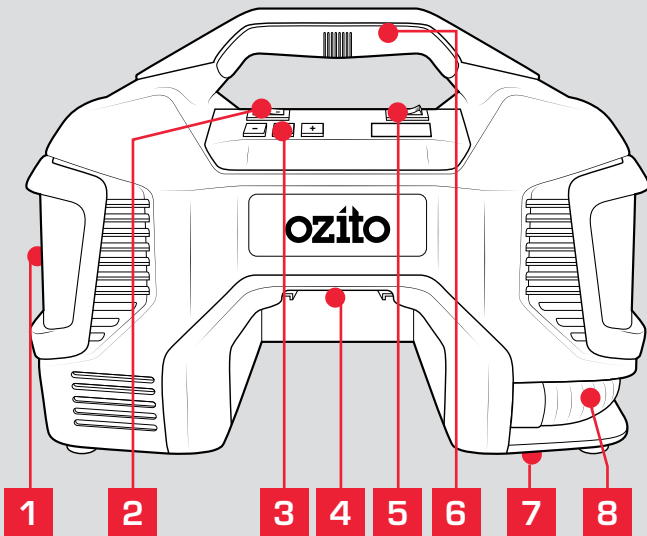

ACCESSORIES

- 9 Presta Adapter
- 10 General Purpose Adapter
- 11 Ball Adapter

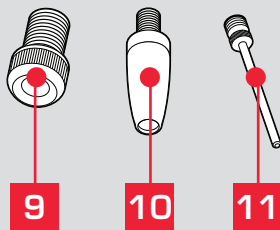

BATTERY & CHARGER (sold separately)

This tool is compatible with all batteries and chargers from the Ozito Power X Change Range.

ONLINE MANUAL

Scan this QR Code with your mobile device to take you to the online manual.



SETUP & PREPARATION

1. BATTERY & CHARGING (sold separately)



CAUTION: THE CHARGER FOR THIS PRODUCT SHOULD BE PROTECTED BY A RESIDUAL CURRENT DEVICE (RATED AT 30mA OR LESS).

The purchased battery will be shipped in a low charge condition, and requires charging prior to use. Allow several cycles of charging and discharging (through use of the tool) for the battery to reach its optimum performance / runtime.

Charging your lithium ion battery - Fast Charger

1 Connect the charger into a mains power outlet.

2 The charger LED will flash green showing power is being supplied to the charger.

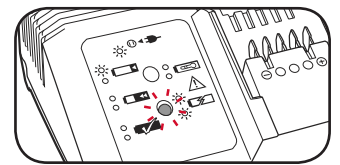

3 With the charger sitting on a flat surface, align the raised ribs on the battery with the recess in the charger and slide onto the charger ensuring a firm connection.

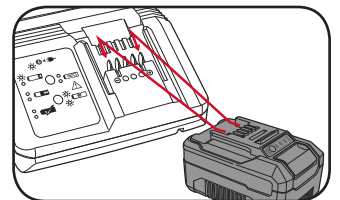

4 The charger LED will illuminate red signifying that the battery is charging.

5 The charger LED will illuminate green once the battery is fully charged.

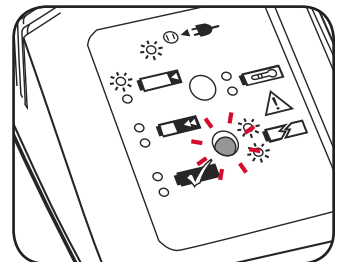
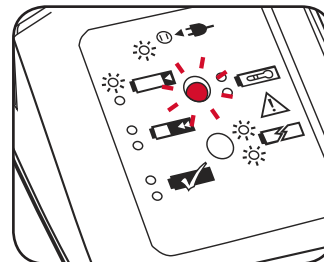

Charger LED Indicator

LED Indicator	Situation
GREEN (Flashing)	Stand By (no battery pack is inserted)
RED (Flashing)	Battery is charging (low charge)
RED (Illuminated)	Battery is charging (mid charge)
GREEN (Illuminated)	Battery is fully charged
BOTH (Illuminated)	Battery pack is too hot or too cold (charging will begin automatically when battery reaches correct charging temperature).
BOTH (Flashing)	Defective battery. Never charge a defective battery pack! Remove battery pack from charger.

5 YEAR
REPLACEMENT WARRANTY

Charging your lithium ion battery - Eco Charger

1 Connect the charger into a mains power outlet.

2 The charger LED will flash green showing power is being supplied to the charger.

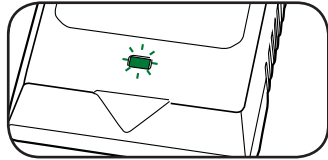

3 With the battery sitting on a flat surface, align the raised ribs on the battery with the recess in the charger and slide onto the battery ensuring a firm connection.

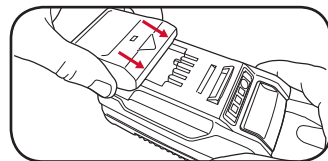

4 The charger LED will illuminate red signifying that the battery is charging.

5 When removing the charger from the battery, first press the battery release tab, then slide the charger from its position.

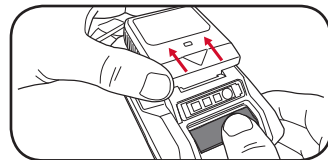

Charger LED Indicator	
LED Indicator	Situation
GREEN (Flashing)	Stand By (no battery pack is inserted)
RED (Illuminated)	Battery is charging (low charge)
GREEN (Illuminated)	Battery is fully charged
RED (Flashing)	Battery or Charger fault
RED & GREEN (Flashing)	Battery pack is too hot or too cold (remove battery from charger and store at room temperature 20°C. Insert battery again when at correct charging temperature). If this happens again, the battery is defective and needs to be replaced.

Battery Charge Indicator

The purchased battery is equipped with a battery charge indicator to show the state of the battery charge.

Press the charge indicator button and look to see which LED lights.

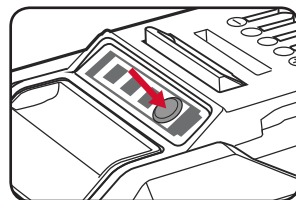

Battery requires immediate charging



Low state of charge, requires charging soon.



Mid state of charge

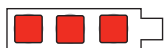

Full state of charge.

Note: The battery needs to be removed from the tool to check the state of charge.

2. CONNECTING TO POWER



WARNING! BEFORE CONNECTING TO A POWER SUPPLY, ENSURE THE OPERATING MODE SWITCH IS IN THE OFF POSITION "0".

Inserting & Removing the Battery (not included)

1 Align the ribs of the battery with the recess at the front of the unit and push in until it clicks into place.

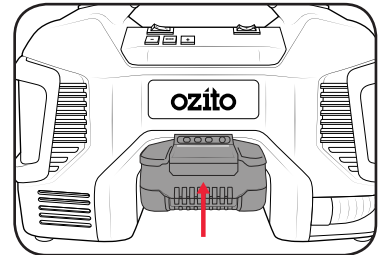

2 To switch the unit on, press the power mode switch into the DC position.

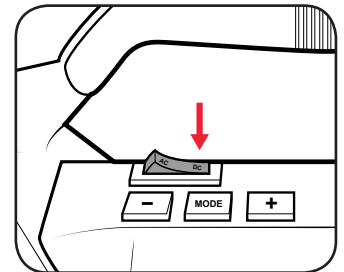

3 To remove, press and hold the battery release tab and pull the battery away from the tool.

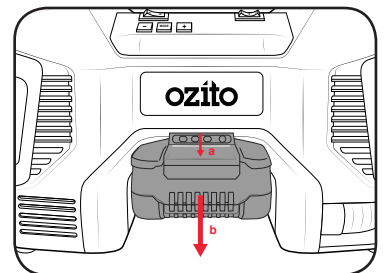

Connecting to a 240V (AC) Outlet



WARNING! THE 240V POWER SUPPLY SHOULD BE PROTECTED BY A RESIDUAL CURRENT DEVICE (RATED AT 30MA OR LESS).

1 Remove the power cord from the compartment at the base of the inflator and connect to a 240V outlet.

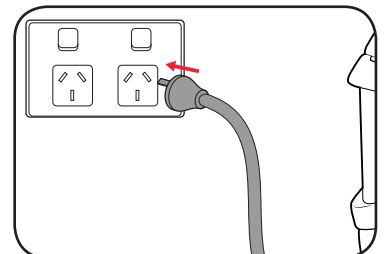

2 To switch the unit on, press the power mode switch into the AC position.

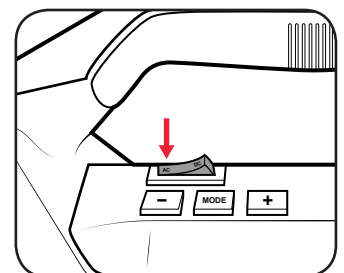

OPERATION

3. ADAPTORS AND ACCESSORIES

Attaching Inflation Adapters

The inflator unit has 3 adapters to allow a range of functions. All the adapters are secured in the compartment at the side of the unit.

- 1 Open the side compartment and remove the desired inflation adapter.

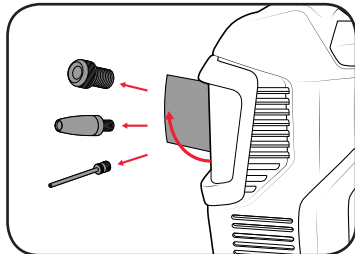

- 2 Remove the high pressure air hose from the back of the tool and unlock the nozzle by lifting the locking lever.

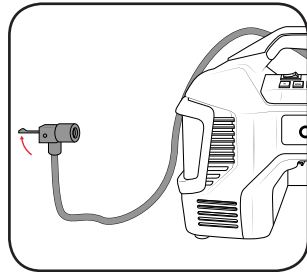

- 3 Insert the adapter into the hose nozzle and lock by pushing down the locking lever.

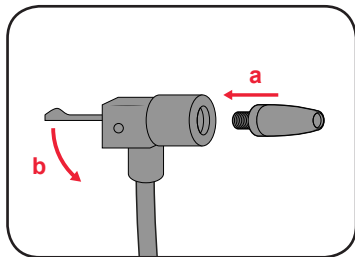

4. CONTROLS

Digital Display

While inflating a high pressure item, the current pressure will be displayed on the digital display.

Note: When using the inflator to inflate or deflate a high volume item, the digital display will show "0.00".

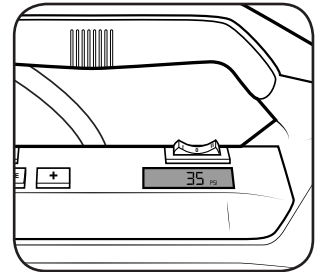

- 1 To change between the 3 pressure modes (Bar, PSI or kPa), press the pressure mode button.

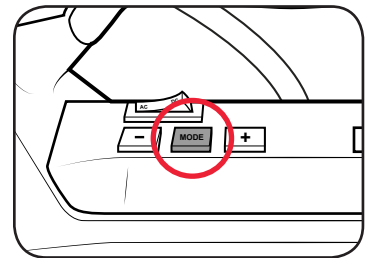

Preset Pressure

When using the high pressure hose, a preset pressure can be set so that the inflator will automatically shut-off once the desired pressure is reached.

- 1 Press the pressure mode button until the desired pressure unit is displayed on the screen.

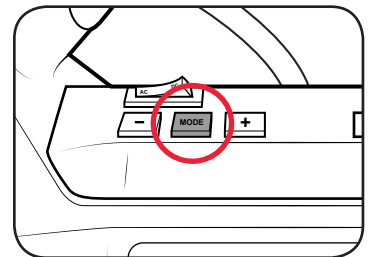

- 2 Increase the preset pressure using the "+" button or decrease the pressure using the "-" button. The preset pressure will be displayed on the digital display as it is adjusted.

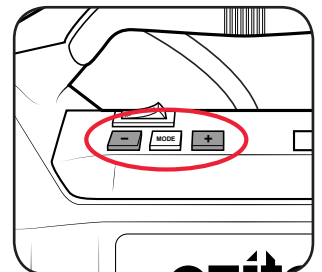

5. INFLATING HIGH PRESSURE ITEMS

The high pressure air hose can be used to inflate high pressure items such as car and bike tyres or sporting equipment.

- 1 Attach the required inflation adaptor to the high pressure hose and secure using the locking lever.

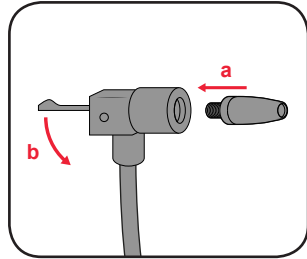

- 2 Insert / attach the hose adaptor to the item to be inflated.

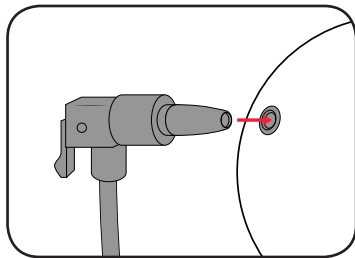

- 3 Adjust the target pressure using the "+" and "-" pressure adjustment buttons.

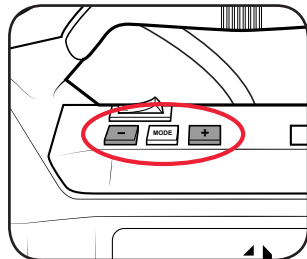

Note: The required pressure should be written on the item.



WARNING! AVOID INFLATING THE OBJECT ABOVE THE RECOMMENDED INFLATION PRESSURE. THIS MAY LEAD TO DAMAGE AND/OR INJURIES.

- 4 Press the operating mode switch into "I" position to start inflating the high pressure item.

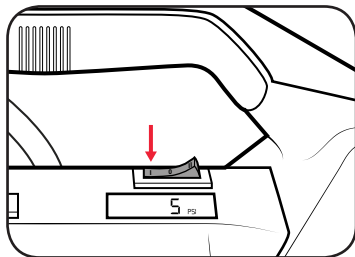

- 5 Once the preset pressure is reached, the tool will automatically shut-off. After the tool has automatically shut off, press the operation mode switch into the off position "0".

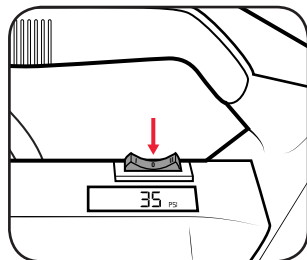

Note: For sporting equipment due to the small size and low pressure, the inflator may automatically cut-off prior to reaching the desired pressure. In this case, cycle the unit on and off until the required pressure is reached.

6. INFLATING HIGH VOLUME ITEMS

The high volume air hose can be used to inflate high volume items by connecting to the air outlet, or deflate high volume items by connecting to the air inlet.

An example of a high volume item is an air mattress or pool toy.

Inflating

- 1 Remove the high volume air hose from the housing and attach to the outlet port.

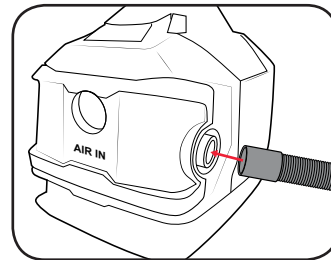

- 2 Insert the adaptor into the inflatable item.

Note: If the inflatable item has a cap or air lock, ensure it is removed or unlocked to allow air to flow into the item.

Deflating

- 1 Remove the high volume air hose from the housing and attach to the inlet port.

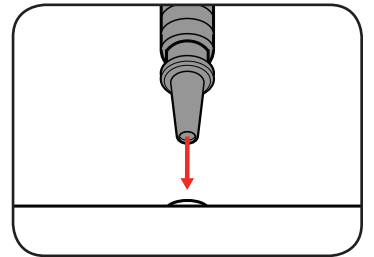
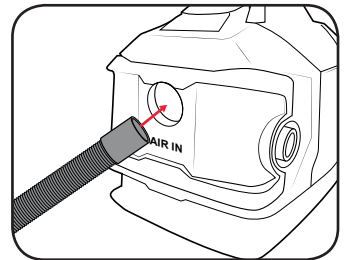

WARNING! ENSURE THE INFLATOR INLET IS NOT BLOCKED DURING INFLATION OR THE OUTLET IS NOT BLOCKED DURING DEFLATION.

- 3 Press the operating mode switch into "II" position to start inflating the high volume item.

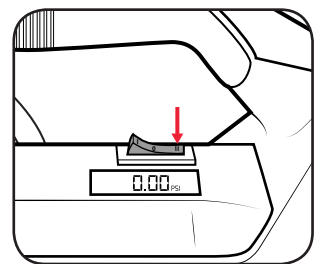

- 4 Once the item is completely inflated, press the operation mode switch into the off position "0".

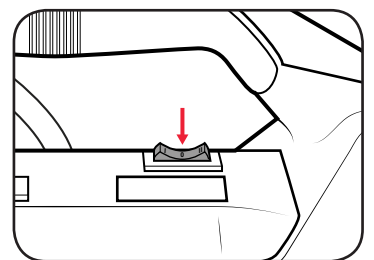

MAINTENANCE



WARNING! ENSURE THE TOOL HAS BEEN SWITCHED OFF AND THE POWER SUPPLY IS DISCONNECTED PRIOR TO ANY MAINTENANCE.









- Keep air intake clean and air vents free of debris to avoid overheating the motor.
- Do not use cleaning agents to clean the plastic parts of the tool. A mild detergent on a damp cloth is recommended. Water must never come into contact with the tool.
- If the inflator vibrates abnormally, stop motor immediately. Abnormal vibration usually indicates a mechanical problem continued operation could lead to injury or damage.

Note: Ozito Industries will not be responsible for any damage or injuries caused by the repair of the inflator by an unauthorised person or by mishandling of the inflator. This tool is designed for DIY use - use in commercial or industrial environments will void the warranty.

TROUBLESHOOTING

Problem	Cause	Remedy
Inflator is not starting	Battery is low in charge	Charge battery
	Battery or power cord not connected properly	Ensure battery is inserted correctly or the power cord is connected
	Incorrect operating mode selected	If a battery is connected, ensure the operating switch is in the DC mode. If the power cord is connected, ensure the operating switch is in the AC mode.
Inflator is not operating at full capacity	Possible clogging	Ensure the air inlet is not blocked when inflating a high volume item. Ensure the air outlet is not blocked when deflating a high volume item.
	Loose hose of adaptor	Ensure the hose or inflation adaptor is fitted securely
Motor stops while inflating	Battery has no power	Charge battery
	High pressure item has reached preset pressure.	The inflator will automatically shut-off when the high pressure item reaches the preset pressure.
The digital display is not working	Power not connected properly	Ensure the power supply is connected and the operating mode switch is in the correct position
	Inflating or Deflating a high volume item	The digital display will only display the current pressure when inflating a high pressure item. When inflating a high volume item the display will show 0.00

DESCRIPTION OF SYMBOLS

V	Volts	Hz	Hertz
mA	Milliamperes	W	Watts
ac / ~	Alternating current	dc	Direct current
/min	Revolutions or reciprocation per minute	∅	Diameter
A	Amps	n_o	No load speed
PSI	Pressure rating	kPa	Pressure rating (kilopascals)
bar	Pressure rating	L	Litres
	Regulator compliance mark		Double insulated
	Read instruction manual	l/min	Litres per minute
	Wear hearing protection		Beware of electrical voltage
	Beware of hot parts		Warning! The equipment is remote-controlled and may start-up without warning
	Warning		

BATTERY AND CHARGER SAFETY WARNINGS

THIS MANUAL CONTAINS IMPORTANT SAFETY AND OPERATING INSTRUCTIONS FOR YOUR BATTERY CHARGER.

1. Before using the charger read all instructions and cautionary markings on the charger, battery pack and the product using the battery pack.
2. This charger is not intended for any uses other than charging rechargeable batteries. Any other use may result in risk of fire, electric shock or electrocution.
3. Do not place any object on top of the charger or place the charger on a soft surface that may result in excessive internal heat. Place the charger in a position away from any heat source.
4. To reduce risk of damage to the electric plug and cord, pull by the plug rather than the cord when disconnecting the charger.
5. Make sure the cord is located so that it will not be stepped on, tripped over, or otherwise subjected to damage or stress.
6. An extension cord should not be used unless absolutely necessary. Use of an improper extension cord could result in the risk of fire, electric shock or electrocution.
7. Do not operate the charger if it has received a sharp blow, been dropped or otherwise damaged in any way. Have it checked by an electrician or power tool repairer.
8. Do not disassemble charger. Take it to an electrician or power tool repairer when service or repair is required. Incorrect reassembly may result in a risk of electric shock, electrocution or fire.
9. To reduce risk of electric shock, unplug the charger from the outlet before attempting any cleaning. Removing the battery pack will not reduce this risk.
10. Never attempt to connect 2 chargers together.
11. DO NOT store or use the tool and battery pack in locations where the temperature may reach or exceed 40°C (such as inside sheds or metal buildings in summer).
12. The charger is designed to operate on standard household electrical power (240 volts). Do not attempt to use it on any other voltage!
13. The battery pack is not fully charged out of the carton. First read the safety instructions and then follow the charging notes and procedures.
14. The longest life and best performance can be obtained if the battery pack is charged when the air temperature is between 18 - 24°C. Do not charge the battery pack in an air temperature below 10°C or above 40°C. This is important and will prevent damage to the battery pack.
15. Do not incinerate the battery pack even if it is seriously damaged or is completely worn out. The battery can explode in a fire.
16. Never attempt to open the battery pack for any reason. If the plastic housing of the battery pack breaks or cracks, immediately discontinue use and do not recharge.
17. During charging, the battery must be placed in a well ventilated area.

SPARE PARTS

Spare parts can be ordered from the Special Orders Desk at your local Bunnings Warehouse.

For further information, or any parts not listed here, visit www.ozito.com.au or contact Ozito Customer Service:

Australia 1800 069 486

New Zealand 0508 069 486

E-mail: enquiries@ozito.com.au

BATTERY PROTECTION SYSTEM

The tool is equipped with the battery protection system, which helps to ensure a long service life.

The output power automatically cuts off during operation when the tool and/or battery are placed under the following situations:

- **When the tool is overloaded:**

If this occurs, release the trigger switch and remove causes of overload, then pull the switch trigger again to restart.

- **When the remaining battery capacity becomes low:**

Recharge the battery pack.

Note: The battery protection system does not in any way damage the tool.

Note: The indicated capacity may be lower than the actual level during use or immediately after using the tool.

CARING FOR THE ENVIRONMENT



Power tools that are no longer usable should not be disposed of with household waste but in an environmentally friendly way. Please recycle where facilities exist. Check with your local council authority for recycling advice.



Recycling packaging reduces the need for landfill and raw materials. Reuse of recycled material decreases pollution in the environment. Please recycle packaging where facilities exist. Check with your local council authority for recycling advice.



ELECTRICAL SAFETY



WARNING! When using mains-powered tools, basic safety precautions, including the following, should always be followed to reduce risk of fire, electric shock, personal injury and material damage.

Read the whole manual carefully and make sure you know how to switch the tool off in an emergency, before operating the tool. Save these instructions and other documents supplied with this tool for future reference.

The electric motor has been designed for DC (18V) motor and AC (230-240V) motor only. The charger has been designed for 230V and 240V only. Always check that the power supply corresponds to the voltage on the rating plate.

Note: The supply of 230V and 240V on Ozito tools are interchangeable for Australia and New Zealand. If the supply cord is damaged, it must be replaced by an electrician or a power tool repairer in order to avoid a hazard.



This tool is double insulated therefore no earth wire is required.

Note: Double insulation does not take the place of normal safety precautions when operating this tool. The insulation system is for added protection against injury resulting from a possible electrical insulation failure within the tool.

Using an Extension Lead

Always use an approved extension lead suitable for the power input of this tool. Before use, inspect the extension lead for signs of damage, wear and ageing. Replace the extension lead if damaged or defective.

When using an extension lead on a reel, always unwind the lead completely. Use of an extension lead not suitable for the power input of the tool or which is damaged or defective may result in a risk of fire and electric shock.

The power supply for this products 240V power cord should be protected by a residual current device (rated at 30mA or less). A residual current device reduces the risk of electric shock.



GENERAL POWER TOOL SAFETY WARNINGS



WARNING! Read all safety warnings and all instructions. Failure to follow the warnings and instructions may result in electric shock, fire and/or serious injury.

Save all warnings and instructions for future reference. The term "power tool" in the warnings refers to your mains-operated (corded) power tool or battery-operated (cordless) power tool.

1. Work area safety

- Keep work area clean and well lit.** Cluttered or dark areas invite accidents.
 - Do not operate power tools in explosive atmospheres, such as in the presence of flammable liquids, gases or dust.** Power tools create sparks which may ignite the dust or fumes.
 - Keep children and bystanders away while operating a power tool.** Distractions can cause you to lose control.
- ## 2. Electrical safety
- Power tool plugs must match the outlet. Never modify the plug in any way. Do not use any adapter plugs with earthed (grounded) power tools.** Unmodified plugs and matching outlets will reduce risk of electric shock.
 - Avoid body contact with earthed or grounded surfaces, such as pipes, radiators, ranges and refrigerators.** There is an increased risk of electric shock if your body is earthed or grounded.
 - Do not expose power tools to rain or wet conditions.** Water entering a power tool will increase the risk of electric shock.
 - Do not abuse the cord. Never use the cord for carrying, pulling or unplugging the power tool. Keep cord away from heat, oil, sharp edges or moving parts.** Damaged or entangled cords increase the risk of electric shock.
 - When operating a power tool outdoors, use an extension cord suitable for outdoor use.** Use of a cord suitable for outdoor use reduces the risk of electric shock.
 - If operating a power tool in a damp location is unavoidable, use a residual current device (RCD) protected supply.** Use of an RCD reduces the risk of electric shock.

3. Personal safety

- Stay alert, watch what you are doing and use common sense when operating a power tool. Do not use a power tool while you are tired or under the influence of drugs, alcohol or medication.** A moment of inattention while operating power tools may result in serious personal injury.
- Use personal protective equipment. Always wear eye protection.** Protective equipment such as dust mask, non-skid safety shoes, hard hat, or hearing protection used for appropriate conditions will reduce personal injuries.
- Prevent unintentional starting. Ensure the switch is in the off-position before connecting to power source and/or battery pack, picking up or carrying the tool. Carrying power tools with your finger on the switch or energising power tools that have the switch on invites accidents.**
- Remove any adjusting key or wrench before turning the power tool on.** A wrench or a key left attached to a rotating part of the power tool may result in personal injury.
- Do not overreach. Keep proper footing and balance at all times.** This enables better control of the power tool in unexpected situations.

- Dress properly. Do not wear loose clothing or jewellery. Keep your hair, clothing and gloves away from moving parts.** Loose clothes, jewellery or long hair can be caught in moving parts.
 - If devices are provided for the connection of dust extraction and collection facilities, ensure these are connected and properly used.** Use of dust collection can reduce dust-related hazards.
- ## 4. Power tool use and care
- Do not force the power tool. Use the correct power tool for your application.** The correct power tool will do the job better and safer at the rate for which it was designed.
 - Do not use the power tool if the switch does not turn it on and off.** Any power tool that cannot be controlled with the switch is dangerous and must be repaired.
 - Disconnect the plug from the power source and/or the battery pack from the power tool before making any adjustments, changing accessories, or storing power tools.** Such preventive safety measures reduce the risk of starting the power tool accidentally.
 - Store idle power tools out of the reach of children and do not allow persons unfamiliar with the power tool or these instructions to operate the power tool.** Power tools are dangerous in the hands of untrained users.
 - Maintain power tools. Check for misalignment or binding of moving parts, breakage of parts and any other condition that may affect the power tool's operation. If damaged, have the power tool repaired before use.** Many accidents are caused by poorly maintained power tools.
 - Keep cutting tools sharp and clean.** Properly maintained cutting tools with sharp cutting edges are less likely to bind and are easier to control.
 - Use the power tool, accessories and tool bits etc. in accordance with these instructions, taking into account the working conditions and the work to be performed.** Use of the power tool for operations different from those intended could result in a hazardous situation.
- ## 5. Battery tool use and care
- Recharge only with the charger specified by the manufacturer.** A charger that is suitable for one type of battery pack may create a risk of fire when used with another battery pack.
 - Use power tools only with specifically designated battery packs.** Use of any other battery packs may create a risk of injury and fire.
 - When battery pack is not in use, keep it away from other metal objects, like paper clips, coins, keys, nails, screws or other small metal objects, that can make a connection from one terminal to another.** Shorting the battery terminals together may cause burns or a fire.
 - Under abusive conditions, liquid may be ejected from the battery; avoid contact. If contact accidentally occurs, flush with water. If liquid contacts eyes, additionally seek medical help.** Liquid ejected from the battery may cause irritation or burns.
- ## 6. Service
- Have your power tool serviced by a qualified repair person using only identical replacement parts.** This will ensure that the safety of the power tool is maintained.



INFLATOR / DEFLATOR SAFETY WARNINGS



WARNING!

We cannot accept any liability for damage or accidents which arise due to a failure to follow these instructions and the safety information.

This appliance is not intended for use by persons (including children) with reduced physical, sensory or mental capabilities, or lack of experience and knowledge, unless they have been given supervision or instruction concerning use of the appliance by a person responsible for their safety.

- Do not aim the hose at other persons or animals.
- Always switch the unit off before changing attachments, filters and emptying the tank.
- When using the inflator to inflate car tyres, ensure you are parked in a safe, well lit location, off the road and with the hand brake engaged.
- Ensure your personal safety is not at risk and never use the inflator while the car is in motion.
- Do not place the hose end against any part of your body when turned on, as this may infuse air into your blood stream putting your health at serious risk.
- Do not make any alterations to this inflator. Only use the adaptors supplied with this product.
- Use this product only in accordance with operation instructions included in this manual.
- Inspect each part before use. Do not use if bent, broken, melted, burnt or if the unit appears to be damaged.
- Check the tyre pressure before inflating. Never exceed the suggested pressure of the item being inflated. If suggested pressure is exceeded, the item being inflated may burst.

- Do not bend or pinch the air hose while the inflator is in use.
- It is not suggested that the inflator work continuously for more than 10 minutes. If 10 minutes of use has been reached, turn it off and let it cool for 10 minutes before using again.
- If the inflator is making abnormal sounds or its temperature is quite high, switch the unit off straight away and let it cool for at least 10 minutes before trying again. Improper use may result in damage of the Compressor.
- Do not leave unattended and operating. Keep out of reach of children.
- Put the inflator in a dry place if it is not in use for an extended period of time.
- Keep the inflator away from flammable liquid or gas. Do not allow the inflator to become wet.
- Never put the connector and adaptors into your mouth, ear or eye. They are not toys.