

Step 6: Locate both leg braces (F) and ensure the long side is near the centre of the frame brace (D) and the short side is closest to the leg (E) – refer to image. Bring both of leg braces together so that they meet in centre of the frame brace (D) and secure with small bolt (L), spring washer, washer and nut.

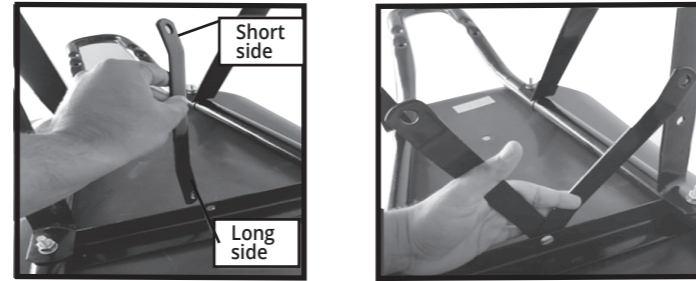

Step 7: Attach the leg brace (F) to each leg, using small bolt (L) and secure with spring washer, washer and nut. Repeat for the other side.

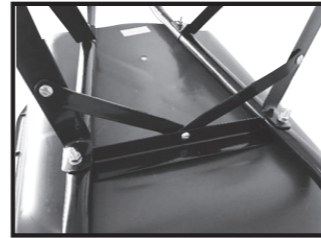

Step 8: Insert the small bolt (L) through the inside of the tray, the front support (G) and the front support plate (H). Secure with spring washer, washer and nut. Make sure the front support brace is in correct position and do not secure this brace to the handle frame at this stage. This needs to occur in the next step (refer to image)

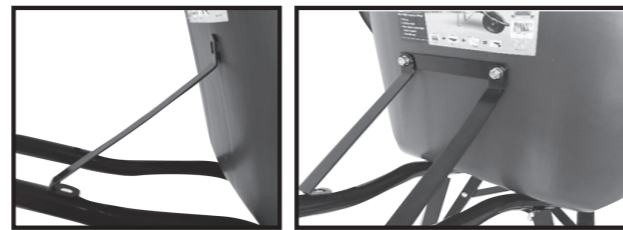

Step 9: Attach the Axle bracket (I), to the front of the handle frame, using medium bolt (M). Ensure the dimple you can see on the axle bracket is facing outwards (refer to image). Secure with spring washer, washer and nut. Please note: only secure one of the axle brackets in place.

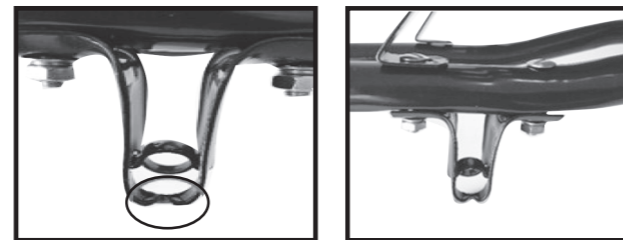

Step 10: Slide the axle (J) through the wheel (K) and insert into the fixed axle bracket. Using medium bolt (M) secure the other axle bracket (I) into position with spring washer, washer and nut.

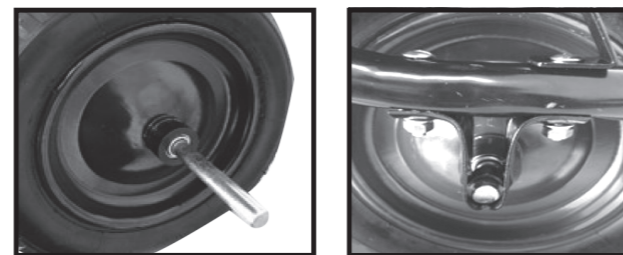

Step 11: Tighten all nuts securely. Inflate the tyre to a maximum 25PSI. Please ensure you use a manual pump to avoid injury and do not over inflate.

Your wheelbarrow is now fully assembled and ready for use.



60 LITRE GARDEN WHEELBARROW
(Item No. 3350437)

Assembly Instructions

Parts List					
Picture	Description	Qty	Picture	Description	Qty
	A. Fork	1		H. Support Plate	1
	B. Handle Grips	2		I. Axle Bracket	2
	C. Tray	1		J. Axle	1
	D. Frame Brace	1		K. Wheel	1
	E. Leg	2		L. Bolt Small	5
	F. Leg Brace	2		M. Bolt Medium	4
	G. Front Support	2		N. Bolt Long	4



60 LITRE GARDEN WHEELBARROW

(Item No. 3350437)

Assembly Instructions

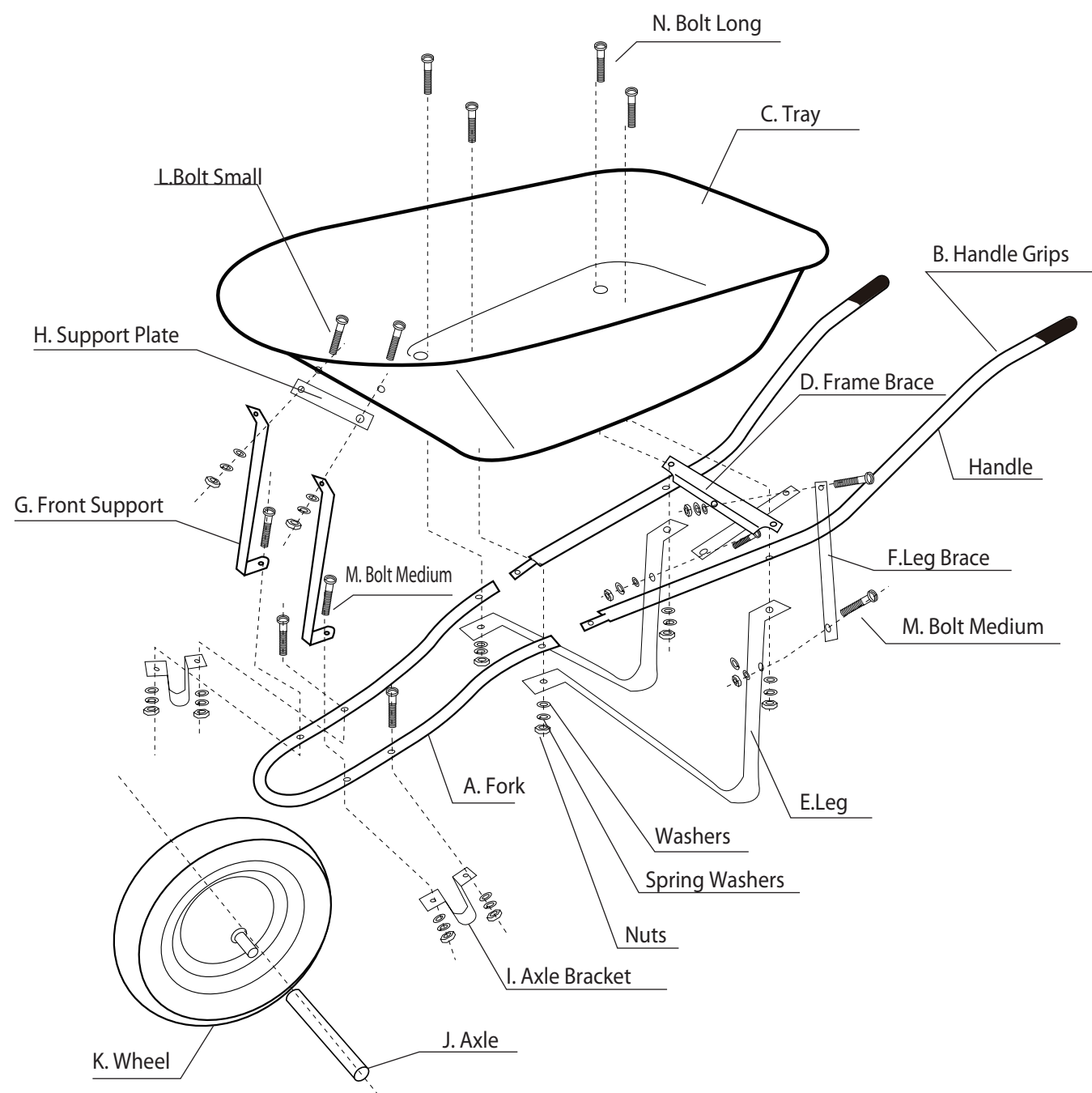

ASSEMBLY

Step 1: Join the fork (A) and the handle grips (B) together.

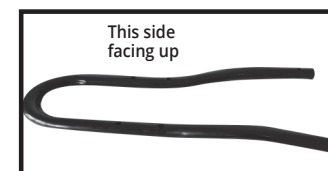

Step 2: Turn the tray (C) on to its side, and connect the handles to the tray using the long bolt (N). Insert this bolt through the front tray holes and loosely tighten.



Step 3: Slide the frame brace (D) between the tray and the rear holes of the handle grips.



Step 4: While holding the wheelbarrow tray on its side, place one leg (E) onto the handle grips and insert the long bolt (N) through the rear hole of the tray, frame brace, handle and leg. Secure with spring washer, washer and nut (hand tighten only).

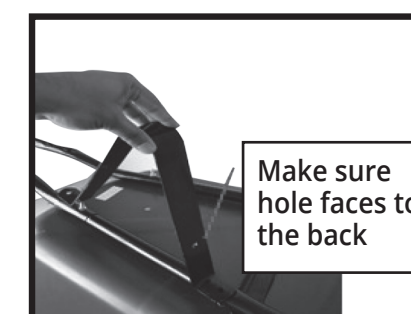

Step 5: While holding the wheelbarrow tray on its side, remove the nut from the bolt inserted in step 2. Then insert the long bolt (N) through the tray, handle and leg and secure using a spring washer, washer and nut. Repeat on the other side.

