

# HEATSTRIP<sup>®</sup>

O U T D O O R H E A T E R S



## Product & Assembly Manual



### HEATSTRIP<sup>®</sup> Electric Portable Heater Model No. THH1800AP

Scan here for HEATSTRIP Installation video



[www.heatstrip.com.au](http://www.heatstrip.com.au)



## Contents

<b>Product Overview</b>	3
Specifications	3
Product Features & Benefits	3
<b>Installation Requirements</b>	4
Hardware Pack	4
Hardware Tools Required	4
Parts Diagram	5
Product Part List	6
<b>Assembly Instructions</b>	7
Electric Heater Assembly Instructions	7-9
<b>Maintenance and Safety</b>	10
Replacement Parts	10
Warranty	11

For repairs or replacement parts, please contact:  
 Thermofilm Australia Pty Ltd  
 17 Johnston Court, Dandenong South, Victoria 3175, Australia  
 Telephone: (03) 9562 3455  
 8:30am-5:00pm Mon-Fri (EST)  
 Email: sales@thermofilm.com.au

To obtain the correct replacement parts for your electric radiant heater, please refer to the part numbers in this parts list. The following information is required to ensure you receive the correct parts:

1. Model and Serial Number (see label on the heater)
2. Part Number
3. Part Description
4. Quantity of parts needed

**Important:** Use only Thermofilm replacement parts. The use of any part that is not a Thermofilm replacement part can be dangerous and void your product warranty. Keep this Instruction Manual for convenient referral and for part replacement.



## Specifications - Australia

MODEL	POWER (WATTS)	CURRENT (AMPS)	DIMENSIONS (mm)	WEIGHT (Kg)	LEAD LENGTH (mm)	PLUG
THH1800AP	1800	7.5	1104 (w) x 670 (d) x 2150 (h)	22	3000	Yes

HEATER TYPE	High intensity electric radiant overhead heater with high surface area profiled alloy
POWER	230-240 Volts Nominal at 50—60 Hertz, Single Phase
CONNECTION	3 Core Cable 2.5mm <sup>2</sup>
APPROVALS	AUSTRALIA/NZ
PROTECTION RATING	IP55 Protection from water ingress from all directions
COUNTRY OF ASSEMBLY	Australia (Designed, engineered and assembled )

## Features & Benefits

- Stylish, high quality portable, free-standing outdoor heater stand
- Ideal for alfresco areas, balconies, apartments & hospitality (internal & external use)
- Heating area up to 3 - 4m<sup>2</sup>
- Concealed power cable ensures a sleek appearance
- Black, no glow heater
- Components are sub-assembled for easy DIY installation
- In-built wheels for easy portability, perfect for residential and commercial applications
- Corrosion protected for even the toughest environments
- 2 year residential and 1 year commercial warranty
- Heater: High temp ceramic coated extruded alloy
- Stand: E-coated mild steel with powder coat finish

## Tips

- If an extension lead is required, use one as short as possible, as a long lead may result in performance loss
- Locate the heater as close to the power point as possible
- This portable heater is for spot heating only. Locate as close to the area you want to heat as possible (e.g. Table)
- Store under cover to prolong heater life

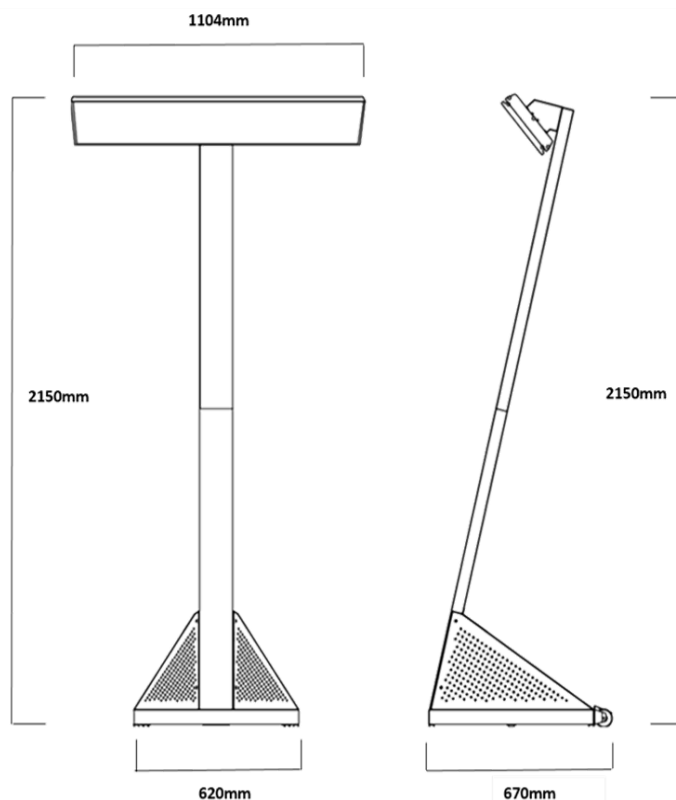



## Hardware Pack For THH1800AP

PART #	PART DESCRIPTION	QTY	PURPOSE OF PART
P06033001A	Hardware Pack	1	For use in assembly of THH1800AP
S112M06102	Pan Head Screw M6 x 10mm	4	Install Base Brackets to Base
S112M06102	Pan Head Screw M6 x 10mm	3	Install Lower Post to Base
S112M06102	Pan Head Screw M6 x 10mm	4	Install Side Panels to Lower Post & Base
S112M06102	Pan Head Screw M6 x 10mm	6	
S112M06102	Pan Head Screw M6 x 10mm	2	Install Real panel to Side Panel & Lower Post
S112M05102	Pan Head Screw M5 x 10mm	4	
S112M06102	Pan Head Screw M6 x 10mm	2	Install Heater Bracket to Upper Post
S112M06102	Pan Head Screw M6 x 10mm	6	Install Upper Post to Lower Post
	Screwdriver	1	
Already Installed in Base			
S112M0610A	Pan Head Screw M6 x 10mm	2	Install Lower Post to Base
S112M0610A	Pan Head Screw M6 x 10mm	2	Install Heater Bracket to Upper Post
Already Installed in Head Outer Case			
S01010021A	Bolt M6 x 130mm	1	Install Heater Bracket

## Hardware Diagram for THH1800AP



Pan Head Screw M6x  
10mm  
Qty: 27  
Part # S112M06102



Pan Head Screw M5x 10mm  
Qty: 4  
Part # S112M0510A

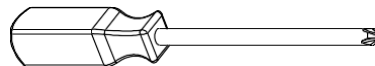

Phillips Head Screwdriver  
required (Not Included)



Pan Head Screw M6x10mm  
Qty. 4 (pre-installed)  
Part # S112M0610A

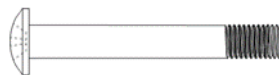

Bolt M6x130mm  
Qty. 1 (pre-installed)  
Part # S01010021A



## Parts List of THH1800AP

Key	Description	Part No	Qty
1	Wheel	P03351004D	2
2	Skid Pad	P05518114I	4
3	Base	P03351001D	1
4	Kick Plate	P03351002D	1
5	Fixed Bracket	P03351003D	2
6	Post - Rear, Lower	P03351005D	1
7	Post - Rear, Upper	P03351006D	1
8	Post - Front, Lower	P03351007D	1
9	Post - Front, Upper	P03351008D	1
10	Side Panel / Left	P03351009D	1
11	Side Panel / Right	P03351010D	1
12	Rear Panel	P03351011D	1
13	Heater Bracket	P03351012D	1
14	Base Bracket	P03351013D	2
15	Electric Heater, 1800W	THH1800A	1





## Parts Diagram

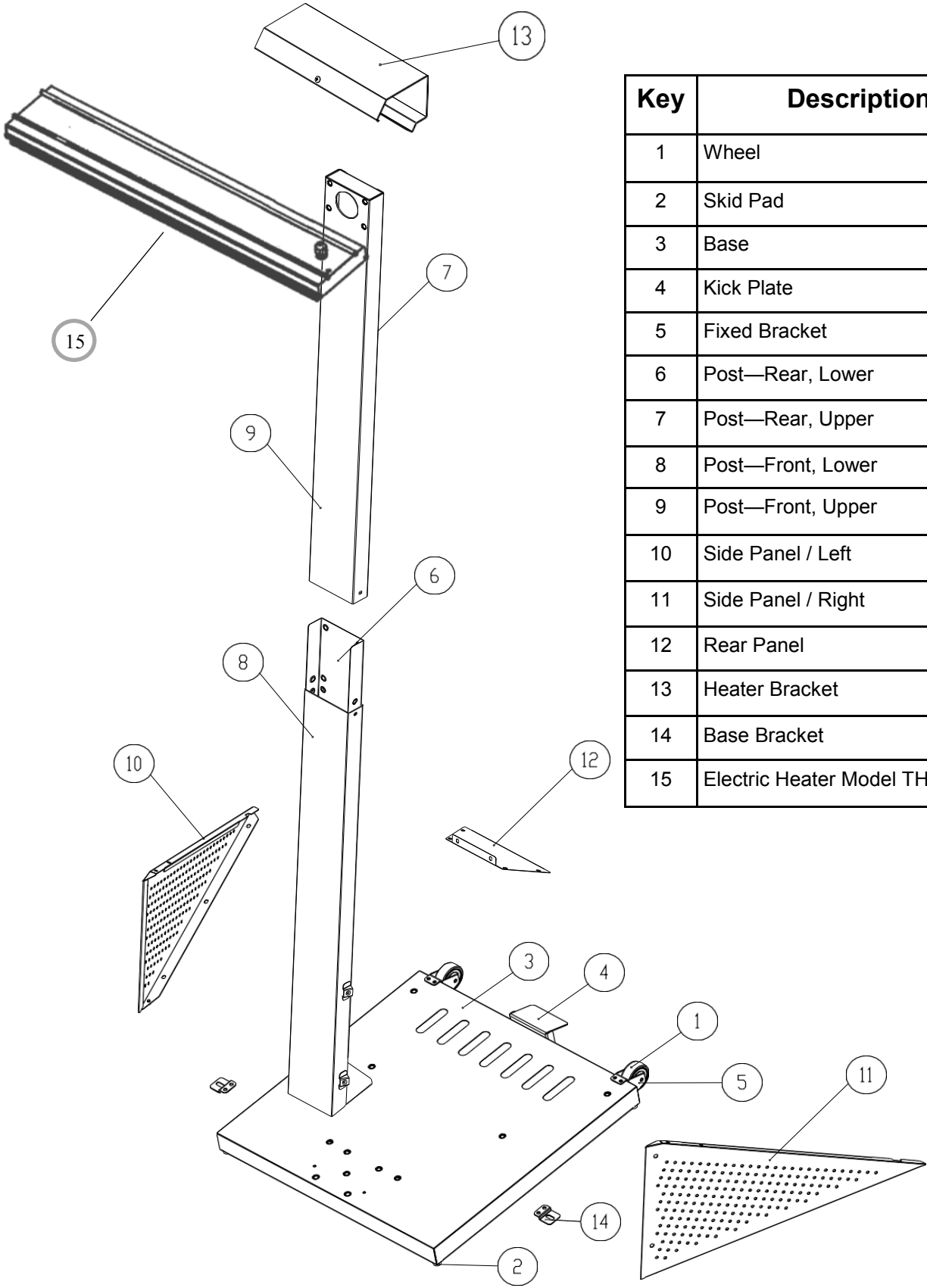

Key	Description
1	Wheel
2	Skid Pad
3	Base
4	Kick Plate
5	Fixed Bracket
6	Post—Rear, Lower
7	Post—Rear, Upper
8	Post—Front, Lower
9	Post—Front, Upper
10	Side Panel / Left
11	Side Panel / Right
12	Rear Panel
13	Heater Bracket
14	Base Bracket
15	Electric Heater Model THH1800A



## Assembly Instructions

**CAUTION:** To assemble this heater, you should obtain assistance from another person when handling the larger, heavier pieces.

### 1 Install Base Brackets (Optional for fixed installation)

- Remove all the packing materials and place on a non-abrasive surface.
- Position the Base as shown in the diagram.
- Install two Brackets to the Base using 4 Pan Head Screws (M6x10mm), once brackets are in place tighten all the screws securely.



Pan Head Screw M6x 10mm  
QTY: 4  
Part # S112M06102

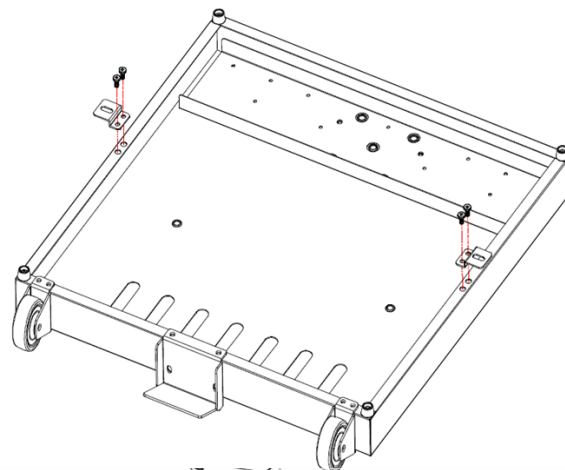

### 2 Install Lower Post

- Loosen the 2 pre-installed screws half way on the Base shown on the diagram, Attach the Lower Post to the Base by matching the slotted holes on the Lower Post into the screws on the Base. Next, attach 3 Pan Head Screws M6x10mm, then tighten all the screws securely



Pan Head Screw M6x 10mm  
QTY: 3 + 2 (pre-installed)  
Part # S112M06102

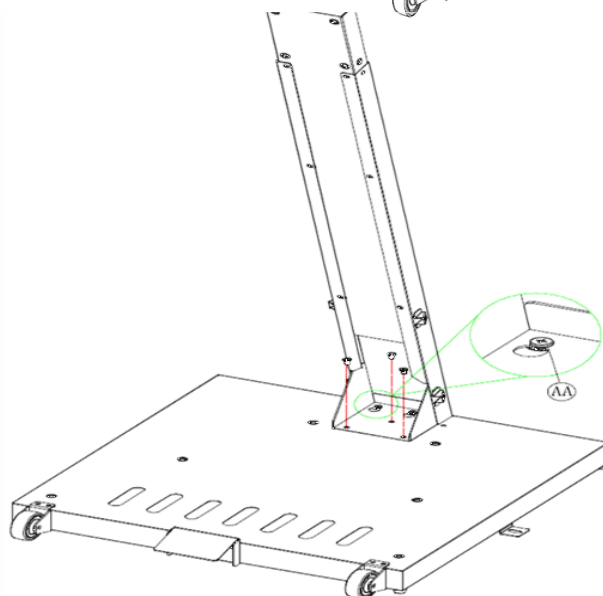

### 3 Install Side Panels

- Place two Side Panels onto the Base.
- Install the Left Side Panel to the Lower Post using 2 Pan Head Screws M6x10mm. Install the Left Side Panel to the Base using 3 Pan Head Screws (M6x10mm).
- Repeat the same procedure for the Right Side Panel, then tighten all the screws securely.



Pan Head Screw M6x 10mm  
QTY: 10  
Part # S112M06102

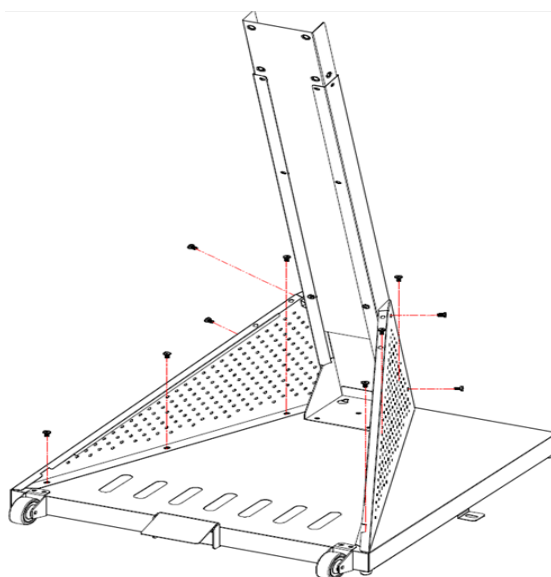



## Assembly Instructions

### 4 Install Rear Panel

- Install the Rear Panel to the Lower Post using 2 Pan Head screws. (M6x10mm)
- Install the Rear Panel to the Side Panels using 4 Pan Head Screws (M5x10mm) then tighten all the screws securely.



Pan Head Screw M6x 10mm  
QTY: 2  
Part # S112M06102



Pan Head Screw M5x10mm  
Qty. 4  
Part # S112M0510A

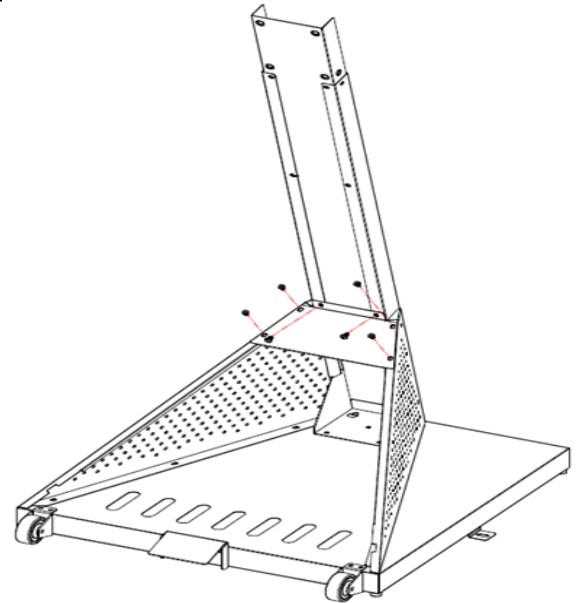

### 5 Install Heater Bracket to the Top Post

- Loosen the two pre-installed screws (See "AA") on the Upper Post half way .
- After the screws have been loosened attach the heater bracket to the upper post matching the slotted holes.
- Next attach 2 pan head screws (M6x10mm) at the bottom of the bracket, then slowly tighten all the screws securely. The 2 pan head screws holes should be located under the pre-installed screws.



Pan Head Screw M6x10mm  
QTY: 2 + 2 (pre-installed)  
Part # S112M06102

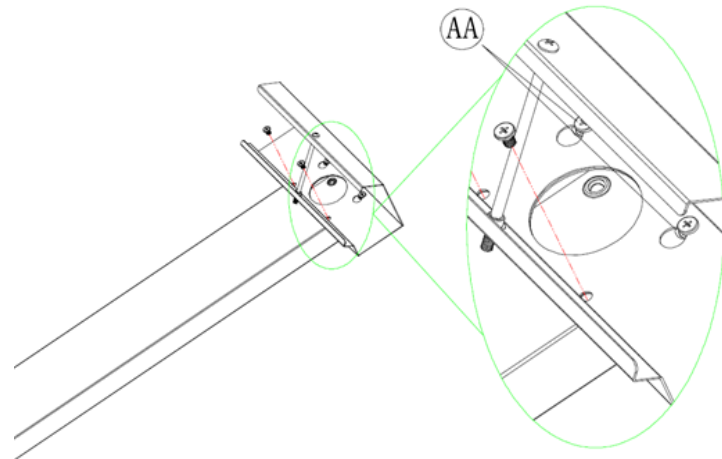

### 6 Install the Heater to Bracket Head attached on the Upper Post

- Loosen the pre-set screw in the centre of the bracket head.
- Place the extension lead through the circular hole on the upper post. After the lead is concealed you'll need to place the heater on the bracket.
- Attach the heater to the bottom bracket before proceeding to the top. Once the bottom and top is in place you can start tightening the pre-set screw.
- Make sure the heater is centred before proceeding to tighten the pre-set screw on the heater bracket.

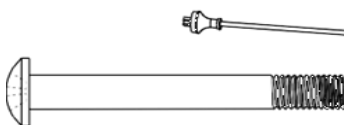

Bolt M6x130mm  
QTY: 1 (pre-installed)  
Part # S112M0610A

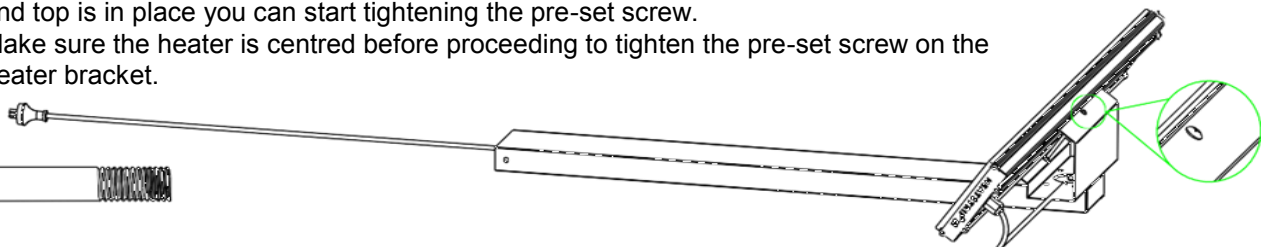





## Assembly Instructions

### 7 Install the Upper post Assembly

- With the help of an assistant, insert and slide top post over front assembly slip joint to the lower post. Before sliding the top post to the lower post an assistant is required to hold the upper post while you lower the cord through the centre of the lower post concealing the 3 pin cord.
- Install the upper post assembly to the lower post using 8 pan head screws (M6x10mm) then tighten all the screws securely.

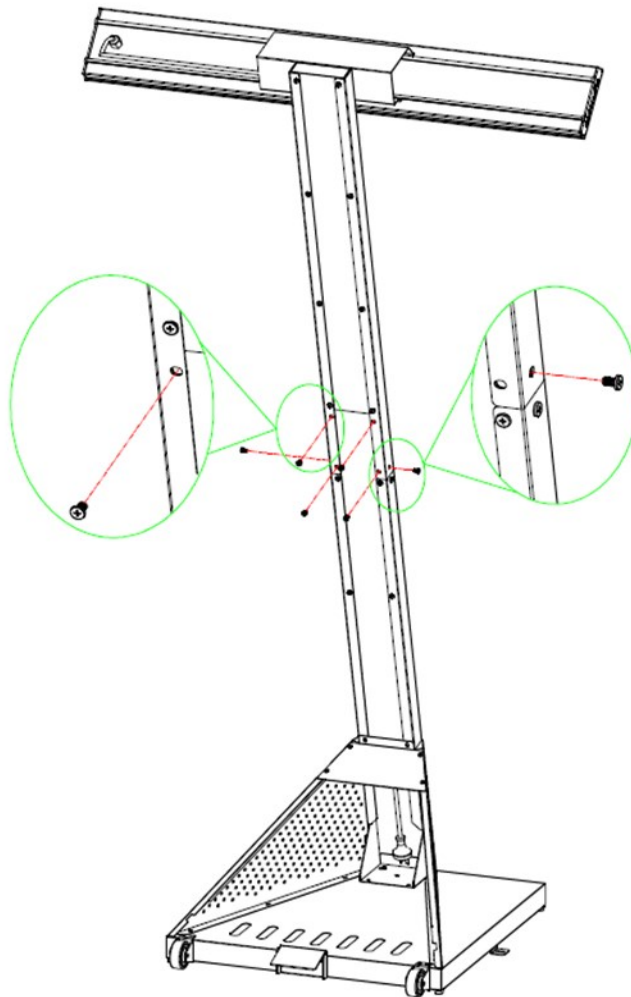

Pan Head Screw M6x 10mm  
QTY: 8  
Part # S112M06102



## Safety

HEATSTRIP® Classic has an IP rating of 55. This means it is safe for water ingress from all directions. The HEATSTRIP® can be safely hosed down.

HEATSTRIP® has undergone extensive testing both in laboratory conditions, in Thermofilm's manufacturing facility in Melbourne and field trials in Australia and overseas. It is this testing that gives the purchaser the confidence of a high quality product.

Independent laboratory testing has confirmed Thermofilm's full compliance with Australian and other International Standards including CE, AS/ANZ, UL/CSA

HEATSTRIP® is Class 1 equipment and must be earthed.

In operation, this heater is VERY HOT— do not touch any part of the heater while it is turned on. Do not touch any part until at least 30 minutes after it is turned off.

This appliance is not intended for use by persons (including children) with reduced physical, sensory or intellectual capabilities, or lack of experience and knowledge, unless they have been given supervision or instruction concerning use of the appliance by a person responsible for their safety. Children should be supervised to ensure they do not play with the appliance.

Do not allow any cables, furnishings, flammable materials or other items come in contact with any surface of the heater.

The heater needs to be installed as per the installation instructions.

In case of a heater fault or damaged supply lead, the appliance should be returned to the point of purchase for return to Thermofilm for repair.

## Maintenance

The HEATSTRIP® Classic is made from durable materials, however regular care and maintenance of your heater will help prolong the life of the heater.

It is recommended that you hose down the heater and with a soft cloth gently wipe the surfaces of the heater with a mild detergent to remove the built up contaminants from the environment. Then rinse all detergent off the heater. All chemicals in the atmosphere including cigarette smoke, pollution etc. will tarnish the surface of the heater. In this case, additional cleaning and maintenance may be required. Carrying out the cleaning process at least every three months will reduce the amount of build up and keep the Heatstrip in good condition. If the heater is in a corrosive environment eg. salt spray, we recommend that you clean your heater with a light spray of fresh water every week. After cleaning, turn the heater on for 20 minutes to dry any water residue and prevent water staining.

Before cleaning or inspection activity, the heater must be switched off and cooled down completely.

Do not use any abrasive materials or products to clean the heater, this includes solvents, citrus based cleaners or other harsh cleaning products.

When handling the heater, ensure that your hands are clean or that you use clean gloves as grease or dirt can mark the surface of the heater.

Do not use high pressure water to clean heaters, light water spray only.



## Warranty Terms & Conditions

The below Warranty Terms and Conditions apply for **Australia and New Zealand only**. For international warranty please refer to international warranty terms and conditions.

Thermofilm warrants to the original owner that HEATSTRIP Electric Portable Heater products will be free from defects in materials and workmanship for a period of 24 months from the date of purchase for residential applications and 12 months for commercial applications in accordance with the following warranty terms and conditions.

Provision of this warranty is subject to:

- The HEATSTRIP products must be installed in accordance with the Installation Instructions and relevant electrical standards and codes.
- The HEATSTRIP products must be maintained and cleaned according to instructions detailed in the Installation Manual.
- There is no warranty expressed or implied with regard to capacity requirements. The selection of the unit or units depends entirely upon the system design and capacities as determined by the purchaser.
- The customer has not repaired, opened or altered the product in any unauthorised manner.
- This warranty excludes damage to the product or components arising from circumstances outside the control of Thermofilm, including, but not limited to, where the product is not used for intended purpose; where the product has been rectified in any way; incorrect installation; incorrect power supply; damaged caused during delivery; misapplication, misuse, abuse, vandalism, lack of maintenance or accident.
- Thermofilm's obligations under this warranty are limited to repair or replacement at Thermofilm's factory of any components of the product which Thermofilm identifies to its satisfaction to be defective.
- Transportation charges involved in return of the product to the Thermofilm factory (or any other location authorised in writing by Thermofilm) is the sole responsibility of the customer.
- All products are inspected and tested before despatch and are at the risk of the purchaser after the shipment from the Thermofilm factory, if not delivered by Thermofilm to destination.
- No products or components will be supplied in advance of an examination of the faulty product or components by Thermofilm or an authorized representative of Thermofilm.

Thermofilm does not participate in any site related costs or labour expenses incidental to replacement of parts, repairing, removing, installing, servicing, transportation or handling of parts to complete products, and assumes no liability on parts repaired or replaced without written authorisation. Thermofilm shall not be liable for any default or delay in performance of its warranty obligations caused by any circumstances beyond its control, including, but not limited to, judicial or government restrictions, strikes, fires, floods, abnormal weather conditions, delayed supply of components.

Should products be determined as damaged on arrival, immediately notify the transport company of the condition and have them noted on the freight documents. If damage is discovered after unpacking, demand immediate inspection by the transportation company and insist that a record of the damage is made on the freight documentation.

The customer warrants using the product in accordance with:

- Any instructions provided to it by Thermofilm from time to time.
- All government and local regulations, including but not limited to all relevant electrical, environmental laws and regulations governing the installation, storage, use, handling and maintenance of the goods.
- All necessary and appropriate precautions and safety measures relating to the installation, storage, use, handling and maintenance of goods.

*Our goods come with guarantees that cannot be excluded under the Australian Consumer Law. You are entitled to a replacement or refund for a major failure and for compensation for any other reasonably foreseeable loss or damage. You are also entitled to have the goods repaired or replaced if the goods fail to be of acceptable quality and the failure does not amount to a major failure.*

All warranty requests for repairs or replacements must be accompanied by a complete "Warranty Claim Form" available from Thermofilm, together with proof of purchase (and where possible, photos of the installation) and the heater returned to the place of purchase.

In the event of a warranty claim, the goods need to be returned to the distributor/retailer for repair/replacement. Contact

Thermofilm Australia Pty Ltd  
 17 Johnston Court, Dandenong South, Victoria 3175, Australia  
 Telephone: (03) 9562 3455  
 Email: [Info@thermofilm.com.au](mailto:Info@thermofilm.com.au)  
[www.heatstrip.com.au](http://www.heatstrip.com.au)