

AEG

BRFM18
BRFMB18

Original instructions

Important!

This appliance is not intended for use by persons (including children) with reduced physical, sensory or mental capabilities, or lack of experience and knowledge, unless they have been given supervision or instruction concerning use of the appliance by a person responsible for their safety.

Children should be supervised to ensure that they do not play with the appliance.

- | | | | |
|---------------------------------|---|--------------------------------------|-------------------------------------|
| 1. Mode selection | 11. Preset selection | 18. Handle | 26. Aux 2 input jack |
| 2. Custom equaliser | 12. Connect via Bluetooth® (BRFMB18 only) | 19. Volume/tuning control | 27. Battery port |
| 3. Clock display setting | 13. Bluetooth® mode indicator (BRFMB18 only) | 20. Power on/off | 28. Device storage |
| 4. Mute sound (BRFM18 only) | 14. AC power adapter indicator (BRFMB18 only) | 21. Aux 1 input jack | 29. Aux cable |
| 5. FM mode indicator | 15. Battery pack indicator | 22. USB charging port (BRFMB18 only) | 30. AC power adapter (BRFMB18 only) |
| 6. AM mode indicator | 16. Antenna | 23. 18V DC input jack (BRFMB18 only) | 31. AAA battery |
| 7. AUX1 mode indicator | 17. Battery cover latch | 24. Bottle opener | |
| 8. AUX2 mode indicator | | | |
| 9. Battery pack indicator | | | |
| 10. Radio tuning or song select | | | |

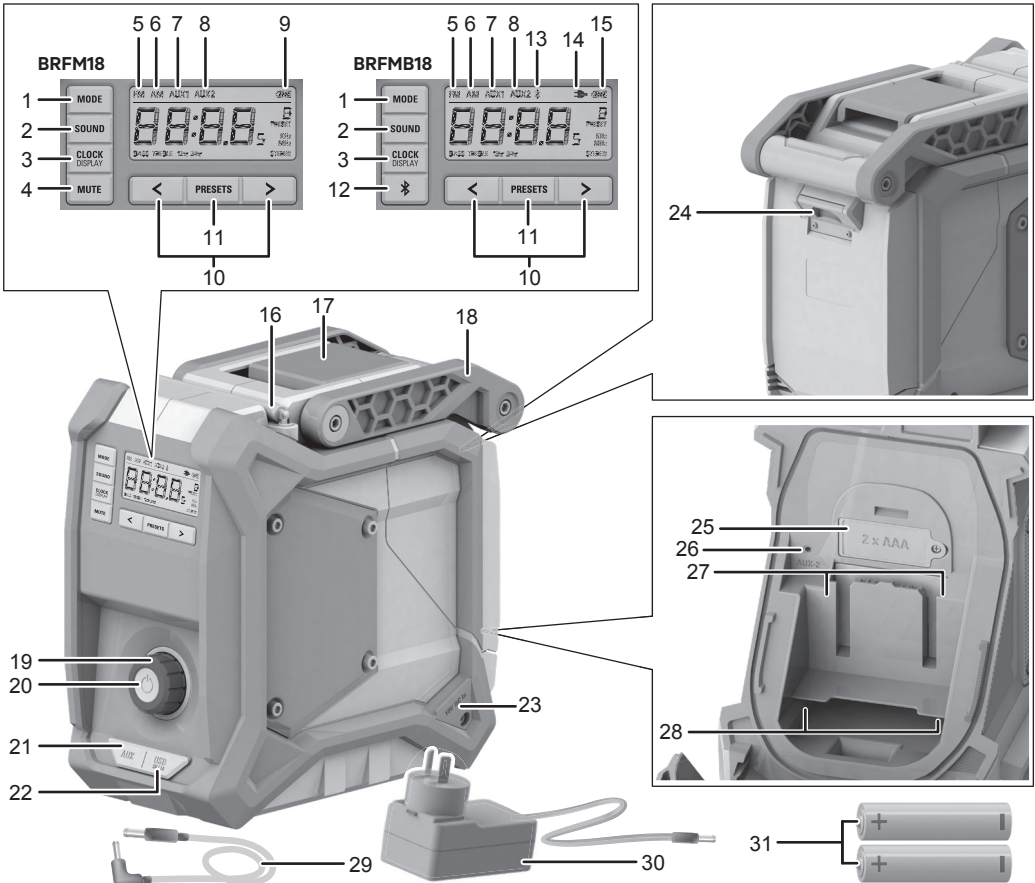

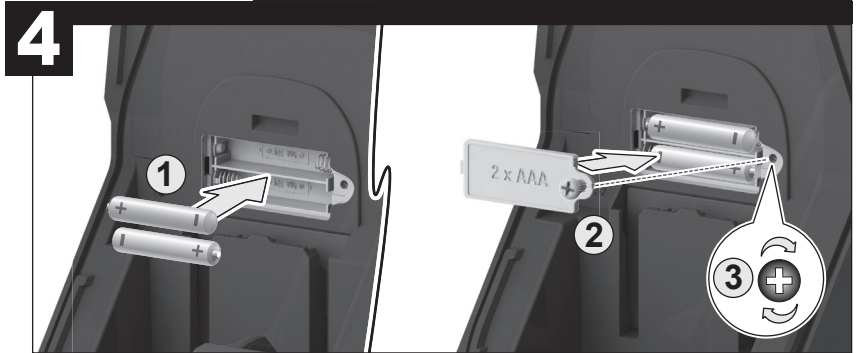
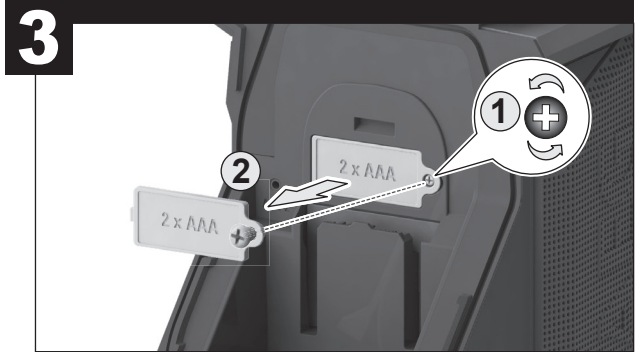
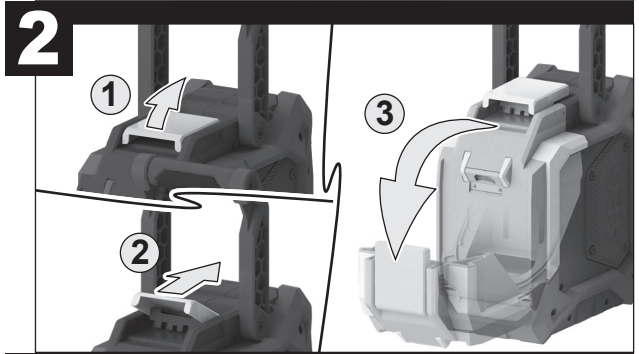
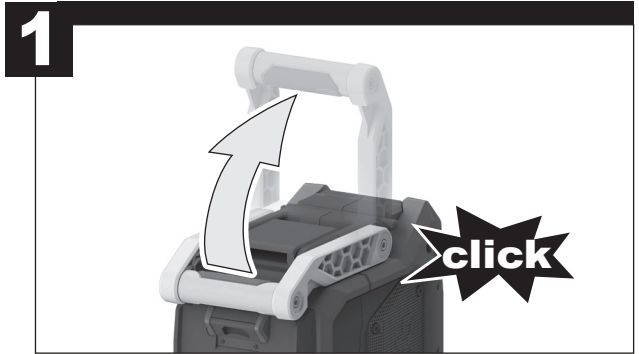
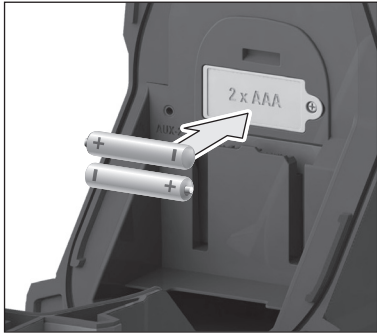

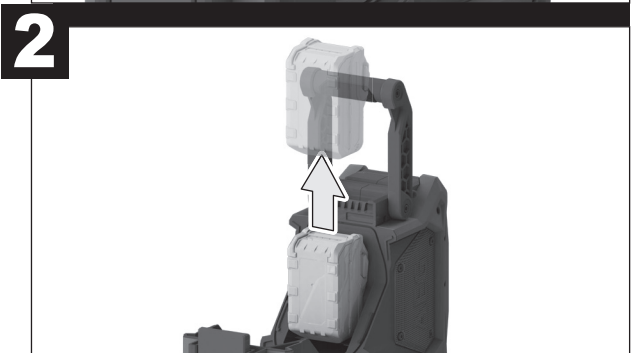
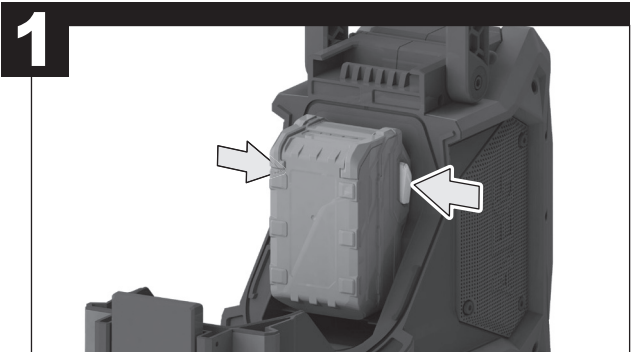
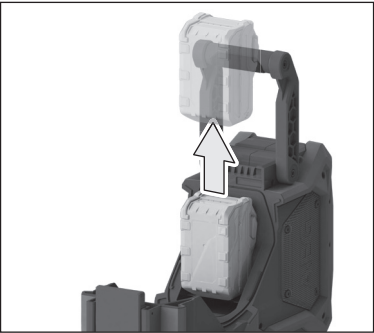
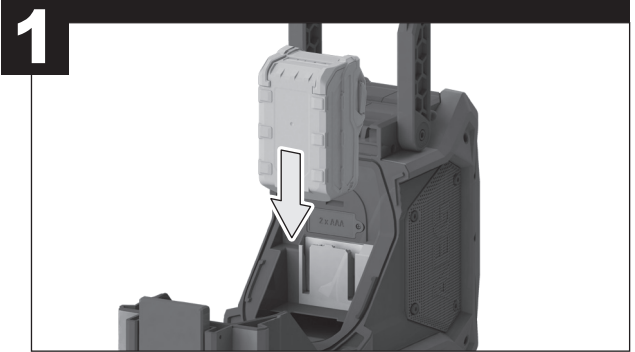
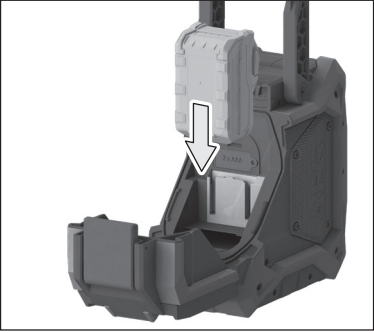

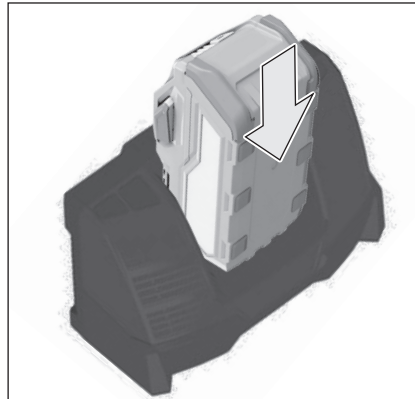
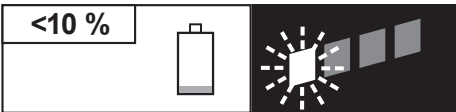
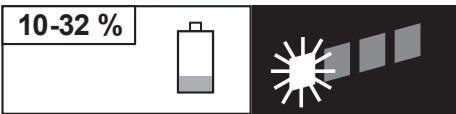
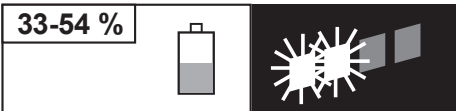
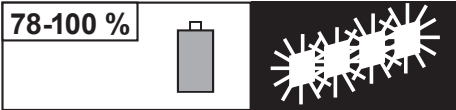
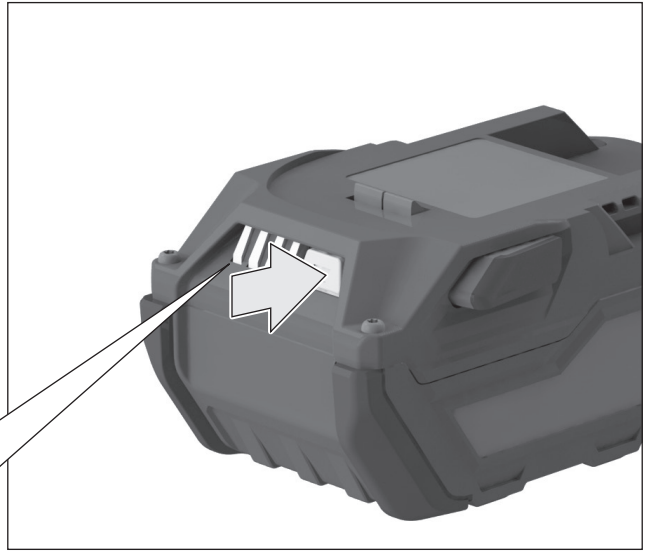

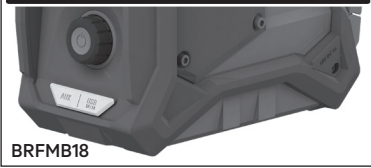
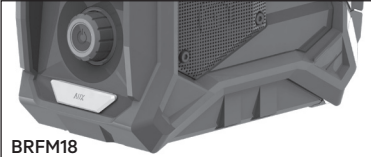

AUX1 mode

BRFM18

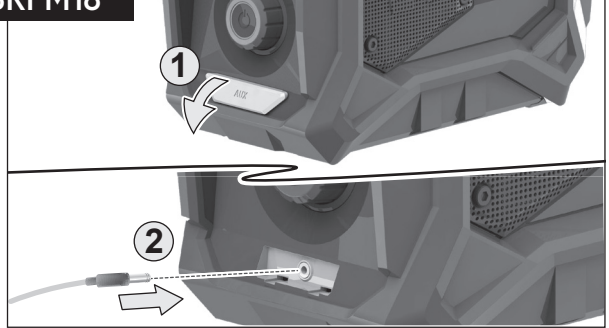

BRFBM18

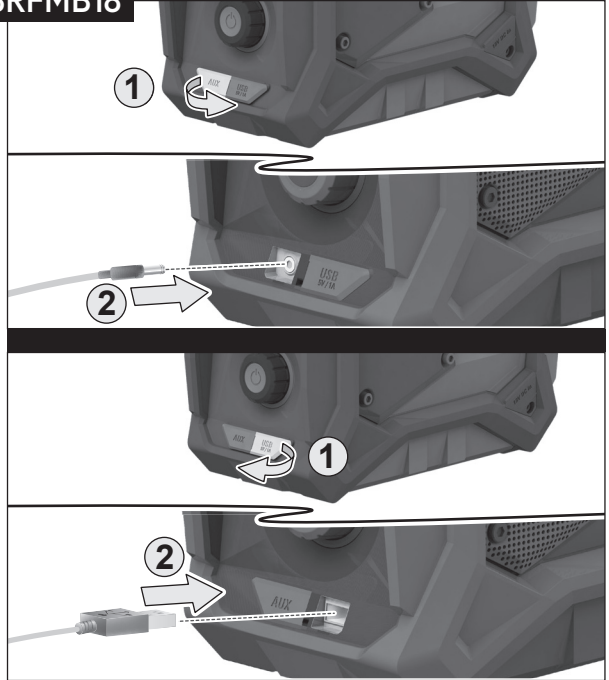

For BRFBM18

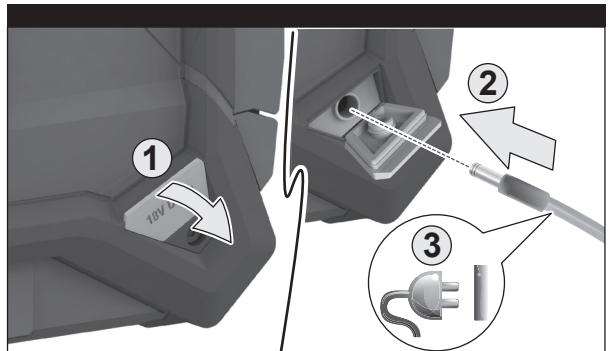
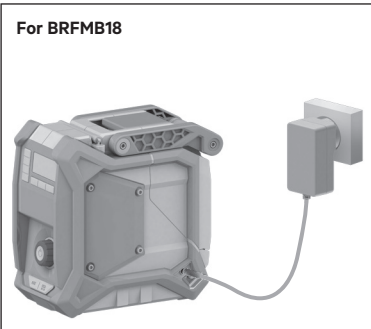



AUX2 mode

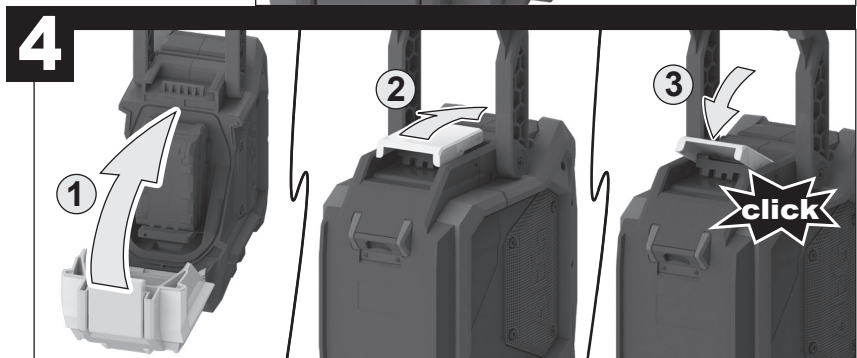
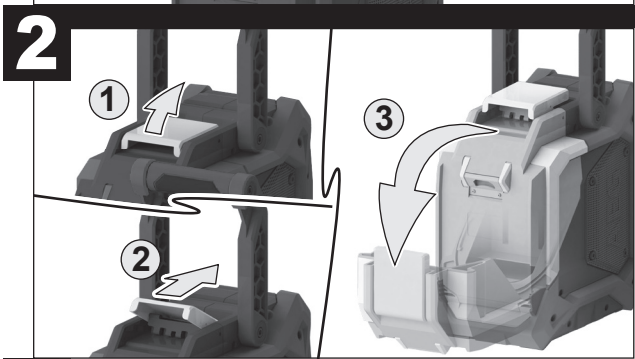
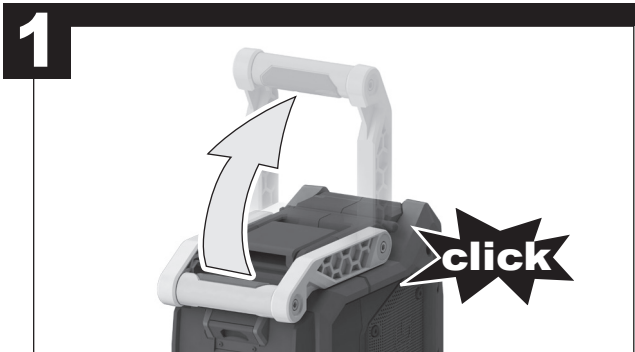

1. Mode selection
2. Custom equaliser
3. Clock display setting
4. Mute sound
5. Preset selection
6. Radio tuning or song select
7. AC adapter indicator
8. Battery pack indicator
9. Volume/tuning control
10. Power on/off
11. Bluetooth® indicator
12. Bluetooth® button

FM mode



AM mode



AUX1 mode



AUX2 mode



BLUETOOTH mode(for BRFMB18)



BRFM18

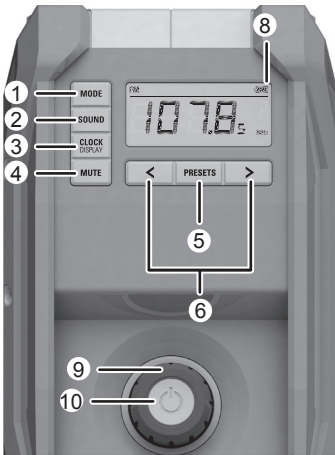

BRFMB18

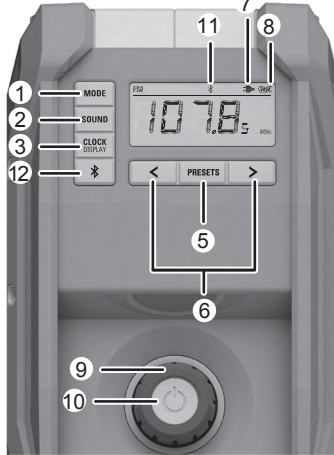

When using radio, adjust the antenna for best signal reception.

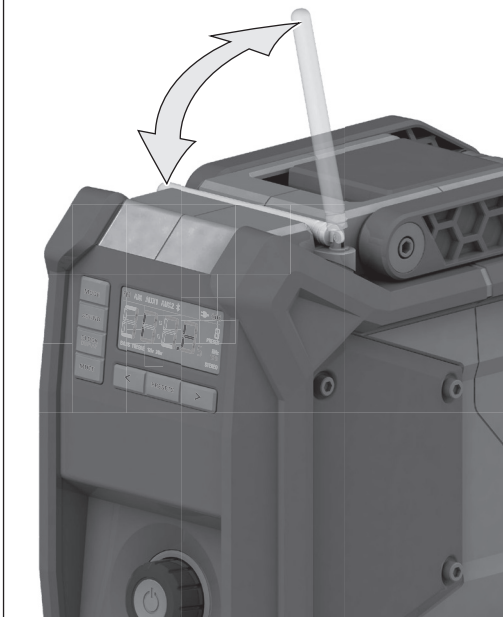

**TECHNICAL DATA****RADIO****BRFM18****BRFMB18**

Rated voltage	18V DC	18V DC
Tuning range FM	87.50 - 108.00 MHz	87.50 - 108.00 MHz
Tuning range AM	522 - 1620 KHz	522 - 1620 KHz
USB output	--	5V/1A max
Weight - not including AUX cable, AC adapter, AAA batteries and battery pack	4.2 kg	4.3 kg
Clock backup	15V AAA (LR03)	15V AAA (LR03)
Sound output wattage (RMS)	4.5 W x 2	4.5 W x 2
Bluetooth® range	--	Max. 40 m
AUX jack input size	3.5 mm	3.5 mm
Speaker size	3.5 in	3.5 in
Adapter input	--	100 - 240VAC 50/60Hz
Adapter output	--	18V DC, 2A

BATTERY AND CHARGER

Compatible battery pack (not included)	Compatible charger (not included)
L1815R	
L1815G	
L1820R	
L1825R	AL18G
L1830R	AL1218G
L1840R	BL1218
L1850R	BLK1218
L1860R	BL18DP-X5
L1890R	BL18DP2-X5
L1830R-X5	BL18DPS
L1860R-X5	

Do not store the battery pack together with metal objects (short circuit risk).

Use only the provided charger for charging the battery pack. Do not use battery packs from other systems.

No metal parts must be allowed to enter the battery section of the charger (short circuit risk).

Never break open battery packs and chargers and store only in dry rooms. Keep dry at all times.

When damaged and under extreme usage and temperature conditions, batteries may start to leak. If chemicals from the batteries come in contact with skin, wash quickly with soap and water. If chemicals from the batteries get into the eyes, flush eyes with clean water for a minimum of 10 minutes and seek immediate medical attention.

Always remove the battery pack from the product when you are assembling parts, cleaning, or when not in use. Removing these energy sources will prevent accidental starting that could cause serious personal injury.

The product shall not be exposed to dripping or splashing and that no objects filled with liquids, such as vases, shall be placed on the product.

Batteries (battery pack or batteries installed) shall not be exposed to excessive heat such as sunshine, fire or the like.

Use only power supplies listed in the user instructions.

Use AEG 18V battery and charger only.

⚠ WARNING! Read all safety warnings, instructions, illustrations and specifications provided with this power tool. Failure to follow all instructions listed below may result in electric shock, fire and/or serious injury. **Save all warnings and instructions for future reference.**

RADIO SAFETY WARNINGS

- Never disassemble or modify this apparatus in any way.
- Do not use this apparatus near water.
- Clean only with dry cloth. Certain cleaning agents and solvents are harmful to plastics and other insulated parts.
- Keep the apparatus handle clean, dry and free of oil or grease.
- Refer all servicing to qualified service personnel.
- Do not install near any heat sources.
- To prevent injury, do not put hands between the battery pack cover and radio when closing the battery pack cover.
- To prevent injury, keep the top surface clear when folding down the handle.
- Do not touch the metal part of the antenna in order to avoid a drop in signal reception caused by electrostatic discharge.
- Do not dispose of used battery packs in the household refuse or by burning them. AEG Distributors offer to retrieve old batteries to protect our environment.

ADAPTER SAFETY WARNINGS

- The outlet should be close to the device and be slightly accessible.
- Do not use the device with a damaged connecting cable or case.
- Follow the technical data given by the manufacturer if you use the device.
- Pull out the plug from the outlet if the device is not used.
- The device is used for office/data processing devices and similar electrical devices and is only for indoor use.
- Maximum ambient temperature is 45 °C.
- The mains connection components of this device cannot be substituted. If the power cable is damaged, the device has to be disposed of.
- The device must not be exposed to splashing water, rain or humid environments.
- Objects with liquids, e.g. vases, should not be placed on the device.



ADDITIONAL BATTERY SAFETY WARNINGS

⚠ WARNING! To reduce the risk of fire, personal injury, and product damage due to a short circuit, never immerse your tool, battery pack or charger in fluid or allow a fluid to flow inside them. Corrosive or conductive fluids, such as seawater, certain industrial chemicals, and bleach or bleach containing products, etc., can cause a short circuit.

⚠ CAUTION! Risk of explosion if the battery is replaced by an incorrect type.

Ambient temperature range for battery during use is between 0°C and 40°C.

Ambient temperature range for battery storage is between 0°C and 20°C.

Replacement of a battery with an incorrect type can defeat a safeguard.

Disposal of a battery into fire or a hot oven, or mechanically crushing or cutting of a battery, can result in an explosion.

Leaving a battery in an extremely high temperature surrounding environment can result in an explosion or the leakage of flammable liquid or gas.

Do not use the product at high altitude due to low air pressure. A battery subjected to extremely low air pressure may result in an explosion or the leakage of flammable liquid or gas.

SPECIFIED CONDITIONS OF USE

The radio is suitable for reception of broadcasting and to playback audio sound of an externally connected CD player, MP3 player or cassette tape deck.

Do not use this product in any other way as stated for normal use.

CAUTION

Danger of explosion if battery is incorrectly replaced. Replace only with the same or equivalent type.

OPERATION

⚠ WARNING

The product is not waterproof. Do not submerge in liquid. Failure to heed this warning could result in serious personal injury.

⚠ WARNING

Always refer to the manual for any device recommended for use as an attachment or accessory. Proper use of any device, when attached to the product, is the sole responsibility of the operator. Improper use may damage the device or the product.

INSTALLING/REMOVING AAA BATTERIES

See page 3.

It is advisable to write down saved channels before replacing the AAA batteries.

There is a 15-second time frame for replacing the AAA batteries. If the batteries are not replaced within 15 seconds, the product will lose all settings previously stored in memory, and they will require reprogramming.

Always use new alkaline batteries for replacement.

1. Turn off the radio.
2. Lift the handle to make clearance for opening the battery pack cover.
3. Disengage the latch and open the battery pack cover.
4. Remove the battery pack, if installed.
5. Loosen the screw in the AAA battery cover. Remove the cover and set aside.

NOTE: AAA batteries are factory-installed for first-time use. Remove the pull tab at the battery cover to enable electrical connection. No installation is required.

6. Install two new AAA batteries according to polarity indicators inside the battery compartment.

NOTE: Do not mix old and new batteries. Do not mix alkaline, standard (carbon-zinc), or rechargeable (nickel-cadmium) batteries.

7. Replace the AAA battery cover and tighten screw to secure.

INSTALLING/REMOVING BATTERY PACK

See page 4.

The product can be operated by either an AEG 18V battery pack or AC adapter.

1. Turn off the radio.
2. Lift the handle to make clearance for opening the battery pack cover.
3. Disengage the latch and open the battery pack cover.
4. Remove the battery pack, if installed.
5. Place the battery pack in the product, aligning the ribs on the battery pack with the grooves in the battery port.
6. Make sure the latches on the battery pack snap into place and the battery pack is secured to the product before beginning operation.
7. Close the battery pack cover and secure with the latch.

Depress the latches on both sides of the battery pack and pull to remove.

NOTE: Always remove the battery pack from radio when not in use. Leaving the battery pack connected for long periods of time may drain the battery pack.

CONNECTING TO AC ADAPTER

See page 6.

1. Open the DC input jack cover.
2. Insert the plug of AC adapter into the input jack.
3. Plug the AC adapter into a wall socket.

⚠ WARNING

Use an authorised AC adapter. An unauthorised adapter may damage the unit.

LCD DISPLAY

See page 8.

When a battery pack is installed and the product is in the ON position, the LCD display will show the channel or time. When the battery pack is removed while AAA batteries are installed, the LCD display will show the time.



The backlight of the LCD display will dim after 15 seconds of no user operation.

NOTE: The illustrations of the LCD display shown in the manual are only examples of the frequencies you may see on your radio and are not the exact frequencies that you may choose to listen to.

MENU NAVIGATION BUTTONS

See page 8.



Use the menu navigation buttons to turn the product on and off, control the volume, change frequencies, toggle between modes and set the time.

Buttons and LCD display backlight will turn off after 15 seconds of no operation.

SWITCHING THE PRODUCT ON AND OFF

Press the on/off button to switch the product on and off.

NOTE: You may need to keep the button pressed for up to 3 seconds before the product will turn on or off.

NOTE: When the product is on and a battery pack is installed,  will be shown in the LCD display. If the battery charge is low,  will be shown.

To help preserve battery power, the product will automatically enter sleep mode approximately 1 hour after it is turned off. To exit sleep mode and restart the product, you must press the on/off button.

MODE SELECTION

■ Press **MODE** to cycle through available modes.

There are four (BRFM18)/five (BRFMB18) modes to choose from:

- FM mode
- AM mode
- AUX mode 1
- AUX mode 2
- BLUETOOTH mode (BRFMB18 only)

ADJUSTING THE VOLUME

When the product is switched on, the product will return to the last volume setting.

- To increase the volume, turn the volume/tuning control clockwise. Maximum volume value is 25.
- To decrease the volume, turn the volume/tuning control counterclockwise.
- To mute the sound, press **MUTE** (BRFM18 only)

CAUTION

Do not use the product at maximum volume for an extended period of time with the bass and treble at maximum levels. It could cause damage to the speakers and/or amplifiers in the product.

FM TUNING

Use **<** and **>**, or the volume/tuning control to tune to the desired radio frequency. The selected frequency is displayed on the LCD display.

To tune frequency automatically:

1. Briefly press **<**. The radio will seek station to lower frequencies automatically.
2. Briefly press **>**. The radio will seek station to higher frequencies automatically.

To tune frequency manually:

1. Briefly press the on/off button to enter frequency tuning. FM indicator will flash.
2. Turn the volume/frequency control knob clockwise to increase the frequency.
3. Turn the volume/frequency control knob counterclockwise to decrease the frequency.
4. Briefly press the on/off button to exit frequency tuning. FM indicator will stop flashing.

The radio will exit manual tuning after 5 seconds of no operation.

To decrease interference or electrical noise, adjust the position of the antenna or move the product to a higher elevation.

NOTE: Signal reception may drop due to electronic discharge. Tune the radio or restart to improve signal reception.

AM TUNING

Use **<** and **>**, or the volume/frequency control knob to tune to the desired radio frequency. The selected frequency is displayed on the LCD display.

To tune frequency automatically:

1. Briefly press **<**. The radio will seek station to lower frequencies automatically.
2. Briefly press **>**. The radio will seek station to higher frequencies automatically.

To tune frequency manually:

1. Briefly press the on/off button to enter frequency tuning. AM indicator will flash.
2. Turn the volume/frequency control knob clockwise to increase the frequency.
3. Turn the volume/frequency control knob counterclockwise to decrease the frequency.
4. Briefly press the on/off button to exit frequency tuning. AM indicator will stop flashing.

The radio will exit manual tuning after 5 seconds of no operation.

To decrease interference or electrical noise, adjust the position of the antenna or move the product to a higher elevation.

NOTE: Signal reception may drop due to electronic discharge. Tune the radio or restart to improve signal reception.

STORING A PRESET IN MEMORY

The memory feature saves up to 10 frequencies as presets in the product's memory. You can save up to 5 frequencies each for FM and AM modes.

To store a frequency in memory:

1. Tune to the desired FM or AM frequency.
 2. Press and hold **PRESETS** until the preset position number flashes on the screen.
 3. Press **<** or **>** to choose a preset position number.
- NOTE:** There are 5 preset positions for FM and 5 for AM. Only one station can be saved in each preset position.
4. Press **PRESETS** again to store the frequency.

To tune to presets (FM or AM):

- Press and release **PRESETS** to cycle through each preset position number and its associated frequency.





EQUALISER FUNCTION

To adjust the bass and/or treble settings:

1. Press **SOUND** to enter Equaliser setting.
2. Press **<** or **>** to adjust the Bass level. (Adjustment range: 0 - 5)
3. Press **SOUND** to enter the Treble setting.
4. Press **<** or **>** to adjust the Treble level. (Adjustment range: 0 - 5)
5. Press **SOUND** to exit Equaliser setting.

SETTING THE CLOCK

To set the clock:

1. Press and hold **CLOCK DISPLAY** to enter clock setting.
2. The hour time blinks. Press **<** or **>**, or rotate volume/tuning control to adjust the hour.
3. Briefly press **CLOCK DISPLAY** or on/off button. The minute time blinks. Press **<** or **>**, or rotate volume/tuning control to adjust the minute.
4. Briefly press **CLOCK DISPLAY** or on/off button again to confirm the time. The clock is now set.

NOTE: If AAA batteries are removed or lose charge for more than 15 seconds, clock settings will be lost. Settings are not affected by the removal of the 18V battery.

AUXILIARY MODE

The product can be used as an amplifier for MP3 players, CD players, smartphones, tablets, and other music devices. There are two auxiliary modes, AUX 1 and AUX 2.

To use AUX 1:

See page 6.

1. Press **MODE** until **AUX1** is displayed.
2. Connect auxiliary cable to the device.
3. Open the AUX 1 input jack cover. Connect the other end of the auxiliary cable to the AUX 1 input jack.

NOTE:

- The external device must be on and in play mode for sound to be heard through the speakers.
 - All external device controls can be used normally while connected to radio.
 - Volume for any device connected through the auxiliary cable can be adjusted using the volume control for that device or by using volume/frequency control knob of the product.
 - Switching the product off will not switch the external device off.
 - The auxiliary cable does not provide charging function.
4. For complete operating instructions for the connected device, always refer to the manual that was included with your device.

To use AUX 2:

See page 7.

1. Press **MODE** until **AUX2** is displayed.
2. Connect auxiliary cable to the device.
3. Open the battery pack cover. Connect the other end of the auxiliary cable to the AUX 2 input jack.

NOTE:

- The external device must be on and in play mode for sound to be heard through the speakers.
- All external device controls can be used normally while connected to radio.

- Volume for any device connected through the auxiliary cable can be adjusted using the volume control for that device or by using volume/frequency control knob of the product.
 - Switching the product off will not switch the external device off.
 - The auxiliary cable does not provide charging function.
4. For complete operating instructions for the connected device, always refer to the manual that was included with your device.

The device storage may be used to store your external device.

NOTE: In AUX1 and AUX2 modes, if there is no audio input for 10 minutes, the radio will turn off automatically to save power.

USING A BLUETOOTH® ENABLED DEVICE WITH THE PRODUCT (BRFMB18 ONLY)

1. Press **MODE** until **⌘** is displayed. Alternatively, press **⌘** to enter Bluetooth® mode directly.

NOTE:

- When the product is switched to Bluetooth® mode, the product will attempt to pair to a Bluetooth® enabled device. The volume/tuning control ring light and **⌘** in the LCD display will flash.
 - The product will automatically attempt to connect to the last device it was paired to. If a connection cannot be established within five seconds, the product will make itself available to other Bluetooth® enabled devices.
 - Bluetooth® enabled devices must be within 10 m (30 ft) of the product and set to search/scan in order to pair with the product.
 - If the radio is not paired with any device, or is paired without playing songs for 10 minutes, the radio will turn off automatically.
2. Select "AEG JOBSITE BT5 RADIO" from your device's list of available Bluetooth® signals to pair the device and the product. No password or PIN is required for connection.

NOTE:

- When the device has successfully paired with the radio, the volume/tuning control ring light and **⌘** in the LCD display will stop flashing. A beep sound will play.
 - When a device is paired to the product, information for connecting to the device is saved in the radio's memory.
 - If the radio does not pair with your device, turn off the radio. Wait 5 seconds, then turn the power on and start the pairing process again.
3. Press **<** and **>** to go to the previous or next track when streaming audio from a Bluetooth® enabled device.
 4. Press and release **PRESETS** to cycle between pausing and playing the audio.

NOTE:

- These controls may not be supported by the Bluetooth® device and application.
 - All Bluetooth® enabled device controls can be used normally while paired to the product.
 - Volume for any device paired to the product can be adjusted using the volume control for that device or by using volume/frequency control knob of the product.
5. Press and hold **⌘** for about 2 seconds to disconnect all Bluetooth® enabled device.

NOTE: When the device is disconnected, the volume/tuning control ring light and **⌘** in the LCD display will begin flashing and the product will begin searching for another device.





USING THE USB DEDICATED CHARGING PORT (BRFMB18 ONLY)

The USB dedicated charging port provides charging power of up to 1 Amp for your cell phone, MP3 player, tablet, or other USB devices.

CAUTION

Attempting to charge devices rated more than 1 Amp could damage the USB dedicated charging port and/or the device.

1. Connect one end of a USB cable (not provided) to your USB device.
2. Open the USB charging port cover.
3. Connect the other end of the USB cable (not provided) to the USB dedicated charging port to begin charging the device.

NOTE: The USB dedicated charging port provides power only; it does not provide any data communication capabilities.

When the product is operating on battery power, the USB dedicated charging port will continue to function for approximately 1 hour after switching the product off. If the product remains inactive after this time, charging will stop. Turn the product on to resume operation.

FOLD-DOWN FLEXIBLE ANTENNA

To decrease interference or electrical noise, extend the antenna or move the product to a higher elevation. The antenna folds down and out of the way when not in use.

BOTTLE OPENER

Use the bottle opener located at the back of the product to remove bottle caps. You may need to move the handle to the upright position and rock the radio slightly forward.

BATTERIES

Battery packs which have not been used for some time should be recharged before use.

Temperatures in excess of 50°C (122°F) reduce the performance of the battery pack. Avoid extended exposure to heat or sunshine (risk of overheating).

The contacts of chargers and battery packs must be kept clean.

For an optimum life-time, the battery packs have to be fully charged, after used.

To obtain the longest possible battery life remove the battery pack from the charger once it is fully charged.

For battery pack storage longer than 30 days:

Store the battery pack where the temperature is below 27°C and away from moisture.

Store the battery packs in a 30% - 50% charged condition.

Every six months of storage, charge the pack as normal.

TRANSPORTING LITHIUM BATTERIES

Lithium-ion batteries are subject to the Dangerous Goods Legislation requirements.

Transportation of those batteries has to be done in accordance with local, national and international provisions and regulations.

- The user can transport the batteries by road without further requirements.
- Commercial transport of Lithium-Ion batteries by third parties is subject to Dangerous Goods regulations. Transport preparation

and transport are exclusively to be carried out by appropriately trained persons and the process has to be accompanied by corresponding experts.

When transporting batteries:

- Ensure that battery contact terminals are protected and insulated to prevent short circuit.
- Ensure that battery pack is secured against movement within packaging.
- Do not transport batteries that are cracked or leaking.

Check with forwarding company for further advice.

RESIDUAL RISKS

Even when the product is used as prescribed, it is still impossible to completely eliminate certain residual risk factors. The following hazards may arise and the operator should pay special attention to avoid the following:

- Use the product only for its intended use. Do not alter or modify the product from the original design or function.
- Always be aware that misuse and improper handling of the product can cause injury to yourself and others.

BATTERY PACK PROTECTION

The battery pack has overload protection that protects it from being overloaded and helps to ensure long life. Under extreme stress the battery electronics switch off the machine automatically. To restart, switch the machine off and then on again. If the machine does not start up again, the battery pack may have discharged completely. In this case it must be recharged in the battery charger.

MAINTENANCE

The ventilation slots of the machine must be kept clear at all times.

Use only AEG accessories and AEG spare parts. Should components need to be replaced which have not been described, please contact one of our AEG service agents (see our list of guarantee/service addresses).

If needed, an exploded view of the tool can be ordered. Please state the Article No. as well as the machine type printed on the label and order the drawing at your local service agents or directly at:

Techtronic Industries Australia Pty Ltd

PO Box 1065
Mount Waverley VIC 3149
Tel. no. 1300 234 797
Australia

Techtronic Industries N.Z. Limited

PO Box 12-806
Penrose AUCKLAND 1642
Tel. no. 0800 234 797
New Zealand

SYMBOLS



Safety alert



Regulatory Compliance Mark (RCM). Product meets applicable regulatory requirements.





Please read the instructions carefully before starting the machine.



For indoor use only.



Class II equipment



Do not touch the metal part of the antenna in order to avoid a drop in signal reception caused by electrostatic discharge.



Bluetooth®



Do not dispose of electric tools together with household waste material. Electric tools and electronic equipment that have reached the end of their life must be collected separately and returned to an environmentally compatible recycling facility.



BLUETOOTH® LICENSE STATEMENT

The Bluetooth® word mark and logos are registered trademarks owned by Bluetooth SIG, Inc., and any use of such marks by Techtronic Industries Australia Pty Ltd and Techtronic Industries N.Z. Limited are under license. Other trademarks and trade names are those of their respective owners.



AEG

www.aegpowertools.com.au
www.aegpowertools.co.nz

Techtronic Industries Australia Pty Ltd

31 Gilby Road, Mount Waverley, VIC 3149
Australia

Techtronic Industries N.Z. Limited

2 Landing Drive, Mangere
Auckland, 2022, New Zealand

20181116v2

*AEG is a registered trademark used under
license from AB Electrolux (publ).*