

AEG

ASJ-01

Original instructions

Important!

It is essential that you read the instructions in this manual before assembling, operating and maintaining the product.

Subject to technical modifications.

- 1 - Fixed clamp
- 2 - Sliding clamp
- 3 - Thumbscrew
- 4 - Leg lock lever
- 5 - Rear leg
- 6 - Foot lock lever
- 7 - Adjustable foot
- 8 - Feet
- 9 - Front legs
- 10 - Foot pedal
- 11 - Foot pedal release
- 12 - Front leg locks
- 13 - Lock/unlock latch
- 14 - Hand grip

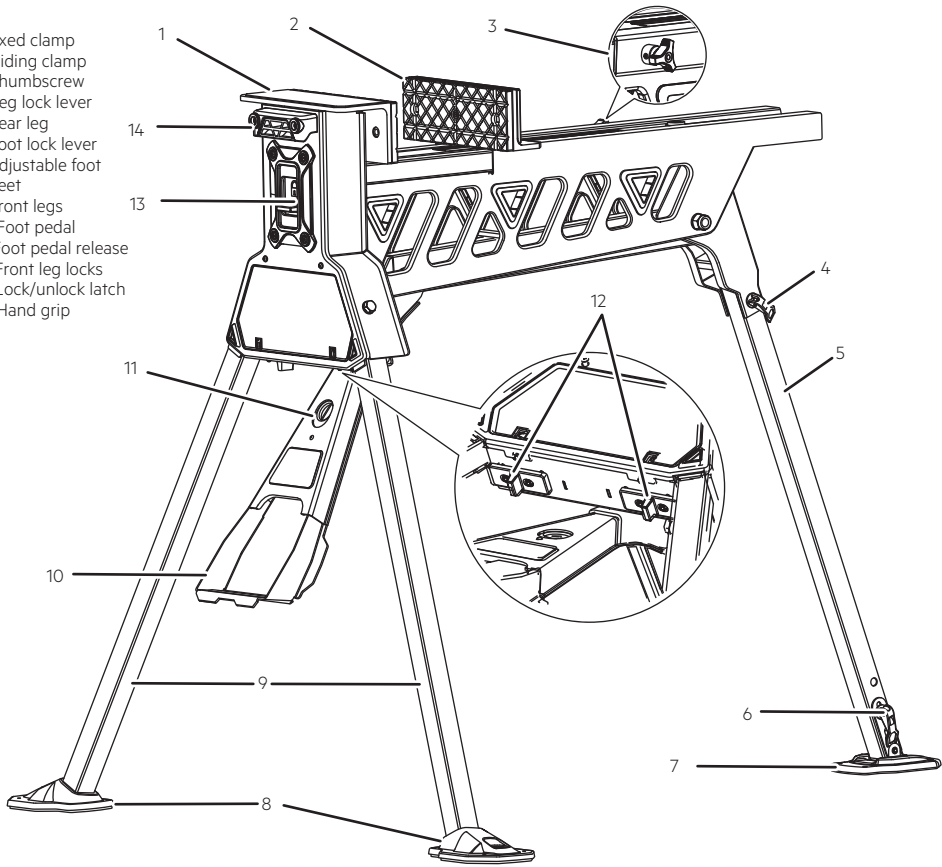
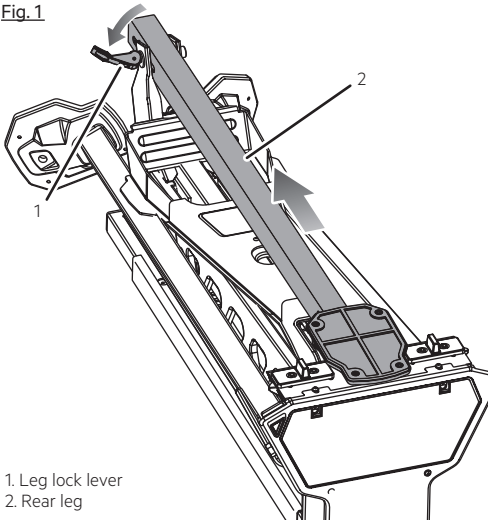
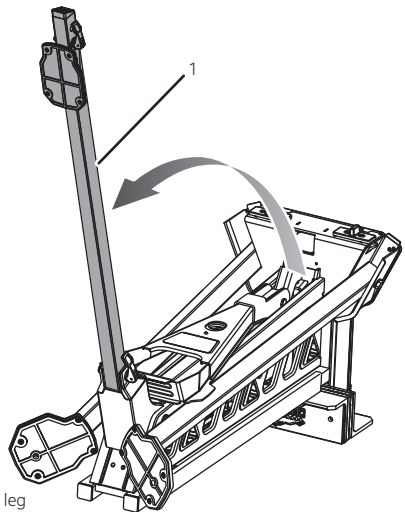

Fig. 1



- 1. Leg lock lever
- 2. Rear leg

Fig. 2



- 1 - Rear leg

Fig. 3

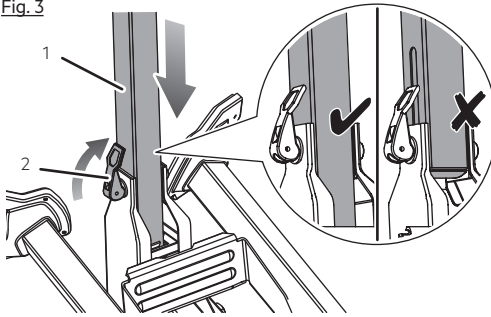

- 1 - Rear leg
- 2 - Leg lock lever

Fig. 4

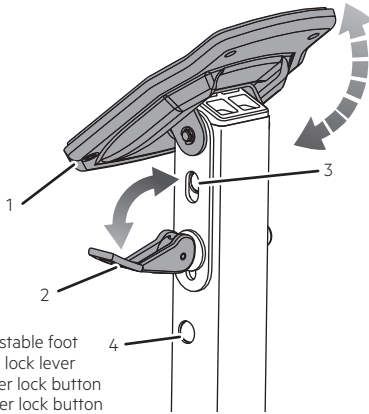

- 1 - Adjustable foot
- 2 - Foot lock lever
- 3 - Lower lock button
- 4 - Upper lock button

Fig. 5

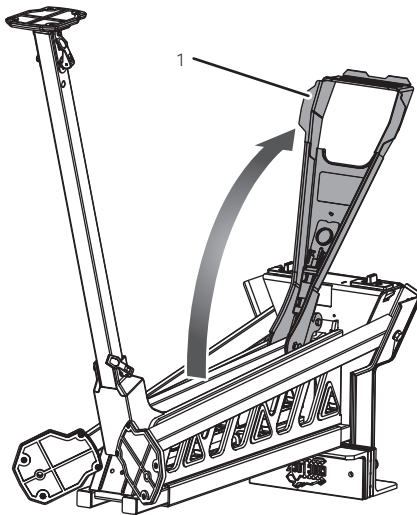

- 1 - Foot pedal

Fig. 6

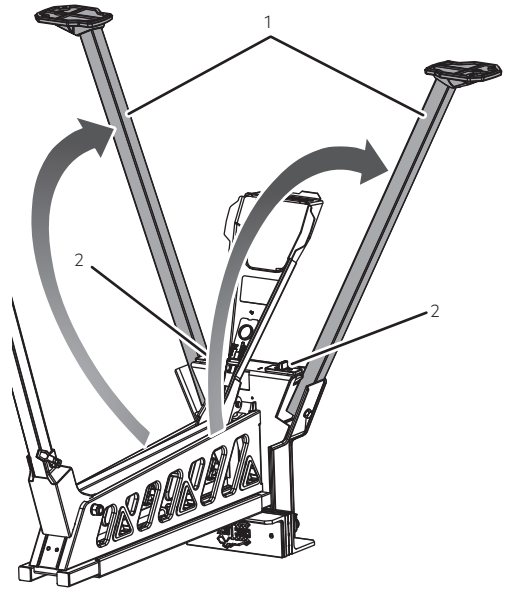

- 1 - Front legs
- 2 - Front leg locks

Fig. 7

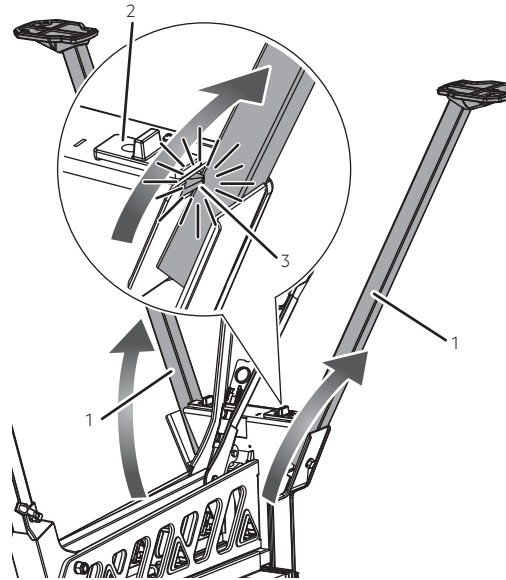

- 1 - Front legs
- 2 - Front leg lock
- 3 - Leg secured in place

Fig. 8

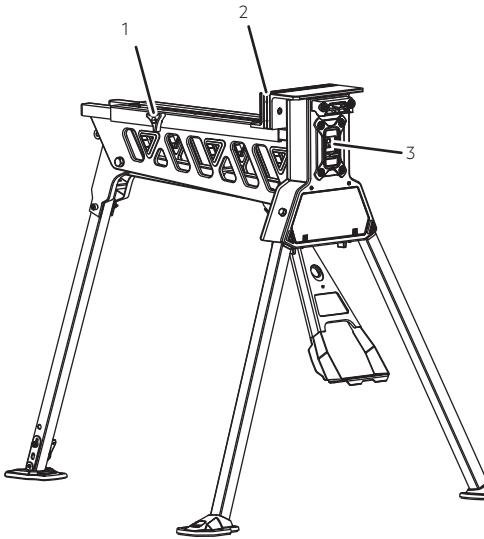

- 1 - Thumbscrew
- 2 - Sliding clamp
- 3 - Lock/unlock latch

Fig. 10

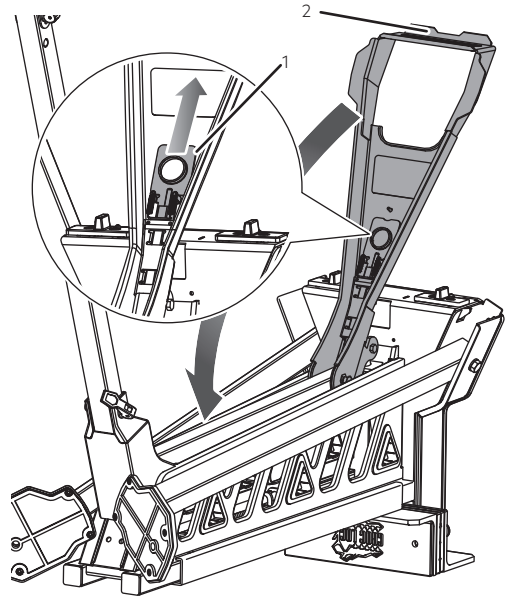

- 1 - Foot pedal release
- 2 - Foot pedal

Fig. 9

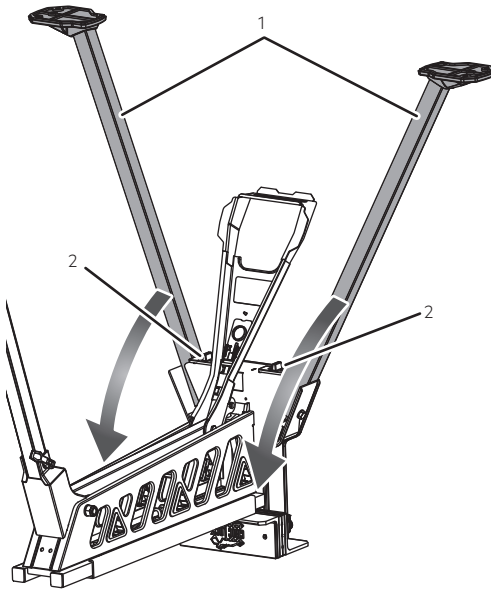

- 1 - Front legs
- 2 - Front leg locks

Fig. 11

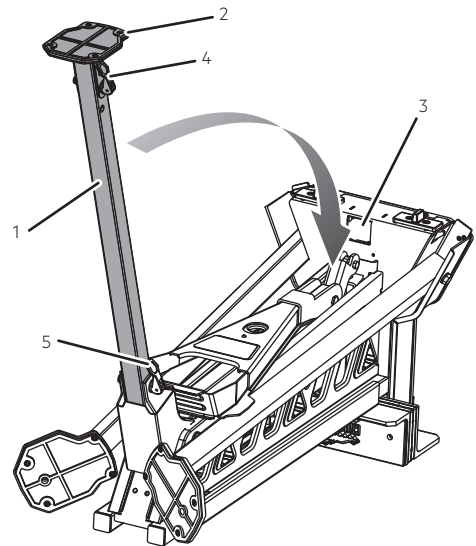

- 1 - Rear leg
- 2 - Adjustable foot
- 3 - Leg storage hole
- 4 - Foot lock lever
- 5 - Leg lock lever

Fig. 12

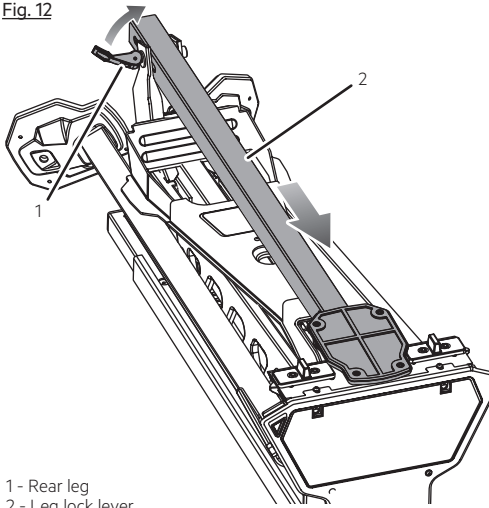

- 1 - Rear leg
- 2 - Leg lock lever

Fig. 13

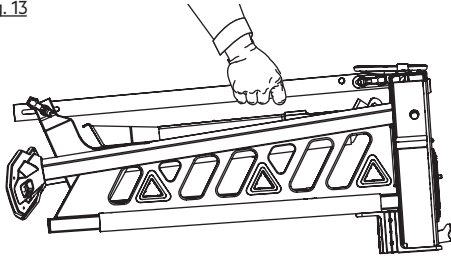
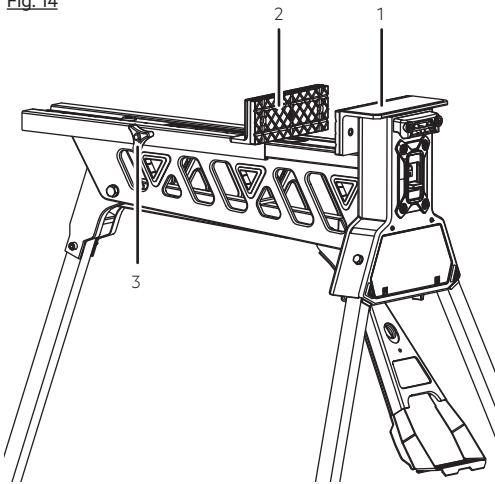
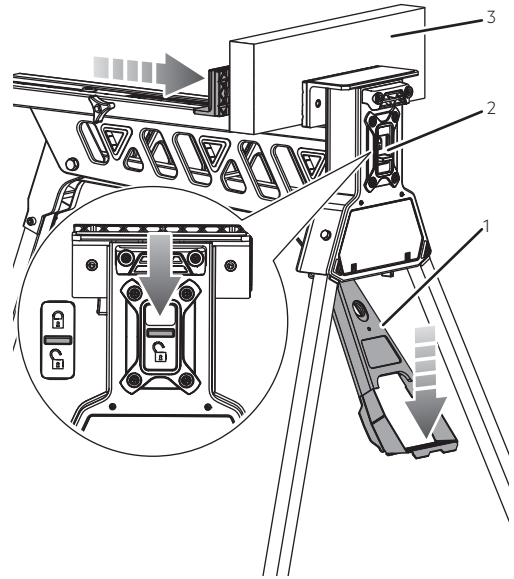

Fig. 14



- 1 - Fixed clamp
- 2 - Sliding clamp
- 3 - Thumbscrew

Fig. 15



- 1 - Foot pedal
- 2 - Lock/unlock latch
- 3 - Workpiece

Fig. 16

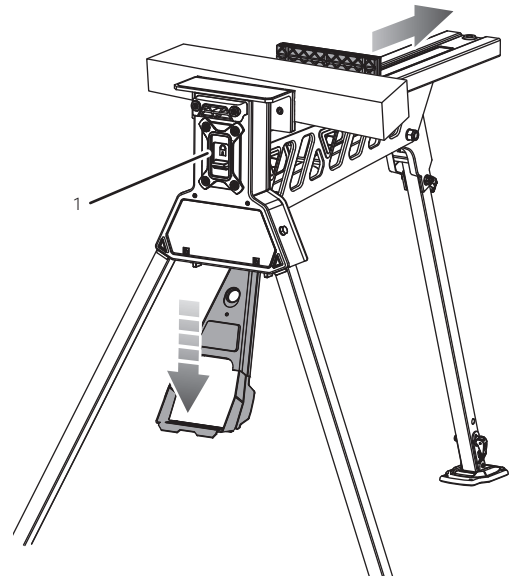

- 1 - Lock/unlock latch

Fig. 17

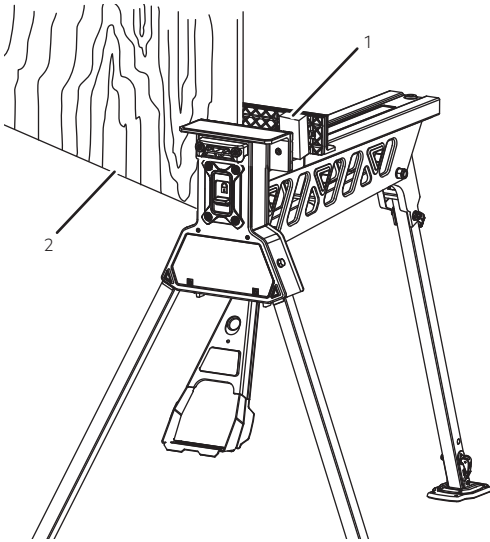

- 1 - Spacer
- 2 - Workpiece

Fig. 19

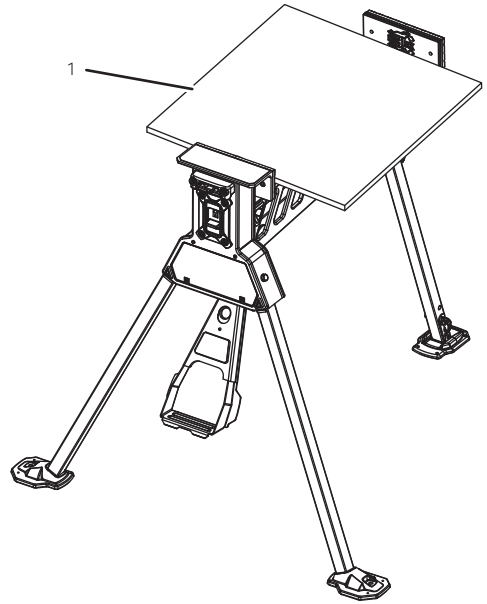

- 1 - Workpiece

Fig. 18

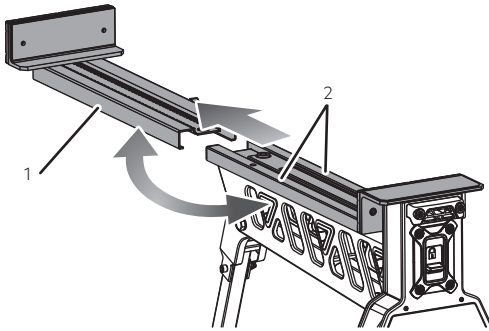

- 1 - Sliding clamp in "reverse position"
- 2 - Tracks

Fig. 20

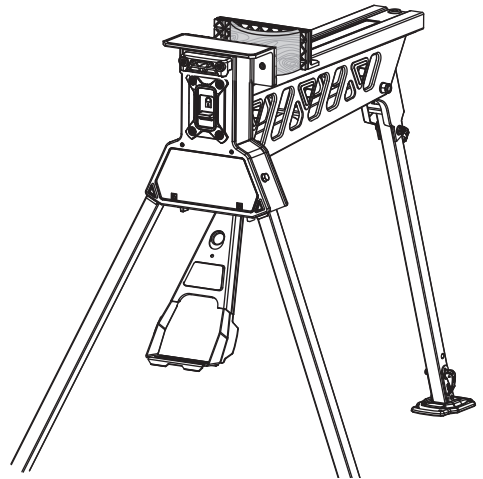
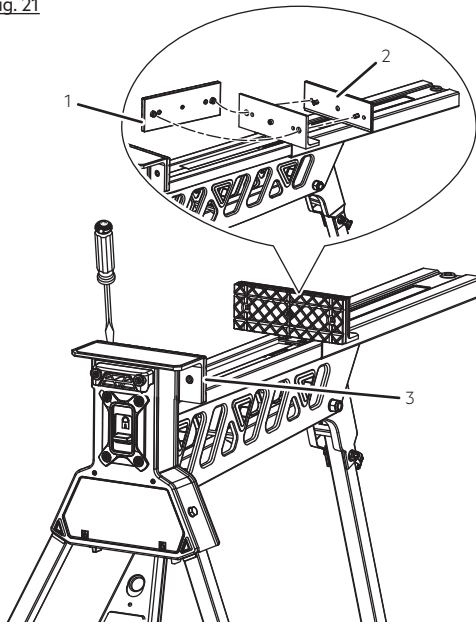
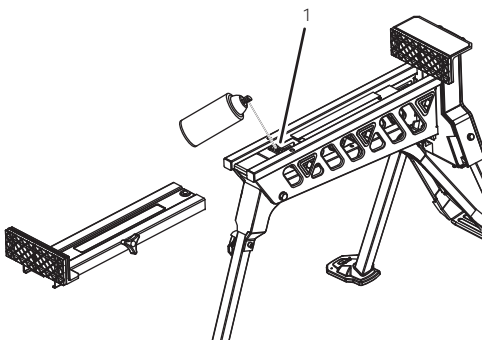

Fig. 21



- 1 - Front clamp pad
- 2 - Back clamp pad
- 3 - Fixed clamp pad

Fig. 22



- 1 - Clamp mechanism

Fig. 23

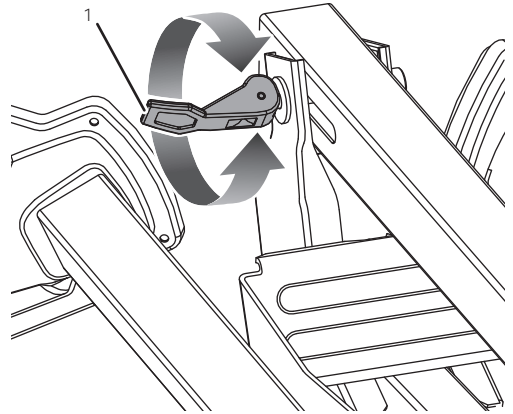

- 1 - Leg lock lever

Fig. 24

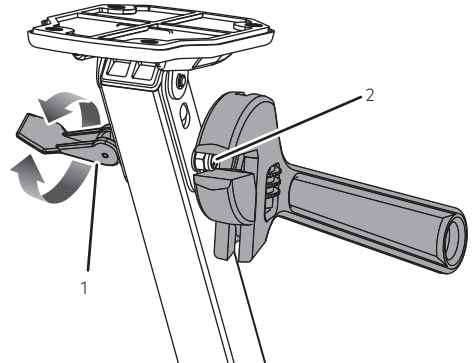

- 1 - Foot lock lever
- 2 - Nut

**TECHNICAL DATA****SUPERCLAMP****ASJ-01**

Clamping range	0 - 940 mm.
Clamping force	1 ton.
Maximum load	250 kg.
Weight	19 kg

⚠ WARNING! Read all safety warnings and all instructions. Failure to follow the warnings and instructions may result in electric shock, fire and/or serious injury. **Save all warnings and instructions for future reference.**

SUPERCLAMP SAFETY WARNINGS

Know your product. Read the operator's manual for the product and for any tool being used with this workstation.

Do not allow familiarity with tools to make you careless. Remember that a careless fraction of a second is sufficient to inflict severe injury.

Always wear eye protection with side shields marked to comply with AS/NZS 1337. Failure to do so could result in objects being thrown into your eyes, resulting in possible serious injury.

Do not use any attachments or accessories not recommended by the manufacturer of the product. The use of attachments or accessories not recommended can result in serious personal injury.

Keep fingers, hands, and all body parts away from moving clamps. Failure to do so could result in possible serious injury.

Stop immediately if the workpiece or product moves when operating. Failure to do so could result in possible serious injury.

Make sure all moving parts are free from interference.

Keep hands free of all moving parts to avoid pinching and other injuries.

Place the product on a firm, level surface where there is plenty of room to handle and properly support the workpiece.

Make sure workpieces are properly supported.

Never perform work on the product outside the width of the front legs. Doing so may cause the product to become unbalanced and tip.

Check that all screws and knobs are tight and legs are securely locked before operating the product.

Do not use as a stepladder, standing platform, or scaffolding support. Stop immediately if the workpiece or the product moves when operating.

Check to make sure the product does not rock, slide or move prior to use.

Save these instructions. Refer to them frequently and use them to instruct other users. If you loan someone the product, also loan these instructions.

RESIDUAL RISKS

Even when the product is used as prescribed, it is still impossible to completely eliminate certain residual risk factors. The following hazards may arise and the operator should pay special attention to avoid the following:

- Keep other persons away.
 - Do not let persons, especially children, not involved in the work touch the tool and keep them away from the work area.
- Ensure the product is set up on a firm, level ground in a stable manner.
- Check to make sure that all fixing screws and knobs are tight and all legs are locked in place before using the tool.
- Ensure the workpiece is clamped firmly and the lock release switch is in proper state before use. Unclamped workpieces can

cause severe injury and damage.

SPECIFIED CONDITIONS OF USE

The superclamp is intended to clamp wood, metal, plastics or any other physical object, to support with other hand tools. The product is also intended to be used on a level surface and in a dry environment. The product is intended to be maintained by a skilled/qualified operator following the operator's instruction manual, and is not intended to be used by anyone under 18 years old.

ASSEMBLY**⚠ WARNING**

Do not use this product if it is not completely assembled or if any parts appear to be missing or damaged. Use of a product that is not properly and completely assembled or with damaged or missing parts could result in serious personal injury.

⚠ WARNING

Do not attempt to modify this product or create accessories or attachments not recommended for use with this product. Any such alteration or modification is misuse and could result in a hazardous condition leading to possible serious personal injury.

UNPACKING

Packing list

- Superclamp x 1
- Operation manual x 1

OPERATION**SETTING UP THE PRODUCT**

See Figures 1 - 8.

- Place the product upside down on a flat level surface.
- Unlock the leg lock lever.
- Slide the rear leg towards the back of the product releasing it from the storage hole.
- Lift the leg slightly then slide the leg toward the front of the product.
- Raise the leg and slide it down into place before locking the leg lock lever.
- Unlock the rear foot lock lever.
- Depress the upper lock button to release the adjustable foot.
- Tilt the adjustable foot until it is perpendicular to the rear leg and push down to engage the lower lock button.
- Lock the foot lock lever.
- Lift the foot pedal and pull toward the front of the product until it clicks into place.
- Lift the right front leg and pull to the front of the product until leg locks in place. Repeat for left leg.

NOTE: When the legs are secure, the lock levers will prevent



them from folding. DO NOT use the product if the legs cannot be secured.

- Turn the product over placing it upright on the ground. Recheck that all levers are locked and all legs are secured firmly into place.

CAUTION

To reduce the risk of injury, never attempt to lift the product until each leg has been properly secured in place.

FOLDING AND/OR CARRYING THE PRODUCT

See Figures 8 - 13.

- Tighten the thumbscrew on the side of the sliding clamp to secure it in place.
- Pull the lock / unlock latch up to unlock.
- Step down on the foot pedal then let the pedal rise completely.
- Turn the product over and place it upside down on the ground.
- Slide the right front leg lock toward the centre of the product and hold in place.
- Lower the right front leg until it rests on the housing. Repeat this process to lower the left leg.
- Place a finger in the foot pedal release and pull up to unlock the foot pedal.
- Lower the foot pedal until it rests on the front legs.
- Unlock the rear foot lock lever.
- Depress the lower lock button to release the adjustable foot.
- Tilt the adjustable foot until it is parallel to the rear leg and push it toward the leg to engage the upper lock button.
- Lock the foot lock lever.
- Unlock the leg lock lever.
- Pull up on the rear leg and fold the leg toward the front of the product.
- Once the rear leg is resting on the housing, slide the rear leg backwards and lower it onto the foot pedal.
- With the rear leg resting on the foot pedal, slide the rear leg forward into the leg storage hole.
- Lock the leg lock lever.

NOTE: When transporting the product, the rear leg becomes the carrying handle.

CLAMPING THE WORKPIECE

See Figure 14 - 15.

Always support the workpiece before releasing the foot pedal to prevent the workpiece from falling off the product.

- Loosen the thumbscrew on the side of the sliding clamp.
- Place the lock / unlock latch in the unlock position then push the sliding clamp to open.
- **NOTE:** When clamping long or heavy materials, always provide proper support for the workpiece.
- Place the workpiece between the fixed clamp and sliding clamp with it balanced on the product.
- Move the sliding clamp until the clamp rests against the workpiece or step repeatedly on the foot pedal to move the sliding clamp against the workpiece. Each full stroke of the foot pedal moves the sliding clamp approximately 13 mm.
- Slide the lock / unlock latch down to lock the sliding clamp against the workpiece.
- Step on the foot pedal until the workpiece has been secured in place.

NOTE: Stand on the foot pedal when extra force is needed. DO NOT jump on the foot pedal as you could damage the product.

UNCLAMPING THE WORKPIECE

See Figure 16.

Always support the workpiece BEFORE unclamping it to prevent the workpiece from falling off the product.

- Pull the lock / unlock latch up to unlock.
- Step down on the foot pedal then let the pedal rise releasing the force on the workpiece.
- **NOTE:** If you have clamped the workpiece tightly, added pressure on the foot pedal may be needed to release the workpiece from the clamps.
- Push the sliding clamp toward the rear of the product then remove the workpiece.

USING ONE SIDE OF THE CLAMP

See Figure 17.

If a large or awkward workpiece can only be clamped on one side of the clamp, it will be necessary to use a spacer. Place a spacer the same thickness as the workpiece on the other side of the clamp from the workpiece to keep clamps from skewing.

CLAMPING WIDE WORKPIECES

See Figure 18 - 19.

The product can support wide workpieces. To clamp a wide workpiece between 450 mm to 940 mm, it will be necessary to remove the clamp pads as described in the Maintenance section and place the sliding clamp in the "reverse position".

- Loosen the thumbscrew on the side of the sliding clamp.
- Pull the lock / unlock latch up to unlock.
- Push the sliding clamp toward the rear of the product and off its tracks.
- Turn the clamp around (180 degrees).
- Slide the clamp back on the tracks.

NOTE: When clamping long or heavy materials, always provide proper support for the workpiece.

USING AS A PRESS

See Figure 20.

With the lock / unlock latch in the unlock position and the rubber clamp pads removed (see Maintenance section), the product can be used as a press by stepping repeatedly on the foot pedal.

OPERATING TIPS

- Use the grooves in the clamp pads to securely hold material such as tubing.
- The easiest way to hacksaw square tubing is from corner to corner rather than across the flats.
- Sharpening a chain saw blade is made easier using two wooden blocks on either side of the bar thus ensuring the chain can be rotated as each tooth is filed.

MAINTENANCE

WARNING

For greater safety and reliability, all repairs should be performed by an authorised AEG service centre.

Avoid using solvents when cleaning plastic parts. Most plastics are susceptible to damage from various types of commercial solvents and can be damaged by their use. Use clean cloths to remove dirt, dust, oil, grease, etc.

Do not modify the product in any way or use accessories not approved by the manufacturer. Your safety and that of others may be compromised.

Before and after each use, check the product for damage or broken parts. Keep the product in top working condition by immediately replacing parts with spares approved by the manufacturer.

When servicing, use only identical replacement parts. Use of any other parts may create a hazard or cause product damage.

Use only AEG accessories and AEG spare parts. Should components need to be replaced which have not been described, please contact one of our AEG service agents (see our list of guarantee/service addresses).

REPLACING THE CLAMP PADS

See Figure 21.

To replace clamp pads or to remove them for greater clamping range:

To replace the clamp pad on the fixed clamp:

- Pry off the fixed clamp pad using a flathead screwdriver.
- Place a new clamp pad over the holes in the fixed clamp and press the pad into place.

To replace the clamp pads on the sliding clamp:

- Remove the front and back clamp pads.
- Place a new front clamp pad into the holes on the sliding clamp.
NOTE: Front clamp pad must be installed before the back clamp pad.
- Align the new back clamp pad holes over the tabs from the front clamp pad and press the pads together.

LUBRICATING THE CLAMP MECHANISM

See Figure 22.

If the sliding clamp does not move smoothly, remove it and spray the clamp mechanism with a small amount of general purpose grease.

ADJUSTING THE LOCK LEVERS

See Figure 23 - 24.

In the "locked" position, the action of pushing the leg lock lever or foot lock lever down should feel tight and secure. If the levers are loose or too tight, an adjustment may be required.

To adjust the leg lock lever:

- Fold the product.
- Unlock the leg lock lever.
- Rotate the leg lock lever clockwise to tighten and counterclockwise to loosen.

To adjust the foot lock lever:

- Fold the product.
- Unlock the leg lock lever.
- Slide the rear leg to the back of the product releasing it from the storage position.
- Lift the leg slightly then slide the leg toward the front of the product.

- Raise the leg and slide it down into place before locking the leg lock lever.
- Unlock the foot lock lever.
- Use a wrench to hold the nut in place.
- Rotate the foot lock lever clockwise to tighten and counterclockwise to loosen.

If needed, an exploded view of the tool can be ordered. Please state the Article No. as well as the machine type printed on the label and order the drawing at your local service agents or directly at:

Techtronic Industries Australia Pty Ltd

PO Box 1065
Mount Waverley VIC 3149
Tel. no. 1300 234 797
Australia

Techtronic Industries N.Z. Limited

PO Box 12-806
Penrose AUCKLAND 1642
Tel no. 0800 234 797
New Zealand

SYMBOLS



Safety alert



Please read the instructions carefully before starting the product.



Do not reach into the gap. Beware of pinching.



Wear eye protection.



Do not exceed 250 kg.



Do not stand on top or use as ladder.



Do not sit on top.

AEG

www.aegpowertools.com.au

www.aegpowertools.co.nz

Techtronic Industries Australia Pty Ltd

31 Gilby Road, Mount Waverley, VIC 3149
Melbourne, Australia

Techtronic Industries N.Z. Limited

2 Landing Drive, Mangere
Auckland, 2022, New Zealand