

Robert Bosch Power Tools GmbH
70538 Stuttgart
GERMANY

www.bosch-garden.com

F 016 L81 340 (2015.05) AS / 228 EURO



AGS | ASB

7,2 LI | 10,8 LI

 **BOSCH**

de Originalbetriebsanleitung
en Original instructions
fr Notice originale
es Manual original
pt Manual original
it Istruzioni originali
nl Oorspronkelijke
gebruiksaanwijzing
da Original brugsanvisning
sv Bruksanvisning i original
no Original driftsinstruks
fi Alkuperäiset ohjeet
el Πρωτότυπο οδηγιών χρήσης

tr Orijinal işletme talimatı
pl Instrukcja oryginalna
cs Původní návod k používání
sk Pôvodný návod na použitie
hu Eredeti használati utasítás
ru Оригинальное руководство по
эксплуатации
uk Оригінальна інструкція з
експлуатації
kk Пайдалану нұсқаулығының
түпнұсқасы
ro Instrucțiuni originale
bg Оригинална инструкция

mk Оригинално упатство за работа
sr Originalno uputstvo za rad
sl Izvirna navodila
hr Originalne upute za rad
et Algupärane kasutusjuhend
lv Instrukcijas oriģinālvalodā
lt Originali instrukcija



10 | English

Transport

Die enthaltenen Li-Ionen-Akkus unterliegen den Anforderungen des Gefahrgutrechts. Die Akkus können durch den Benutzer ohne weitere Auflagen auf der Straße transportiert werden.

Beim Versand durch Dritte (z.B.: Lufttransport oder Spedition) sind besondere Anforderungen an Verpackung und Kennzeichnung zu beachten. Hier muss bei der Vorbereitung des Versandstückes ein Gefahrgut-Experte hinzugezogen werden.

Entsorgung

Gartengeräte, Zubehör und Verpackungen sollen einer umweltgerechten Wiederverwertung zugeführt werden.

Werfen Sie Gartengeräte, Ladegeräte und Akkus/Batterien nicht in den Hausmüll!

Nur für EU-Länder:



Gemäß der europäischen Richtlinie 2012/19/EU müssen nicht mehr gebrauchsfähige Elektro- und Elektronikgeräte und gemäß der europäischen Richtlinie 2006/66/EG müssen defekte oder ver-

brauchte Akkus/Batterien getrennt gesammelt und einer umweltgerechten Wiederverwendung zugeführt werden.

Nicht mehr gebrauchsfähige Akkus/Batterien können direkt abgegeben werden bei:

Deutschland

Recyclingzentrum Elektrowerkzeuge
Osteroder Landstraße 3
37589 Kalefeld

Schweiz

Batrec AG
3752 Wimmis BE

► **Integrierte Akkus dürfen nur zur Entsorgung entnommen werden.** Durch das Öffnen der Gehäuseschale kann das Gartengerät zerstört werden.

Um den Akku aus dem Elektrowerkzeug zu entnehmen, betätigen Sie den Ein-/Ausschalter solange, bis der Akku vollständig entladen ist. Drehen Sie die Schrauben am Gehäuse heraus und nehmen Sie die Gehäuseschale ab, um den Akku zu entnehmen. Um einen Kurzschluss zu verhindern, trennen Sie die Anschlüsse am Akku einzeln nacheinander und isolieren Sie diese anschließend die Pole. Auch bei vollständiger Entladung ist noch eine Restkapazität im Akku enthalten, die im Kurzschlussfall freigesetzt werden kann.

Akkus/Batterien:



Li-Ion:

Bitte beachten Sie die Hinweise im Abschnitt „Transport“.

Änderungen vorbehalten.

English

Safety Notes

Explanation of symbols



Read all safety warnings and all instructions.

Failure to follow the warnings and instructions may result in electric shock, fire and/or serious injury.



Wear eye protection and stout shoes at all times while operating the machine.



Pay attention that bystanders are not injured through foreign objects thrown from the machine.



Warning: Keep a safe distance from the machine when operating.



Do not use the machine in the rain or leave it outdoors when it is raining.



Warning! The cutting means continues to move after the motor is switched off.



Only use the battery charger indoors.

General Power Tool Safety Warnings



WARNING Read all safety warnings and all instructions.

Failure to follow the warnings and instructions may result in electric shock, fire and/or serious injury.

Save all warnings and instructions for future reference.

The term “power tool” in the warnings refers to your mains-operated (corded) power tool or battery-operated (cordless) power tool.

Work area safety

- **Keep work area clean and well lit.** Cluttered or dark areas invite accidents.
- **Do not operate power tools in explosive atmospheres, such as in the presence of flammable liquids, gases or dust.** Power tools create sparks which may ignite the dust or fumes.
- **Keep children and bystanders away while operating a power tool.** Distractions can cause you to lose control.

Electrical safety

- **Power tool plugs must match the outlet. Never modify the plug in any way. Do not use any adapter plugs with earthed (grounded) power tools.** Unmodified plugs and matching outlets will reduce risk of electric shock.

► **Avoid body contact with earthed or grounded surfaces, such as pipes, radiators, ranges and refrigerators.**

There is an increased risk of electric shock if your body is earthed or grounded.

► **Do not expose power tools to rain or wet conditions.**

Water entering a power tool will increase the risk of electric shock.

► **Do not abuse the cord. Never use the cord for carrying, pulling or unplugging the power tool. Keep cord away from heat, oil, sharp edges and moving parts.** Damaged or entangled cords increase the risk of electric shock.

► **When operating a power tool outdoors, use an extension cord suitable for outdoor use.** Use of a cord suitable for outdoor use reduces the risk of electric shock.

► **If operating a power tool in a damp location is unavoidable, use a residual current device (RCD) protected supply.** Use of an RCD reduces the risk of electric shock.

Personal safety

► **Stay alert, watch what you are doing and use common sense when operating a power tool. Do not use a power tool while you are tired or under the influence of drugs, alcohol or medication.** A moment of inattention while operating power tools may result in serious personal injury.

► **Use personal protective equipment. Always wear eye protection.** Protective equipment such as dust mask, non-skid safety shoes, hard hat, or hearing protection used for appropriate conditions will reduce personal injuries.

► **Prevent unintentional starting. Ensure the switch is in the off-position before connecting to power source and/or battery pack, picking up or carrying the tool.** Carrying power tools with your finger on the switch or energising power tools that have the switch on invites accidents.

► **Remove any adjusting key or wrench before turning the power tool on.** A wrench or a key left attached to a rotating part of the power tool may result in personal injury.

► **Do not overreach. Keep proper footing and balance at all times.** This enables better control of the power tool in unexpected situations.

► **Dress properly. Do not wear loose clothing or jewellery. Keep your hair, clothing and gloves away from moving parts.** Loose clothes, jewellery or long hair can be caught in moving parts.

► **If devices are provided for the connection of dust extraction and collection facilities, ensure these are connected and properly used.** Use of dust collection can reduce dust-related hazards.

Power tool use and care

► **Do not force the power tool. Use the correct power tool for your application.** The correct power tool will do the job better and safer at the rate for which it was designed.

► **Do not use the power tool if the switch does not turn it on and off.** Any power tool that cannot be controlled with the switch is dangerous and must be repaired.

► **Disconnect the plug from the power source and/or the battery pack from the power tool before making any adjustments, changing accessories, or storing power tools.** Such preventive safety measures reduce the risk of starting the power tool accidentally.

► **Store idle power tools out of the reach of children and do not allow persons unfamiliar with the power tool or these instructions to operate the power tool.** Power tools are dangerous in the hands of untrained users.

► **Maintain power tools. Check for misalignment or binding of moving parts, breakage of parts and any other condition that may affect the power tool's operation. If damaged, have the power tool repaired before use.** Many accidents are caused by poorly maintained power tools.

► **Keep cutting tools sharp and clean.** Properly maintained cutting tools with sharp cutting edges are less likely to bind and are easier to control.

► **Use the power tool, accessories and tool bits etc. in accordance with these instructions, taking into account the working conditions and the work to be performed.** Use of the power tool for operations different from those intended could result in a hazardous situation.

Battery tool use and care

► **Recharge only with the charger specified by the manufacturer.** A charger that is suitable for one type of battery pack may create a risk of fire when used with another battery pack.

► **Use power tools only with specifically designated battery packs.** Use of any other battery packs may create a risk of injury and fire.

► **When battery pack is not in use, keep it away from other metal objects, like paper clips, coins, keys, nails, screws or other small metal objects, that can make a connection from one terminal to another.** Shorting the battery terminals together may cause burns or a fire.

► **Under abusive conditions, liquid may be ejected from the battery; avoid contact. If contact accidentally occurs, flush with water. If liquid contacts eyes, additionally seek medical help.** Liquid ejected from the battery may cause irritation or burns.

Service

► **Have your power tool serviced by a qualified repair person using only identical replacement parts.** This will ensure that the safety of the power tool is maintained.

Hedge trimmer safety warnings

► **Keep all parts of the body away from the cutter blade. Do not remove cut material or hold material to be cut when blades are moving. Make sure the switch is off when clearing jammed material.** A moment of inattention while operating the hedge trimmer may result in serious personal injury.

12 | English

- ▶ **Carry the hedge trimmer by the handle with the cutter blade stopped. When transporting or storing the hedge trimmer always fit the cutting device cover.** Proper handling of the hedge trimmer will reduce possible personal injury from the cutter blades.
- ▶ **Hold power tool by insulated gripping surfaces only, because the cutter blade may contact hidden wiring.** Cutter blades contacting a "live" wire may make exposed metal parts of the power tool "live" and could give the operator an electric shock.

Shrub/Grass Shears safety warnings

- ▶ This machine is not intended for use by persons (including children) with reduced physical, sensory or mental capabilities, or lack of experience and knowledge, unless they have been given supervision or instruction concerning use of the machine by a person responsible for their safety. Children should be supervised to ensure that they do not play with the machine.
- ▶ Never allow children or people unfamiliar with these instructions to use the machine. Local regulations may restrict the age of the operator. When not in use store the machine out of reach of children.
- ▶ The operator or user is responsible for accidents or hazards occurring to other people or their property.
- ▶ Never operate the machine while people, especially children or pets, are nearby.
- ▶ Keep supply flexible cord away from cutting means.
- ▶ Wear eye protection and stout shoes at all times while operating the machine.
- ▶ Avoid trimming in bad weather conditions especially when there is a risk of lightning.
- ▶ Use the machine only in daylight or good artificial light.
- ▶ Check if guards and protective devices are undamaged and properly mounted. Before using, carry out any necessary maintenance and repairs.
- ▶ Switch on the motor only when the hands and feet are away from the cutting means.
- ▶ Always disconnect the machine from the power supply (i. e. remove the plug from the mains or remove the disabling device):
 - Whenever you leave the machine.
 - before clearing a blockage,
 - before checking, cleaning or working on the machine,
 - after striking a foreign object. Inspect the machine for damage and make repairs as necessary,
 - if the machine starts to vibrate abnormally (check immediately).
- ▶ Take care against injury to feet and hands from the cutting means.



Protect the power tool against heat, e. g., against continuous intense sunlight, fire, water, and moisture. Danger of explosion.

- ▶ **Do not open the machine.** There is danger of explosion when short-cutting the battery.
- ▶ **In case of damage and improper use of the battery, vapours may be emitted. Ventilate the area and seek medical help in case of complaints.** The vapours can irritate the respiratory system.

- ▶ **If the battery becomes defective, liquid can escape and come into contact with adjacent components. Check any parts concerned.** Clean such parts or replace them, if required.

Safety Warnings for Battery Chargers



Keep the battery charger away from rain or moisture.

Penetration of water in the battery charger increases the risk of an electric shock.

- ▶ **Do not charge other batteries.** The battery charger is suitable only for charging Bosch lithium-ion batteries within the listed voltage range. Otherwise there is danger of fire and explosion.
- ▶ **Keep the battery charger clean.** Contamination can lead to danger of an electric shock.
- ▶ **Before each use, check the battery charger, cable and plug. If damage is detected, do not use the battery charger. Never open the battery charger yourself. Have repairs performed only by a qualified technician and only using original spare parts.** Damaged battery chargers, cables and plugs increase the risk of an electric shock.
- ▶ **Do not operate the battery charger on easily inflammable surfaces (e. g., paper, textiles, etc.) or surroundings.** The heating of the battery charger during the charging process can pose a fire hazard.
- ▶ **Supervise children during use, cleaning and maintenance.** This will ensure that children do not play with the charger.

- ▶ **Children or persons that owing to their physical, sensory or mental limitations or to their lack of experience or knowledge, are not capable of securely operating the charger, may only use this charger under supervision or after having been instructed by a responsible person.** Otherwise, there is danger of operating errors and injuries.

Products sold in GB only: Your product is fitted with a BS 1363/A approved electric plug with internal fuse (ASTA approved to BS 1362).

If the plug is not suitable for your socket outlets, it should be cut off and an appropriate plug fitted in its place by an authorised customer service agent.



The replacement plug should have the same fuse rating as the original plug. The severed plug must be disposed of to avoid a possible shock hazard and should never be inserted into a mains socket elsewhere.







Products sold in AUS and NZ only:

Use a residual current device (RCD) with a rated residual current of 30 mA or less.

Symbols

The following symbols are important for reading and understanding the operating instructions. Please take note of the symbols and their meaning. The correct interpretation of the symbols will help you to use the machine in a better and safer manner.

Symbol	Meaning
	Wear protective gloves
	Wear eye protection.
	Reaction direction

14 English			
Symbol	Meaning	Symbol	Meaning
	Movement direction		Audible noise
	Switching On/Switching Off		Accessories
	Permitted action	Intended Use	
	Prohibited action	The garden product is intended for light trimming of shrubs and lawn edges.	

Technical Data

	Grass Shear (* with telescopic handle)		Shrub Shear	Shrub/Grass Shear Set	
	AGS 7,2 LI	AGS 10,8 LI	ASB 10,8 LI	ASB 10,8 LI Set ASB 10,8 LI 2-Set	
Article number	3 600 H56 0..	3 600 H56 1..	3 600 H56 3..	3 600 H56 3..	
Grass shear blade	●	●	-	●	
Blade width	mm 80	100	-	100	
Shrub shear blade	-	-	●	●	
Blade length	mm -	-	200	120***	
	mm -	-	-	200	
Anti Blocking	-	-	●	●	
Weight according to EPTA-Procedure 01:2014	kg 0.75 (1.4*)	0.78 (1.4*)	0.90	0.78 (100 mm) 0.90 (200 mm)	
Battery	Li-Ion	Li-Ion	Li-Ion	Li-Ion	
Rated voltage	V= 7.2	10.8	10.8	10.8	
Capacity	Ah 1.5	1.5	1.5	1.5	
Charging period (battery discharged)	h 3.25	3.25	3.25	3.25	
Number of battery cells	2	3	3	3	
Run time per battery charge (upto)	min 80 (70)**	100 (85)**	100	100	
Battery Charger					
Article number	EU 2 609 003 916 2 609 007 262 UK 2 609 003 932 AU 2 609 004 762	2 609 003 916 2 609 007 262 2 609 003 932 2 609 004 762	2 609 003 916 2 609 007 262 2 609 003 932 2 609 004 762	2 609 003 916 2 609 007 262 2 609 003 932 2 609 004 762	
Input voltage	V 100 – 240	100 – 240	100 – 240	100 – 240	
Charging current	mA 500	500	500	500	
Allowable charging temperature range	°C 0 – 45	0 – 45	0 – 45	0 – 45	
Weight according to EPTA-Procedure 01:2014	kg 0.088 (EU) kg 0.093 (UK) kg 0.085 (AU)	0.088 (EU) 0.093 (UK) 0.085 (AU)	0.088 (EU) 0.093 (UK) 0.085 (AU)	0.088 (EU) 0.093 (UK) 0.085 (AU)	

Please observe the article number on the type plate of your garden product. The trade names of the individual garden products may vary.

**approx. run time

***only with "ASB 10,8 LI Set"

Noise/Vibration Information

Grass Shear

Sound emission values determined according to EN 50636-2-94.

Typically the A-weighted sound pressure level of the product is less than 70 dB(A).

Vibration total values a_h (triax vector sum) and uncertainty K determined according to EN 50636-2-94:

$a_h = 2,5 \text{ m/s}^2$, $K = 1,5 \text{ m/s}^2$.

Vibration-emission-level₁

Shrub Shear

Sound emission values determined according to EN 60745-2-15.

Typically the A-weighted noise levels of the product are: Sound pressure level 66 dB(A); sound power level 76 dB (A). Uncertainty K = 1 dB.

Vibration total values a_h (triax vector sum) and uncertainty K determined according to EN 60745-2-15:

$a_h = 2.5 \text{ m/s}^2$, $K = 1.5 \text{ m/s}^2$.

Vibration-emission-level₁

1) The vibration level given in this information sheet has been measured in accordance with a standardised test given in EN 60745 and may be used to compare one tool with another. It may be used for a preliminary assessment of exposure.

The declared vibration emission level represents the main applications of the tool. However if the tool is used for different applications, with different accessories or insertion tools or is poorly maintained, the vibration emission may differ. This may significantly increase the exposure level over the total working period.

An estimation of the level of exposure to vibration should also take into account the times when the tool is switched off or when it is running but not actually doing the job. This may significantly reduce the exposure level over the total working period.

Identify additional safety measures to protect the operator from the effects of vibration such as: maintain the tool and the accessories, keep the hands warm, organisation of work patterns.

Declaration of Conformity

Grass Shear

We declare under our sole responsibility that the product described under "Technical data" is in conformity with all relevant provisions of the directives 2014/35/EU, 2011/65/EU, until 19 April 2016: 2004/108/EC, from 20 April 2016 on: 2014/30/EU, 2006/42/EC including their amendments and complies with the following standards: EN 60335-1, EN 50636-2-94 (battery powered product), EN 50581, EN 60335-1, EN 60335-2-29 (battery charger).

Shrub Shear

We declare under our sole responsibility that the product described under "Technical data" is in conformity with all relevant provisions of the directives 2014/35/EU, 2011/65/EU, until 19 April 2016: 2004/108/EC, from 20 April 2016 on: 2014/30/EU, 2006/42/EC, 2000/14/EC including their amendments and complies with the following standards: EN 60745-1, EN 60745-2-15 (battery powered product), EN 50581, EN 60335-1, EN 60335-2-29 (battery charger).

2000/14/EC: Guaranteed sound power level 77 dB(A). Conformity assessment procedure according to Annex V.

Equipment category: 25

Technical file (2006/42/EC, 2000/14/EC) at: Bosch Lawn and Garden Ltd., PT-HG/ENS-PA2, Stowmarket, Suffolk IP14 1EY, England

Henk Becker
Executive Vice President
Engineering

Helmut Heinzelmann
Head of Product Certification
PT/ECS

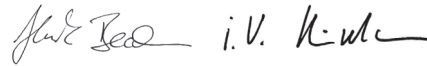

Robert Bosch Power Tools GmbH
70538 Stuttgart, GERMANY
Stuttgart, 01.01.2017

Mounting and Operation

Action	Figure	Page
Delivery Scope	1	224
Battery Charging	2	224
Detaching Tool	3	224
Attaching Tool	4	225
Switching On and Off	5	225
Fitting Telescopic handle	6	225
Adjusting handle length	7	226
Setting for Edge Cutting	8	226
Maintenance	9	226
Accessories	10	227

Cutting Hedges

Before cutting check the hedge for foreign objects e. g. wire fences.

Application

To maintain control hold the machine properly by the handle. Holding the machine incorrectly could result in injury.

After use replace the blade transport guard.

Telescopic handle

The telescopic handle can be used with the grass and shrub shear attachment. Before using the handle with the shrub shear attachment, the wheels should be detached.

16 | English

Anti Blocking

If the blade stalls on a tough material, the load of the motor increases. The intelligent micro-electronics senses this overload condition and repeatedly reverses the motor, in order to prevent stalling and to cut the material through. This audible reversing cut action continues for up to 3 s. After cutting through, the garden product continues in its normal mode, or in case the overload condition continues the blades automatically stop in the open position (e. g. in case a piece of metal fence accidentally blocks the garden product).

Battery Charge-control Indication

The battery charge-control indicator indicates the charging progress. During the charging process, the indicator **flashes green**. When the battery charge-control indicator **lights up green continuously**, the battery is fully charged.

The battery charge-control indicator indicates the charge condition of the battery for a few seconds when the On/Off switch is pressed through halfway of fully.

LED	Capacity
Continuous lighting, green	35 – 100%
Flashing light, green	15 – 35%
Flashing light, red	5 – 15%
Continuous lighting, red	0 – 5%

Troubleshooting



Problem	Possible Cause	Corrective Action
Cutting time per battery charge too low	Battery close to end of lifecycle	Contact Service Agent
Continuous lighting of the battery charge indicator	Battery pack defective	Contact Service Agent
No charging procedure possible		

Maintenance and Cleaning

- ▶ **Warning! Switch off before adjusting or cleaning. The blades continue to move for a few seconds after the garden product is switched off. Caution! Do not touch the moving blades.**
- ▶ **For safe and proper working, always keep the garden product clean.**
- ▶ **Always wear protective gloves when using, adjusting or cleaning the garden product.**

Regularly check for obvious defects such as loose fixings, and worn or damaged components.

After-sales Service and Application Service

www.bosch-garden.com

In all correspondence and spare parts order, please always include the 10-digit article number given on the type plate of the machine.

Great Britain

Robert Bosch Ltd. (B.S.C.)
P.O. Box 98
Broadwater Park
North Orbital Road
Denham
Uxbridge
UB 9 5HJ

At www.bosch-pt.co.uk you can order spare parts or arrange the collection of a product in need of servicing or repair.
Tel. Service: (0344) 7360109
E-Mail: boschservicecentre@bosch.com

Ireland

Origo Ltd.
Unit 23 Magna Drive
Magna Business Park
City West
Dublin 24
Tel. Service: (01) 4666700
Fax: (01) 4666888

Australia, New Zealand and Pacific Islands

Robert Bosch Australia Pty. Ltd.
 Power Tools
 Locked Bag 66
 Clayton South VIC 3169
 Customer Contact Center
 Inside Australia:
 Phone: (01300) 307044
 Fax: (01300) 307045
 Inside New Zealand:
 Phone: (0800) 543353
 Fax: (0800) 428570
 Outside AU and NZ:
 Phone: +61 3 95415555
 www.bosch.com.au

Republic of South Africa**Customer service**

Hotline: (011) 6519600

Gauteng – BSC Service Centre

35 Roper Street, New Centre
 Johannesburg
 Tel.: (011) 4939375
 Fax: (011) 4930126
 E-Mail: bsctools@icon.co.za

KZN – BSC Service Centre

Unit E, Almar Centre
 143 Crompton Street
 Pinetown
 Tel.: (031) 7012120
 Fax: (031) 7012446
 E-Mail: bsc.dur@za.bosch.com

Western Cape – BSC Service Centre

Democracy Way, Prosperity Park
 Milnerton
 Tel.: (021) 5512577
 Fax: (021) 5513223
 E-Mail: bsc@zsd.co.za

Bosch Headquarters

Midrand, Gauteng
 Tel.: (011) 6519600
 Fax: (011) 6519880
 E-Mail: rbsa-hq.pts@za.bosch.com

Transport

The contained lithium-ion batteries are subject to the Dangerous Goods Legislation requirements. The user can transport the batteries by road without further requirements.

When being transported by third parties (e.g.: air transport or forwarding agency), special requirements on packaging and labelling must be observed. For preparation of the item being shipped, consulting an expert for hazardous material is required.

Disposal

The garden product, accessories and packaging should be sorted for environmental-friendly recycling.

Do not dispose of garden products, battery chargers and batteries/rechargeable batteries into household waste!

Only for EC countries:

According to the European law 2012/19/EU, electrical and electronic equipments that are no longer usable, and according to the European law 2006/66/EC, defective or used battery packs/batteries, must be collected separately and disposed of in an environmentally correct manner.

Batteries no longer suitable for use can be directly returned at:

Great Britain

Robert Bosch Ltd. (B.S.C.)
 P.O. Box 98
 Broadwater Park
 North Orbital Road
 Denham
 Uxbridge
 UB 9 5HJ

At www.bosch-pt.co.uk you can order spare parts or arrange the collection of a product in need of servicing or repair.

Tel. Service: (0344) 7360109

E-Mail: boschservicecentre@bosch.com

► Integrated batteries may only be removed for disposal.

Opening the housing shell can damage or destroy the garden product.

To remove the battery from the power tool, press the On/Off switch until the battery is fully discharged. Unscrew the screws on the housing and remove the housing shell in order to remove the battery. To prevent a short circuit, disconnect the connectors on the battery one at a time and then isolate the poles. Even when fully discharged, the battery still contains a residual capacity, which can be released in case of a short circuit.

Battery packs/batteries:**Li-Ion:**

Please observe the instructions in section "Transport".

Subject to change without notice.

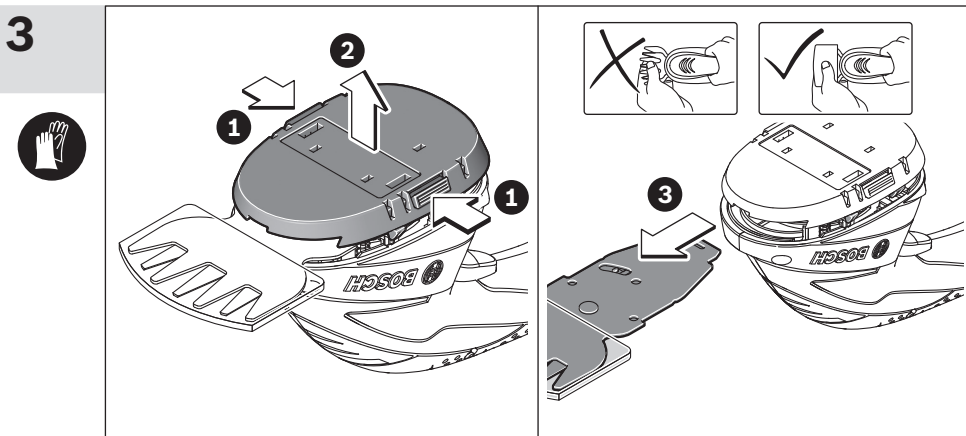
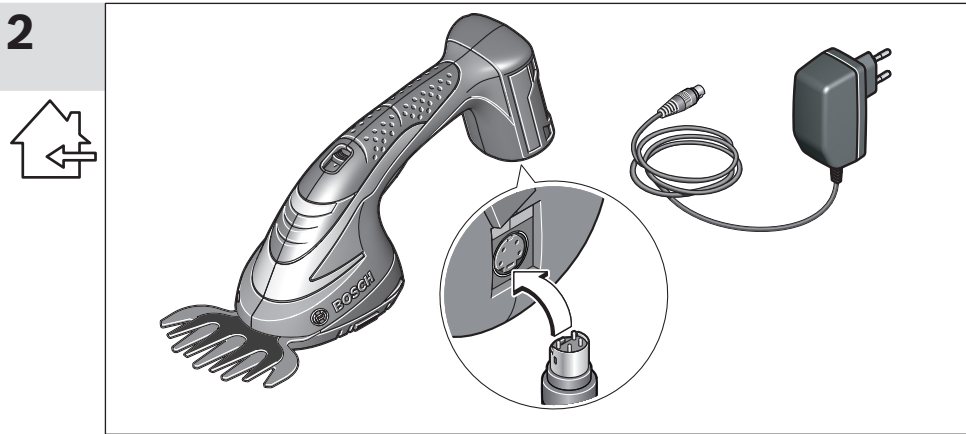
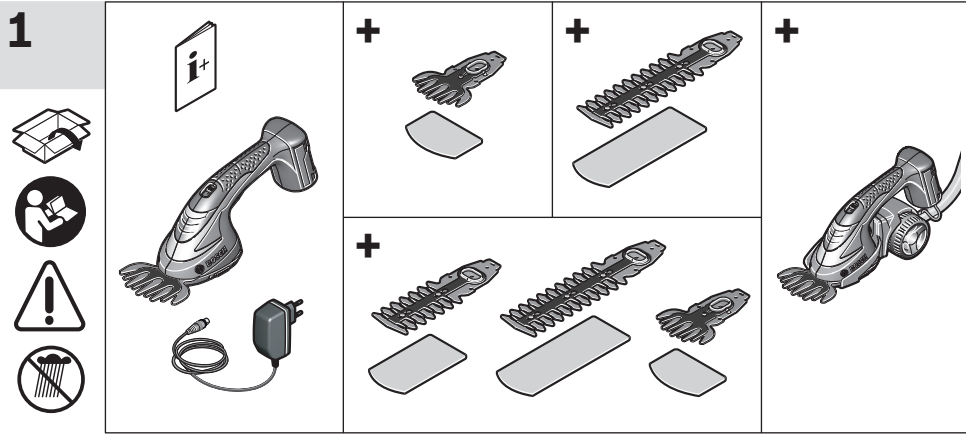

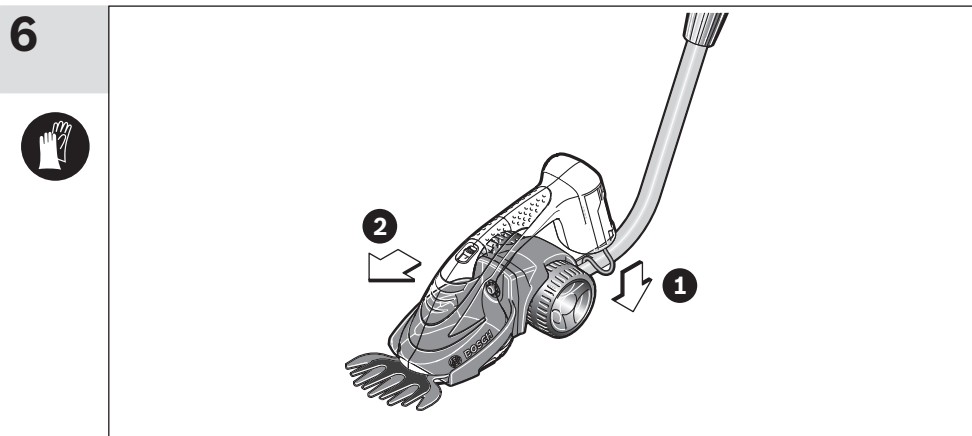
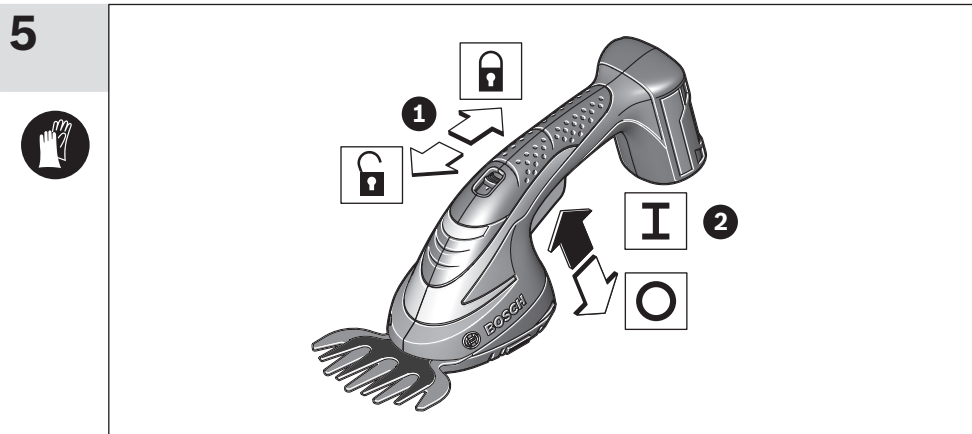
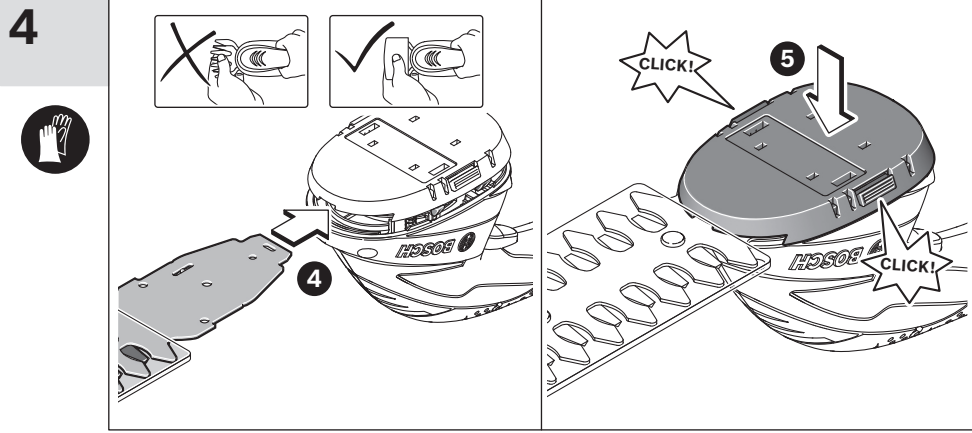

7

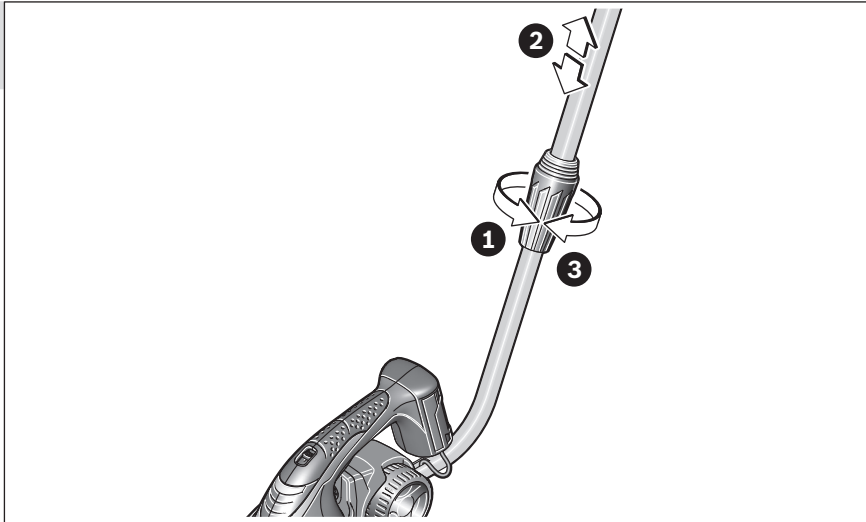

8

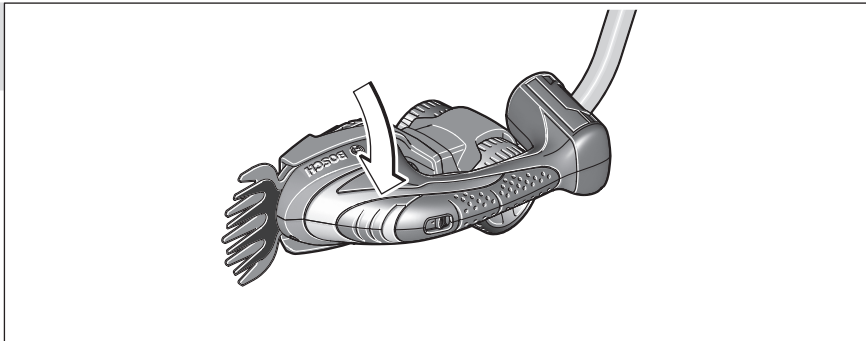

9

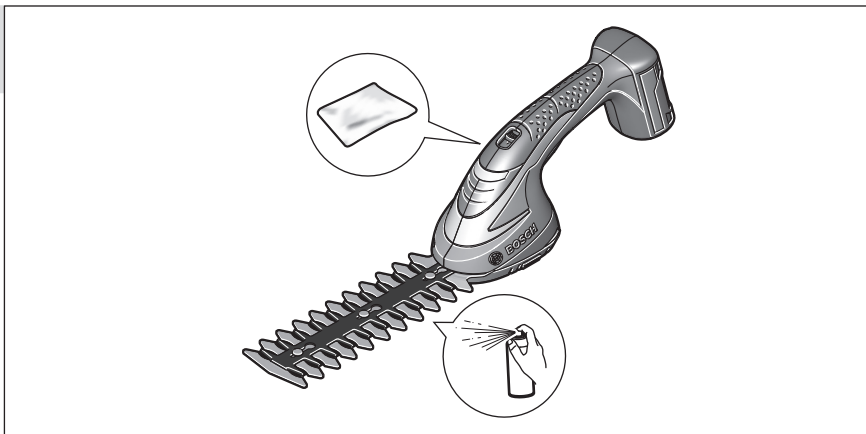

10



1 609 200 399



2 609 003 884
(AGS 7,2 LI)

2 609 003 867
(AGS 10,8 V LI, ASB 10,8 V LI)



2 609 003 885
(AGS 7,2 LI, AGS 10,8 V LI, ASB 10,8 V LI)

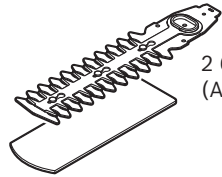

2 609 003 868
(ASB 10,8 V LI)

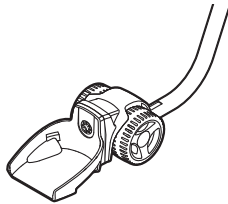

2 609 003 869
(AGS 7,2 LI, AGS 10,8 V LI)