



User Guide

IXL Eco Ventflo

Model: 10324 (200mm) - Extraction Rate: 340m³/h

Model: 10326 (250mm) - Extraction Rate: 490m³/h

Electrical Rating: 230~240 V. 50 Hz.



Welcome

Thank you for buying this IXL Eco Ventflo Fan. Even if you have used an exhaust fan before, there are some very good reasons to read this user guide before using this one:

- You and your family, property and home will be safe from harm.
- You will learn how this appliance may differ from others.
- By using the Ventflo Fan fully and properly, you will get maximum life and value from it.
- Our warranty depends on you using the Ventflo Fan according to this user guide.

It will only take you a few minutes, so please read on!

Contents

Safety	Pg 3-4
Ventilation Requirements	Pg 5
Clearances	Pg 6
Flat Roof Installations	Pg 7
Electrical Requirements	Pg 7
Wiring Diagrams	Pg 8
Installation	Pg 9
Use	Pg 10
Cleaning	Pg 10
Record Your Model	Pg 11
Warranty	Pg 12-13
Notes	Pg 14
Template for Cut Out	Pg 15

IXL Eco Ventflo

Safety



Do not allow insulation material to rest against the sides or top of the Ventflo unit when installed.

Read through these instructions fully before commencing installation.

Locate the IXL Eco Ventflo in accordance with the requirements of the current Australian/ New Zealand Wiring Rules AS/NZS 3000 relating to damp situations, or according to applicable Wiring Rules for installations outside of Australia and New Zealand. This appliance has an IPX4 rating which means it is suitable for Zone 1 installations and can be mounted directly above a bath or shower recess.

This unit is fitted with a cord and plug, however, any interconnecting wiring and switches used must be fitted by a licensed electrician.

Switches and other controls must not be located where they can be touched by a person in the bath or shower.

Warning:

- Do not use this appliance for functions other than those described in this user guide.
- After removing the appliance from its packaging, ensure that it is complete and undamaged. If in doubt contact a qualified electrician or Sampford IXL. Do not leave packaging within the reach of children or infirm persons.
- This appliance is not intended for use by persons (including children) with reduced physical, sensory or mental capabilities, or lack of experience and knowledge, unless they have been given supervision or instruction concerning the use of the appliance by a person responsible for their safety.
- Young children should be supervised to ensure they do not play with the appliance.
- Do not operate the appliance in the presence of inflammable vapours (alcohol, insecticides, petrol, etc.)
- Do not sit or place objects on or in the appliance.
- The supply cord cannot be replaced. If the cord is damaged the appliance should be scrapped.
- Do not operate this appliance without the plastic surround in position.
- This appliance must be mounted with the lowest point at least 2.1 metres from the floor.

Caution:

- Do not make modifications of any kind to this appliance.
- Do not expose this appliance to the weather (rain, sun, etc.)
- Do not immerse the appliance or any parts of it in water or other liquids. Refer to the relevant instructions to clean the appliance (page 10)

- If the appliance does not function correctly or develops a fault, contact Sampford IXL immediately.
- Should the appliance be dropped or suffer a heavy blow, have it checked by an authorised service agent for IXL products
- The electrical system to which the appliance is connected must conform to applicable standards.
- The electrical power supply/socket to which the appliance is to be connected must be able to provide the maximum electrical power required by the appliance. If it can't do this, contact a qualified electrician to make the necessary modifications.
- Switch off the appliance at the installation's main switch: a) if the appliance does not function correctly; b) before cleaning the outside of the appliance; c) if the appliance is not going to be used for any length of time.
- The room must have an adequate source of replacement air for this appliance to function effectively. Moreover, if there is any non-sealed combustion based appliance such as a water heater, gas stove, etc. in the same room, air replacement must be sufficient for all appliances to work effectively together.
- Keep the appliance's inlet grille free from dust to ensure optimum air flow

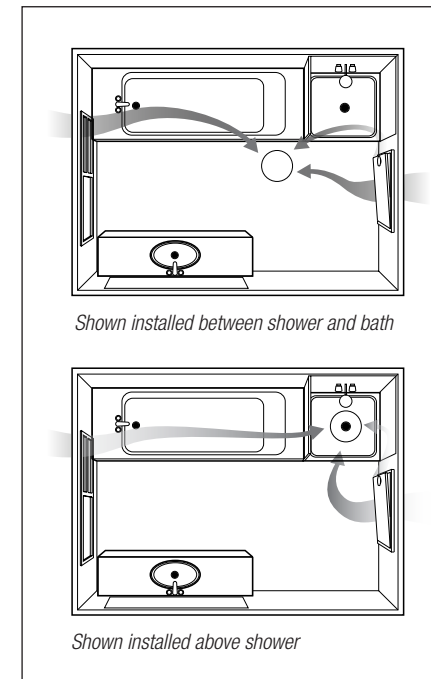

Fig. 1: Ideal placement of Ventflo.
Sufficient air inlets into room are required.

For maximum efficiency and fan performance there are a few key points to keep in mind when installing your IXL Eco Ventflo exhaust fan.

Sufficient air inlet into room

Steam will only be removed if there is sufficient flow of air through the room. Ensure generous inlets exist through windows, vents or under the door. Air flow path from inlet to fan should ideally pass over the steam sources. (See Fig 1.)

Adequate ventilation in roof cavity

It is essential that there is adequate space within the roof cavity so that exhaust air from the fan can dissipate. Where space is restricted, use Fig. 3 as a guide to minimum requirements for adequate ventilation.

The roof cavity itself should be well ventilated to outside so that moist air can be removed. Local building codes may require flueing to outside through roof as per Fig. 4 (page 7) for flat roof installation.

Where ventilation space is restricted

This product is not recommended for installation between floors of multi-storey dwellings, or where space within the roof cavity is severely restricted and a flue as per Fig. 4 cannot be fitted. IXL has other Ventilation products available that are particularly suited to installations between floors or where space is restricted. Contact your nearest IXL Service Centre on the numbers located on the back of this booklet.

For further details and advice on ventilation products and tips, visit the IXL Ventilation Selection Guide on our website: www.sampfordixl.com.au

IXL Eco Ventflo

Clearances

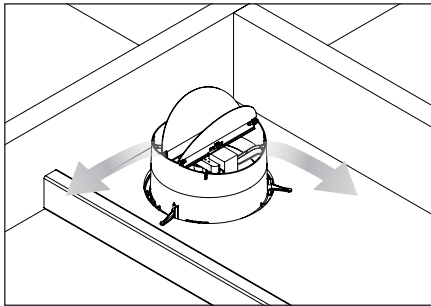

Fig. 2: Adequate open space in the roof cavity is required

All appliances must be mounted so that the lowest point is at least 2.1m above the floor. The IXL Eco Ventflo is designed to fit a ceiling cavity with a minimum height of 215 mm (10324) & 260 mm (10326) when installed in a well ventilated roof cavity. Where ventilation is restricted, these heights should be increased by a minimum of 25 mm. This will allow for the back draught shutters to open fully when the unit is in operation.

Additionally, a minimum of 40 mm clearance is required between the sides of the fan and any adjoining parts of the roof structure, such as walls, joists or insulation batts.

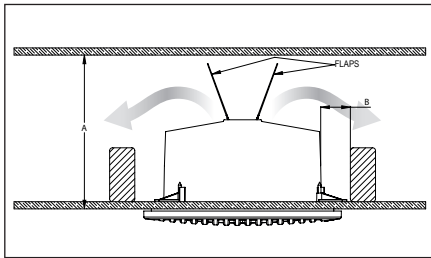

Fig. 3: Minimum clearances for installation

Figure 3 measurement A:

Model 10324 (Ventflo 200)
215 mm min. where there is good ventilation to the sides of the unit.

240 mm min. where ventilation to the sides of the unit is restricted.

Model 10326 (Ventflo 250)
260 mm min. where there is good ventilation to the sides of the unit.

285 mm min. where ventilation to the sides of the unit is restricted.

Figure 3 measurement B:

40 mm min. clearance on all sides to allow clips to fully rotate outwards.

IXL Eco Ventflo

Flat Roof Installations

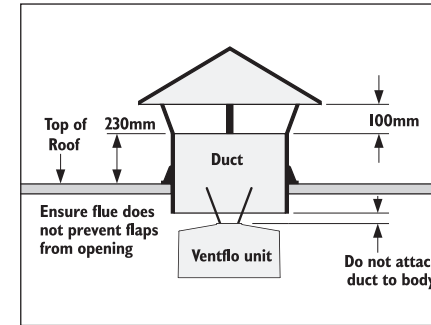

Fig. 4: Minimum external outlet requirements

When installing into a flat roof with insufficient clearance, or where ceiling cavity ventilation is restricted, an external venting duct must be installed. Use Fig. 4 as a guide to minimum external outlet requirements.

IMPORTANT: Do not attach the duct to the body of the fan. Allow for 10-20 mm minimum gap between the fan and the end of the duct. The duct should have a diameter of at least 235mm (10324) & 290mm (10326).

Electrical Requirements

See the wiring diagram (Fig. 5) for supply requirements and maximum loadings for each model. Fans may be connected to a lighting power circuit if loading permits. Wiring of the wall switch (not provided) and socket outlet in roof cavity must be carried out by a registered electrician. The wall switch should be located in accordance the Wiring Rules AS/NZS 3000. It must not be installed where it can be reached by a person in the bath or shower.

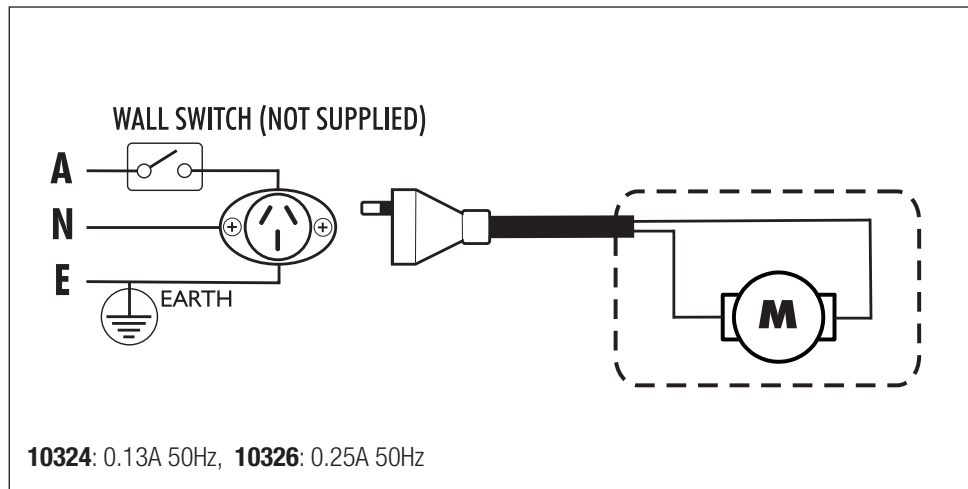

Fig. 5: Wiring diagram.

Important considerations before installing

- Joists, beams and rafters shall not be cut or notched to install the appliance.
- This unit has an IPX4 rating which means it is suitable for Zone 1 installations and can be installed directly above a shower or bath.
- For the exhaust fan to work efficiently, replacement air of a volume equivalent to what is being extracted must be able to enter the room. In general this air would be drawn under the door or through a slightly open window. If the room is airtight the fan will function poorly.
- This product is designed for installation in flat ceiling only. Do not mount it on a sloping ceiling or vertical wall.

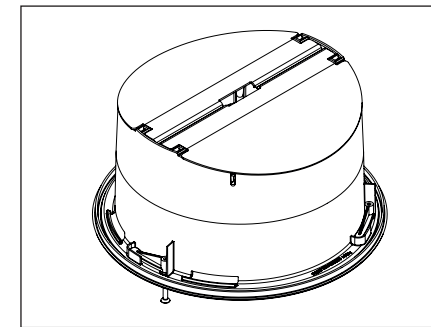

Fig. 6: Mounting clips closed

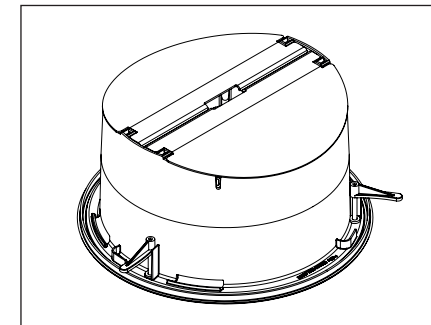

Fig. 7: Mounting clips open

1. Locating the unit – Before commencing any cutting, check in the ceiling space that there are no obstructions such as ceiling joists and that there is sufficient clearance for the housing. Check that the electrical wiring can be routed from the wall switches to the mounting location.
2. Prepare the ceiling – Using the template provided on page 15, mark the ceiling with a pencil outline and cut out the required hole (10324 needs 244 mm dia. & 10326 needs 294 mm dia. hole).
3. Remove the grille.
4. Plug the fan into the power point.
5. Ensure that the mounting clips are in the closed position, then insert fan into ceiling cut out.
6. Using a screwdriver (or a battery driver with a low torque setting) partially tighten the screws. This will move the mounting clips into the open position and hold the unit to the ceiling.
7. Rotate the unit so that the grille direction lines on the body are aligned with the walls. These lines show the orientation of the fascia grille when installed.
8. Tighten the screws. Do not over tighten as this can damage plasterboard.
9. Fit grille onto unit. Once fitted the grille can be adjusted to better align with the walls.

IXL Eco Ventflo

Use

1. Turn the power switch on/off to make sure the unit runs
2. Running the fan can exhaust steam and odours quickly and efficiently.

Note: Shut off power urgently when any abnormalities occur in operation. Then call a licensed electrician or IXL service person for inspection and necessary service work.

Do not insert fingers or thin bars into the grille when the unit is operating. This could cause harm to yourself and the appliance.

The unit must not be installed in a place that suffers from severe water leakage.

Cleaning

1. Shut power off before cleaning or maintenance.
2. Remove grille and wipe it with care using a damp soft cloth with a mild detergent if necessary. Ensure the motor or other electrical parts can't touch the water.
3. The grille can be cleaned in a dishwasher on low heat setting ~45°C and only wash on the top shelf.
4. Replace the grille after it is thoroughly dry

IXL Eco Ventflo

Record Your Model

**RECORD THE DETAILS OF YOUR MODEL AND KEEP THE FOLLOWING INFORMATION
DO NOT SEND THIS TO IXL.**

Installed By

Suburb

Date of Purchase

Model No..... Serial No

Three Year Replacement Warranty

This Warranty against defects for your newly purchased IXL product is proudly prepared by Sampford IXL Pty Ltd of 421 Smith Street, Fitzroy, VIC 3065, phone 1300 727 421.

1. Sampford IXL Ventilation products come with guarantees that do not exclude the following consumer entitlements under the Australian Consumer Law:
 - a. replacement or refund for a major failure and compensation for any other reasonably foreseeable loss or damage; and
 - b. to have the goods replaced if goods fail to be of acceptable quality and the failure does not amount to a major failure.
2. Sampford IXL warrants that your product and related supply will be free from defects in materials and workmanship during the warranty term. Your warranty term is three years commencing from the date of purchase.
3. Subject to Point 1, Sampford IXL will during the warranty term provide a replacement of an equivalent current model where the balance of the warranty period from the original date of purchase will take effect.
4. To the fullest extent permitted by law and subject always to Point 1, Sampford IXL will not be liable for:
 - a. any loss or damage arising from loss of use, loss of profits or revenue; or
 - b. for any indirect or consequential loss or damage resulting from any breach of this warranty against defects.
5. Defective Sampford IXL products may be replaced by a refurbished product of the same type.

Limitations to Your IXL Warranty

6. Subject to Point 1, this Warranty:
 - a. will only be provided to the original purchaser where the original purchase was made from a Sampford IXL Authorised Dealer or Reseller and proof of such purchase can be presented at the time of service;
 - b. only applies to Sampford IXL products purchased in Australia from a Sampford IXL Authorised Dealer or Reseller;
 - c. will not apply where the defect in or failure of the product is attributable to misuse, abuse, accident or non-observation of the manufacturer's instructions. This product must be used in accordance with the manufacturer's instructions;
 - d. will not cover faults due to normal wear and tear with reasonable use nor consumable components such as globes, filters, glass items, etc;
 - e. will not cover any damages or problems caused to this product by natural forces eg. storm, fire, flood, and earthquake; or by intrusion or accumulation (or both) of foreign matters eg. dust, soil, and moisture. Sampford IXL recommends that you take out appropriate insurances to protect your product to this end;
 - f. will not apply if this product is installed in a mobile dwelling eg. caravan or boat;
 - g. will not apply if this product is removed from the location where it was first installed;
 - h. covers use of this product for domestic use only;
 - i. will not be restarted or extended upon replacement of the product or a part.

How to make a Claim under Your IXL Warranty

7. To make a claim under this Warranty you will need to:
 - a. contact Sampford IXL service department on 1300 727 421 or aftersaleservice@sampfordixl.com.au to provide details and register your claim enabling a Sampford IXL assessment;
 - b. submit proof of purchase with your claim eg. tax invoice or purchase receipt;
 - c. where a property has been constructed by a builder/developer and it is fitted with IXL products, please submit proof of purchase by way of the certificate of occupancy, with your claim.
8. Sampford IXL will contact you to make arrangements for a replacement product.

Privacy

The privacy of your personal information has always been important to us. To learn more about how we collect, keep and use your personal information, please obtain a copy of our privacy statement by visiting our website at www.sampfordixl.com.au or by contacting us via email on info@sampfordixl.com.au or by telephone on 1300 727 421.

⊕ VENTFLO 250

⊕ VENTFLO 200

⊕ HOLE CENTRE

For comments, questions or warranty matters:

Sampford IXL Pty Ltd

Service Department

421 Smith St

Fitzroy Victoria 3065 Australia

Phone: 1300 727 421

Fax: 1300 727 425

aftersalesservice@sampfordixl.com.au

info@sampfordixl.com.au

www.sampfordixl.com.au



N5323

Approved by the appropriate
electrical supply authorities.

Part number 611030 Issue A.