

# Homelite®

## HLT25SDSN



## **Important!**

It is essential that you read the instructions in this manual before assembling, operating, and maintaining the product.

Subject to technical modifications.

Safety, performance, and dependability have been given top priority in the design of your grass trimmer.

### INTENDED USE

The grass trimmer is intended to be used only by adults who have read and understood the instructions and warnings in this manual and can be considered responsible for their actions.

The product is only intended for use outdoors in a well-ventilated area. For safety reasons, the product must be adequately controlled using a two-handed operation.

The product is designed for cutting grass, light weeds, and other similar vegetation at or about ground level. The cutting plane should be approximately parallel to the ground surface.

The product should not be used to cut or trim hedges, bushes, or other vegetation where the cutting plane is not or about ground surface level.

Do not use the product for any other purpose.

### ⚠ WARNING

To reduce the risk of injury, the user must read and understand the operator's manual.

### ⚠ WARNING

Do not attempt to operate the product until you have read thoroughly and understood completely all instructions and safety rules contained in this manual. Failure to comply may result in accidents involving fire, electric shock, or serious personal injury. Save the operator's manual and review frequently for continuing safe operation, and instructing others who may use the product.

### ⚠ WARNING

The product is not intended to be used by children or persons with reduced physical, mental, or sensory capabilities. Children should be adequately supervised to ensure they do not play with the product.

### GENERAL SAFETY WARNINGS

- For safe operation, read and understand all instructions before using the product. Follow all safety instructions. Failure to follow all safety instructions listed below can result in serious personal injury.
- Some regions have regulations that restrict the use of the product. Check with your local authority for advice.
- Do not allow children or untrained individuals to use the product.
- Do not start or run the engine in a closed or poorly ventilated area; breathing exhaust fumes can kill.
- Clear the work area before each use. Remove all objects such as rocks, broken glass, nails, wire, or string that can be thrown or become entangled in the string head.
- Wear full eye and hearing protection while operating the product. If working in an area where there is a risk of falling objects, head protection must be worn.
- Hearing protection may restrict the operator's ability to hear warning sounds. Pay particular attention to potential hazards around and inside the working area.
- Wear heavy, long trousers, non-slip protective footwear, and gloves. Do not wear loose fitting clothing, short trousers, jewellery of any kind, or use with bare feet.
- Secure long hair so it is above shoulder level to prevent entanglement in any moving parts.
- Keep all bystanders, children, and pets at least 15 m away. Stop the product if anyone enters the area.
- Do not use the product when tired, ill, under medication, or under the influence of alcohol and drugs.
- Do not use in poor lighting. The operator needs clear unrestricted vision to identify potential hazards.
- Keep firm footing and balance at all times. Do not overreach. Overreaching can result in loss of balance or exposure to hot surfaces.
- Keep all parts of your body away from any moving part.
- Do not touch the area around the silencer or cylinder of the product, these parts get hot from operation.
- Always stop the engine and allow it to cool down before making any adjustments.
- Do not smoke when mixing the fuel or when filling the fuel tank.
- Mix and store the fuel in a container that is approved for fuel.
- Mix the fuel outdoors where there are no sparks or flames. Wipe up any fuel spillage. Move 9 m away from refueling site before starting engine.
- Stop the engine and allow it to cool down before refueling or storing the product.
- Allow the engine to cool down, empty the fuel tank, and secure the product from moving before transporting in a vehicle.
- Switch off the engine. Make sure all moving parts have come to a complete stop:
  - before servicing
  - before leaving the product unattended
  - before clearing a blockage
  - before checking, cleaning, and working on the product
  - before changing accessories
  - after striking a foreign object
  - whenever performing maintenance
  - whenever the product starts to vibrate abnormally

## Original instructions | English

### **⚠ WARNING**

Never use cutting means or attachments, which are not specified by HOMELITE in this manual. This includes the use of metal multi-piece pivoting chains and flail-blades. These items are known to break up during use and present a high risk of serious injury to the operator or bystanders.

### **⚠ WARNING**

Inspection after dropping or other impacts: Thoroughly inspect the product and identify any problems or damage to it. Any part that is damaged should be properly repaired or replaced by an authorised service centre.

### **GRASS TRIMMER SAFETY WARNINGS**

- Replace the string head if cracked, chipped, or damaged in any way. Be sure the string head is properly installed and securely fastened. Failure to do so can cause serious injury.
- Avoid using on wet grass.
- Do not walk backwards when using the product.
- Walk, never run.
- The small blade fitted to the cutting attachment guard is designed to trim the new extended line to the correct length for safe and optimum performance. It is very sharp; do not touch it, particularly when cleaning the product.
- Always ensure that ventilation openings are kept clear of debris.
- Before use and after any impact, check that there are no damaged parts. Examine the cutting means for signs of cracking or other damage. A defective switch or any part that is damaged should be properly repaired or replaced by an authorised service facility.
- Make sure the head attachment is properly installed and securely fastened.
- Make sure all guards, deflectors, handles, bolts, and fasteners are properly and securely attached.
- Do not modify the product in any way. This may increase the risk of injury to yourself or others.
- Use only the manufacturer's replacement line in the cutting head. Do not use any other cutting attachment.
- Do not operate the product without the cutting attachment guard in place. Ensure the cutting attachment is in good condition.
- Maintain a firm grip on both handles while trimming. Keep string head below waist level. Never cut with the string head located over 76 cm or more above the ground.

### **TRANSPORTATION AND STORAGE**

- Stop the engine and allow it to cool down before storing or transporting.
- Clean all foreign materials from the product.

- Drain all fuel from tank into a container approved for petrol. Remember to properly replace and tighten the fuel cap.
- Run the engine until it stops, this will remove all fuel that could become stale and leave varnish and gum in the fuel system.
- Drain all lubricant from tank into a container approved for lubricant. Remember to properly replace the lubricant cap.
- Store the product in a cool, dry, and well-ventilated place that is inaccessible to children. Keep away from corrosive agents, such as garden chemicals and de-icing salts. Do not store outdoors.
- When transporting the product in a vehicle, secure it against movement or falling to prevent injury to persons or damage to the product.
- Never carry or transport the product while the engine is running.
- Abide all government and local regulations for the safety storage and handling of petrol.

### **Short term**

- Stop the engine, and allow it to cool down before storing.
- Clean all foreign material from the product.
- Store the product in a cool, dry, and well-ventilated place that is inaccessible to children.
- Keep away from corrosive agents such as garden chemicals and de-icing salts.
- Do not store outdoors.

### **MAINTENANCE**

### **⚠ WARNING**

Use only original manufacturer's replacement parts, accessories, and attachments. Failure to do so can cause possible injury, contribute to poor performance, and may void your warranty.

- Always stop the engine and allow it to cool down before making any maintenance.
- You may make adjustments and repairs described in this manual. For other repairs, contact an authorised service centre.
- Consequences of improper maintenance may include excess carbon deposits resulting in loss of performance and discharge of black lubricant residue dripping from the silencer.
- For the replacement line, use only nylon filament line of the diameter described in the specification table of this manual.
- After extending the new cutter line, always return the product to its normal operating position before starting.
- After each use, clean the product with a soft, dry cloth.
- Any part that is damaged should be properly repaired or replaced by an authorised service centre.

- Check all nuts, bolts, and screws at frequent intervals for proper tightness to ensure the product is in a safe working condition.

### RESIDUAL RISK

Even when the product is used as prescribed, it is still impossible to completely eliminate certain residual risk factors. The following hazards may arise in use and the operator should pay special attention to avoid the following:

- Injury caused by vibration
  - Hold the product by designated handles and restrict working time and exposure.
- Exposure to noise can cause hearing injury
  - Wear hearing protection and limit exposure.
- Eye injury due to flying debris
  - Wear eye protection at all times.

### RISK REDUCTION

It has been reported that vibrations from handheld tools may contribute to a condition called Raynaud's Syndrome. Symptoms may include tingling, numbness and blanching of the fingers, usually apparent upon exposure to cold. Hereditary factors, exposure to cold and dampness, diet, smoking and work practices are all thought to contribute to the development of these symptoms. There are measures that can be taken by the operator to possibly reduce the effects of vibration:

- Keep your body warm in cold weather. When operating the product, wear gloves to keep the hands and wrists warm. It is reported that cold weather is a major factor contributing to Raynaud's syndrome.
- After each period of operation, exercise to increase blood circulation.
- Take frequent work breaks. Limit the amount of exposure per day.

If you experience any of the symptoms of this condition, immediately discontinue use and see your physician.

### WARNING

Injuries may be caused, or aggravated, by prolonged use of a tool. When using any tool for prolonged periods, ensure you take regular breaks.

### SYMBOL



Safety alert



Please read the instructions carefully before starting the product.



Wear eye, hearing, and head protection when operating the product.



Beware of thrown or flying objects. Keep all bystanders, especially children and pets, at least 15 m from the operating area.



The product is not intended for use with a toothed saw type blade.



Do not use blade(s) on the product.



Rotational direction and maximum speed of the shaft for the cutting attachment.



Wear non-slip safety footwear when using the product.



Wear non-slip, heavy duty gloves.



Set switch to ON.



PRIME - Press the primer bulb 10 times slowly.



Run position



Half choke position



Full choke position



Squeeze the trigger and pull the starter grip.



Wait for 10 seconds.



Keep hands away from blades.



To reduce the risk of injury or damage, avoid contact with any hot surface.



Use 2-stroke lubricant for air cooled engines.

# Original instructions | English



Use unleaded petrol intended for motor vehicle use with an octane rating of 91 ([R+M]/2) or higher.



Sound pressure level at idle



Guaranteed sound power level



Regulatory Compliance Mark (RCM). Product meets applicable regulatory requirements.

The following signal words and meanings are intended to explain the levels of risk associated with this product.

## **⚠ DANGER**

Indicates an imminently hazardous situation, which, if not avoided, will result in death or serious injury.

## **⚠ WARNING**

Indicates a potentially hazardous situation, which, if not avoided, could result in death or serious injury.

## **⚠ CAUTION**

Indicates a potentially hazardous situation, which, if not avoided, may result in minor or moderate injury.

## **CAUTION**

Without safety alert symbol

Indicates a situation that may result in property damage.

## **ASSEMBLY**

### **UNPACKING**

The product requires assembly.

- Carefully remove the product and any accessories from the box. Make sure that all items listed in the packing list are included.
- Inspect the product carefully to make sure no breakage or damage occurred during shipping.
- Do not discard the packing material until you have carefully inspected and satisfactorily operated the product.

### **PACKING LIST**

- Power head and upper boom assembly x 1
- Front handle assembly x 1
- Safety grass deflector assembly x 1
- Combination wrench x 1
- Lower boom and string head assembly x 1
- 2-stroke lubricant x 1
- Manual x 1

## **⚠ WARNING**

If any parts are damaged or missing, do not operate the product until the parts are replaced. Failure to heed this warning could result in serious personal injury.

## **⚠ WARNING**

Do not attempt to modify the product or create accessories not recommended for use with the product. Any such alteration or modification is misuse and could result in a hazardous condition leading to possible serious personal injury.

## **⚠ WARNING**

Never attach or adjust any attachment while power head is running. Failure to stop the engine may cause serious personal injury.

## **⚠ WARNING**

To avoid serious injury, ensure that all grass deflector and covers are correctly fitted and all fixings and fasteners are tight before use. Re-check tightness after a period of use.

### **ATTACHING THE FRONT HANDLE**

See page 12, step 5.

- Remove the bolt and wing nut from the front handle.
- Mount the front handle in front of the foam part.
- Replace the bolt and wing nut. Tighten the wing nut.

### **ASSEMBLING THE GRASS DEFLECTOR**

See page 13, step 4.

- Insert the tab on the mounting bracket in the slot on the grass deflector.
- Align the screw hole in the mounting bracket with the screw hole in the grass deflector.
- Using the combination wrench supplied, tighten the screw securely.

### **ATTACHING THE LOWER BOOM TO THE POWER HEAD**

See page 13, step 3.

## **⚠ WARNING**

Never attach or adjust any attachment while power head is running. Failure to stop the engine may cause serious personal injury.

- The lower boom connects to the power head by means of a coupler device.
- Loosen the knob on the coupler of the power head upper boom and remove the end cap from the attachment.
- Push in the button located on the lower boom. Align the button with the guide recess on the power head coupler and slide the two booms together.
- Rotate the lower boom until the button locks into the positioning hole.

**NOTE:** If the button does not release completely in

the positioning hole, the booms are not locked into place. Slightly rotate from side to side until the button is locked into place.

- Tighten the knob securely.

### ⚠ WARNING

To avoid serious injury, ensure that all grass deflector and covers are correctly fitted and all fixings and fasteners are tight before use. Re-check tightness after a period of use.

## REMOVING THE LOWER BOOM FROM THE POWER HEAD

See page 28, step 3.

- Loosen the knob.
- Push in the button and twist the lower boom to remove and separate ends.

### ⚠ WARNING

Always stop the engine and remove the spark plug wire before making any adjustments such as changing cutting heads; this is to reduce the risk of serious personal injury.

## OPERATION

### FUEL AND REFUELING

#### Handling the fuel safely

- Always handle fuel with care, it is highly flammable.
- Always refuel outdoors where there are no sparks and flames. Do not inhale fuel vapors.
- Do not let petrol or oil come in contact with your skin.
- Keep petrol and oil away from the eyes. If petrol or oil comes in contact with the eyes, wash them immediately with clean water. If irritation is still present, see a physician immediately.
- Clean up spilled petrol immediately.

#### Mixing the fuel

- The product is powered by a 2-stroke engine and requires pre-mixing petrol and 2-stroke oil. Store pre-mix unleaded petrol and 2-stroke engine oil in a clean container approved for petrol.
- This engine is certified to operate on unleaded petrol intended for automotive use with an octane rating of 91 ([R + M] / 2) or higher.
- Do not use any type of pre-mixed petrol / oil from fuel service stations, this includes the pre-mixed petrol / oil intended for use in mopeds, motorcycles, etc.
- Use synthetic 2-stroke oil only. Do not use automotive oil or 2-stroke outboard oil.
- Mix 2% synthetic 2-stroke oil into the petrol. This is a 50:1 ratio.

- Mix the fuel thoroughly and also each time before fuelling.
- Mix in small quantities. Do not mix quantities larger than usable in a 30 day period. Synthetic 2-stroke oil containing a fuel stabilizer is recommended.



#### Filling the tank

- Clean the surface around the fuel cap to prevent contamination.
- Loosen the fuel cap slowly to release pressure and to keep fuel from escaping around the cap.
- Carefully pour the fuel mixture into the tank. Avoid spillage.
- Prior to replacing the fuel cap, clean and inspect the gasket.
- Immediately replace fuel cap and hand tighten. Wipe up any fuel spillage. Move 9 m away from refueling site before starting engine.

**NOTE:** It is normal for smoke to be emitted from a new engine during and after first use.

### ⚠ WARNING

Always shut off the engine before fueling. Never add fuel to a machine with a running or hot engine. Move at least 9 m from refueling site before starting engine. Do not smoke!



1 Litre	+	20 ml	=	} 50:1 (2%)
2 Litres	+	40 ml	=	
3 Litres	+	60 ml	=	
4 Litres	+	80 ml	=	
5 Litres	+	100 ml	=	

### STARTING THE PRODUCT

Starting the product differs depending on whether the engine is cold (not yet started today) or warm (has been running in the last hour). Always refer to the Starting Instructions label on the air filter when starting the engine. Refer below for full instructions.

### ⚠ WARNING

Never start or run the engine inside a closed or poorly ventilated area; breathing exhaust fumes can kill.







## Original instructions | English

**NOTE:** Before starting the product, make sure the trimmer is lying on a flat and bare surface.

### Starting a cold engine:

See page 15.

1. Ensure the switch is in the "I" (ON) position.
2. Press the primer bulb for 10 times.  
**NOTE:** After the 7th press, the fuel should be visible in the primer bulb. If not, continue pressing until the fuel is visible.
3. Set the choke lever to  choke position.
4. Squeeze the throttle lock and throttle trigger completely and pull the starter grip until the engine attempts to start. Do not pull the starter grip more than 4 times.  
**NOTE:** Keep the throttle lock and throttle trigger squeezed completely through steps 4 to 7.
5. Set the choke lever to  choke position.
6. Pull the starter grip until the engine starts. Do not pull the starter grip for more than 6 times.  
**NOTE:** If the engine does not start, return to  choke position and repeat the process beginning at step 2.
7. Allow the engine to run for 10 seconds, then set the choke lever to  position.

### Starting a warm engine:

See page 16.

1. Ensure the switch is in the "I" (ON) position.
2. Press the primer bulb for 10 times.
3. Set the choke lever to  position.
4. Squeeze the throttle lock and throttle trigger completely and pull the starter grip until the engine starts. Do not pull the starter grip for more than 6 times.  
**NOTE:** If the engine does not start, return step 2 under "To start a cold engine".

### Stopping the engine:

Set the ignition switch to the "O" (OFF) position.

### OPERATING THE TRIMMER

See page 17.

- Hold the product with the right hand on the rear handle and the left hand on the front handle.
- Keep a firm grip with both hands while in operation. Trimmer should be held at a comfortable position with the trigger handle about hip height.
- Always operate trimmer at full throttle. Cut tall grass from the top down. This will prevent grass from wrapping around the shaft housing and bump head which may cause damage from overheating. If grass becomes wrapped around the bump head, stop the engine, wait for all moving parts to stop, and remove the grass. Prolonged cutting at partial throttle will result in lubricant dripping from the silencer.
- Maintain your grip and balance on both feet. Position yourself so that you will not be drawn off balance by the kick-back reaction.

### CUTTING TIPS

See page 17.

When cutting, make sure the cutter head is at a slight angle while still approximately parallel to the ground surface. In tall grass, cut from the top down to ensure the moving parts do not get tangled with the long grass.

### ADVANCING THE LINE

See page 18, step 2.

If the line becomes short, tap the bump head on the ground as shown at full throttle. More line will extend. Take care not to bump the head on a hard surface such as concrete or pavers as this may cause damage to the bump head.

#### WARNING

When servicing, use only original manufacturer's replacement parts. Use of any other parts may create a hazard or cause product damage.

#### WARNING

Always wear safety goggles or safety glasses with side shields during product operation. If operation is dusty, also wear a dust mask.

#### WARNING

Before inspecting, cleaning, or servicing the product, shut off the engine, wait for all moving parts to stop. Failure to follow these instructions can result in serious personal injury or property damage.

#### WARNING

Neglected or poorly conducted maintenance may create additional hazards. Do not attempt to repair or maintain the product if you are not qualified to do so. If in doubt, return to a service centre for professional assistance.

### GENERAL MAINTENANCE

Avoid using solvents when cleaning plastic parts. Most plastics are susceptible to damage from various types of commercial solvents and may be damaged by their use. Use clean cloths to remove dirt, dust, lubricant, and grease.

#### WARNING

Do not at any time let brake fluids, petrol, petroleum-based products, penetrating lubricants, etc., come in contact with plastic parts. Chemicals can damage, weaken or destroy plastic, which may result in serious personal injury.

You can often make adjustments and repairs described in this manual. For other repairs, have the trimmer serviced by a service agent.

### REPLACING THE LINE

See page 20.

- Ensure the product is in the off position.





- Unlock the retainer clockwise as shown and remove the retainer and spool.
- Remove all old cutter line, and replace with the correct replacement line.
- Once you have reloaded the line on the spool, locate it in the correct channels.
- Replace the spool back into the head making sure all the lines are located correctly.
- Have 15 cm of line protruding from the eyelets of the string head housing.
- Press the head into the drive shaft of lower boom to hold it steady.
- Replace the retainer and then tighten it counterclockwise.
- Pull excess line out to ensure no tangles in the head.

### CLEANING THE EXHAUST PORT AND SILENCER

Depending on the type of fuel used, the type and amount of lubricant used, and/or your operating conditions, the exhaust port and silencer may become blocked with carbon deposits. If you notice a power loss with your petrol powered product, a qualified service technician will need to remove these deposits to restore performance.

### SPARK ARRESTOR

See page 25.

The spark arrestor must be cleaned or replaced every 25 hours or yearly to ensure proper performance of the product. Spark arrestors may be found in different locations depending on the model purchased. Please contact your nearest service centre for the location of the spark arrestor for your model.

### CLEANING THE AIR FILTER

See page 23.

For proper performance and longer life, keep the foam air filter clean.

- Remove the air filter cover by pushing down on the latches while gently pulling off the cover.
- Remove the air filter.
- Clean the foam filter element with warm, soapy water. Rinse and let dry.
- **NOTE:** If the foam filter element is damaged, it should be replaced.
- Apply a light coat of engine oil to the foam filter element, then squeeze it out.
- Reinstall the air filter.
- **NOTE:** Make sure the filter is seated properly inside the cover. Installing the filter incorrectly will allow dirt to enter the engine, causing rapid engine wear.
- Replace the air filter cover by placing the slots on the air filter cover over the latches on the housing, then push the cover down until it snaps securely in place.

### CHECKING THE FUEL CAP

#### ⚠ WARNING

A leaking fuel cap is a fire hazard and must be replaced immediately.

The fuel cap contains a non-serviceable filter and a check valve. A clogged fuel filter causes poor engine performance. If performance improves when the fuel cap is loosened, the valve may be faulty or the filter may be clogged. Replace the fuel cap if necessary.

### REPLACING THE SPARK PLUG

See page 22.

This engine uses a Champion RCJ6Y, TORCH L7RTC or equivalent spark plug with 0.63 mm electrode gap. Use an exact replacement and replace annually.

Follow these steps to replace the spark plug.

- Stop the engine.
- Remove the spark plug boot.
- Loosen the spark plug by turning it counterclockwise with a combination wrench.
- Remove the spark plug.
- Hand thread the new spark plug, turning it clockwise.
- Tighten with a combination wrench to 22~25 Nm torque. Do not overtighten.

### IDLE SPEED ADJUSTMENT

If the string still move at idle speed, contact an authorised service centre for adjustment and discontinue use until the repair is made.

### CLEANING THE EXHAUST HOLE OF THE CYLINDER AND INTAKE HOLE OF THE MUFFLER

See page 25.

#### ⚠ CAUTION

Always stop the engine and allow it to cool down before cleaning the exhaust hole.

- Make sure the product is in the "off" position.
- Remove the screws on the top and rear portions of the housing counterclockwise.
- Remove the rear housing from the engine.
- Remove the muffler screws counterclockwise, and then remove the muffler from the cylinder.
- Use the brush to clean the exhaust hole of the cylinder and intake hole of the muffler.
- Replace the muffler. Replace the screws and then tighten it clockwise.
- Replace the rear housing. Replace the screws, and then tighten it clockwise.

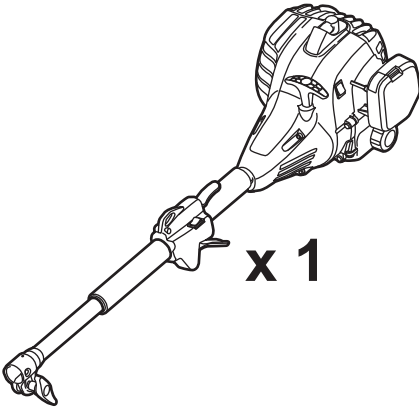

**x 1**

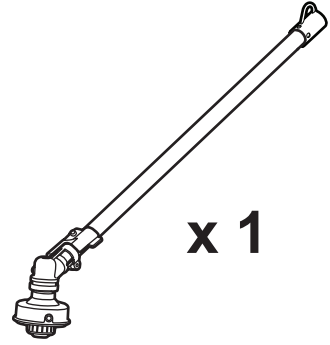

**x 1**

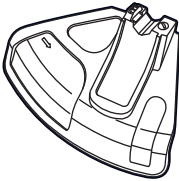

**x 1**

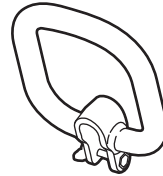

**x 1**



**x 1**



**x 1**



**x 1**



1. Ignition module
2. Choke lever
3. Fuel cap
4. Throttle lock
5. Switch
6. Throttle trigger
7. Muffler

8. Knob
9. Air filter
10. Lower shaft
11. Grass deflector
12. String line
13. Trimmer head
14. Retainer

15. Front handle
16. Strap hanger
17. Primer bulb
18. Starter grip
19. Spark plug

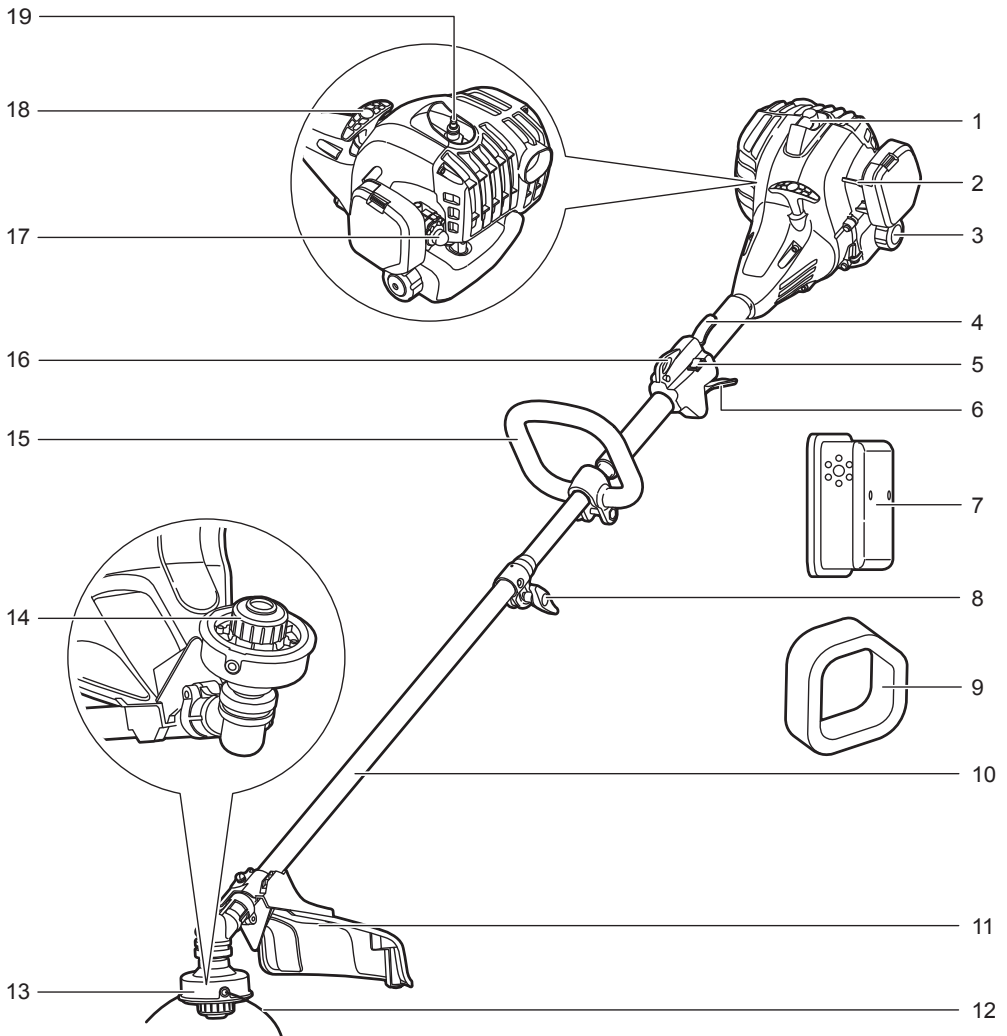

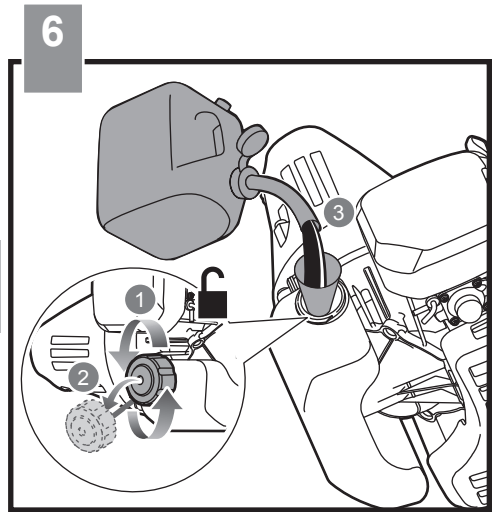
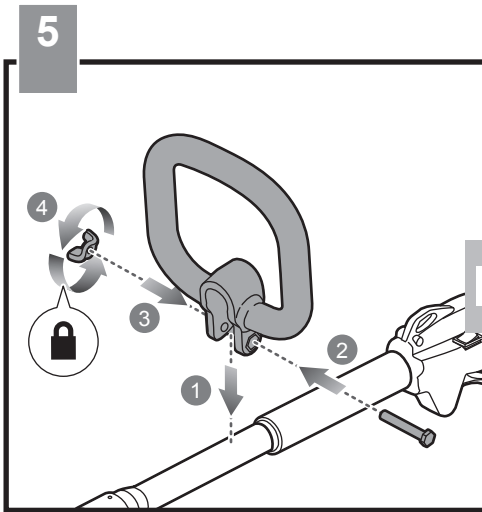
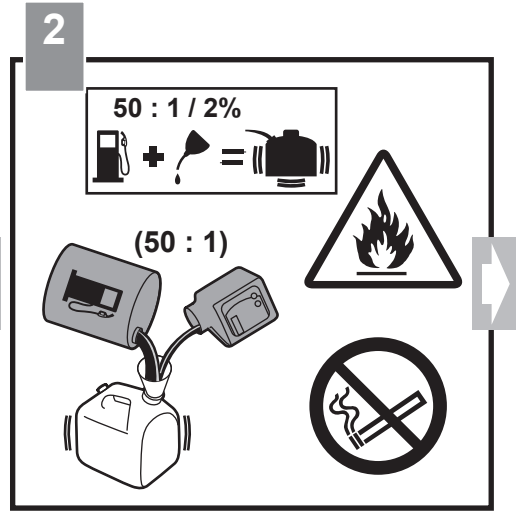
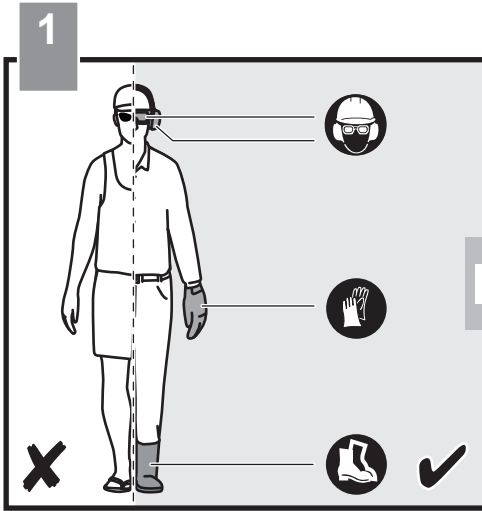

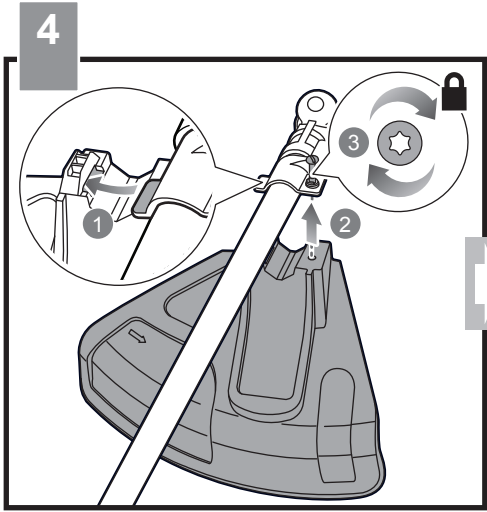
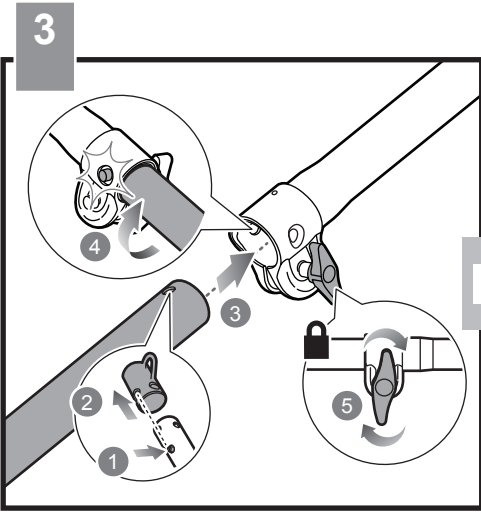

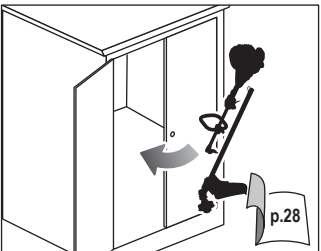
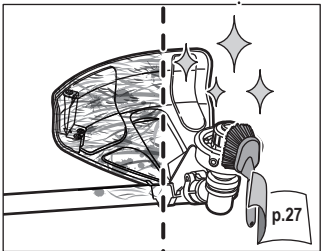
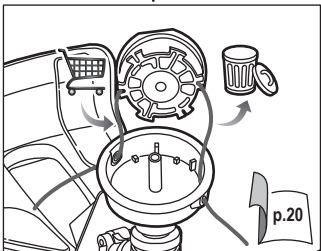
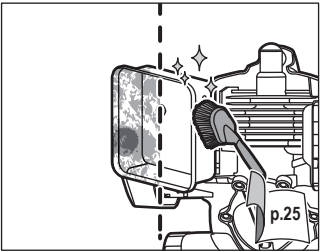
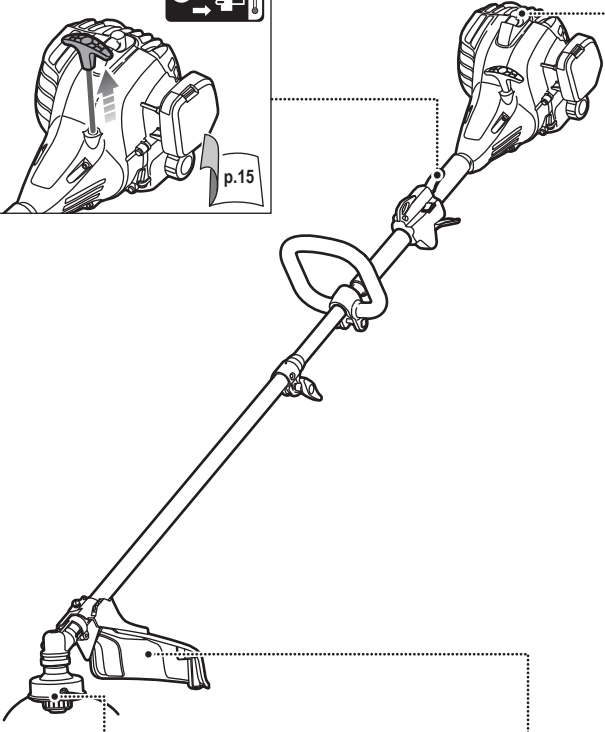
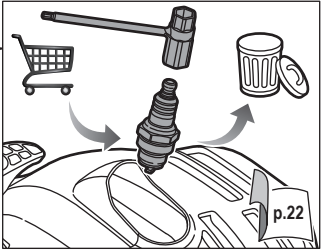
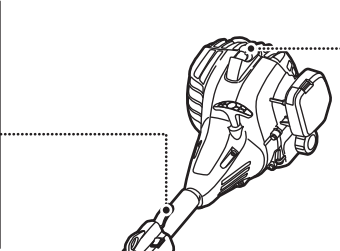
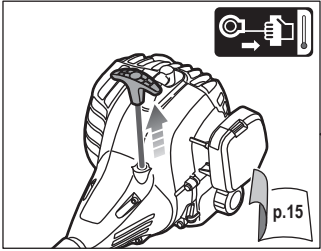
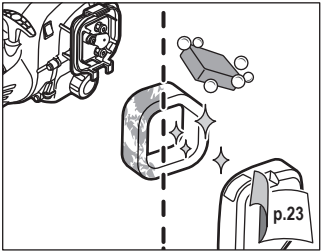
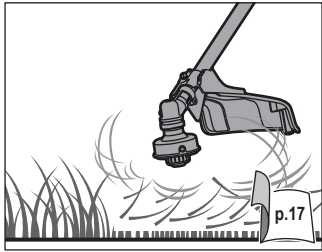
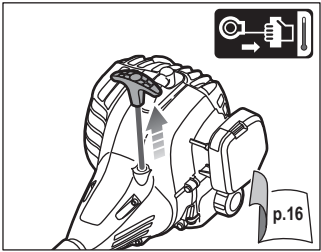

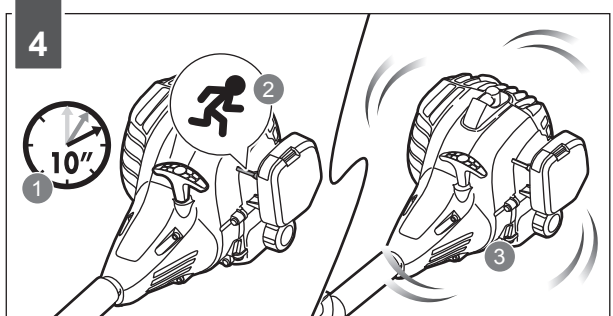
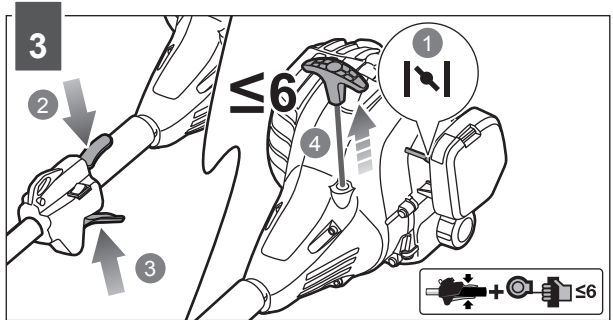
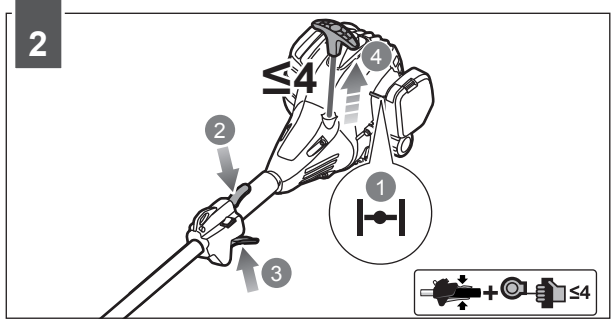
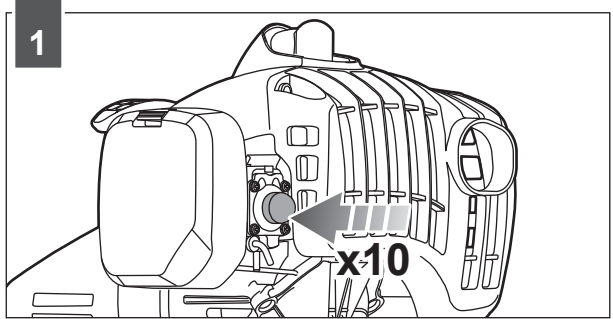
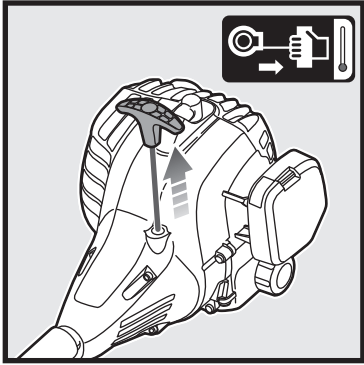

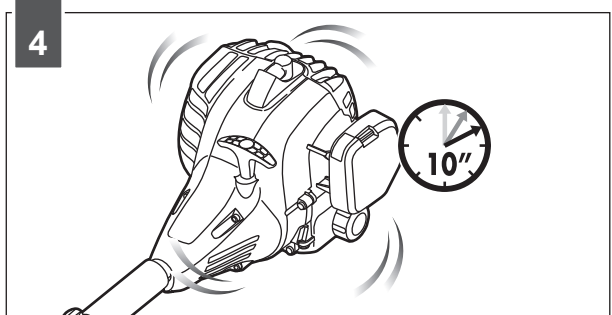
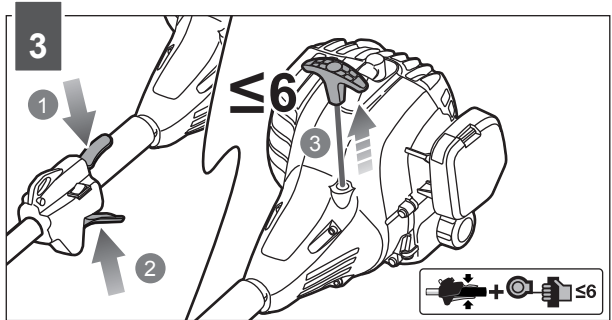
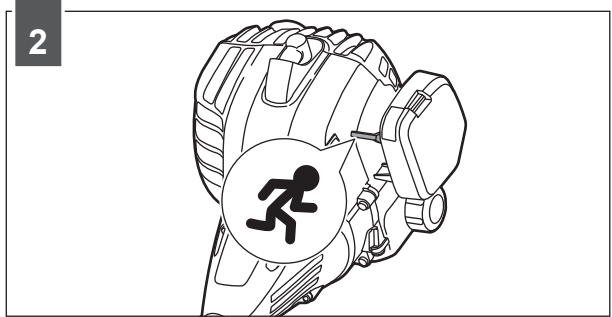
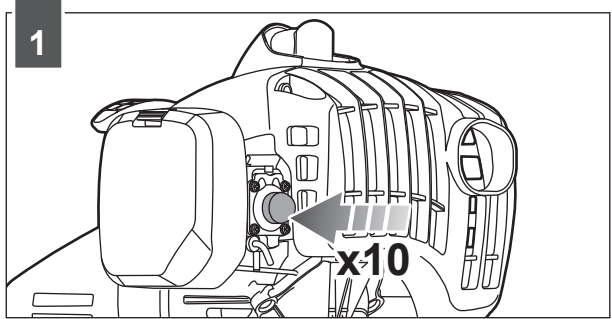
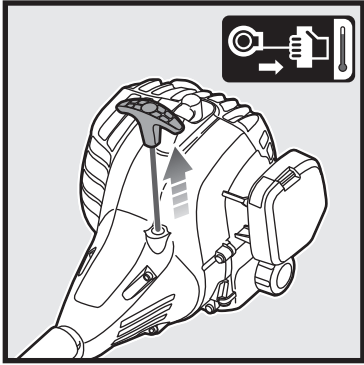



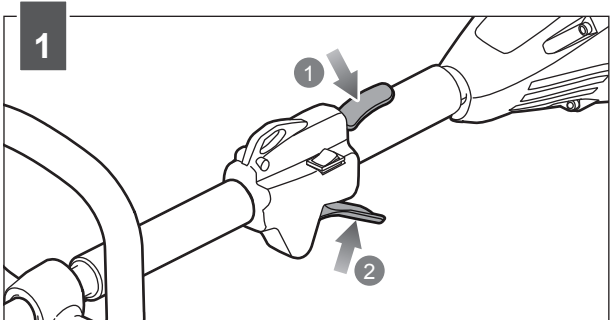
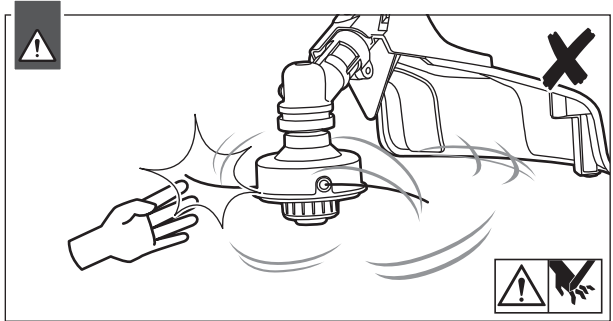
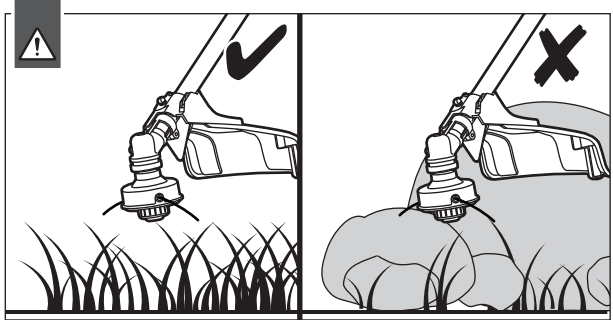
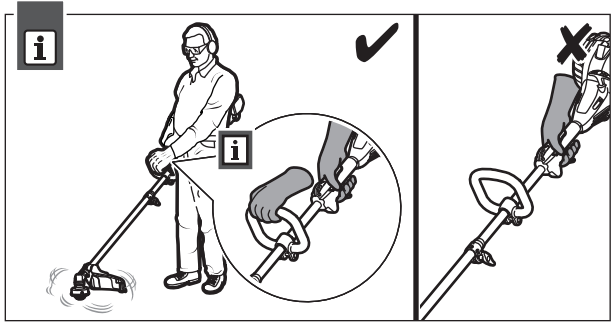
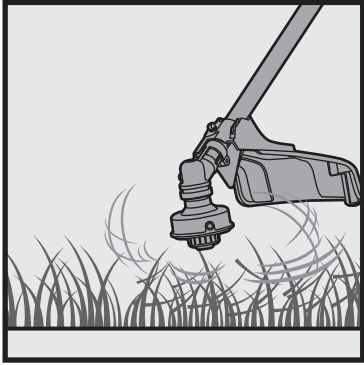

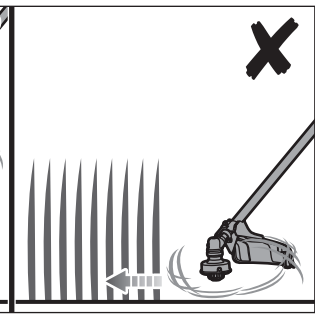
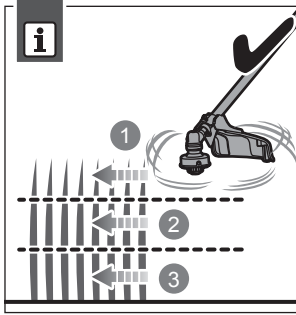
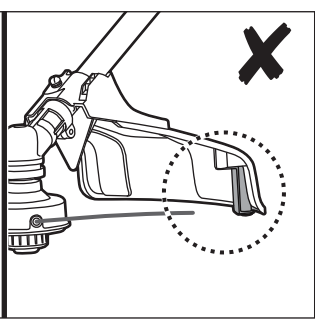
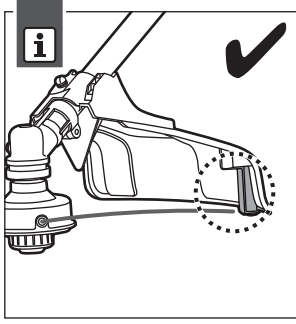
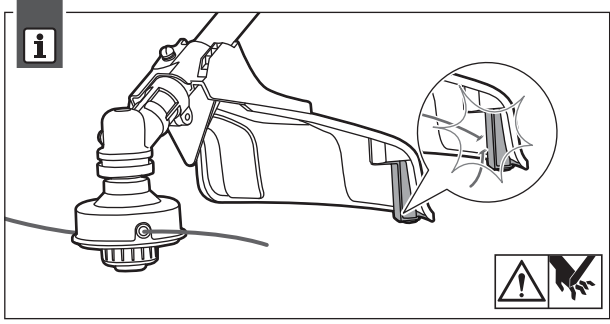
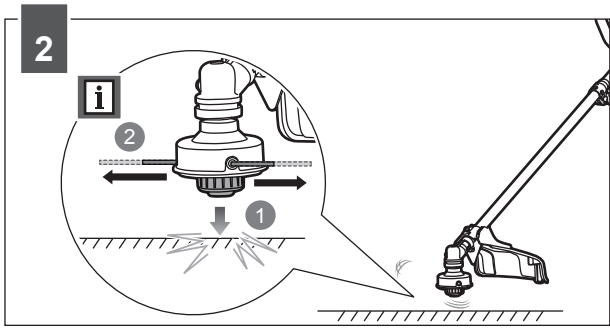

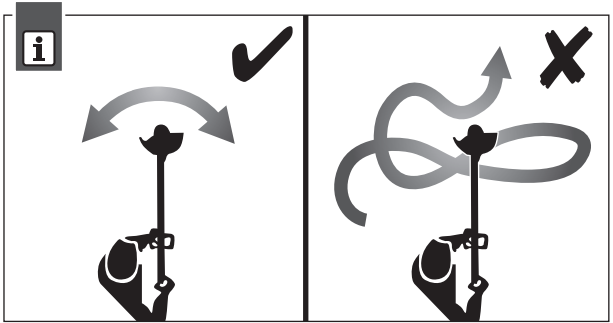

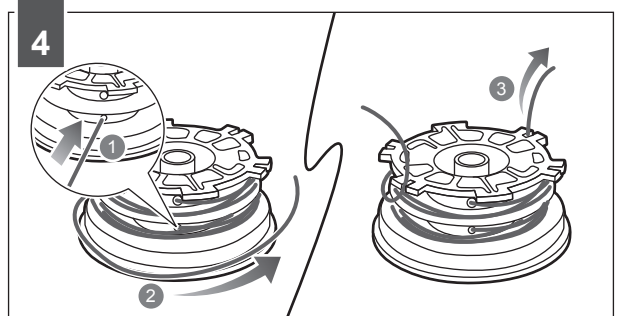
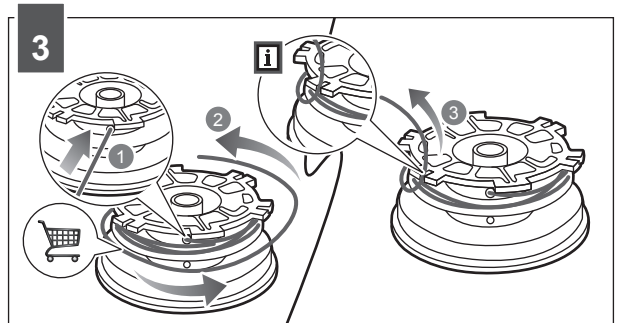
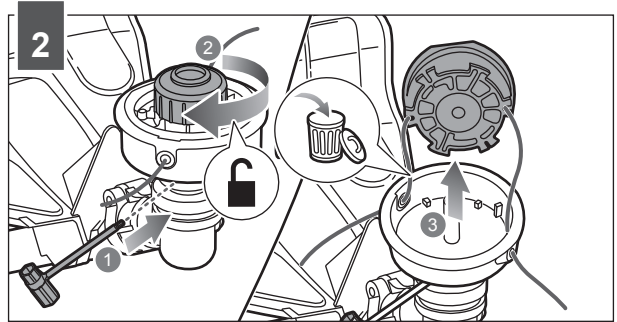
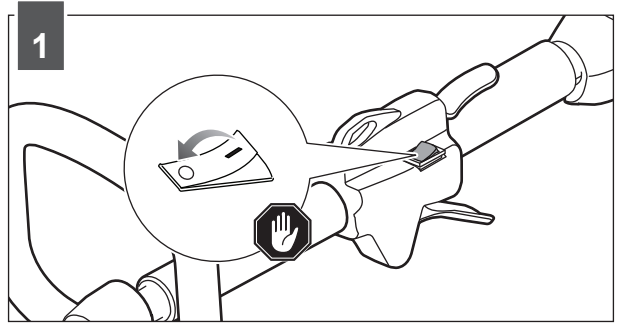
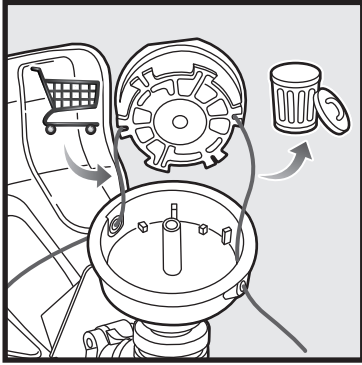

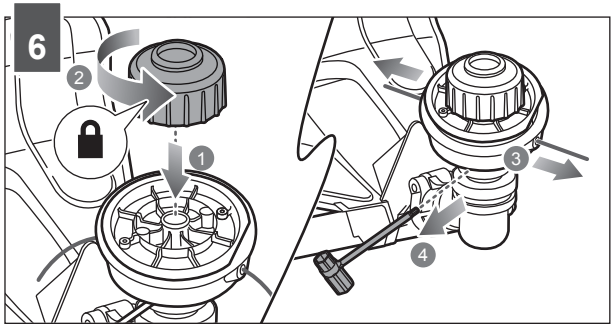
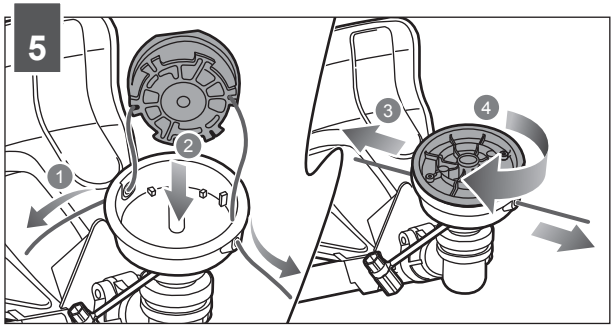

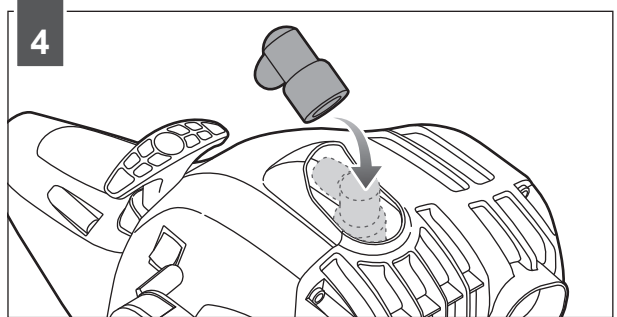
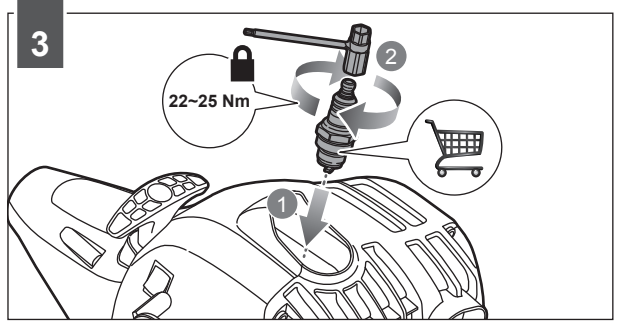
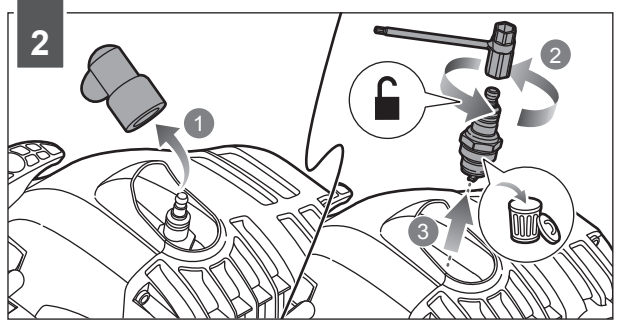
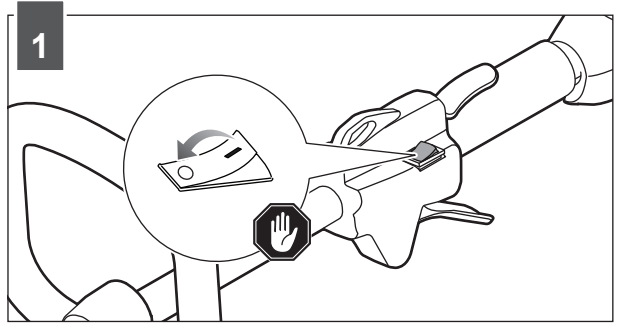
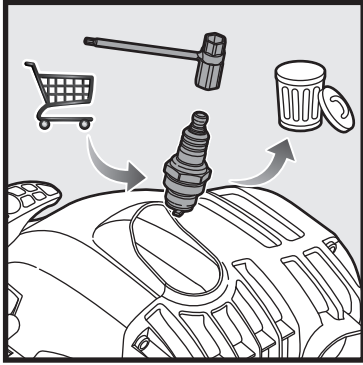

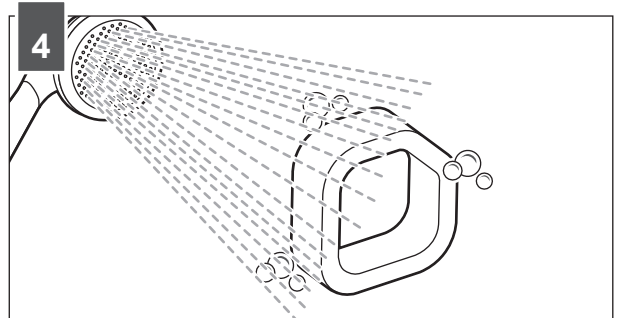
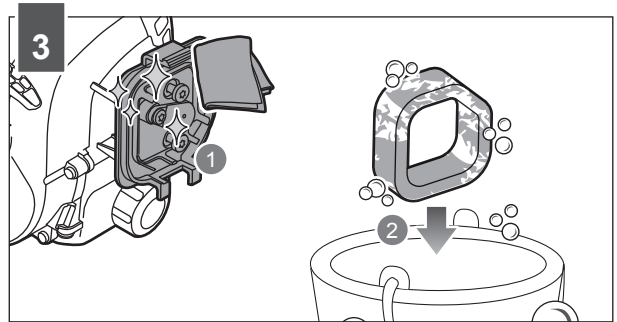
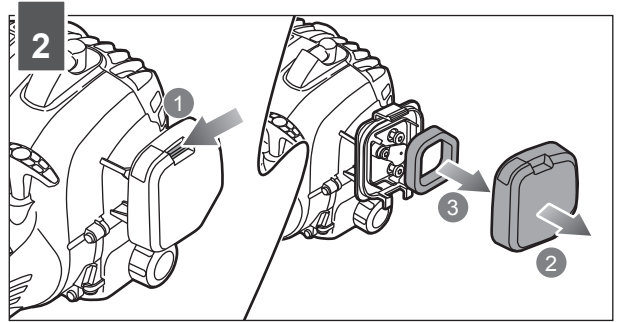
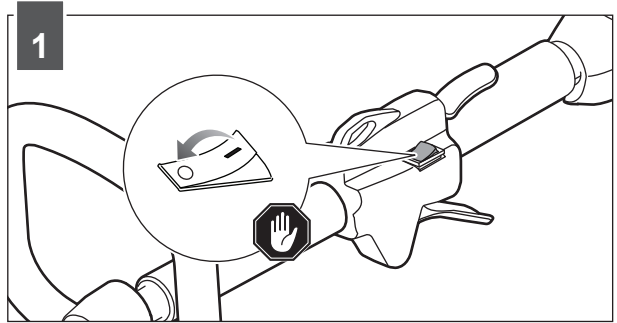
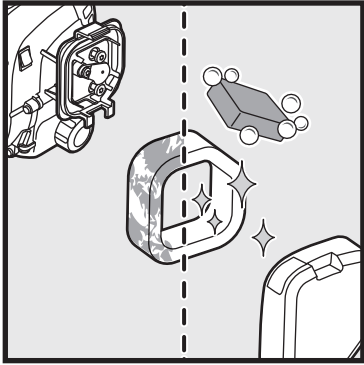

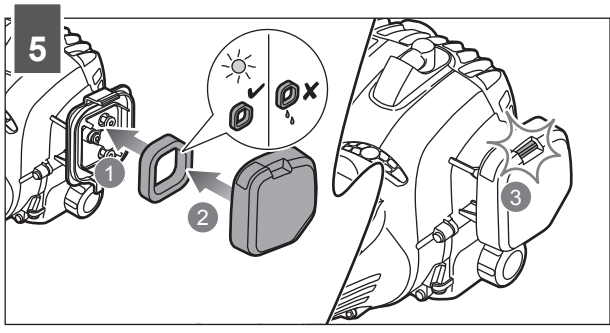



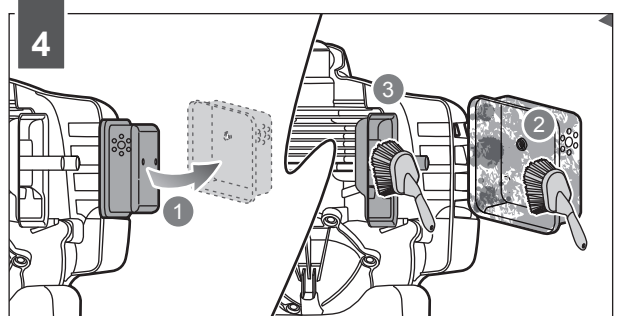
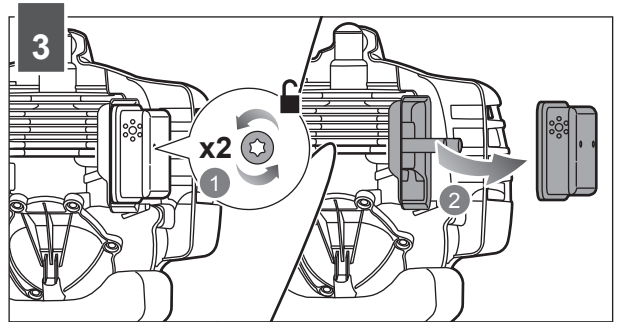
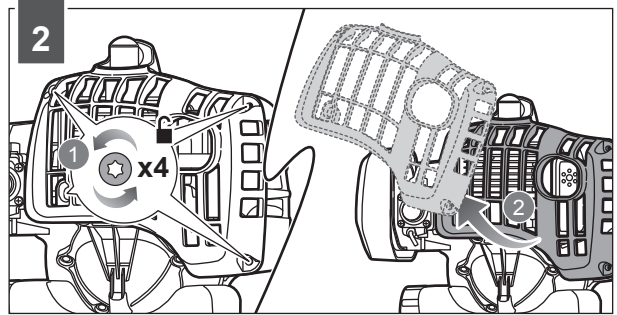
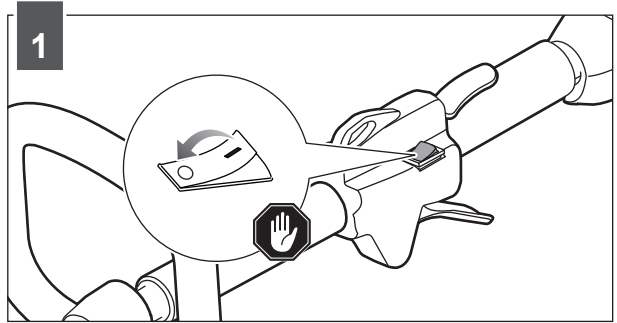
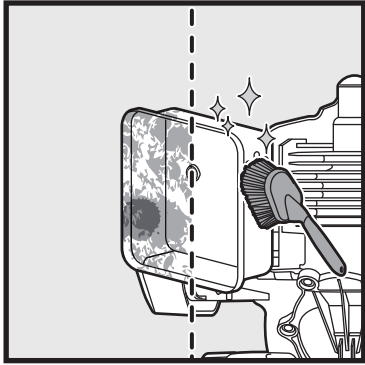

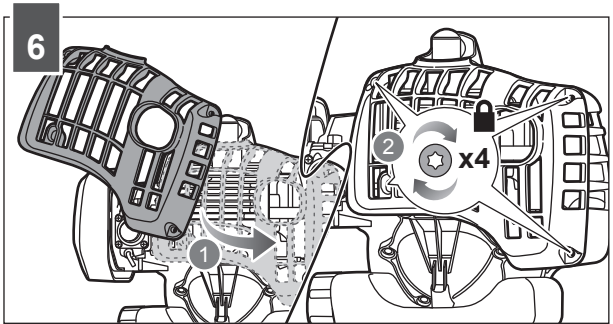
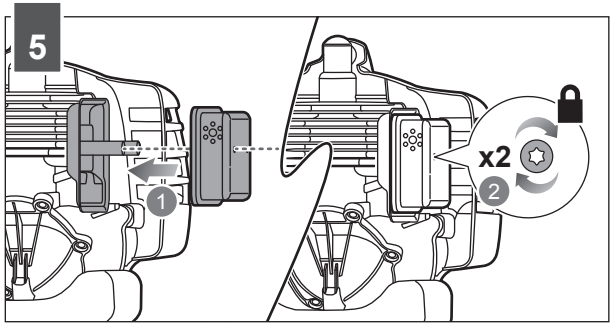

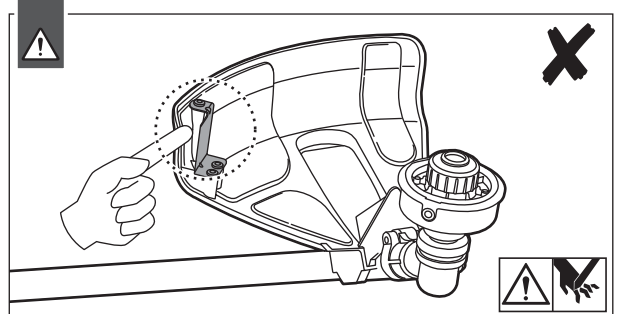
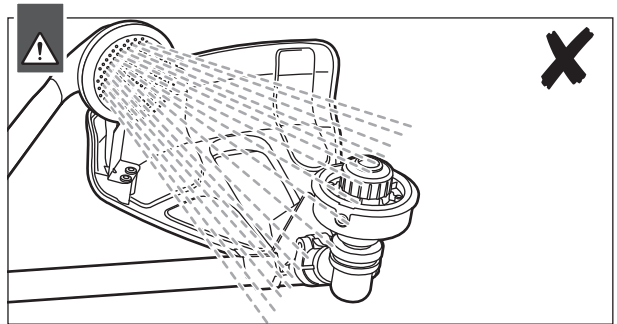
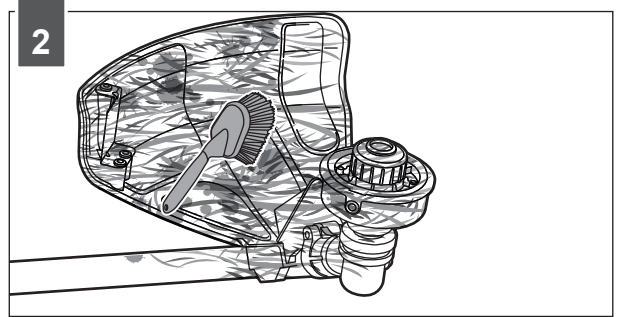
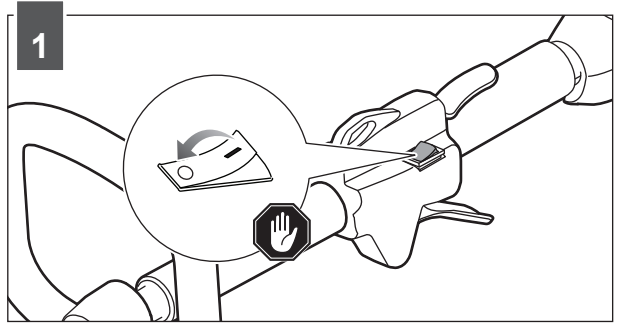
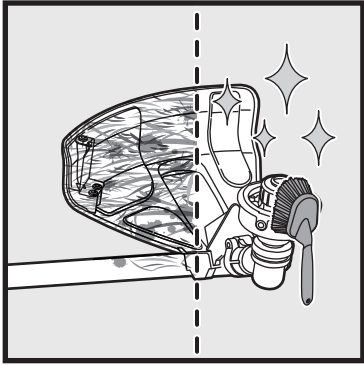

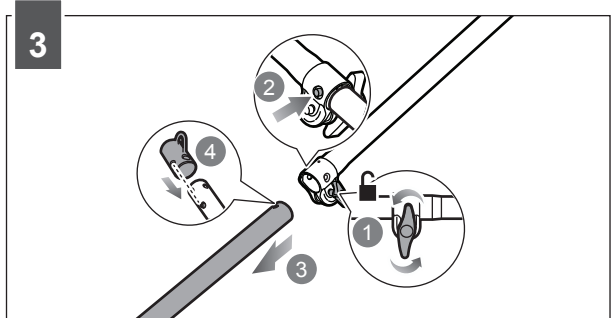
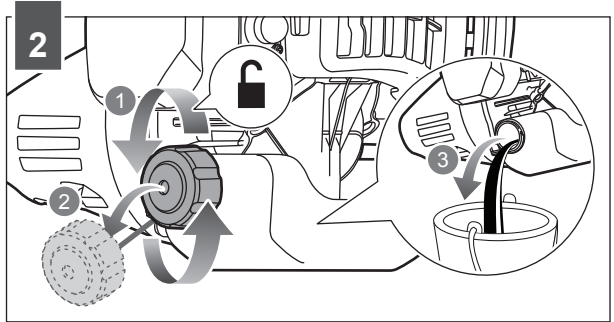
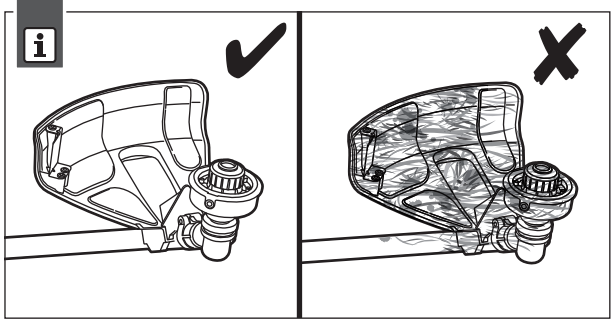
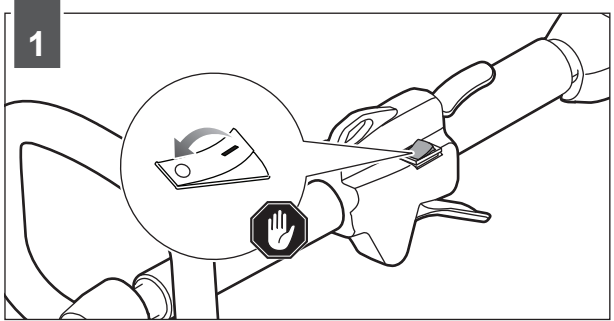
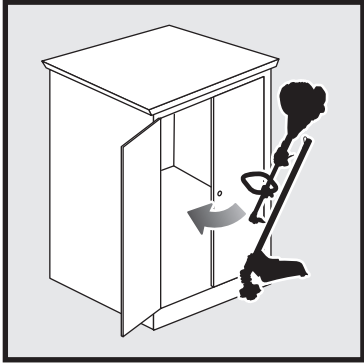

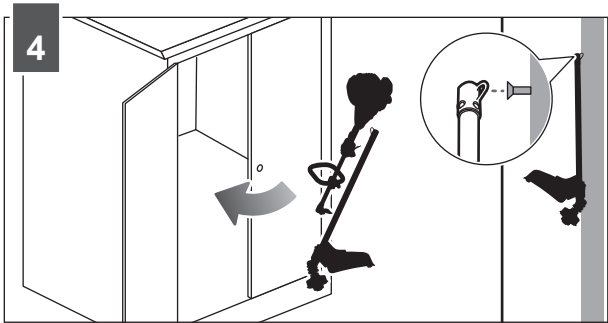

## MAINTENANCE SCHEDULE

	Every 25 hours	Before each use	After first month or 20 hours of operation	Every 3 months or 50 hours of operation	Every 6 months or 100 hours of operation	Every year or after 300 hours of operation
Check if fastener is fully tightened		■				
Check: Cutting attachment must not rotate in idle mode <sup>2</sup>		■				
Clean spark arrestor	■					
Replace spark arrestor						■
Clean air filter	■					
Change air filter						■
Check or adjust spark plug					■	
Replace spark plug						■
Clean fuel tank and filter <sup>1</sup>				■		
Check fuel hose		■				
Replace fuel filter <sup>1</sup>						■
Check all hose connections		■				
Inspect fuel tank vapor vent (if equipped)		■				
Clean the exhaust port and silencer	■					



<sup>1</sup> These items should only be carried out by an authorised service centre.

<sup>2</sup> If this requirement is not met, contact an authorised service centre for repair or adjustment.

### NOTES:

- Maintenance should be performed more frequently when product is used in dusty areas.
- When product has exceeded the maximum figures specified in the table, maintenance should still be cycled according to the intervals of time or hours stated herein.

## TROUBLESHOOTING

Problem	Possible cause	Solution
Engine will not start.	No spark.	The spark plug may be damaged. Remove it and check for dirt and cracks. Replace with a new spark plug.
	No fuel.	Push primer bulb until bulb is full of fuel. If bulb does not fill, primary fuel delivery system is blocked. Contact an authorised service centre. If primer bulb fills, engine may be flooded, proceed to next item.
	Engine is flooded.	<ul style="list-style-type: none"> <li>■ Turn the on/off switch to the "O" (Off) position.</li> <li>■ Completely remove the spark plug from the engine and spark plug boot, then turn the product so the spark plug hole is aimed at the ground.</li> <li>■ Set the choke lever to  position and pull starter cord 10-15 times. This will clear excessive fuel from the engine.</li> <li>■ Remove any expelled fuel from the product.</li> <li>■ Clean and reinstall the spark plug.</li> <li>■ Clean up any spilled fuel and move at least 9 m away before restarting.</li> <li>■ Pull starter handle 3 times with the choke lever at  position.</li> <li>■ If the engine does not start, set the choke lever to  choke position and repeat the normal starting procedure.</li> <li>■ If the engine still fails to start, repeat procedure with a new spark plug.</li> </ul>
	Starter rope now harder to pull than when new.	Contact an authorised service centre.
Engine starts but will not accelerate.	Engine requires approximately three minutes to warm up.	Allow engine to completely warm up. If engine does not accelerate after three minutes, contact an authorised service centre.
Engine starts but will only run at high speed at half choke.	Carburetor requires adjustment.	Contact an authorised service centre.
	Lubricant fuel mixture is incorrect.	Use fresh fuel and the correct 2-stroke lubricant mix.
Engine does not reach full speed and emits excessive smoke.	Air filter is dirty.	Clean air filter. Refer to Cleaning the Air Filter earlier in this manual.
	Spark arrestor screen is dirty.	Contact an authorised service centre.
Engine starts, runs, and accelerates but will not idle.	Idle speed screw on carburetor requires adjustment.	Contact an authorised service centre.
Bump head continues to rotate at idle speed.	Carburetor requires adjustment.	Contact an authorised service centre.

## PRODUCT SPECIFICATIONS

### Grass trimmer

Model HLT25SDSN

### Weight

- Without fuel, cutting attachment and harness 5.11 kg

- Without fuel and harness, with cutting attachment 5.30 kg

Fuel tank volume 250 cm<sup>3</sup> or (0.25 L)

Cutting swath 457 mm

Engine displacement 26 cm<sup>3</sup>/cc

Line diameter 2.0 mm

Maximum engine performance (in accordance with ISO 8893) 0.80 kW

Maximum rotational frequency of the spindle 10,000 min<sup>-1</sup>

Engine speed (rotational frequency) at idle 2, 800-3, 600 min<sup>-1</sup>

Fuel consumption (in accordance with ISO 8893) at max. engine performance 0.45 kg/h

Specific fuel consumption (in accordance with ISO 8893) at max. engine performance 0.56 kg/kW.h

### Vibration (in accordance with ISO 22867)

#### Front handle

- Idling (m/s<sup>2</sup>) 7.3

- Racing (m/s<sup>2</sup>) 8.3

- Equivalent (m/s<sup>2</sup>) 7.8

#### Rear handle

- Idling (m/s<sup>2</sup>) 4.0

- Racing (m/s<sup>2</sup>) 12.2

- Equivalent (m/s<sup>2</sup>) 9.1

Uncertainty 1.5

### Noise emission (in accordance with ISO 22868)

A-weight emission sound pressure level at the operator's position

- Idling dB (A) 76.5

- Racing dB (A) 96.9

- Equivalent dB (A) 93.9

A-weight emission sound power level

- Idling dB (A) 89.3

- Racing dB (A) 110.2

- Equivalent dB (A) 110.2

Uncertainty dB 2.5

## REPLACEMENT PART

Part	Accessory number	Part number
Spool retainer	N/A	308042003
String head with cutting line	N/A	308743015
Cutting line	N/A	900890003
Grass deflector	N/A	308743020











# Homelite®

Imported by:

**Techtronic Industries Australia Pty. Ltd.**  
31 Gilby Road, Mount Waverly, VIC 3149,  
Melbourne, Australia

**Techtronic Industries N.Z. Limited**  
2 Landing Drive, Mangere,  
Auckland, 2022 , New Zealand

960994092-01

