

2 PCS

HÄFELE

**SALICE 94° MINI HINGE**

Full Overlay - Slide On

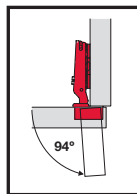

## Drilling Instructions

Hinge Cup (Door)

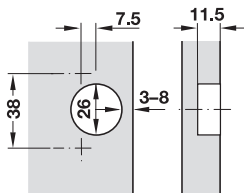

## Mounting Instructions

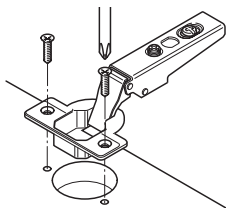

Mount Plate (Cabinet Side)

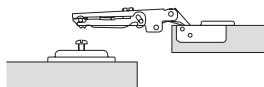
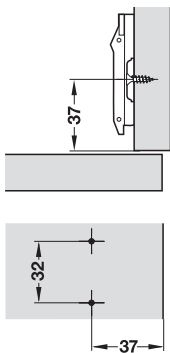

Place hinge on mounting plate. Positioning with pre-determined end stop.

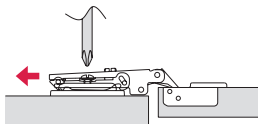

Apply light pressure.

## Adjusting the Door

### Depth adjustment of door with SALICE mounting plates.

It is possible to adjust the door up to +2.8 mm. The slot on the metal bottom plate allows the hinge to slide. Afterwards the screw must be re-tightened.

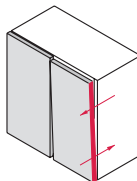
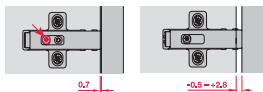

### Height adjustment of door with SALICE cruciform mounting plates with slot.

Height adjustment of door of  $\pm 2$  mm is possible by loosening the two fixing screws. The slots allow the mounting plates to slide in both directions. Afterwards the screws must be re-tightened.

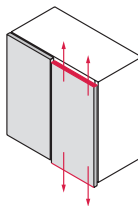
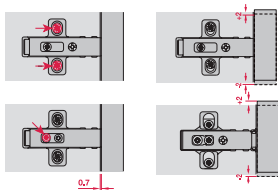

### Lateral adjustment of door with SALICE concealed hinges.

The adjusting screw produces the lateral travel of the hinge arm from  $-1.5$  mm up to  $+4.5$  mm. This value is reduced to  $-0.5$  mm when using profile door hinges and mini hinges. The door moves with respect to the furniture side without coming apart. There are no further correcting actions required.

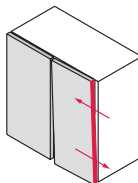
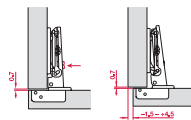

# HÄFELE

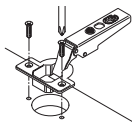
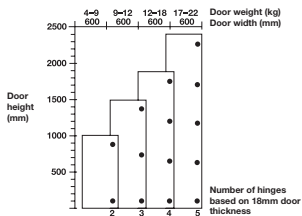

#### Screw fixing

Cup fixed with screws (countersunk head).

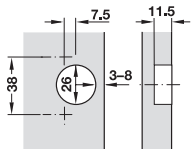

Salice Hinge Drilling Pattern

#### Tools Required:

- > 26mm Ø Drill Bit & Template Kit
- > 2mm Ø Drill Bit
- > Pencil
- > Power Drill
- > No 2 Pozidrive Screwdriver / Screw Bit

MADE IN ITALY



HÄFELE AUSTRALIA PTY. LTD  
ARTICLE # 483.02.424

8 MONTEREY RD DANDENONG VIC 3175  
730.83.652