

# AEG

## POWERTOOLS

**BSS18B3**

Original instructions

## **Important!**

It is essential that you read the instructions in this manual before assembling, operating and maintaining the product.

Subject to technical modifications.

1. Speed selector
2. LED light
3. Auto-load chuck
4. Direction of rotation selector
5. Variable speed switch trigger
6. Handle, insulated gripping surface
7. LED light button
8. Battery port
9. Belt clip bracket
10. Belt clip
11. Screw



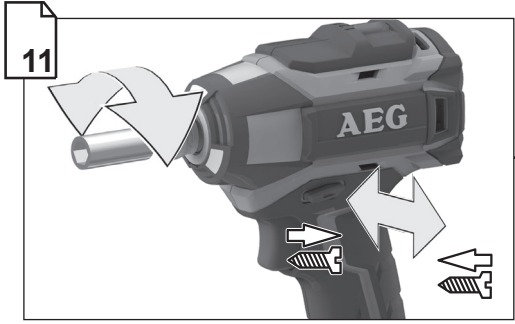

Remove the battery pack before starting any work on the machine.

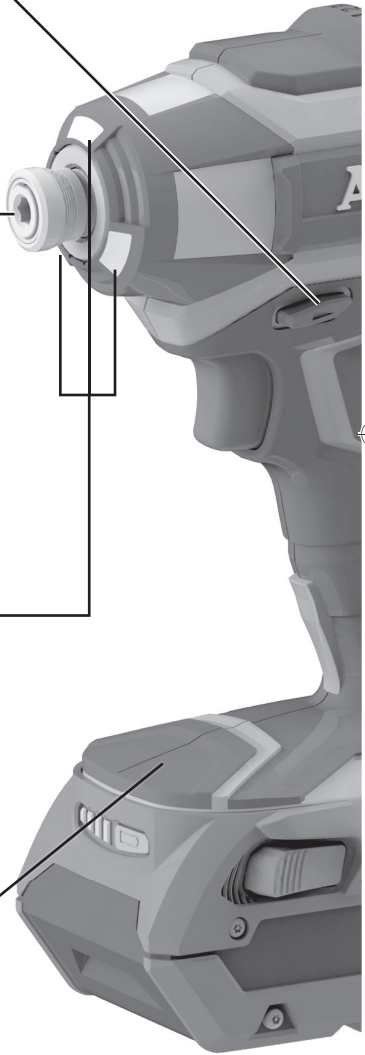
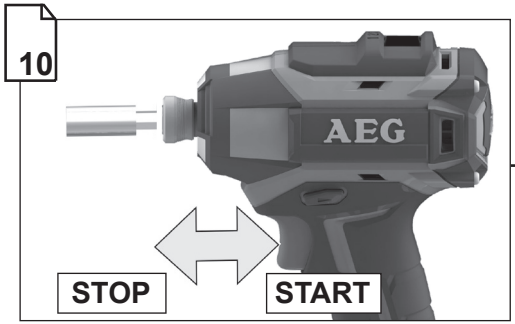
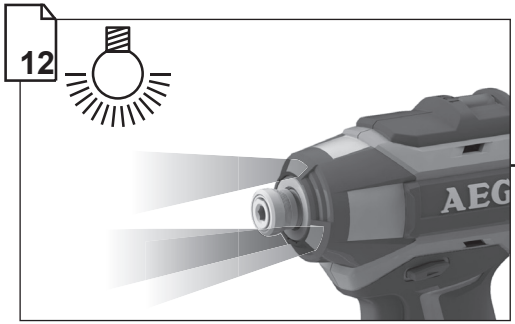
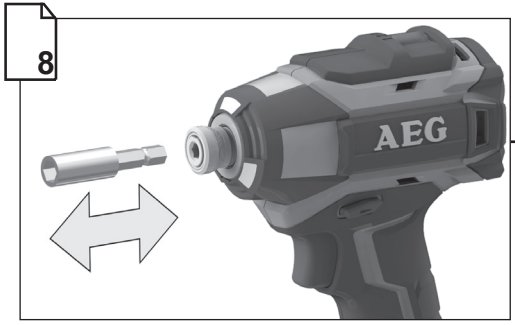

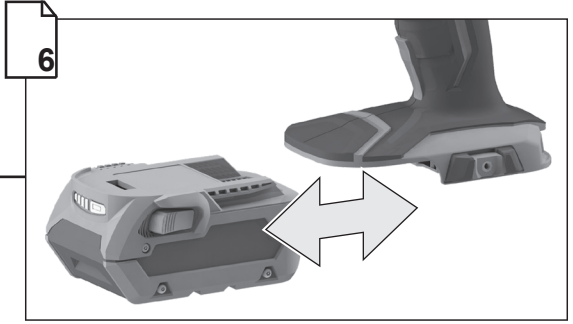
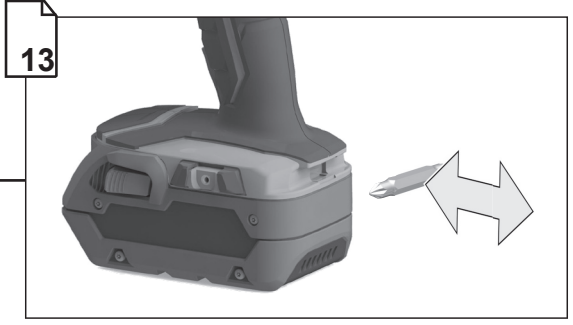
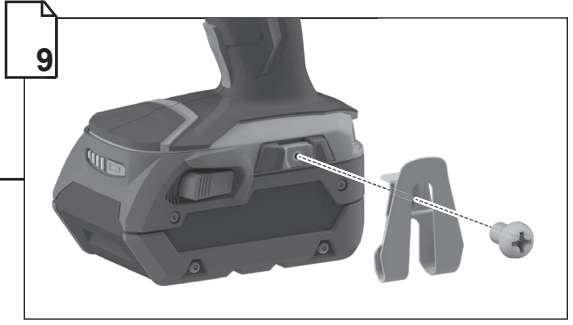
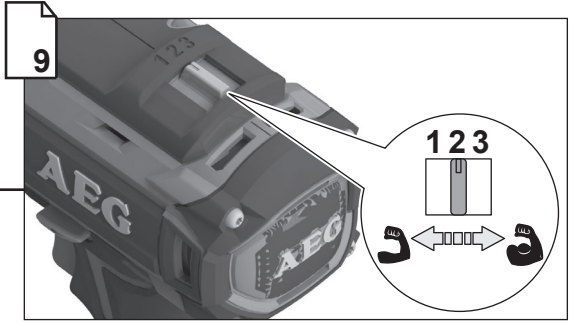
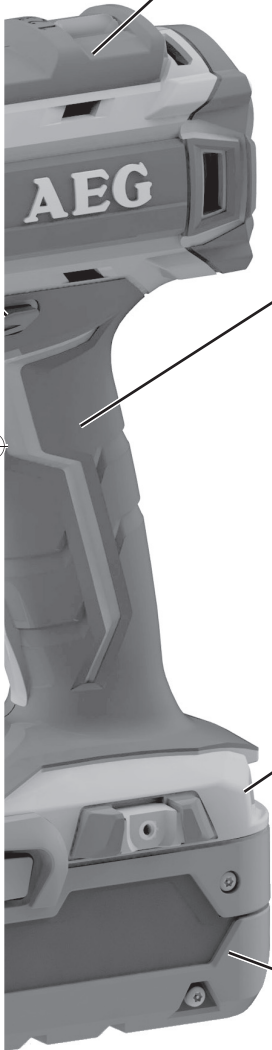

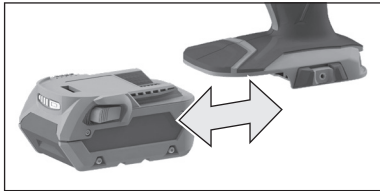

Remove the battery pack before starting any work on the machine.

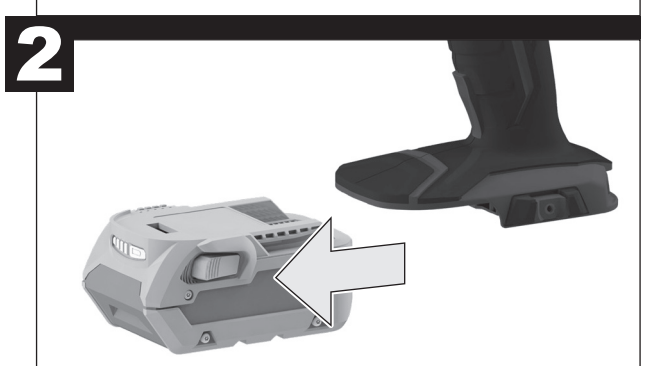
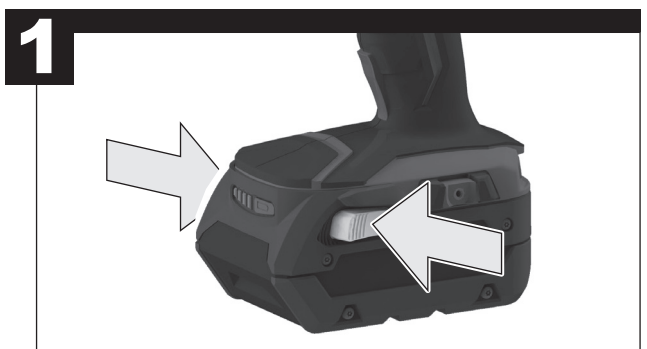
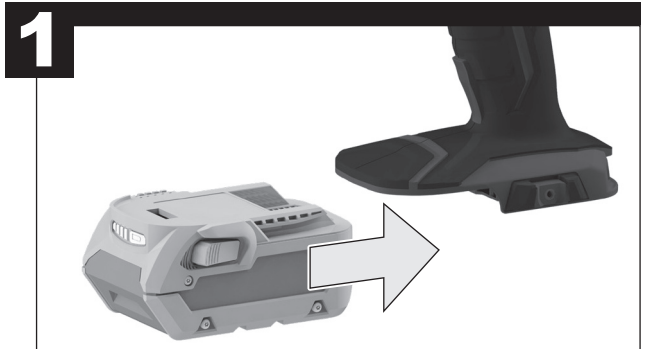

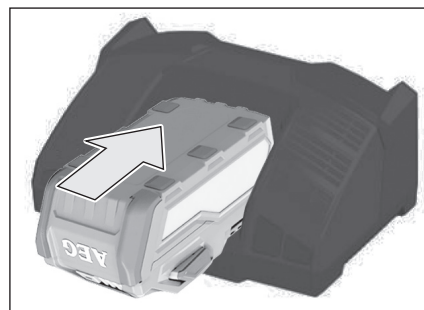
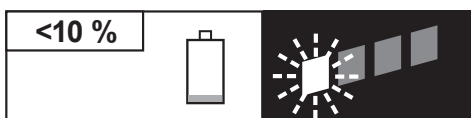
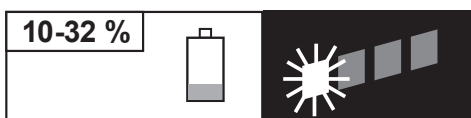
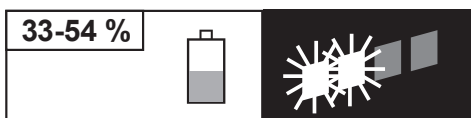
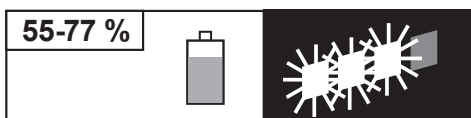
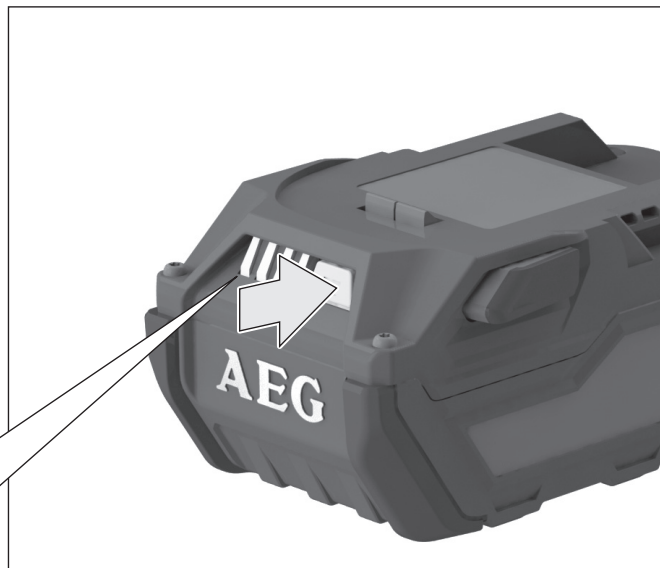

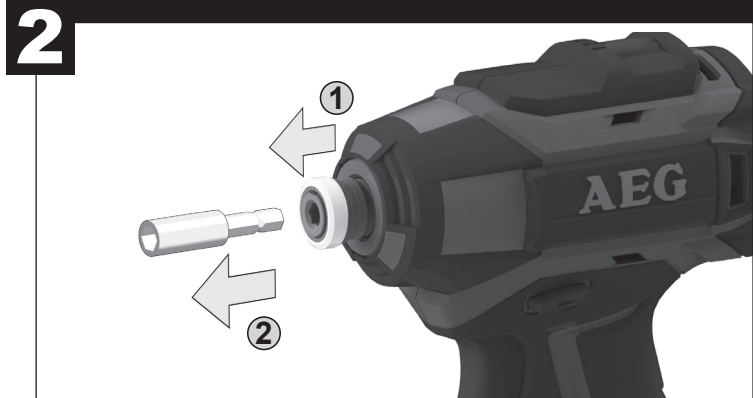
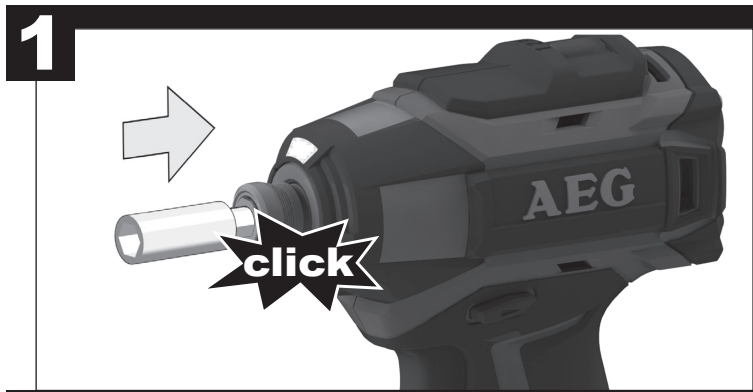
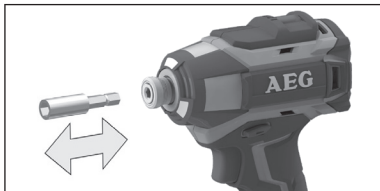



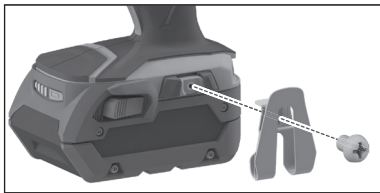
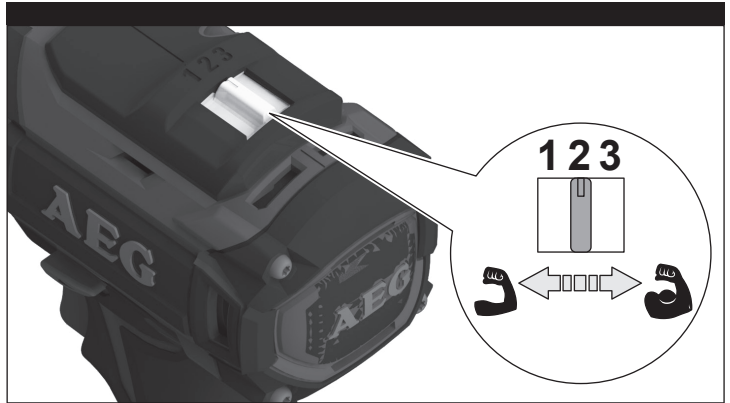
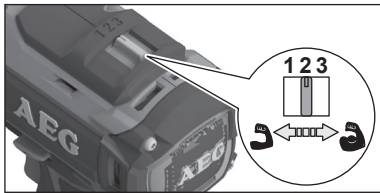

Remove the battery pack before starting any work on the machine.

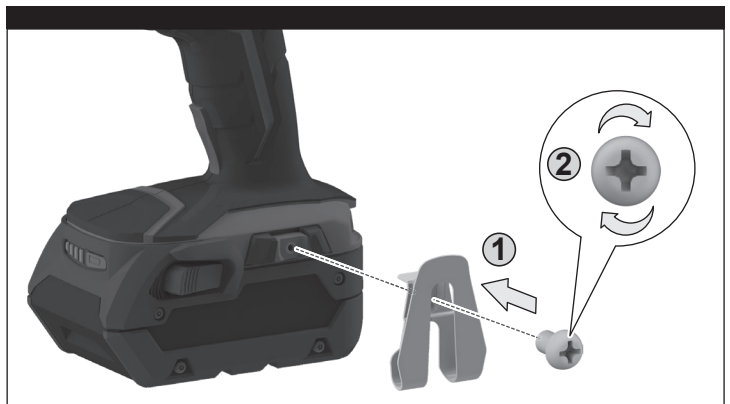

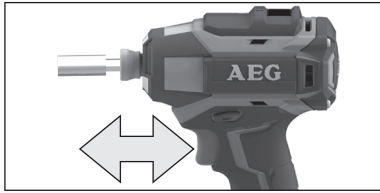

# START

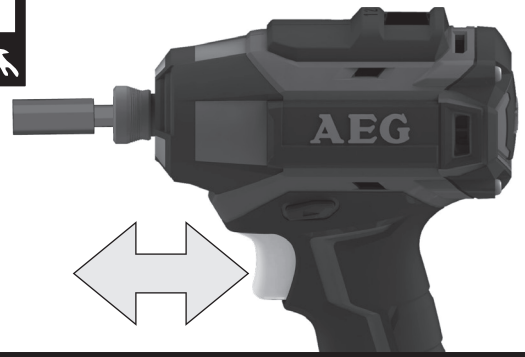

# STOP



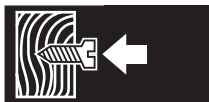
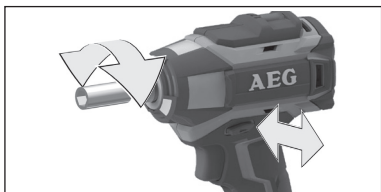

# LOCK

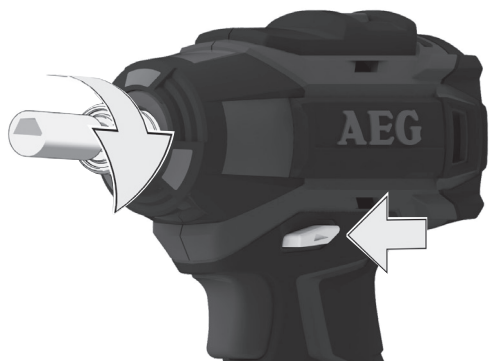

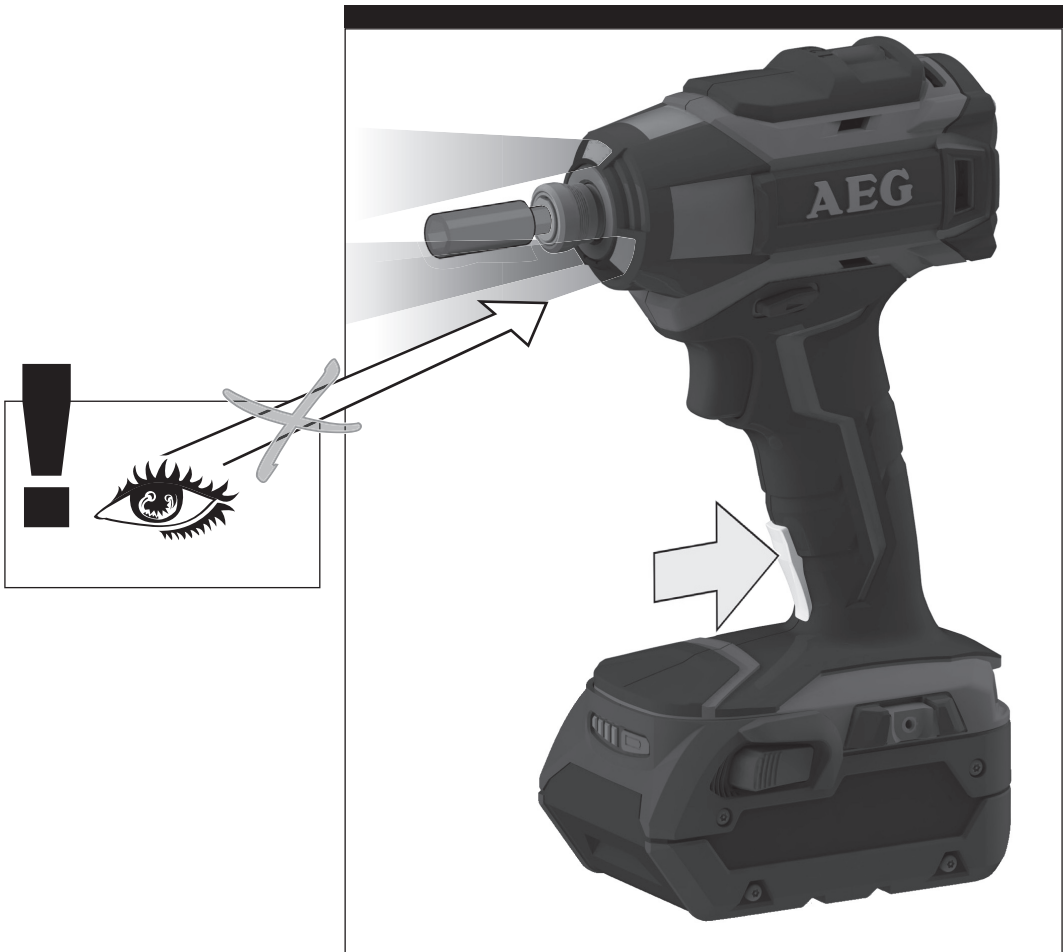
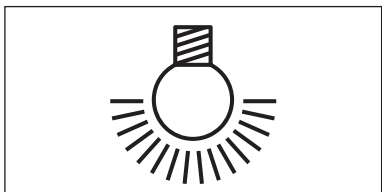



**1**



**2**



**TECHNICAL DATA****18V BRUSHLESS IMPACT DRIVER****BSS18B3**

Rated voltage .....	18 V
Tool reception .....	1/4" (6.35 mm)
No-load speed	
Speed 1 .....	0 - 750 min <sup>-1</sup>
Speed 2 .....	0 - 2000 min <sup>-1</sup>
Speed 3 .....	0 - 2750 min <sup>-1</sup>
Impact rate	
Speed 1 .....	0 - 850 min <sup>-1</sup>
Speed 2 .....	0 - 3000 min <sup>-1</sup>
Speed 3 .....	0 - 3700 min <sup>-1</sup>
Max torque .....	230 Nm
Max. diameter bolt / nut .....	M14
Recommended ambient operating temperature .....	-18...+50 °C
Weight - not including battery pack .....	1.14 kg
Measured values determined according to EN 60745.	
A-weighted sound pressure level .....	$L_p = 99$ dB(A)
Uncertainty K .....	3 dB
A-weighted sound power level .....	$L_W = 110.0$ dB(A)
Uncertainty K .....	3 dB
Wear ear protectors.	
The vibration total values (triaxial vector sum) determined according to EN 60745:	
Impact tightening of fasteners of the maximum capacity of the tool .....	$a_h = 19.1$ m/s <sup>2</sup>
Uncertainty K .....	1.5 m/s <sup>2</sup>

**⚠ WARNING**

The vibration emission level given in this information sheet has been measured in accordance with a standardised test given in EN 60745 and may be used to compare one tool with another. It may be used for a preliminary assessment of exposure. The declared vibration emission level represents the main applications of the tool. However if the tool is used for different applications, with different accessories or poorly maintained, the vibration emission may differ. This may significantly increase the exposure level over the total working period.

An estimation of the level of exposure to vibration should also take into account the times when the tool is switched off or when it is running but not actually doing the job. This may significantly reduce the exposure level over the total working period.

Identify additional safety measures to protect the operator from the effects of vibration such as: maintain the tool and the accessories, keep the hands warm, organisation of work patterns.

**BATTERY AND CHARGER**

Compatible battery pack (not included)		Compatible charger (not included)
L1815R	L1850R	AL18G
L1820R	L1860R	AL1218G
L1825R	L1860B	BL1218
L1830R	L1860R-X5	BLK1218
L1840R	L1890R	BL18DP-X5
		BL18DP2-X5

Use AEG 18V battery and charger only

**⚠ WARNING!** Read all safety warnings, instructions, illustrations and specifications provided with this power tool. Failure to follow all instructions listed below may result in electric shock, fire and/or serious injury. Save all warnings and instructions for future reference.

**IMPACT DRIVER SAFETY WARNINGS**

Hold the power tool by insulated gripping surfaces, when performing an operation where the fastener may contact hidden wiring. Fasteners contacting a "live" wire may make exposed metal parts of the power tool "live" and could give the operator an electric shock.

**Wear ear protectors.** Exposure to noise can cause hearing loss.

**Sawdust and splinters must not be removed while the machine is running.**

**When working in walls, ceiling, or floor, take care to avoid electric cables and gas or waterpipes.**

**Remove the battery pack before starting any work on the machine.**

**Do not dispose of used battery packs in the household refuse or by burning them.** AEG Distributors offer to retrieve old batteries to protect our environment.

**Do not store the battery pack together with metal objects (short circuit risk).**

**Use only System GBS chargers for charging System GBS battery packs.** Do not use battery packs from other systems.

**Battery acid may leak from damaged batteries under extreme load or extreme temperatures. In case of contact with battery acid wash it off immediately with soap and water.** In case of eye contact rinse thoroughly for at least 10 minutes and immediately seek medical attention.

**SPECIFIED CONDITIONS OF USE**

**The impact driver may be used to tighten and loosen nuts and bolts for independent use away from mains supply.**





**Do not use the product for any other purpose.**

## BATTERIES

Battery packs which have not been used for some time should be recharged before use.

Temperatures in excess of 50°C (122°F) reduce the performance of the battery pack. Avoid extended exposure to heat or sunshine (risk of overheating).

The contacts of chargers and battery packs must be kept clean.

For an optimum life-time, the battery packs have to be fully charged, after used.

To obtain the longest possible battery life remove the battery pack from the charger once it is fully charged.

### For battery pack storage longer than 30 days:

- Store the battery pack where the temperature is below 27°C and away from moisture.
- Store the battery packs in a 30% - 50% charged condition.
- Every six months of storage, charge the pack as normal.

## ADDITIONAL BATTERY SAFETY WARNINGS

**⚠ WARNING!** To reduce the risk of fire, personal injury, and product damage due to a short circuit, never immerse your tool, battery pack or charger in fluid or allow a fluid to flow inside them. Corrosive or conductive fluids, such as seawater, certain industrial chemicals, and bleach or bleach containing products, etc., can cause a short circuit.

## TRANSPORTING LITHIUM BATTERIES

Lithium-ion batteries are subject to the Dangerous Goods Legislation requirements.

Transportation of those batteries has to be done in accordance with local, national and international provisions and regulations.

- The user can transport the batteries by road without further requirements.
- Commercial transport of Lithium-Ion batteries by third parties is subject to Dangerous Goods regulations. Transport preparation and transport are exclusively to be carried out by appropriately trained persons and the process has to be accompanied by corresponding experts.

When transporting batteries:

- Ensure that battery contact terminals are protected and insulated to prevent short circuit.
- Ensure that battery pack is secured against movement within packaging.
- Do not transport batteries that are cracked or leak.

Check with forwarding company for further advice.

## BATTERY PACK PROTECTION

The battery pack has overload protection that protects it from being overloaded and helps to ensure long life. Under extreme stress the battery electronics switch off the machine automatically. To restart, switch the machine off and then on again. If the machine does not start up again, the battery pack may have discharged completely. In this case it must be recharged in the battery charger.

## THERMAL OVERLOAD PROTECTION

Overheated cells will reduce performance, run time and life. Overheating can occur from battery packs being exposed to very hot environments or from the tool they are powering being over-worked. The control electronics will automatically shut down the battery pack to protect the cells which in turn protects the electronics

and motor within the tool. The battery pack will automatically shut itself down again should the temperature condition remain high when the trigger is pulled again. The system will continue to shut the battery pack down until the temperature is returned to a safe operating level.

## CURRENT OVERLOAD PROTECTION

The control electronics will instantly shut down the battery pack when excessive current draw is detected - protecting both the battery cells and the motor of the tool. Releasing the trigger will reset the battery pack each time.

## INDIVIDUAL CELL MONITORING

The control electronics constantly check each individual cell and automatically adjust its charge and discharge requirements accordingly.

This system maximises individual cell life whilst ensuring that the battery pack is delivering peak performance to the tool at all times.

## MAINTENANCE

The ventilation slots of the machine must be kept clear at all times.

Use only AEG accessories and AEG spare parts. Should components need to be replaced which have not been described, please contact one of our AEG service agents (see our list of guarantee/service addresses).

If needed, an exploded view of the tool can be ordered. Please state the Article No. as well as the machine type printed on the label and order the drawing at your local service agents or directly at:

### Techtronic Industries Australia Pty Ltd

PO Box 1065  
Mount Waverley VIC 3149  
Tel. no. 1300 234 797  
Australia

### Techtronic Industries N.Z. Limited

PO Box 12-806  
Penrose AUCKLAND 1642  
Tel. no. 0800 234 797  
New Zealand

## SYMBOLS



Safety alert

V

Volts



Direct current

min<sup>-1</sup>

Revolutions or reciprocations per minute

$n_o$

No-load speed



Regulatory Compliance Mark (RCM). Product meets applicable regulatory requirements.



Please read the instructions carefully before starting the machine.



Do not dispose of electric tools together with household waste material. Electric tools and electronic equipment that have reached the end of their life must be collected separately and returned to an environmentally compatible recycling facility.



# AEG

## POWERTOOLS

[www.aegpowertools.com.au](http://www.aegpowertools.com.au)  
[www.aegpowertools.co.nz](http://www.aegpowertools.co.nz)

**Techtronic Industries Australia Pty Ltd**  
31 Gilby Road, Mount Waverley, VIC 3149  
Melbourne, Australia

**Techtronic Industries N.Z. Limited**  
2 Landing Drive, Mangere  
Auckland, 2022, New Zealand

961004193-01A