



DÉCOFIRE

– Milano Series **FIRE TABLES** –

Assembly, Safety & Operating Instructions



Milano 500
Fire Column
DF102040



Milano 880
Fire Table
DF102041



Milano 1220
Fire Table
DF102042

Gas Cylinder and Gas not included - Sold Separately.
Tools required for assembly: Phillips screwdriver



WARNING

Read instructions carefully. If the information in this instruction manual is not followed exactly, a fire or explosion may result causing property damage, personal injury or loss of life.

Keep instructions in a safe place for future reference.

If you are assembling this unit for someone else, give this manual to them to read.



WARNING

DO NOT SPRAY AEROSOLS IN THE VICINITY OF THIS APPLIANCE WHILE IT IS IN OPERATION.

DO NOT USE OR STORE FLAMMABLE MATERIALS NEAR THIS APPLIANCE.

DO NOT PLACE ARTICLES ON OR AGAINST THIS APPLIANCE.



FOR OUTDOOR USE ONLY

THIS APPLIANCE IS DESIGNED AND APPROVED FOR OUTDOOR USE ONLY

DO NOT USE THIS APPLIANCE INDOORS OR IN AN UNVENTILATED AREA.



DANGER

If you smell gas:

1. Shut off gas to the appliance.
2. Extinguish any open flame or ignition source
3. If odour continues, keep away from the appliance and immediately call your local fire department



DANGER - CARBON MONOXIDE HAZARD

This appliance can produce carbon monoxide, which has no odour. Using it in an enclosed space can kill you. Never use this appliance in an enclosed space such as a tent, home, basement or camper. Do not bring this appliance indoors.



Specifications & Dimensions

Décofire Milano Series Fire Tables

Specifications	Fire Column DF102040	Fire Table DF102041	Fire Table DF102042
Model	500	880	1220
Gas type	LPG - ONLY	LPG - ONLY	LPG - ONLY
Gas consumption	24 MJ/Hr	36 MJ/Hr	52 MJ/Hr
Operating pressure	2.75kPa	2.75kPa	2.75kPa
Injector size	1.38 mm	1.68 mm	2.09 mm
Certified by the AGA	AGA 8714 G	AGA 8714 G	AGA 8714 G

Milano 500

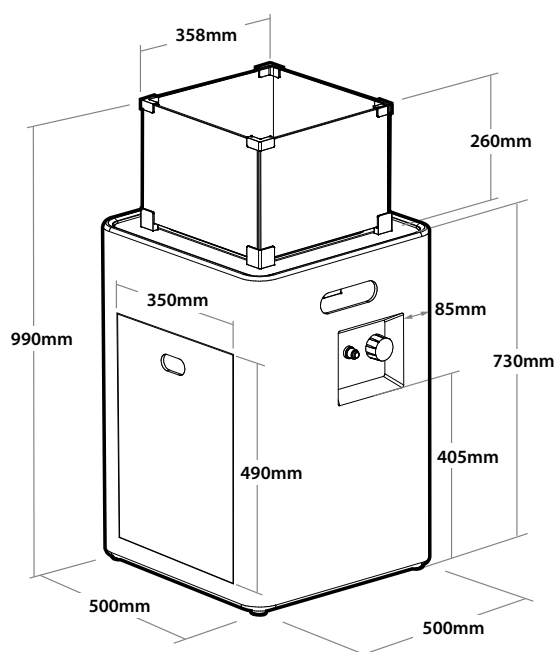

Milano 880

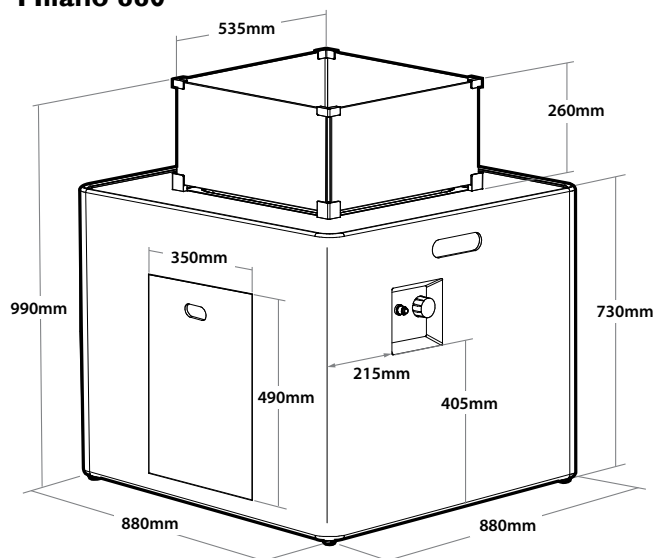

Milano 1220

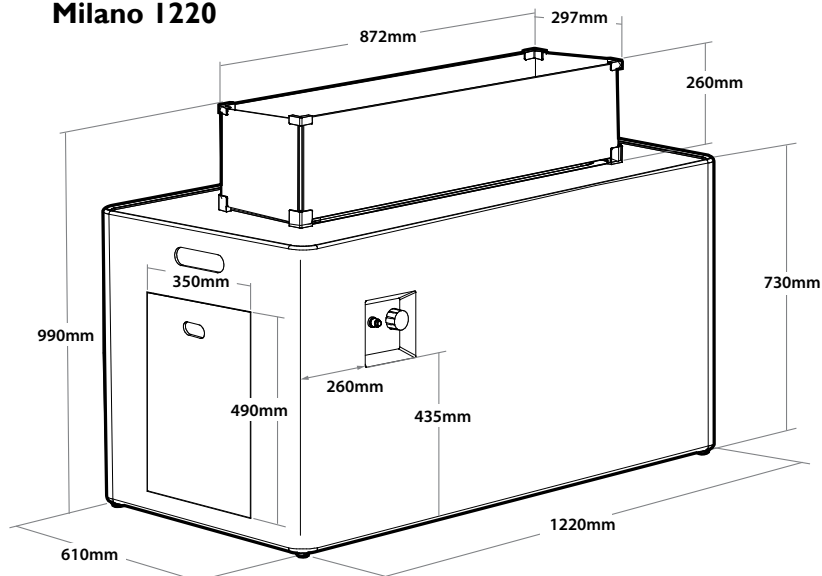



IMPORTANT SAFETY WARNINGS

- THIS APPLIANCE IS DESIGNED AND INTENDED FOR OUTDOOR USE ONLY!
- This appliance shall be used outdoors, in a ventilated space and shall not be used in any enclosed area.
- This appliance shall not be installed or used indoors, inside buildings, sheds or garages or any other enclosed area.
- DO NOT SPRAY AEROSOLS IN THE VICINITY OF THIS APPLIANCE WHILE IT IS IN OPERATION.
- DO NOT place, use or store any flammable liquid or gas fuels or fuel containers within the vicinity of this appliance and always ensure that any fuel containers or cylinders nearby are sealed or shut off to prevent escaping vapour.
- This appliance is designed and approved for use with LPG / Propane Gas Only. Cylinder size 480mm Height x 310mm Diameter. Type: 9KG / 8.5KG Fill Capacity. (Cylinder and gas sold separately)
- An LP Gas Cylinder not connected for use shall not be stored in the vicinity of this or any other appliance.
- This appliance is NOT approved for use with Natural Gas. Do Not attempt to convert this appliance to Natural Gas. Converting this appliance to Natural Gas is dangerous. Unauthorised conversion of this appliance will void the manufacturer's warranty.
- DO NOT PLACE ARTICLES ON OR AGAINST THIS APPLIANCE.
- NEVER dry clothes or flammable items over, on or immediately near this appliance.
- Children & adults must be alerted to the hazards of high surface temperatures and risk of burns and igniting of clothing.
- Children should be carefully supervised when they are in the area of the appliance.
- DO NOT operate this appliance unless it is fully assembled.
- This appliance should be inspected and serviced at least every 2 years by a qualified service technician.
- It is important that all control compartments, burners and circulating air passages of the appliance be kept clean for continued safe operation.
- Only use the regulator and hose assembly provided with this appliance. Use only genuine replacement parts. All replacement parts used must be of the same specification as originally supplied with this appliance.
- DO NOT USE AN UNLINED MASONRY CHIMNEY AS THE FLUE FOR THIS APPLIANCE
- DO NOT MODIFY THIS APPLIANCE

GENERAL SAFETY WARNINGS

- Ensure this appliance is placed on a firm, level surface.
- Do Not use the appliance if it has been exposed to rain or water. Always allow appliance to dry before operating.
- Check the weather forecast before using this appliance. Don't use your appliance during high winds. Avoid installing or operating this appliance, where a direct draft may affect or fan the flames.
- Make sure that the fire is completely extinguished before you leave this appliance unattended.
- Do not disassemble this appliance in any manner other than as described within these instructions.
- Installation clearance requirements must be adhered to. Please read the section on installation clearances before installing or placing this appliance.
- Do not cover or surround this appliance with insulating materials.
- The installation of this appliance must adhere to local codes or AS/NZS: 5601
- Never remove or reinstall a gas cylinder from this appliance while it is in use - always turn off all valves and controls before changing over the gas supply cylinder.
- Never use a naked flame to check for gas leaks.
- Discontinue use if any part of the gas cylinder is damaged. Rust and dents may be hazardous and should be inspected by a gas supplier or cylinder inspection station.
- Do not paint any part of this appliance - other than using the touch up pen supplied.
- Never leave this appliance unattended while in use.
- Keep a safe distance to avoid burning skin or clothing. Do not sit on or rest hands or feet on this appliance.
- If the flame goes out while burning, turn the gas valve off. Wait 5 minutes before repeating the initial lighting procedure. Once you have a flame started, hold down the control knob for 1 minute.
- Do not spray appliance with water when it is operating. Do not operate appliance if any part has been submerged in water.
- Do not disconnect any part of this appliance while it is in use.
- If this appliance is being stored indoors, detach the gas cylinder and store in a safe place - ensure all gas valves and controls are turned to the off position.
- Do not install or operate this on a boat or vehicle.
- Always remove any protective cover (polyester, vinyl or other type of cover). Do not set the protective cover over the appliance until it is turned off and completely cooled down.
- Always check for leaks if the appliance has not been used for an extended period.
- Inspect the gas hose and all connections to the gas cylinder prior to each use.
- In case of high winds, you may be required to secure this appliance to the ground to prevent the unit falling over.

OPERATING SAFETY WARNINGS

- Always follow lighting instructions carefully.
- This appliance is not intended for cooking.
- Appliance may be hot while in use, do not attempt to move it while in use.
- Always observe any local or state fire warnings.
- Do Not use gasoline, petrol, ethanol, alcohol, turpentine, kerosene, lighter fluids or any other liquid fuels in conjunction with this appliance. This is dangerous and may result in an explosion.
- While this appliance is operating or hot, do not touch the main heating surface or immediate surroundings as these areas may be hot and could cause burns.
- Do not use this appliance for any purpose other than its intended use.
- To prevent accidental fire and / or smoke damage, remove all packaging before lighting or operating this appliance.
- Do not heat any unopened plastic, glass or metal containers on or in this appliance. Pressure may build up and cause the container to burst, resulting in serious personal injury or death, property damage or damage to this appliance.
- Never move this appliance when it is operating or hot.
- Do not use this appliance while under the influence of alcohol, prescription or non-prescription drugs or any substance that may impair sound judgment.
- Avoid wearing loose clothing while operating this appliance.

CHILD & PET SAFETY WARNINGS

- Never let children operate this appliance without close supervision. Children must be supervised while near this unit.
- Never leave this appliance unattended while in use. Monitor any child or pet activities around this appliance at all times.
- Gas appliances contain hot working surfaces that, if touched, may cause skin burns or scalding.
- Never leave children or pets unattended in the vicinity of where this appliance is being used.
- Do not store items of interest to children on, around or below this appliance. Children climbing on this appliance, to reach items, could damage this appliance or be burned or seriously injured.
- Never allow children to sit or stand on any part of this appliance.
- We recommend the use of a fire screen or guard to prevent children or pets from coming into direct contact with the surfaces of this appliance while it is in use or hot.

MAINTENANCE & REPAIR SAFETY WARNINGS

- This appliance must be cleaned, maintained and serviced in accordance with the instructions and recommended service intervals supplied in this instruction manual. Any repairs should be undertaken by a qualified service technician.
- This appliance is designed for Domestic Consumer Use. Use of this appliance in a commercial application may require a more frequent schedule of service, maintenance or parts replacement.
- Always check this appliance prior to each use - do not use this appliance if there is a fault.
- Unless specifically recommended in this manual, do not attempt to repair or replace any part of the appliance yourself.
- Only use genuine replacement parts.
- Do not operate the product if it has been dropped or damaged in any manner. Call our customer service number for information on examination or mechanical repair or adjustment of this product.
- Any guard or other protective device removed for servicing the appliance shall be replaced prior to operating the appliance.
- It is imperative that the control compartment, burners and circulating airways of the appliance are kept clean.

IN THE EVENT OF ACCIDENTAL FIRE

- In the event of an accidental fire, if safe to do so, immediately turn this appliance off at the main control and then shut off the cylinder control valve.
- For emergency purposes, we recommend the installation of an approved fire extinguisher in the vicinity of where this appliance is installed.

UNPACKING YOUR APPLIANCE

- Due to the weight - this product may require two people to lift the components from the carton.
- Place a sheet or blanket on the ground to protect the surfaces of this appliance when unpacking and handling.
- Carefully remove all components from the carton and remove all packaging materials from the product prior to first use.
- Before beginning assembly of product, make sure all parts are present. Compare parts with components and hardware contents list. If any part appears to be missing or damaged, don't use this product and call customer service immediately.

CHOOSING A LOCATION FOR YOUR FIRE TABLE

This appliance is designed for outdoor use only

We recommend choosing a location that is protected from the elements, while at the same time complying with the requirements of the 'minimum clearances to combustibles' and 'installation guide' below.

- Avoid placing the appliance where it will be exposed to strong breezes.
- Avoid placing the appliance where it will be exposed to harsh weather conditions, such as rain or hail.
- This appliance can be used in most outdoor environments but must never be permanently left in an unprotected or exposed area when not in use.
- When not in use, this appliance should be stored in a dry, protected area - such as under an awning or pergola - with its protective cover fitted.



MINIMUM CLEARANCES TO COMBUSTIBLES



WHEN CERTAIN MATERIALS OR ITEMS ARE STORED ABOVE, BESIDE OR UNDER THIS APPLIANCE WHILE IN USE, THEY MAY BE SUBJECT TO RADIANT HEAT AND COULD BE SERIOUSLY DAMAGED.

Minimum Clearances To Combustibles

Combustible materials are materials such as wood, paper plant fibers some plastics. e.g. any material that is capable of being ignited.

Above this appliance:

Minimum of 1800mm to combustible materials.

NOTE: DO NOT use this appliance under any awning or pergola if there is a risk of the structure or materials igniting or being damaged by the heat.

Around this appliance:

Minimum of 1200mm to combustible materials.

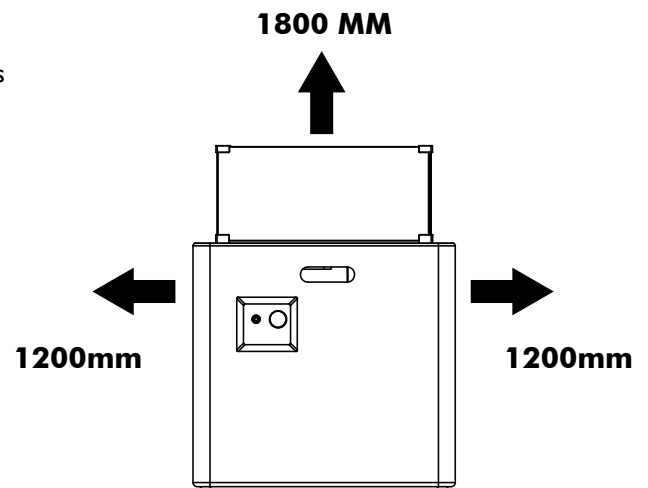

INSTALLATION GUIDELINE

Only use this appliance in an above ground, open-air situation with natural ventilation, without stagnant areas, where gas leakage and products of combustion are rapidly dispersed by wind and natural convection. Any enclosure in which the appliance is used must comply with one of the following:

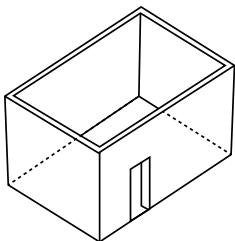

1. An enclosure with walls on all sides, but at least one permanent opening at ground level and no overhead cover

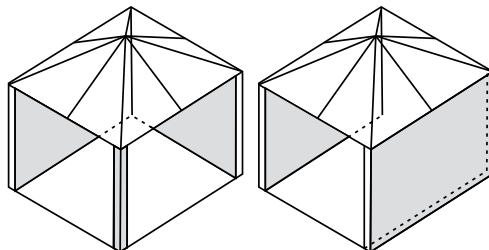

2. Within a partial enclosure that includes an overhead cover and no more than two walls

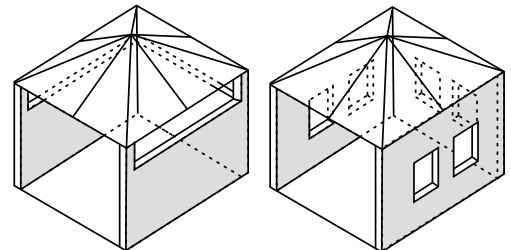

3. Within a partial enclosure that includes an overhead cover and more than two walls, the following will apply:

- (i) at least 25% of the total wall area is completely open, and
- (ii) at least 30% of the remaining wall area is open and unrestricted (see Example 4 & 5).
- (iii) In the case of balconies, at least 20% of the total wall area shall be and remain open and unrestricted.

APPLIANCE FEATURES

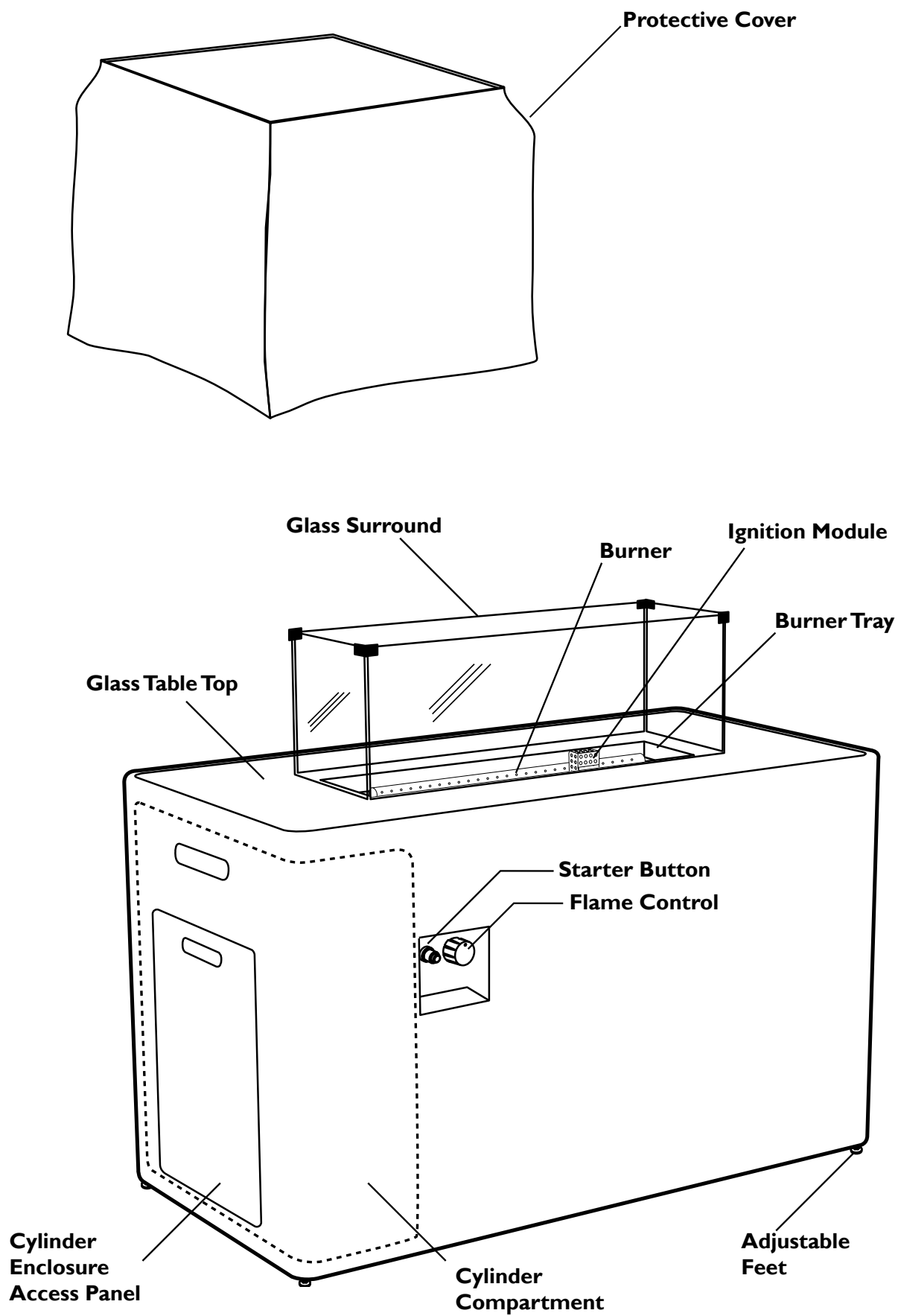

COMPONENTS AND HARDWARE

Note: Tools required for assembly: Phillips screwdriver.

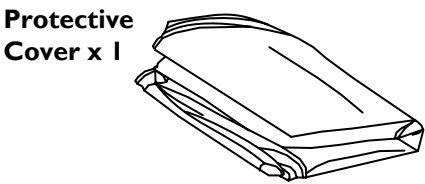

Lava Rock
(DFI02040) 1 x 3.2 KG Pack
(DFI02041) 2 x 3 KG Pack
(DFI02042) 1 x 6.5 KG Pack

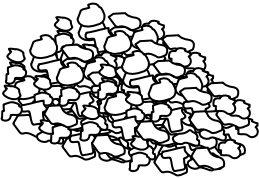

Glass Surround Panels

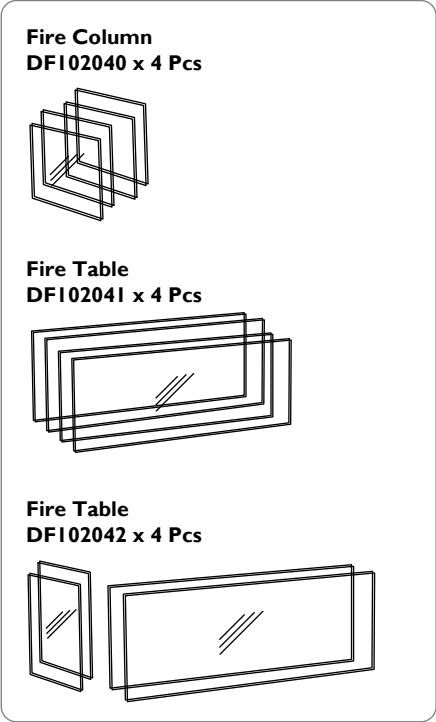

Glass Mounting Hardware

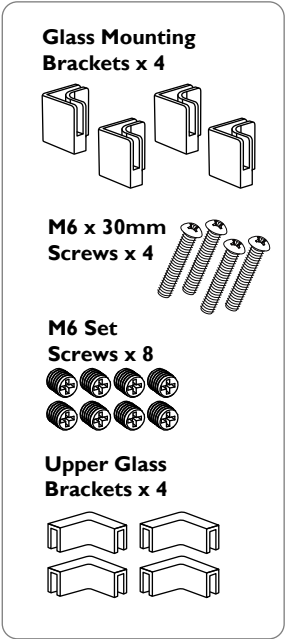

Main Body

Cylinder
Enclosure
Panel

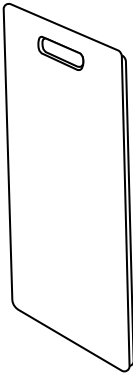

Hose &
Regulator

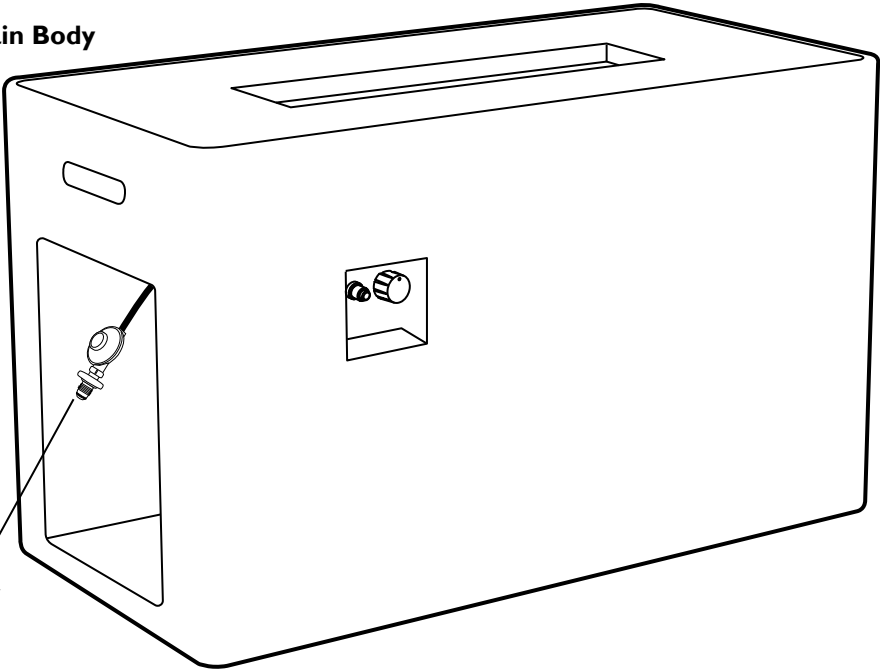

ASSEMBLY & SETUP

Step 1.

(Note the location of the adjustable feet)

To begin - screw the feet all the way in and then adjust each one as necessary to obtain a firm and level footing of the fire table.

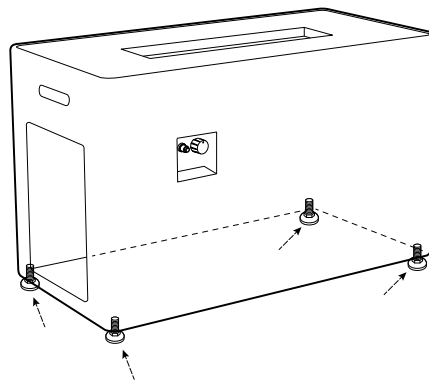

Step 2.

Check that the control knob is turned to the "OFF" position before commencing assembly of the fire table.

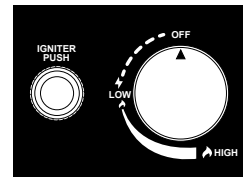
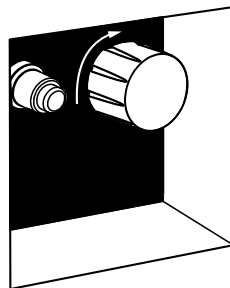

Step 3.

Remove the cylinder enclosure panel.

Pull firmly on the handle to release the panel then remove the panel completely from the main body of the appliance.

Place the panel to one side.

Note the tabs at the bottom of the panel - these will be used to correctly position the panel when it is replaced later.

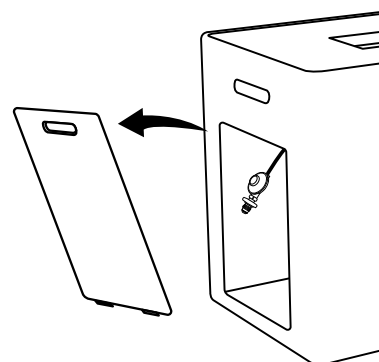

Step 4.

Install the gas cylinder. (Gas cylinder and gas not included - sold separately)

Install the cylinder into the mounting ring, located inside the main body of the appliance.

Position the gas cylinder over the mounting ring and allow the cylinder to drop into place.

Adjust the cylinder so that the valve connection is accessible - for the connection of the gas hose and regulator in the following step.

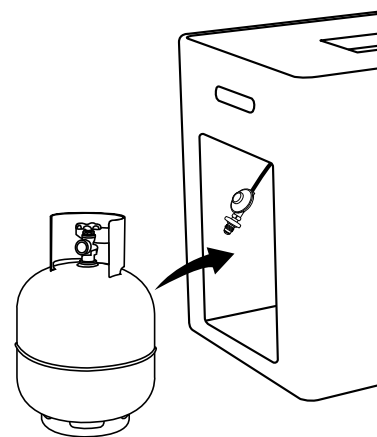

Step 5.

Attach the appliance regulator to the gas cylinder. Ensure the valve is clean and free of any debris.

Note: The POL connector is left hand threaded. You must turn the hand-wheel anti-clockwise to tighten. Hand tighten only. Do not use tools.

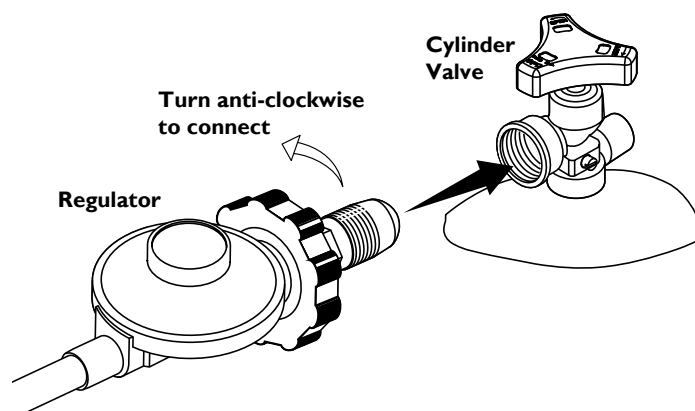

ASSEMBLY & SETUP

Step 6.

Secure the gas cylinder.

Once the regulator connection is secured, make sure the base of the gas cylinder is positioned in the mounting ring.

Now, hand tighten the thumb screw to secure the gas cylinder.

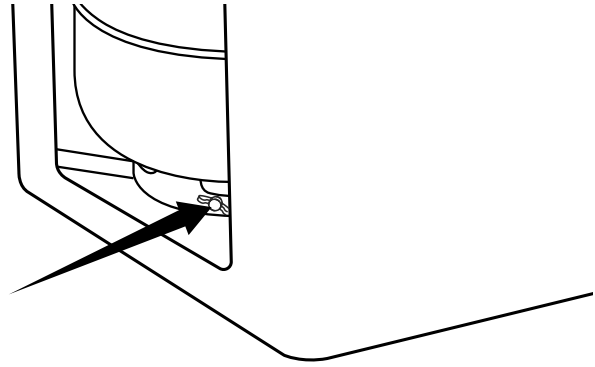

Step 7.

Replace the cylinder enclosure panel.

1. Place the bottom end of the panel into the bottom of the enclosure on the fire table body. The small tabs on the bottom of the panel will engage on the enclosure frame.
2. Push the top of the panel shut - it will 'click' into place.

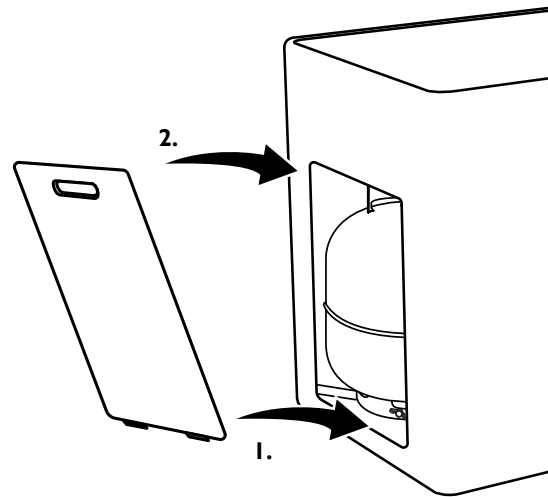

Step 8.

Unscrew the cap on the electronic igniter. Insert a AAA battery into the housing. Ensure the positive end of the battery faces outwards.

Screw the cap back on and tighten firmly.

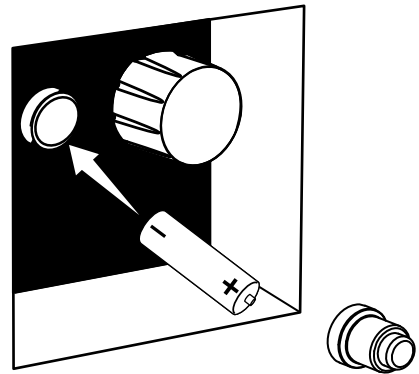

Step 9.

Add the Lava Rock.

Carefully open the Lava Rock bag(s) supplied.

Add the Lava Rock to the burner tray. Spread the rock evenly around the burner tray and burner until all of the supplied rock has been added and now evenly covers the burner.

Important: Do not cover the burner ports (holes) with more than 6-8mm of Lava rock or this will impede the flame.

Important: To ensure trouble free operation of the burner, keep the ignition probe shield clear of any Lava Rock at all times.

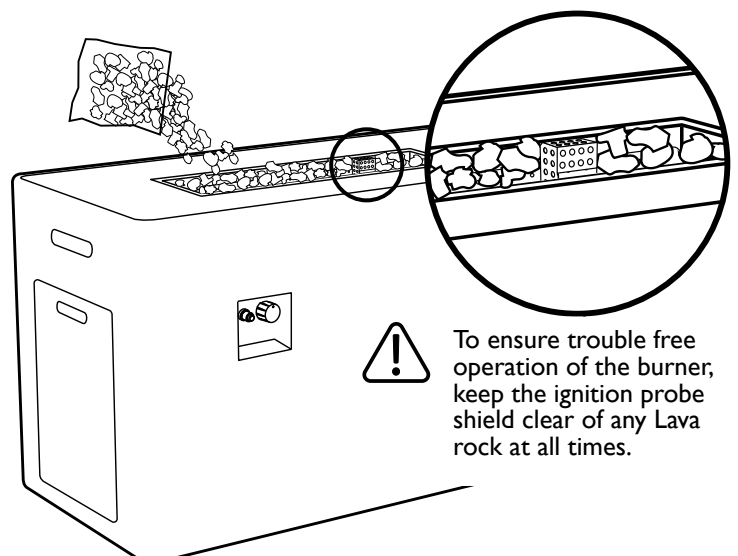

To ensure trouble free operation of the burner, keep the ignition probe shield clear of any Lava rock at all times.

ASSEMBLY & SETUP

Step 10.

Attach the glass mounting brackets and glass panels.



Warning: Read these steps carefully before proceeding.

The glass panels must be installed in accordance with the steps outlined. Failure to follow these instructions may cause the glass to break during installation or during operation.

Glass Installation Sequence Models: DF102040 & DF102041 (Fig 1.)

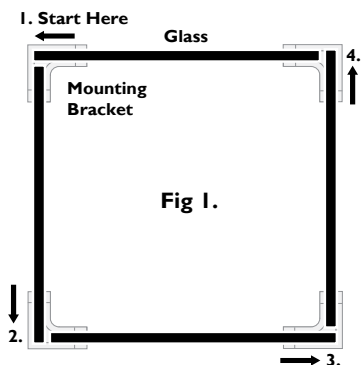

Before installing the mounting brackets and glass panels, note the correct position and installation sequence of the glass panels.

Each glass panel must be installed sequentially, starting in one corner and working around until all glass panels are fitted.

Glass Installation Sequence Model: DF102042 (Fig 2.)

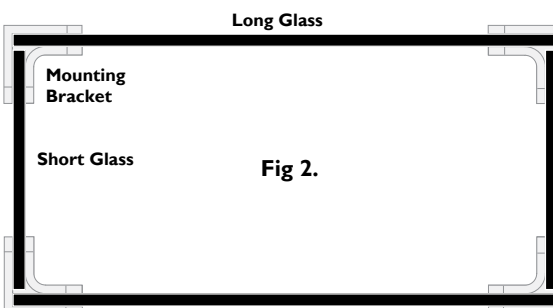

Before installing the mounting brackets and glass panels, note the correct position and installation sequence of the glass panels.

The short glass panels must be positioned between the long glass panels.

A. Attach the four mounting brackets to the table top.

Note the correct orientation of each bracket.

Secure the brackets using the M6 x 30mm screws.

Do Not Overtighten The Screws. Leave a small margin of freedom to allow the brackets to be adjusted when the glass panels are inserted.

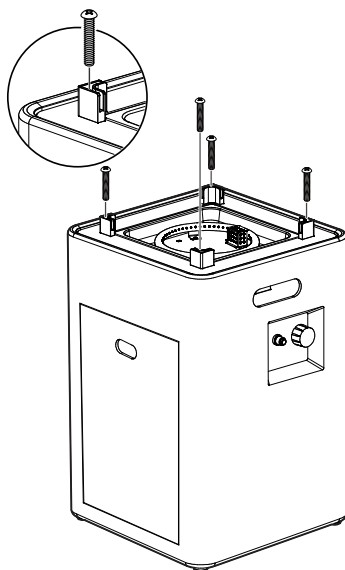

B. Fit the glass panels as described in the glass installation sequence above for your model.

(Fig 1. or Fig 2.)

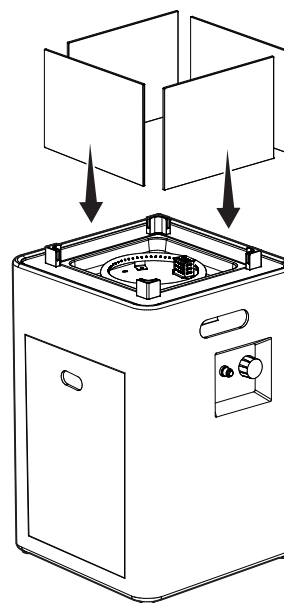

C. With all of the glass panels now installed, secure each of the glass panels using the eight M6 Set Screws provided.

IMPORTANT. Do not overtighten the Set Screws or the glass will crack. The screws only need to be tight enough to prevent excess movement of the glass.

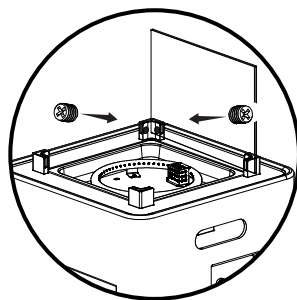

D. Attach the upper glass brackets to each corner.

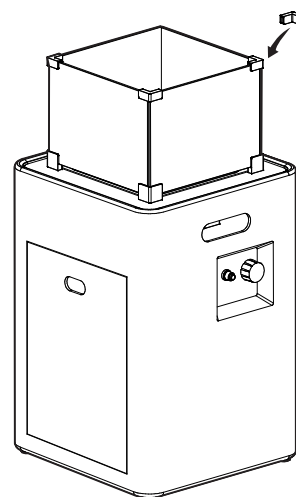

OPERATION

Pre-Start Checks

Prior to using the appliance at any time, it is advisable to inspect the appliance using the following checklist.

Appliance

- Check the burner and ignition module for any damage or build up of carbon, spider webs or nests etc.
- Check the glass surround panels for damage or cracks, do not use the appliance if cracks are present in the glass.
- Check the appliance controls - (flame adjustment control and starter button) - the flame adjustment control should rotate smoothly and the starter button, when pressed, should cause a spark to occur at the burner ignition probe.
- Ensure the ignition probe / ignition module is clear of dust, lava rock and debris.

Gas Hose & Regulator - Gas Line Connections

- Inspect the appliance gas hose and regulator for abrasion, cuts or other damage. If there are signs of wear, abrasion or damage, you must replace the hose and regulator.
- If the gas hose / regulator has been disconnected from the appliance for a period of time - inspect the POL connector to ensure it is free of any dirt, spider webs or nests etc. If not cleared, these elements can cause a blockage that will prevent the appliance from functioning.

Gas Cylinder & Cylinder Valve

- Inspect the gas cylinder and cylinder valve for any signs of wear or damage.
- The gas cylinder should be clean and show no signs of rust or dents. If the cylinder is corroded or, has been dropped or, sustained a dent, it will need to be inspected at an authorised cylinder inspection station. (Or swap over your cylinder for a freshly filled one at your nearest cylinder exchange retailer).
- If the gas cylinder has been disconnected from the appliance for a period of time - inspect the cylinder valve / outlet to ensure it is free of any dirt, spider webs or nests etc. If not cleared, these elements can cause a blockage that will prevent the appliance from functioning.



Gas Leak Test

- Before using the appliance each time, it is advisable to perform a leak test on each gas line connection.
- Prior to performing a leak test be sure there are no live ignition sources present such as a naked flame or pilot light for another gas appliance.
- Never ever check for gas leaks with a naked flame.

Leak Test Procedure

1. Connect the appliance hose & regulator to the gas cylinder and make sure the valve on the gas cylinder is turned off.
2. Check that the gas control on the appliance is turned to the 'OFF' position.
3. Brush a mixture of detergent and water on all connections, including the Hose, Regulator, POL Connection, Cylinder Valve.
4. Turn the gas cylinder valve on. If bubbles form on any connection point along the gas line, this is an indication that a leak is present.
5. If you smell gas or a leak is discovered, turn the gas cylinder valve off, disconnect the regulator from the gas cylinder and do not use the appliance until the leak is repaired.

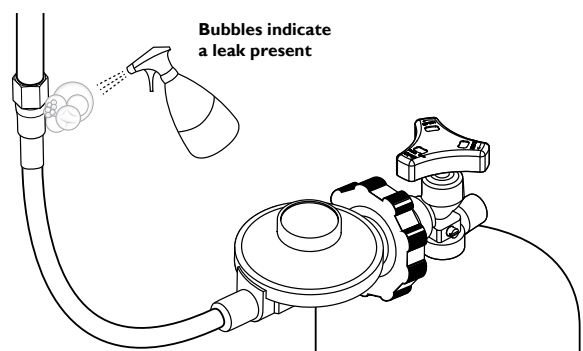
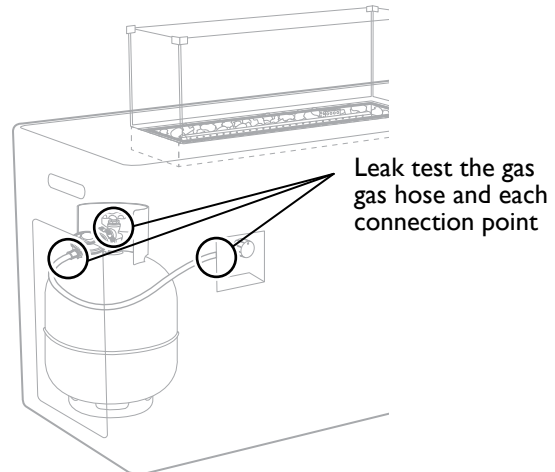

OPERATION



WARNING: If the lighting instructions are not followed directly, a fire or explosion may occur resulting in property damage, personal injury or death.

Lighting the Appliance

1. Make sure the appliance control knob is at the 'OFF' position.

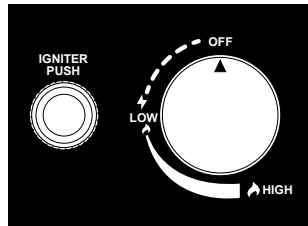
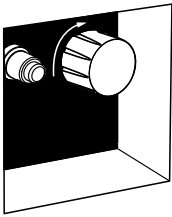

2. Turn on the gas cylinder valve.

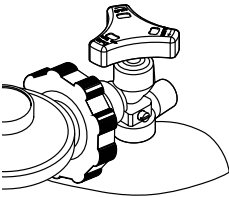

3. Push in the control knob and turn it to the 'LOW' position. Keep holding down the control knob in, while at the same time... Push and hold in the electronic igniter button until the burner is alight.

(When lighting the appliance for the first time, or after recently refilling the gas cylinder, this process may take longer as air needs to be purged from the gas hose).

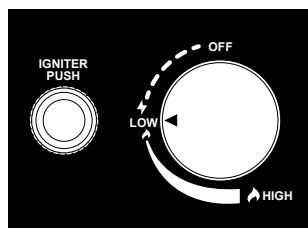
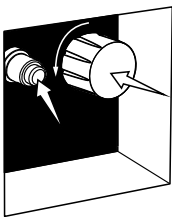

4. If ignition doesn't occur within a few seconds, release the control knob and rotate it to the 'OFF' position. Wait for 5 minutes for gas to clear and then repeat the above lighting instructions.

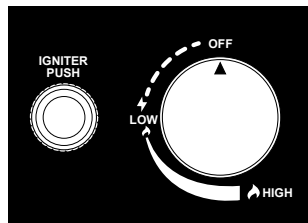
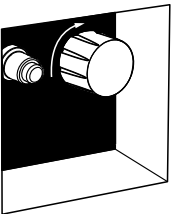

5. Once the burner is alight, the flame intensity can be adjusted by rotating the knob between the 'LOW' and 'HIGH' positions.

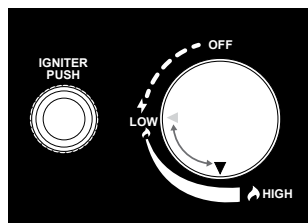
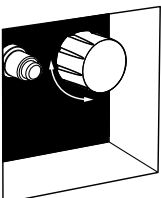

Extinguishing the Appliance

1. Push in and turn the flame control knob to the 'OFF' position.

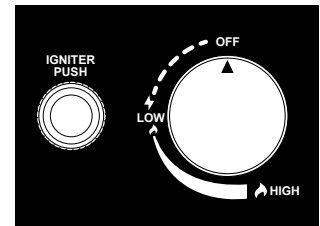
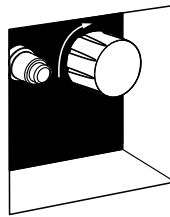

2. Always turn the gas cylinder valve off after use, especially if the appliance is not to be used for some time.

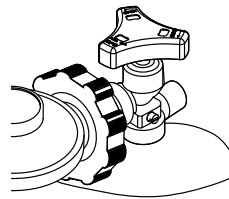

Flame Colour & Height

20 minutes after igniting the burner, the flame should appear as a yellow/blue color, with a height between 70mm - 250mm.

Important Note - Lava Rock

During manufacture, we take steps to preheat the Lava rock to expel any residual moisture before it is packed with the appliance.

Lava rock is a porous material that can absorb moisture. When heated, any moisture trapped inside the Lava rock may expand and cause the Lava rock to crack or pop.

Lava rock should therefore be kept dry at all times - cover the appliance when not in use. If the Lava rock becomes wet at any time (Rain or, an accidental spill for example) do not use the appliance until the Lava rock has thoroughly dried out.

Avoid standing directly over the burner when lighting or using the appliance at any time.

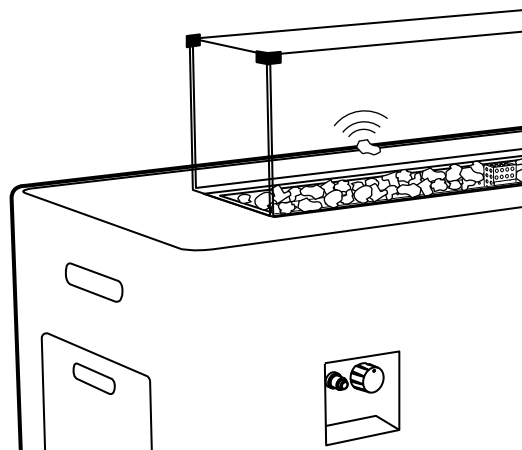

IN THE EVENT OF A FAULT

Most problems can be easily solved by using the trouble shooting guide below to determine the cause and solution before calling our customer service team.

Problem	Cause	Solution
Burner will not light (Electric starter faults)	Igniter electrode pin and / or burner are wet	Dry off with a soft cloth.
	Igniter battery is incorrectly inserted	Check which direction the battery is inserted.
	Igniter battery is exhausted / dead	Replace with a fresh 1.5V AAA battery .
	Igniter electrode pin is broken	Replace the electrode - Contact Décofire.
	Igniter electrode wire is loose or disconnected	Reconnect contact wire to the igniter box.
	Electrode wire is shorting between valve	Check for source of short - replace electrode wire if faulty - Contact Décofire.
Burner will not light (Gas supply faults)	No gas flow / no gas	Check cylinder valve is turned on.
	No gas flow / no gas	Cylinder low or empty - refill or swap over cylinder.
	No gas flow / no gas	Regulator / hose not connected - check all connections, leak test and resume lighting and operation procedures.
	Obstructed gas flow	Check all hoses for kinks and bends.
	Burner ports obstructed - dirt or debris	Turn off appliance flame control and cylinder valve. Insert an opened paper clip (or similar item) into each of the burner ports to clear them out.
Burner will not stay alight	The holding time of control knob is not long enough to activate the thermocouple	Push and turn the control knob to the low position and then hold for at least 45 seconds until burner is completely alight.
	The connection of the thermocouple and valve is loose	Tighten the connection between and thermocouple and the valve.
	Burner media caught between the burner port and the thermocouple inside the ignition guard	Inspect thermocouple and ignition guard. Clean and remove any burner media or debris.
	Thermocouple is damaged or faulty	Replace thermocouple - Contact your supplier to order new thermocouple.
	Control knob is damaged / broken (Spinning on valve control shaft)	Remove the control knob. Light the unit according to lighting instructions, if flame is able to stay on - then replace the control knob. Contact your supplier to order a new control knob.
Burner will not stay alight / Flame blows out easily	Flame obstructed at burner ports	Check that all burner ports are free of any small burner media (Lava rock or pumice stone etc).
	Strong ambient breeze present.	Increase flame to 'HIGH'
	No gas flow / no gas	Check cylinder valve is turned on / fully open.
	No gas flow / no gas	Cylinder low or empty - refill or swap over cylinder.
Burner emits smoke	Flame obstructed at burner ports	Check that all burner ports are free of any small burner media (Lava rock or pumice stone etc).
	Regulator hose is kinked	Check hose and remove any bends or kinks.
Sudden drop in gas flow	No gas flow / no gas	Check cylinder valve is turned on / fully open.
	No gas flow / no gas	Cylinder low or empty - refill or swap over cylinder.
	Excess flow or safety shut off device safety valve has been activated (If fitted)	Turn the flame control knob to the 'OFF' position. Turn off the cylinder valve. Check for the reason why the safety device has activated before resetting the safety device. (Follow the manufacturers instructions). Then turn on the gas cylinder valve and restart the appliance as per the lighting procedure in this manual.

CARE & CLEANING

A few tips...

- Never clean this appliance when it is hot - always allow the appliance to cool completely before cleaning or maintenance.
- Before performing any maintenance always shut off all gas controls and valves and disconnect the gas cylinder from the appliance.
- Do not use high pressure water blasting devices to clean the surfaces of the appliance body as this may damage or remove the surface coatings.
- Always check any cleaning product on a small area of the underside of the product to confirm it is safe to use. Note: Permanent damage may occur if abrasive powder or solvent cleaners come in contact with painted or metal components of this appliance.
- Avoid using harsh chemical cleaners, sprays or highly abrasive cleaning tools.
- Corrosive environmental conditions (seaside & coastal locations) may cause stubborn stains, discoloration and possibly rust pitting of components.

Care: Body - Painted Finishes

Wipe the appliance over with a soft damp cloth and mild detergent if required. Rinse with clean water and dry off all components with a soft cloth before using appliance.

Care: Glass Components

Periodically clean the glass panels with a damp soft cloth. Use glass cleaner to assist with removing any build up or stubborn stains.

Use a soft dry cloth to dry the glass. Ensure the glass is completely dry before using the appliance.

Care: Stainless Steel / Aluminium Components

Regularly clean the visible stainless steel or aluminium components with a suitable approved cleaner. Follow the manufacturers instructions for cleaning and then rinse the components with clean water and then dry the components with a soft cloth. Ensure all components are completely dry before using the appliance.

STORAGE

When not in use, this appliance must be protected from exposure to the elements: e.g. Sun, Wind, Rain, Dust, Snow and Ice.

Cover this appliance at all times when not in use or move this appliance to a covered outdoor space or store the appliance in a dry environment, for example, a garage or suitable storage space.

If this appliance is being stored indoors, the gas cylinder must be turned off at the cylinder valve and the gas cylinder must be disconnected from the appliance.

It is generally recommended that any gas cylinder - when not in use - be stored outdoors in a secure, protected and well ventilated area.

CLEANING, MAINTENANCE & SERVICING SCHEDULE

Service Item	Recommended Interval
Major appliance inspection and service This appliance should be inspected and serviced by a qualified gas service technician.	2 years
Cleaning: Appliance Body, Glass Panels and Burner.	6 months or, more frequently if required.
Gas leak test.	1-2 months or, Whenever gas cylinder is refilled or, If the hose and regulator has been disconnected.
Inspect /check burner and flame control operation.	12 months.
Check ignition / starter system and battery.	12 months.
Inspect hose and regulator for damage, abrasion, cuts or other damage.	6 months or, whenever the cylinder is refilled.
Inspect all 'O' Rings at gas connection points.	12 months or, whenever the cylinder is refilled.
Inspect appliance guard for damage - ensure guard is secured to appliance.	6 months.
Inspect gas cylinder. Check for corrosion or damage to cylinder and valve. Check valve operation.	6 months or, Whenever cylinder is refilled or reconnected to the appliance.

SPARE PARTS

Where components require replacement, these should be obtained from the original supplier - or as advised by your gas service technician.

Using non manufacturer approved parts or accessories may result in a defective condition and void the warranty of this appliance.

ENVIROSTONE® SURFACE CARE

The surface material of this appliance has been sealed with a patented treatment to prevent staining and moisture absorption, but it does require proper maintenance to ensure the integrity of the surface.

The following recommendations will assist in maintaining your Envirostone® surface for many years:

- Clean any spills immediately to prevent permanent surface staining or damage.
- Blot any liquid spills with a clean, dry cloth or sponge to avoid spreading of the spill to the rest of the appliance.
- Clean your appliance surfaces with a soft, clean cloth or sponge. Mix a solution of warm clean water and mild dish soap to remove any surface dirt or mild spills. Rinse all soap solution off of the appliance surfaces and dry completely to avoid water spots. Regularly cleaning the appliance surfaces will aid in a longer lasting product.
- Do not use petroleum-based or abrasive cleaning products. Do not use any harsh brushes when cleaning the appliances surfaces.
- Do not slide products across the glass table top or appliance surfaces to avoid permanent scratching and damage.
- Always use protective mats, place mats or coasters to avoid scratching or staining the table top surface. These protective products will help absorb sweating on cool beverages and will block out any heat rings from appearing beneath a warm mug or plate.
- When placing hot dishes on an Envirostone® surface, always use mats or hot pads.
- Envirostone® surface must be covered at all times when not in use. Cover your product with the weather cover supplied or a suitable outdoor furniture cover when not in use to protect it from the elements.
- In extremely cold climates or regions, store your appliance indoors during winter months. Avoiding extreme cold temperatures will prevent cracking of the body and tabletop.

TOUCH UP PEN

A touch up pen is supplied with this appliance for touching up minor marks and scratches. The pen contains an acrylic based paint designed to match the body colour of your appliance.

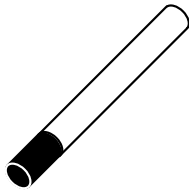

A few tips...

- Shake the pen for about 15 seconds, before each use.
- Store the touch up pen in a safe place for future use.
- Do not unnecessarily remove the cap except for when using the pen to touch up minor marks and scratches.
- Always replace the cap when finished using.
- The pen contents is a non toxic acrylic based paint. However, keep the pen out of the reach of children.
- Do not consume the contents of the pen
- Avoid deliberately breathing the vapour of the contents.

To apply

1. Remove the cap and press the tip of the pen up and down a few times on a flat surface, using a few sheets of paper as a blotter. This will allow the paint to flow through the tip.
2. Apply the paint as required - using a dabbing motion to touch up minor marks and scratches.
3. Allow the paint to dry for at least 24 hours before touching the repaired area.
4. Shake the pen as required from time to time, to mix the paint.
5. Immediately replace the cap when finished using
6. Store the pen in a safe place for future use.

PROTECTIVE COVER

The protective cover supplied must be used to protect the fire table at all times when it is not in use.

The cover provided is designed to provide general protection against dust and moisture only. In areas of extreme hot or cold climates, corrosive environments such as seaside and coastal locations or areas that receive frequent, harsh weather conditions; a more durable cover should be considered and purchased separately.

When the fire table is not in use at any time, it should be covered and stored in a dry, protected area, away from the elements. (under an awning for example). Failure to cover and protect the fire table when it is not in use will leave it exposed to dust and moisture which will affect both the look and performance of your fire table.

A few tips...

- Do not place the cover over the fire table until the burner has been turned off and the appliance has cooled completely. (Normally around 30 minutes after shutdown)
- Never place the cover on the unit when it is operating or hot.
- Always remove the cover before lighting the burner or using the fire table.

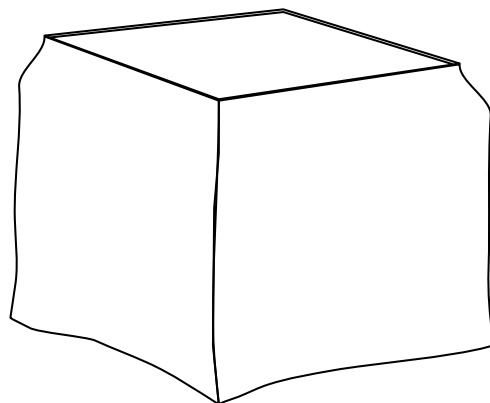



WARRANTY

Our goods come with guarantees that cannot be excluded under the Australian Consumer Law. You are entitled to a replacement or refund for a major failure and for compensation for any other reasonably foreseeable loss or damage. You are also entitled to have the goods repaired or replaced if the goods fail to be of acceptable quality and the failure does not amount to a major failure. The benefits to the consumer given by this warranty are in addition to other rights and remedies of the consumer under the law in relation to the goods and services to which the warranty relates.

Warranty Period / Term

Mayo Hardware Pty Ltd warrants this Décofire™ product to be free from manufacturing defects for a period of 12 months commencing from the date of purchase.

Who provides the warranty:

- In Australia, warranty is provided by Mayo Hardware. In other countries, contact your authorised Mayo Hardware distributor or the retailer from whom this product was purchased.

What you need to do to make a claim:

- To make a claim under this warranty you may:
- (a) Contact the retailer from whom the product was purchased and advise them of the nature of the problem of defect.
- (b) Contact Mayo Hardware and advise us of the nature of the problem of defect.

What will we do in the event of a claim:

- If any part of this product is found to be defective during the term of this warranty, Mayo Hardware shall repair or replace the defective component or product or, provide a remedy to the consumer in accordance with the Australian Consumer Law.

Conditions of warranty:

- This warranty provides remedy on manufacturer's faults and defects only.
- It is a condition of warranty that you contact the Mayo Hardware or the retailer from whom the product was purchased immediately upon finding a problem or defect with this product.
- It is a condition of warranty that the product is returned to the retailer from whom this product was purchased or, Mayo Hardware's distributor, service department or authorised service agent.
- The product is installed, operated and maintained in accordance with the instructions supplied. Repairs or service must only be carried out by an authorised person.
- No alterations or repairs shall be undertaken without obtaining consent from Mayo Hardware Pty Ltd.
- This warranty applies only to the original owner of the product and is not transferable.
- The warranty period (term) commences from the date of purchase.
- When claiming warranty for this product you must provide a copy of your proof of purchase. No claims for warranty will be accepted without proof of purchase.

Items not covered by this warranty:

- Working surfaces or components subject to normal wear and tear - unless it is a clear defect or manufacturing fault.
- Deterioration as a result of exposure to the elements.
- Damage or corrosion caused by adverse weather conditions, fair wear and tear, accidents, misuse, negligence, fire, flood, hail, earthquakes or other natural disasters, lightning strikes, insects, hail, prolonged exposure to the elements or direct sunlight, chemicals, food acids or juices.
- Damage or fault to the product or its components as a result of a failure to follow the installation / operating instructions.
- Damage sustained to the appliance from negligence, alteration, abuse, misuse, lack of maintenance, accidental damage or improper installation of this product.
- Scratches, dents, corrosion or discolouring caused by accident, cleaning, normal wear and tear, heat, abrasive or chemical cleaners.
- Damage caused by dirt, sand, and/or water damage.
- Alterations or repairs undertaken by an unauthorised service person.
- Modification of the appliance or any of its components.
- Use of any non specified component or replacement part.
- Use or installation of this appliance - other than what is described in the user instructions (instruction manual)
- Removal of any safety device or guard.
- Damage caused by continued operation of the product with a known problem.
- This warranty does not extend to commercial use of the product.

If a defect occurs during the warranty period and you wish to obtain a replacement, please forward to Mayo Hardware Pty Ltd a written description and photographs of the claimed defect, and a copy of the original receipt or proof of purchase. Full documentation must be provided within 28 days of the occurrence that leads to a claim.

Mayo Hardware Pty Ltd reserves the right to determine manufacturing faults at their discretion. In the interest of ongoing product development and improvement the manufacturer reserves the right to discontinue or change specifications or designs at any time without notice and without incurring obligations.

For warranty or technical support, please call:
Mayo Hardware Pty Ltd. Customer Service:

Ph: 1300 360 211 Web: decofireheating.com.au