

# AEG

**KS12-1**

Original instructions

## **Important!**

It is essential that you read the instructions in this manual before assembling, operating and maintaining the product.

Subject to technical modifications.



- |                           |   |
|---------------------------|---|
| 1. Lock-off button        | 9. Upper guard  |
| 2. Switch trigger         | 10. Blade   |
| 3. Base                   | 11. Lower guard   |
| 4. Rip guide lock         | 12. Lower guard lever   |
| 5. Angle scale lock lever | 13. Exhaust port (outer: $\varnothing 31.8$ mm, inner: $\varnothing 27.9$ mm) |
| 6. Angle scale            | 14. Power cord  |
| 7. Hex key                | 15. Blade bolt  |
| 8. Front handle           | 16. Handle, insulated gripping surface  |
|                           | 17. Edge guide  |

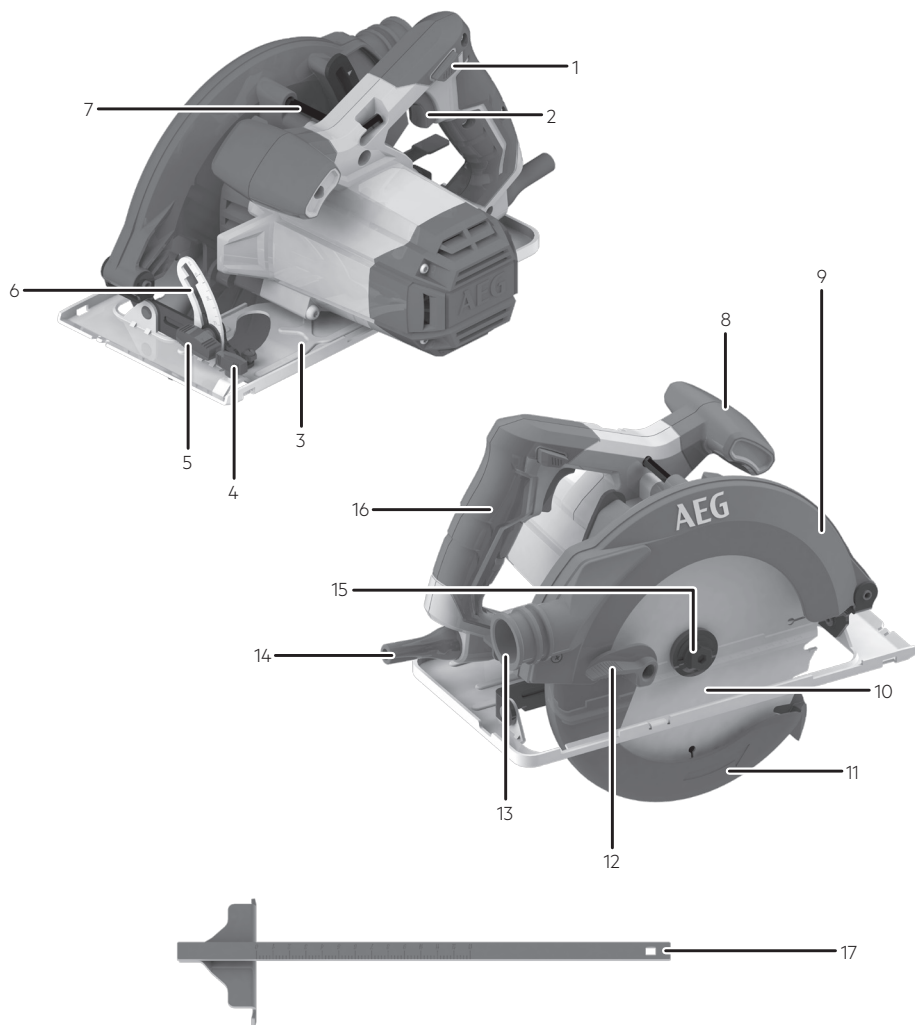

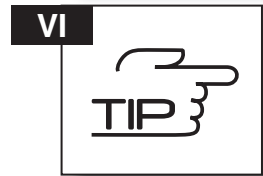
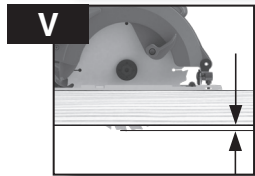
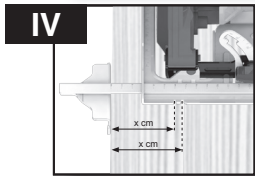
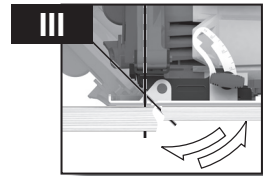
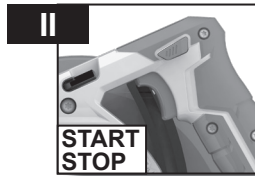
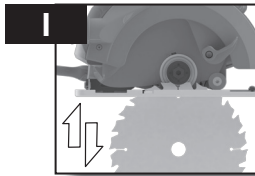
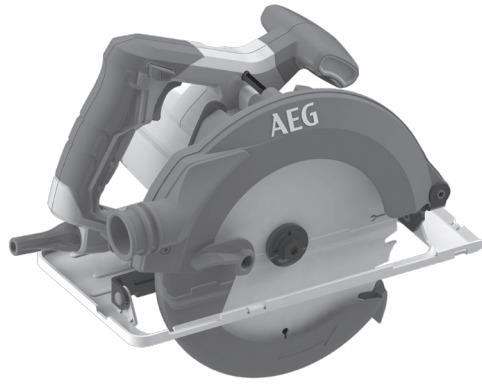

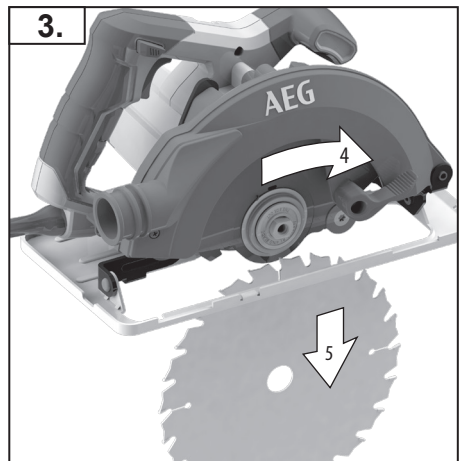
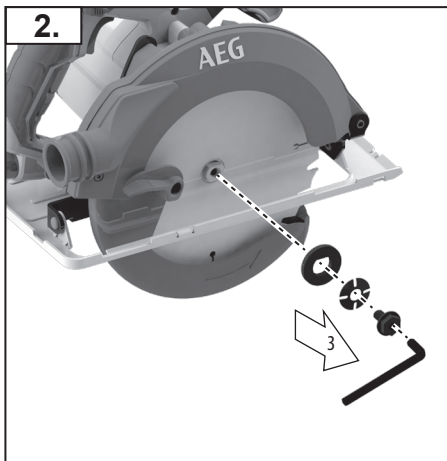
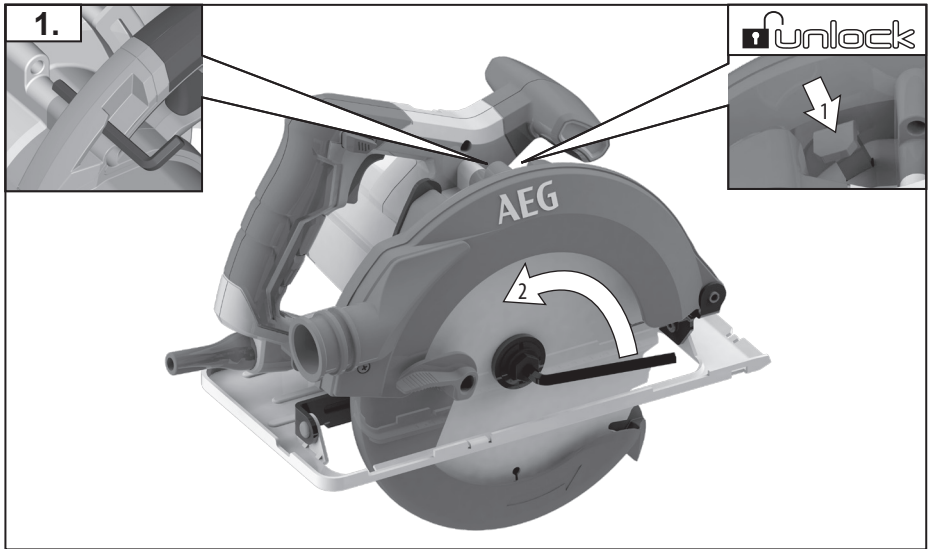
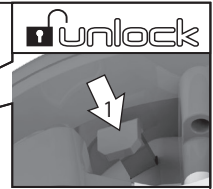
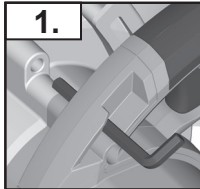
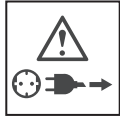
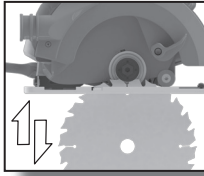

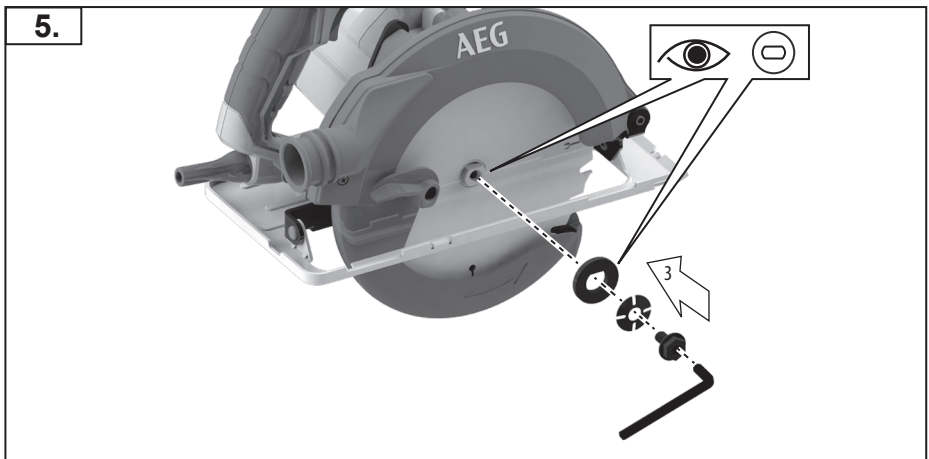
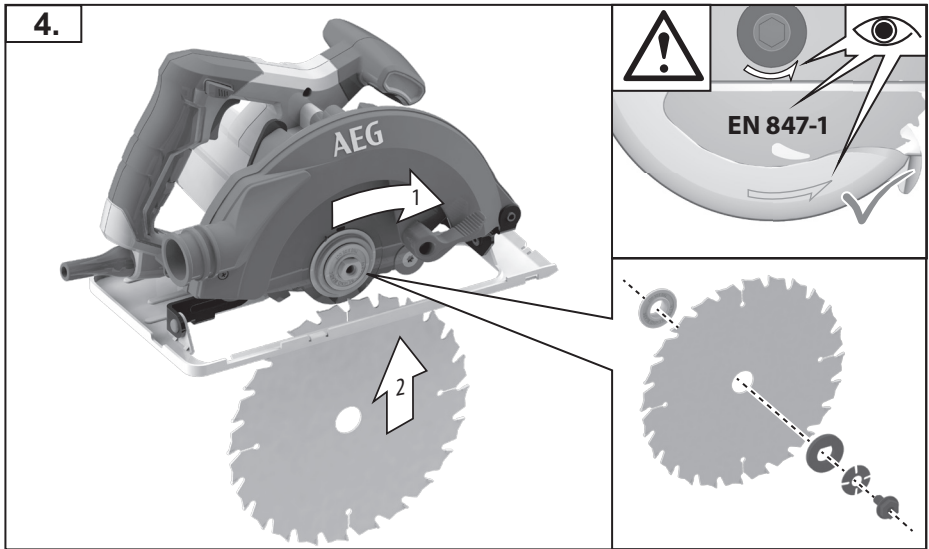
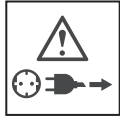
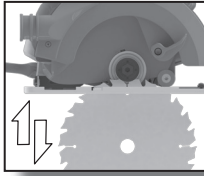

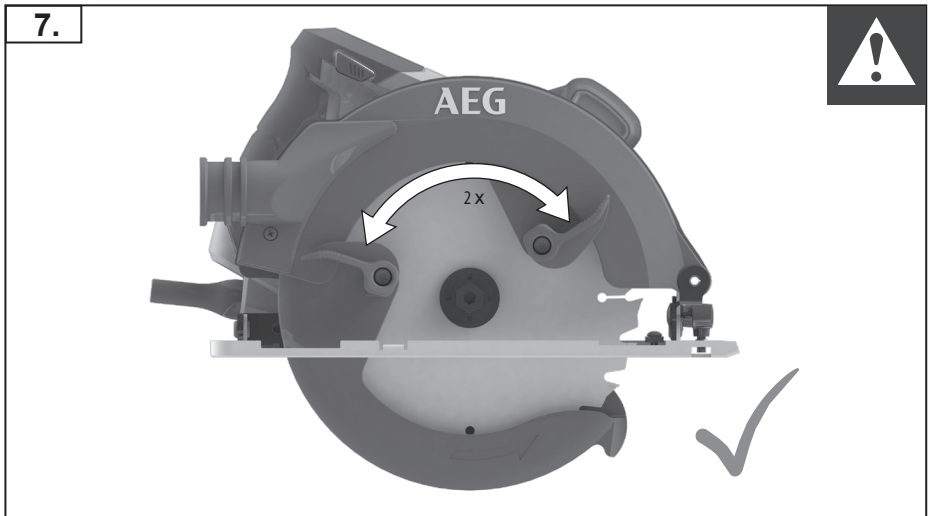
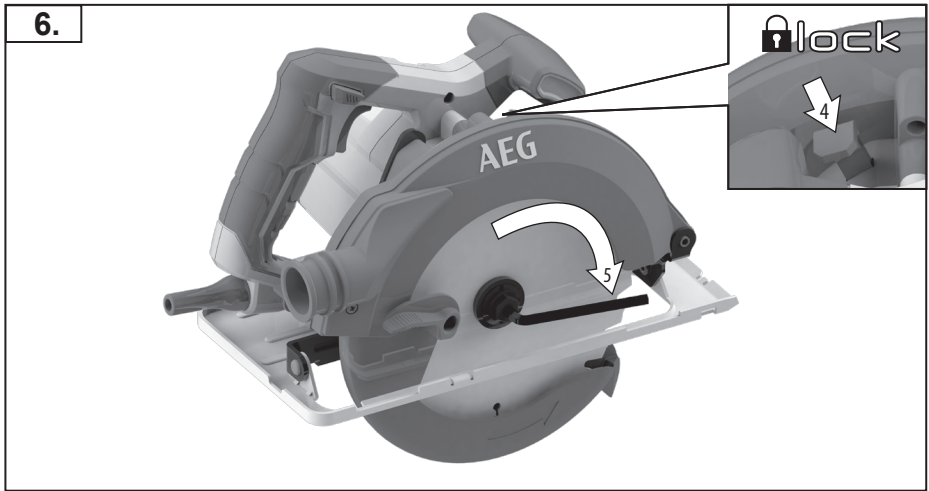
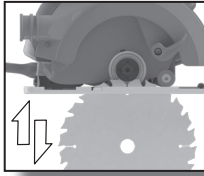



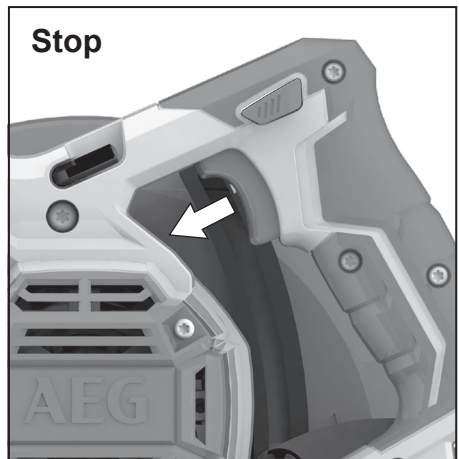
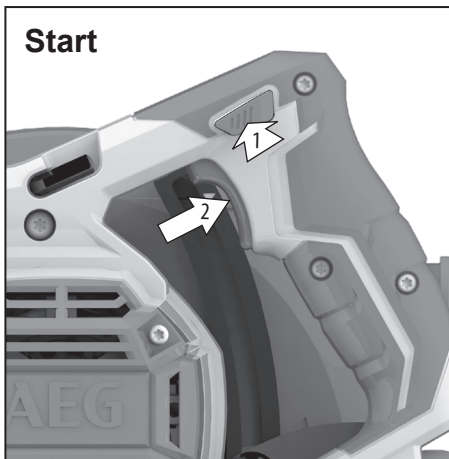
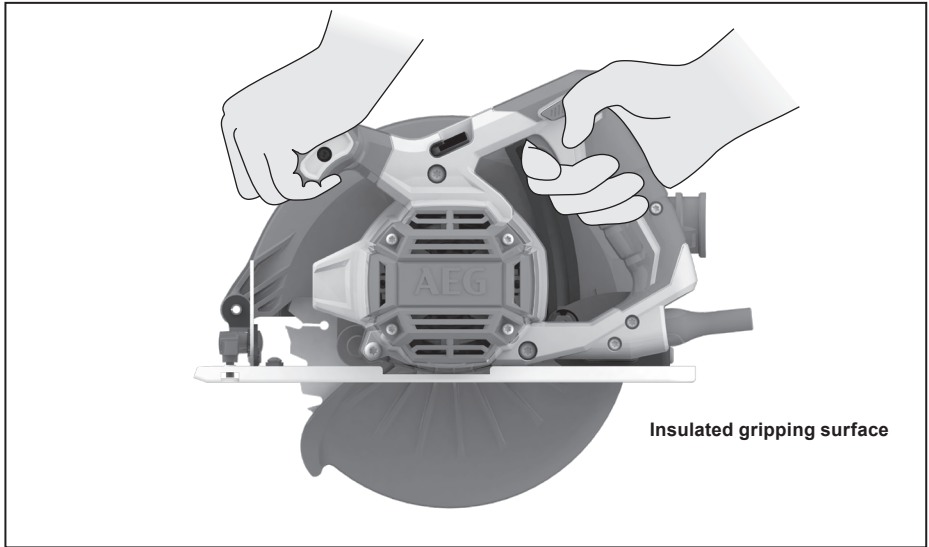

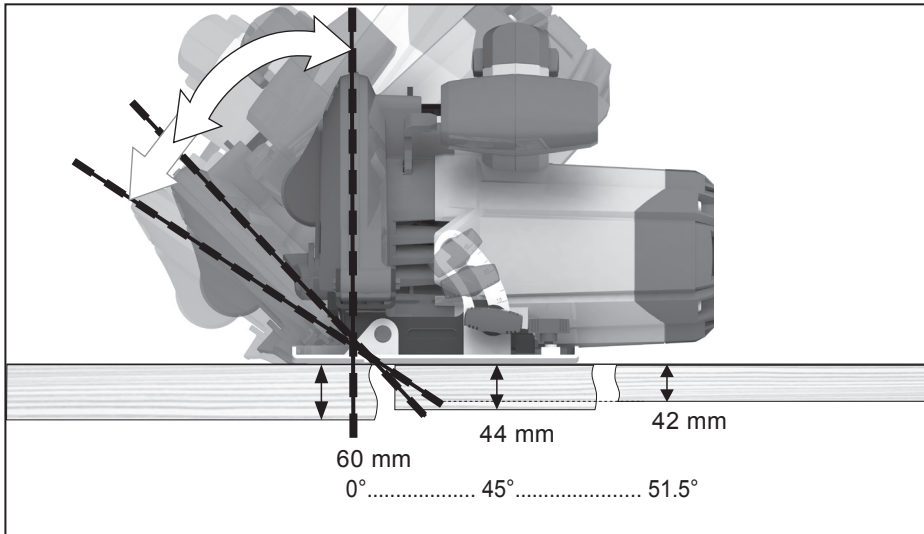
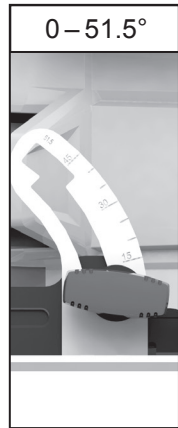
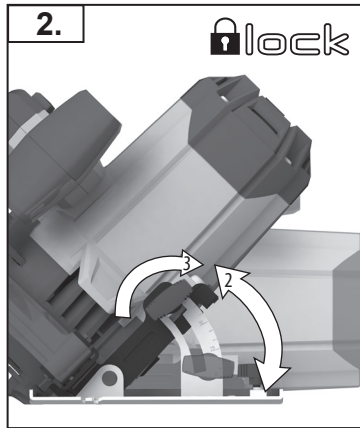
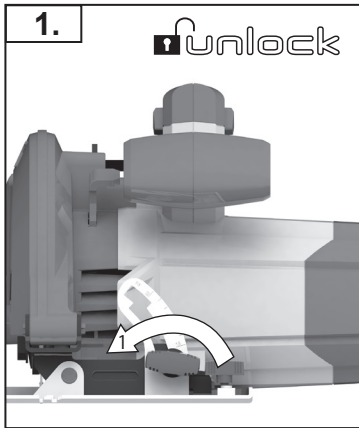
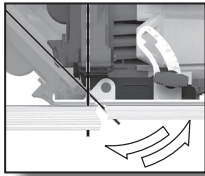

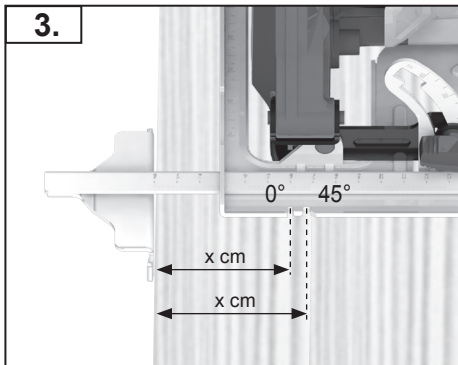
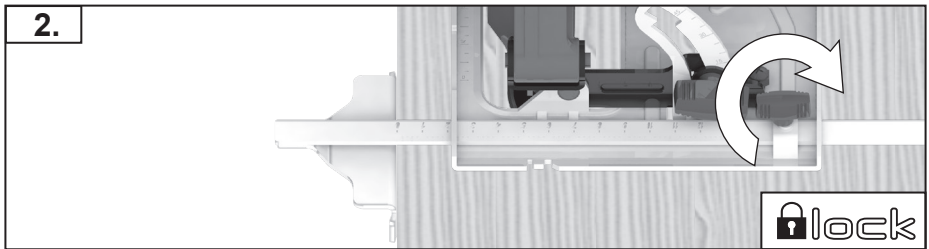
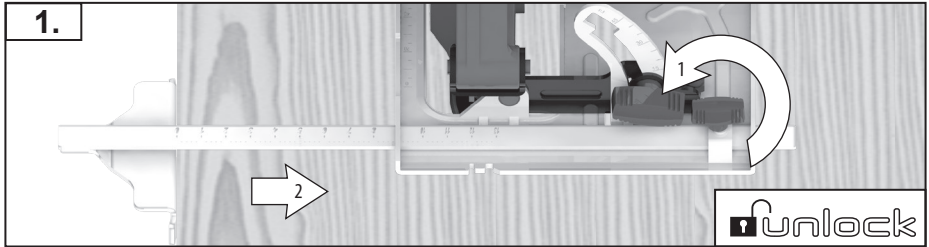
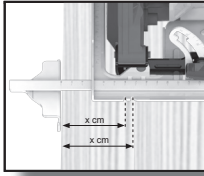

Carry out a test cut



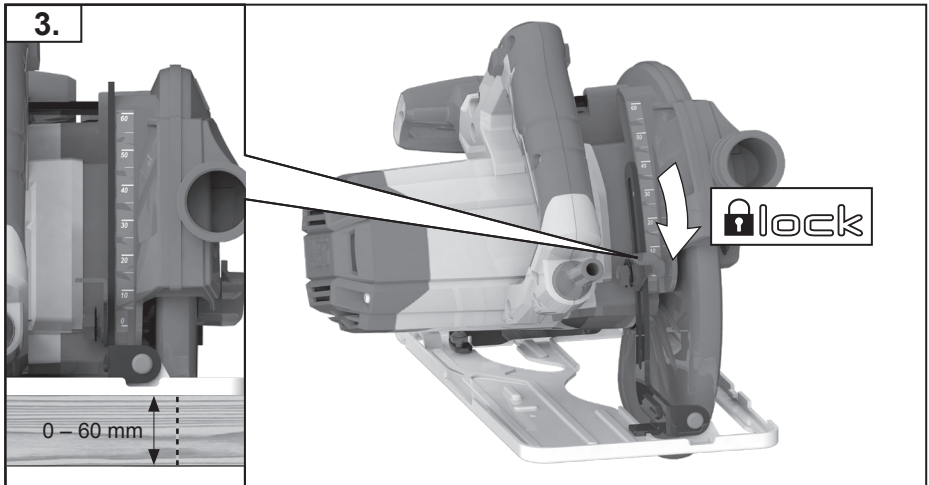
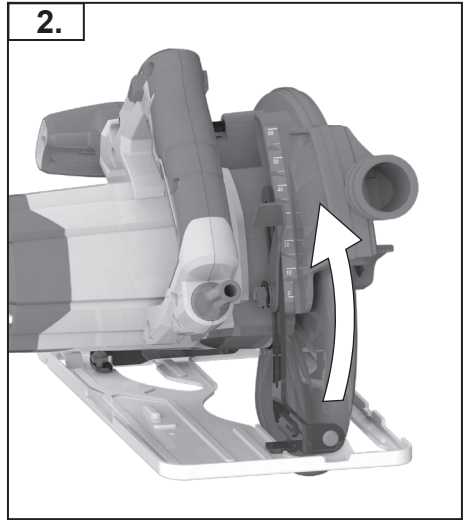
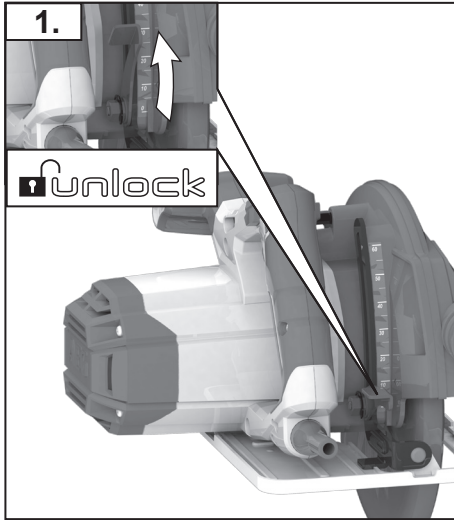
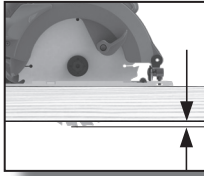

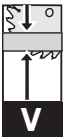
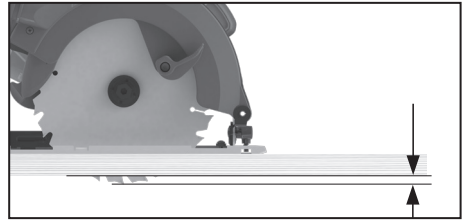
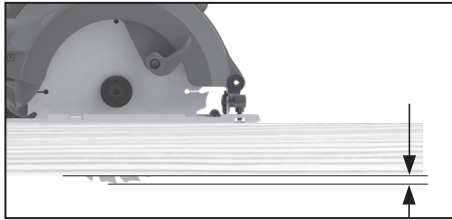
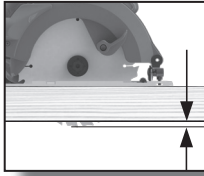

Adjust the cutting depth to the thickness of the workpiece. Less than a full tooth of the blade teeth should be visible below the workpiece.



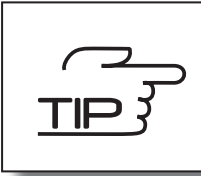

TIP  
VI

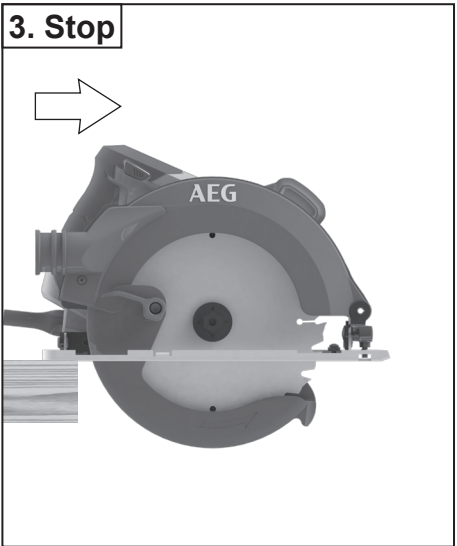
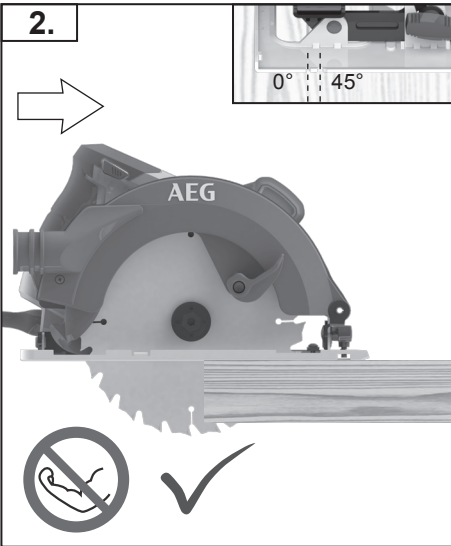
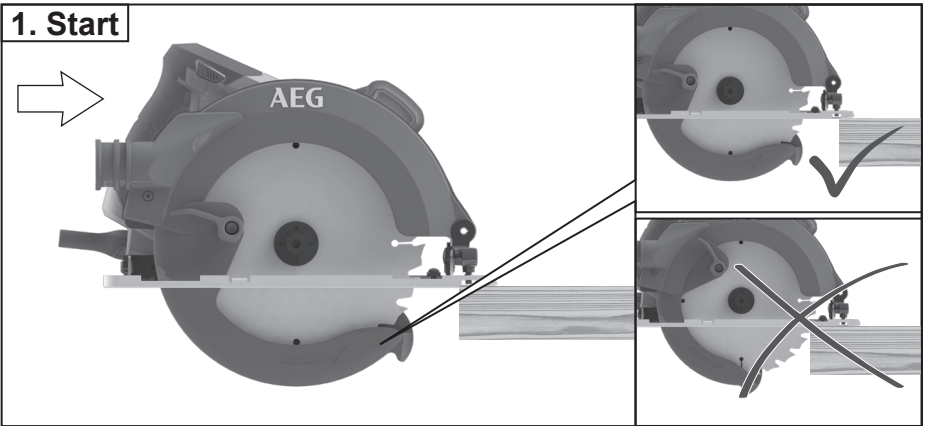

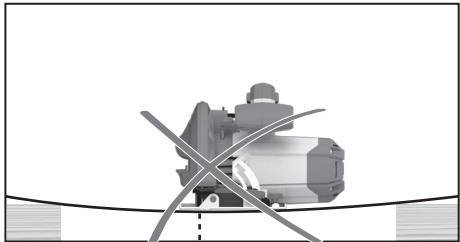
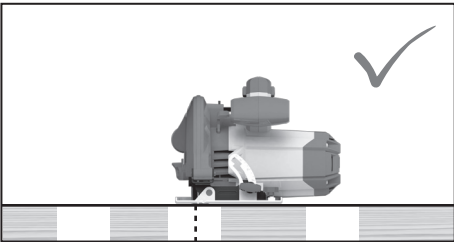
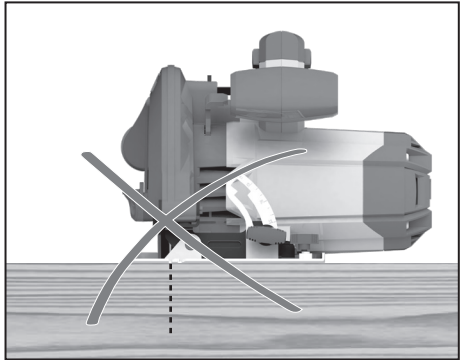
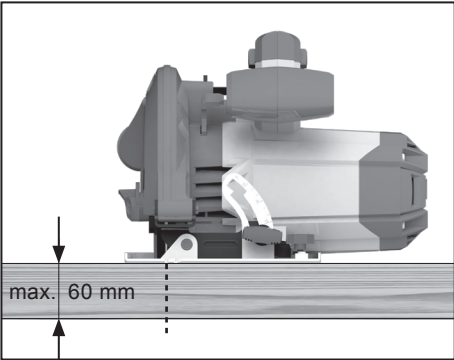
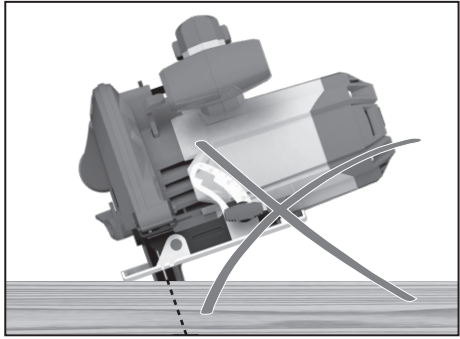
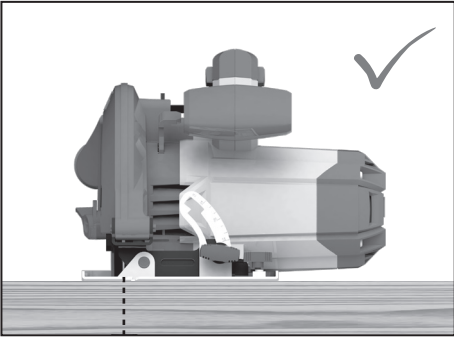

## TECHNICAL DATA

Circular Saw	KS12-1
Rated wattage	1200 W
Input voltage	220-240V AC 50Hz
No-load speed	5000 min <sup>-1</sup>
Saw blade diameter x hole diameter	184 x 20 mm
Saw blade thickness	2.2 mm
Max. Cutting depth at 0°/ 45°/ 51.5°	60/ 44/ 42 mm
Weight according EPTA-Procedure 01/2014	3.7 kg
<b>Noise information</b>	
Measured values determined according to EN 62841. Typically, the A-weighted noise levels of the tool are:	
Sound pressure level (Uncertainty K=3dB(A))	94.5 dB (A)
Sound power level (Uncertainty K=3dB(A))	105.5 dB (A)
Wear ear protectors!	
<b>Vibration information</b>	
Vibration total values (triaxial vector sum) determined according to EN 62841.	
Sawing of wood	
Vibration emission value a <sub>nw</sub>	3.2 m/s <sup>2</sup>
Uncertainty K=	1.5 m/s <sup>2</sup>



### **WARNING!**

The vibration emission level given in this information sheet has been measured in accordance with a standardised test given in EN 62841 and may be used to compare one tool with another. It may be used for a preliminary assessment of exposure.

The declared vibration emission level represents the main applications of the tool. However if the tool is used for different applications, with different accessories or poorly maintained, the vibration emission may differ. This may significantly increase the exposure level over the total working period.

An estimation of the level of exposure to vibration should also take into account the times when the tool is switched off or when it is running but not actually doing the job. This may significantly reduce the exposure level over the total working period. Identify additional safety measures to protect the operator from the effects of vibration such as: maintain the tool and the accessories, keep the hands warm, organisation of work patterns.



**⚠ WARNING!** Read all safety warnings, instructions, illustrations and specifications provided with this power tool. Failure to follow all instructions listed below may result in electric shock, fire and/or serious injury.

Save all warnings and instructions for future reference.

## CIRCULAR SAW SAFETY WARNINGS

### Cutting procedures

- **⚠ DANGER:** Keep hands away from cutting area and the blade. Keep your second hand on auxiliary handle, or motor housing. If both hands are holding the saw, they cannot be cut by the blade.
- **Do not reach underneath the workpiece.** The guard cannot protect you from the blade below the workpiece.
- **Adjust the cutting depth to the thickness of the workpiece.** Less than a full tooth of the blade teeth should be visible below the workpiece.
- **Never hold the workpiece in your hands or across your leg while cutting. Secure the workpiece to a stable platform.** It is important to support the work properly to minimise body exposure, blade binding, or loss of control.
- **Hold the power tool by insulated gripping surfaces, when performing an operation where the cutting accessory may contact hidden wiring or its own cord.** Contact with a “live” wire will also make exposed metal parts of the power tool “live” and could give the operator an electric shock.
- **When ripping, always use a rip fence or straight edge guide.** This improves the accuracy of cut and reduces the chance of blade binding.
- **Always use blades with correct size and shape (diamond versus round) of arbour holes.** Blades that do not match the mounting hardware of the saw will run off-centre, causing loss of control.
- **Never use damaged or incorrect blade washers or bolt.** The blade washers and bolt were specially designed for your saw, for optimum performance and safety of operation.

### Kickback causes and related warnings

- kickback is a sudden reaction to a pinched, jammed or misaligned saw blade, causing an uncontrolled saw to lift up and out of the workpiece toward the operator;
- when the blade is pinched or jammed tightly by the kerf closing down, the blade stalls and the motor reaction drives the unit rapidly back toward the operator;
- if the blade becomes twisted or misaligned in the cut, the teeth at the back edge of the blade can dig into the top surface of the wood causing the blade to climb out of the kerf and jump back toward the operator.

Kickback is the result of saw misuse and/or incorrect operating procedures or conditions and can be avoided by taking proper precautions as given below.

- **Maintain a firm grip with both hands on the saw and position your arms to resist kickback forces. Position your body to either side of the blade, but not in line with the blade.** Kickback could cause the saw to jump backwards, but kickback forces can be controlled by the operator, if proper precautions are taken.
- **When blade is binding, or when interrupting a cut for any reason, release the trigger and hold the saw motionless in the material until the blade comes to a complete stop. Never attempt to remove the saw from the work or pull the saw backward while the blade is in motion or kickback may occur.** Investigate and take corrective actions to eliminate the cause of blade binding.
- **When restarting a saw in the workpiece, centre the saw blade in the kerf so that the saw teeth are not engaged into the material.** If a saw blade binds, it may walk up or kickback from the workpiece as the saw is restarted.
- **Support large panels to minimise the risk of blade pinching and kickback.** Large panels tend to sag under their own weight. Supports must be placed under the panel on both sides, near the line of cut and near the edge of the panel.
- **Do not use dull or damaged blades.** Unsharpened or improperly set blades produce narrow kerf causing excessive friction, blade binding and kickback.
- **Blade depth and bevel adjusting locking levers must be tight and secure before making the cut.** If blade adjustment shifts while cutting, it may cause binding and kickback.
- **Use extra caution when sawing into existing walls or other blind areas.** The protruding blade may cut objects that can cause kickback.

### Lower guard function

- **Check the lower guard for proper closing before each use. Do not operate the saw if the lower guard does not move freely and close instantly. Never clamp or tie the lower guard into the open position.** If the saw is accidentally dropped, the lower guard may be bent. Raise the lower guard with the retracting handle and make sure it moves freely and does not touch the blade or any other part, in all angles and depths of cut.
- **Check the operation of the lower guard spring. If the guard and the spring are not operating properly, they must be serviced before use.** Lower guard may operate sluggishly due to damaged parts, gummy deposits, or a build-up of debris.
- **The lower guard may be retracted manually only for special cuts such as “plunge cuts” and “compound cuts”. Raise the lower guard by the retracting handle and as soon as the blade**



enters the material, the lower guard must be released. For all other sawing, the lower guard should operate automatically.

**NOTE:** Alternate wording for "retracting handle" is possible.

- **Always observe that the lower guard is covering the blade before placing the saw down on bench or floor.** An unprotected, coasting blade will cause the saw to walk backwards, cutting whatever is in its path. Be aware of the time it takes for the blade to stop after switch is released.

#### ADDITIONAL SAFETY AND WORKING INSTRUCTIONS

**Wear ear protectors.** Exposure to noise can cause hearing loss.

Use protective equipment. Always wear safety glasses when working with the product. The use of protective clothing is recommended, such as dust mask, protective gloves, sturdy non-slip footwear, helmet and ear defenders.

The dust produced when using the product may be harmful to health. Do not inhale the dust. Use a dust absorption system and wear a suitable dust protection mask. Remove deposited dust thoroughly, e.g. with a vacuum cleaner.

Do not use saw blades not corresponding to the key data given in these instructions for use.

Do not use any abrasive wheels.

Use only blade diameter(s) in accordance with the markings.

Identify the correct saw blade to be used for the material to be cut.

Use only saw blades that are marked with a speed equal or higher than the speed marked on the tool.

It is necessary to select a saw blade which is suitable for the material being cut.

Use only woodworking blades specified in this manual, which comply with EN 847-1.

Do not use abrasion disks in the product.

Do not fix the on/off switch in the "on" position when using the saw hand-held.

#### RESIDUAL RISKS

Even when the product is used as prescribed, it is still impossible to completely eliminate certain residual risk factors. The following hazards may arise and the operator should pay special attention to avoid the following:

- risk of contact with uncovered parts of the rotating saw blade;
- kick-back of work pieces or parts of work pieces due to improper adjustment or handling;
- catapulting of faulty carbide tips from the saw blade;

- damage to the respiratory system, dust may be harmful to the operator and bystanders.

**NOTE:** Wear respiratory protection masks containing filters appropriate to the materials being worked. Ensure adequate workplace ventilation. Do not eat, drink or smoke in the work area.

- damage to hearing if effective hearing protection is not worn.

**⚠ WARNING!** Dust from certain paints, coatings, and materials may cause irritation or allergic reactions to the respiratory system. Dust from wood such as oak, beech, MDF and others are carcinogenic. Material containing asbestos should only ever be worked or processed by qualified specialist operators.

**⚠ WARNING!** Injuries may be caused, or aggravated, by prolonged use of a tool. When using any tool for prolonged periods, ensure you take regular breaks.

#### SPECIFIED CONDITIONS OF USE

This electric circular saw can cut lengthways and mitre accurately in wood.

#### WORKING INSTRUCTIONS

Adapt the feed speed to avoid overheating the blade tips.

#### MAINS CONNECTION

Connect only to single-phase AC system voltage as indicated on the rating plate.

Appliances used at many different locations including wet room and open air must be connected via a residual current device (FI, RCD, PROD) of 30 mA or less.

When using the product, voltage fluctuations may affect other electrical products or lighting on the same power circuit. Connect the product to a power source with an impedance equal to  $0.477\Omega$  to minimize voltage fluctuations. Contact your electric power supplier for further clarification.

Only plug-in when product is switched off.

Do not let any metal parts enter the airing slots - danger of short circuit.

Keep mains lead clear from working range of the product. Always lead the cable away behind you.

Before use, check product, cable, safety harness, and plug for any damages or material fatigue. Repairs should only be carried out by authorised service agents.

#### MAINTENANCE

Always disconnect the plug from the socket before carrying out any work on the product.

Be sure to disconnect the product from the power supply before attaching or removing the saw blade.

Clean product and guarding system with dry cloth.

Certain cleaning agents and solvents are harmful to

plastics and other insulated parts.

The ventilation slots of the product must be kept clear at all times.

Remove dust regularly. Remove the sawdust which has accumulated inside the saw in order to avoid the risk of fire.

Keep the apparatus handle clean, dry and free of spilt oil or grease.

Check the function of guards.

Regular maintenance and cleaning provide for a long service life and safe handling.

If the replacement of the supply cord is necessary, this has to be done by the manufacturer or his agent in order to avoid a safety hazard.

If the supply cord is damaged, it must be replaced by a special cord or assembly available from the manufacturer or its service agent.

Use only AEG accessories and spare parts. Should components need to be replaced which have not been described, please contact one of our AEG service agents (see our list of guarantee/service addresses).

If needed, an exploded view of the product can be ordered. Please state the Article No. as well as the product type printed on the label and order the drawing at your local service agents or directly at:

**Techtronic Industries (Australia) Pty. Ltd.**

PO Box 1065  
Mount Waverley VIC 3149  
Tel. no. 1300 234 797  
Australia

**Techtronic Industries N.Z. Ltd.**

PO Box 12-806  
Penrose AUCKLAND 1642  
Tel. no. 0800 234 797  
New Zealand

**SYMBOLS**



**CAUTION! WARNING! DANGER!**



Please read the instructions carefully before starting the product.



Always wear goggles when using the product.



Wear ear protectors.



Wear a suitable dust protection mask.



Wear gloves.



Always disconnect the plug from the socket before carrying out any work on the product.



Do not use force.



Accessory - Not included in standard equipment, available as an accessory.



Do not dispose of electric tools together with household waste material. Electric tools and electronic equipment that have reached the end of their life must be collected separately and returned to an environmentally compatible recycling facility. Check with your local authority or retailer for recycling advice and collection point.



Class II product. Product in which protection against electric shock does not rely on basic insulation only, but in which additional safety precautions, such as double insulation or reinforced insulation, are provided. There being no provision for protective earthing or reliance upon installation conditions.



Rotation direction

**n<sub>0</sub>**

No-load speed

**V**

Volts





AC Current



Regulatory Compliance Mark (RCM). Product meets applicable regulatory requirements.



# AEG



[www.aegpowertools.com.au](http://www.aegpowertools.com.au)  
[www.aegpowertools.co.nz](http://www.aegpowertools.co.nz)

**Techtronic Industries Australia Pty Ltd**  
31 Gilby Road, Mount Waverley, VIC 3149  
Australia

**Techtronic Industries N.Z. Limited**  
2 Landing Drive, Mangere  
Auckland, 2022, New Zealand

961096493-01A

*AEG is a registered trademark used under  
license from AB Electrolux (publ).*

