



POWDER PUTTY

Multi-purpose interior & exterior filler



Proudly
Australian
Made &
Owned

Just Mix with Water

- **No Waste** • **Non Shrinking**

Earl's Powder Putty is a low cost filler with a high quality finish. It won't crack and fills to any depth.

Perfect for timber, masonry & metal

Earl's Powder Putty is the perfect filler to fill interior or exterior surfaces such as wood, plasterboard, cement sheeting, concrete and metal.

Cut, carve, sand or saw it

Earl's Powder Putty dries to a hardwearing finish and can be cut, carved, sanded or sawn.

Ideal for so many jobs

Use on timber, woodwork, walls and architectural or hobby moulding, windows, flooring, decking etc

What is required

With Earl's Powder Putty, you only need to mix enough for your immediate needs, so there is no waste.

Indefinite shelf life

Earl's Powder Putty has an indefinite shelf life, so no waste.

Use it for interior or exterior

Earl's Powder Putty is water resistant, weather proof but **NOT** waterproof. If using in an exterior situation ensure base material is stable. Earl's Powder Putty is not a flexible compound and is unsuitable as a filler where there may be structural movement.

Code	Size	Barcode	Pack Size
EWP05	500g	9315284530053	12
EWP1	1kg	9315284530060	6
EWP5	5kg	9315284530077	1
EWP10	10kg	9315284530138	1
EWP20	20kg	9315284530084	1

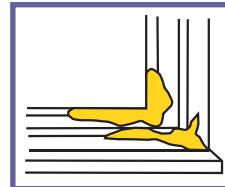

Patching

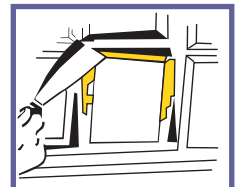

Rotted Timber

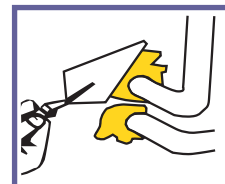

Masonry Fillings

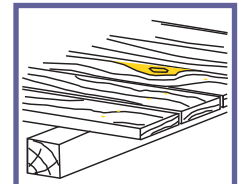

Timber Imperfections

- **Wood**
- **Concrete**
- **Steel**
- **Plasterboard**
- **Cement Sheets**
- **Masonry**

Easy to Apply

Prepare base material. Restore rotted wood with **Earl's Wood Hardener** and remove loose mortar and any contaminants such as oil, flaking paint, dirt, dust or sealant. Mix to required consistency and apply with a putty knife.

Slightly overfill and leave for 30 minutes before scraping off to level or mould to required shape. For a smooth finish, wipe with a damp sponge and wait 2-3 hours to sand. Apply a primer before decorating with paint. Note that Earl's Powder Putty does not absorb stain or colour as readily as wood, so a few coats may be required.

For further instructions, please refer to the product label.

Manufactured by Timbermate Products Pty Ltd

Phone (03) 9873 4811 or call
Toll Free 1800 354 811 (Except Mobiles)