

CLEANING PROCEDURE

If coating material was water based (acrylic paint), use **ONLY** water when performing the cleaning procedure. Use of solvent based cleaning materials on water based paints will result in a new substance that will be extremely difficult to clean.

If coating material was oil based (enamel paint, lacquer etc.) use **ONLY** the appropriate cleaning solution. Read the cleaning instructions printed on the coating material's label to determine which cleaning material you need. The following solvent based cleaning products are safe to use in the paint sprayer:

- Diggers Easy Cleanup Turpentine Substitute (highly recommended)
- Mineral Turpentine
- Paint Thinner

- 1 Empty the paint pot of remaining material.

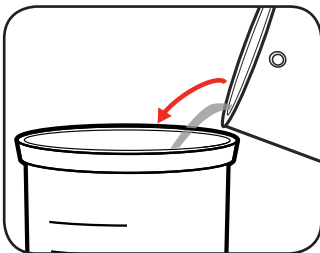

- 2 Rinse paint pot, suction tube & nozzle with cleaning solution. Wipe all parts with a clean cloth.

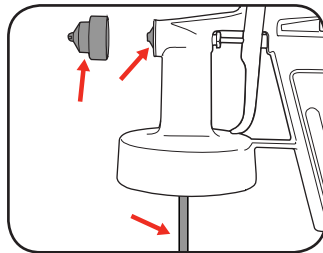

- 3 Fill paint pot with appropriate cleaning solution.

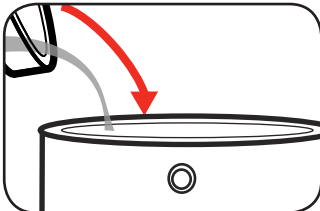

- 4 Connect the spray gun to the air supply then spray solution into a bucket.

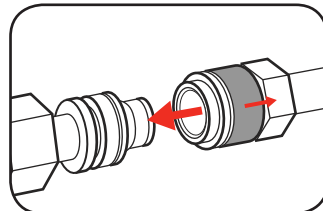

- 5 Repeat steps 3-4 until the cleaning solution runs clear from gun.

- 6 Unscrew and remove fluid adjustment dial, needle & spring. Clean all parts in cleaning solution.

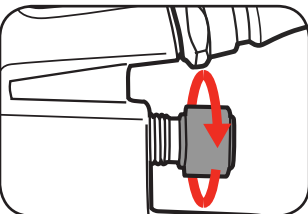

- 7 Unscrew and remove air cap, air nozzle and material nozzle. Clean in cleaning solution.

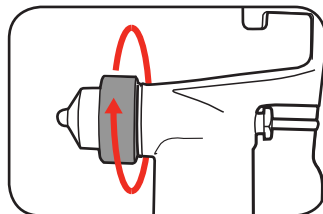

- 8 Take note of the holes on the air nozzle and material nozzle, if blocked clean carefully using a small needle.

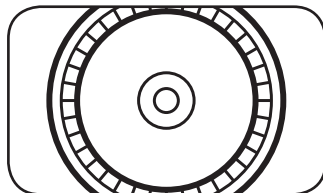

- 9 Ensure the 2 holes on the gun body are not blocked, clean if necessary. Dry all components and then re-assemble the spray gun.

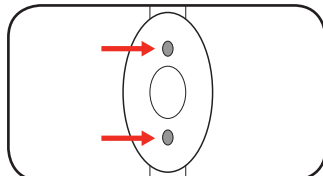

TROUBLE SHOOTING

Problem	Cause	Remedy
Little or no material flow	Fluid adjustment dial too limited	Turn fluid adjustment dial further out clockwise
	Air may be escaping between the gun body and paint pot	Ensure the black gasket is fitted to the gun body and the paint pot is attached tightly.
	Air pressure too low	Increase air pressure at the compressor
	Material too thick	Thin material
	Nozzle clogged	Clean nozzle
Material leaking	Nozzle loose	Tighten nozzle
	Nozzle worn	Contact Ozito for replacement spare parts
Spray pattern is heavy in the middle	Air pressure too low	Increase air pressure at the compressor
Spray pattern heavy at the edges	Air pressure too high	Reduce air pressure at the compressor
Spray jet pulsates	Material in paint pot running out	Refill paint pot
	Nozzle clogged	Clean nozzle
	Material too thick	Thin material
Pattern runs or sags	Too much material is being applied	Turn fluid adjustment dial further in clockwise
		Increase spray speed
	Material is too thin	Thicken material by adding more paint
Too much overspray	Gun too far from the spray surface	Reduce distance & turn fluid adjustment dial further in clockwise to reduce the amount of paint being applied.
Pattern is very light and splotchy	Material is too thick	Thin the material
	Moving the spray gun to fast	Decrease spray speed

SPARE PARTS

Nozzle Assembly
Needle Assembly
Paint Pot Seal
Paint Pot

SPASGPGU-04A
SPASGPGU-11A
SPASGPGU-05
SPASGPGU-07

Spare parts can be ordered from the Special Orders Desk at your local Bunnings Warehouse.

For further information, or any parts not listed here, visit www.ozito.com.au or contact Ozito Customer Service:

Australia 1800 069 486

New Zealand 0508 069 486

E-mail: enquires@ozito.com.au



GENERAL AIR TOOL SAFETY WARNINGS



WARNING! Read all safety warnings and all instructions. Failure to follow the warnings and instructions may result in electric shock, fire and/or serious injury.

Save all warnings and instructions for future reference. The term “power tool” in the warnings refers to your mains-operated (corded) power tool or battery-operated (cordless) power tool.

1. Work area safety

- Keep work area clean and well lit.** Cluttered or dark areas invite accidents.
- Do not operate power tools in explosive atmospheres, such as in the presence of flammable liquids, gases or dust.** Power tools create sparks which may ignite the dust or fumes.
- Keep children and bystanders away while operating a power tool.** Distractions can cause you to lose control.
- Dress properly. Do not wear loose clothing or jewellery. Keep your hair, clothing and gloves away from moving parts.** Loose clothes, jewellery or long hair can be caught in moving parts.
- Check the maximum pressure rating of any tools or accessories that you intend using with the compressor. The output pressure of the air from the compressor must be regulated so that it never exceeds the rated pressure of the tool or accessory.
- Always wear safety goggles or glasses when using the air compressor. Never point the nozzle of an accessory towards any part of your body or towards another person.
- Use safety equipment including safety goggles or shield, ear protection, breathing or respirator mask and protective clothing.
- The tool must be used only for its prescribed purpose. Any use other than those mentioned in this Manual will be considered a case of misuse. The user and not the manufacturer shall be liable for any damage or injury resulting from such cases of misuse.



WARNING! In the event that an air line is cut or broken, the air supply must be turned off at the compressor. A broken air line which is not supported is extremely dangerous and can whip around very quickly, both with the capability of striking people, and blowing foreign particles into the air.

- Do not attempt to catch the air line but immediately keep bystanders well clear and turn off the air supply to the hose, turn off the compressor at the On / Off button, and then remove the hose from the compressor.
- This appliance is not intended for use by persons (including children) with reduced physical, sensory or mental capabilities, or lack of experience and knowledge, unless they have been given the supervision or instruction concerning use of the appliance by a person responsible for their safety.
- Children should be supervised to ensure that they do not play with the appliance.



SPRAY GUN SAFETY WARNINGS



WARNING!

This appliance is not intended for use by persons (including children) with reduced physical, sensory or mental capabilities, or lack of experience and knowledge, unless they have been given supervision or instruction concerning use of the appliance by a person responsible for their safety.

Using an Extension Hose

Always use an approved extension hose suitable for the air input of this tool. Before use, inspect the hose for signs of damage, wear and ageing. Replace the extension hose if damaged or defective.

When using an hose on a reel, always unwind the lead completely.

It is recommended that the hose is a maximum of 25m in length.

NEVER under any circumstances aim the nozzle at another person or animal.

- In the event of an injury occurring, seek medical advice immediately.
- The spray gun must not be used for spraying flammable paints and solvents with a flash point of less than 21°C.
- Always ensure there is adequate ventilation when spraying.
- The use of ear protection is recommended.
- Eye protection is recommended to keep hazardous vapours and liquids out of eyes.
- Always wear a face mask when spraying.
- Always read the paint manufacturers thinning instructions before using.
- Always keep the spray nozzle in place during use. Never allow the spray to come in direct contact with the skin.
- Never immerse the spray gun in liquid.

- The spray gun must not be cleaned by using flammable liquids with a flash point of less than 21°C.

NEVER spray near a naked flame, including an appliance pilot light.

NEVER smoke whilst spraying.

NEVER allow children to operate or play with the spray gun.

- Before cleaning, always disconnect the appliance from the air supply.

- Always disconnect from air supply when refilling the paint pot.

- After every use ensure you clean your spray gun thoroughly.

NEVER use the spray gun outside when it is raining.

DESCRIPTION OF SYMBOLS

	Warning		Read instruction manual
	Wear ear protection		Wear eye protection and breathing mask
ml/min	Millilitres per minute	cfm	Cubic feet per minute

CARING FOR THE ENVIRONMENT



Power tools that are no longer usable should not be disposed of with household waste but in an environmentally friendly way. Please recycle where facilities exist. Check with your local council authority for recycling advice.



Recycling packaging reduces the need for landfill and raw materials. Reuse of recycled material decreases pollution in the environment. Please recycle packaging where facilities exist. Check with your local council authority for recycling advice.

ozito

SPRAY PUTTY GUN

160-260ml/min

INSTRUCTION MANUAL

SPECIFICATIONS

Working Pressure:	36psi (2.5Bar)
Max Air Pressure:	50psi (3.5Bar)
Air Consumption:	57-170l/min (2-6cfm)
Nozzle Size:	ø1.3mm
Jet Nozzle Spray Width:	ø40-70mm
Fan Nozzle Spray Width:	180-260mm
Flow Rate:	160-260ml/min
Feed Type:	Suction
Paint Pot Size:	1000ml
Air Inlet:	1/4" BSP
Weight (tool only):	0.61 kg

ozito.com.au



WHAT'S IN THE BOX

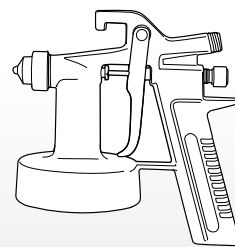

Spray Gun

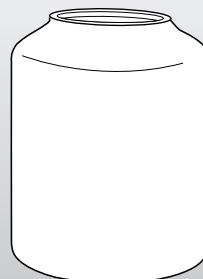

Paint Pot

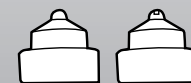

2x Nozzles

3

YEAR REPLACEMENT WARRANTY

ASG-PGU

WARRANTY

IN ORDER TO MAKE A CLAIM UNDER THIS WARRANTY YOU MUST RETURN THE PRODUCT TO YOUR NEAREST BUNNINGS WAREHOUSE WITH YOUR BUNNINGS REGISTER RECEIPT. PRIOR TO RETURNING YOUR PRODUCT FOR WARRANTY PLEASE TELEPHONE OUR CUSTOMER SERVICE HELPLINE:

Australia 1800 069 486

New Zealand 0508 069 486

TO ENSURE A SPEEDY RESPONSE PLEASE HAVE THE MODEL NUMBER AND DATE OF PURCHASE AVAILABLE. A CUSTOMER SERVICE REPRESENTATIVE WILL TAKE YOUR CALL AND ANSWER ANY QUESTIONS YOU MAY HAVE RELATING TO THE WARRANTY POLICY OR PROCEDURE.

The benefits provided under this warranty are in addition to other rights and remedies which are available to you at law.

Our goods come with guarantees that cannot be excluded at law. You are entitled to a replacement or refund for a major failure and for compensation for any other reasonably foreseeable loss or damage. You are also entitled to have the goods repaired or replaced if the goods fail to be of acceptable quality and the failure does not amount to a major failure.

Generally you will be responsible for all costs associated with a claim under this warranty, however, where you have suffered any additional direct loss as a result of a defective product you may be able to claim such expenses by contacting our customer service helpline above.

3 YEAR REPLACEMENT WARRANTY

Your product is guaranteed for a period of **36 months from the original date of purchase** and is intended for DIY (Do It Yourself) use only. If a product is defective it will be replaced in accordance with the terms of this warranty. Warranty excludes consumable parts.

WARNING

The following actions will result in the warranty being void.

- If the tool has been operated on a supply voltage other than that specified on the tool.
- If the tool shows signs of damage or defects caused by or resulting from abuse, accidents or alterations.
- Failure to perform maintenance as set out within the instruction manual.
- If the tool is disassembled or tampered with in any way.
- Professional, industrial or high frequency use.

KNOW YOUR PRODUCT

SPRAY PUTTY GUN

- | | |
|-----------------|-------------------------|
| 1 Air Nozzle | 4 Variable Trigger |
| 2 Nozzle Collar | 5 Fluid Adjustment Dial |
| 3 Paint Pot | 6 Air Inlet |

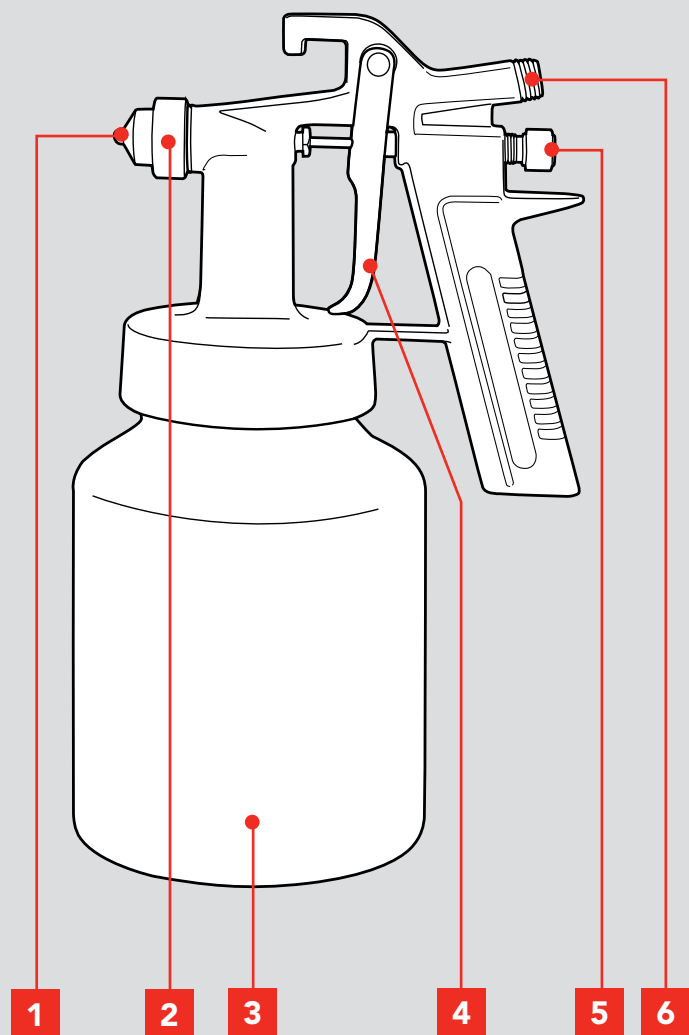

ONLINE MANUAL

Scan this QR Code with your mobile device to take you to the online manual.



SETUP & PREPARATION

1. ASSEMBLY



WARNING! ENSURE THE TOOL IS DISCONNECTED FROM THE AIR SUPPLY BEFORE PERFORMING ANY OF THE FOLLOWING OPERATIONS.

Installing the Paint Pot

Note: Ensure the black gasket is fitted to the inside of the gun head where the paint pot is inserted. This will prevent any air or paint leaking out.

- 1 Slide the paint pot over the suction tube and align with the head.
- 2 Screw the paint pot into place by rotating in a clockwise direction.

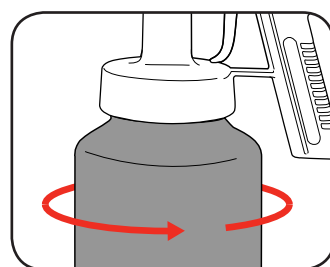
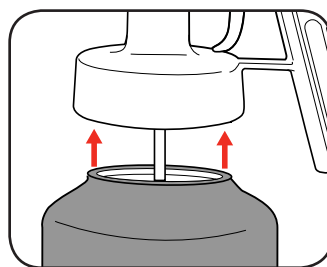

- 3 To remove, simply unscrew the paint pot in an anti-clockwise direction.

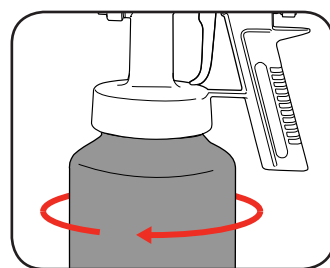

Attaching to Compressor

Note: Ensure the air inlet working pressure is set to 36PSI. Operating at a higher pressure than 50PSI will cause damage to the tool.

- 1 Wrap the threaded male air inlet of the spray gun with teflon tape in a clockwise direction.
- 2 Screw the female fitting clockwise onto the male end of the air inlet.

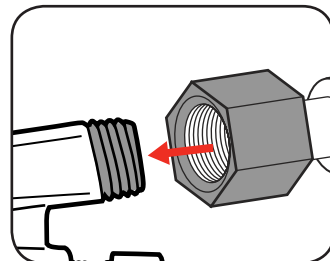
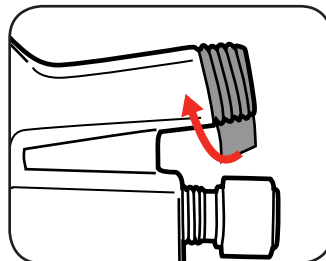

- 3 Pull back the sleeve on hose fitting, insert male end & release sleeve on hose fitting.

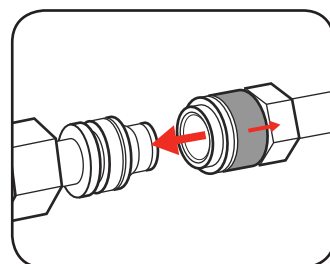

3 YEAR REPLACEMENT WARRANTY

OPERATION

2. PREPARATION

NOTE: FOR BEST RESULTS, SURFACE PREPARATION AND PAINT THINNING ARE THE TWO MOST IMPORTANT AREAS. ENSURE ALL SURFACES ARE FREE OF DUST, DIRT AND GREASE.

Thinning

Thinning is particularly important when spraying. Most paints are supplied ready for brush application and need to be diluted sufficiently for spraying purposes.

Follow the manufacturers guide for thinning ratios which should be labelled on the paint container.

- 1 Before pouring any paint or thinners work out how much of each substance is needed.

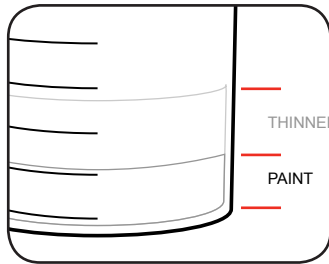

- 2 Pour the required paint and thinners through a filter into a mixing cup and then mix thoroughly.

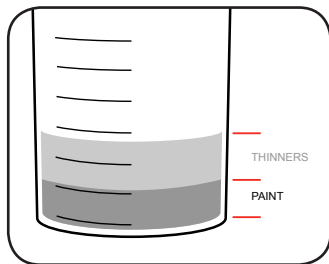

- 3 Once the correct viscosity is obtained, pour the mixture into the paint pot.

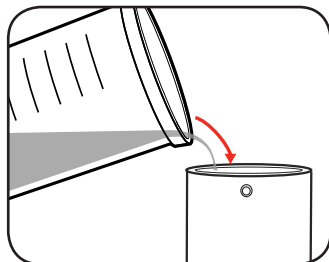

IMPORTANT! THE SPRAY GUN CANNOT BE USED WITH MATERIALS CONTAINING ABRASIVE SUBSTANCES, GLAZES, CAUSTIC AND ALKALINE SUBSTANCES.

3. ADJUSTING THE SPRAY GUN



IMPORTANT: IT IS NORMAL FOR AIR TO PASS THROUGH THE NOZZLE WITH THE TRIGGER CLOSED, TO PREVENT BLOCKAGES.

Variable Trigger

- 1 Press the variable trigger to allow fluid to be sprayed.

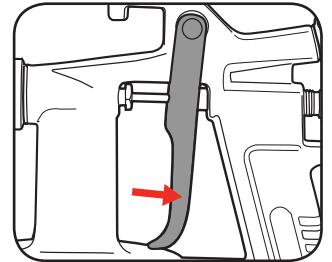

- 2 Release the variable trigger to stop spraying.

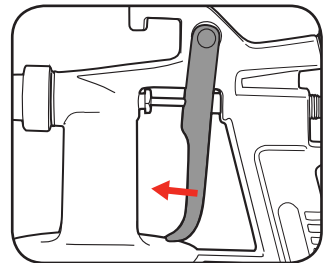

Note: The further the variable trigger is pressed, the more fluid will flow through the gun.

Fluid Adjustment Dial

The fluid adjustment dial is a stop that limits the distance the trigger can be pressed and can therefore limit the amount of paint being sprayed.

- 1 Fully tighten the fluid adjustment dial by rotating clockwise.

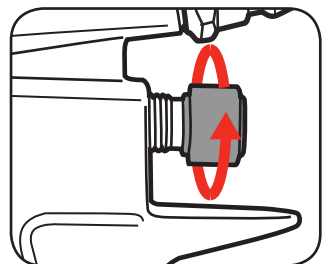

- 2 Slightly loosen the fluid adjustment dial by rotating anti-clockwise, then test setting on a scrap piece of material.

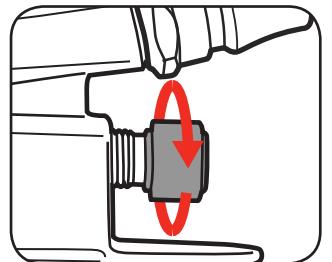

- 3 Repeat step 2 until desired fluid output is reached.

4. ADJUSTING THE SPRAY GUN CONT.

Changing Nozzles

The spray putty gun is supplied with two nozzles (a jet nozzle and a fan nozzle). The jet nozzle allows for ease of filling spots holes whereas the fan nozzle is used on wider work pieces for an even coat. Follow the steps below to swap between nozzles.

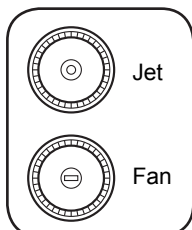

- 1 Loosen and remove the nozzle collar.

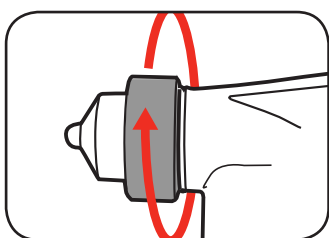

- 2 Replace the fitted nozzle with the desired nozzle.

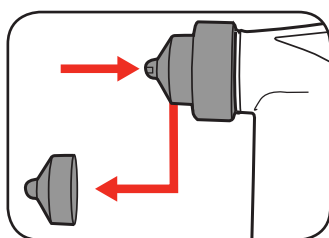

- 3 Fit the nozzle collar and tighten.

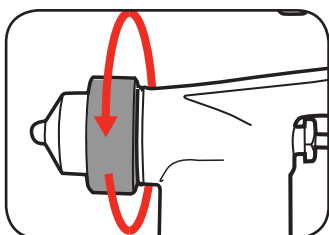

Choosing Spray Patterns

When using the fan nozzle, the direction of the slit will need to be rotated into the correct position for the desired direction of travel.

- 1 To change the spray pattern, loosen the nozzle collar and rotate the nozzle to the desired position. Tighten the nozzle collar to secure nozzle in place.

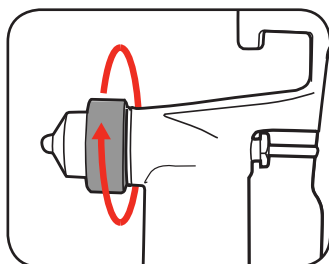

For vertical surfaces:

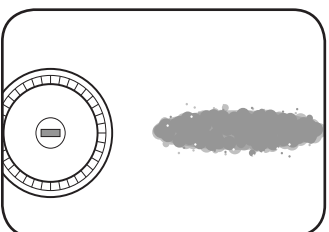

For horizontal surfaces:

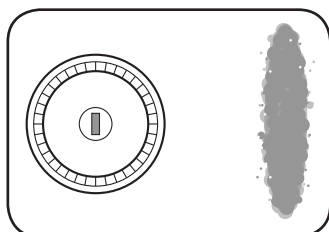

5. SPRAYING TECHNIQUE

1. Move the gun with the entire arm, not by flexing the wrist. This will keep the spray gun at right angles to the surface, keeping the pattern uniform.

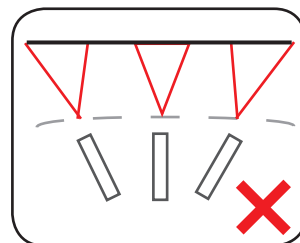
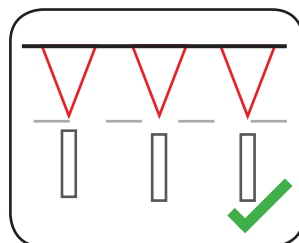

2. Keep the spray gun perpendicular to the surface, so spray distance is consistent.

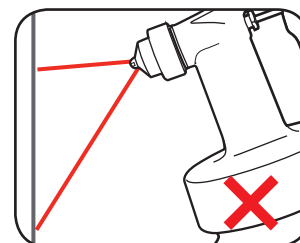
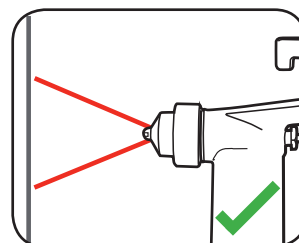

3. Begin 15cm off the edge of the area being sprayed. Start the movement of the stroke before squeezing the trigger. Release trigger once passed the opposite edge of the workpiece.

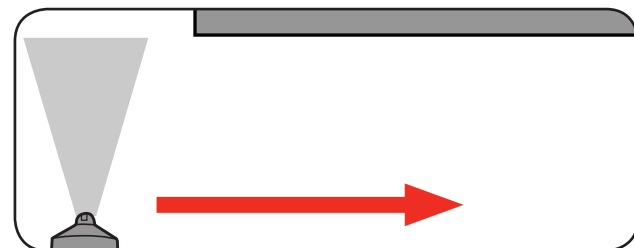

IT IS CRUCIAL TO CLEAN THE SPRAY GUN AFTER EACH USE. Please refer to the cleaning procedure.

Helpful Hints

1. Maintain the same distance from workpiece (approx 15cm) throughout each pass.
2. Maintain the same speed throughout each pass.
3. Always allow a coat to completely dry before adding another coat.
4. Avoid stopping and starting in the middle of workpiece as this can lead to a patchy finish.
5. Overlap each stroke by half the width of the previous stroke for even coverage.

NOTE: After each use it is essential that the spray gun is cleaned thoroughly. Failure to do so will likely cause blockages which will prevent the tool from working. **FAILURE TO CLEAN THE TOOL WILL VOID THE WARRANTY.**