

Contour 450

Wall hung Solid Surface basin

CIBO

Inspire Series



A contemporary wall hung basin with a sleek finish and a seamless appearance.

Ideal as smaller bathroom solution, it's the perfect solution for en suite, guest bathroom or powder room.

Solid Surface - is a composite material made from predominantly natural minerals (around 60%). Gibbsite (a component of bauxite) is combined with high grade polyester resin. The result is a non-porous and hygienic surfacing material with unlimited design possibilities.

Solid Surface material is renewable, meaning it can be restored to its original condition.

SET-OUT FOR LICENSED PLUMBER:

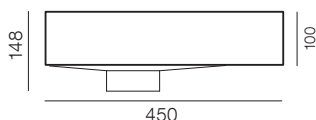
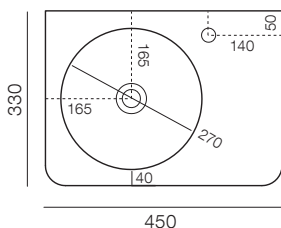

TOP/BASIN

Solid Surface

Requires: 32mm with overflow plug and waste

Tap hole options:

0 or 1 tap hole only

Plug & Waste and Tapware

sold separately

DIMENSIONS

W 450 x H 100 x D 330 mm

PACKAGED DIMENSIONS & WEIGHT

W 510 x H 180 x D 370mm, 15kg

WARRANTY

Three (3) years (see warranty information below).

INSTALLATION

- * Must be installed by a Licensed Plumber
- * Hang basin on wall using mounting bolt, screw and washer through both fixing holes.
- * Mounting bolts, screws and washers are included in box.
- * Ensure top and sides of basin are silicon sealed

DELIVERY/PICK UP & INSTALLATION

If your item is damaged or imperfect when opened, do not proceed with installation.

If a defective item is installed, CIBO is not liable for removal of the item, nor will CIBO accept responsibility to repair or replace the product. CIBO bathroomware should only be installed by a licensed plumber.

PRODUCT CARE & MAINTENANCE

Clean with a soapy sponge, followed by a gentle rinse. For stubborn stains such as lime scale or soap build up use a mild abrasive cleaner such as Gumption® paste, Jif® cream or AJAX® cream or powder – use with a soft damp cloth in wide circular motions. Finish by wiping off all residue with a clean, damp cloth.

CIBO DESIGN – WHO ARE WE?

Established in 1994 on Sydney's northern beaches, CIBO Design has built a solid reputation for its collection of high quality Australian-designed bathroomware. Specialising in producing innovative bathroom storage solutions, CIBO's products combine contemporary design and quality craftsmanship with practicality.

Warranty

This product is covered by a three (3) year replacement product warranty. Products which are within 3 years from the date of purchase, found upon inspection by an authorised representative to be defective will be repaired or exchanged with an equivalent product free of charge. Replaced items become CIBO Design's property. All replacement products will be available for collection without charge to the customer at the nearest Bunnings store to the customer's location, or elsewhere as agreed with the customer.

Warranty for Labour and Spare Parts – One (1) Year

The labour for the replacement of products and spare parts to which this warranty applies will be supplied by CIBO Design if the warranty claim is made within one (1) year from the date of purchase.

Spare parts which are within one (1) year from the date of purchase and found upon inspection by an authorised CIBO Design representative to be defective in construction, material or assembly, will be replaced free of charge. Products found to be faulty more than one (1) year from the date of purchase will be replaced free of charge by CIBO Design. After one (1) year from date of purchase, labour and spare parts costs are the responsibility of the customer.

Warranty Conditions

This warranty will apply only under all of the following conditions:

- The item has been installed by a licensed plumber;
- This item has been installed for and subjected to domestic residential use only;
- Failure is due to the manufacture of the product;
- Proof of purchase (including date

of purchase) is provided;

• The installation of the product is in accordance with the instructions provided. This warranty does not include faults caused by:

- Unsuitable or improper use;
- Incorrect installation or installation not in accordance with the instructions provided;
- Installation or part installation by the purchaser or any person other than a Licensed Plumber;
- Normal wear and tear including water* and natural causes such as sunlight, humidity and other environmental conditions or factors;
- Inadequate or complete lack of maintenance;
- Chemical, electrochemical or electrical influences;
- Harsh detergents or abrasive cleaners used on product finishes

*Important note: CIBO Design vanity cabinets are manufactured from Moisture Resistant (MR) materials but are not waterproof. Care must be

taken to dry spillages or leakage of water that may gain access to cabinetry. Accurate sealing of the vanity cabinet and kickboard (where applicable) is vital for proper maintenance of the product and ensuring longevity.

Exclusions - To the fullest extent permitted by law, CIBO Design excludes all liability for damage or injury to any person, damage to any property, and any indirect consequential or other loss or damage.

Warranty Claim Procedure - Please retain your receipt and contact the 'Returns and Exchanges' Desk at the Bunnings store where you purchased the product. Warranty claims can also be sent to: CIBO Design, After Sales Service PO Box 7461, Warringah Mall, Brookvale NSW 2100

Our goods come with guarantees that cannot be excluded under the Australian Consumer Law. You are entitled to a replacement or refund for a major failure and compensation

for any other reasonably foreseeable loss or damage. You are also entitled to have the goods repaired or replaced if the goods fail to be of acceptable quality and the failure does not amount to a major failure.

The benefits to the customer given by this CIBO Design warranty are in addition to any other rights and remedies available to the customer as a consumer under any laws that relate to the goods covered by this CIBO Design warranty.

CIBO Design Pty Ltd
1/130 Old Pittwater Road
Brookvale NSW Australia
Postal: PO Box 7461, Warringah Mall,
Brookvale NSW 2100
Tel: (02) 9939 4434
Email: aftersales@cibodesign.com.au