



MULTISTORE

DRAWER INSTRUCTIONS TO SUIT EXC-4J UNITS - PART 2

NO	MODEL	DESCRIPTION	QTY
1		CONFIRMAT SCREWS	16
2		DOWELS	16
3		BACKING NAILS	120
4		16mm WOOD SCREWS	24
5		INFILL	1

NO	MODEL	DESCRIPTION	QTY
6		CAMS	8
7		CAM PINS	8
8		60mm WOOD SCREW	3
9		EURO SCREWS	16
10		HANDLE	4
11		RUNNERS PER SET	4

STEP 1.

LAYOUT YOUR DRAWER PIECES FLAT AS PER DESIGN WITH PRE-DRILLED HOLES FACING UP.

START WITH THE BACK OF THE FRONT DRAWER AND PLACE YOUR DOWELS & CAM PIN IN THE PRE-DRILLED HOLES ON EITHER SIDE AS INSTRUCTED BELOW.

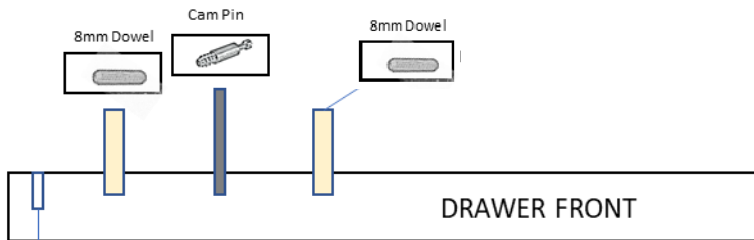

Cut out for drawer base on drawer front

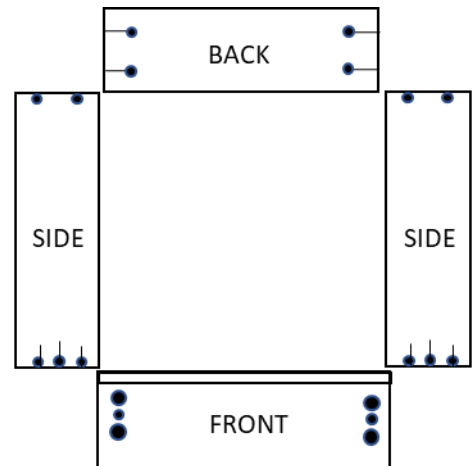

STEP 2.

GRAB YOUR FIRST SIDE AND INSERT YOUR CAMS INTO THE HOLE PROVIDED ON THE OUTSIDE OF THE DRAWER SIDE GENTLY AS PER INSTRUCTIONS BELOW.



IMPORTANT NOTICE:

PLACE THE FITTING OVER THE HOLE KEEPING THE SQUARE EDGE OF THE FITTING PARALLEL TO THE FACE OF THE BOARD, KNOCK IN **CAREFULLY**.

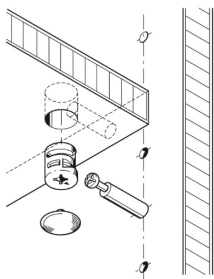

PUSH THE SIDE INTO THE FRONT DOWELS & PIN AND THEN CAREFULLY USING A SCREW DRIVER TURN UNTIL IT LOCKS IN. REPEAT THIS PROCESS WITH THE OTHER SIDE.

NOW PLACE YOUR LAST PIECE BETWEEN THE TWO SIDES USING THE SCREW NO: 1 SUPPLIED SCREW INTO THE SIDES OF THE BACK DRAWER PIECE.

DRAWER ASSEMBLY

STEP 3.

YOUR DRAWER SHOULD BE FACING DOWN WITH THE FRONT DRAWER EXPOSING THE CUTOUT FOR THE BASE TO BE PUSHED INTO FACE DOWN WITH THE BROWN SIDE SHOWING. MAKING SURE YOU HAVE THE DRAWER SQUARE, PROCEED TO NAIL DOWN THE BASE SPACING THEM OUT AROUND THE EDGE OF THE THREE SIDES.

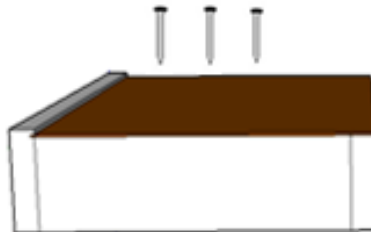

STEP 4.

USING THE HANDLE SCREW (NO:4) ATTACH THE HANDLE TO THE BACK OF THE DRAWER FRONT INTO THE PREDRILLED HOLES ALREADY PROVIDED.

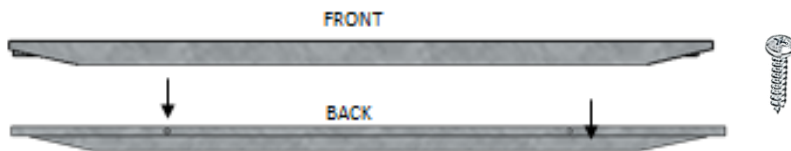

STEP 5.

PLACE YOUR DRAWER RUNNER ON THE BOTTOM OF THE DRAWER USING THE WOOD SCREWS PROVIDED No: 4 SCREW TWO INTO EACH RUNNER . REPEAT FOR THE OTHER SIDE.

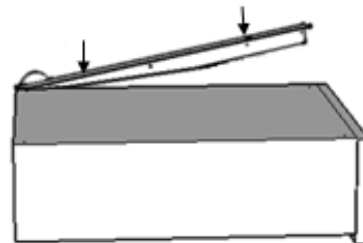

PICTURE OF YOUR FINISHED DRAWER



Multistore Industries (Aust) Pty Ltd

9 Nevilles Street, Underwood, QLD 4119

Tel—(07) 3208 6799

Fax- (07) 3209 6332

www.multistore.com.au

sales@multistore.com.au

INSTRUCTIONS FOR RUNNER PLACEMENT

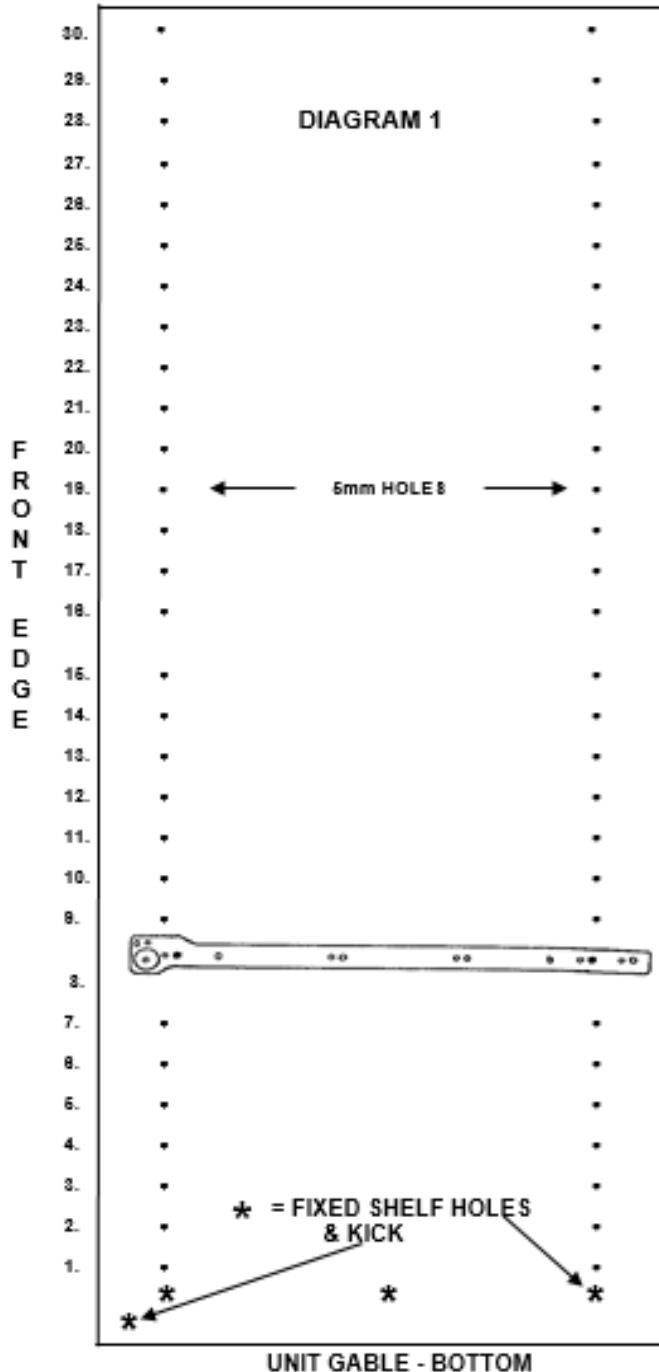

Place metal runners in their correct hole positions (see above) making sure CL = LEFT HAND GABLE & CR = RIGHT HAND GABLE, then attach using the special 7.5mm euro screws provided (see diagram 1)

IMPORTANT

Executive Series

Models	Hole Positions	Fixed Shelf Position
EXC - 4J	1 - 8 - 15 - 22	N/A
EXC - 5C	1 - 8 - 15 - 20 - 25	N/A
EXC - 4B	8 - 16 - 24 - 32	N/A
EXC - 2B	8 - 14	N/A
EXB - 5C	1 - 8 - 15 - 20 - 25	N/A
EXB - 4J	1 - 8 - 15 - 20	N/A
EXB - 4B	8 - 16 - 22 - 28	N/A

MAXI ULTRA 'H' SERIES

Models	Hole Positions	CAM PIN-Hole Positions
H1	1	8
HS2	1	8 - 15
H2	1 - 8	13
HS		8

MAXI ULTRA & ULTRA SERIES

Models	Hole Positions	Models	Hole Positions
450	1-6-11-16	LSD550	1-8
315C	1-8-15-20	LSD330	1
515	1-6-11-16-21		

Executive 750 'H' SERIES

Models	Hole Positions	CAM PIN-Hole Positions
HS		8
H1	1	8
H2	1 - 6	11
H3	1 - 8 - 13	20

MAXI & MSM SERIES

Models	Hole Positions	Fixed Shelf Position
16J3	1 - 8 - 15	22
C16	1 - 8 - 15 - 20 - 25	30
C06	1 - 8 - 15 - 20 - 25	30
600J3	8 - 15 - 22	
400J3	1 - 8 - 15	

7.5mm EURO SCREW
NOTE: MAKE SURE CORRECT HOLES ARE USED.

