

# AEG

**AP218E2-0**

Original instructions

## **Important!**

This appliance is not intended for use by persons (including children) with reduced physical, sensory or mental capabilities, or lack of experience and knowledge, unless they have been given supervision or instruction concerning use of the appliance by a person responsible for their safety.

Children should be supervised to ensure that they do not play with the appliance.

It is essential that you read the instructions in this manual before operating this machine.

Subject to technical modifications.

- 1. Collapsible handle
- 2. Battery cover
- 3. Washable HEPA filter
- 4. On/off switch
- 5. Speed selector
- 6. Blower adapter
- 7. Battery ports
- 8. Latch
- 9. Vacuum port
- 10. Extension tube
- 11. Air regulator
- 12. Power tool adaptor
- 13. Crevice tool
- 14. Foam sleeve filter
- 15. Dust bag
- 16. Anti-crush hose
- 17. Floor tool
- 18. Round brush
- 19. Caster feet
- 20. Caster feet screw

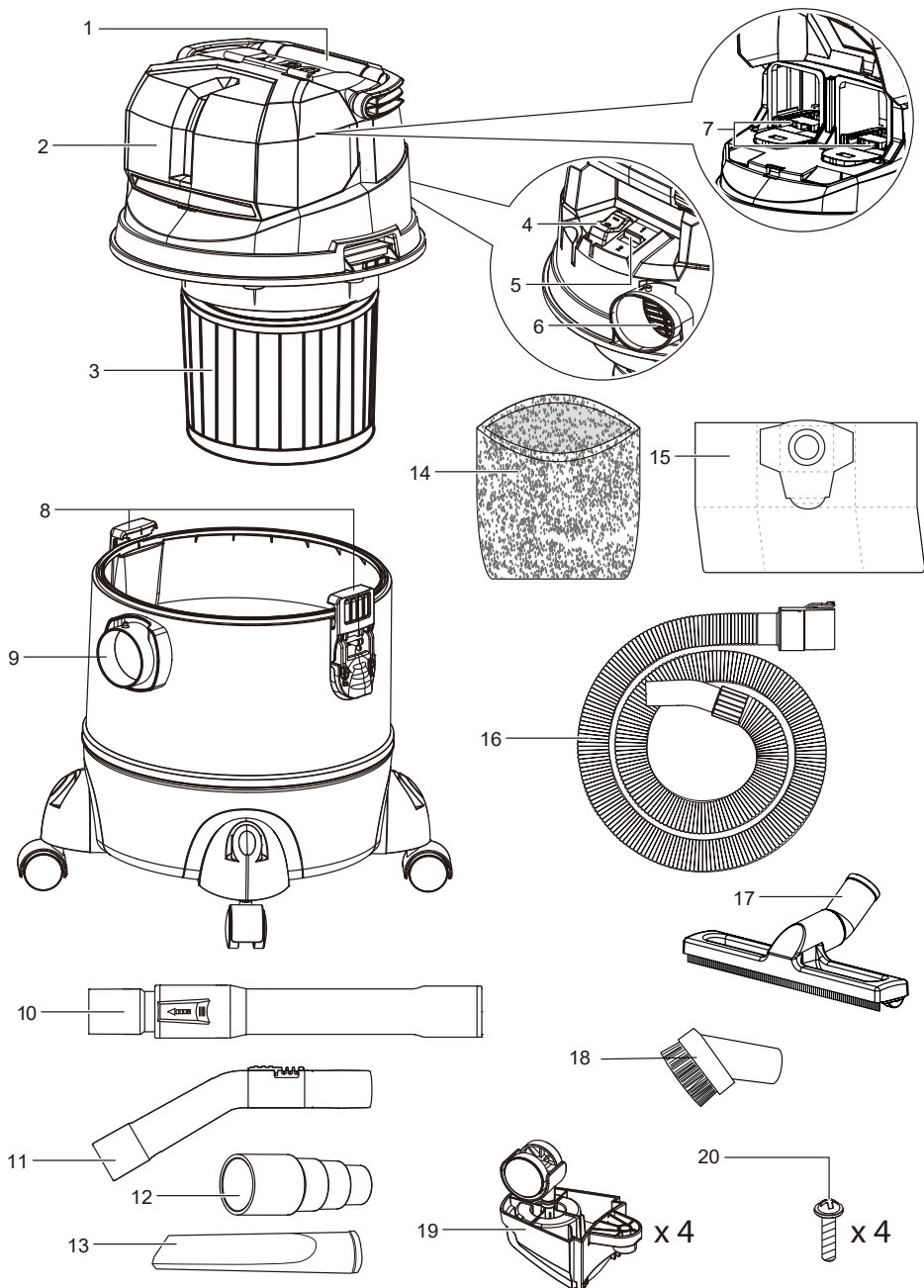

Fig. 1

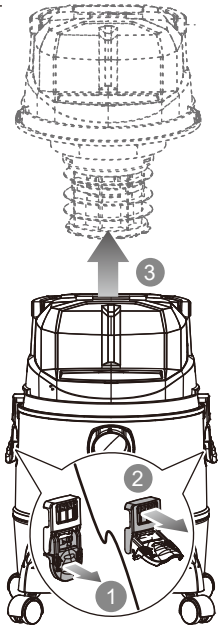

Fig. 2

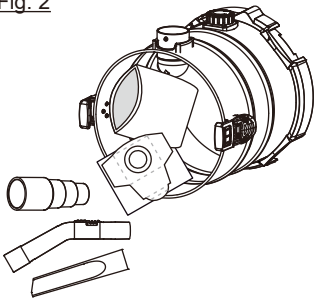

Fig. 3

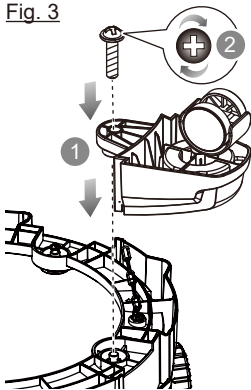

Fig. 4

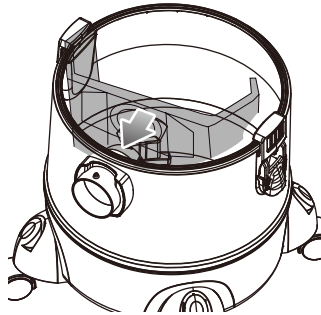

Fig. 5

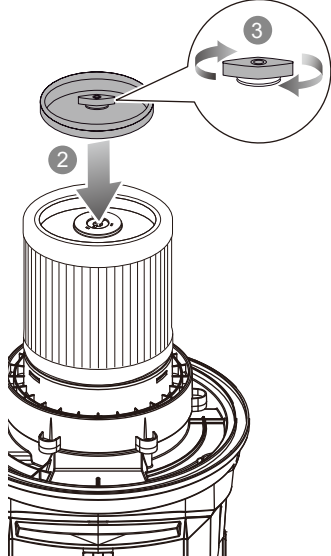
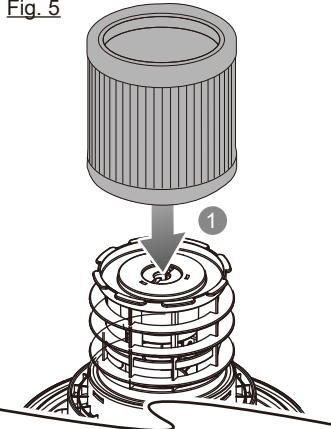

Fig. 6

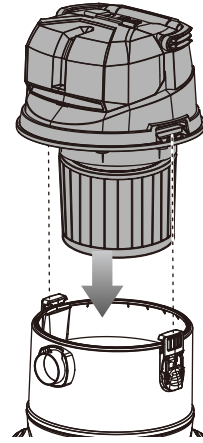

Fig. 7

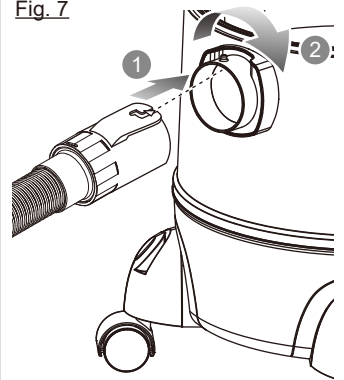

Fig. 8

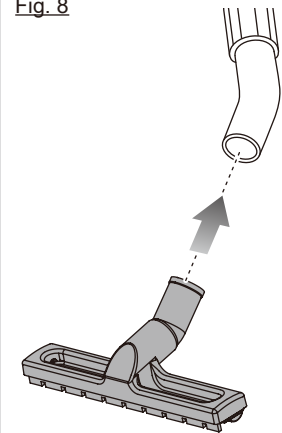

Fig. 9

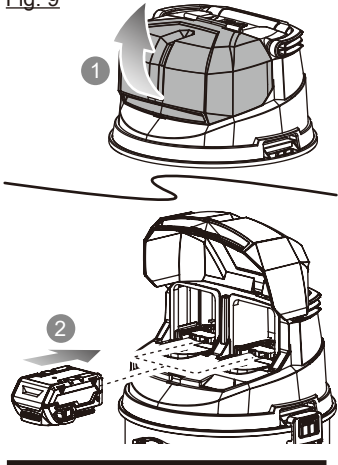

Fig. 10

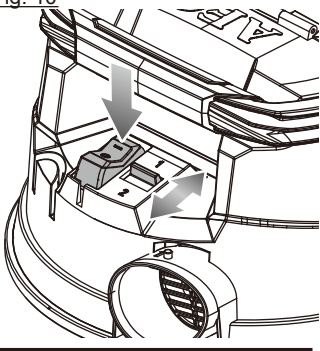

Fig. 11

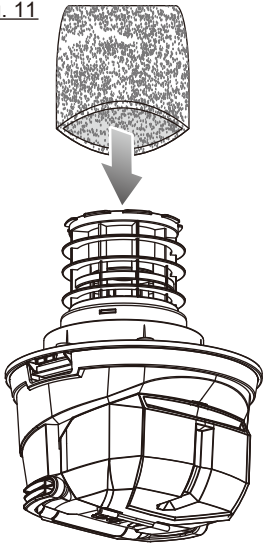

Fig. 12

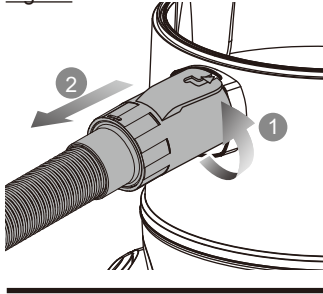

Fig. 13

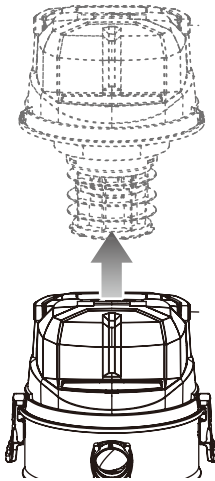

Fig. 14

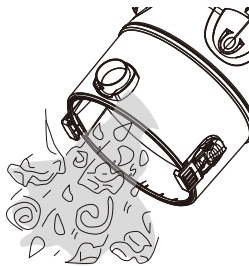

Fig. 15

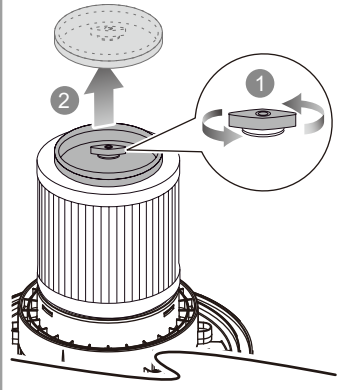

Fig. 16

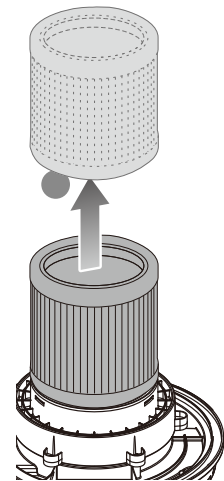
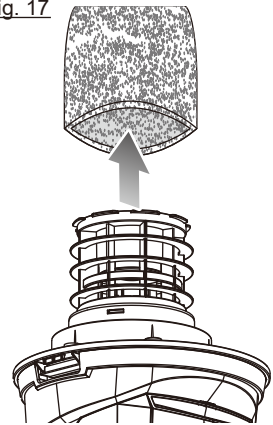
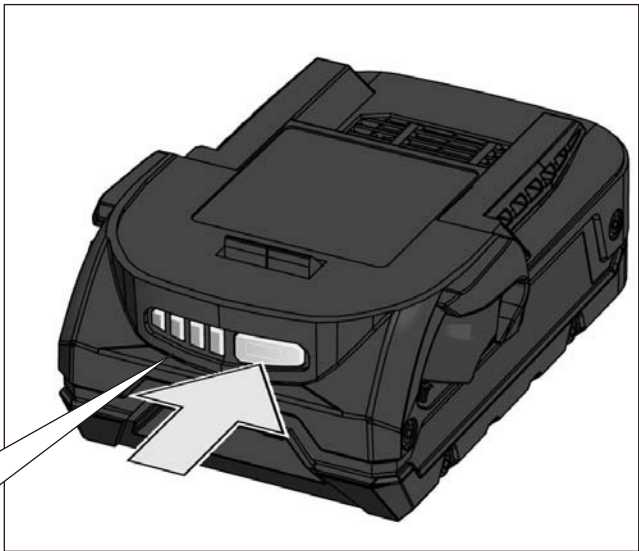
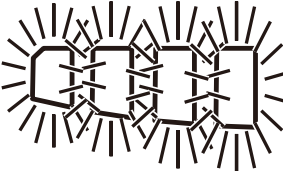

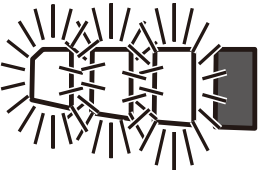

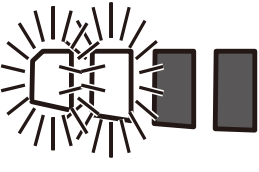

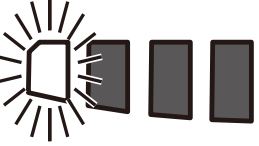



Fig. 17





		75-100 %
		50-75 %
		25-50 %
		0-25 %

Rated voltage.....	18 V ===
Suction power.....	12 kPa
Air flow.....	1,500 L/min
Tank volume.....	20 L
Weight - not including battery pack.....	4.9 kg
Ingress protection.....	IPX4
Electrical Wattage/Current draw.....	2 A
HEPA Filter rating.....	H12
Hose Length.....	1.8 m
Hose diameter.....	35 mm
Operation Noise figures.....	≤85 dBA

**BATTERY AND CHARGER**

Compatible battery pack (not included)	Compatible charger (not included)
Model series L18XXR includes models below:	
L1815R	
L1820R	AL18G
L1825R	AL1218G
L1830R-X5	BL1218
L1840R	BLK1218
L1850R	BL18DP-X5
L1860R	BL18DP2-X5
L1860R-X5	BL18DPS
L1890R	

Use AEG 18V battery and charger only

**⚠ WARNING! Read all safety warnings and all instructions.**

Failure to follow the warnings and instructions may result in electric shock, fire and/or serious injury.

**Save all warnings and instructions for future reference.**

**DUST EXTRACTOR SAFETY WARNINGS**

- The product is designed solely for use in the private sector and for the designated purpose. The product is not suitable for commercial use. Do not use the product outdoors (unless it has been specifically designed for use outdoors). Do not subject the product to heat, direct sunshine or very high moisture (e.g., rain).
- Never immerse the product in liquids and be aware of sharp edges that may damage it. Never use the product with wet or damp hands. Remove all battery packs immediately if the product becomes wet or damp when it is running. Do not immerse the appliance in water.
- The product may only be used and kept in a private home.
- The product is designed to vacuum up materials that are not hazardous to your health and that are not flammable.
- Never hold the connectors in front of your face (especially your eyes, ears, etc.). Never direct the nozzle towards persons or animals.
- Only use the product for its designated purpose. Any other types of use are at your own risk and are possibly dangerous.
- Other uses and unattended operation are not allowed.
- The manufacturer cannot be made responsible for damages that are caused by improper use or incorrect operation.

- Wear protective clothing and gloves.
- Make sure that the correct dust bag has been inserted securely in its holder before using the product. The wrong dust bag or incorrectly installed dust bags can cause damage to the product and cause the guarantee to become void.
- Do not vacuum up ashes, hot coals and the like, large fragments of glass and sharp objects.
- Do not vacuum up any printer toner dust as it is electrically conductive. In addition, it is possible that it will not be completely filtered out by the filter system of the wet/dry vacuum cleaner and can be released into the air via the exhaust fan.
- Never vacuum flammable or poisonous liquids like petrol, oil, acids, or other volatile substances.
- Do not vacuum up liquids that are hotter than 60°C or any poisonous or flammable dusts.
- Never lay the product on its side. Pay particular attention to a horizontal position and adequate stability on stairs.
- Always remove all battery packs after use and before cleaning or changing the filters or accessories.
- Only trained specialists may make repairs on electric equipment. Improper repairs could result in considerable danger to the user.
- Do not store the product directly beside a hot oven or radiator.
- Children, disabled persons, and the aged are often not aware of the dangers that can result from handling electric appliances. The above mentioned persons and untrained persons must never work with this electrical appliance.
- When cleaning or removing the product, always switch it off. Remove all battery packs, if you are not going to use the product for an extended period of time. Also, remove any special accessories from the product.
- Always keep the product clean. Do not use any solvents or cleaners that may damage or be harmful to the product or user.
- Never leave the product switched on unattended. If you leave the work area, switch the product off and remove all battery packs.
- In order to protect children from electric household appliances, do not give children access to the product.
- Never use the product when you are under the influence

of medication, alcohol or drugs, if you are currently under medical care, or if you are tired.

- Check the product regularly for any possible damage. Do not use damaged appliances.
- Do not try to repair the product yourself. Always use an authorised technician for repairs.
- Only use original spare parts and accessories. Non approved parts or third-party accessories may be a possible source of danger and cause the guarantee to become void.
- If you notice liquid leaking from the product, switch it off immediately and remove all battery packs.
- Do not submerge the product in water. Make sure that water is not spilled on the product.
- When disposing of the wastewater, make sure that you observe any legal regulations.
- Only store the product in a safe and dry location outside the reach of children.
- This appliance is not intended for use by persons (including children) with reduced physical, sensory or mental capabilities, or lack of experience and knowledge, unless they have been given supervision or instruction concerning use of the appliance by a person responsible for their safety.
- Children should be supervised to ensure that they do not play with the appliance.
- Never vacuum up hot ashes, pointed or sharp objects.
- Never use the product in damp rooms.
- Do not use the product without a dust bag (an exception is wet vacuuming or with the cartridge filter). Make sure that the dust bag is inserted into the appliance correctly.
- When using the product, make sure that no hair, clothing, or members are drawn in.
- Keep the vacuum cleaner away from heat sources such as radiant heaters, ovens, and so on.
- If the hose or tools are blocked, switch off the product and remove the blockage(s) before re-starting the product.
- Cleaning filters and replacing them regularly maintains vacuum performance. We recommend that your filters should be checked, cleaned and replaced periodically.
- Damage to the vacuum cleaner caused as a direct result of not adhering to the general safety information and the instructions in this user guide invalidates the warranty.
- Cleaning and user maintenance shall not be made by children without supervision.
- Rechargeable batteries are to be removed from the appliance before being charged.
- Exhausted batteries are to be removed from the appliance and safely disposed of.
- If the appliance is to be stored unused for a long period, the batteries should be removed.
- The supply terminals are not to be short-circuited.

#### SPECIFIED CONDITIONS OF USE

This cordless wet/dry vacuum is intended for household use. It may be used for light vacuuming of wet or dry media.

#### CAUTION

Danger of explosion if battery is incorrectly replaced. Replace only with the same or equivalent type.

#### ASSEMBLY

#### CAUTION

Use only manufacturer's approved vacuum filters and filter bags. Before attempting to use or before cleaning this vacuum, be sure that you fully understand the instructions for setting up or cleaning/changing filters.

#### UNPACKING THE PRODUCT AND GENERAL ASSEMBLY

See figure 1-8.

1. Verify that no battery pack is inserted in the battery port(s).
2. Undo the latches.
3. Lift the power head off the tank (Fig 1).
4. Remove the contents from inside the tank and carton. Make sure you have all contents as listed in component list (Fig 2).
5. Turn the tank upside down and insert the four caster feet into the slots on the base. Apply downward pressure to each caster. Verify that the casters are mounted correctly. Lock the casters in place with the provided screws (Fig 3).
6. The product comes ready for dry vacuum cleaning. If HEPA filter is not installed, refer to the Installing HEPA filter section for instructions of installation (Fig 5).
7. Fit collection bag flange onto the inlet stub, taking care not to damage the bag (Fig 4).
8. For wet vacuum cleaning, remove the HEPA filter and collection bag. Install the supplied foam filter. Refer to the Installing foam sleeve filter section for instructions of installation (Fig 11).
9. Place the power head back on the tank, aligning the top section with the latches, and hook the latches (Fig 6).
10. Insert the locking end of the hose into the vacuum port and turn to lock into place (Fig 7).
11. Choose the desired accessories and push onto the suction tube (Fig 8).

#### WARNING

If filters are contaminated or damaged, they must be replaced prior to performing wet vacuuming operations.

#### BATTERY PORTS

The product is equipped with dual battery ports for an extended operation time per use. When two battery packs are inserted, the product draws power from the battery pack at the left port first. When the battery pack at the left port is fully discharged, the product will begin drawing power from the battery pack at the right port.

#### INSTALLING/REMOVING BATTERY PACK

See figure 9.

The product is operated by an AEG 18V battery pack.

1. Open the battery port cover (Fig 9).
2. Place the battery pack in the product, aligning the ribs on the battery pack with the grooves in the battery port (Fig 9).



3. Make sure the latches on the battery pack snap into place and the battery pack is secured to the product before beginning operation.

## OPERATION

### DRY VACUUMING

See figure 4-11.

#### ⚠ WARNING

Be sure to read, understand all warnings and instructions in the manual before use. Do not vacuum in areas with flammable gases, vapours, or explosive dusts in the air.

#### ⚠ WARNING

Flammable gases or vapors include but are not limited to; lighter fluid, solvent type cleaners, oil-base paints, gasoline, alcohol or aerosol sprays. Explosive dusts include but are not limited to; coal, magnesium, grain or gun powder. To reduce the risk of health hazards from vapors or dust, do not vacuum toxic materials.

#### CAUTION

Never operate the vacuum cleaner without all of the filters installed. This includes the HEPA filter and collection bag. Motor damage, loss of operating efficiency and recirculation of hazardous material into the work area will take place if not installed. Make sure no battery pack is inserted in the battery ports before assembly.

**NOTE:** Make sure the power tool adaptor is fully fitted into the dust port of the power tool.

1. Verify that no battery pack is inserted in the battery ports.
2. In order to prepare your vacuum for dry vacuuming, verify that the HEPA filter is securely mounted. With power head removed and in upside down position, make sure the filter is pushed in until it stops against the power head and the filter cap is installed. Turn the locking knob clockwise to lock the filter cap in place (Fig 5).
3. For improved dust collecting, fit collection bag flange onto the inlet stub, taking care not to damage the bag (Fig 4).
4. Place the power head back on the tank, and secure it in place using the latches (Fig 6).
5. Insert the locking end of the hose into the vacuum port and lock in place. Push the required attachment onto the free end of the hose or extension (Fig 7).
6. Open the battery port cover and insert a battery pack in the battery port (Fig 9).
7. Turn the motor on by turning the switch to the 'I' ON position (Fig 10).
8. Slide the speed selector for the desired vacuuming speed.
9. Once you have completed vacuuming, flip the switch to the 'O' OFF position and remove all battery packs from the battery ports (Fig 10).

#### ⚠ WARNING

If filters are contaminated or damaged, they must be replaced prior to performing wet vacuuming operations.

**NOTE:** Do not use the HEPA filter for wet vacuuming.

### WET VACUUMING

See figure 11.

#### ⚠ WARNING

Be sure to read, understand all warnings and instructions in the manual before use. Do not vacuum in areas with flammable gases, vapours, or explosive dusts in the air.

#### ⚠ WARNING

Flammable gases or vapors include but are not limited to; lighter fluid, solvent type cleaners, oil-base paints, gasoline, alcohol or aerosol sprays. Explosive dusts include but are not limited to; coal, magnesium, grain or gun powder. To reduce the risk of health hazards from vapors or dust, do not vacuum toxic materials.

1. Verify that no battery pack is inserted in the battery ports. Verify that the tank is clean and free of dust and dirt.
2. Remove the HEPA filter and dust bag (Fig 16 & reverse of Fig 4).
3. Rinse out the inside of tank to remove any loose debris.
4. Carefully install the foam sleeve filter over the filter cage and place the power head back on the tank (Fig 11).

**NOTE:** Do not use the HEPA filter for wet vacuuming.

#### ⚠ WARNING

If filters are contaminated or damaged, they must be replaced prior to performing wet vacuuming operations.

### Wet vacuuming operation instructions

1. Fit the desired nozzle to the vacuum hose.
2. Verify that the switch is in the 'O' OFF position before inserting the battery pack.
3. Open the battery port cover and insert a battery pack in the battery port (Fig 9).
4. Turn the motor on by flipping the switch to the 'I' ON position (Fig 10).
5. After use, empty the tank (Fig 15).

**NOTE:** Do not use the HEPA filter for wet vacuuming.

**NOTE:** When vacuuming large quantities of liquids, do not immerse the nozzle completely in the liquid. Leave a gap at the tip of the nozzle opening to allow air inflow.

The machine is fitted with a float valve that stops the suction action when the tank reaches its maximum capacity. You will notice an increase in motor speed.

When this happens, turn off the machine, remove all battery

packs, and drain the liquid into a suitable receptacle or drain. To continue vacuuming, refill the tank with the drain cap. After wet vacuuming, turn the machine off and remove all battery packs. Empty the tank, clean and dry the inside and outside before storage.

The foam filter must be removed after wet vacuuming, and the HEPA filter must be reinstalled before dry vacuuming again.

## BATTERIES

Battery packs which have not been used for some time should be recharged before use.

Temperatures in excess of 50°C reduce the performance of the battery pack. Avoid extended exposure to heat or sunshine (risk of overheating).

The contacts of chargers and battery packs must be kept clean. For an optimum life-time, the battery packs have to be fully charged, after used.

To obtain the longest possible battery life remove the battery pack from the charger once it is fully charged.

### For battery pack storage longer than 30 days:

- Store the battery pack where the temperature is below 27°C and away from moisture.
- Store the battery packs in a 30% - 50% charged condition.
- Every six months of storage, charge the pack as normal.

## TRANSPORTING LITHIUM BATTERIES

Lithium-ion batteries are subject to the Dangerous Goods Legislation requirements.

Transportation of those batteries has to be done in accordance with local, national and international provisions and regulations.

- The user can transport the batteries by road without further requirements.
- Commercial transport of Lithium-Ion batteries by third parties is subject to Dangerous Goods regulations. Transport preparation and transport are exclusively to be carried out by appropriately trained persons and the process has to be accompanied by corresponding experts.

When transporting batteries:

- Ensure that battery contact terminals are protected and insulated to prevent short circuit.
- Ensure that battery pack is secured against movement within packaging.
- Do not transport batteries that are cracked or leak.

Check with forwarding company for further advice

## BATTERY PACK PROTECTION

The battery pack has overload protection that protects it from being overloaded and helps to ensure long life. Under extreme stress the battery electronics switch off the machine automatically. To restart, switch the machine off and then on again. If the machine does not start up again, the battery pack may have discharged completely. In this case it must be recharged in the battery charger.

## MAINTENANCE

See figure 12-14.

## ⚠ WARNING

Always remove all battery packs before removing the power head from the tank.

1. Verify that no battery pack is inserted in the battery ports.
2. Disconnect the hose from the vacuum (Fig 13).
3. Undo the latches and remove the power head from the tank (Fig 14).
4. Clear all dirt or debris from the tank and hose (Fig 15).
5. Clean the foam filter by washing it with water and mild soap.
6. Check the hose and attachments to verify that they have not been damaged.

## INSTALLING AND REMOVING HEPA FILTER

### Installing HEPA filter

See figure 5.

1. Verify that no battery pack is inserted in the battery ports.
2. Remove power head and place in upside down position.
3. Install the HEPA filter over the filter cage with the flat end of the filter towards the vacuum power head. Carefully push filter in until it stops against the power head.
4. Install the filter cap. Turn the locking knob clockwise to lock the filter cap in place.

### Removing HEPA filter

See figure 15-16.

1. Unlock and remove the filter cap by turning cap counter clockwise.
2. Carefully hold and pull the HEPA filter up for removal.
3. To clean, either dust off the filter by gently tapping or brushing direct off. Alternatively wash it with clean water. If washed, please allow to air dry for 24hours before installing back onto the unit.

**NOTE:** Change the cartridge filter regularly for best performance. Always use the HEPA filter for dry vacuuming. If the product is used for dry vacuuming without the HEPA filter and cap attached, the motor will burn out and the warranty will be voided.

**NOTE:** The HEPA cartridge filter included is made of high quality materials designed to stop small dust particles. The HEPA cartridge filter should be used for dry pick-up only.

A dry HEPA cartridge filter is necessary to pick up dust. If the HEPA cartridge filter is wet, it will clog quickly and be very difficult to clean. Handle the HEPA cartridge filter carefully when removing it for replacing it. Check the HEPA cartridge filter for tears or small holes. A small hole can let dust pass through and out of the cleaner.

Do not use a HEPA cartridge filter with holes or tears. Replace it immediately.

Clean the cartridge filter by gently tapping or brushing dirt off. For optimal performance it is recommended to regularly change this filter depending on level of use.



## CLEANING AND CHANGING HEPA FILTER

### WARNING

To ensure maximum performance, clean the HEPA filter after each discharge cycle or if performance drops. Replace the HEPA filter every 25 discharge cycles.

### Cleaning HEPA filter

The HEPA filter supplied is washable. Having a washable filter helps increase its lifespan. Clean the HEPA filter on a regular basis.

**NOTE:** Filter maintenance is important. Make sure the HEPA filter is cleaned and replaced on a regular basis.

Helpful hint: When washing the HEPA filter it will need to completely dry before reusing in the vacuum. We recommend to always have a spare filter (not supplied) on hand to replace in case of urgent use needed.

### Changing the HEPA filter

Replace the HEPA filter when loss of vacuum continues to occur after you have checked for any obstructions in the hose or wand. Also, install a new collection bag.

## INSTALLING AND CLEANING FOAM SLEEVE FILTER

### Installing foam sleeve filter

See figure 11.

1. Verify that no battery pack is inserted in the battery ports.
2. Remove power head and place in upside down position.
3. Carefully slide foam sleeve filter down over the filter cage making sure the hole is covered.
4. Replace the power head on to the tank.

### Cleaning foam sleeve filter

See figure 17.

1. With the removed power head in the upside down position, carefully remove foam sleeve filter.
2. Use a mild soap and water solution to wash foam sleeve filter and rinse with clean water.
3. Allow filter to air dry before installing and using again.

## CHANGING THE DUST BAG

When the collection bag is 3/4 full, it must be replaced. Excessive over filling of this bag makes it difficult to remove from the vacuum tank and can result in breakage and spills. When collection bag becomes 3/4 full, turn off vacuum and slowly remove the collection bag from the tank until the opening in the collection bag is clear of the tank.

Use only AEG accessories and AEG spare parts. Should components need to be replaced which have not been described, please contact one of our AEG service agents (see our list of guarantee/service addresses).

If needed, an exploded view of the tool can be ordered. Please state the Article No. as well as the machine type printed on the label and order the drawing at your local service agents or directly at:

### Techtronic Industries (Australia) Pty. Ltd.

PO Box 1065  
Mount Waverley VIC 3149  
Tel. no. 1300 361 505  
Australia

### Techtronic Industries N.Z. Ltd.

PO Box 12-806  
Penrose AUCKLAND 1642  
Tel no. 0800 279 624  
New Zealand

## SYMBOLS



Safety alert



Regulatory Compliance Mark (RCM). Product meets applicable regulatory requirements.



Please read the instructions carefully before starting the machine.



Do not dispose of electric tools together with household waste material. Electric tools and electronic equipment that have reached the end of their life must be collected separately and returned to an environmentally compatible recycling facility.

## TROUBLESHOOTING

Problem	Possible Causes	Solution
Vacuum will not operate.	<ol style="list-style-type: none"> <li>1. No power supply.</li> <li>2. Tank full.</li> </ol>	<ol style="list-style-type: none"> <li>1. Check if battery pack is properly inserted.</li> <li>2. Check if battery pack is charged.</li> <li>3. Empty tank.</li> </ol>
Dust comes out from motor cover.	<ol style="list-style-type: none"> <li>1. The cartridge filter is missing or damaged.</li> <li>2. HEPA cartridge filter is not installed correctly.</li> </ol>	<ol style="list-style-type: none"> <li>1. Attach or replace cartridge filter.</li> <li>2. Check the HEPA cartridge filter and install it correctly.</li> </ol>
Reduced efficiency and motor/speed vibration.	<ol style="list-style-type: none"> <li>1. There is a blockage in the nozzle, hose, or the tank inlet. The cartridge filter is clogged by fine dust.</li> <li>2. Dust bag is full.</li> </ol>	<ol style="list-style-type: none"> <li>1. Check nozzle, hose and tank inlets for blockage. Take off the filter and clean it. Or install a new cartridge filter.</li> <li>2. Replace the dust bag.</li> </ol>



# AEG

[www.aegpowertools.com.au](http://www.aegpowertools.com.au)

[www.aegpowertools.co.nz](http://www.aegpowertools.co.nz)

Techtronic Industries Australia Pty. Ltd.  
31 Gilby Road, Mount Waverley, VIC 3149  
Melbourne, Australia

Techtronic Industries N.Z. Limited  
2 Landing Drive, Mangere  
Auckland, 2022, New Zealand