

Dirt Devil Service line
AU: 1300 361 505 / NZ: 0800 800 900

Machine Overview

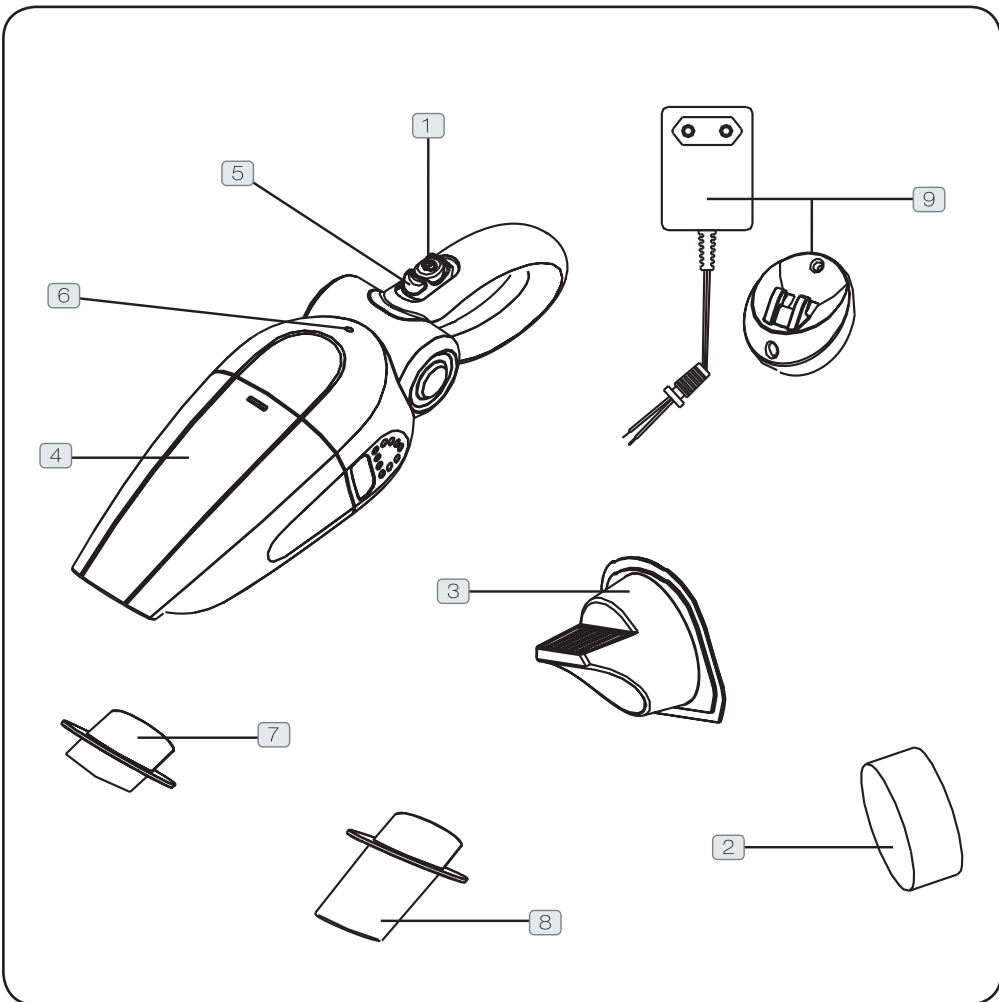

1 On/off switch

2 Sponge filter

3 Mesh filter

4 Dust container

5 Button for dust cup release and handle rotation

6 Indicator light

7 Wet vacuuming nozzle

8 Dry crevice nozzle

9 Adaptor and charger base

General Safety Information

FOR HOUSE HOLD USE ONLY.

When using the vacuum cleaner, basic safety precautions should always be observed, including the following:

1. Only use the vacuum cleaner indoors on dry surfaces.
2. Turn off the vacuum cleaner controls before disconnecting or connecting the charger from the mains supply.
3. Always turn off the vacuum cleaner before connecting or disconnecting to the charger.
4. Children should be supervised to ensure that they do not play with the appliance.
5. This appliance is not intended for use by persons (including children) with reduced physical, sensory or mental capabilities, or lack of experience and knowledge, unless they have been given supervision or instruction concerning use of the appliance by a person responsible for their safety.
6. Use only as described in this manual. Use only Dirt Devil recommended attachments.
7. Do not use the vacuum cleaner if it has been dropped, damaged, left outdoors or dropped into water. Do not use the vacuum cleaner if the charger cord or plug is damaged it must be replaced by the manufacturer, its service agent or similarly qualified persons in order to avoid a hazard.
8. Do not pull or carry by the charger cord. Do not use the cord as a handle, close a door on the cord or pull cord around sharp edges or corners.
9. Do not handle the plug, charger pack or vacuum cleaner with wet hands. Do not use outdoors or on wet surfaces.
10. Do not put any objects into openings. Do not use with any openings blocked and do not restrict airflow. Keep all openings free of dust, lint, hair or anything that might reduce airflow.
11. Keep hair, loose clothing, fingers and all parts of the body away from openings and moving parts.
12. Do not pick up hot coals, cigarette butts, matches or any hot, smoking or burning objects.
13. Do not pick up flammable or combustible materials (lighter fluid, petrol, kerosene etc.) or use in the presence of explosive liquids or vapours.
14. Do not vacuum up harmful or toxic material (chlorine, bleach, ammonia, drain cleaner etc.).

15. Do not vacuum up hard or sharp objects such as glass, nails, screws, coins, etc.
16. Do not use without ALL of the filters in place.
17. Take extra care when vacuuming on stairs.
18. Keep vacuuming area well lit.
19. Store the vacuum cleaner in a cool, dry area.
20. Turn off the on/off switch before unplugging the vacuum cleaner charger.



WARNING: Always switch off the vacuum cleaner before assembling, opening or emptying the dirt container, or before connecting/disconnecting the attachments.



IMPORTANT: Washing filters improves vacuum performance. We recommend that they should be checked and cleaned periodically (depending on the level of use). Make sure all filters are completely dry before inserting back into the vacuum cleaner.



WARNING: Use only the original charger and adaptor designed for this model.

This machine is intended for house hold use only, and NOT for commercial or industrial use.

PLEASE KEEP THESE INSTRUCTIONS FOR FURTHER USE.

Operation

Before using for the first time

NOTE: The Dirt Devil cordless wet & dry rechargeable hand-held vacuum cleaner is supplied with the battery in the uncharged state. Before using the appliance for the first time, charge the battery for 7 – 8 hours.

1. The cordless vacuum cleaner is operated by a rechargeable Nickel-Cadmium battery (Ni-Cd).
2. The rechargeable battery will reach its full capacity after a charging time of 7 – 8 hours.
With a fully charged battery, the rechargeable vacuum cleaner will work for its full operating period of approx 8 – 10 minutes.
3. Place the vacuum on the charger when you are not using it. This will ensure that it is always fully charged and ready for use.

NOTE: Set appliance on/off switch to OFF position before charging begins.

How to Use

1. Remove the vacuum cleaner from the charger.
2. Make sure the dust filter is installed before you use the appliance.
3. To operate the appliance, press the On/Off switch into the **On** mode.
4. After use press the On/Off switch into the **Off** mode.
5. The wet vacuum nozzle and the crevice tool are used to clean narrow difficult to reach places.
These tools can be inserted into the nozzle opening.

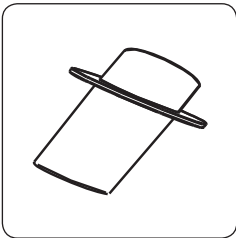

Dry crevice nozzle

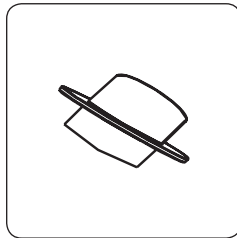

Wet vacuum nozzle

Operation

Dry Vacuuming

1. Start/stop the vacuum by pressing the start button once.
2. Attached the crevice nozzle to the vacuum cleaner to facilitate cleaning areas difficult to reach.

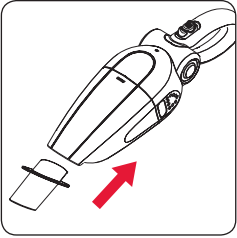

NOTE: Empty dust container when the "MAX" mark is reached.

Wet Vacuuming

1. Remove all dry dust from the dust container.
2. Insert the wet vacuuming nozzle.
3. When in use, always hold the vacuum cleaner with the suction opening downwards.
4. Always remove the liquid after usage and allow vacuum to completely dry before using for dry vacuuming again. Allow the wet filter to completely dry for 24 hours before replacing in the vacuum.

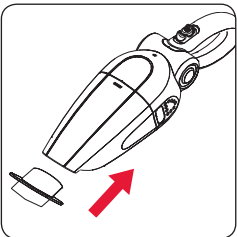

NOTE: Do not continue to use the vacuum cleaner again when the water reaches the mark indicating "MAX".

Operation

Pivoting Handle

To clean hard to reach places such as on top of shelves, in a car or on top of furniture, this vacuum handle is designed to pivot into two locking positions for increased accessibility and user comfort.



Normal position



First pivot lock



Second pivot lock

To activate the pivot function, simply slide the on/off button forward to pivot in multiple positions.

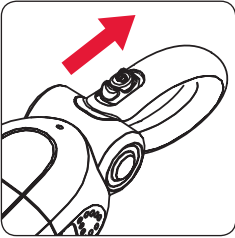

Maintenance (Keep your Dirt Devil as good as new)

Replacing and cleaning the dust filter and dust container

The dust container must be emptied when it reaches the "MAX" mark for both wet and dry vacuuming or after each use.

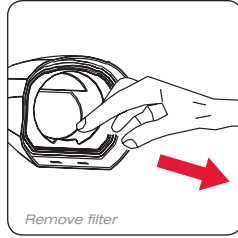
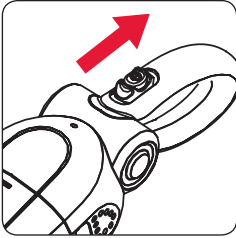

Remove filter

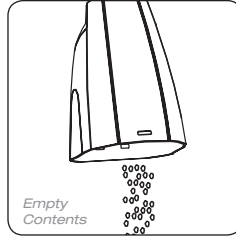

Empty Contents

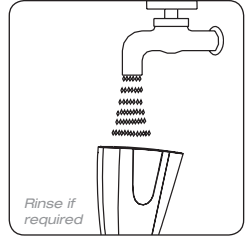

Rinse if required

To empty the dust/water container, simply slide the on/off button backwards to release the container

Remove the sponge filter and empty the contents into a rubbish bin. If the container is dirty it can be rinsed with lukewarm water. Once clean, re-attach the filter to the vacuum.

To thoroughly clean the actual filter, separate the filter and sponge and rinse the filter in lukewarm water (40°C maximum). Make sure that the parts are completely dry before they are reassembled – we recommend 24 hours.

Re-assemble in the reverse order.

FAQ's



WARNING: To reduce the risk of personal injury, unplug the hard floor cleaner before performing maintenance/troubleshooting checks.

Problem	Solution
Is there an accessory missing?	Check the 'Parts Overview' page in this guide to make sure the part is definitely included in your unit.
	If it is missing, we're here to help. Simply call us on AU: 1300 361 505 NZ: 0800 800 900
Why won't the vacuum cleaner pick up?	The dirt container may be incorrectly installed; please check the fitment according to instructions.
	The filter may be clogged; refer to 'Maintenance: Cleaning the filters' on page 7.
What do I do if the unit/an accessory becomes damaged or broken?	We're here to help. Simply call AU: 1300 361 505 / NZ: 0800 800 900 or visit dirtdevil.com.au
Why won't the accessories pick up properly?	Accessory blockages: remove accessory from unit base. Carefully remove blockage and re-attach to the vacuum cleaner.
	The accessory may be faulty. Simply call us on for assistance. AU: 1300 361 505 / NZ: 0800 800 900



A wicked way to clean.

Don't take me back to the shop, simply call us

AU: 1300 361 505
NZ: 0800 800 900 dirtdevil.com.au

This does not affect your statutory rights

Other Information

Dirt Devil Service & Help

Dirt Devil Careline:

Australia 1300 361 505

New Zealand 0800 800 900

Monday-Friday 8.30am to 5.00pm

If you have queries or concerns about using your Dirt Devil, call the Dirt Devil Careline. Calls are charged at the standard local rate. Please make a note of the serial number and model number of the vacuum cleaner before calling.

For the nearest Service Agent, please call the Dirt Devil Customer Careline or visit dirtdevil.com.au

Technical Specification

Charger Voltage: 220-240V ~ 50Hz

Hand Vac: 6Vdc

Dirt Capacity: 500ml

Water Capacity: 100ml

Filters: Washable mesh and foam

Weight: 1.5kg

Charge Time: 7 – 8 Hours

Run Time: Approx. 8 – 10 Minutes

Subject to technical change without notice.



Double Insulated



Indoor Use



Read Instructions



Waste electrical products should not be disposed of with household waste. Please recycle where facilities exist. Check with your Local Authority or retailer for recycling advice.

Notes

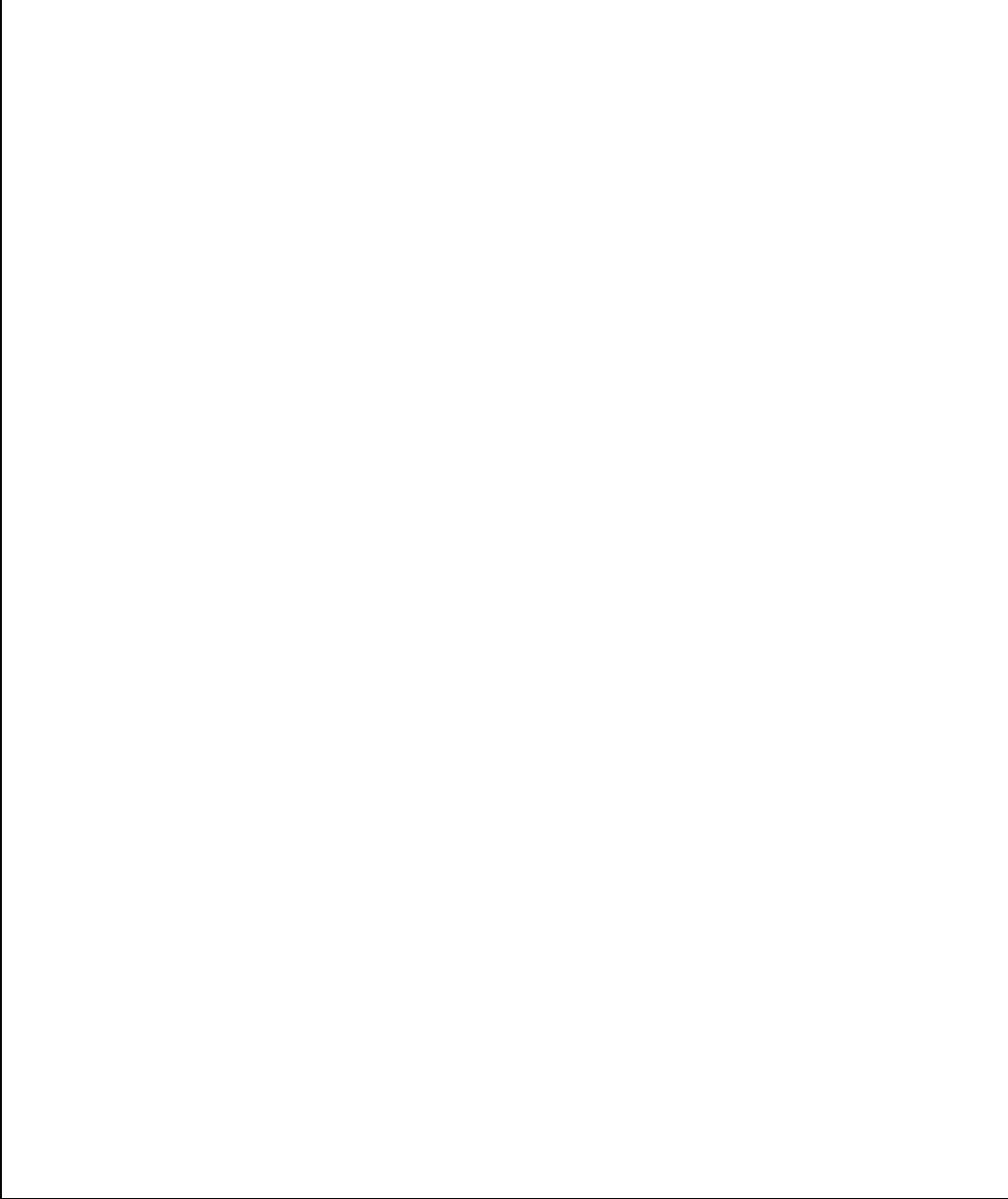



A wicked way to clean.

Distributed by Techtronic Industries Pty. Ltd.

Level 1, 660 Doncaster Road, Doncaster, Australia 3108.

dirtdevil.com.au Service Line: AU: 1300 361 505 / NZ: 0800 800 900