

# EUROMATIC



## Portable Air Conditioner

### USER MANUAL

Model Number A011A-18C

**AFTER SALES SUPPORT**

**(AU) 1300 886 649 (NZ) 0800 836 761**



# Contents

## Page

<b>03</b>	<b>Important Safety Instructions</b>
<b>07</b>	<b>R32-Specific Safety Advice</b>
<b>09</b>	<b>Getting Started</b>
<b>10</b>	<b>Product Overview</b>
<b>13</b>	<b>Installation</b>
<b>15</b>	<b>Instructions</b>
<b>19</b>	<b>FAQs &amp; Troubleshooting Guide</b>
<b>20</b>	<b>Other Useful Information</b>

# Important Safety Instructions

## READ CAREFULLY AND KEEP FOR FUTURE REFERENCE

Read this manual thoroughly before first use, even if you are familiar with this type of product. The safety precautions enclosed herein reduce the risk of fire, electric shock and injury when correctly adhered to. Make sure you understand all instructions and warnings. Keep the manual in a safe place for future reference, along with any warranty information, your purchase receipt and the original packaging. If you sell or transfer ownership of this product, pass on these instructions to the new owner.

**Always follow basic safety precautions and accident prevention measures when using an electrical appliance, including the following:**

### Electrical safety and cord handling

- **Voltage:** Before turning on the air conditioner, ensure the electrical voltage and circuit frequency correspond to those indicated on the appliance.
- **Socket:** Ensure your electrical outlet is properly installed and earthed and complies with your local electrical safety requirements.
- **Moisture:** To reduce the risk of electrocution, never operate the appliance with wet hands; never submerge it in water or spill liquids into it. Do not use it in a bathroom or laundry, or where it can be splashed with water.
- **Power supply cord:** Do not kink or damage the cord. Do not pull the cord or place it near a heat source. Always unwind the cord completely to avoid overheating. Run the cord in such a way so that no one will trip over it.
- **Extension cord/adaptor:** Do not use this appliance with an extension cord or power adaptor.
- **Damaged cord:** If the supply cord is damaged, do not use the appliance. A damaged power supply cord must be replaced by the manufacturer or its service agent or a similarly qualified person in order to avoid a hazard. Contact our after sales support centre.
- **WARNING: Do not use when damaged!** In case of damage, switch off the appliance, unplug it and contact our after sales support centre. Do not pick up or operate a damaged appliance, or after it malfunctions or has been dropped or damaged in any manner.
- **Power button:** Do not use the mains plug to start and stop the unit; always use the power button to start and stop the unit.
- **Switching on/off:** Do not use the mains plug to start and stop the unit; always use the POWER button on the control panel or remote control to start and stop the unit.
- **Disconnect:** Turn off the unit first and then unplug it when it is not in use and before maintenance or cleaning, but do not unplug it when it is in operation, as this could create a spark and cause a fire. Grip by the plug, do not pull by the cord when disconnecting.

# Important Safety Instructions (Cont.)

- **RCD:** The installation of a residual current device (safety switch) is recommended to provide additional safety protection when using electrical appliances. It is advisable that a safety switch with a rated residual operating current not exceeding 30mA be installed in the electrical circuit supplying the appliance. See your electrician for professional advice.

## Usage conditions and restrictions

- **Intended use:** This appliance is intended for air conditioning domestic environments. It is not suitable for commercial, industrial or trade use. Do not use it for any other purpose (such as drying clothes, cooling food, etc.), and only use it as described in this manual.
- **Common sense:** These instructions are not intended to cover every possible condition and situation. As with any electrical appliance, common sense and caution are therefore always recommended when installing, operating and maintaining the unit.
- **No outdoor use:** Do not use the unit outdoors. It is for indoor use only.
- **Usage restriction:** This appliance is not intended for use by persons (including children) with reduced physical, sensory or mental capabilities, or lack of experience and knowledge, unless they have been given supervision or instruction concerning use of the appliance in a safe way and understand the hazards involved.
- **No external timer:** This appliance is not intended to be used with an external timer or a separate remote control system.
- **WARNING: Do not cover!** Do not cover the air conditioner or obstruct any air inlet or outlet grilles. Obstructing these openings causes a fire hazard, reduces the operating efficiency and may lead to malfunction or damage.
- **Air outlets:** Do not insert any objects, or your fingers, into the air outlet, and make sure to warn children of the dangers.
- **Children:** Supervise children to ensure they do not play with the appliance. Close supervision is necessary when any appliance is used by or near children. Cleaning and user maintenance shall not be made by children without supervision.
- **Unattended:** Do not leave the appliance unattended when in use.
- **Attachments:** The use of attachments not recommended or sold by the manufacturer may cause fire, electric shock or injury.
- **Start-up settings:** Set the unit to maximum cooling and high speed ventilation for the initial startup, then adjust the unit down to a more comfortable setting as required.
- **Airflow:** Do not direct the airflow onto plants or animals, as long and direct exposure to cold air from the air conditioner could adversely affect them.

# Important Safety Instructions (Cont.)

- **Cold air exposure:** Never remain directly exposed to the flow of cold air for a long time, as direct and prolonged exposure to cold air from the air conditioner could be dangerous for your health. Take particular care in rooms where there are children, old, or sick people.
- **Moving the appliance:** When moving the air conditioner, always turn it off first and disconnect the power supply, and move it slowly. Keep the unit upward during transport and storage.

## Cleaning and maintenance

- **Disconnect:** Make sure the appliance is disconnected from the power supply when it will not be used for a long time and before carrying out any cleaning or maintenance.
- **Air filters:** Keep the air filters clean. Do not use the unit without the air filters fitted. Using it without air filters could cause an excessive accumulation of dust or waste on the inner parts of the device with possible subsequent failures.
- **Service and repair:** The air conditioner has no user-serviceable parts contained inside. Do not attempt to disassemble, modify or conduct repairs on this unit. It has been built in accordance with relevant safety and performance standards. An electrical specialist must carry out all repairs. Contact our after sales support centre for advice on service.

## Installation

- **Proper installation:** Install the appliance according to the instructions in this manual and national wiring regulations. Improper installation may result in the risk of fire, electric shock and/or injury.
- **WARNING: Electric shock hazard!** Before installation or servicing, ensure the unit is switched off and disconnected from the power outlet to prevent possible injury.
- **The location:** When deciding on an installation place, keep in mind that the area must be flat, the air outlets must not be covered up, and there must be a properly earthed 220~240V~ 50Hz power outlet nearby.
- **Do NOT install/use the appliance in the following areas:**
  - outdoors or where water is likely to splash
  - near a bath, shower, laundry basin or swimming pool
  - in an area where oil is likely to splash
  - near a hot gas or electric burner, or sources of fire
  - near sources of heat, or exposed to direct sunlight
  - in an area where furniture or other objects can obstruct the airflow
  - in the presence of flammable substances or vapour such as alcohol, insecticides, petrol, etc.
  - at a dry cleaner's premises.

# Important Safety Instructions (Cont.)

- **Clearances:** There must be a clearance of at least 30cm between the appliance and any walls, furniture, curtains or any other obstacles (refer to Fig. 1, below). Maintaining this minimum 30cm clearance is essential; failure to keep that distance can result in the unit malfunctioning or causing injury.
- **Window application:** The air exhaust can be installed in a vertical or horizontal sliding window (refer to Fig. 2, below).
- **Air exhaust installation** instructions follow on pages 13–14. Keep the length of the air exhaust hose to the minimum length necessary during operation.
- **Upright position:** Place the unit on a flat surface to reduce the risk of it tipping over. Do not tilt the unit, always keep it upright during installation and use.
- **Misuse:** We accept no responsibility for any eventual injuries or damages caused by improper installation, faulty use or failure to follow the instructions in this manual.

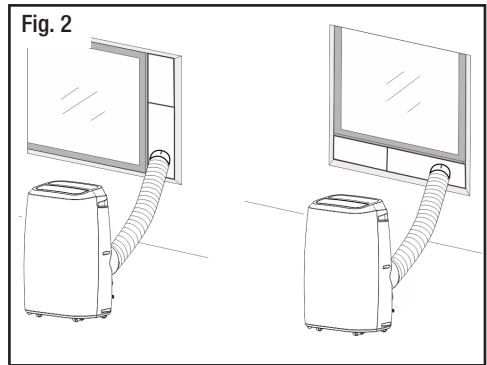
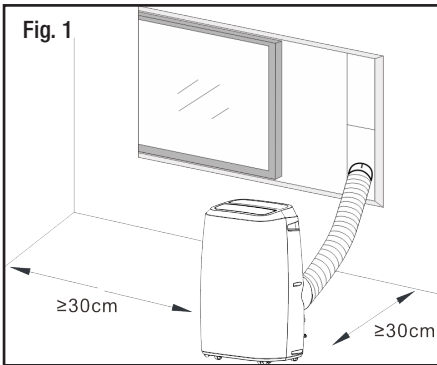

- **Pressure specifications:**

Permissible excessive operating pressure	Discharge 3.8MPa
	Suction 1.2MPa
Maximum allowable pressure	Discharge 5.0MPa
	Suction 1.5MPa

# R32-Specific Safety Advice

## Important safety precautions concerning refrigerant R32



WARNING: low burning velocity material

### **WARNING: Combustible & Dangerous**

This symbol alerts you to take care as the appliance contains a flammable refrigerant: R32 (difluoromethane). Take extra care when installing the unit and when carrying out maintenance.

The refrigerant used in this air conditioner, R32, is an odourless hydrocarbon gas with a high level of environmental compatibility, with just one third of the global warming potential (GWP) and a zero ozone depleting potential (ODP).



Read the user manual

While R32 is flammable and can explode under certain conditions, there will be no risk of burning and explosion if the air conditioner is properly installed and maintained following all instructions and safety advice in this manual.

- The room in which this air conditioner is installed must have a minimum area of more than 15m<sup>2</sup>. (This unit is designed for use in a room of approximately 26–35m<sup>2</sup> size.)
- Do not expose the appliance to high heat, sparks and open flames.
- The appliance shall be stored in a room without continuously operating sources, such as open flames, an operating ignition gas appliance or an operating electric heater.
- Do not pierce or burn the appliance.
- This air conditioner has been fully charged with refrigerant at the factory. Should a recharge of refrigerant become necessary, it may only be recharged by a professional installer.
- Maintenance must only be carried out by properly qualified, authorised personnel. If the appliance requires maintenance or service, please contact our after sales support centre.
- The service technician must strictly comply with:
  - all safety instructions in the manual provided with the appliance
  - all relevant provisions of gas-related local laws and regulations.

# R32-Specific Safety Advice (Cont.)

- After servicing the appliance, the service technician must:
  - check that air cannot enter the refrigerant system
  - check for refrigerant leaks when moving the air conditioner
  - carry out a test cycle under controlled conditions after installing the unit and record the operating data.

## Disposal

- This air conditioner contains a flammable refrigerant, which must be removed before disposal. Contact your municipal authorities for any codes or regulations concerning the disposal of such materials.
- At the end of its working life, do not throw this appliance out with your household rubbish. Electrical and electronic products contain substances that can have a detrimental effect on the environment and human health if disposed of inappropriately. Observe any local regulations regarding the disposal of electrical consumer goods and dispose of it appropriately for recycling and recovery of the refrigerant.



# Getting Started

## Before you start

- **Unpacking:** This product has been packaged to protect it against transportation damage. Unpack the appliance and keep the original packaging materials in a safe place. It will help prevent any damage if the product needs to be transported in the future, and you can use it to store the appliance when it is not in use. In the event that the packaging is to be disposed of, please recycle it where possible.
- **Safe packaging disposal:** Plastic wrapping can be a suffocation hazard for babies and young children, so ensure all packaging materials are kept out of their reach and disposed of safely.
- **Inspection:** Unwind the cord fully and inspect it for damage. Do not use if any part of the appliance is damaged. In case of damage, contact our after sales support centre for advice.
- **Documentation:** Read the manual to familiarise yourself with all parts and operating principles of the portable air conditioner. Pay particular attention to the safety instructions on the previous pages.

### **Electric shock hazard!**

Before installation, cleaning or or servicing, ensure the unit is switched off and disconnected from the power outlet to prevent possible injury.

# Product Overview

## Scope of delivery

### A Portable air conditioner

- 1 Louvre
- 2 Control panel (see page 10 for details)
- 3 Front panel
- 4 Castor wheels
- 5 Air inlets
- 6 Drainage outlet
- 7 Air outlet grille
- 8 Power cord and plug
- 9 Drainage outlet

Front view (Fig. 3)

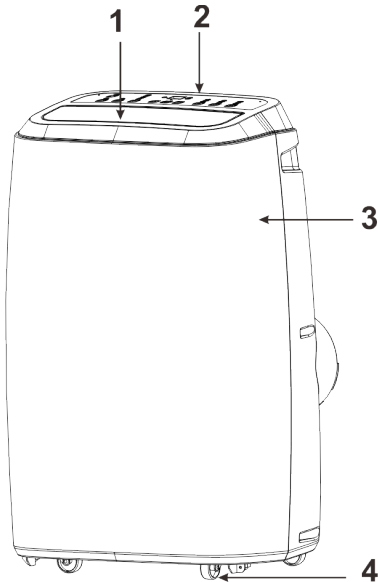



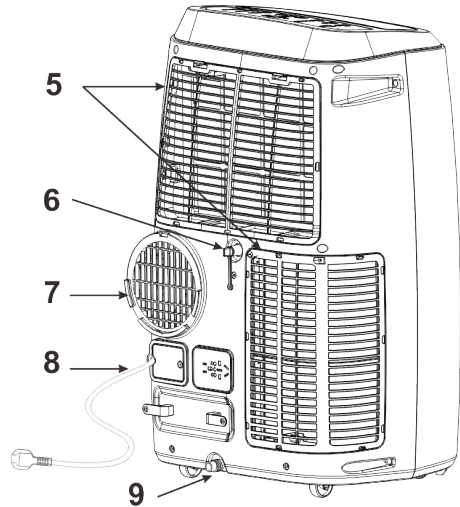



Rear view (Fig. 4)



# Product Overview (Cont.)

## B Accessory parts (Fig. 5)

Part	Description
	Flexible air exhaust hose
	Exhaust hose connector (window end)
	Exhaust hose connector (air conditioner end)
	Remote control
	Adjustable window slider (for 67.5cm – 123cm windows)
	2 Dowels
	2 AAA-size batteries (packaged separately)

**NOTE:** Due to continued product improvement, images and illustrations in this manual may vary slightly from the product purchased. All images in this manual are for reference purposes only. Parts are not necessarily pictured to scale.

# Product Overview (Cont.)

Control panel (Fig. 6)

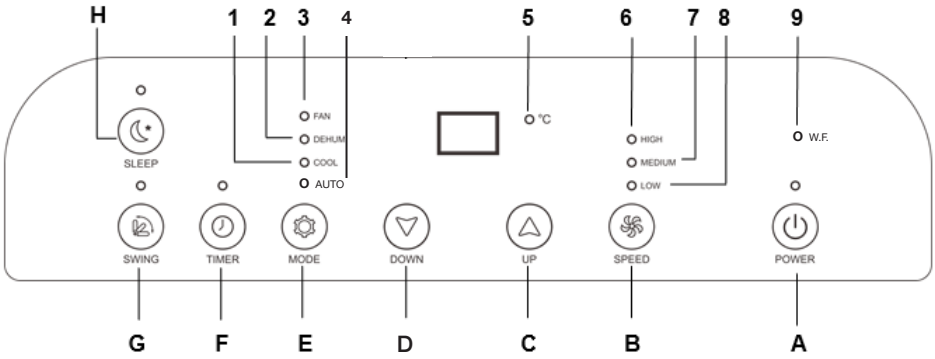

A	Power on/off	1	Cooling
B	Fan speed	2	Dehumidifying
C	Temperature up	3	Fan
D	Temperature down	4	Auto
E	Operation mode	5	Centigrade temperature
F	Timer on/off	6	High fan speed
G	Auto swing	7	Medium fan speed
H	Sleep mode	8	Low fan speed
		9	Water full

Remote control (Fig. 7)

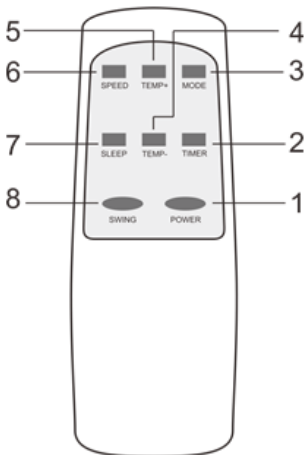

1	Power on/off
2	Timer on/off
3	Operation MODE
4	Temperature down
5	Temperature up
6	Fan speed
7	Sleep mode
8	Auto swing

**NOTE:** Do not drop the remote control. Do not place the remote control in a location exposed to direct sunlight.

# Installation

## Installing the air exhaust hose

- Fit the exhaust hose and housing connectors to the ends of the flexible air exhaust hose (Fig. 8).

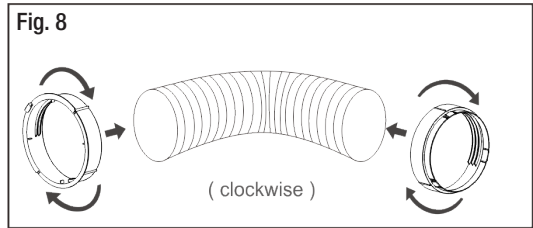

- Insert the fixing clip of the housing connector into the openings at the back of the air conditioner (Fig. 9).

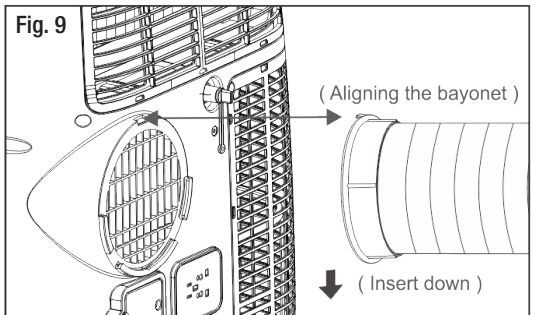

- **For temporary installation** (in fan mode only), lead the exhaust hose connector (window end) out of an open window (Fig. 10).

**NOTE:** Ambient air will still be able to enter the room this way. **To cool the room effectively, the window kit must be properly installed.**

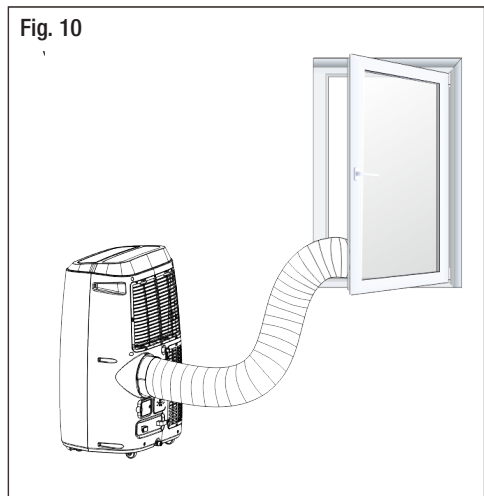

### IMPORTANT!

For best performance, keep the length of the air exhaust hose to the minimum length necessary during operation.

# Installation (Cont.)

## Installing the window kit

Your window kit has been designed to fit most standard 'horizontal' and 'vertical' window applications, but for certain types of windows it may be necessary for you to improvise/modify some aspects of the installation procedure.

- Adjust the window slider to the length of a horizontally (or height of a vertically) opening window (Fig. 11) and fix it with a dowel (Fig. 12).

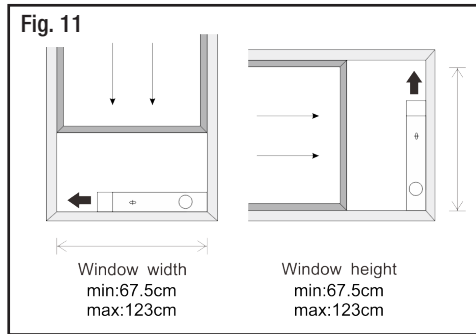

- Fit the slider to the bottom of the window sill (or to the side of the window, if it opens vertically), then close the window.
- Fit the exhaust hose connector (window end) through the opening to the outside (Fig. 13).

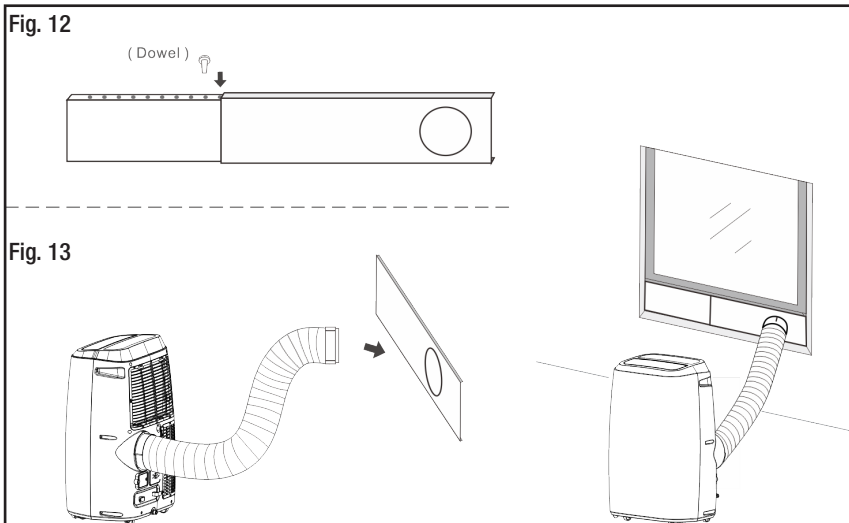

# Instructions

## Using the portable air conditioner

- Before switching the unit on for the first time, make sure you have properly installed the exhaust hose and window kit (see pages 5–6 and 12–13) and inserted two AAA size batteries into the remote control (see page 21).
- Find a place for the air conditioner where there is a power outlet nearby.
- Install the exhaust hose through the window kit so that the hot air is expelled to the outside (Fig. 14).
- Ensure the rubber stoppers at the back of the appliance are properly in place to block the drainage outlets.
- Plug the portable air conditioner into a properly earthed 220~240V ~ 50Hz mains socket and switch on power to the outlet.

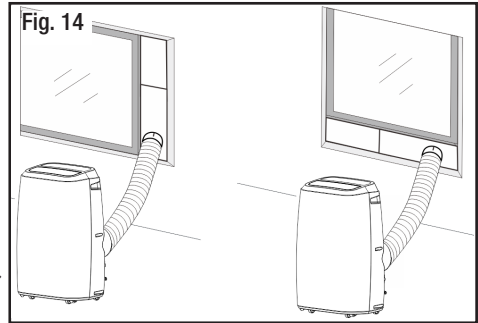

**NOTE:** Do not connect it to a multiple socket outlet that is also being used for other electrical appliances. Do not connect it to an extension cord.

- Press the POWER button and the unit will start operation.

### IMPORTANT INFORMATION

- **Room size:** It is important to use the right size air conditioner in the room you want to cool. (This appliance is suitable for cooling rooms of 26m<sup>2</sup>–35m<sup>2</sup> size.)
- **Exhaust hose:** This MUST BE CONNECTED and hot air expelled to the outside for the appliance to work properly. Keep the hose as short as possible.
- **Noise:** As the compressor is inside the room, a portable air conditioner makes more noise than a split system, where the compressor is outside.
- **For best cooling efficiency, keep blinds and curtains closed** during the sunniest part of the day. Close off any fireplace damper, floor and/or wall register so cool air does not escape through the chimney or duct work.
- **Switching on/off:** After switching on, allow 30 seconds for cool air to flow through the louvres. Avoid starting the air conditioner soon after switching off, and avoid switching it off immediately after switching on. Allow at least 3 minutes in between switching the unit on and then off, or vice versa.
- **Moving the appliance:** Take care when moving the appliance as condensation water may spill out. Ensure the drip tray is empty before moving it.

# Instructions (Cont.)

## Auto mode

- Press the MODE button until the Auto mode indicator illuminates. In this mode the air conditioner automatically selects the mode: cooling, dehumidifying or fan according to the ambient room temperature (see the table below).
- Press the MODE button again to cancel Auto mode.

Room Temperature (Tr)	Tr < 23 °C	23°C ≤ Tr < 26°C	Tr ≥ 26°C
Mode	Fan	Dehumidify	Cooling
Set Temperature	--	23°C	25°C

## Cooling mode

- Press the MODE button until the cooling mode indicator illuminates.
- Press the DOWN or UP button repeatedly to set the desired room temperature between 16°C and 31°C.
- Press the SPEED button to select the fan speed: high, medium or low.

**NOTE:** For best cooling efficiency, make sure that:

- \* Curtains/blinds are closed if your room is directly exposed to the sun.
- \* The air conditioner is located away from any heat source.

## Dehumidifying mode

- Press the MODE button until the dehumidifying mode indicator illuminates.
- The unit will automatically set the fan motor to low speed and maintain the room temperature at 2°C lower than the current room temperature (within the 16°C to 31°C range).

## Fan mode

- Press the MODE button until the fan mode indicator illuminates.
- Press the SPEED button to select the fan speed.

## Auto swing

- When the unit is running, press the SWING button to start automatic oscillation. The louvre will swing continuously up and down.
- Press this button again to stop automatic oscillation and the louvre will remain in that position.



# Instructions (Cont.)

## Timer operation

The air conditioner has a 24 hour timer, which you can set to start the unit at a later time, or to switch off the unit automatically.

### On-Timer setting

- With the unit switched **off** (but power supplied), press the TIMER button and select the desired on-time using the UP and DOWN buttons.
- “Preset ON Time” is displayed on the operation panel.
- Timer OFF setting

### Off-Timer setting

- Use the same procedure as above, but while the unit is switched on, to set an auto-off time.
- “Preset OFF Time” is displayed on the operation panel.

## Sleep mode

- While in cooling mode, press the SLEEP button to increase the temperature gradually by two degrees for night-time use.
- In Sleep mode, the set the temperature will increase by 1°C after an hour and by another degree after 2 hours.
- Press the SLEEP button again to cancel Sleep mode.

# Instructions (Cont.)

## Water full alarm

Condensation water that forms during cooling will drop into an in-built drip tray, from where it will be evaporated automatically. When the water level in the drip tray is getting too full, an automatic water level sensor illuminates the W.F. indicator on the control panel to alert you that the drip tray needs to be emptied.

Should the W.F. indicator light up during operation, proceed as follows:

- Place a pan under the water drainage outlet at the bottom of the unit.
- Alternatively, attach a water drain hose (not supplied) to the drainage outlet.
- Remove the rubber stopper and drain all water out of the tray (Fig. 15).

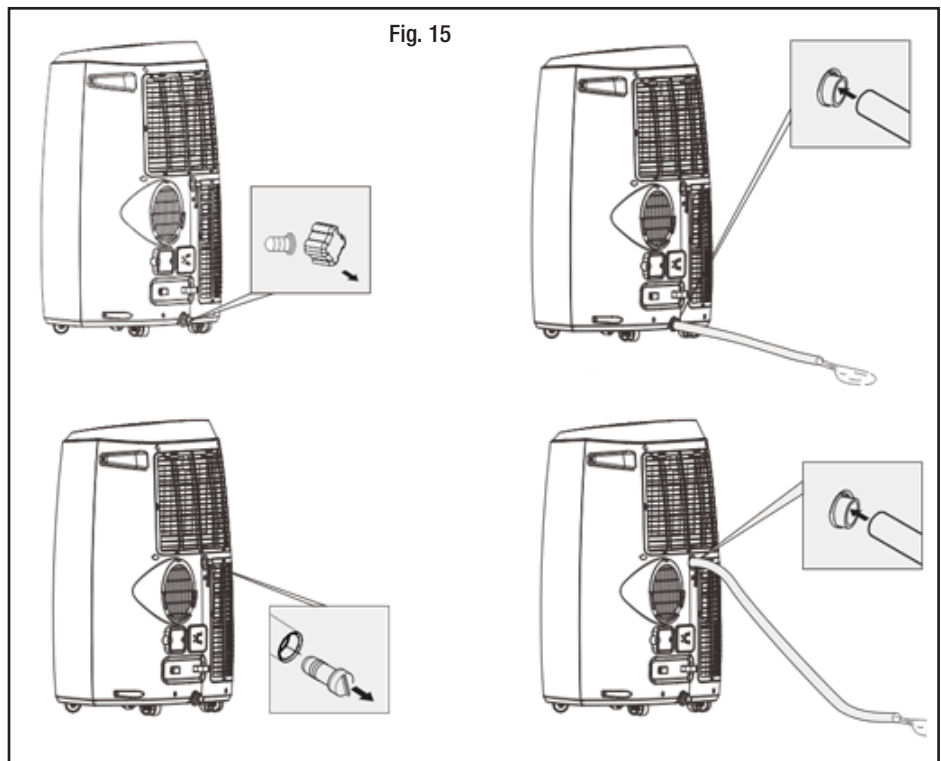

# FAQs & Troubleshooting Guide

If you experience problems with your portable air conditioner, or it appears not to be operating correctly, check the information below for solutions to common problems. If none of the solutions offered help you solve your problem, please contact our after sales support centre for advice.

**Do not attempt to repair the appliance yourself!**

Problem	Possible Causes	Solution
Unit does not start when pressing the POWER button.	The water full (W.F.) indicator blinks, indicating that the drip tray is full.	Drain the condensation water manually.
	The room temperature is lower than the set temperature.	Reset the temperature.
Low cooling performance.	Doors or windows to the room are open.	Ensure all windows and doors to the room are closed.
	There are heat sources inside the room.	Remove the heat sources, if possible.
	The exhaust air hose is not connected, or blocked.	Connect or clean the exhaust air hose.
	The set temperature is too high.	Reset the temperature.
	The air inlet is blocked.	Clean the air inlet.
Noisy	The ground is not level or not flat enough.	Make sure to place the unit on a flat, level ground.
	The sound comes from the refrigerant flowing inside the air conditioner.	This is normal and no cause for concern.
E0 Code	The room temperature sensor failed.	Call for service to replace the part (the unit can also work without replacement).
E1 Code	Condenser temperature sensor failed.	Call for service to replace the part.
E2 Code	Water drip tray is full.	Drain the water manually out of the drip tray.
E3 Code	Evaporator temperature sensor failed.	Call for service to replace the part.

# Other Useful Information

## Care and cleaning

### Electric shock hazard!

Before cleaning and servicing, ensure the unit is switched off and disconnected from the power outlet to prevent possible injury.

### Cleaning the air conditioner

- Wipe the housing with a damp cloth, moistened with water and a little mild detergent. Dry with a soft, dry cloth.

**CAUTION:** Do not wash the unit directly. Do not use any solvent or alcohol-based cleaning agent on any surface. Using such harsh cleansers will scratch or damage the surface, or can even lead to deformation of the housing.

### Cleaning the air filters

This unit has two air intake filters at the back of the unit. If the air filters clog up with dust, the airflow volume will be reduced. We recommend cleaning the filters once every two weeks.

To remove the filters, proceed as follows (Fig. 16):

- Open the air inlet grilles and take off the air filters.
- Clean the air filters with a mild detergent in lukewarm water (max. 40°C). Rinse thoroughly.
- Let all parts dry completely in the shade before reinstallation.

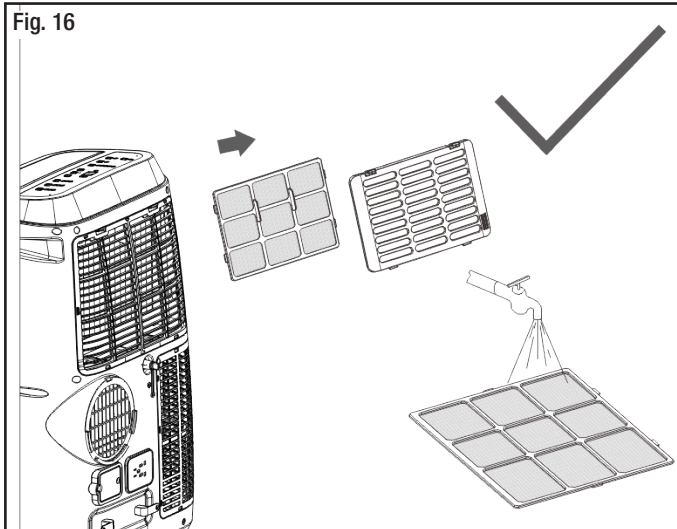

# Other Useful Information (Cont.)

## Before storage

At the end of the summer season, follow the simple steps below before disconnecting and storing the appliance.

- Place a pan under the water drainage outlet and remove the rubber stopper (Fig. 17).
- Alternatively, connect a drain hose (not supplied) to the outlet and lead the hose to the outside.
- Any condensation water that has accumulated will drain out.
- Operate the unit in fan mode for a few hours to let the drainage pipe dry.
- Switch off the unit and disconnect the plug from the power supply.
- Disconnect the drain hose (if installed) and keep the hose and stopper with the portable air conditioner during storage.
- Store the appliance in the original packaging, or wrap it with a plastic bag or piece of material and keep it in a dry, cool place, out of children's reach.

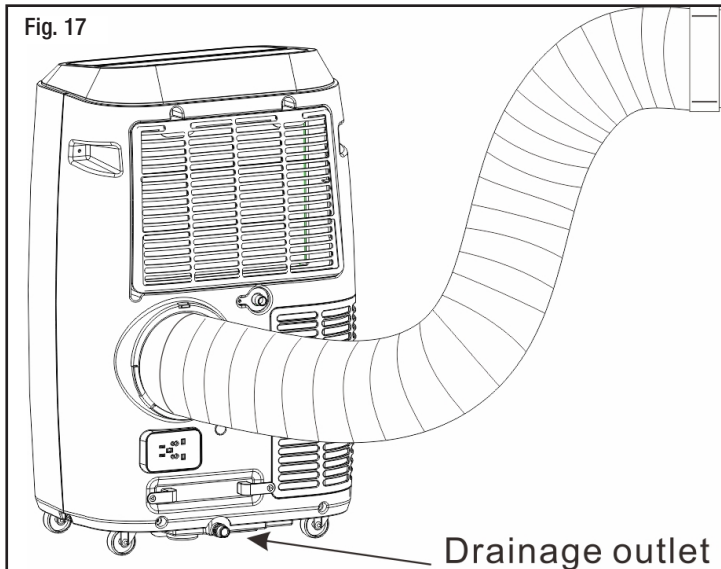

# Other Useful Information (Cont.)

## Battery replacement

The remote control is powered by 2x AAA size batteries, packaged separately. To install them, or to replace them when required, proceed as follows:

- Open the cover to the battery compartment at the back of the remote control and insert 2 AAA batteries, making sure to match the polarity markings (+/-) on the batteries with those inside the compartment.
- Close the battery compartment.

**CAUTION:** Only use fresh batteries of the required size and type. Do not mix old and new, or different types of batteries.

## Battery precautions

To prevent a risk of explosion, normal batteries must not be charged, heated or disposed of by burning.

Never throw batteries into a fire or subject them to high temperatures.

Do not open the batteries or short-circuit them.

If battery acid has leaked, avoid contact with skin, eyes and mucous membranes to prevent injury.

In the event of contact with the acid, rinse the affected areas immediately with plenty of clean water and contact a doctor at once.

## Service and repair

If you look after your portable air conditioner, it should give you years of good service. Should you experience problems with the appliance that you cannot solve yourself using the advice given on page 18, please contact our after sales support centre for advice. **Do not attempt to repair the appliance yourself!**

# Other Useful Information (Cont.)

## Technical specifications

Model	A011A-18C
Cooling capacity	5.0kW
Refrigerant, quantity	R32, 610g
Permissible excessive operating pressure	Discharge 3.8MPa
	Suction 1.2MPa
Max. allowable pressure	Discharge 5.0MPa
	Suction 1.5MPa
Weight (approx.)	37.8kg
Rated voltage	220-240V~
Rated frequency	50Hz
Rated current	9.3A
Rated input	2000W
Resistance class	IP20
Dimensions (mm)	425(W) x 780(H) x 370(D)
Sound power level	65dB(A)

## Compliance

This appliance has been fully tested and meets all requirements as set out by standards AS/NZS 60335.1 and AS/NZS 60335.2.40.



The RCM Mark (Regulatory Compliance Mark) indicates that the product complies with the relevant guidelines of the ACMA as well as corresponding government requirements for the safety of electrical devices.

## Responsible disposal

At the end of its working life, do not throw this appliance out with your household rubbish. Electrical and electronic products contain substances that can have a detrimental effect on the environment and human health if disposed of inappropriately. Observe any local regulations regarding the disposal of electrical consumer goods and dispose of it appropriately for recycling and recovery of the refrigerant. Contact your local authorities for advice on recycling facilities in your area.

## **Warranty returns**

Should you for any reason need to return this product for a warranty claim, make sure to include all accessories with the product.

## **Product does not work?**

If you encounter problems with this product, or if it fails to perform to your expectations, make sure to contact our After Sales Support Centre on (AU) 1300 886 649 or (NZ) 0800 836 761 for advice.

Distributed by Tempo (Aust) Pty Ltd ABN 70 106 100 252

PO BOX 6056 Frenchs Forest, Australia NSW 2086

Customer Helpline:

(AU) 1300 886 649 (NZ) 0800 836 761

Email: [info@tempo.org](mailto:info@tempo.org)

For an electronic copy of this manual, please contact our after sales support centre.

IM Version No: V1.2

Issue: June 2020

**After Sales Support**

**☎ 1300 886 649 | ✉ [info@tempo.org](mailto:info@tempo.org)**