

AEG

ABL18F

Original instructions

Important!

It is essential that you read the instructions in this manual before assembling, operating and maintaining the product.

Subject to technical modifications.

ABL18F



x 1



x 1



x 1



TURBO BOOST BUTTON

CRUISE CONTROL

UPPER TUBE

LOWER TUBE

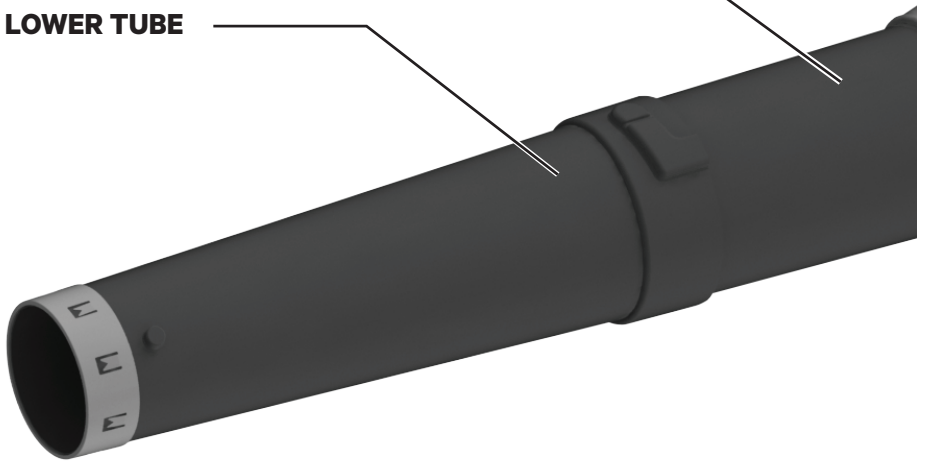

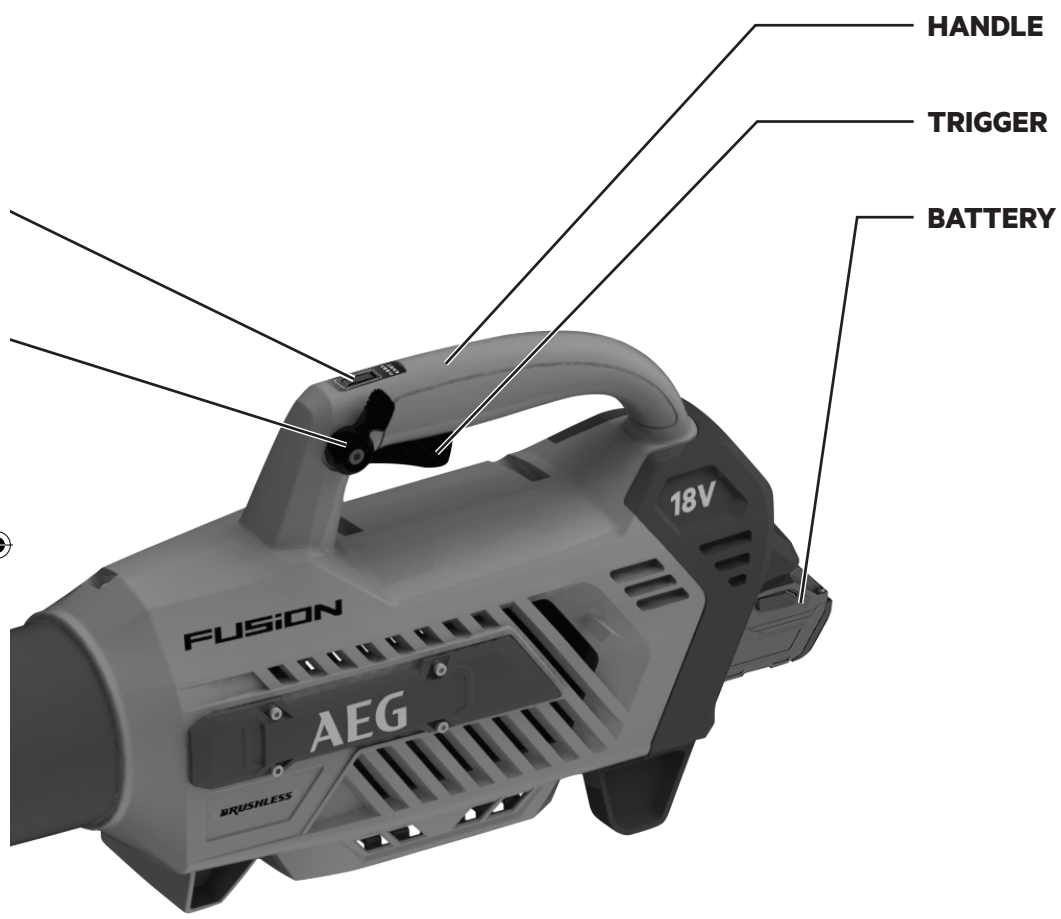

HANDLE

TRIGGER

BATTERY

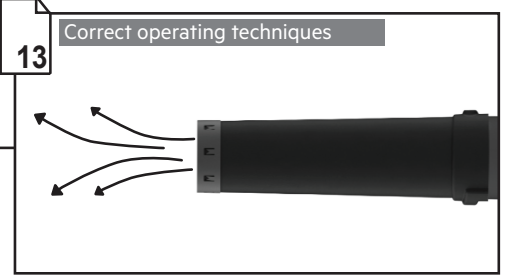
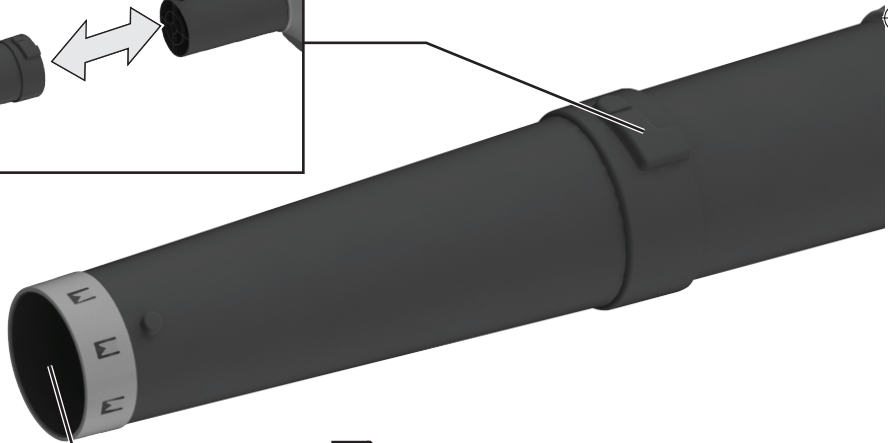
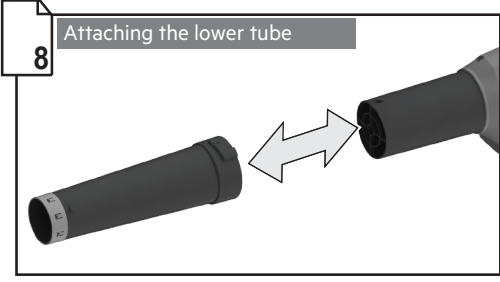
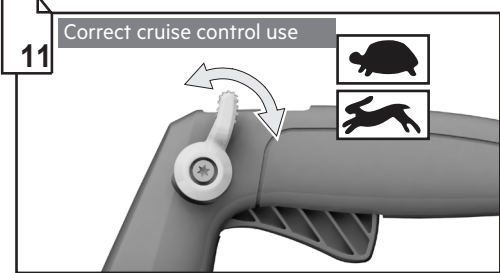
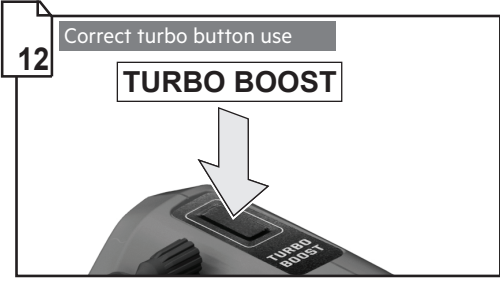

9

Inserting and removing the battery

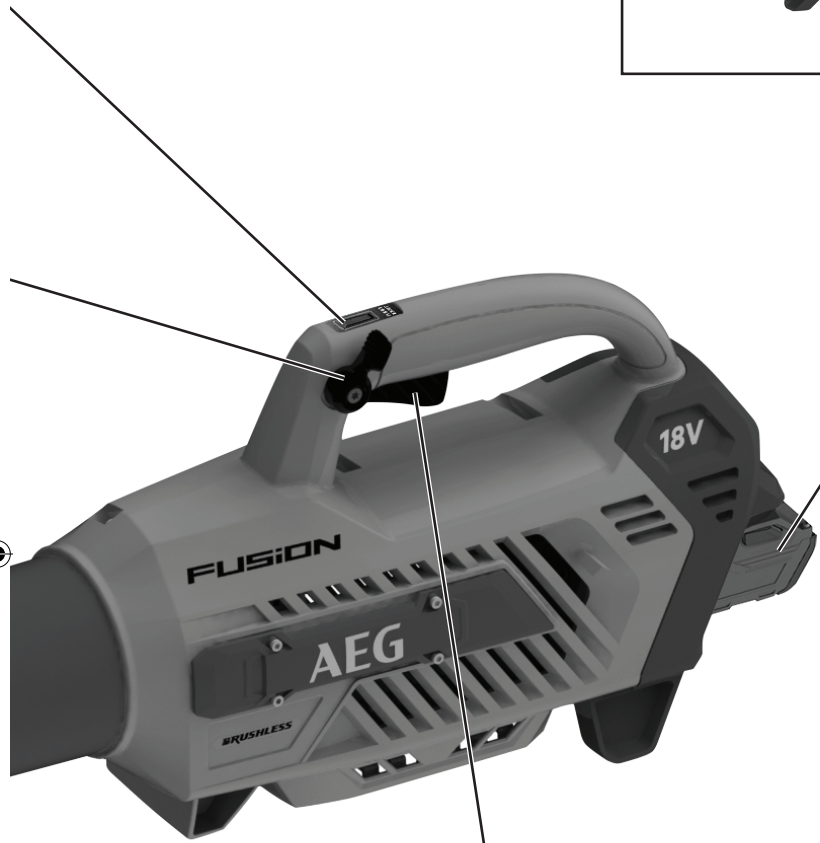
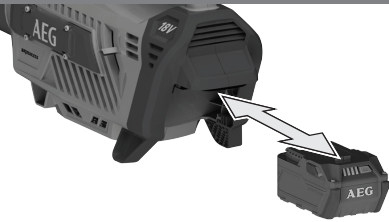

10

Correct trigger use

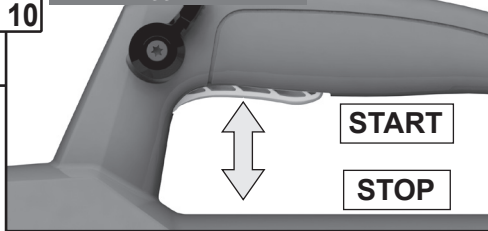

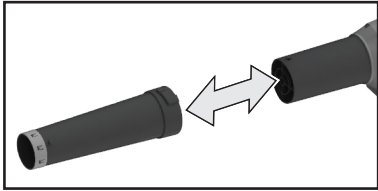

Attaching the lower tube

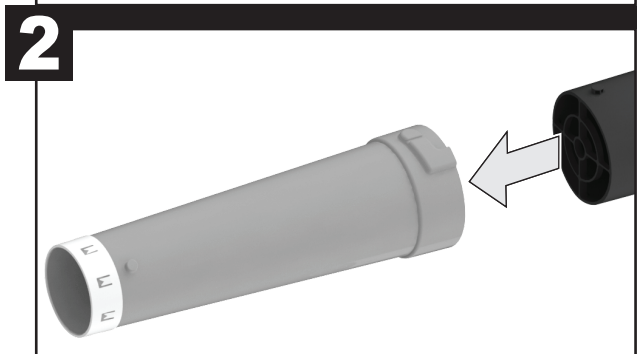
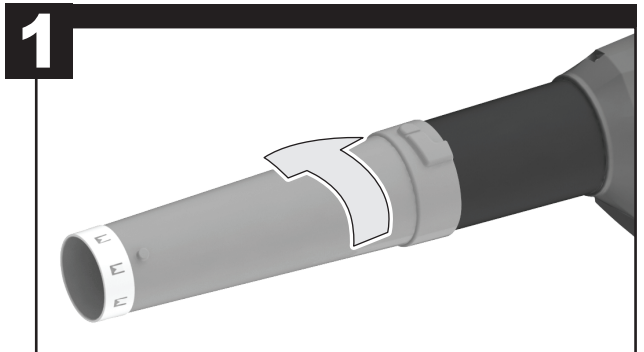
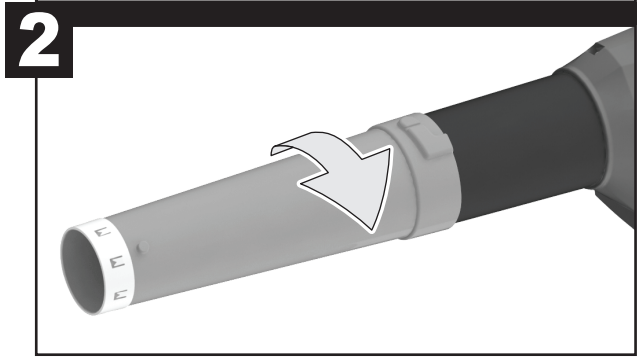
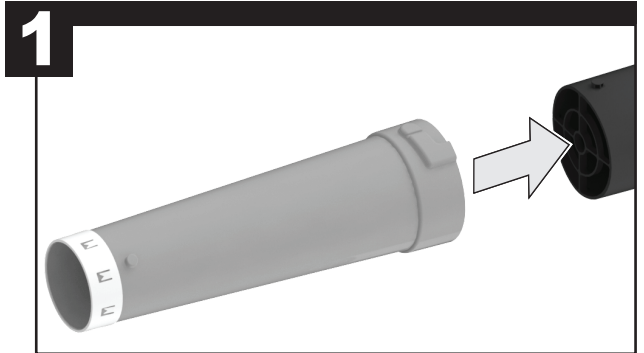

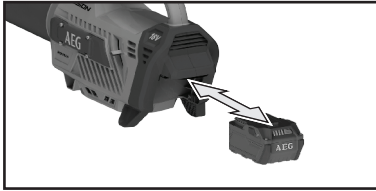

Inserting and removing the battery

NOTE: This AEG fusion blower is optimised for use with FORCE battery packs. For the best possible performance, use with AEG 18V FORCE battery packs.



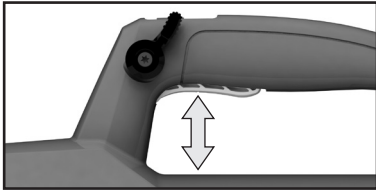

Correct trigger use

START

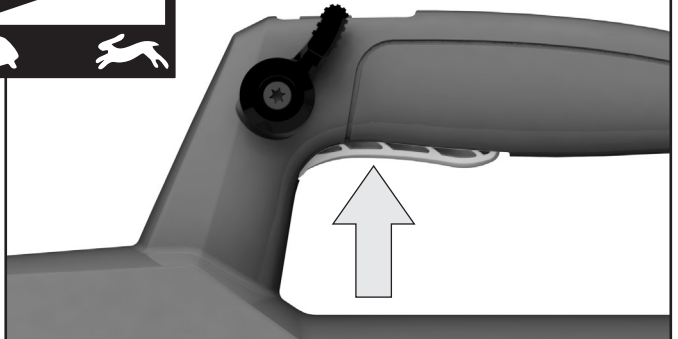
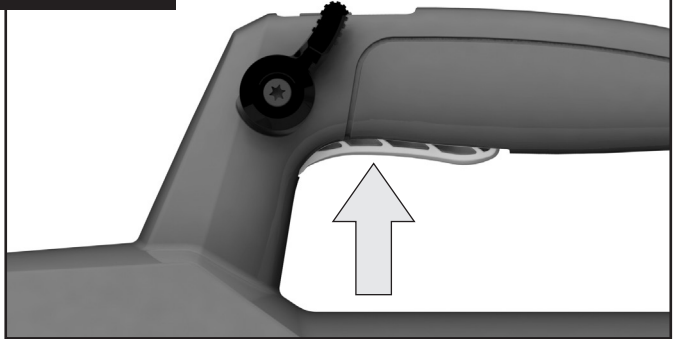

STOP

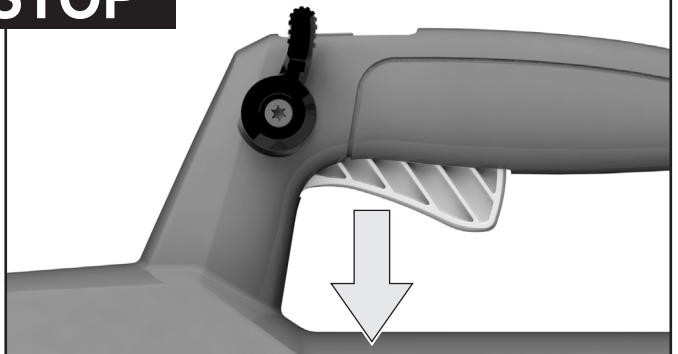

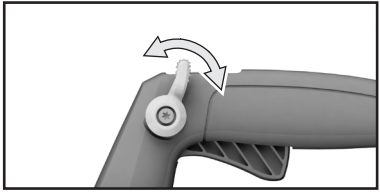

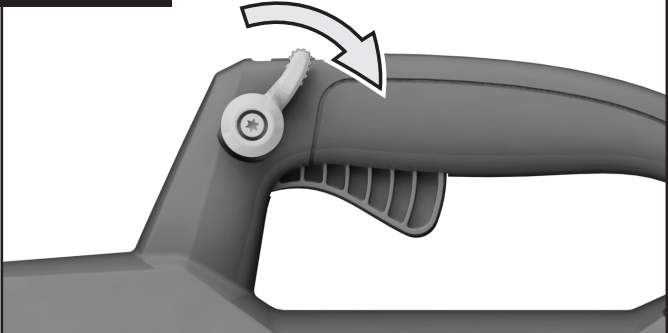

Correct cruise control use

START



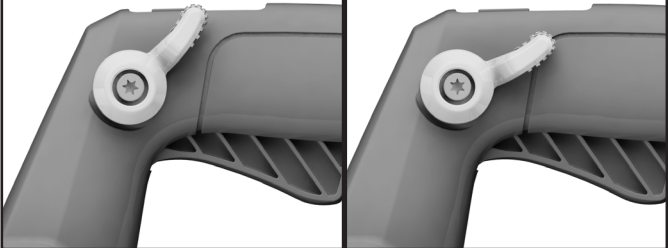

STOP



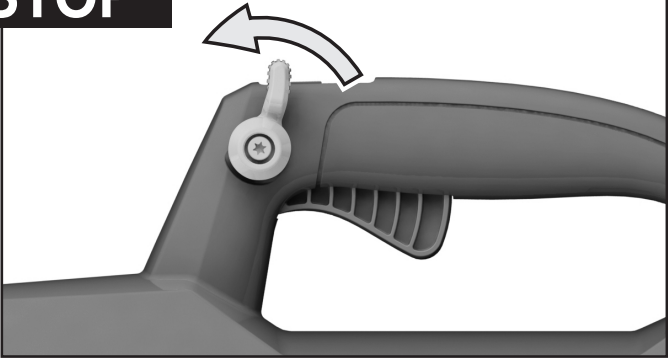

Correct turbo button use

START

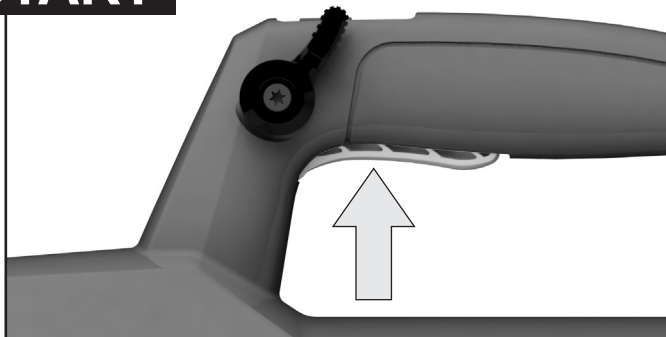

NOTE: The turbo boost button provides the highest performance for the tool, but will also drain the battery capacity more quickly. Use turbo boost only when required to maximise runtime.

TURBO BOOST



STOP

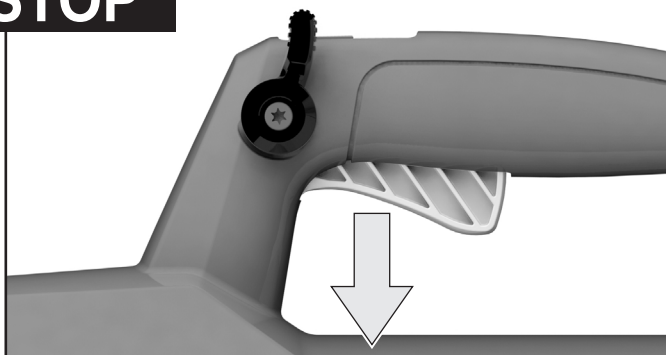

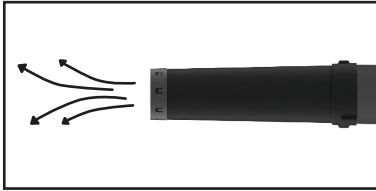

Correct operating techniques

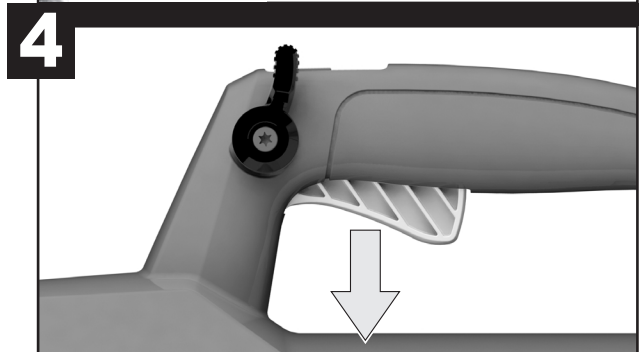
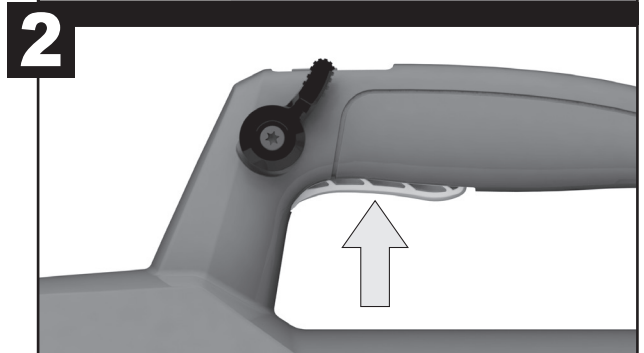
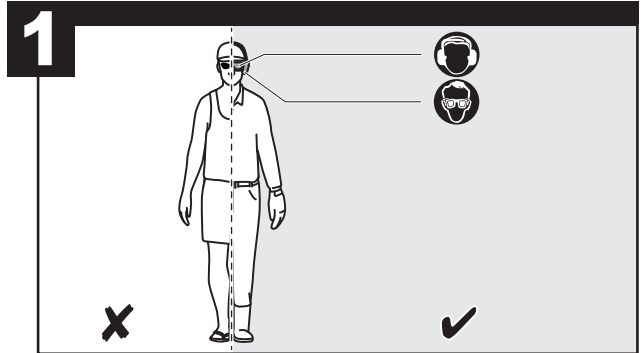

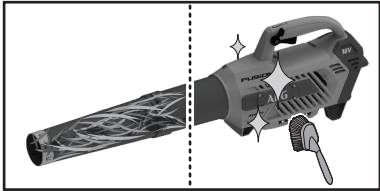

Maintenance

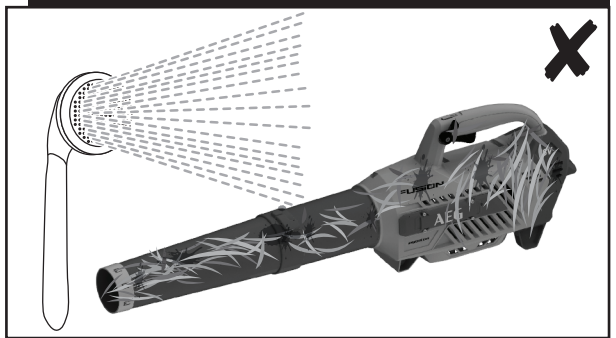
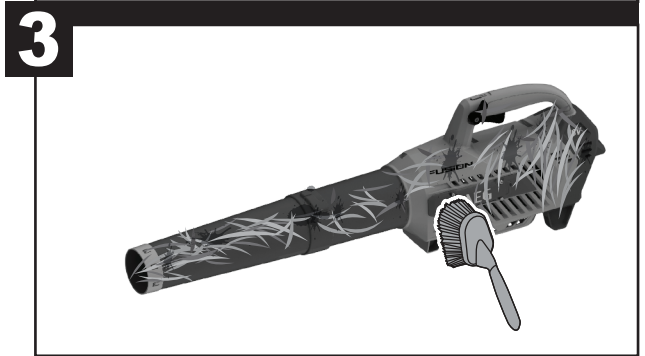
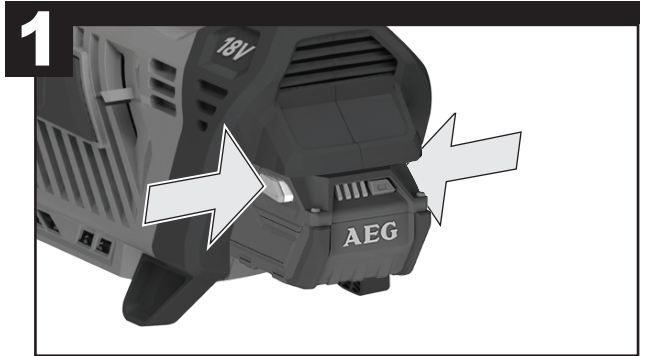

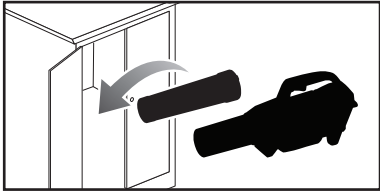

Storage

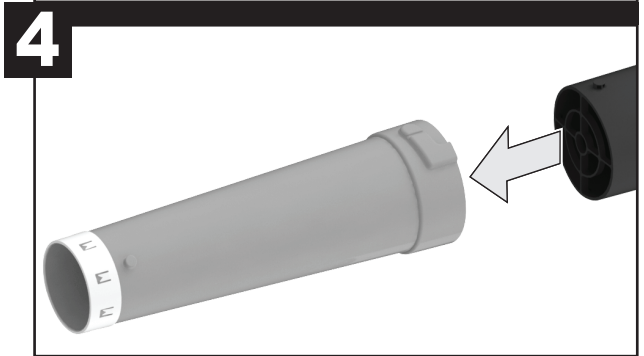
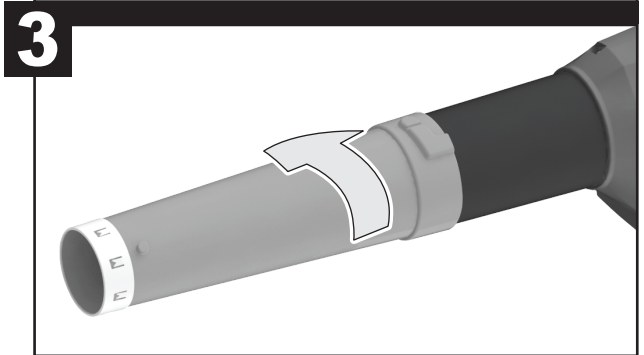
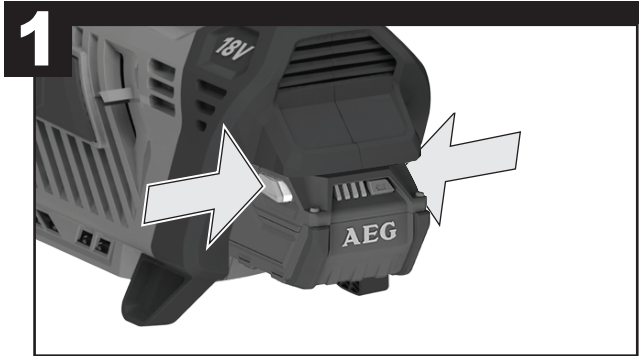

NOTE: Always store the unit in a cool, dry, and well ventilated area.

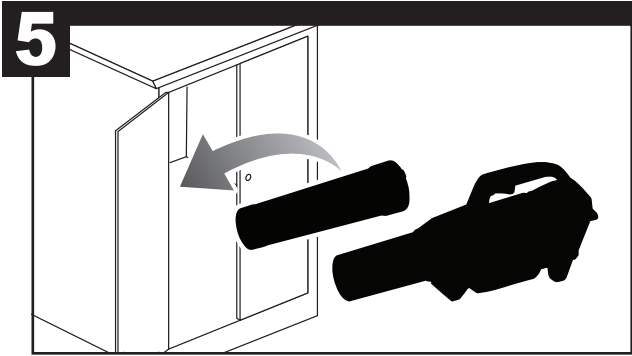

**TECHNICAL DATA****CORDLESS BLOWER****ABL18F/ABL18FF6**

Rated voltage	18 V DC
Rated current turbo mode	39 A
Turbo mode	
Air velocity turbo mode	200 km/h
Air volume turbo mode	465 CFM
Fan loaded speed turbo mode	19600 rpm
Weight	2.3 kg
Noise emission level (in accordance with EN 50636-2-100 Annex CC)	
A-weighted sound pressure level at the operator's position	$L_{PA} = 94.4 \text{ dB (A)}$
Uncertainty	$K = 2.5 \text{ dB}$
A-weighted sound power level	$L_{PA} = 107 \text{ dB (A)}$
$L_{WA} + K_{WA}$	110 dB
Vibration level (in accordance with EN 50636-2-100 Annex BB)	$a_h = 0.6 \text{ m/s}^2$
Uncertainty	$K = 1.5 \text{ m/s}^2$

BATTERY AND CHARGER

Model	ABL18F	ABL18FF6
Battery pack	Not included	L1860R-X5
Charger	Not included	BL1218-X4
Compatible battery packs	L1830R-X5, L1860R-X5, L1890R	
Compatible chargers	BLK1218, BL18DP2-X5, AL18G, BL1418, BL1218, BL1218LE, BL18DPS, AL1218G, BL18DP, BL18DP-LE, BL18DP-X5	

VIBRATION LEVEL**⚠ WARNING!**

The declared vibration value has been measured with a standard test method and may be used to compare one tool with another. The declared vibration value may be used in a preliminary assessment of exposure.

The vibration emission during actual use of power tool can differ from the declared total value depending on the ways in which the tool is used. Identify safety measures to protect yourself based on an estimation of exposure in the actual conditions of use, taking account of all parts of the operating cycle such as the times when the tool is switched off and when it is running idle in addition to the trigger time.

Safety, performance, and dependability have been given top priority in the design of your cordless blower.

INTENDED USE

The cordless blower is intended only for outdoor use, in dry, and well-illuminated conditions.

The product is not intended to be used by children or persons with reduced physical, mental, or sensory capabilities.

The product is designed for blowing light debris, such as leaves, grass, and other garden refuse.

Do not use the product for any other purpose.

GENERAL SAFETY WARNINGS**⚠ WARNING!**

Read all safety warnings and all instructions. Failure to follow the warnings and instructions may result in electric shock, fire, and/or serious injury. Save all warnings and instructions for future reference.

⚠ WARNING!

Never allow children or people unfamiliar with these instructions to use the product. Local regulations may restrict the age of the operator.

TRAINING

Read the instructions carefully. Be familiar with the controls and the correct use of the product.

Keep in mind that the operator or user is responsible for accidents or hazards occurring to other people or their property.

Do not use the product while tired, ill, or under the influence of alcohol, drugs, or medication.

PREPARATION

Some regions have regulations that restrict the use of the product to some operations. Check with your local authority for advice.

Wear hearing protection at all times while operating the product. Strictly adhere to precautions to reduce noise to prevent permanent hearing injury.

Wear full eye protection at all times while operating the product. Wear a full face mask or fully enclosed goggles. Normal spectacles or sunglasses are not adequate protection. Objects can be thrown at high speed by the powerful air jet at any time and may rebound from hard surfaces toward the operator.

While operating the product, always wear substantial footwear and



long trousers. Do not operate the product when barefoot or wearing open sandals. Avoid wearing clothing with loose fitting or that has hanging cords or ties.

Do not wear loose clothing or jewellery that can be drawn into the air inlet. Secure long hair so it is above shoulder level to prevent entanglement in moving parts.

Before each use, ensure that all controls and safety devices function correctly. Do not use the product if the off switch does not stop the product.

Operate the product in a recommended position and only on a firm and level surface.

Do not operate the product on a paved or gravel surface where ejected material could cause injury.

Before each use, always inspect the housing for damage. Ensure that guards and handles are in place and properly secured. Replace worn or damaged components in sets to preserve balance. Replace damaged or unreadable labels.

Never operate the product while people, especially children, or pets are nearby.

Keep all cooling air inlets clear of debris.

Use rakes and brooms to loosen debris before blowing.

Clear the work area before each use. Remove all objects such as rocks, broken glass, nails, wire, or string which can be blown a considerable distance by high velocity air.

BATTERY TOOL USE AND CARE

Recharge only with the charger specified by the manufacturer. A charger that is suitable for one type of battery pack may create a risk of fire when used with another battery pack.

Use power tools only with specifically designated battery packs. Use of any other battery packs may create a risk of injury and fire.

When battery pack is not in use, keep it away from other metal objects, like paper clips, coins, keys, nails, screws or other small metal objects that can make a connection from one terminal to another. Shorting the battery terminals together may cause burns or a fire.

Under abusive conditions, liquid may be ejected from the battery pack; avoid contact. If contact accidentally occurs, flush with water. If liquid contacts eyes, additionally seek medical help. Liquid ejected from the battery pack may cause irritation or burns.

Do not use a battery pack or tool that is damaged or modified. Damaged or modified batteries may exhibit unpredictable behaviour resulting in fire, explosion, or risk of injury.

Do not expose a battery pack or tool to fire or excessive temperatures. Exposure to fire or excessive temperature above 130°C may cause explosion.

Follow all charging instructions and do not charge the battery pack or tool outside the temperature range specified in the instructions. Charging improperly or at temperatures outside the specified range may damage the battery and increase the risk of fire.

OPERATION

Operate the product only at reasonable hours—not early in the morning or late at night when people might be disturbed.

Never operate the product in an explosive atmosphere.

Avoid using the product in bad weather conditions especially when there is a risk of lightning.

Keep bystanders, children, and pets 15 m away from the area of

operation. Stop the product if anyone enters the area.

Do not operate the product in poor lighting. The operator requires a clear view of the work area to identify potential hazards.

Operating similar tools nearby increases both the risk of hearing injury and the potential for other persons to enter your working area.

Always be sure of your footing on slopes. Walk, never run.

Keep proper footing and balance. Do not overreach. Overreaching can result in loss of balance.

Never use the product with defective guards or shields, or without safety devices in place.

Do not modify the product in any way or use parts and accessories that are not recommended by the manufacturer.

WARNING!

If the product is dropped, suffers heavy impact, or begins to vibrate abnormally, immediately stop the product and inspect for damage or identify the cause of the vibration. Any damage should be properly repaired or replaced by an authorised service centre.

To reduce the risk of injury associated with contacting rotating parts, always turn off the product and remove the battery pack. Make sure that all moving parts have come to a complete stop:

- before leaving the product unattended
- before clearing blockages
- before checking, cleaning, or working on the product
- before inspecting the product after striking a foreign object
- whenever the product starts to vibrate abnormally (inspect immediately)

Immediately turn off and remove the battery pack in the event of accident or breakdown. Do not operate the product again until it has been fully checked by an authorised service centre.

The product is provided with a cruise control lever near the trigger. Cruise control sets the speed at a convenient level to provide enough power to achieve the task. Low running speed will help reduce noise and vibration. Cruise control helps reduce operator fatigue.

Press the turbo boost to increase the air flow to the maximum velocity. The turbo boost will override the cruise control feature. The blower will return to the previously selected speed when the button is released.

WARNING!

Setting the cruise control will operate and lock the trigger. In this case, the trigger will not release and turn off the blower. Turn off the cruise control by pressing the lever fully forward to stop the motor of the blower.

BLOWER SAFETY WARNINGS

Wear a face filter mask in dusty conditions to reduce the risk of injury associated with the inhalation of dust.

Slightly dampen surfaces in dusty conditions.

Do not point the blower nozzle in the direction of people or pets.

Never place objects inside the blower tubes.

Do not operate the product near open windows.

Use the full blower nozzle extension so that the air stream can work close to the ground and perform effectively.

Do not place the blower on top of or near loose debris. Debris can be sucked into the intake vent, resulting in possible damage to the product.



ADDITIONAL BATTERY SAFETY WARNINGS

WARNING!

To reduce the risk of fire, personal injury, and product damage due to a short circuit, never immerse your tool, battery pack or charger in fluid or allow a fluid to flow inside them. Corrosive or conductive fluids, such as seawater, certain industrial chemicals, and bleach or bleach-containing products, etc., can cause a short circuit.

TRANSPORTATION AND STORAGE

Turn off the product, remove the battery pack, and allow it to cool before storing or transporting.

Clean all foreign materials from the product. Store the product in a cool, dry, and well-ventilated place that is inaccessible to children. Keep the product away from corrosive agents, such as garden chemicals and de-icing salts. Do not store the product outdoors.

For transportation in a vehicle, secure the product against movement or falling to prevent injury to persons or damage to the product.

TRANSPORTING LITHIUM BATTERIES

Transport the battery pack in accordance with local and national provisions and regulations.

Follow all special requirements on packaging and labelling when transporting batteries by a third party. Ensure that no batteries can come in contact with other batteries or conductive materials while in transport by protecting exposed connectors with insulating, non-conductive caps or tape. Do not transport batteries that are cracked or leaking. Check with the forwarding company for further advice.

MAINTENANCE

WARNING!

Use only original manufacturer's replacement parts, accessories, and attachments. Failure to do so can cause possible injury, can contribute to poor performance, and may void your warranty.

WARNING!

Servicing requires extreme care and knowledge and should be performed only by a qualified service technician. Have the product serviced by an authorised service centre only. When servicing, use only original replacement parts.

Do not make adjustments and repairs that are not described in this manual. For other repairs, contact an authorised service centre.

After each use, clean the product with a soft, dry cloth.

Check all nuts, bolts, and screws at frequent intervals for proper tightness to ensure that the product is in safe working condition. Any part that is damaged should be properly repaired or replaced by an authorised service centre.

Bring the product to an authorised service centre to replace damaged or unreadable labels.

CLEARING A BLOCKAGE

To reduce the risk of injury associated with contacting rotating parts, always turn off the product, remove the battery pack, and make sure that all moving parts have come to a complete stop.

Remove the blower tubes to inspect for blockage. Clear the tubes if required.

Re-install the blower tubes before starting the product.

RESIDUAL RISKS

Even when the product is used as prescribed, it is still impossible to completely eliminate certain residual risk factors. The following hazards may arise and the operator should pay special attention to avoid the following:

- injury caused by vibration
 - Always use the right tool for the job, hold the product by the designated handles and use the lowest speed necessary to achieve the task.
- injury caused by exposure to noise
 - Wear ear protection and limit exposure.
- injury caused by flying objects from the blow tube airflow
 - Wear eye protection at all times.

RISK REDUCTION

It has been reported that vibrations from handheld tools may contribute to a condition called Raynaud's Syndrome. Symptoms may include tingling, numbness, and blanching of the fingers, usually apparent upon exposure to cold. Hereditary factors, exposure to cold and dampness, diet, smoking, and work practices are all thought to contribute to the development of these symptoms. There are measures that can be taken by the operator to possibly reduce the effects of vibration:

- Keep your body warm in cold weather. When operating the product, wear gloves to keep the hands and wrists warm. It is reported that cold weather is a major factor contributing to Raynaud's Syndrome.
- After each period of operation, exercise to increase blood circulation.
- Take frequent work breaks. Limit the amount of exposure per day.

If you experience any of the symptoms of this condition, immediately discontinue use and see your physician.

WARNING!

Injuries may be caused or aggravated by prolonged use of the product. When using any tool for prolonged periods, ensure to take regular breaks.

SYMBOLS



Read and understand all instructions before operating the product. Follow all warnings and safety instructions.



Wear ear protection.



Wear eye protection.



Do not expose the product to rain or damp condition.





Beware of thrown or flying objects. Keep all bystanders, especially children and pets, at least 15m away from the operating area.



Rotating fans. Keep hands and feet out of openings while the product is running.



Remove the battery pack before starting any work on the product.



Regulatory Compliance Mark (RCM). The product meets applicable regulatory requirements.



The guaranteed sound power level is 110 dB.



Do not dispose of electric tools together with household waste material! In observance of European Directive 2002/96/EC on waste electrical and electronic equipment and its implementation in accordance with national law, electric tools that have reached the end of their life must be collected separately and returned to an environmentally compatible recycling facility.

The following signal words and meanings are intended to explain the levels of risk associated with this product.

 **DANGER**

Indicates an imminently hazardous situation, which, if not avoided, will result in death or serious injury.

 **WARNING**

Indicates a potentially hazardous situation, which, if not avoided, could result in death or serious injury.

 **CAUTION**

Indicates a potentially hazardous situation, which, if not avoided, may result in minor or moderate injury.

CAUTION

Without safety alert symbol

Indicates a situation that may result in property damage.











AEG



www.aegpowertools.com.au
www.aegpowertools.co.nz

Techtronic Industries Australia Pty Ltd

31 Gilby Road, Mount Waverley,
VIC, 3149, Australia

Techtronic Industries N.Z. Limited

Unit C, 70 Business Parade South,
Highbrook, Auckland 2013, New Zealand

960087370-01

*AEG is a registered trademark used under
license from AB Electrolux (publ).*

© 2019 Techtronic Cordless GP. All rights reserved.

