

**12 MONTHS HOME USE
REPLACEMENT WARRANTY**

**XDH-040
Operating Instructions**

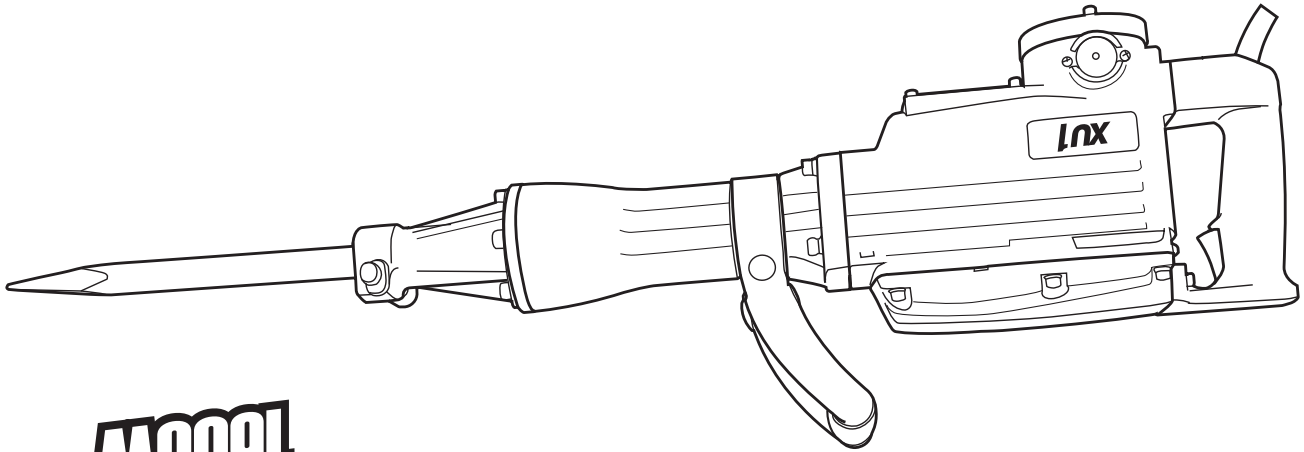

**Demolition
Kit
1600W**

XU1

XU1 Power tools

1-23 Letcon Drive, Bangholme, Victoria, Australia 3175

Telephone: 1800 069 486

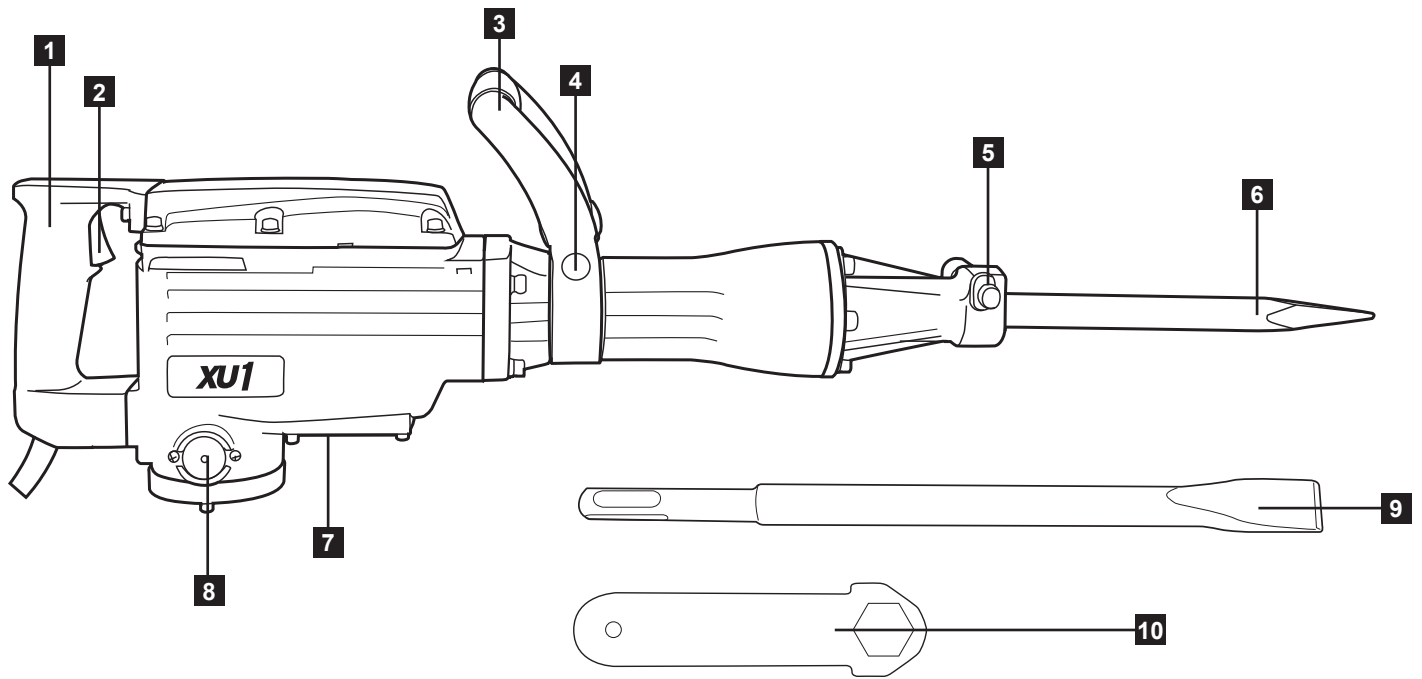

- 1 Rear Handle
- 2 On/Off Trigger
- 3 Adjustable Secondary Handle
- 4 Secondary Handle Securing Knob

- 5 Accessory Chuck
- 6 Pointed Chisel
- 7 Oil View Window
- 8 Carbon Brush Access Covers

- 9 Flat Chisel
- 10 Spanner

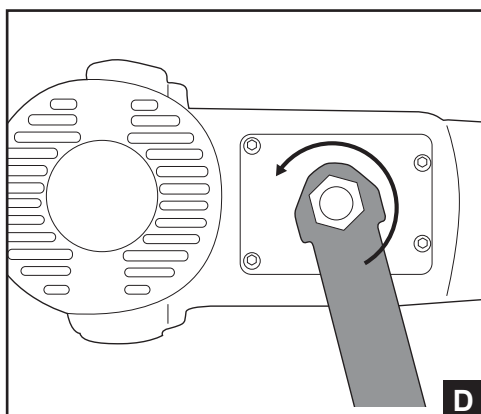
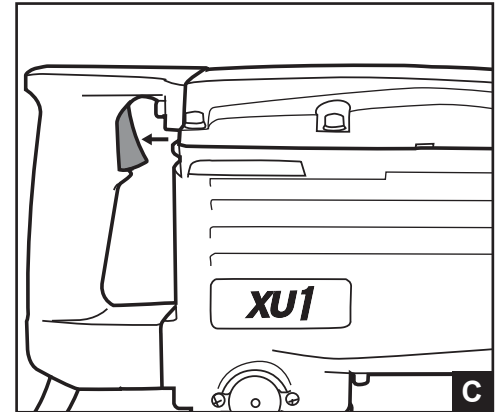
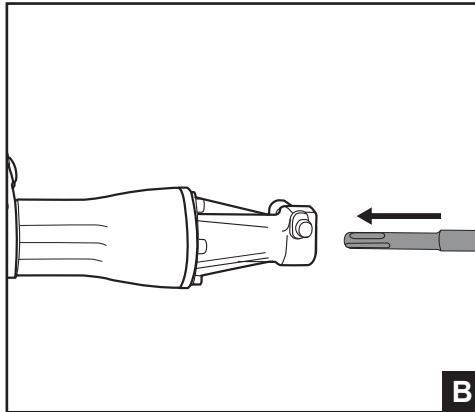
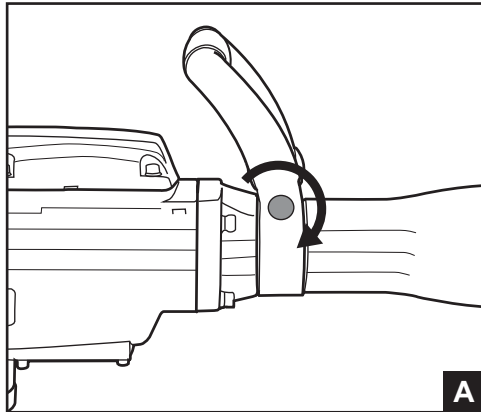

SPECIFICATIONS

Motor:	1600W
Impact Energy:	43J
Impact Rate:	1900/min
Chuck:	30mm Hex
Noise Level:	105dB
Tool Weight:	14.7kg

PROPER USE

This tool is intended for use in a DIY (Do It Yourself) context or for hobbyist purposes. It is not built for continuous daily use in a trade or professional capacity.

Before using the machine, carefully read these instructions, especially the safety rules to help ensure that your machine always operates properly.

Before attempting to operate the machine, familiarise yourself with the controls and make sure you know how to stop the machine quickly in an emergency.

Save these instructions and the other documents supplied with this machine for future reference.

SETUP



WARNING! Ensure the tool is turned off, disconnected from the power supply before performing any of the following operations.

Secondary Handle

The secondary handle must be fitted securely before operating the demolition breaker. The handle can be adjusted to suit all users by simply rotating into the desired orientation.

1. Loosen the Secondary Handle Securing Knob by rotating anti-clockwise.
2. Rotate the handle into the desired position.
3. Tighten the Secondary Handle Securing Knob to secure in position. **FIG. A**

Fitting Accessories



IMPORTANT! Always lubricate the accessory fitment prior to inserting. Using your finger apply grease sparingly to the shaft of the accessory.

1. Pull the Accessory Chuck bolt out as far as possible then rotate 180 degrees and release.
2. Insert the accessory into the chuck. **FIG. B**
3. Pull the Accessory Chuck bolt out and rotate 180 degrees to secure the accessory
4. Ensure the accessory is secure by trying to pull it out.

Note: The accessory should slide in the chuck but not be able to be removed.

CONTROLS



WARNING! The power supply for this product should be protected by a residual current device (rated at 30mA or less).

On/Off Switch

1. To turn the demolition breaker on, squeeze the On/Off Trigger. **FIG. C**
2. To turn the tool off, release the On/Off Trigger.



WARNING! After use, hold the tool away from your body until the demolition breaker stops completely. This may help to prevent serious injury.

OPERATION



IMPORTANT! Do not use the flat chisel as a "pry bar" as this will damage the flat chisel and potentially the demolition breaker. Such damage will void your warranty.

Using the Demolition Breaker

For best penetration rates in concrete, run the demolition breaker with a steady pressure, but do not use excessive force as this will decrease the efficiency of the tool.

1. Ensure the accessory and secondary handle are secure.
2. Position the tip of the tool in the desired starting position.
3. Ensure you have a stable stance and hold the tool firmly with both hands.
4. Press the On/Off Trigger to begin operation.
5. Apply steady pressure to allow the tool to break through the material.
6. Once the tool has completed the first pass through the material, reposition and repeat.

MAINTENANCE



WARNING! Ensure the tool is turned off and disconnected from the power supply before performing any of the following operations.

CLEANING



CAUTION! Excessive build up of dust particles may cause the tool to overheat and fail.

1. Keep the ventilation slots of the tool clean at all times. If possible prevent foreign matter from entering the vents.
2. After each use, blow air through the tool housing to ensure it is free from all dust particles that may build up.
3. If the enclosure of the tool requires cleaning, use a soft, moist cloth only. Do not use solvents.



CAUTION! Never immerse any part of the tool in liquid.

Checking the Oil Level

The oil level should be checked before each use.

1. Lay the tool on its side with the base facing you.
2. Inspect the oil view window. The level should be half way up the view window.
3. If the level is lower than this then you must add more oil following the procedure below.

Adding Oil

The oil tank is approximately 45ml, therefore you should add oil in small amounts.

Recommended Oil: SAE 15W/40 or an alternative of the same quality.

1. Lay the tool upside down so that the view window is facing up.
2. Unscrew the view window anti-clockwise using the supplied spanner. **FIG. D**
3. Add a small amount of oil through the view window hole.
4. Screw the view window back in and tighten using the supplied spanner in a clockwise direction.
5. Recheck the oil level and repeat this process if necessary.

Carbon Brushes

Carbon brushes will wear out after many uses, causing the sander to spark and/or stop. The brushes are a wearing component of the sander and should be replaced prior to the carbon wearing out completely. Take the sander to a suitably qualified electrician or power tool repairer for replacement. Always replace both brushes at the same time.

Note: XU1 will not be responsible for any damage or injuries caused by the repair of the tool by an unauthorised person or by mishandling of the tool.

TROUBLESHOOTING

1. **Not chiselling or low breaking power:**
 - Tool temperature is low;
 - Accessories are not lubricated;
 - Refer to the section 'Cold Hammering' below on how to resolve this issue.
2. **Accessory is jammed/stuck in concrete during use:**
 - Release the accessory locking mechanism, allowing the demolition breaker to be separated from the accessory. The accessory should be easily removed from the concrete once it is detached from the demolition hammer.
3. **Accessory repeatedly becomes stuck while in use:**
 - Free the accessory as described above. Refrain from penetrating too deeply with the chisel bit, as it is prone to becoming stuck when demolishing large pieces of concrete.
4. **A small amount of sparking is visible through the housing air vents:**
 - This is normal and does not indicate a problem.
5. **Excessive sparking is visible through the housing air vents and/or the demolition breaker is failing to operate:**
 - This may indicate the carbon brushes have worn out and need to be replaced. Carbon brushes should only be replaced by a qualified electrician or power tool repairer.

Cold Hammering

If the demolition hammer is stored for long periods of time at cold temperatures, the lubrication may become stiff and the demolition hammer may not hammer initially or the hammering may be weak.

Should this occur, insert an accessory into the demolition hammer, turn the demolition hammer on and apply the end of the accessory against a scrap piece of concrete or timber. Turn the demolition hammer on and off every few seconds. After 15 seconds to 2 minutes, the demolition hammer should have started to hammer normally. The colder the demolition hammer, the longer it may take to warm up and function like normal.

Note: Always wait until the accessory has stopped moving before putting down the demolition hammer.

WARRANTY

YOUR WARRANTY FORM SHOULD BE RETAINED BY YOU AT ALL TIMES. IN ORDER TO MAKE A CLAIM UNDER THIS WARRANTY YOU MUST RETURN THE PRODUCT TO YOUR NEAREST BUNNINGS WAREHOUSE WITH YOUR BUNNINGS REGISTER RECEIPT. PRIOR TO RETURNING YOUR PRODUCT FOR WARRANTY. PLEASE TELEPHONE OUR CUSTOMER SERVICE HELPLINE:

Australia 1800 069 486

New Zealand 0508 069 486

TO ENSURE A SPEEDY RESPONSE PLEASE HAVE THE MODEL NUMBER AND DATE OF PURCHASE AVAILABLE. A CUSTOMER SERVICE REPRESENTATIVE WILL TAKE YOUR CALL AND ANSWER ANY QUESTIONS YOU MAY HAVE RELATING TO THE WARRANTY POLICY OR PROCEDURE.

The benefits provided under this warranty are in addition to other rights and remedies which are available to you at law.

Our goods come with guarantees that cannot be excluded at law. You are entitled to a replacement or refund for a major failure and for compensation for any other reasonably foreseeable loss or damage. You are also entitled to have the goods repaired or replaced if the goods fail to be of acceptable quality and the failure does not amount to a major failure.

Generally you will be responsible for all costs associated with a claim under this warranty, however, where you have suffered any additional direct loss as a result of a defective product you may be able to claim such expenses by contacting our customer service helpline above.

1 YEAR REPLACEMENT WARRANTY

Your product is guaranteed for a period of 12 months from the original date of purchase and is intended for DIY (Do It Yourself) use only. If a product is defective it will be replaced in accordance with the terms of this warranty. Warranty excludes consumable parts, for example: driver bits.

WARNING

The following actions will result in the warranty being void.

- Professional, Industrial or high frequency use.
- If the tool has been operated on a supply voltage other than that specified on the tool.
- If the tool shows signs of damage or defects caused by or resulting from abuse, accidents or alterations.
- Failure to perform maintenance as set out within the instruction manual.
- If the tool is disassembled or tampered with in any way.

XU1

Australia/New Zealand (Head Office)

1-23 Letcon Drive, Bangholme, Victoria, Australia 3175

SAFETY INSTRUCTIONS



WARNING! When using mains-powered equipment, basic safety precautions, including the following, should always be followed to reduce risk of fire, electric shock, personal injury and material damage.



ALWAYS WEAR EYE, FACE AND EAR PROTECTION

When operating the tool

Keep the mains cable away from any moving parts or accessories.

Never cover the ventilation slots in the tool.

Electrical safety

The electric motor has been designed for 230-240V only. Always check that the power supply corresponds to the voltage on the rating plate.



This tool is double insulated; therefore no earth wire is required.

The power supply for this product should be protected by a residual current device (rated at 30mA or less). A residual current device reduces the risk of electric shock.

If the supply cord is damaged, it must be replaced by the manufacturer, its service agent or similarly qualified persons in order to avoid a hazard.

Using an extension lead

Always use an approved extension lead suitable for the power input of this tool. Before use, inspect the extension lead for signs of damage, wear and ageing. Replace the extension lead if damaged or defective.

When using an extension lead on a reel, always unwind the lead completely. Use of an extension lead not suitable for the power input of the tool or which is damaged or defective may result in a risk of fire and electric shock.

It is recommended that the extension lead is a maximum of 25m in length. DO not use multiple extension leads.

GENERAL POWER TOOL SAFETY WARNINGS



WARNING! Read all safety warnings and all instructions. Failure to follow the warnings and instructions may result in electric shock, fire and/or serious injury.
Save all warnings and instructions for future reference. The term "power tool" in all of the warnings refers to your mains-operated (corded) power tool or battery-operated (cordless) power tool.

1) Work area safety

a) Keep work area clean and well lit.

Cluttered and dark areas invite accidents.

b) Do not operate power tools in explosive atmospheres, such as in the presence of flammable liquids, gases or dust.

Power tools create sparks which may ignite the dust or fumes.

c) Keep children and bystanders away while operating a power tool.

Distractions can cause you to lose control.

2) Electrical safety

a) Power tool plugs must match the outlet. Never modify the plug in any way. Do not use any adapter plugs with earthed (grounded) power tools.

Unmodified plugs and matching outlets will reduce risk of electric shock.

b) Avoid body contact with earthed or grounded surfaces such as pipes, radiators, ranges and refrigerators.

There is an increased risk of electric shock if your body is earthed or grounded.

c) Do not expose power tools to rain or wet conditions.

Water entering a power tool will increase the risk of electric shock.

d) Do not abuse the cord. Never use the cord for carrying, pulling or unplugging the power tool. Keep cord away from heat, oil, sharp edges or moving parts.

Damaged or entangled cords increase the risk of electric shock.

e) When operating a power tool outdoors, use an extension cord suitable for outdoor use.

Use of a cord suitable for outdoor use reduces the risk of electric shock.

f) If operating a power tool in a damp location is unavoidable, use a residual current device (RCD) protected supply.

Use of an RCD reduces the risk of electric shock.

3) Personal safety

a) Stay alert, watch what you are doing and use common sense when operating a power tool. Do not use a power tool while drugs, alcohol or medication.

A moment of inattention while operating power tools may result in serious personal injury.

b) Use personal protective equipment. Always wear eye protection.

Personal protective equipment such as dust mask, non-skid safety shoes, hard hat, or hearing protection used for appropriate conditions will reduce personal injuries.

c) Prevent unintentional starting. Ensure the switch is in the off-position before connecting to power source and/or

battery pack, picking up or carrying the tool. Carrying power tools with your finger on the switch or energising power tools that have the switch on invites accidents.

d) Remove any adjusting key or wrench before turning the power tool on.

A wrench or a key left attached to a rotating part of the power tool may result in personal injury.

e) Do not overreach. Keep proper footing and balance at all times.

This enables better control of the power tool in unexpected situations.

f) Dress properly. Do not wear loose clothing or jewellery. Keep your hair, clothing and gloves away from moving parts.

Loose clothes, jewellery or long hair can be caught in moving parts.

g) If devices are provided for the connection of dust extraction and collection facilities, ensure these are connected and properly used.

Use of dust collection can reduce dust-related hazards.

4) Power tool use and care

a) Do not force the power tool. Use the correct power tool for your application.

The correct power tool will do the job better and safer at the rate for which it was designed.

b) Do not use the power tool if the switch does not turn it on and off.

Any power tool that cannot be controlled with the switch is dangerous and must be repaired.

c) Disconnect the plug from the power source and/or the battery pack from the power tool before making any adjustments, changing accessories, or storing power tools.

Such preventive safety measures reduce the risk of starting the power tool accidentally.

d) Store idle power tools out of the reach of children and do not allow persons unfamiliar with the power tool or these instructions to operate the power tool.

Power tools are dangerous in the hands of untrained users.

e) Maintain power tools. Check for misalignment or binding of moving parts, breakage of parts and any other condition that may affect the power tools operation. If damaged, have the power tool repaired before use.

Many accidents are caused by poorly maintained power tools.

f) Keep cutting tools sharp and clean.

Properly maintained cutting tools with sharp cutting edges are less likely to bind and are easier to control.

g) Use the power tool, accessories and tool bits etc. in accordance with these instructions and in the manner intended for the particular type of power tool, taking into account the working conditions and the work to be performed.

Use of the power tool for operations different from those intended could result in a hazardous situation.

h) Keep handles and grasping surfaces dry, clean and free from oil and grease.

Slippery handles and grasping surfaces do not allow for safe handling and control of the tool in unexpected situations.

5) Service

a) Have your power tool serviced by a qualified repair person using only identical replacement parts.

This will ensure that the safety of the power tool is maintained.

ADDITIONAL SAFETY WARNINGS FOR DEMOLITION HAMMERS

 **WARNING! Hold power tool by insulated gripping surfaces when performing an operation where the cutting accessory may contact hidden wiring or its own cord.** Cutting a 'live' wire may make exposed metal parts of the power tool 'live' and could give the operator an electric shock.

Safety Warnings Specific for Demolition Hammer Operations:

- Always use the side handle, this gives you greater control if the accessory should become jammed.
- Keep the cord clear of the accessory being used, do not wrap the cord around your arm or wrist.
- Use thick cushioned gloves and limit the exposure time by taking frequent breaks.
- Vibration caused by the hammer action may be harmful to your hands and arms.
- When removing an accessory from the tool avoid contact with skin and use proper protective gloves when grasping the bit or accessory. Accessories may be hot after prolonged use.

Safety Warnings Common for Demolition Operations:

- Always wear eye protection and a dust mask for dusty applications and when sanding overhead.** Sanding particles can be absorbed by your eyes and inhaled easily and may cause health complications.
- Wear ear protectors.** Exposure to noise can cause hearing loss.
- Use auxiliary handle(s), if supplied with the tool.** Loss of control can cause personal injury.
- Always use an approved extension lead suitable for the power input of this tool. Before use, inspect the extension lead for signs of damage, wear and ageing. Replace the extension lead if damaged or defective.
- When using an extension lead on a reel, always unwind the lead completely. Use of an extension lead not suitable for the power input of the tool or which is damaged or defective may result in a risk of fire and electric shock.
- It is recommended that the extension lead is a maximum of 25m in length. Do Not use multiple extension leads.
- Before drilling into walls, ceilings etc, ensure there are no concealed power cables or pipes in the cavity.

WARNING! Some dust created by power sanding, sawing, grinding, drilling and other construction activities contain chemicals known to cause cancer, birth defects or other reproductive harm.

Some examples of these chemicals are:

- Lead from lead-based paints;
- Crystalline silica from bricks, cement and other masonry products, and;
- Arsenic and chromium from chemically-treated timber.

The risk from such exposures vary depending on how often you do this type of work. To reduce your exposure to these chemicals; work in a well ventilated area, and work with approved safety equipment,

such as those dust masks that are specifically designed to filter out microscopic particles.

This appliance is not intended for use by persons (including children) with reduced physical, sensory or mental capabilities, or lack of experience and knowledge, unless they have been given supervision or instruction concerning use of the appliance by a person responsible for their safety.

Young children should be supervised to ensure that they do not play with the appliance.

DESCRIPTION OF SYMBOLS



Read instruction manual



Wear eye, breathing and hearing protection



R.C.M. Regulatory compliance mark



Do not put in the rubbish



Double insulated

V

Volts

~

Alternating current

Hz

Hertz

W

Watts

/min

Revolutions, reciprocations or strokes per minute

n₀

No load speed



Warning

CARING FOR THE ENVIRONMENT



Power tools that are no longer usable should not be disposed of with household waste but in an environmentally friendly way.

Please recycle where facilities exist. Check with your local council authority for recycling advice.



Recycling packaging reduces the need for landfill and raw materials.

Reuse of recycled material decreases pollution in the environment. Please recycle packaging where facilities exist.

Check with your local council authority for recycling advice.