

BTCR9AU Remote Control

INSTALLATION and INSTRUCTION SHEET

fanSync Bluetooth receiver and hand piece included, allows 3 fan speeds and light control (supports dimming)

Free fanSync app available for some smart devices, allows 3 fan speeds, light control (supports dimming) and timer function

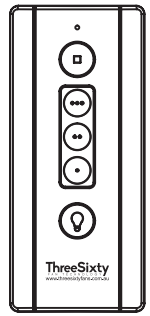

**MUST BE INSTALLED
BY A LICENSED
ELECTRICIAN**

RECEIVER ELECTRICAL SPECS:

220-240V, 50 Hz, Max. 100W – Min. 15W (Fan motor)
Incandescent lamp: Max. 250W CFL: Max. 120W LED lamp: Max. 40W

1. Install the Bluetooth Receiver

NOTE: Fans with Pull Chains must be set to HIGH speed and light kits (if any) set in the ON position
CAUTION: To avoid electrical shock, ensure electricity is turned off at the main fuse box before wiring

Step 1. Connect wires as shown in Figure 1

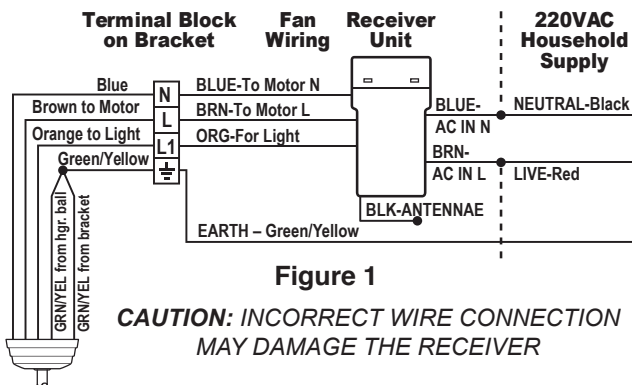

Figure 1

**CAUTION: INCORRECT WIRE CONNECTION
MAY DAMAGE THE RECEIVER**

Step 2. Once the connections have been made, slide the receiver into the hanger bracket taking care not to pinch the wires (Figure 2)

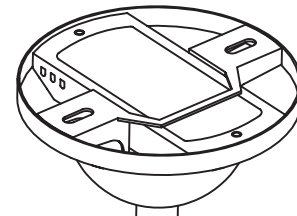

Figure 2

IMPORTANT: The supply to the remote receiver should be connected through a mains isolation switch (e.g. existing wall switch). Do not use this product in conjunction with any variable (rheostat) wall control

2. Setup the Hand Piece

IMPORTANT: The Remote Control Hand Piece and Remote Receiver are paired at the factory and **DO NOT** need to be paired for standard installations or when changing the battery

Basic settings for Hand Piece

1. Open the back cover of the hand piece
2. Dip Switches are preprogrammed at the factory to match the receiver and do not need to be changed in a standard installation
3. Ensure the battery is correctly installed as shown in Figure 3. Battery will weaken with age and reduce the working range of the hand piece transmitter
4. When using a light, set the Dimmer Switch to Dimmer (D) if bulbs support dimming, otherwise set to ON/OFF (O)

Installing the Wall Plate

5. Attach the wall plate using the two screws supplied as shown in Figure 4

Functions of your hand piece (transmitter)

Refer to Section 4 (overleaf) for further information

Dip Switch

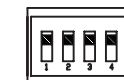

Dimmer Switch

DIMMER ← ON/OFF

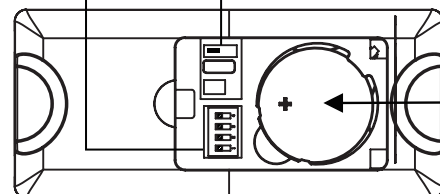

**BATTERY
CR2430 3V**

Figure 3

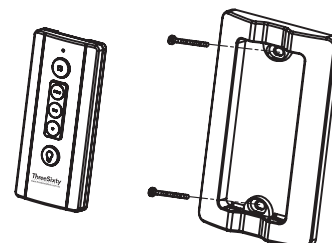



Figure 4

2. Setup the Hand Piece (cont'd)

IMPORTANT: The following steps are optional and do not need to be completed for a standard installation. Follow these steps only if replacing hand piece, receiver or controlling multiple fans with one hand piece

Pairing Process for Receiver & Hand Piece

Optional: Set desired transmitter code by pushing dip switches up or down

1. Switch off power to fan (from isolation switch or fuse box) and wait 60 seconds
2. Restore power to fan and complete next step within 30 seconds
3. Press and hold the fan OFF button  for 1 to 3 seconds (refer to Figure 8)
4. The fan will turn off (if running) and then turn back on to medium

Controlling multiple fan receivers with one hand piece

1. Ensure each fan has a remote receiver correctly installed
2. Choose one hand piece to use as the master remote
3. Complete the **Pairing Process** (outlined to the left) for each fan

3. Setup the fanSync App (optional)

Visit the Apple App Store or the Google Play Store to download the freely available fanSync app. Complete these steps for each fan installed with a Bluetooth receiver

IMPORTANT: Bluetooth must be turned on in your smart device settings

NOTE: Not all smart devices are compatible with the fanSync app, refer to Specification Sheet



Figure 5

Step 1. Open the fanSync app and tap the new fan to begin setup

NOTE: Most fans do not support reversing from a remote or wall control

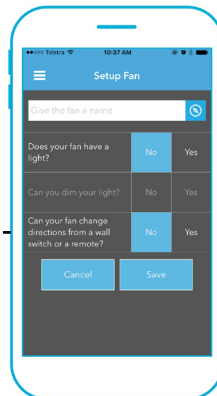

Figure 6

Step 2. Give the fan a name and specify your fan's options

NOT SURE? Leave the defaults; you can always change the settings later

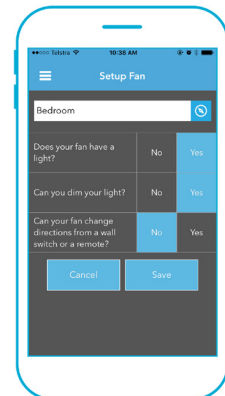

Figure 7

Step 3. Press Save and your fan will be ready to operate

4. Controlling your fan

The wall-mounted remote control can be used to control the ceiling fan in conjunction with the fanSync app

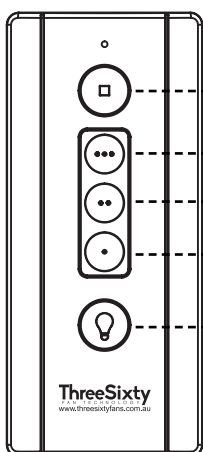







Figure 8

-  Turns fan ON/OFF
-  Fan speed HIGH
-  Fan speed MED
-  Fan speed LOW
-  Light Dimmer
Press and hold to dim or brighten
Light ON/OFF
Press and release immediately

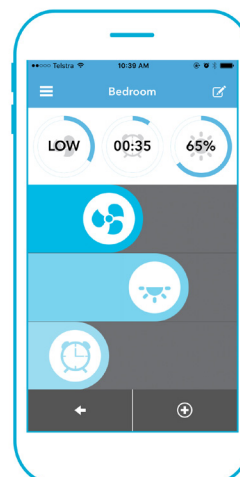

Figure 9

- Name of fan
- Fan setting indicators
Speed / Timer / Light
- Fan speed control
- Light level control
- Fan timer (minutes)