

2 PCS

HÄFELE

SALICE 94° HINGE

Inset - Slide On

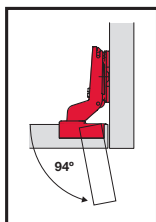

Drilling Instructions

Hinge Cup (Door)

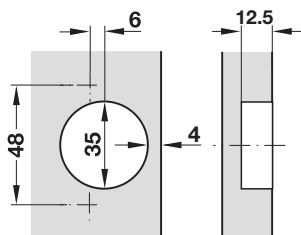

Mounting Instructions

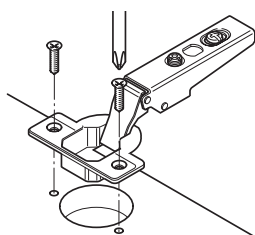

Mount Plate (Cabinet Side)

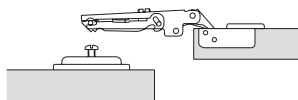
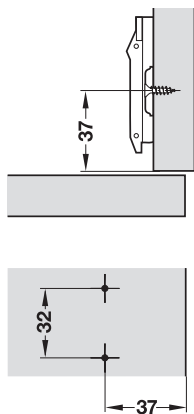

Place hinge on mounting plate. Positioning with pre-determined end stop.

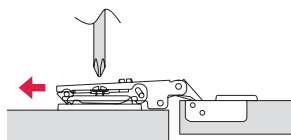

Apply light pressure.

Adjusting the Door

Depth adjustment of door with SALICE mounting plates.

It is possible to adjust the door up to $+2.8$ mm. The slot on the metal bottom plate allows the hinge to slide. Afterwards the screw must be re-tightened.

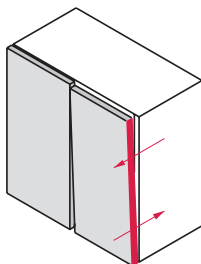
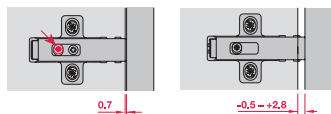

Height adjustment of door with SALICE cruciform mounting plates with slot.

Height adjustment of door of ± 2 mm is possible by loosening the two fixing screws. The slots allow the mounting plates to slide in both directions. Afterwards the screws must be re-tightened.

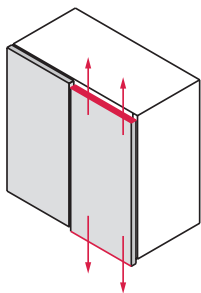
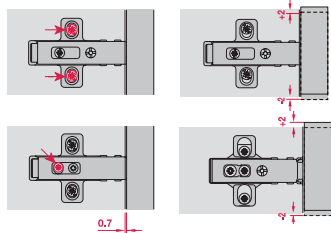

Lateral adjustment of door with SALICE concealed hinges.

The adjusting screw produces the lateral travel of the hinge arm from -1.5 mm up to $+4.5$ mm. This value is reduced to -0.5 mm when using profile door hinges and mini hinges. The door moves with respect to the furniture side without coming apart. There are no further correcting actions required.

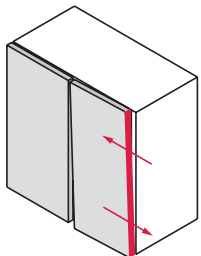
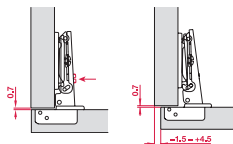

HÄFELE

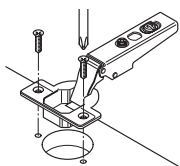
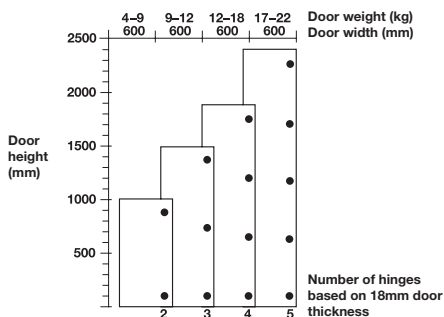

Tools Required:

- > 35mm Ø Drill Bit & Template Kit
- > 2mm Ø Drill Bit
- > Pencil
- > Power Drill
- > No 2 Pozidrive Screwdriver / Screw Bit

Screw fixing

Cup fixed with screws (countersunk head).

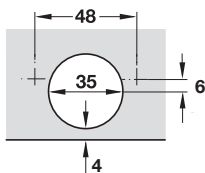

Salice Hinge Drilling Pattern

MADE IN ITALY



HÄFELE AUSTRALIA PTY. LTD
ARTICLE # 483.02.423

8 MONTEREY RD DANDENONG VIC 3175
730.83.636