



# Instructions 2.9m x 1.5m Original Range 4 in 1



## IMPORTANT NOTES

- Before assembly and whilst unpacking, please be aware that there are sharp corners and edges that could cause injury and it is advisable to wear protective gloves when handling these items, sensible shoes are also recommended. Until such time as the SAFETY EDGE is fitted all necessary precautions need to be undertaken to avoid injury.
- We recommend placing the bottom edge of the bed on a layer of 10-20mm gravel, this allows excellent drainage and protects the bottom edge of the bed. Placing the bed on level ground is also advised.
- If filling with a bobcat or backhoe fill initial 1/3 of bed slowly. Also when filling your veggie bed do not climb in as this puts unnecessary pressure onto the bed.
- Initially place all wing nuts in loosely & then tighten (using the wingnut tension tool as shown below), failure to tighten each nut and bolt to its maximum may cause failure. A screwdriver or cordless drill may assist with this process.

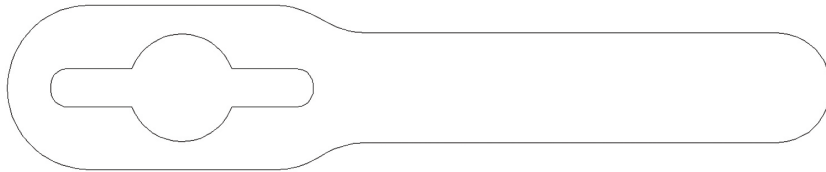

- The 820mm high bed requires a support brace to be fitted 4th hole from the bottom. The 600mm high bed requires a brace 3rd hole from the bottom. This is required on the Standard, Narrow and Rectangle (as shown on below configurations diagram).

## CONFIGURATIONS

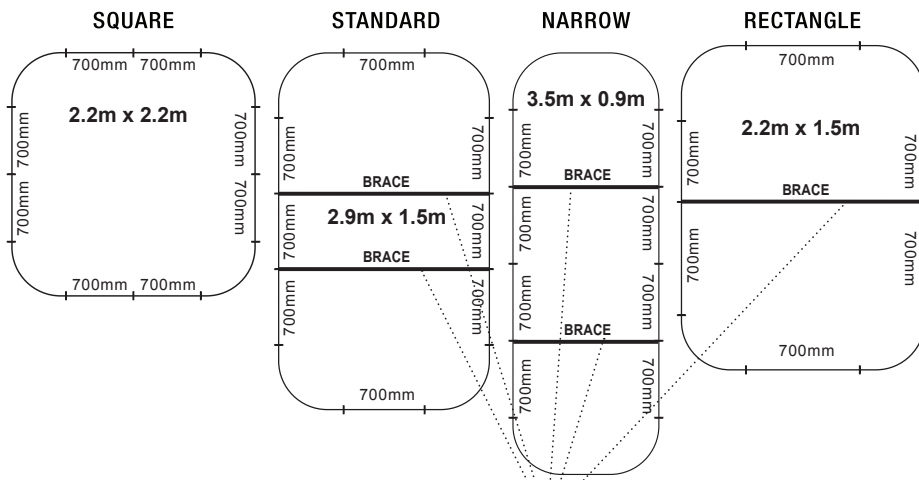

(Following information applies to 600mm and 820mm high bed only)

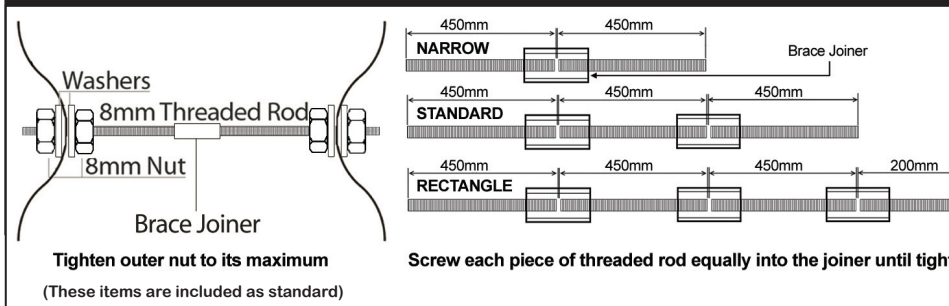

## ASSEMBLY

- > **STEP 1**  
Remove protective plastic covering (on all coloured beds).

- > **STEP 2**  
Please follow below assembly diagram.

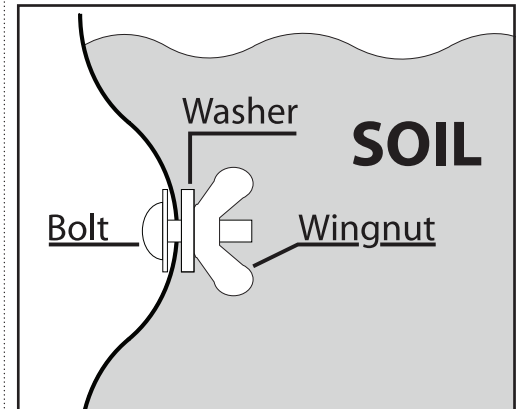

- > **STEP 3**  
Simply push the rubber edging onto the rolled steel edge and trim excess. The safety edging is designed to lock onto the rolled steel edge making it more permanent.

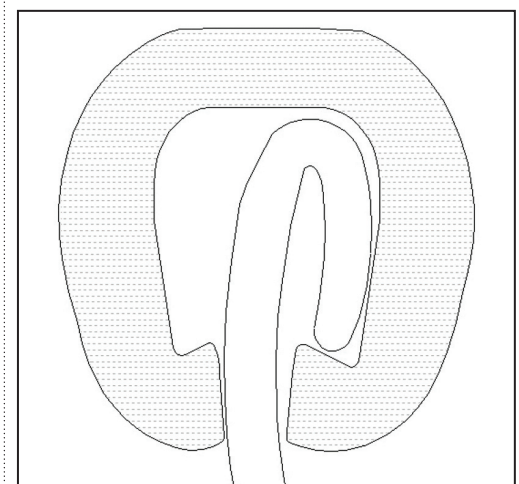
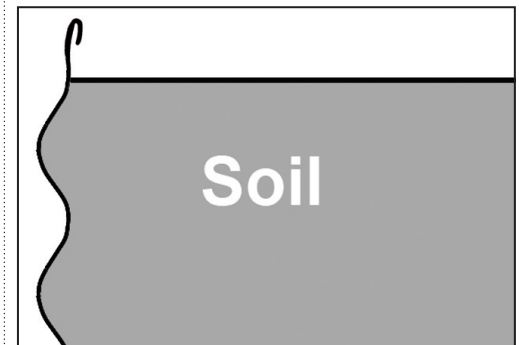

PLEASE RECYCLE ALL PACKAGING & PLASTIC FILM  
FOR MORE PRODUCTS VISIT [WWW.BIRDIESGARDENPRODUCTS.COM.AU](http://WWW.BIRDIESGARDENPRODUCTS.COM.AU)  
HAPPY AND SUSTAINABLE GARDENING!