



3 x DRAWER ASSEMBLY INSTRUCTION

NO	MODEL	DESCRIPTION	QTY
1		CONFIRMAT SCREWS	12
2		DOWELS	12
3		BACKING NAILS	60
4		5/8 X 6 WOOD SCREWS	18
5		INFILL	1

NO	MODEL	DESCRIPTION	QTY
6		CAMS	6
7		CAM PINS	6
8		30mm 8 GAUGE SCREW	3
9		EURO SCREWS	12
10		HANDLE	3
11		RUNNERS PER SET	3

STEP 1.

LAYOUT YOUR DRAWER PIECES FLAT AS PER DESIGN WITH PRE-DRILLED HOLES FACING UP.

START WITH THE BACK OF THE FRONT DRAWER AND PLACE YOUR DOWELS & CAM PIN IN THE PRE-DRILLED HOLES ON EITHER SIDE AS INSTRUCTED BELOW.

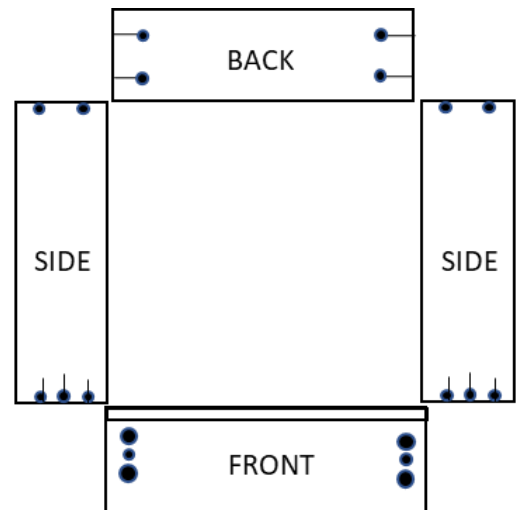
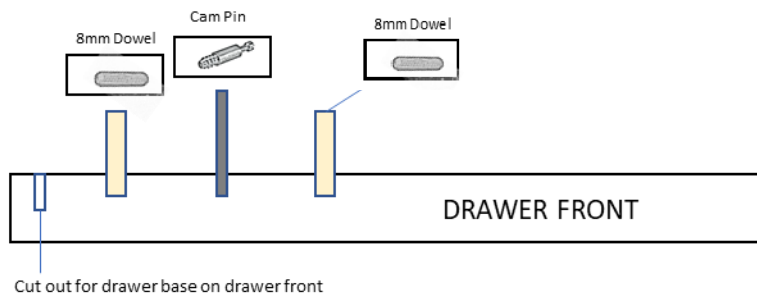

STEP 2.

GRAB YOUR FIRST SIDE AND INSERT YOUR CAMS INTO THE HOLE PROVIDED ON THE OUTSIDE OF THE DRAWER SIDE GENTLY AS PER INSTRUCTIONS BELOW.

IMPORTANT NOTICE:



PLACE THE FITTING OVER THE HOLE KEEPING THE SQUARE EDGE OF THE FITTING PARALLEL TO THE FACE OF THE BOARD, KNOCK IN **CAREFULLY**.

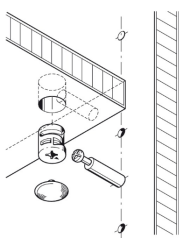

PUSH THE SIDE INTO THE FRONT DOWELS & PIN AND THEN CAREFULLY USING A SCREW DRIVER TURN UNTIL IT LOCKS IN. REPEAT THIS PROCESS WITH THE OTHER SIDE.

NOW PLACE YOUR LAST PIECE BETWEEN THE TWO SIDES USING THE SCREWS SUPPLIED SCREW INTO THE SIDES OF THE BACK DRAWER PIECE.



DRAWER ASSEMBLY

STEP 3.

YOUR DRAWER SHOULD BE FACING DOWN WITH THE FRONT DRAWER EXPOSING THE CUTOUT FOR THE BASE TO BE PUSHED INTO FACE DOWN WITH THE BROWN SIDE SHOWING. MAKING SURE YOU HAVE THE DRAWER SQUARE, PROCEED TO NAIL DOWN THE BASE SPACING THEM OUT AROUND THE EDGE OF THE THREE SIDES.

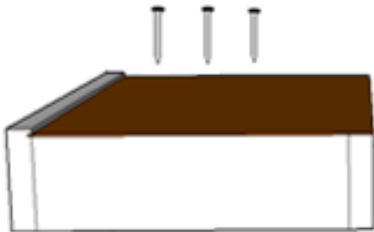

STEP 4.

RUNNER PLACEMENT

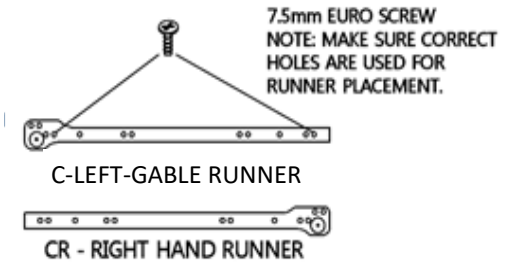

PLACE YOUR RUNNERS INTO THE DESIGNATED HOLES MAKING SURE THE WHEEL IS FACING TO THE FRONT OF THE GABLE. HOLE POSITION NO 1, 8 AND 15 .

YOUR DRAWER RUNNER WILL HAVE THE WHEEL TO THE BACK OF THE DRAWER.

STEP 5.

USING THE HANDLE SCREW (NO:5) ATTACH THE HANDLE TO THE BACK OF THE DRAWER FRONT INTO THE PREDRILLED HOLES ALREADY PROVIDED.

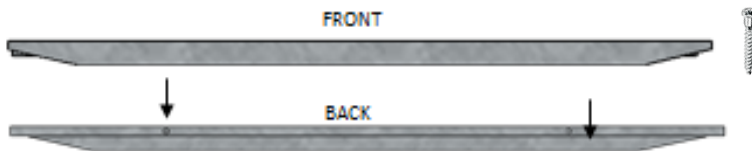

STEP 6.

PLACE YOUR DRAWER RUNNER ON THE BOTTOM OF THE DRAWER USING THE WOOD SCREWS PROVIDED (No:4) SCREW TWO INTO EACH RUNNER . REPEAT FOR THE OTHER SIDE.

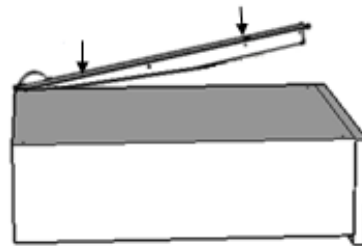

PICTURE OF YOUR FINISHED DRAWER



Multistore Industries (Aust) Pty Ltd

9 Nevilles Street, Underwood, QLD 4119

Tel—(07) 3208 6799

Fax- (07) 3209 6332

www.multistore.com.au

sales@multistore.com.au



MULTISTORE

INSTRUCTIONS FOR RUNNER PLACEMENT

9 Nevilles Street,
Underwood Qld 4119
Ph. (07) 3208 6799 Fax: (07) 3290 6332
Int Ph: +617 3208 6799 Int Fax: +617 3290 6332

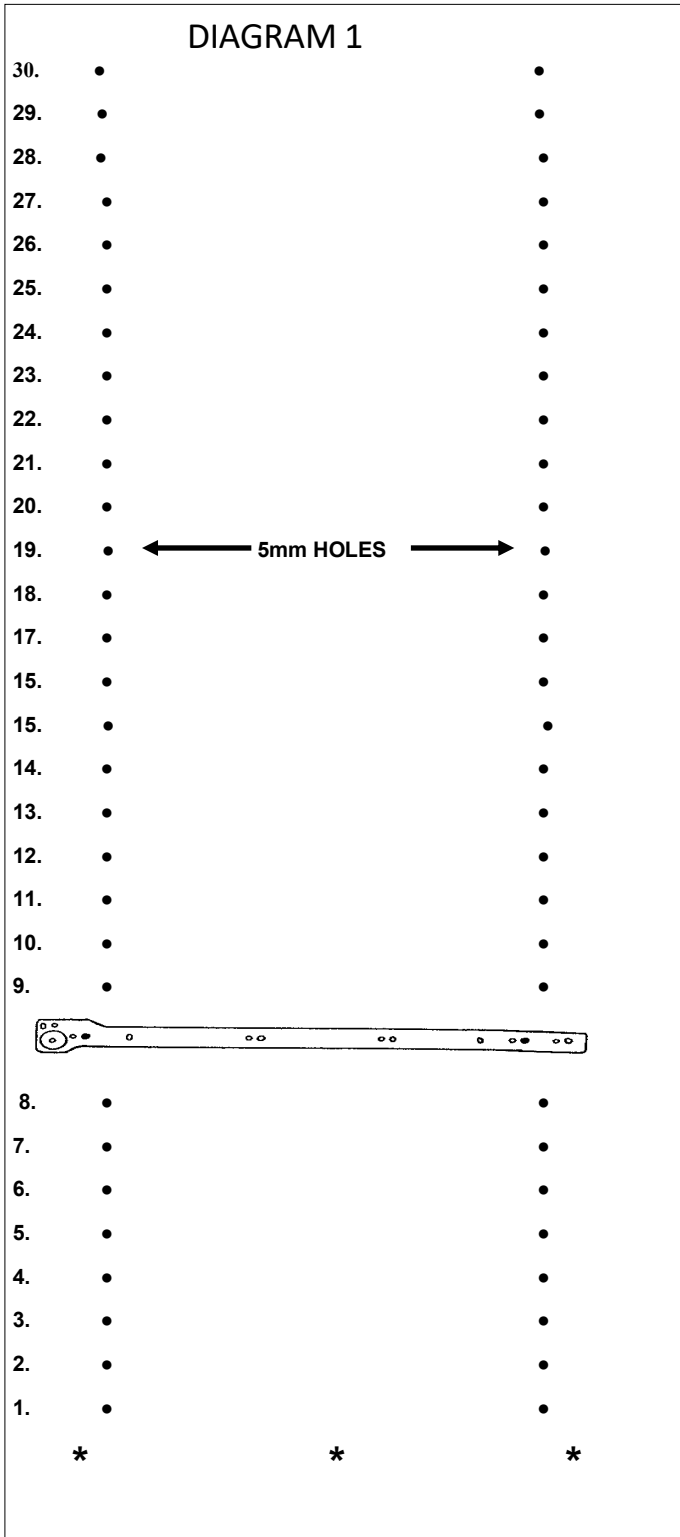

*** = FIXED SHELF HOLES & KICK**

Place metal runners in their correct hole positions (see above DIAGRAM 1) making sure CL = LEFT HAND GABLE & CR = RIGHT HAND GABLE, then attach using the special 7.5 euro screws provided. (see diagram to the right). →

<u>Executive Series</u>			
Models	Hole Positions	Fixed Shelf Position	
EXC – 4J	1 – 8 – 15 - 22	N/A	
EXC – 5C	1 – 8 – 15 – 20 – 25	N/A	
EXC – 4B	8 – 16 – 24 - 32	N/A	
EXC – 2B	8 – 14	N/A	
EXB - 5C	1 – 8 – 15 – 20 – 25	N/A	
EXB – 4J	1 – 8 – 15 – 20	N/A	
EXB – 4B	8 – 16 – 22 – 28	N/A	
<u>Executive 750 'H' SERIES</u>			
Models	Hole Positions	CAM PIN-Hole Positions	
HS		8	
H1	1	8	
H2	1 – 6	11	
H3	1 – 8 – 13	20	
<u>MAXI ULTRA 'H' SERIES</u>			
Models	Hole Positions	CAM PIN-Hole Positions	
H1	1	8	
HS2	1	8 – 15	
H2	1 – 8	13	
HS		8	
<u>MAXI ULTRA & ULTRA SERIES</u>			
Models	Hole Positions	Models	Hole Positions
450	1-6-11-16	LSD550	1-8
315C	1-8-15-20	LSD330	1
515	1-6-11-16-21		
<u>MAXI & MSM SERIES</u>			
Models	Hole Positions	Fixed Shelf Position	
16J3	1 – 8 – 15	22	
C16	1 – 8 – 15 – 20 – 25	30	
C06	1 – 8 – 15 – 20 – 25	30	
600J3	8 – 15 - 22		
400J3	1 – 8 – 15		

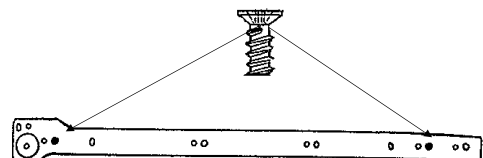



WARRANTY

Our goods come with guarantees that cannot be excluded under the Australian Consumer Law. You are entitled to a replacement or refund for major failure.

10 Year Warranty

- If the purchaser has a fault or defect with this product, the purchaser needs to contact Multistore Industries (Aust) directly on (07) 3208 6799 and state date of purchase, place of purchase and proof of purchase.
- Multistore Industries (Aust) will replace any faulty or defect parts at no cost to the customer. A replacement will be sent to you as soon as possible, or product can be exchanged at the store of purchase.
- This warranty is in addition to other rights and remedies of the customer under law.

Sincerely,

Multistore Industries (Aust) Management