

# FEEL THE FREEDOM AND CREATE YOUR OWN CLEAN, CONTEMPORARY AND COMMERCIAL INSPIRED DESIGNS.

If you get your home design inspiration from the modern, high-end apartment, office and retail complexes of urban landscapes, then Scyon™ Matrix™ cladding is for you. Just by adding a Matrix feature wall or architectural highlight to your home, you can transform even the most traditional design into something unique and eye-catching. Or use Matrix cladding as your primary building material to create a bold and industrial look throughout.



Matrix Cladding in a staggered vertical layout



Matrix Cladding in a horizontal layout



Matrix Cladding in a horizontal layout

## Matrix™ Cladding Range



### Features and Benefits

- Create unique designs with vertical, horizontal, square or staggered layouts.
- 4 sheet sizes to facilitate design choice 1190 x 1190, 2390 x 590, 1790 x 890 and 2990 x 1190.
- Panels have a smooth sanded finish and are sealed on all sides and pre-primed for a lasting quality finish.
- Install Matrix panels over vertical Scyon fibre cement cavity battens rather than the expensive steel top hats of commercial express joint cladding systems.
- Cavity battens can be fastened with 65 x 2.8mm ring shank nails or 75 x 2.8mm D or round head smooth shank nails.
- Install onto timber or light gauge steel frames. Cavity battens can be installed on or off stud.
- Can be nailed to cavity battens using 25mm DA stainless steel brad nails (Up to N3 and C1 wind classifications).
- BAL Rating up to BAL 29 for bushfire prone areas. This can be upgraded to FZ with a HardieSmart boundary wall system.
- Resists damage from shrinking, swelling, cracking, rot, moisture and termites when installed and maintained correctly.
- Made in Australia for Australian conditions.
- Read the installation guide before commencing work for more details on flashing, framing, fixing, details, warranties, warnings and safe work practices.

Matrix™ cladding installation

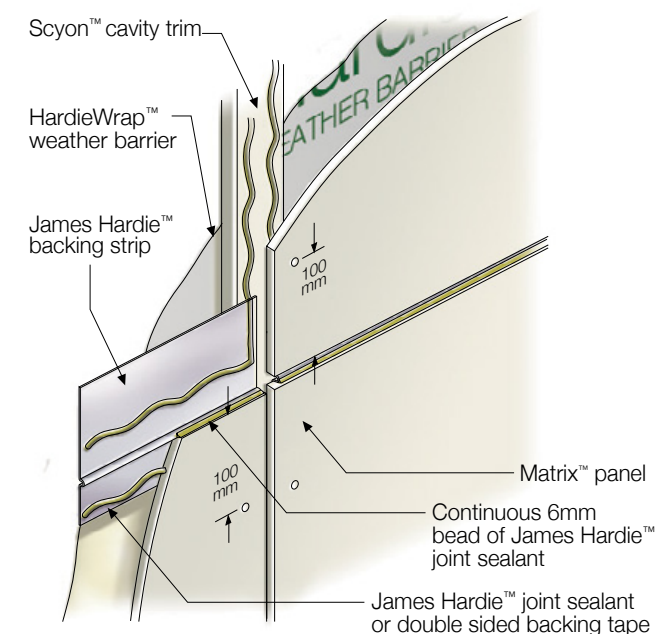

See Installation Guide for full details.

### Sizes

Product code	Length (mm)	Width (mm)	Thickness (mm)	Mass (kg/m <sup>2</sup> )
403811	1,190	1,190	8	12.6
403810	2,390	590	8	12.6
403812	1,790	890	8	12.6
404169	2,990	1,190	8	12.6
<b>Scyon™ cavity trim</b>				
403840	2,450	70	19	3.4

### Accessories

Accessories	Code	Illustration	Accessories	Code	Illustration
James Hardie™ Backing Strip 1,190mm	305557		James Hardie™ 18mm PVC Cavity Vent Strip	305555	
James Hardie™ Backing Strip 2,390mm	305558		James Hardie™ Base Coat 15kg Bag	304491	
James Hardie™ Backing Strip 2,990mm	305559		HardieDrive™ Facade Washers	305565	
James Hardie™ 9mm Aluminium External Corner	305521		James Hardie™ Joint Sealant* 300ml cartridge	305534	
HardieBlade™ Saw Blade 254mm	303375		James Hardie™ Joint Sealant* 600ml sausage	305672	
HardieBlade™ Saw Blade 254mm	303375		HardieDrive™ Screws 40mm long	305533	

© James Hardie Australia Pty Ltd ABN 12 084 635 558 2016. ™ and ® denote trademarks and registered trademarks owned by James Hardie Technology Ltd.

### ADDITIONAL PRODUCT INFORMATION

Go to the Matrix Cladding page at [jameshardie.com.au](http://jameshardie.com.au) for:

- Installation Guide
- Warranty
- Safety information including Safety Data Sheet, warnings and safe work practices.