

ozito

POLE HEDGE TRIMMER

900W 410mm

INSTRUCTION MANUAL

SPECIFICATIONS

Motor:	900W
Input:	230 – 240V ~ 50Hz
No Load Speed:	1000/min
Blade length:	410mm
Max. Blade Capacity:	18mm
Weight (Tool Only):	6.05kgs

ozito.com.au

3 YEAR REPLACEMENT WARRANTY

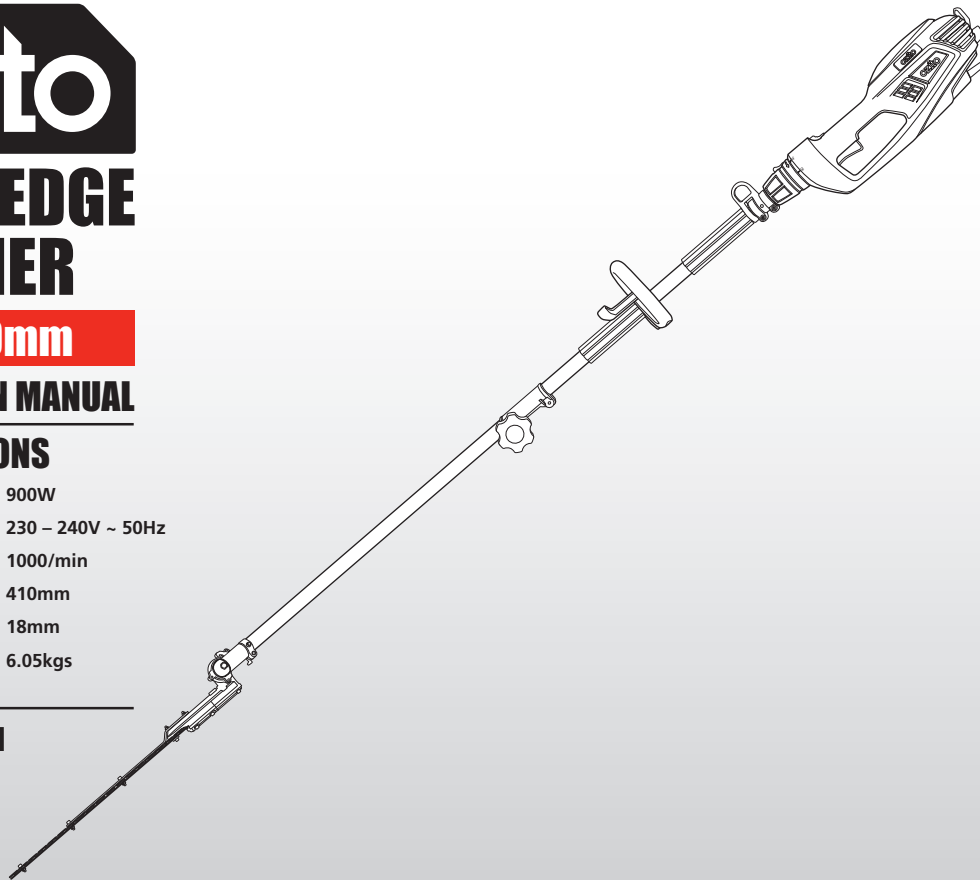

WHAT'S IN THE BOX

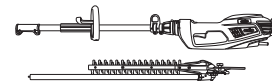

Pole Hedge Trimmer (2 parts)



Blade Cover



Auxiliary D-handle



Auxiliary Straight Handle



Auxiliary Handle Bracket

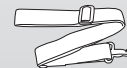

Shoulder Strap



2 x Assembly Bolts



Hex Key

PHT-410

KNOW YOUR PRODUCT

POLE HEDGE TRIMMER

- | | |
|----------------------------------|--------------------------------|
| 1. Blade | 11. Upper shaft |
| 2. Blade angle adjustment handle | 12. Auxiliary straight handle |
| 3. Extension cord restraint | 13. Lower shaft |
| 4. Rear handle | 14. Shaft locking knob |
| 5. Lock off switch | 15. Blade adjustment lock knob |
| 6. Rotating handle lock | 16. Angle head lock mechanism |
| 7. Shoulder strap bracket | 17. Upper locking lever |
| 8. Safety slide | 18. Lower locking lever |
| 9. On/off button | 19. Gearbox |
| 10. Auxiliary D-handle | |

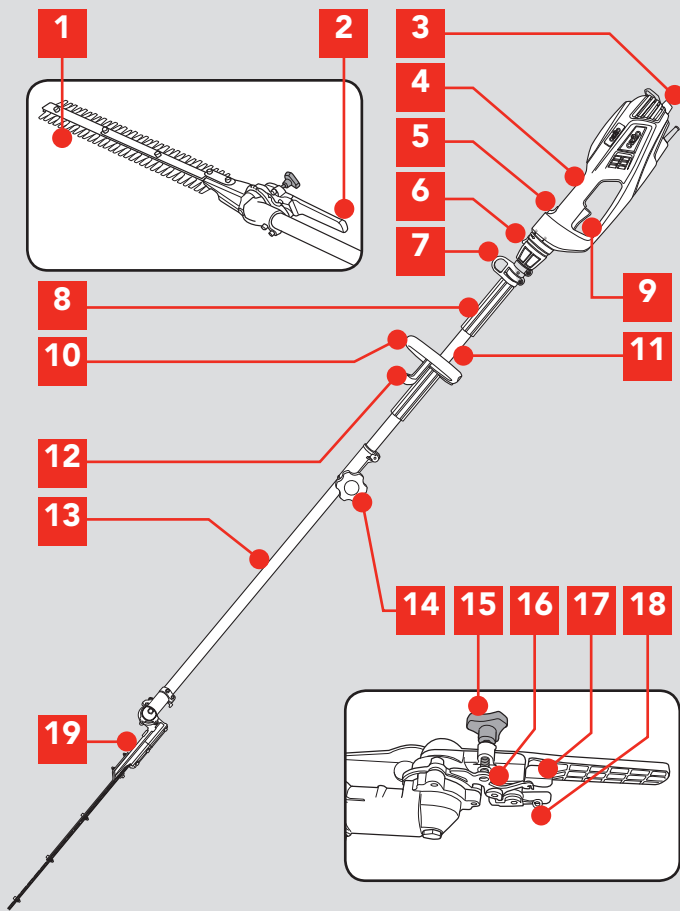

ACCESSORIES

- 20. Shoulder strap
- 21. Blade cover
- 22. Hex key

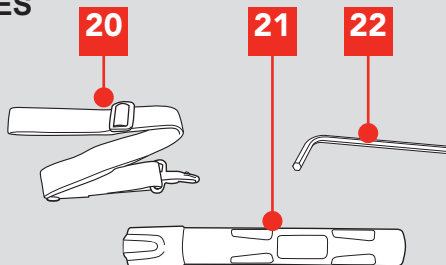

ONLINE MANUAL

Scan this QR Code with your mobile device to take you to the online manual.



ASSEMBLY

1. SHAFT ASSEMBLY

WARNING! TO PREVENT ACCIDENTAL STARTING, ENSURE THAT THE POLE HEDGE TRIMMER IS DISCONNECTED FROM THE POWER SUPPLY BEFORE MAKING ANY ADJUSTMENTS.

Assembling upper shaft to lower shaft

1. Align the upper shaft locking button with the locking hole of the lower shaft.

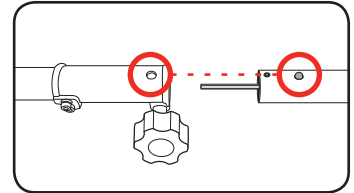

2. Slide the upper shaft of the pole hedge trimmer on to the lower shaft.

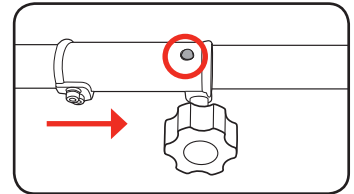

3. Ensure the upper shaft locking button clicks into the hole of the lower shaft.

Note: Gently pull the upper shaft to ensure the locking button has engaged correctly into the hole of the lower shaft.

4. Once the upper shaft and lower shaft have locked together tighten the shaft locking knob in a clockwise direction.

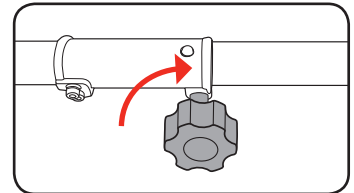

3

YEAR REPLACEMENT WARRANTY

SETUP & PREPARATION

2. AUXILIARY HANDLE ASSEMBLY

Assembling the adjustable auxiliary handle

1. Locate the adjustable auxiliary D-handle and adjustable auxiliary straight handle onto the lower shaft between the two safety slides.

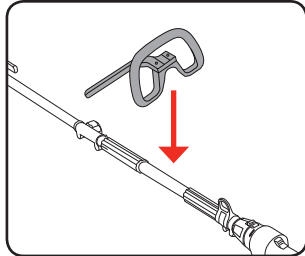

2. Place the adjustable auxiliary handle bracket onto the lower shaft and insert the 2 x assembly bolts supplied through the holes of the auxiliary handle bracket, adjustable auxiliary D-handle and adjustable auxiliary straight handle.

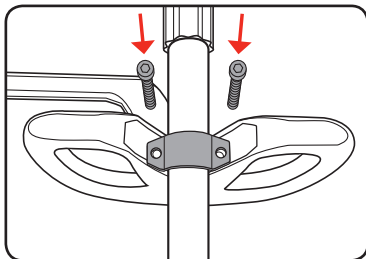

3. Position the auxiliary handles in a comfortable position and tighten the two screws with the Hex key provided.

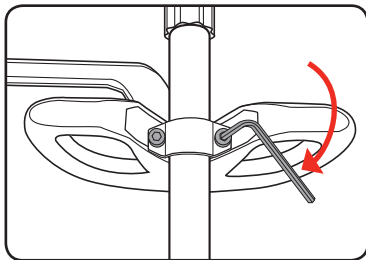

Note: The Hex key is located on the underside of the auxiliary straight handle.

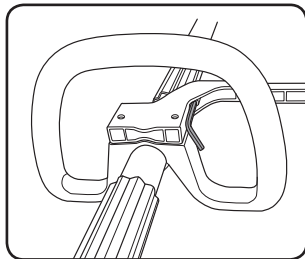

3. ADJUSTMENTS

Adjusting the auxiliary handle

1. Loosen the two bolts securing the auxiliary handle bracket, adjustable auxiliary D-handle and adjustable auxiliary straight handle.

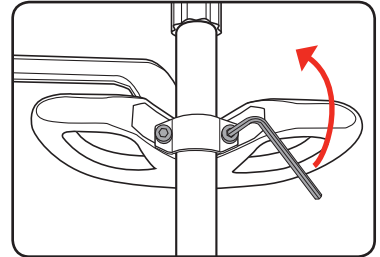

2. Move the adjustable auxiliary handles up or down to the desired position. Retighten the two bolts to secure the adjustable handles.

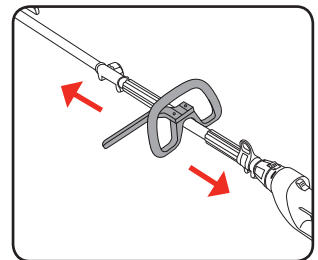

Assembling the shoulder strap

1. Hook the shoulder strap onto the shoulder strap attachment bracket.
2. Adjust the shoulder strap to a length that is suitable to you.

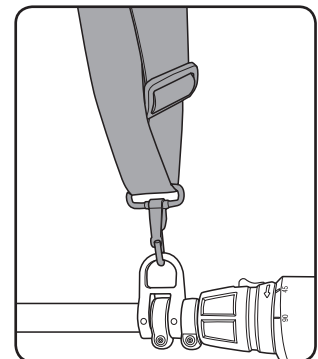

OPERATION

4. USING THE POLE HEDGE TRIMMER

Adjusting the blade angle

WARNING! DO NOT HOLD THE BLADE IN AN ATTEMPT TO ADJUST THE BLADE ANGLE. DOING SO MAY RESULT IN POSSIBLE PERSONAL INJURY.

1. Lie the pole hedge trimmer on the ground, then hold the upper shaft firmly and turn the blade adjustment locking knob anti clockwise to unlock the head locking mechanism.

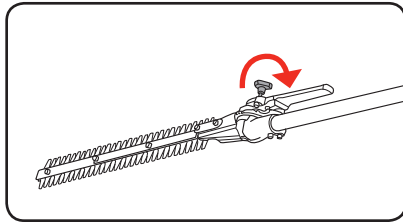

2. Hold the blade angle adjustment handle with the other hand and depress both the lower locking lever and the upper locking lever simultaneously.

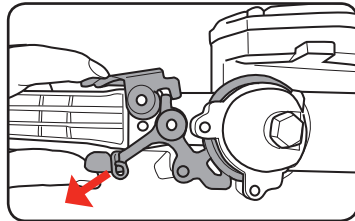

3. Rotate the blade to the desired angle. Release both locking levers. Continue to rotate until both levers 'click' to locate in one of the preset positions.

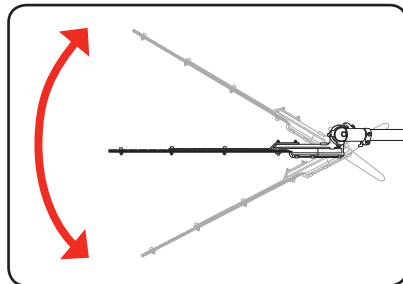

4. Tighten the blade adjustment locking knob by rotating clockwise.

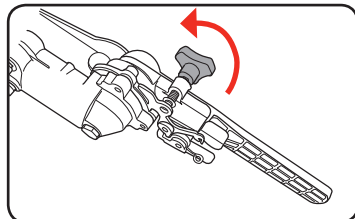

Rotating handle lock

In addition to adjusting the blade angle upwards and downwards, the shaft can also be rotated.

Hold the rear handle with one hand, push forward the rotating handle lock with the other. The shaft can then be rotated to the left and right. There are 45° and 90° preset positions on either side and the rotating handle lock will snap back when these positions are reached.

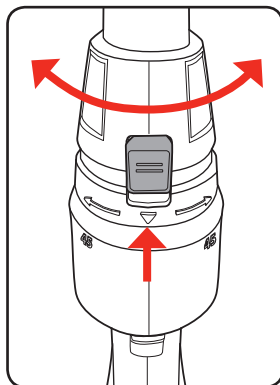

WARNING! IF CORDSET IS CUT OR DAMAGED REMOVE IT IMMEDIATELY FROM THE POWER POINT. THIS PRODUCT REQUIRES THE USE OF TWO HANDS TO ENSURE SAFE OPERATION. INSPECT THE AREA TO BE CUT BEFORE STARTING. REMOVE ANY OBJECTS OR DEBRIS THAT COULD BE THROWN, JAMMED OR BECOME ENTANGLED IN THE BLADES.

Cord retainer

1. Make a loop with the extension cord and push it through the square hole at the back of the rear handle.

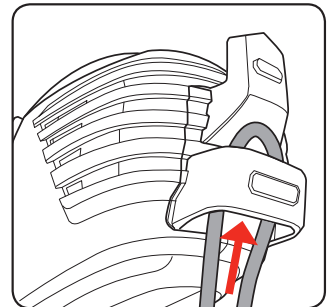

2. Place the end of the loop around the extension cord restraint and ensure it is pulled firmly enough to prevent it coming loose while operating the pole hedge trimmer.

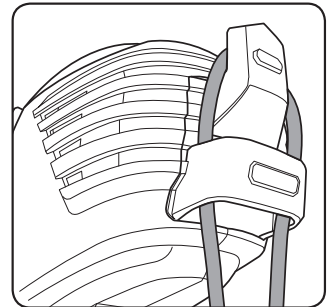

3. Connect the extension cord socket to the pole hedge trimmer cord socket.

Switching on/off

CAUTION! TO REDUCE THE RISK OF ELECTRIC SHOCK, WE RECOMMEND THE USE OF A RESIDUAL CURRENT DEVICE (RATED AT 30MA OR LESS).

WARNING! FAMILIARISE YOURSELF WITH SURROUNDING HAZARDS SUCH AS POWER LINES, PHONE LINES, METAL FENCES AND OTHER OBJECTS THAT COULD BE IN YOUR TRIMMING PATH, FAILURE TO DO SO COULD RESULT IN ELECTRICAL SHOCK, PERSONAL INJURY OR DAMAGE TO YOUR POLE HEDGE TRIMMER.

For your safety, the Pole Hedge Trimmer is designed with a two button safety switch. If only one switch is squeezed, the tool will not operate.

1. Hold the Pole Hedge Trimmer with both hands, and away from your body.

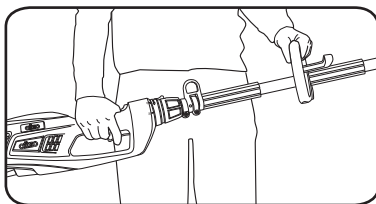

2. Depress the lock-off switch and squeeze the on/off button.

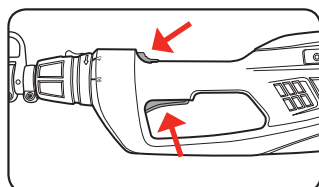

3. To turn the Pole Hedge Trimmer off, simply release the on/off button.

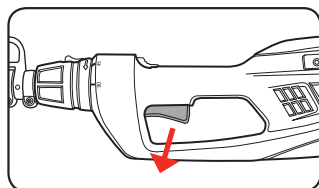

Blade brake

The Pole Hedge Trimmer is fitted with a motor brake which will stop the cutting blade within 1 second of releasing the on/off button.

Note: There may be some sparking (or flashing) in the area of the motor ventilation slots when the pole hedge trimmer is switched off and the blade brake engages. This is normal and will not damage the machine.

5. TRIMMING

Trimming Instructions

WARNING! NEVER USE THE POLE HEDGE TRIMMER WHEN STANDING ON A LADDER OR UNEVEN GROUND.

WARNING! FAMILIARISE YOURSELF WITH SURROUNDING HAZARDS SUCH AS POWER LINES, PHONE LINES, METAL FENCES AND OTHER OBJECTS THAT COULD BE IN YOUR TRIMMING PATH, FAILURE TO DO SO COULD RESULT IN ELECTRICAL SHOCK, PERSONAL INJURY OR DAMAGE TO YOUR POLE HEDGE TRIMMER.

1. **Extension cord.** Always keep the extension cord behind the pole hedge trimmer and away from the trimming operation. Never drape it over a hedge being trimmed. If you cut or damage the cord, unplug it at the mains electrical outlet immediately. It must be repaired by an electrician or a power tool repairer before being used again.

2. **Working position.** Maintain proper footing and balance and do not overreach. Wear safety goggles, non-slip footwear and rubber gloves when trimming. Hold the pole hedge trimmer firmly in both hands before turning the pole hedge trimmer on. Always hold the pole hedge trimmer with one hand on the rear handle and one hand on the adjustable auxiliary handle.

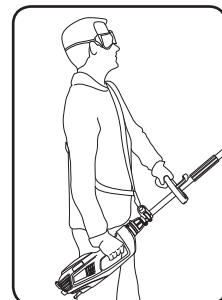

3. **Trimming new growth.** Using a wide sweeping motion, feed the blade teeth through the twigs. A slight downward tilt of the blade, in the direction of motion gives the best cut.

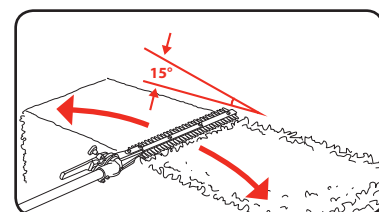

Note: Do not use the pole hedge trimmer for cutting stems greater than 18mm. Use the trimmer only for cutting normal shrubbery found around houses and buildings.

OPERATION cont.

5. TRIMMING cont.

4. **Level hedges.** To obtain exceptionally level hedges a piece of string can be stretched along the length of the hedge as a guide.

5. **Side-trimming hedges.** Hold the pole hedge trimmer and begin at the bottom and sweep up.

6. **Cutting sequence.** First cut both sides, starting at the bottom and work to the top: this prevents cuttings from falling into the area where you are still working.

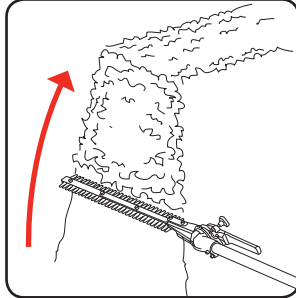

7. **Trimming the top.** Where the branches have grown extremely long, cut back the hedge in several stages.

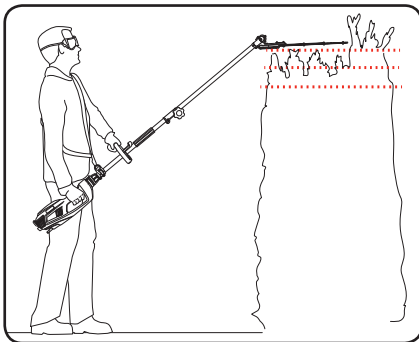

8. **General information.** When older hedges are to be cut back a substantial amount, use pruning shears or some other device to trim thicker branches (greater than 18mm diameter) to the desired length before starting work with the pole hedge trimmer.

Ensure the blades do not come into contact with any object made of hard material that could damage the blades, such as wire fencing or metal plant supports.

CAUTION! IF THE BLADES COME IN CONTACT WITH A HARD OBJECT, VISUALLY INSPECT THE BLADE FOR DAMAGE. IF THE BLADE IS DAMAGED, DO NOT CONTINUE TO OPERATE THE POLE HEDGE TRIMMER.

MAINTENANCE

6. GENERAL MAINTENANCE

WARNING! ENSURE THE POLE HEDGE TRIMMER IS TURNED OFF & DISCONNECTED FROM THE POWER SUPPLY BEFORE PERFORMING ANY OF THE FOLLOWING OPERATIONS.

- When not in use, the Pole Hedge Trimmer should be stored in a dry, frost free location not within the reach of children.
- Keep ventilation slots of the Pole Hedge Trimmer clean at all times and prevent any foreign matter from entering.
- If the enclosure of the Pole Hedge Trimmer requires cleaning do not use solvents but a moist cloth only.
- There are no user serviceable parts in the Pole Hedge Trimmer; if a fault is suspected, please contact Ozito customer service.
- If the supply cord requires replacement, please take your Pole Hedge Trimmer to an authorized power tool repairer/ electrician to repair the damaged cord.
- The blade rail should be cleaned and treated with light machine oil or spray lubricant (such as WD40, CRC 5.56 or RP7) after each use. When a job lasts for a longer period of time it is recommended that the blade rail also be treated with spray lubricant at regular intervals during operation.

Carbon brushes

When the carbon brushes wear out the tool will spark and/or stop. Discontinue use as soon as this happens.

They should be replaced prior to recommencing use of the tool.

Carbon brushes are a wearing component of the tool and therefore not covered under warranty. Continuing to use the tool when carbon brushes

need to be replaced may cause permanent damage to the tool. Carbon brushes will wear out after many uses but when the carbon brushes need to be replaced take the tool to an electrician or a power tool repairer for a quick and low cost replacement. Always replace both carbon brushes at the same time.



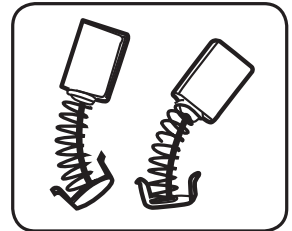













Note: Ozito Industries will not be responsible for any damage or injuries caused by the repair of the tool by an unauthorised person or by mishandling of the tool.



7. TROUBLESHOOTING

Problem	Possible Cause	Solution
Does not start	No supply voltage	Check the mains power, power cord, extension cord, plug and house fuse. Contact Ozito customer service
	Switch ON / OFF are broken	
	Carbon brushes are worn	
	Motor defective	
Pole Hedge Trimmer works intermittently	Damaged electricity power cord	Check power cable. If damaged, contact Ozito customer service. Contact Ozito customer service
	On/off switch may be damaged	
	Upper and lower shafts are not securely fasten	
Blade turning hot	Dull and/or damaged blades	Contact Ozito customer service Check the blades and lubricate or contact Ozito service centre for replacement blades Lubricate the blade with light machine oil or spray lubricant.
	Blades are binding due to lack of lubrication	

DESCRIPTION OF SYMBOLS

V	Volts	Hz	Hertz
~	Alternating current	W	Watts
/min	Revolutions or reciprocation per minute	No	No load speed
	Double insulated		Regulator compliance mark
	Keep hands away from blade		Warning
	Read instructions		Do not expose to rain
	Wear safety shoes for preventing slipping		Beware of falling objects
	Wear gloves for cutting protection		The sound power level indicates by LWA in dB
	Keep bystanders away from the electric hedge trimmer		Electrical appliances can not be thrown into the family dustbin
	Cutting length		Gearbox will become hot to touch after use
	Disconnect and discontinue use should the power cord be damaged		
	Wear personal protective equipment. Always wear safety glasses or a face shield, hearing protection and safety helmet		
	Caution: Keep it at least 10m away from Transmission lines.		

CARING FOR THE ENVIRONMENT



Power tools that are no longer usable should not be disposed of with household waste but in an environmentally friendly way. Please recycle where facilities exist. Check with your local council authority for recycling advice.



Recycling packaging reduces the need for landfill and raw materials. Reuse of recycled material decreases pollution in the environment. Please recycle packaging where facilities exist. Check with your local council authority for recycling advice.

SPARE PARTS

Limited spare parts are available subject to availability. Please contact your local Bunnings Special Orders Desk to order the required spare parts.

Most common spare parts listed below

Spare Part	Part No.
Shaft Locking Knob	SPPHT410-011
Carbon Brush (set)	SPPHT410-045
Lock-off Switch	SPPHT410-051
Shoulder Strap	SPPHT410-123

For further information, or any parts not listed here, visit www.ozito.com.au or contact Ozito Customer Service:
Australia 1800 069 486
New Zealand 0508 069 486
E-mail: enquires@ozito.com.au

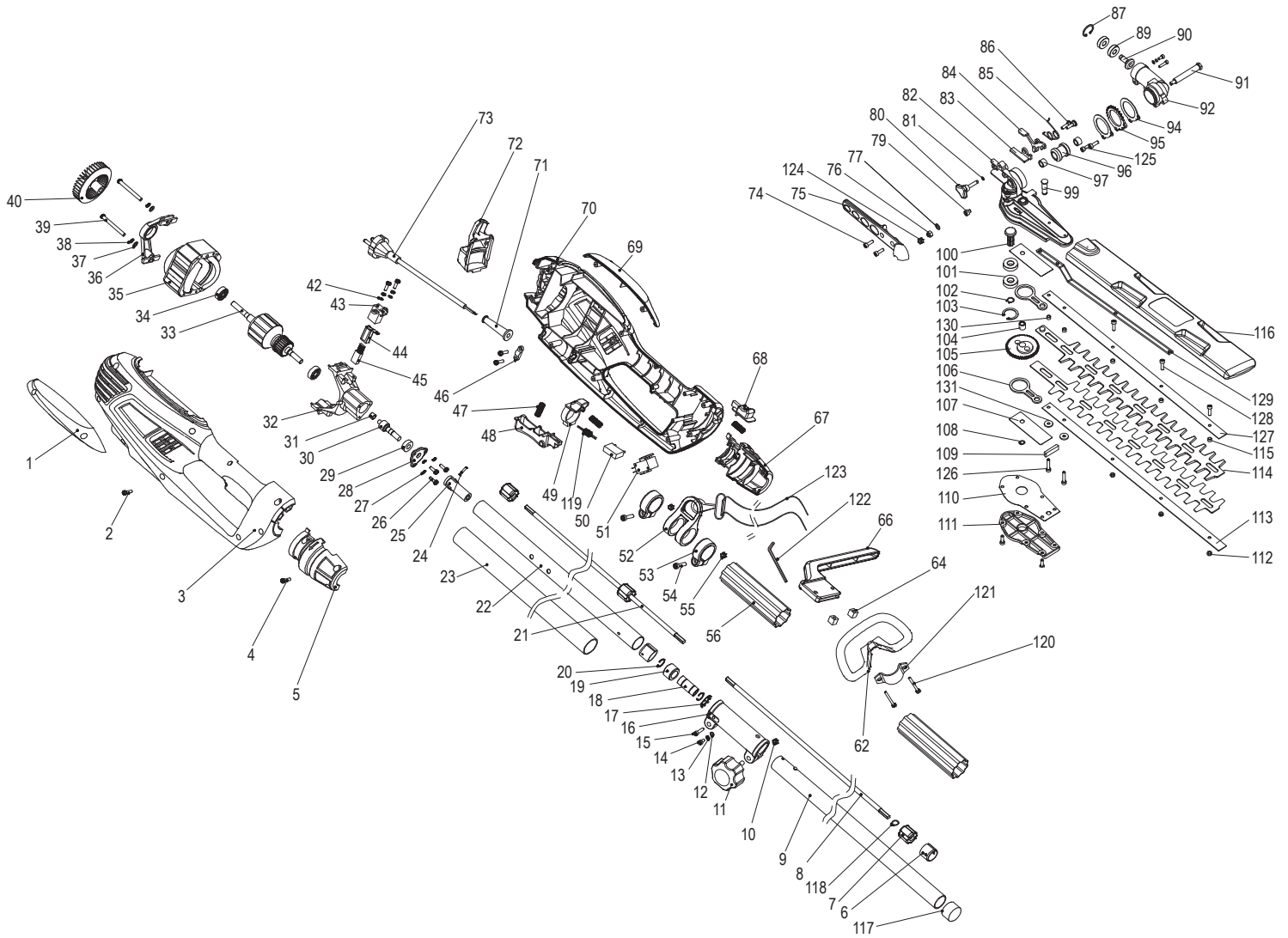

The following is a list of spare parts carried by Ozito.
Please contact Customer Service for any parts not listed.

Item No.	Description	Part No.	Item No.	Description	Part No.
11	Shaft Locking Knob	SPPHT410-011			
45	Carbon Brush (set)	SPPHT410-045			
51	Lock-off Switch	SPPHT410-051			
123	Shoulder Strap	SPPHT410-123			

How To Order

Available spare parts can be ordered through the Special Orders Desk at any Bunnings Warehouse. If you have any further questions, please contact Ozito Customer Service on:

Australia: 1800 069 486

New Zealand: 0508 069 486

enquiries@ozito.com.au

ELECTRICAL SAFETY

 **WARNING!** When using mains-powered tools, basic safety precautions, including the following, should always be followed to reduce risk of fire, electric shock, personal injury and material damage.

Read the whole manual carefully and make sure you know how to switch the tool off in an emergency, before operating the tool.
Save these instructions and other documents supplied with this tool for future reference.

The manufacturer cannot accept any liability for damage or accidents which arise due to a failure to follow these instructions and the safety information.

This product has been designed for 230V and 240V only. Always check that the power supply corresponds to the voltage on the rating plate.

 **Note:** The supply of 230V and 240V is interchangeable for Australia and New Zealand. This tool is double insulated in accordance with AS/NZS 60745-2-15; therefore no earth wire is required.

The power supply for this product should be protected by a residual current device (rated at 30mA or less). A residual current device reduces the risk of electric shock.

If the supply cord is damaged, it must be replaced by an electrician or a power tool repairer in order to avoid a hazard.

Note: Double insulation does not take the place of normal safety precautions when operating this tool. The insulation system is for added protection against injury resulting from a possible electrical insulation failure within the tool.

Using an Extension Lead

Always use an approved extension lead suitable for the power input of this tool. Before use, inspect the extension lead for signs of damage, wear and ageing. Replace the extension lead if damaged or defective. When using an extension lead on a reel, always unwind the lead completely. Use of an extension lead not suitable for the power input of the tool or which is damaged or defective may result in a risk of fire and electric shock.

GENERAL POWER TOOL SAFETY WARNINGS

 **WARNING!** Read all safety warnings and all instructions. Failure to follow the warnings and instructions may result in electric shock, fire and/or serious injury.
Save all warnings and instructions for future reference.

The term "power tool" in the warnings refers to your mains-operated (corded) power tool or battery-operated (cordless) power tool.

1. Work area safety

a. Keep work area clean and well lit. Cluttered or dark areas invite accidents.

b. Do not operate power tools in explosive atmospheres, such as in the presence of flammable liquids, gases or dust. Power tools create sparks which may ignite the dust or fumes.

c. Keep children and bystanders away while operating a power tool. Distractions can cause you to lose control.

2. Electrical safety

a. Power tool plugs must match the outlet. Never modify the plug in any way. Do not use any adapter plugs with earthed (grounded) power tools. Unmodified plugs and matching outlets will reduce risk of electric shock.

b. Avoid body contact with earthed or grounded surfaces, such as pipes, radiators, ranges and refrigerators. There is an increased risk of electric shock if your body is earthed or grounded.

c. Do not expose power tools to rain or wet conditions. Water entering a power tool will increase the risk of electric shock.

d. Do not abuse the cord. Never use the cord for carrying, pulling or unplugging the power tool. Keep cord away from heat, oil, sharp edges or moving parts. Damaged or entangled cords increase the risk of electric shock.

e. When operating a power tool outdoors, use an extension cord suitable for outdoor use. Use of a cord suitable for outdoor use reduces the risk of electric shock.

f. If operating a power tool in a damp location is unavoidable, use a residual current device (RCD) protected supply. Use of an RCD reduces the risk of electric shock.

3. Personal safety

a. Stay alert, watch what you are doing and use common sense when operating a power tool. Do not use a power tool while you are tired or under the influence of drugs, alcohol or medication. A moment of inattention while operating power tools may result in serious personal injury.

b. Use personal protective equipment. Always wear eye protection. Protective equipment such as dust mask, non-skid safety shoes, hard hat, or hearing protection used for appropriate conditions will reduce personal injuries.

c. Prevent unintentional starting. Ensure the switch is in the off-position before connecting to power source and/or battery pack, picking up or carrying the tool.

Carrying power tools with your finger on the switch or energising power tools that have the switch on invites accidents.

d. Remove any adjusting key or wrench before turning the power tool on. A wrench or a key left attached to a rotating part of the power tool may result in personal injury.

e. Do not overreach. Keep proper footing and balance at all times. This enables better control of the power tool in unexpected situations.

f. Dress properly. Do not wear loose clothing or jewellery. Keep your hair, clothing and gloves away from moving parts. Loose clothes, jewellery or long hair can be caught in moving parts.

g. If devices are provided for the connection of dust extraction and collection facilities, ensure these are connected and properly used. Use of dust collection can reduce dust-related hazards.

4. Power tool use and care

a. Do not force the power tool. Use the correct power tool for your application. The correct power tool will do the job better and safer at the rate for which it was designed.

b. Do not use the power tool if the switch does not turn it on and off. Any power tool that cannot be controlled with the switch is dangerous and must be repaired.

c. Disconnect the plug from the power source and/or the battery pack from the power tool before making any adjustments, changing accessories, or storing power tools. Such preventive safety measures reduce the risk of starting the power tool accidentally.

d. Store idle power tools out of the reach of children and do not allow persons unfamiliar with the power tool or these instructions to operate the power tool. Power tools are dangerous in the hands of untrained users.

e. Maintain power tools. Check for misalignment or binding of moving parts, breakage of parts and any other condition that may affect the power tool's operation. If damaged, have the power tool repaired before use. Many accidents are caused by poorly maintained power tools.

f. Keep cutting tools sharp and clean. Properly maintained cutting tools with sharp cutting edges are less likely to bind and are easier to control.

g. Use the power tool, accessories and tool bits etc. in accordance with these instructions, taking into account the working conditions and the work to be performed. Use of the power tool for operations different from those intended could result in a hazardous situation.

5. Service

a. Have your power tool serviced by a qualified repair person using only identical replacement parts. This will ensure that the safety of the power tool is maintained.

b. If the supply cord is damaged, it must be replaced by the manufacturer, its service agent or similarly qualified persons in order to avoid a hazard.

ADDITIONAL SAFETY INSTRUCTIONS FOR HEDGE TRIMMERS

• **Keep all parts of the body away from the cutter blade.** Do not remove cut material or hold material to be cut when blades are moving. Make sure the switch is off when clearing jammed material. A moment of inattention while operating the hedge trimmer may result in serious personal injury.

• **Carry the hedge trimmer by the handle with the cutter blade stopped.** When transporting or storing the hedge trimmer always fit the blade cover. Proper handling of the hedge trimmer will reduce possible personal injury from the cutter blades.

• **Hold the power tool by insulated gripping surfaces only, because the cutter blade may contact hidden wiring or its own cord.** Cutter blades contacting a "live" wire may make exposed metal parts of the power tool "live" and could give the operator an electric shock.

• **Keep cable away from cutting area.** The cable may be hidden in shrubs and can be accidentally cut by the blade during operation.

• **Perform visual inspection on the hedge being trimmed.** Ensure that there are no wire fences or foreign objects that may come into contact with the Pole Hedge Trimmer during operation.

• **If the cord becomes damaged during use, disconnect the cord from the supply immediately. DO NOT TOUCH THE CORD BEFORE DISCONNECTING THE SUPPLY.** Do not use the Pole Hedge trimmer if the cord is damaged or worn.

• **Inspect and maintain the Pole Hedge Trimmer regularly.** Have the Pole Hedge Trimmer repaired by an authorized repairer.

• Keep extension cord away from cutting blades.

• Never allow children or people unfamiliar with these instructions to use the Pole Hedge Trimmer.

• Avoid using the Pole Hedge Trimmer, while people, especially children or pets are nearby.

• Use the Pole Hedge Trimmer only in daylight.

• Never operate the Pole Hedge Trimmer with a damaged cutting blade.

• Switch on the Pole Hedge Trimmer only when hands and feet are away from the cutting blades.

• Use only manufacturer's recommended replacement parts and accessories.

• Always disconnect the Pole Hedge Trimmer from the mains power outlet and put the blade cover on when leaving the Pole Hedge Trimmer unattended.

• Disconnect the Pole Hedge Trimmer from the mains power outlet before carrying out any maintenance or cleaning work.

• When not in use, store the Pole Hedge Trimmer out of the reach of children

• Face the cutting blades away from yourself, other people and animals while the power is connected to the Pole Hedge Trimmer (especially during operation).

• Use both handles and shoulder strap.

• Keep ventilation openings clear of debris. Keep handles dry, clean and free of oil and grease.

• Never reach underneath the Pole Hedge Trimmer cutting blades until it has completely stopped and the power has been disconnected.

This appliance is not intended for use by persons (including children) with reduced physical, sensory or mental capabilities, or lack of experience and knowledge, unless they have been given supervision or instruction concerning use of the appliance by a person responsible for their safety.

Recommendations for the use of a residual current device with a rated residual current of 30mA or less.

Using an Extension Lead

Always use an approved extension lead suitable for the power input of this tool. Before use, inspect the extension lead for signs of damage, wear and ageing. Replace the extension lead if damaged or defective.

When using an extension lead on a reel, always unwind the lead completely. Use of an extension lead not suitable for the power input of the tool or which is damaged or defective may result in a risk of fire and electric shock.

It is recommended that the extension lead is a maximum of 25m in length. Do Not use multiple extension leads.

WARRANTY

IN ORDER TO MAKE A CLAIM UNDER THIS WARRANTY YOU MUST RETURN THE PRODUCT TO YOUR NEAREST BUNNINGS WAREHOUSE WITH YOUR BUNNINGS REGISTER RECEIPT. PRIOR TO RETURNING YOUR PRODUCT FOR WARRANTY PLEASE TELEPHONE OUR CUSTOMER SERVICE HELPLINE:

Australia 1800 069 486

New Zealand 0508 069 486

TO ENSURE A SPEEDY RESPONSE PLEASE HAVE THE MODEL NUMBER AND DATE OF PURCHASE AVAILABLE. A CUSTOMER SERVICE REPRESENTATIVE WILL TAKE YOUR CALL AND ANSWER ANY QUESTIONS YOU MAY HAVE RELATING TO THE WARRANTY POLICY OR PROCEDURE.

The benefits provided under this warranty are in addition to other rights and remedies which are available to you at law.

Our goods come with guarantees that cannot be excluded at law. You are entitled to a replacement or refund for a major failure and for compensation for any other reasonably foreseeable loss or damage. You are also entitled to have the goods repaired or replaced if the goods fail to be of acceptable quality and the failure does not amount to a major failure.

Generally you will be responsible for all costs associated with a claim under this warranty, however, where you have suffered any additional direct loss as a result of a defective product you may be able to claim such expenses by contacting our customer service helpline above.

3 YEAR REPLACEMENT WARRANTY

Your product is guaranteed for a period of **36 months from the original date of purchase**. If a product is defective it will be replaced in accordance with the terms of this warranty. Warranty excludes consumable parts, for example: blade cover, assembly bolts, hex key, adjustable auxiliary handle, handle bracket.

WARNING

The following actions will result in the warranty being void.

- If the tool has been operated on a supply voltage other than that specified on the tool.
- If the tool shows signs of damage or defects caused by or resulting from abuse, accidents or alterations.
- Failure to perform maintenance as set out within the instruction manual.
- If the tool is disassembled or tampered with in any way.
- Professional, industrial or high frequency use.