

MAINTENANCE

The purpose of the maintenance and adjustment schedule is to keep the generator in the best operating condition. Inspect or service as scheduled in the table below.

WARNING! SHUT OFF THE ENGINE BEFORE PERFORMING ANY MAINTENANCE. IF THE ENGINE MUST BE RUN, MAKE SURE THE AREA IS WELL VENTILATED. THE EXHAUST CONTAINS POISONOUS CARBON MONOXIDE GAS.

CAUTION! USE AUTHORIZED PARTS OR THEIR EQUIVALENT. THE USE OF REPLACEMENT PARTS WHICH ARE NOT OF EQUIVALENT QUALITY MAY DAMAGE THE GENERATOR.

Project	Periodic maintenance time (1)	Every use	Every month or 20 hours	Every 3 months or 50 hours	Every 6 months or 100 hours	Every year or 300 hours
Oil	Examination	○	○			
	Replace					
Air filter	Examination	○				
	Clean			○ (2)		
Muffler Anti-Fire	Examination	○				
Spark plug	Clean-adjustment					○
Fuel sediment bowl	Clean				○	
Valve clearance	Examination-adjustment					○ (3)
Fuel and fuel filter	Clean					○ (3)
Fuel line	Examination		Every 2 years (if necessary, please change) (3)			

Note:

- Log hours of operation to determine proper maintenance.
- Service more frequently when used in dusty areas.
- Service of this product can be arranged by contacting customer service. Telephone: 1800 069 486.

WARNING! DO NOT REMOVE THE FRONT PANEL WHILE THE GENERATOR IS RUNNING.

Oil Change

Drain the oil while the engine is still warm to ensure rapid and complete draining.

WARNING! MAKE SURE TO TURN THE ENGINE SWITCH AND FUEL LEVER ARE OFF BEFORE DRAINING.

- Using a spanner remove the oil drain screw.

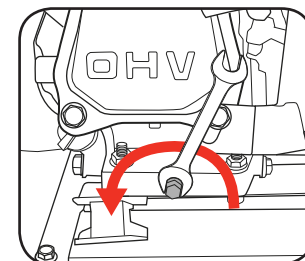

- Tilt the generator and spill out the oil into a suitable container.
- Refit the oil drain screw and refill with new oil, check the oil level with the dipstick as described in "Checking the Oil" section.

Note: Please dispose of used motor oil in a manner that is compatible with the environment. Do not throw it in the rubbish bin or pour it on the ground.

Air Filter Service

A dirty air filter will restrict air flow to the carburettor. To prevent carburettor malfunction, service the air cleaner regularly. Service more frequently when operating the generator in extremely dirty areas.

- Remove the air filter locking knob and remove the cover.
- Check the air filter sponge is intact and clean, if not rinse with water and allow to dry or replace the filter.

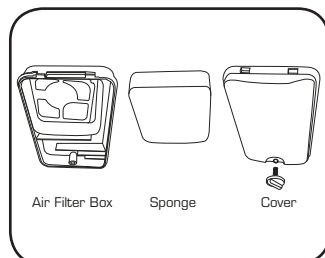
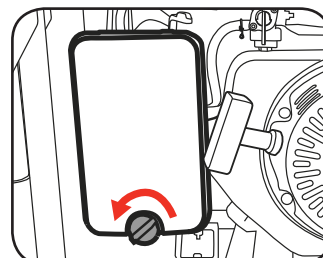

Note: It is normal for a little oil to appear under the air filter box if the generator is running for a long period of time, or if a lot of oil is in the engine. Wipe up the excess oil after each use and after stopping the generator.

WARNING! DO NOT USE PETROL OR LOW FLASH POINT SOLVENTS FOR CLEANING. THEY ARE FLAMMABLE AND EXPLOSIVE UNDER CERTAIN CONDITIONS.

WARNING! NEVER RUN THE ENGINE WITHOUT THE AIR CLEANER. RAPID ENGINE WEAR WILL RESULT FROM CONTAMINANTS SUCH AS DUST AND DIRT BEING DRAWN THROUGH THE CARBURETTOR, INTO THE ENGINE.

Spark Plug Servicing

Use only good quality spark plugs. To ensure proper engine operation, the spark plug must be properly gapped and free of deposits.

- Pull out the spark plug lead.

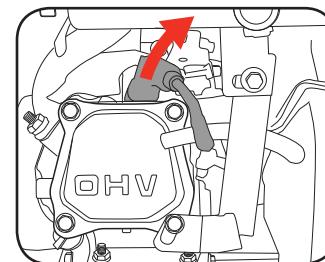

- Remove the spark plug using the spark plug wrench supplied by turning it anti-clockwise.

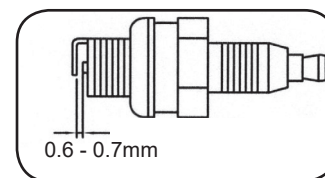

- Clean the electrode with a metal brush and remove any carbon build-up or replace the spark plug. Set the electrode gap to 0.6 - 0.7mm

- Install the spark plug carefully by hand, to avoid cross threading. Tighten it securely with Spark plug wrench.

- Reinstall the spark plug lead.

Fuel Filter

A dirty fuel filter will restrict fuel flow to the carburettor. Replace the fuel filter if it becomes noticeably discoloured. The fuel filter can be found under the fuel cut off tap.

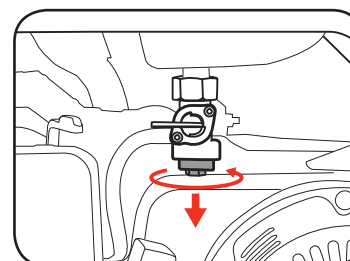

TROUBLESHOOTING

Circuit Breaker Trips During Use

If the circuit breaker trips during use, it usually indicates faulty electrical equipment or cords. Follow the steps below to determine if the issue lies with the circuit breaker or with equipment/cords.

- Disconnect loads, reset and test the circuit breaker as described in the "Checking the Residual Current Circuit Breaker" section of this manual.
- Let the generator run without any loads for 1 minute.
- If the circuit breaker trips in the 1 minute period, do not continue to use the generator. Shut the generator down and contact Ozito Customer Service.
- If the circuit breaker tests correctly, the electrical equipment or extension cords may be faulty. Replace faulty electrical equipment and cords before further use. Have qualified personnel check all electrical equipment and cords for any defects.

TRANSPORTING & STORAGE

When Transporting Generator

- When transporting a short distance, it is advised that you use the handles.
- Do not overfill the fuel tank.
- Avoid a place exposed to direct sunlight when putting the generator on a vehicle. If the generator is left in an enclosed vehicle for many hours, high temperatures inside the vehicle could cause fuel to vaporize, resulting in a possible explosion.
- Do not operate the generator while it is on a vehicle. Take the generator off the vehicle and use it in a well ventilated place.
- Do not drive on a rough road for an extended period with the generator on board. If you must transport the generator on a rough road, drain the fuel from the generator beforehand.

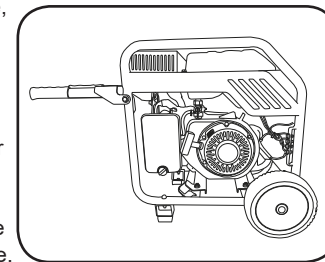

Storing the Generator for an Extended Period

- Be sure the storage area is free of excessive humidity and dust.
- Completely drain the fuel from the tank. Open the fuel valve, start the engine and operate it in the idle position until all remaining fuel is gone and the engine stops automatically.
- Discharge oil as described in ("Oil Change") section.
- Check the fuel tap is turned off.

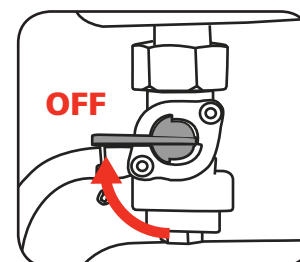

WARNING! PETROL IS EXTREMELY FLAMMABLE AND EXPLOSIVE UNDER CERTAIN CONDITIONS. DO NOT SMOKE OR ALLOW FLAMES OR SPARKS IN THE AREA.

DESCRIPTION OF SYMBOLS

V	Volts	Hz	Hertz
~	Alternating current	W	Watts
min ⁻¹	Revolutions or reciprocation per minute	no	No load speed
	Read instruction manual		Regulator compliance mark
	Warning		Hot surface
	Do not parallel connect other cables to receptacles, use special jack, or it may cause an electrical shock.		
	Extremely hot surface. Do not touch a hot muffler or exhaust system. You may get burned. These parts get extremely hot from operation and remain hot a short time after the unit is turned off.		
	Exhaust contains poisonous carbon monoxide. Do not operate generator in confined area.		
	Unleaded Petrol		Four stroke engine oil
	Ground		Do not smoke
	Keep bystanders away		Toxic Fumes
	Engine may continue to rotate after machine is switched off		

CARING FOR THE ENVIRONMENT

Power tools that are no longer usable should not be disposed of with household waste but in an environmentally friendly way. Please recycle where facilities exist. Check with your local council authority for recycling advice.

Recycling packaging reduces the need for landfill and raw materials. Reuse of recycled material decreases pollution in the environment. Please recycle packaging where facilities exist. Check with your local council authority for recycling advice.

SPARE PARTS

Spare parts can be ordered from the Special Orders Desk at your local Bunnings Warehouse.

For further information, or any parts not listed here, visit www.ozito.com.au or contact Ozito Customer Service:

Australia 1800 069 486

New Zealand 0508 069 486

E-mail: enquiries@ozito.com.au

ozito

INVERTER GENERATOR

2500W

INSTRUCTION MANUAL

SPECIFICATIONS

Engine: 4-stroke OHV 1-cylinder
 Displacement: 196cc
 Max. Power: 2,500W (2min)
 Rated Power: 2,200W
 Power Factor: 1.0
 AC Output: 2 x 240V~50Hz, 9.2A
 DC Output: 1 x 12V, 8.3A
 Fuel Capacity: 5 litres
 Fuel Type: 91 RON unleaded petrol
 Sump Capacity: 0.6 litres
 Oil Type: 4-stroke SAE30, 15W40
 Sound Pressure Level: 68dBA @ 7m
 Weight: 26kg

ozito.com.au

1 YEAR WARRANTY

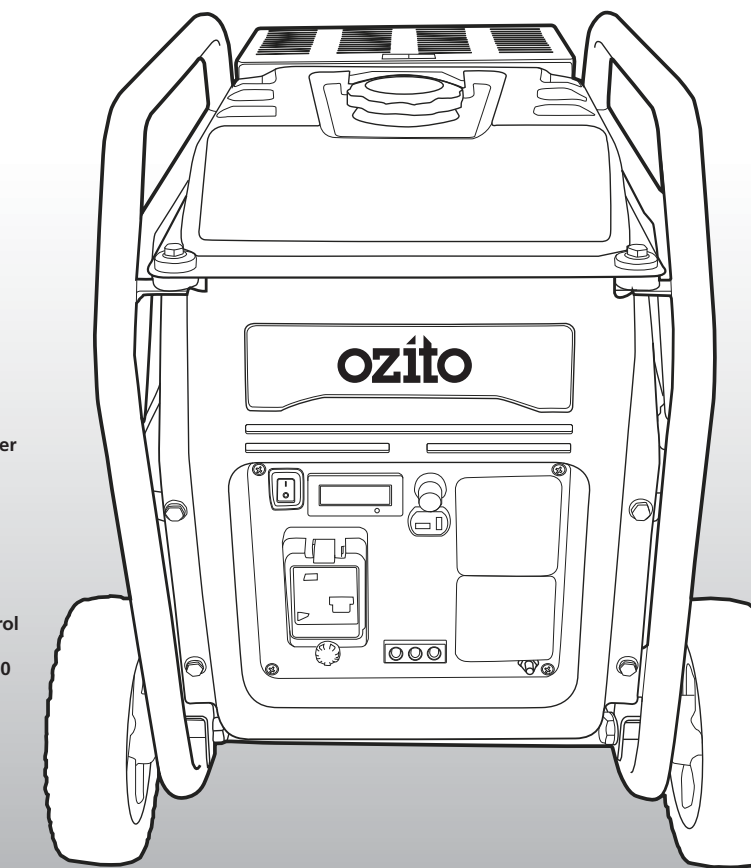

WHAT'S IN THE BOX

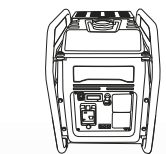

Inverter Generator



Wheels & Wheel Fasteners



Transport Handles



Support Feet



Generator Oil



Tools & Accessories

IGP-2500

WARRANTY

IN ORDER TO MAKE A CLAIM UNDER THIS WARRANTY YOU MUST RETURN THE PRODUCT TO YOUR NEAREST BUNNINGS WAREHOUSE WITH YOUR BUNNINGS REGISTER RECEIPT. PRIOR TO RETURNING YOUR PRODUCT FOR WARRANTY PLEASE TELEPHONE OUR CUSTOMER SERVICE HELPLINE:

Australia 1800 069 486

New Zealand 0508 069 486

TO ENSURE A SPEEDY RESPONSE PLEASE HAVE THE MODEL NUMBER AND DATE OF PURCHASE AVAILABLE. A CUSTOMER SERVICE REPRESENTATIVE WILL TAKE YOUR CALL AND ANSWER ANY QUESTIONS YOU MAY HAVE RELATING TO THE WARRANTY POLICY OR PROCEDURE.

The benefits provided under this warranty are in addition to other rights and remedies which are available to you at law. Our goods come with guarantees that cannot be excluded at law. You are entitled to a replacement or refund for a major failure and for compensation for any other reasonably foreseeable loss or damage. You are also entitled to have the goods repaired or replaced if the goods fail to be of acceptable quality and the failure does not amount to a major failure.

Generally you will be responsible for all costs associated with a claim under this warranty, however, where you have suffered any additional direct loss as a result of a defective product you may be able to claim such expenses by contacting our customer service helpline above.

1 YEAR WARRANTY

Your product is guaranteed for a period of 12 months from the original date of purchase. If a product is defective it will be replaced in accordance with the terms of this warranty. Warranty excludes consumable parts, for example: Wheels.

WARNING

The following actions will result in the warranty being void.

- If the tool has been operated on a supply voltage other than that specified on the tool.
- If the tool shows signs of damage or defects caused by or resulting from abuse, accidents or alterations.
- Failure to perform maintenance as set out within the instruction manual.
- If the tool is disassembled or tampered with in any way.
- Professional, industrial or high frequency use.

