

LR515

Solitaire

Oliveri®

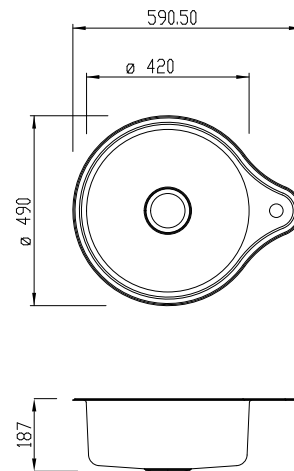

INCLUDED ACCESSORIES



RECOMMENDED TAPWARE

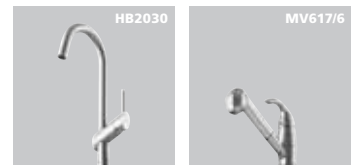

OPTIONAL ACCESSORIES



SPECIFICATIONS

Description

Round bowl inset or undermount sink with tap landing

Sink Size

490W x 490H

Round Bowl

420W x 180D / 24L

Construction	Single piece
Material	304 grade, 18/10 polished stainless steel (0.8mm thick)
Installation	Inset recommended.
Fixings	Adjustable clips and sealing foam supplied
Cut Out Template	oliverisinks.com
Min Cabinet Size	500mm
Tap holes	Available 1 tap hole only
Waste fittings	1 x 90mm basket waste included
Overflow	Not available
Carton Size	574 x 574 x 230mm
Weight	4.0kg
Warranty	Lifetime manufacturer's warranty (refer to oliverisinks.com)

For more information call **1300 13 7465** or visit **www.oliverisinks.com**

