



# Yale Secure App Quick Start Guide



## Download the App Step 1



### Yale Secure App

Install the free Yale Secure app, available from the App Store<sup>SM</sup>. This app is compatible with iPhone®, iPad® and iPod touch® running iOS 10.3 and later. Create your account after successfully downloading the app.



## Turn on Bluetooth Step 2

Ensure that your iPhone, iPad or iPod touch has Bluetooth® turned on. This can be done with your device settings.

## Install the Yale iM1 Network Module Step 3

After your Yale lock has been successfully installed and your master pin code has been created (follow the installation instructions packaged with your lock), continue with the steps below:

- Remove the lock's battery cover and batteries.
- Insert the Yale iM1 Network Module into the slot above the battery compartment. The module has visible pins that should be located at the bottom right corner when inserted into the lock.
- Reinstall the batteries and battery cover.

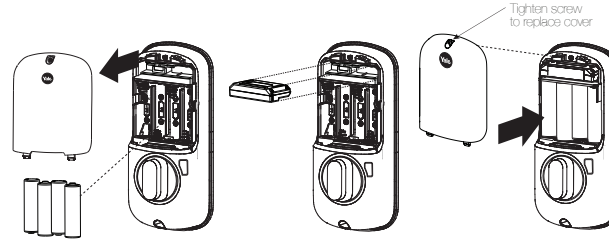

## Enroll the Yale iM1 Network Module Step 4

• Wake the keypad by touching it with three fingers.  
• Enter your master pin code followed by the gear key.  
• Tap 7, followed by the gear key.  
• Tap 1, followed by the gear key.  
Your module has now been successfully enrolled.

## Create Your Home Step 5

If you already have a home created, please skip this step. While holding your phone close to your Yale lock, open the Yale Secure app. Agree to allow access to your home data. Tap the + icon in the top right corner to add your new home. Enter your home name and tap 'Add Home'.

## Add Your Yale Lock to Your Home Step 6

Tap the + icon next to your home name. Your app will search for your Yale lock. Tap your Yale lock when it appears. You'll then be asked to scan your Accessory Setup Code located on the back of your iM1 Installation and Programming Instructions. You can also choose to manually enter your code. In case you misplace this guide, your code is also printed on the module itself. Once the lock has been added, you'll be prompted to rename your lock.

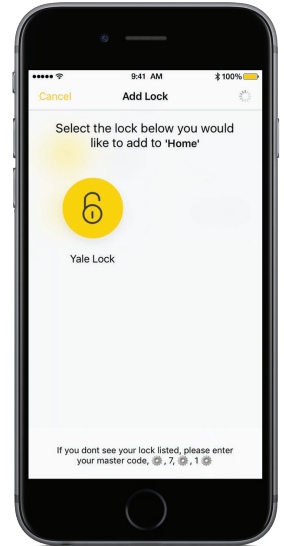

## Customise Your Lock Step 7

Within the lock settings you can customise several features including Auto Relock, Language, One-Touch Locking, Operation Mode and more. You can also edit your lock name at any time. The name of your lock will be what is used when locking or unlocking with Siri®. For example, for a lock named "Front Door" you could say, "Siri, unlock my front door."

## Did You Know?

After completing this set-up, you can manage your Yale lock with iM1 Network Module using the Apple Home app or Siri voice commands!

