

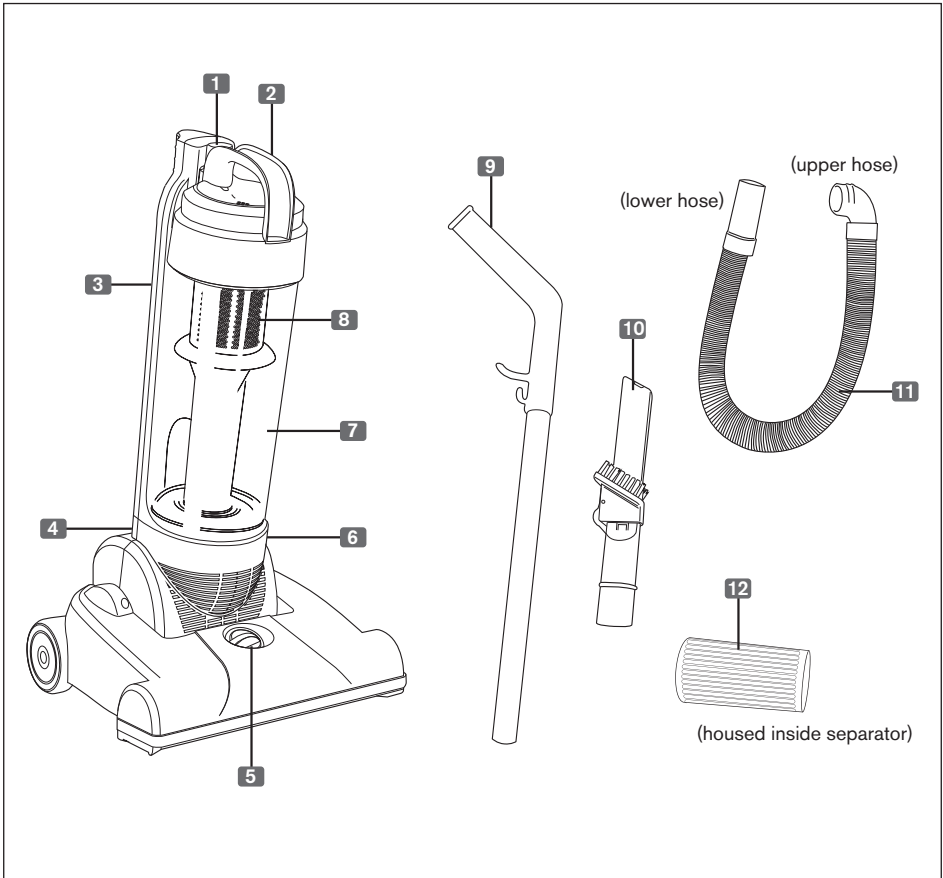

Dirt Devil Service Line: AU: 1300 361 505
NZ: 0800 800 900

MACHINE OVERVIEW



FEATURES

1. Dirt container release button
2. Upper hose connector (hidden)
3. Cord wrap (hidden)
4. Lower hose connector (not shown)
5. Brushbar height adjust
6. On/off button (hidden)
7. Dirt container
8. Separator
9. Handle
10. 2-in-1 crevice tool and dusting brush
11. Hose
12. HEPA Media filter (housed inside separator)

SAFETY INSTRUCTIONS

THIS PRODUCT IS INTENDED FOR HOUSEHOLD USE ONLY. IF USED COMMERCIALY WARRANTY IS VOID.

When using the vacuum cleaner basic safety precautions should always be observed, including the following:

1. Only use the vacuum cleaner indoors on dry surfaces.
2. Turn off the on/off switch on the vacuum cleaner controls before disconnecting or connecting from the mains supply.
3. Always unplug the vacuum cleaner before connecting or disconnecting the vacuum hose and accessories.
4. Children should be supervised to ensure that they do not play with the appliance.
5. This appliance is not intended for use by children and persons with reduced physical, sensory or mental capabilities or lack of experience and knowledge, unless they have been given supervision or instruction concerning use of the appliance in a safe way and understands the hazards involved.
6. Cleaning and maintenance shall not be made by children.
7. The appliance should only be used as described in the quick start guide or in the full user guide.
8. Only Dirt Devil recommended attachments should be used with this appliance.
9. Do not use this vacuum cleaner if it has been dropped, damaged, left outdoors or dropped into water. Do not use this vacuum cleaner with a damaged cord or plug.
10. Do not pull or carry this appliance by the cord. Do not use the cord as a handle, close a door on the cord or pull the cord around sharp edges or corners. Do not run the vacuum cleaner over the cord. Keep the cord away from heated surfaces.
11. Do not handle the plug or the vacuum cleaner with wet hands.
12. Keep hair, loose clothing, fingers and all parts of the body away from openings and moving parts.
13. Do not pick up any hot coals, ash, cigarette butts, matches or any hot, smoking or burning objects.
14. Do not pick up any flammable or combustible materials (lighter fluid, petrol, kerosene etc.) or use in the presence of explosive liquids or vapours.
15. Do not vacuum harmful or toxic material (chlorine, bleach, ammonia, drain cleaner etc.).
16. Do not vacuum hard or sharp objects such as glass, nails, screws, coins etc.
17. Do not vacuum plaster dust, concrete dust or any other building or vitreous materials.
18. Do not vacuum baking soda or any other powder-based carpet refresher or deodoriser.
19. Use only SAA approved 10amp extension cords. Non-approved cords may overheat. Care should be taken to arrange the cord so that the cord cannot be tripped over.

20. Store the vacuum cleaner in a cool, dry area.
21. Do not put any objects into openings. Do not use with any openings blocked and do not restrict airflow. Keep all openings free of dust, lint, hair or anything that might reduce airflow.
22. Do not use the vacuum cleaner with blocked filters and without all of the filters in place.
23. Take extra care when positioning the vacuum cleaner on the stairs.
24. Please ensure that the brushbar is turned off when you are vacuuming on the stairs.
25. Keep vacuuming area well lit.



WARNING: Always switch off and unplug the vacuum cleaner from the electrical socket before assembling, opening or emptying the dirt container, or before connecting/disconnecting the attachments.



CAUTION: The vacuum cleaner is a very powerful unit. Before plugging the cord into the electrical socket, make sure the switch is in the 'off' position.



IMPORTANT: If the inlet, hose or telescopic tube is blocked, switch off the vacuum cleaner and remove the blockage(s) before re-starting the vacuum cleaner.



IMPORTANT: Dirt Devil recommends the use of Residual Current Device Rating of 30mA or less.



IMPORTANT: It is very important that filters are kept clean to obtain maximum performance from your vacuum cleaner. Not cleaning and not replacing your filters regularly can reduce the suction power and cause overheating and permanent damage to the vacuum cleaner.



NOTE: If the supply cord is damaged it must be replaced by the manufacturer, or a similarly qualified person in order to avoid hazard, or invalidating the warranty.



IMPORTANT: The motor is equipped with a thermal cut-out. If for any reason the unit should overheat (eg. from blocked nozzles, a full dust container or unclean filters), the thermostat will automatically turn off the switch. Should this occur, unplug the vacuum cleaner from the electrical socket and turn off the switch. Remove dirt container and empty. Clean filters. Allow the unit to cool for approximately one (1) hour. To re-start, plug into an electrical socket and switch back on.

DAMAGE TO THE VACUUM CLEANER CAUSED AS A DIRECT RESULT OF NOT ADHERING TO THE GENERAL SAFETY INFORMATION AND THE INSTRUCTIONS IN THIS USER GUIDE INVALIDATES THE WARRANTY

PLEASE KEEP THESE INSTRUCTIONS FOR FUTURE REFERENCE

OPERATION

Assembling your upright

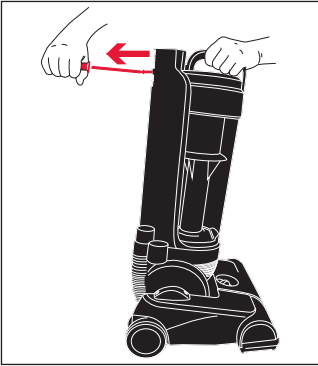

Using a crosshead screwdriver, remove the screw from the back of the unit as shown.

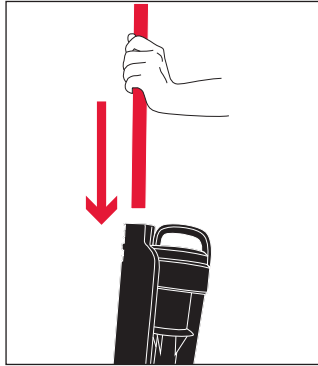

Slide the handle down onto the main body of the unit.

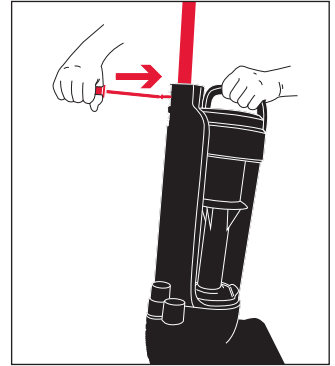

Return the screw and tighten, securing the handle into the main body of the unit.

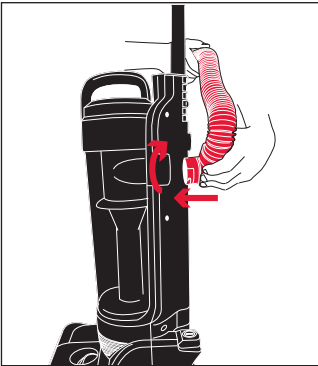

Connect the upper hose to the upper hose connector, rotate hose clockwise to secure.

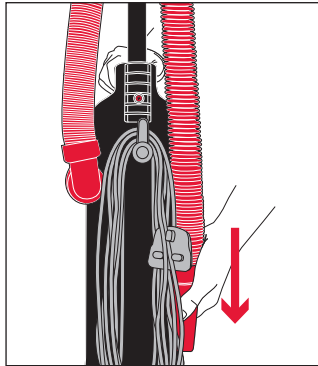

Insert the lower hose to the lower hose connector.

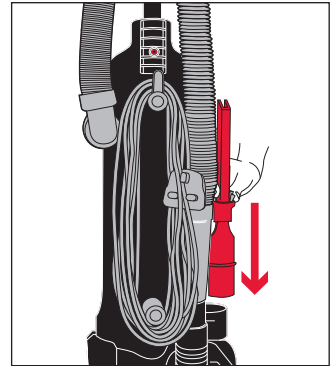

Place the 2-in-1 tool into the holder.

OPERATION

Operating the appliance

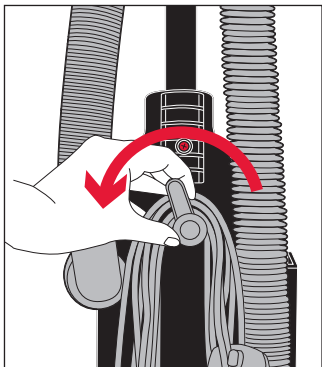

Twist the upper cord wrap to fully unwrap the cord then plug the unit into the electrical socket and turn on.

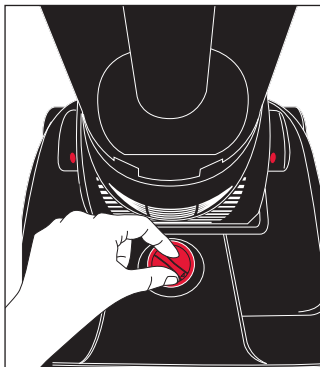

Select a floor height setting by adjusting the brush bar height.
High – for long pile carpet.
Low – for short pile carpet.
Hard floors – for timber, lino, tiles and other hard floor surfaces.



IMPORTANT:

Dirt Devil recommends that you raise the height of the brush bar to the hard floor position when using this cleaner on lino and hard floors due to constant rotation. Dirt Devil cannot be held responsible for damage to these surfaces if the consumer fails to take notice of this recommendation.

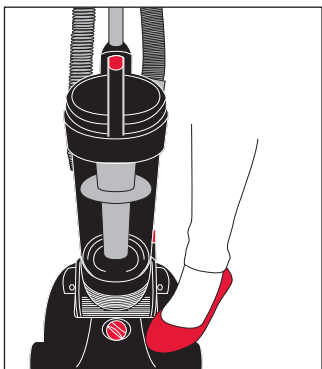

Place foot on the vacuum to recline the vacuum body as desired.

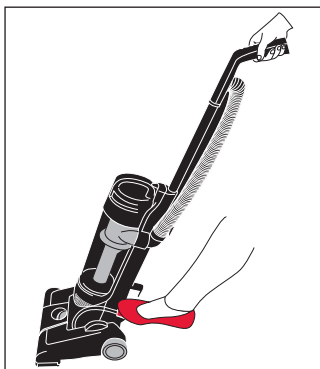

Place foot on the on/off button to switch the vacuum cleaner on.

OPERATION

Using the accessories

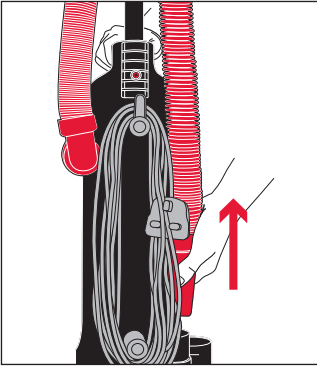

Pull out the lower hose from the lower hose connector.

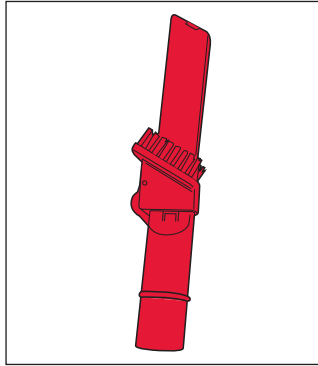

Choose an accessory, then attach to the end of the hose – 2 in 1 dusting brush and crevice tool.

! **IMPORTANT:** When the vacuum cleaner is stood in the upright position, or when using the hose and tools, the brush bar height adjust must be set to the highest position.

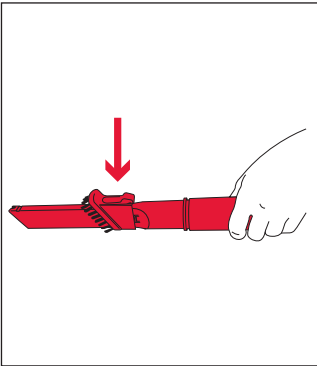

To use crevice tool attach to hose.

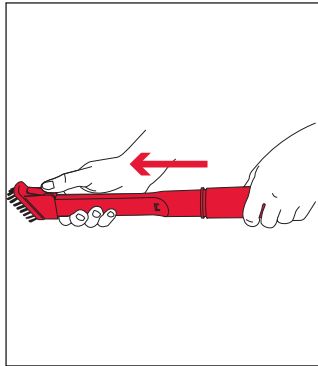

To use the dusting brush, push the tab and slide up the dusting brush until it clicks into place.

Emptying and cleaning the dirt container

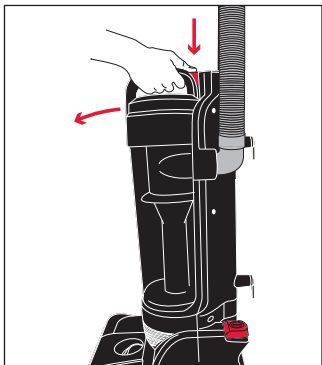

Press dirt container release button to remove the dirt container.

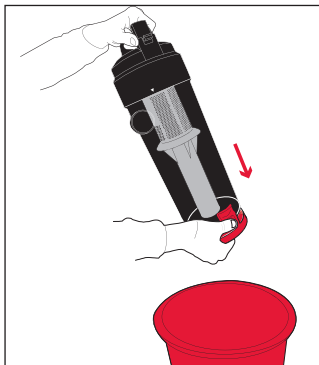

Hold dirt container over a bin and press the dirt container latch to open, allowing dirt to fall out.

 **IMPORTANT:** Always switch off the appliance and unplug the mains socket before carrying out any maintenance.

Cleaning the separator

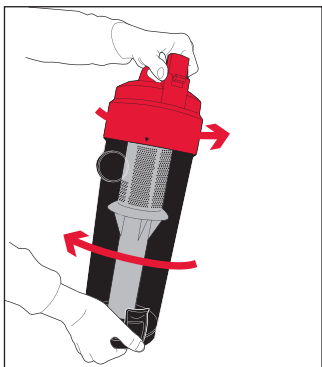

Turn the lid of the dirt container anticlockwise to remove.

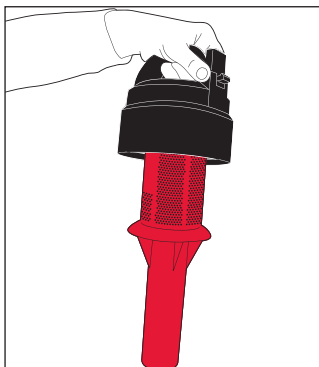

Wipe the separator with a cloth to remove any dirt.

MAINTENANCE

Cleaning the HEPA media filter

! **IMPORTANT:** It is very important to keep the filters clean to maintain maximum performance of the vacuum. Dirt Devil recommends that your filters should be cleaned after each use in addition to being washed and replaced on a regular basis (at least every 3 months depending on the level of use). Do not use detergent to clean the filters.

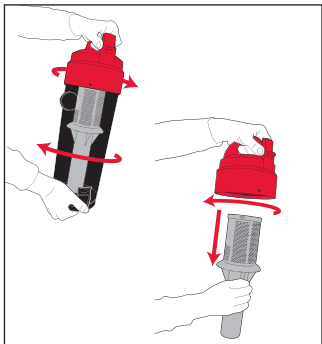

Turn the lid of the dirt container anticlockwise to remove the lid. Then turn the separator clockwise to remove filter from the dirt container lid.

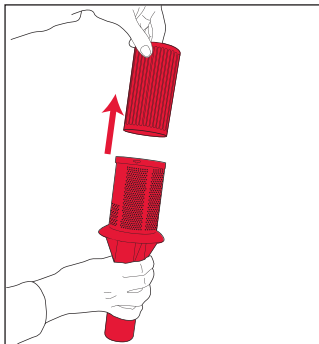

Remove the HEPA media filter from the separator.

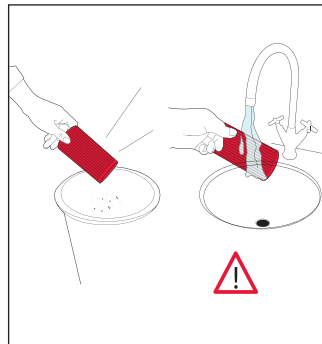

To clean, tap the HEPA media filter against a bin to remove excess dirt.

! **IMPORTANT:** When washing the HEPA media filter, water temperature should not exceed 40°C. Allow to dry completely before reinserting filter in machine.

Clearing blockages

Hose blockages

The flexible hose may be disconnected from the vacuum cleaner. Carefully remove any blockages found and reconnect the hose securely.

Accessory blockages

Remove accessory from the hose. Carefully remove the blockage and return to the cleaner.

Replacing the belt

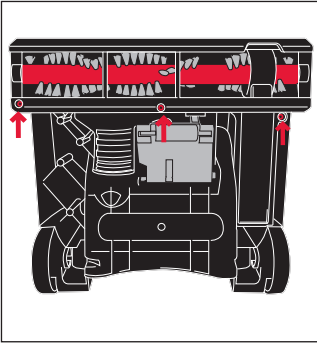

Turn unit over and remove the three screws using a crosshead screwdriver as indicated by arrows.

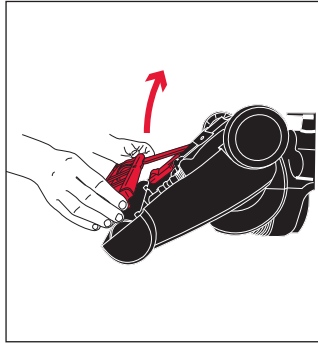

Remove the brushbar cover from the base of the unit.

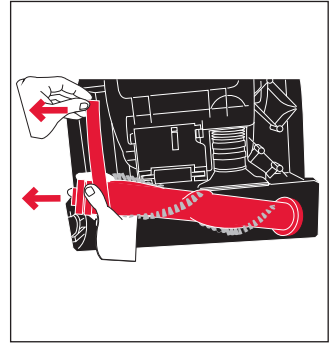

Lift the brush bar out of the base of the unit. Next, remove the belt from the brushbar and from the motor spindle towards the rear of the floor head. Replace the belt.

FAQ



WARNING: To reduce the risk of personal injury, unplug the vacuum cleaner before performing maintenance/troubleshooting checks.

Problem	Solution
Why won't the vacuum cleaner turn on?	It may not be plugged into the electrical socket correctly; ensure that the plug is pushed in securely.
	The electrical socket may not be working properly; check the fuse or breaker, or consult an electrician.
	The motor thermostat may have tripped; switch off and unplug the vacuum cleaner, and leave for one hour before switching the cleaner back on.
Why won't the vacuum cleaner pick up?	The dirt container may be incorrectly installed; remove the dirt container from the unit by pressing the dirt container release button and then re-attaching it to the unit, ensuring it is locked firmly back into place.
	The filter may be clogged; refer to 'Maintenance: Cleaning the filters' on pages 8.
	The dirt container may be blocked; refer to 'Maintenance: Emptying and cleaning the dirt container' on page 7.
	There may be a blockage in the hose/tube; disconnect from the vacuum cleaner. Carefully remove any blockages found and reconnect securely.
Why is dust escaping from the vacuum?	The filter may be clogged; refer to 'Maintenance: Cleaning the filters' on pages 8.
	The dirt container may be blocked; refer to 'Maintenance: Emptying and cleaning the dirt container' on page 7.
	The dirt container may be incorrectly fitted; remove the dirt container from the unit by pressing the dirt container release button and then re-attaching it to the unit, ensuring it is locked firmly back into place.
Why won't the accessories pick up properly?	Hose blockages: remove the hose from the unit. Carefully remove any blockages found and reconnect hose securely.
	Accessory blockages: remove accessory from handle/tube. Carefully remove blockage and reattach to the vacuum cleaner.
	The accessory may be faulty. Simply call us on AU: 1300 361 505 / NZ: 0800 800 900

WE'RE HERE TO HELP

Instead of taking me back to the shop, simply call

AU: 1300 361 505

NZ: 0800 800 900

dirtdevil.com.au

This does not affect your statutory rights



OTHER INFORMATION

Dirt Devil Service & Help

Dirt Devil Service Line:

Australia 1300 361 505

New Zealand 0800 800 900

Monday-Friday 8.30am to 5.00pm

If you have queries or concerns about using your Dirt Devil, call the Dirt Devil Service Line. Calls are charged at the standard local rate. Please make a note of the serial number and model number of the vacuum cleaner before calling.

For the nearest Service Agent, please call the Dirt Devil Service Line or visit dirtdevil.com.au

Technical Specification

Voltage	220-240V ~50Hz
Wattage	1600W
Capacity	2.4L
Filters	HEPA Media Filter (washable)
Weight	4.7kg
Cord length	7.5m

Subject to technical change without notice.



Double Insulated



Indoor Use



Read Instructions



Waste electrical products should not be disposed of with household waste. Please recycle where facilities exist. Check with your Local Authority or retailer for recycling advice.

NOTES



Distributed by Techtronic Industries Australia Pty. Ltd.

Level 1, 660 Doncaster Road,

Doncaster, Australia 3108.

www.dirtdevil.com.au

Service Line:

AU: 1300 361 505 / NZ: 0800 800 900

LET'S GO.