

ozito

TILE CUTTING SAW

500W 115mm

INSTRUCTION MANUAL

SPECIFICATIONS

Motor: 500W

Input: 230 – 240V~50Hz

No Load Speed: 5,200min⁻¹

Blade: Ø115 x Ø22.2mm

Max. Depth Of Cut: 24mm

Table Size: 330 x 360mm

Weight: 5.9 kg

ozito.com.au

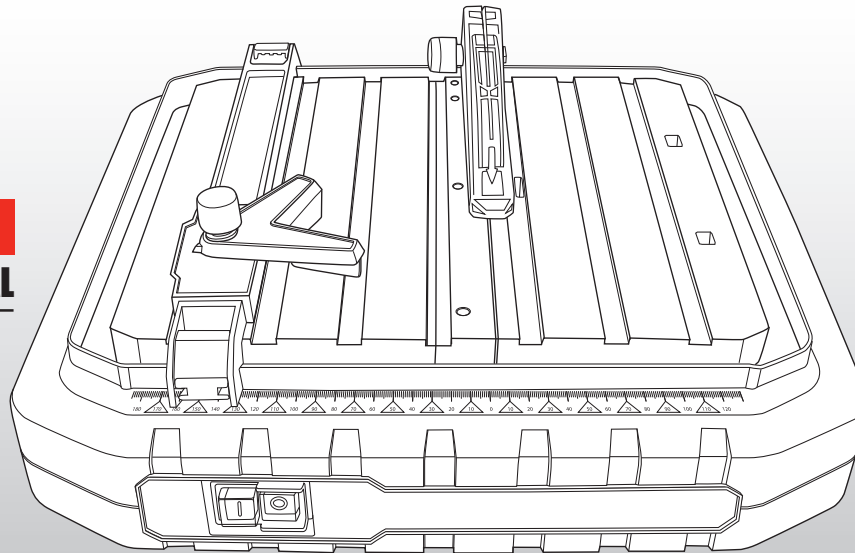

WHAT'S IN THE BOX

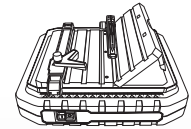

Tile Cutting Saw



Diamond Blade



Parallel Fence & Mitre Guide



Blade Guard



Spanners x 2, Rubber Feet x 4

3 YEAR REPLACEMENT WARRANTY

TCS-115

KNOW YOUR PRODUCT

TILE CUTTING SAW

- | | |
|---------------------------------|--------------------------|
| 1. Mitre guide locking knob | 8. Diamond blade |
| 2. Parallel fence | 9. Blade guard |
| 3. Mitre guide | 10. Blade guard bracket |
| 4. 45° Fence | 11. Blade cover |
| 5. Parallel fence locking clips | 12. Carry handle |
| 6. On/Off switch | 13. Water reservoir plug |
| 7. Guide ruler | |

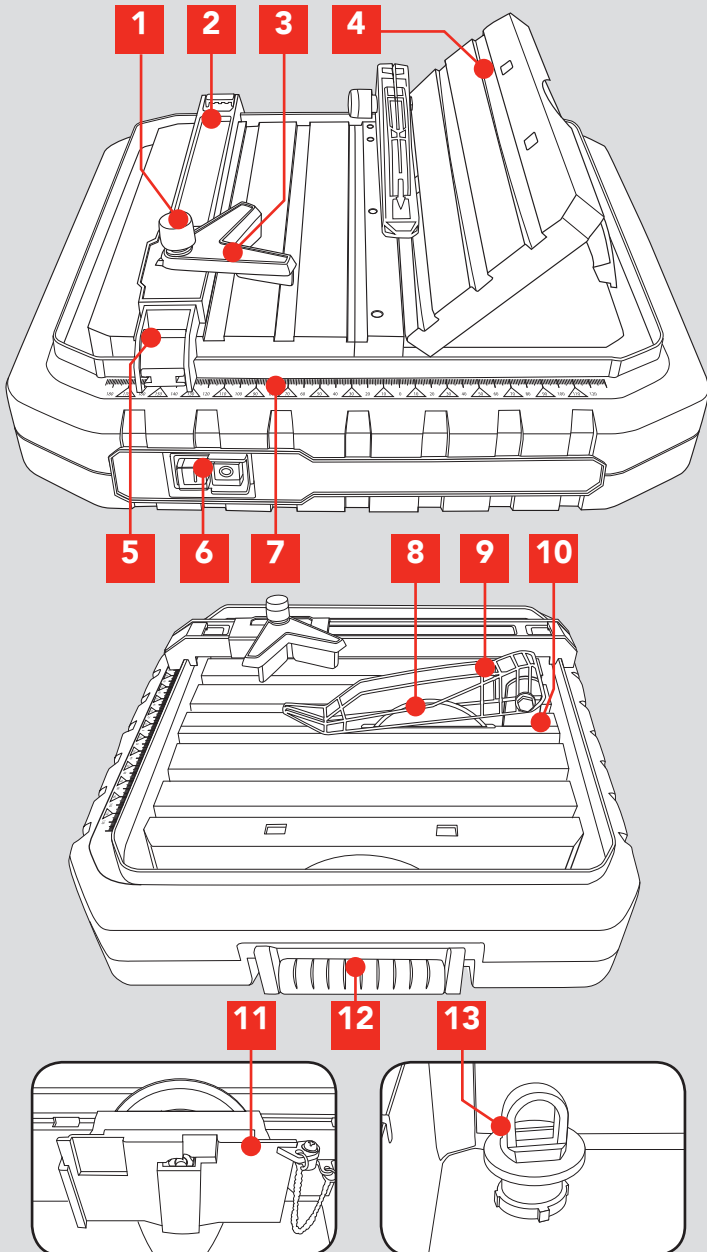

ONLINE MANUAL

Scan this QR Code with your mobile device to take you to the online manual.



SETUP & PREPARATION

1. ASSEMBLY

Prior to using the Tile cutting saw, the rubber feet, diamond blade, blade guard and parallel fence will need to be installed.

WARNING! ENSURE THE TOOL IS DISCONNECTED FROM THE POWER SUPPLY BEFORE ASSEMBLY .

Fitting the rubber feet

1. Insert the 4 rubber feet into the holes on the base of the tile saw.

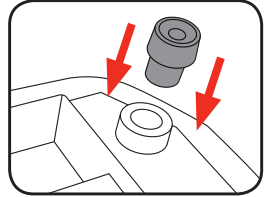

Fitting the diamond blade

1. Remove the 45° fence.
2. Remove the screw and washer from the blade guard.
3. Lift the blade cover out of its notch.
4. Remove the blade nut and outer flange from the spindle.
5. Place the diamond blade on the spindle, so that it aligns centrally on the inner flange. Then place the outer flange on the spindle.
6. Replace the blade nut. The unit is supplied with 2 spanners, stop the spindle from rotating with one spanner while tightening the blade nut with the other.

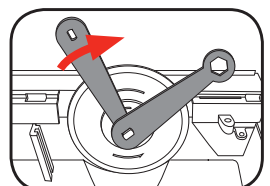
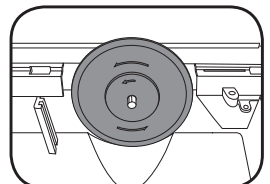
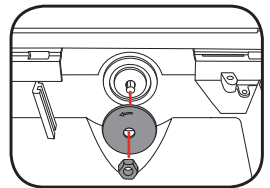
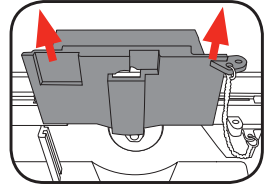
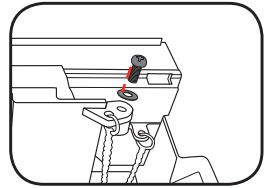
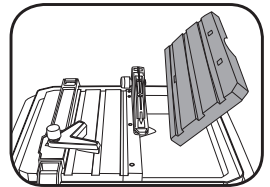

Note: Ensure that the blades direction of rotation corresponds to the arrow marked on the housing.

3

YEAR REPLACEMENT WARRANTY

Fitting the blade guard

1. Remove the screw and washer from the blade guard bracket.

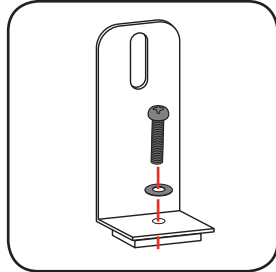

2. Position the blade guard bracket within the water reservoir. The 'L' of the bracket should point towards the centre of the table.

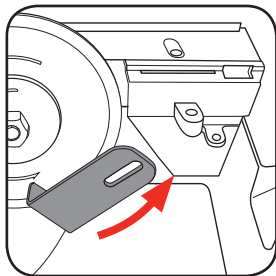

3. Slide the blade guard bracket up into the slot behind the diamond blade, at the rear of the table.

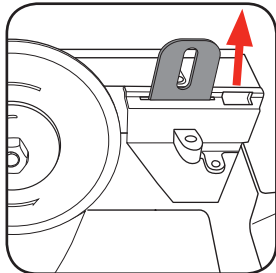

4. While holding the blade guard bracket upwards and in position, fasten it to the table top with the screw and washer.

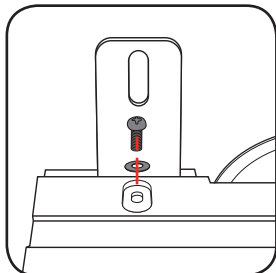

Note: Ensure the blade guard bracket aligned to the centre of the diamond blade.

5. Slide the blade cover back into its original position.

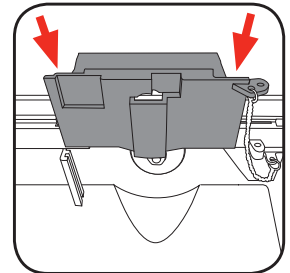

6. Fasten the blade cover in place with the washer and screw.

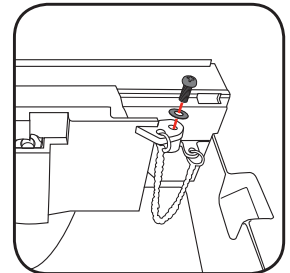

7. Refit the 45° fence.

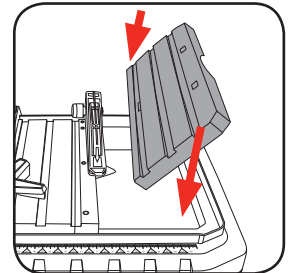

8. Remove the knob, bolt and washer from the blade guard.

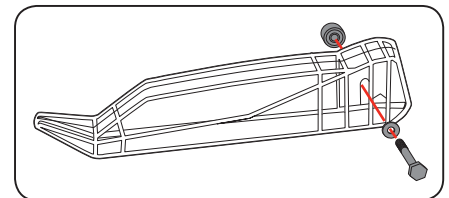

9. Place the blade guard onto the blade guard bracket. Secure it in place with bolt, washer and knob. Tighten knob sufficiently as to allow the blade guard to rest on the table but lift when the workpiece is pushed into the diamond blade.

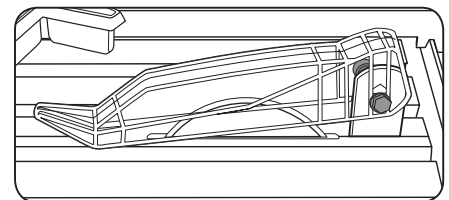

2. SET UP AND ADJUSTMENTS



WARNING! ENSURE THE TOOL IS DISCONNECTED FROM THE POWER SUPPLY BEFORE PERFORMING ANY OF THE FOLLOWING OPERATIONS.

Saw position

As a safety precaution due to the product using water.

To avoid the possibility of the appliance plug or power point getting wet, the user should arrange a "drip loop" in the cord connecting the saw to a wall mounted power point.

The "drip loop" is the part of the cord that sits below the level of the power point (or the connector if an extension cord is used). It prevents water travelling along the cord and coming in contact with the power point.

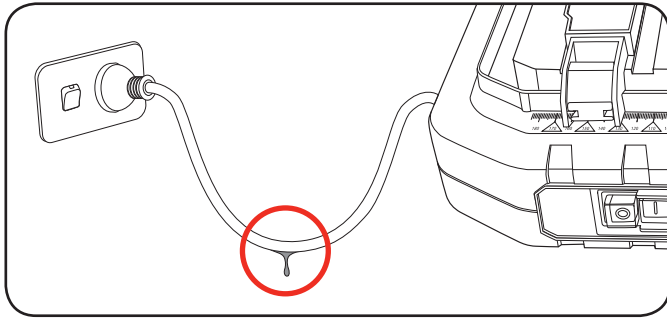

Setting up the parallel fence

1. Release the parallel fence locking clips and place the parallel fence onto the working table. Ensure that it is parallel to the blade. Use the guide ruler to assist in achieving the desired width of cut.

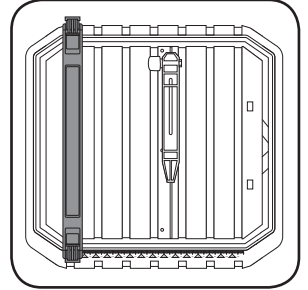

2. Secure the parallel fence in place with the Parallel fence locking clips.

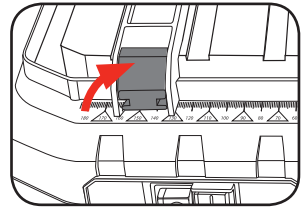

Setting up the mitre guide

1. After the parallel fence has been secured in place, the mitre guide can be clipped onto it. The mitre guide can be easily moved forwards and backwards on the parallel fence.

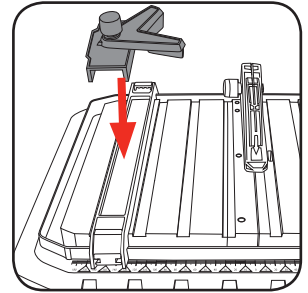

2. Loosen the mitre guide locking knob and adjust the mitre scale to the desired cutting angle, as displayed on the mitre gauge. Re secure the mitre guide locking knob.

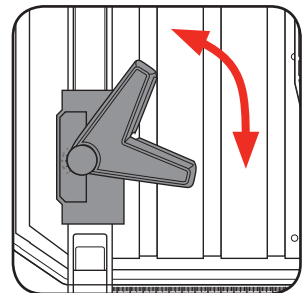

Setting up the 45° fence

1. Raise the 45° fence, lever out the support and locate the tabs into the corresponding holes in the deck. Ensure the fence is correctly secure before making a cut.

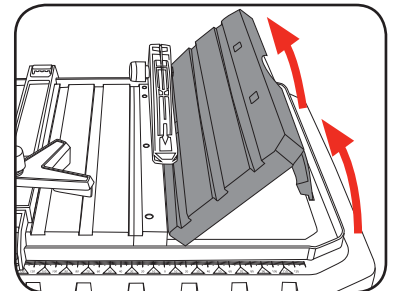

OPERATION

Water tank

1. Remove the 45° fence and fill the water tank with clean water just enough to cover the diamond blades bottom edge. No more than 1/4 of the diamond blade should be submerged in water.

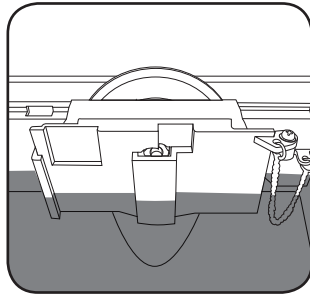

2. When you have finished cutting, remove the plug inside the tank to drain the water.

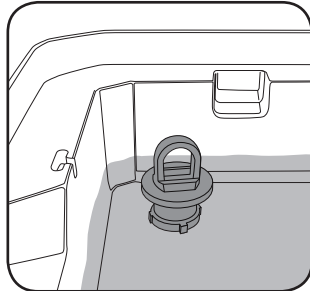

Note: The plug is also an over flow safety device, if the unit is over filled, water will spill out.



WARNING!: DO NOT ADD CHEMICALS OR DETERGENTS TO THE WATER.

3. OPERATING THE TILE CUTTING SAW

On/off switch

1. Switch the tile cutting saw ON by pushing the green (I) button.
2. Switch the tile cutting saw OFF by pushing the red (O) button.

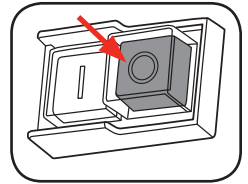
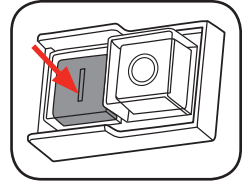

Note: It is recommended to use in conjunction with this appliance a Residual Current Device (RCD) of rating not exceeding 30mA.

Note: In the event of a power failure, accidentally unplugged or turned off at the mains power supply, you will need to push the green (I) button again to restart the tile cutting saw.

CAUTION! ALWAYS ALLOW THE BLADE TO REACH FULL SPEED BEFORE PERFORMING ANY CUTTING OPERATIONS.



WARNING!: THE DIAMOND BLADE WILL CONTINUE TO ROTATE FOR A FEW SECONDS AFTER THE TILE SAW HAS BEEN SWITCHED OFF. WAIT FOR THE BLADE TO STOP BEFORE REMOVING

Straight Cut

Adjust the parallel fence to the desired width. Securely hold the workpiece and evenly guide it with gentle pressure into the diamond blade. Hold the edges of the workpiece and press down firmly to prevent the workpiece lifting during the cut.

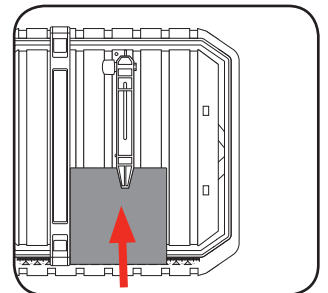

Bevel Cut

Raise the 45° fence if you wish to cut an angle or bevel on the workpiece edge. Make the cut using the same technique as making a straight cut. Internal or external bevel cuts can be made by turning the workpiece face up or down.

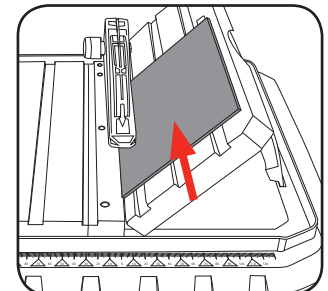

Mitre Cut

With the mitre guide clipped onto the parallel fence, adjust the mitre angle to the desired angle. Securely hold the mitre guide and workpiece and evenly guide the workpiece into the diamond blade. Make sure that the workpiece sits firmly in the guide before making the cut.

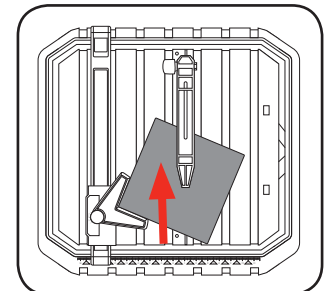

MAINTENANCE

4. CHANGING THE BLADE

CAUTION! NEVER USE A BLADE THAT IS TOO THICK TO ALLOW THE OUTER BLADE WASHER TO ENGAGE WITH THE FLATS ON THE SPINDLE. IT WILL PREVENT THE BLADE SCREW FROM PROPERLY SECURING THE BLADE ONTO THE SPINDLE.

CAUTION! NEVER TRY TO USE A BLADE THAT IS LARGER THAN THE STATED CAPACITY OF THE TILE SAW. IT MIGHT COME INTO CONTACT WITH THE BLADE GUARD AND RISK PERSONAL INJURY OR DAMAGE TO THE TILE SAW. THIS WILL NOT BE COVERED UNDER WARRANTY.

1. Ensure the plug is disconnected from the mains power supply.
2. Remove the 45° fence.

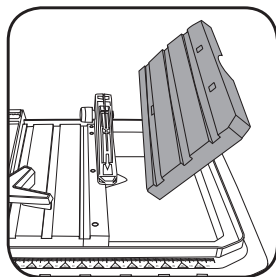

3. Remove the screw and washer from the blade cover.

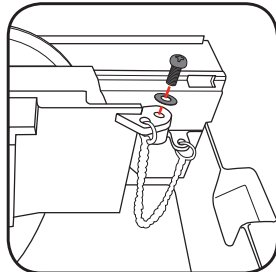

4. Lift the blade cover out of its notch.

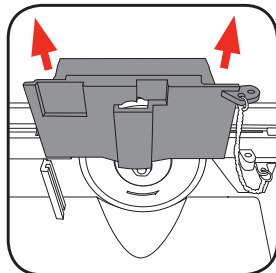

5. Remove the blade nut, outer flange and old blade from the spindle.

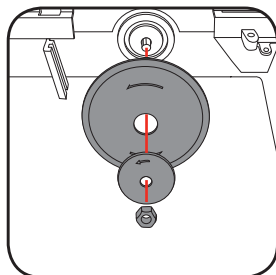

6. Place the new diamond blade on the spindle, so that it sits centrally aligned on the inner flange. Place the outer flange on the spindle.

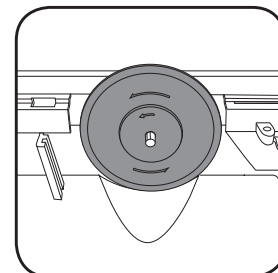

Note: Ensure that the blades direction of rotation corresponds to the arrow marked on the housing.

7. Replace the blade nut. The unit is supplied with 2 spanners, stop the spindle from rotating with one spanner while tightening the blade nut with the other.

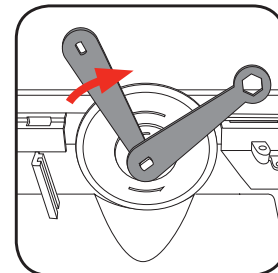

8. Replace the blade cover back into its notch, then tighten the screw and washer.

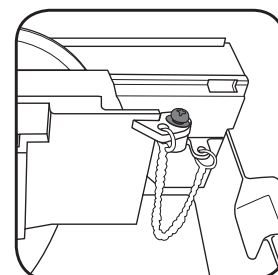

9. Refit the 45° fence.

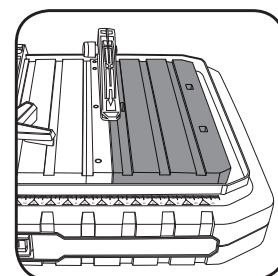









5. GENERAL MAINTENANCE

IMPORTANT! BEFORE CLEANING YOUR TILE CUTTING SAW OR CARRYING OUT ANY MAINTENANCE PROCEDURE, MAKE SURE THAT THE MOTOR IS OFF AND THE TOOL DISCONNECTED FROM THE POWER SUPPLY TO PREVENT ACCIDENTAL STARTING.

- Keep the ventilation slots of the tile cutting saw clean at all times and prevent any foreign matter from entering.
- If the housing of the tile cutting saw requires cleaning do not use solvents but a moist soft cloth only.
- Blow dust from the tile cutting saw through the ventilation slots with compressed air periodically to ensure a dust free tool.

Note: Ozito Industries will not be responsible for any damage or injuries caused by the repair of the tile saw by an unauthorised person or by mishandling of the tool.

DESCRIPTION OF SYMBOLS

V	Volts	Hz	Hertz
~	Alternating current	W	Watts
min⁻¹	Revolutions or reciprocation per minute	n_o	No load speed
	Warning		Regulator compliance mark
	Read instruction manual		Wear eye protection
	Caution, risk of cutting		Wear hearing protection
	Use only non fragmented blades		Wear safety gloves

CARING FOR THE ENVIRONMENT

 Power tools that are no longer usable should not be disposed of with household waste but in an environmentally friendly way. Please recycle where facilities exist. Check with your local council authority for recycling advice.

 Recycling packaging reduces the need for landfill and raw materials. Reuse of recycled material decreases pollution in the environment. Please recycle packaging where facilities exist. Check with your local council authority for recycling advice.

SPARE PARTS

Switch	SPTCS115-05
Safety Guard	SPTCS115-35
Diamond Blade	SPTCS115-43
Drain Plug	SPTCS115-48

Spare parts can be ordered from the Special Orders Desk at your local Bunnings Warehouse.

For further information, or any parts not listed here, visit www.ozito.com.au or contact Ozito Customer Service:

Australia 1800 069 486

New Zealand 0508 069 486

E-mail: enquires@ozito.com.au

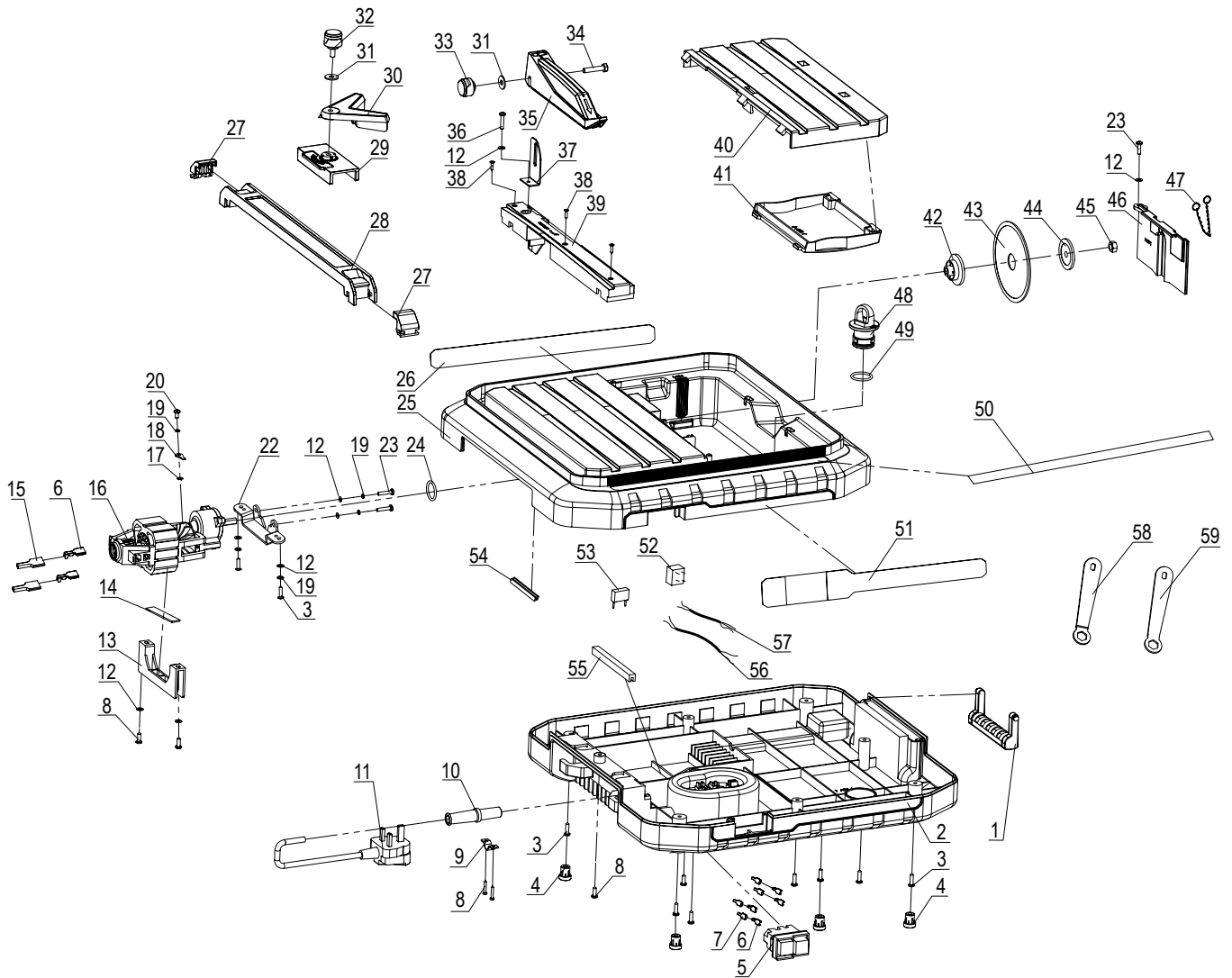

The following is a list of spare parts carried by Ozito. Please contact Customer Service for any parts not listed.

Item No.	Description	Part No.	Item No.	Description	Part No.
5	Switch	SPTCS115-05			
35	Safety Guard	SPTCS115-35			
43	Diamond Blade	SPTCS115-43			
48	Drain Plug	SPTCS115-48			

How To Order

Available spare parts can be ordered through the Special Orders Desk at any Bunnings Warehouse. If you have any further questions, please contact Ozito Customer Service on:

Australia: 1800 069 486

New Zealand: 0508 069 486

enquiries@ozito.com.au

ELECTRICAL SAFETY



WARNING! When using mains-powered tools, basic safety precautions, including the following, should always be followed to reduce risk of fire, electric shock, personal injury and material damage.

Read the whole manual carefully and make sure you know how to switch the tool off in an emergency, before operating the tool.

Save these instructions and other documents supplied with this tool for future reference.

The electric motor has been designed for 230V and 240V only. Always check that the power supply corresponds to the voltage on the rating plate.

The tool is earthed in accordance with AS/NZS 60335-1

Note: The supply of 230V and 240V on Ozito tools are interchangeable for Australia and New Zealand.

If the supply cord is damaged, it must be replaced by an electrician or a power tool repairer in order to avoid a hazard.

Using an Extension Lead

Always use an approved extension lead suitable for the power input of this tool. Before use, inspect the extension lead for signs of damage, wear and ageing. Replace the extension lead if damaged or defective.

When using an extension lead on a reel, always unwind the lead completely. Use of an extension lead not suitable for the power input of the tool or which is damaged or defective may result in a risk of fire and electric shock.

GENERAL POWER TOOL SAFETY WARNINGS



WARNING! Read all safety warnings and all instructions. Failure to follow the warnings and instructions may result in electric shock, fire and/or serious injury.

Save all warnings and instructions for future reference. The term "power tool" in the warnings refers to your mains-operated (corded) power tool or battery-operated (cordless) power tool.

1. Work area safety

- Keep work area clean and well lit.** Cluttered or dark areas invite accidents.
- Do not operate power tools in explosive atmospheres, such as in the presence of flammable liquids, gases or dust.** Power tools create sparks which may ignite the dust or fumes.
- Keep children and bystanders away while operating a power tool.** Distractions can cause you to lose control.

2. Electrical safety

- Power tool plugs must match the outlet. Never modify the plug in any way. Do not use any adapter plugs with earthed (grounded) power tools.** Unmodified plugs and matching outlets will reduce risk of electric shock.
- Avoid body contact with earthed or grounded surfaces, such as pipes, radiators, ranges and refrigerators.** There is an increased risk of electric shock if your body is earthed or grounded.
- Do not expose power tools to rain or wet conditions.** Water entering a power tool will increase the risk of electric shock.
- Do not abuse the cord. Never use the cord for carrying, pulling or unplugging the power tool. Keep cord away from heat, oil, sharp edges or moving parts.** Damaged or entangled cords increase the risk of electric shock.
- When operating a power tool outdoors, use an extension cord suitable for outdoor use.** Use of a cord suitable for outdoor use reduces the risk of electric shock.
- If operating a power tool in a damp location is unavoidable, use a residual current device (RCD) protected supply.** Use of an RCD reduces the risk of electric shock.

3. Personal safety

- Stay alert, watch what you are doing and use common sense when operating a power tool. Do not use a power tool while you are tired or under the influence of drugs, alcohol or medication.**
A moment of inattention while operating power tools may result in serious personal injury.
- Use personal protective equipment. Always wear eye protection.** Protective equipment such as dust mask, non-skid safety shoes, hard hat, or hearing protection used for appropriate conditions will reduce personal injuries.
- Prevent unintentional starting. Ensure the switch is in the off-position before connecting to power source and/or battery pack, picking up or carrying the tool.** Carrying power

tools with your finger on the switch or energising power tools that have the switch on invites accidents.

- Remove any adjusting key or wrench before turning the power tool on.**
A wrench or a key left attached to a rotating part of the power tool may result in personal injury.
 - Do not overreach. Keep proper footing and balance at all times.** This enables better control of the power tool in unexpected situations.
 - Dress properly. Do not wear loose clothing or jewellery. Keep your hair, clothing and gloves away from moving parts.** Loose clothes, jewellery or long hair can be caught in moving parts.
 - If devices are provided for the connection of dust extraction and collection facilities, ensure these are connected and properly used.** Use of dust collection can reduce dust-related hazards.
- ## 4. Power tool use and care
- Do not force the power tool. Use the correct power tool for your application.** The correct power tool will do the job better and safer at the rate for which it was designed.
 - Do not use the power tool if the switch does not turn it on and off.** Any power tool that cannot be controlled with the switch is dangerous and must be repaired.
 - Disconnect the plug from the power source and/or the battery pack from the power tool before making any adjustments, changing accessories, or storing power tools.** Such preventive safety measures reduce the risk of starting the power tool accidentally.
 - Store idle power tools out of the reach of children and do not allow persons unfamiliar with the power tool or these instructions to operate the power tool.** Power tools are dangerous in the hands of untrained users.
 - Maintain power tools. Check for misalignment or binding of moving parts, breakage of parts and any other condition that may affect the power tool's operation. If damaged, have the power tool repaired before use.** Many accidents are caused by poorly maintained power tools.
 - Keep cutting tools sharp and clean.** Properly maintained cutting tools with sharp cutting edges are less likely to bind and are easier to control.
 - Use the power tool, accessories and tool bits etc. in accordance with these instructions, taking into account the working conditions and the work to be performed.** Use of the power tool for operations different from those intended could result in a hazardous situation.
- ## 5. Service
- Have your power tool serviced by a qualified repair person using only identical replacement parts.** This will ensure that the safety of the power tool is maintained.
 - If the supply cord is damaged, it must be replaced by the manufacturer, its service agent or similarly qualified persons in order to avoid a hazard.**

TILE CUTTING SAW SAFETY WARNINGS

Note. The machine must be supplied through a residual current device (RCD) having a rated residual operating current not exceeding 30 mA for extra protection against electric shock.

- This appliance is not intended for use by persons (including children) with reduced physical, sensory or mental capabilities, or lack of experience and knowledge, unless they have been given supervision or instruction concerning use of the appliance by a person responsible for their safety**
- Young children should be supervised to ensure that they don't play with the appliance**
- Make sure that the cutting blade is correctly screened by the guard.
- Never remove the safety guard bracket. The distance between the cutting blade and the safety guard bracket should not exceed 5mm.
- Do not use cutting blade which is bent, deformed or otherwise damaged.
- Do not use cutting blades which do not comply with the specifications stated in this manual.
- Never start cutting tiles before the machine reaches full speed.
- Never attempt to cut extremely small workpieces.
- Do not leave the work area until the machine has been switched off and the cutting disc has come to a complete standstill.
- Never attempt to stop the cutting blade by exerting pressure on the side of the blade.
- Always unplug the machine before performing any maintenance.
- Do not use the machine before it has been completely assembled and installed according to the instructions.
- Do not perform any design, assembly or construction activities on the table while the machine is switched on.
- Unplug the machine and clean the table before leaving the work area.
- Take care that the selection of the diamond discs is suitable for the material to be cut.

- Faults in the machine, including guards or diamond discs, should be reported as soon as they are discovered. Never use the machine without the guard in position.
- Maximum size of working piece should be 1m².
- This tile cutter should be used with limitations on ambient conditions (between 15°C and 30°C).
- Sharp edges and splinters of ceramic tiles can easily cause cuts. Wear work gloves for handling and while cutting tiles.
- Keep hands away from cutting area and blade.
- Keep your body positioned to either side of the blade, but not in line with the blade. Kickback could cause the tool to jump backwards.
- Do not reach underneath the workpiece. The guard cannot protect you from the blade below the workpiece.
- Do not attempt to remove cut material when the blade is rotating. Note that the blade will continue to coast for a while after the motor is switched off.
- Never wet cut with blades designed for dry cutting. There is danger of blade fracture and serious personal injury.
- Diamond blades do not cut material, rather they grind material to perform a cutting action. Do not feed the blade into the tile/masonry faster than the blade can grind.
- Never grind a tile using the side of the blade, or try to make radius or curve cuts. This will damage the blade and could cause blade fracture.
- Wear suitable personal protective equipment when necessary, this could include hearing protection to reduce the risk of induced hearing loss, respiratory protection to reduce the risk of inhalation of harmful dust, wear gloves when handling diamond discs and rough material.

Wear ear muffs

Wear goggles

Wear a breathing mask

Wear gloves

WARRANTY

IN ORDER TO MAKE A CLAIM UNDER THIS WARRANTY YOU MUST RETURN THE PRODUCT TO YOUR NEAREST BUNNINGS WAREHOUSE WITH YOUR BUNNINGS REGISTER RECEIPT. PRIOR TO RETURNING YOUR PRODUCT FOR WARRANTY PLEASE TELEPHONE OUR CUSTOMER SERVICE HELPLINE:

Australia 1800 069 486

New Zealand 0508 069 486

TO ENSURE A SPEEDY RESPONSE PLEASE HAVE THE MODEL NUMBER AND DATE OF PURCHASE AVAILABLE. A CUSTOMER SERVICE REPRESENTATIVE WILL TAKE YOUR CALL AND ANSWER ANY QUESTIONS YOU MAY HAVE RELATING TO THE WARRANTY POLICY OR PROCEDURE.

The benefits provided under this warranty are in addition to other rights and remedies which are available to you at law.

Our goods come with guarantees that cannot be excluded at law. You are entitled to a replacement or refund for a major failure and for compensation for any other reasonably foreseeable loss or damage. You are also entitled to have the goods repaired or replaced if the goods fail to be of acceptable quality and the failure does not amount to a major failure.

Generally you will be responsible for all costs associated with a claim under this warranty, however, where you have suffered any additional direct loss as a result of a defective product you may be able to claim such expenses by contacting our customer service helpline above.

3 YEAR REPLACEMENT WARRANTY

Your product is guaranteed for a period of **36 months from the original date of purchase**. If a product is defective it will be replaced in accordance with the terms of this warranty. Warranty excludes consumable parts, for example: diamond blade and spanners.

WARNING

The following actions will result in the warranty being void.

- ï If the tool has been operated on a supply voltage other than that specified on the tool.
- ï If the tool shows signs of damage or defects caused by or resulting from abuse, accidents or alterations.
- ï Failure to perform maintenance as set out within the instruction manual.
- ï If the tool is disassembled or tampered with in any way.
- ï Professional, industrial or high frequency use.