

# AEG

**FL182**

Original instructions

## Important!

This appliance is not intended for use by persons (including children) with reduced physical, sensory or mental capabilities, or lack of experience and knowledge, unless they have been given supervision or instruction concerning use of the appliance by a person responsible for their safety. Children should be supervised to ensure that they do not play with the appliance.

It is essential that you read the instructions in this manual before assembling, maintaining and operating the product.

Subject to technical modifications.

1. Rotating head
2. On / Off switch
3. Handle, insulated grasping surface
4. On / Off button
5. Belt clip bracket
6. Belt clip
7. Screw



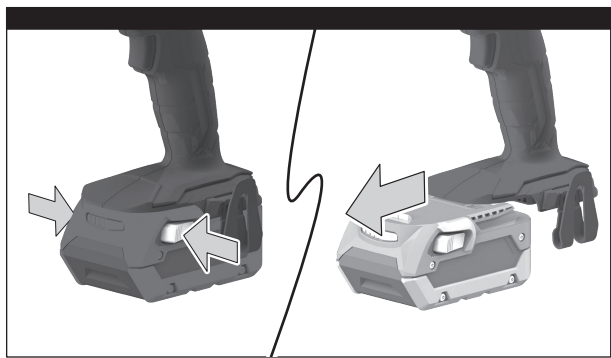
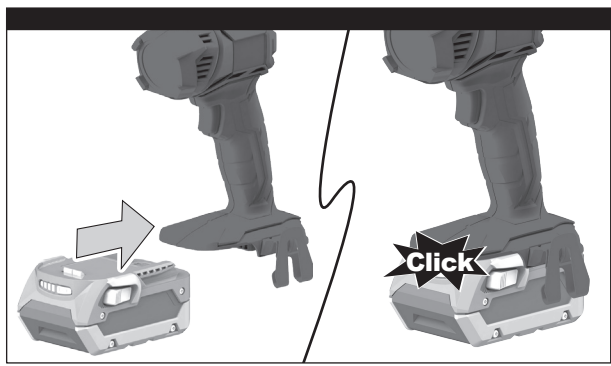
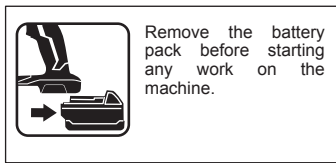
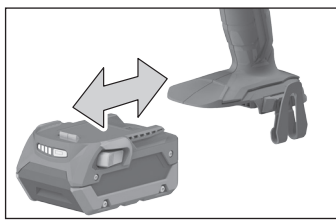
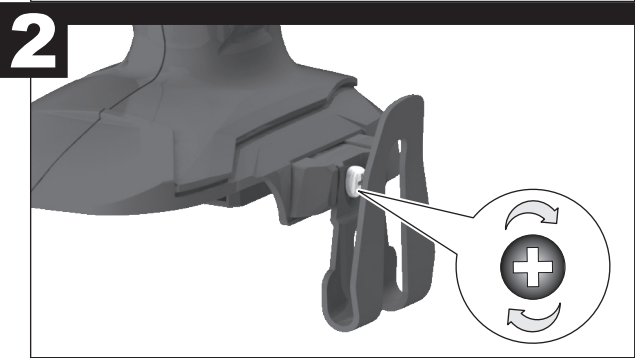
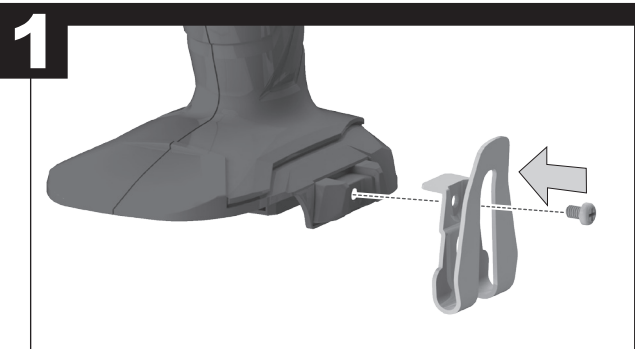
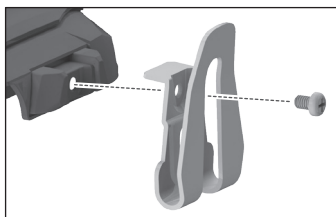

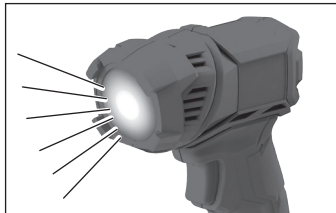

Press trigger to switch on the light until trigger locks.

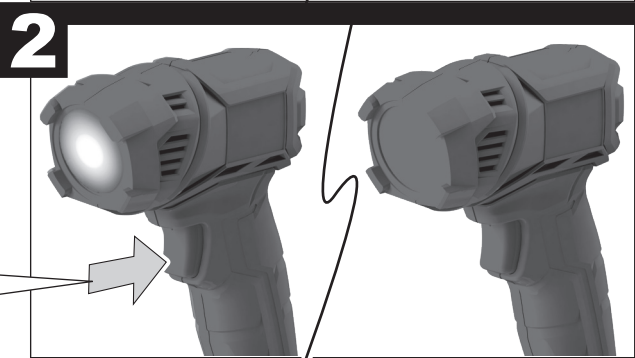
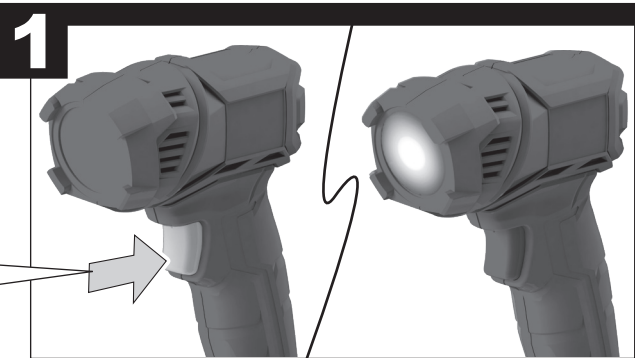

Press trigger again to release the switch to turn off the light.

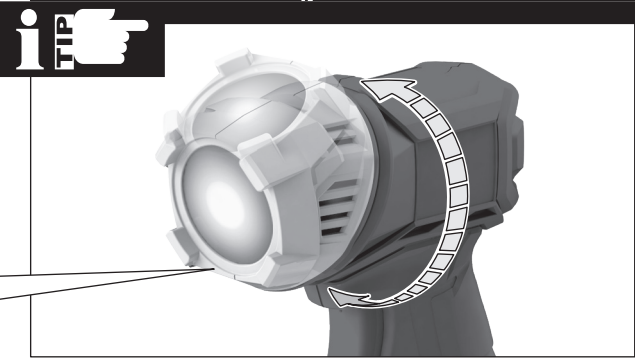

This light is equipped with a 180 degree rotating light.



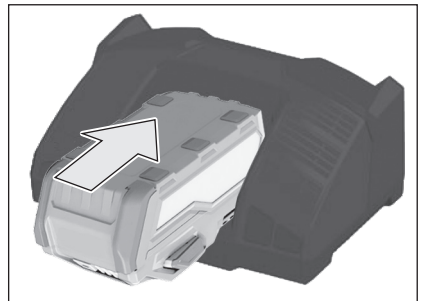
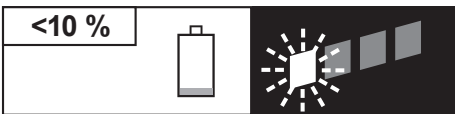
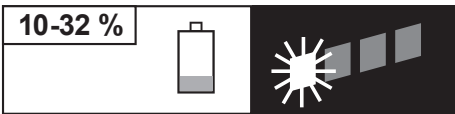
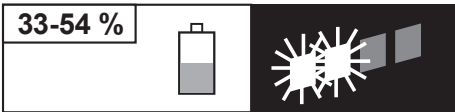
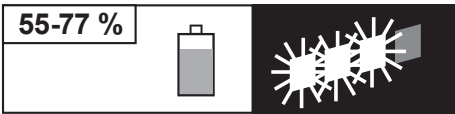
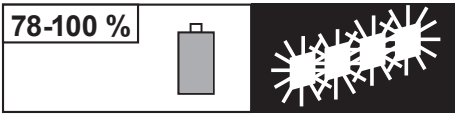
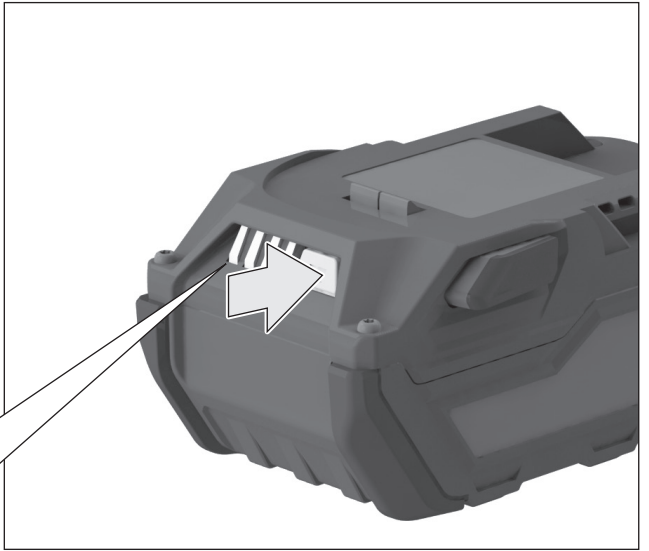

**TECHNICAL DATA****LED TORCH****FL182**

Rated voltage .....	18 V
Luminous flux .....	300 lm
Colour rendering index .....	72
Colour temperature .....	5500 k
Beam angle .....	7 degrees
Output watts .....	4.5 W
Run time with one fully charged battery (1.5 Ah) .....	6 hours
Run time with one fully charged battery (2.0 Ah) .....	7.5 hours
Run time with one fully charged battery (2.5 Ah) .....	9 hours
Run time with one fully charged battery (3.0 Ah) .....	12.5 hours
Run time with one fully charged battery (4.0 Ah) .....	16.5 hours
Run time with one fully charged battery (5.0 Ah) .....	18.5 hours
Run time with one fully charged battery (6.0 Ah) .....	23.5 hours
Run time with one fully charged battery (9.0 Ah) .....	35.5 hours
Weight - not including battery pack .....	0.35 kg

**BATTERY AND CHARGER**Compatible battery pack  
(not included)Compatible charger  
(not included)

L1815R

L1820R

L1825R

L1830R

L1840R

L1850R

L1860R

L1860B

L1860R-X5

L1890R

AL18G

AL1218G

BL1218

BLK1218

BL18DP-X5

BL18DP2-X5

Use AEG 18V battery and charger only

**⚠ WARNING! Read all safety warnings, instructions, illustrations and specifications provided with this power tool.** Failure to follow all instructions listed below may result in electric shock, fire and/or serious injury. **Save all warnings and instructions for future reference.**

**SAFETY WARNINGS**

Remove the battery pack before starting any work on the appliance.

Do not dispose of used battery packs in the household refuse or by burning them. AEG Distributors offer to retrieve old batteries to protect our environment.

Do not store the battery pack together with metal objects (short circuit risk).

Only use AEG batteries and chargers. Do not use battery packs from other systems.

Battery acid may leak from damaged batteries under extreme load or extreme temperatures. In case of contact with battery acid wash it off immediately with soap and water. In case of eye contact rinse thoroughly for at least 10 minutes and immediately seek medical attention.

Warning: Do not direct the light beam at persons or animals and do not stare into the light beam yourself (not even from a distance). Staring into the light beam may result in serious injury or vision loss.

Don't use this tool in wet areas.

Do not stare at the operating light source.

The light source of this luminaire is not replaceable; when the light source reaches its end of life the whole luminaire shall be replaced.

**ADDITIONAL BATTERY SAFETY WARNINGS**

**⚠ WARNING!** To reduce the risk of fire, personal injury, and product damage due to a short circuit, never immerse your tool, battery pack or charger in fluid or allow a fluid to flow inside them. Corrosive or conductive fluids, such as seawater, certain industrial chemicals, and bleach or bleach containing products, etc., can cause a short circuit.

**SPECIFIED CONDITIONS OF USE**

The LED torch is intended to be used as a spotlight.

Do not use this product in any other way as stated for normal use.

**BATTERIES**

New battery packs reach full loading capacity after 4 - 5 chargings and dischargings. Battery packs which have not been used for some time should be recharged before use.

Temperatures in excess of 50°C (122°F) reduce the performance of the battery pack. Avoid extended exposure to heat or sunshine (risk of overheating).

The contacts of chargers and battery packs must be kept clean.

For an optimum life-time, the battery packs have to be fully charged,



after used.

To obtain the longest possible battery life remove the battery pack from the charger once it is fully charged.

**For battery pack storage longer than 30 days:**

- Store the battery pack where the temperature is below 27°C and away from moisture.
- Store the battery packs in a 30% - 50% charged condition.
- Every six months of storage, charge the pack as normal.

**TRANSPORTING LITHIUM BATTERIES**

Lithium-ion batteries are subject to the Dangerous Goods Legislation requirements.

Transportation of those batteries has to be done in accordance with local, national and international provisions and regulations.

- The user can transport the batteries by road without further requirements.
- Commercial transport of Lithium-Ion batteries by third parties is subject to Dangerous Goods regulations. Transport preparation and transport are exclusively to be carried out by appropriately trained persons and the process has to be accompanied by corresponding experts.

When transporting batteries:

- Ensure that battery contact terminals are protected and insulated to prevent short circuit.
- Ensure that battery pack is secured against movement within packaging.
- Do not transport batteries that are cracked or leak.

Check with forwarding company for further advice.

**BATTERY PACK PROTECTION**

The battery pack has overload protection that protects it from being overloaded and helps to ensure long life. Under extreme stress the battery electronics switch off the battery-lamp automatically. To restart, switch the battery-lamp off and then on again. If the battery-lamp does not start up again, the battery pack may have discharged completely. In this case it must be recharged in the battery charger.

**MAINTENANCE**

The ventilation slots of the machine must be kept clear at all times. Use only AEG accessories and AEG spare parts. Should components need to be replaced which have not been described, please contact one of our AEG service agents (see our list of guarantee/service addresses). If needed, an exploded view of the tool can be ordered. Please state the Article No. as well as the machine type printed on the label and order the drawing at your local service agents or directly at:

**Techtronic Industries Australia Pty Ltd**

PO Box 1065  
Mount Waverley VIC 3149  
Tel. no. 1300 234 797  
Australia

**Techtronic Industries N.Z. Limited**

PO Box 12-806  
Penrose AUCKLAND 1642  
Tel. no. 0800 234 797  
New Zealand

**SYMBOLS**



Safety alert



Regulatory Compliance Mark (RCM). Product meets applicable regulatory requirements.



Please read the instructions carefully before starting the machine.



Class III protection



Do not stare at the operating light source.



Do not dispose of electric tools together with household waste material. Electric tools and electronic equipment that have reached the end of their life must be collected separately and returned to an environmentally compatible recycling facility.

# AEG

[www.aegpowertools.com.au](http://www.aegpowertools.com.au)  
[www.aegpowertools.co.nz](http://www.aegpowertools.co.nz)

**Techtronic Industries Australia Pty Ltd**  
31 Gilby Road, Mount Waverley, VIC 3149  
Australia

**Techtronic Industries N.Z. Limited**  
2 Landing Drive, Mangere  
Auckland, 2022, New Zealand

*AEG is a registered trademark used under  
license from AB Electrolux (publ).*