

HOW TO CLEAN PAD

Machine wash in warm water

- DO NOT USE BLEACH
- DO NOT USE FABRIC SOFTENER
- Lay flat to dry completely before re-assembling onto the product.

DIRT CUP & FILTER: REMOVAL & REPLACEMENT

IMPORTANT: FOR BEST RESULTS, CLEAN THE FILTER AFTER EACH USE.

NOTE: For best performance, replace filter at least every 3-6 months depending on the level of use. If filter is discoloured or damaged it requires replacement.

DIRT DEVIL FILTER PART NO.
DDQC120

For genuine replacement parts, please visit our website at www.dirtdevil.com.au / www.dirtdevil.co.nz or call customer service on AU: 1300 361 505 / NZ: 0800 800 900

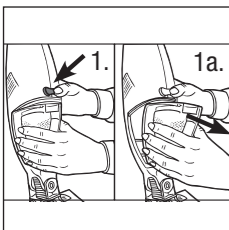

Press the dirt cup release button located above the cup on the body of the unit (Diagram 1).

Tip the dirt cup out to remove (Diagram 1a).

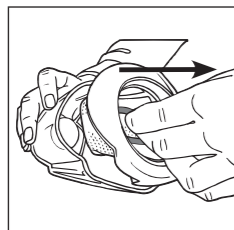

Grasp the center tab on the filter and pull out of dirt cup.

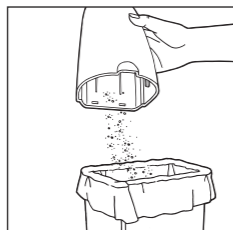

Empty Contents into bin. For best results, shake and lightly tap filter against bin to remove remaining dirt.

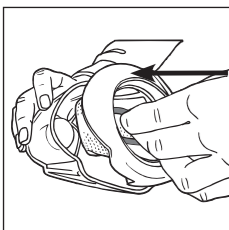

Return filter to dirt cup.

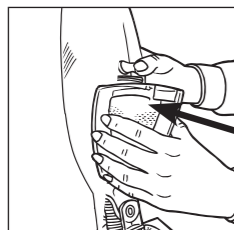

Tilt and push dirt cup in until it locks into place.

CLEAN AND RINSE FILTER

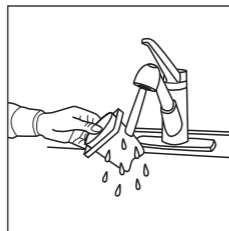

Hold filter under running water to rinse.

! DO NOT use soap/detergent.

Tap excess water out of filter.

! Allow filter to COMPLETELY DRY for at least 24 hours before replacing in dirt cup.

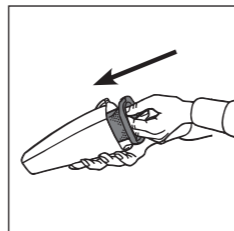

Gently push filter back into dirt cup.

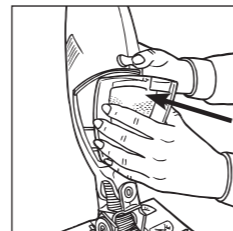

To reattach dirt cup: Align bottom first and pivot dirt cup until it snaps into place.

TROUBLESHOOTING GUIDE

WARNING: TO REDUCE RISK OF PERSONAL INJURY - UNPLUG CLEANER BEFORE SERVICING

PROBLEM	POSSIBLE REASON	POSSIBLE SOLUTION
Cleaner won't run	Battery not charged.	Charge battery. For first use, charge for at least 24 hours.
	Handle is not pushed into housing.	Make sure handle is pushed firmly all the way into housing.
	Battery dead - won't hold a charge.	Call Customer Service: AU 1300 361 505 NZ 0800 800 900
	Needs service.	Call Customer Service: AU 1300 361 505 NZ 0800 800 900
Cleaner won't pick up or low suction	Dirt Container is full.	Empty Dirt Container
	Filter is dirty.	Remove filter and clean.
	Battery charge is getting weak.	Charge battery.
Dust escaping from cleaner	Dirt Container is full.	Empty Dirt Container.
	Filter is dirty.	Clean or replace filter

Distributed by Techtronic Industries Australia Pty. Ltd.
Level 1, 660 Doncaster Road, Doncaster, 3108 Australia.
Service Line: AU: 1300 361 505 / NZ: 0800 800 900

www.dirtdevil.com.au / www.dirtdevil.co.nz

USER GUIDE

DRY
VAC
+
DUST

1 year
warranty

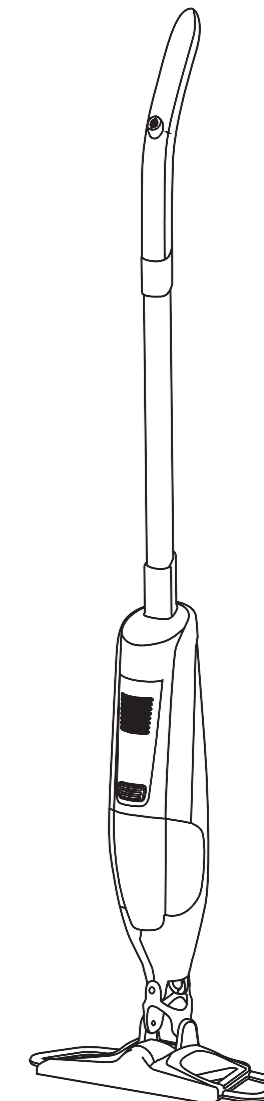

Model No. DDQC105

- Please read these instructions carefully before using your product.
- Let us help you put your product together, order parts and accessories or answer any questions.
- Please Do Not Return This Product To The Store.

DIRT DEVIL SERVICE LINE:

Monday-Friday 8:30am – 5:00pm EST.

Australia: 1300 361 505 www.dirtdevil.com.au

New Zealand: 0800 800 900 www.dirtdevil.co.nz

WARNING: Product assembly may include small parts. Small parts can present a choking hazard.

WARRANTY

To assist with any warranty claims, attach your sales receipt to this Owner's manual as verification of date of purchase. This will be required for warranty service of your Dirt Devil® product.

For quick reference, please record your product information below.

Model Number: **DDQC105**

Serial No. (located on side of machine):

GENERAL SAFETY INFORMATION

FOR HOUSEHOLD USE ONLY.

When using the vacuum cleaner, basic safety precautions should always be observed, including the following:

1. Only use the vacuum cleaner indoors on dry surfaces.
2. Turn off the vacuum cleaner before disconnecting or connecting to the charger.
3. Always unplug the vacuum cleaner before emptying dirt container and removing/reinserting filter and/or SWIPES pad.
4. Children should be supervised to ensure that they do not play with the appliance.
5. This appliance is not intended for use by children and persons with reduced physical, sensory or mental capabilities or lack of experience and knowledge, unless they have been given supervision or instruction concerning use of the appliance in a safe way and understand the hazards involved.
6. Cleaning and maintenance shall not be made by children.
7. The appliance should only be used as described in this user guide.
8. Only Dirt Devil recommended consumables should be used with this appliance.
9. Do not use this vacuum cleaner if it has been dropped, damaged, left outdoors or dropped into water. Do not use this vacuum cleaner with a damaged charger.
10. Do not pull or carry charger by the cord. Do not use the cord as a handle, close a door on the cord or pull the cord around sharp edges or corners. Do not run the vacuum cleaner over the cord. Keep the cord away from heated surfaces.
11. Do not handle the charger or the vacuum cleaner with wet hands.
12. Keep hair, loose clothing, fingers and all parts of the body away from openings and moving parts.

13. Do not pick up any hot coals, ash, cigarette butts, matches or any hot, smoking or burning objects.
14. Do not pick up any flammable or combustible materials (lighter fluid, petrol, kerosene etc.) or use in the presence of explosive liquids or vapours.
15. Do not vacuum harmful or toxic material (chlorine, bleach, ammonia, drain cleaner etc.).
16. Do not vacuum hard or sharp objects such as glass, nails, screws, coins etc.
17. Do not vacuum plaster dust, concrete dust or any other building or vitreous materials.
18. Do not vacuum baking soda or any other powder-based carpet refresher or deodoriser.
19. Store the vacuum cleaner in a cool, dry area.
20. Do not put any objects into openings. Do not use with any openings blocked and do not restrict airflow. Keep all openings free of dust, lint, hair or anything that might reduce airflow.
21. Do not use the vacuum cleaner with a blocked filter and without the filter in place.
22. Take extra care when positioning the vacuum cleaner on the stairs.
23. Keep vacuuming area well lit.

WARNING: The vacuum cleaner is a very powerful unit. Always switch off and unplug the vacuum cleaner from charger before assembling, opening or emptying the dirt container and before removing/reinserting filter and/or SWIPES pad.

IMPORTANT: If the inlet is blocked, switch off the vacuum cleaner and remove the blockage(s) before re-starting the vacuum cleaner.

IMPORTANT: It is very important that the filter is kept clean to obtain maximum performance from your vacuum cleaner. Not cleaning and not replacing your filter regularly can reduce the suction power and cause overheating and permanent damage to the vacuum cleaner.

DAMAGE TO THE VACUUM CLEANER CAUSED AS A DIRECT RESULT OF NOT ADHERING TO THE GENERAL SAFETY INFORMATION AND THE INSTRUCTIONS IN THIS USER GUIDE INVALIDATES THE WARRANTY

This vacuum cleaner is intended for household use only and NOT for commercial or industrial use.

PLEASE KEEP THESE INSTRUCTIONS FOR FURTHER USE.

TECHNICAL SPECIFICATIONS

VACUUM CLEANER	
Voltage	10.8V Ni-MH
Filter	Washable
Weight	1.75kg
Run Time	7 minutes
Charging Time	12 hours

CHARGER	
Voltage Input	100-240V~50/60Hz
Voltage Output	15V d.c 0.15A
Only suitable for battery supplied with Dirt Devil DRY VAC + DUST: model no. DDQC105	

FEATURES

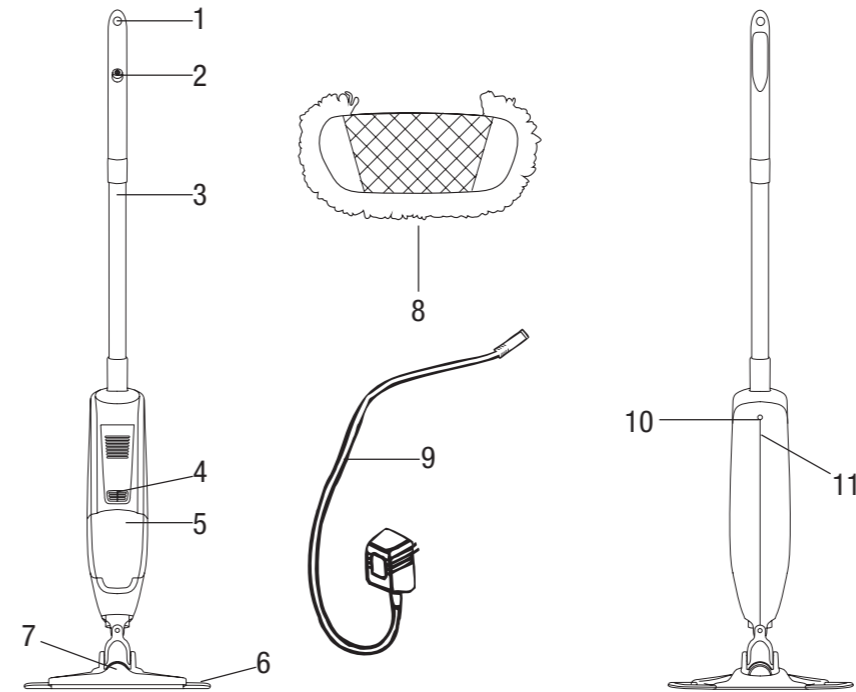

1. Hanging Loop
2. Power Button (ON/OFF)
3. Upper Handle
4. Dirt Container Release Button
5. Dirt Container
6. Frame for Cleaning Pad
7. Vacuum Nozzle
8. Microfibre Pad
9. Charger
10. Charging Light
11. Charger Plug Inlet

HOW TO ASSEMBLE

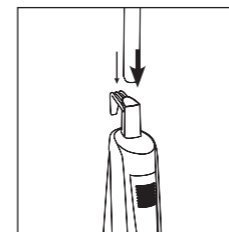

1. Insert the handle into the body of the unit and firmly push in until it locks into place (Diagram 1)

NOTE: SOME MODELS COME ASSEMBLED

CHARGING

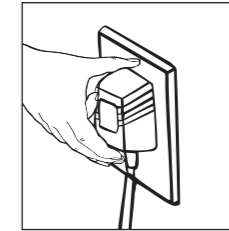

Connect charger to the outlet.

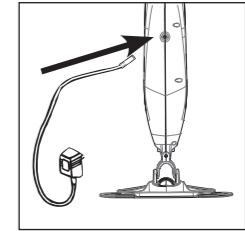

Plug charger end into the charger plug inlet at the back of the unit.

NOTE: The indicator light will come on to indicate that the appliance is charging. It will go off when charging has been completed.

STORAGE

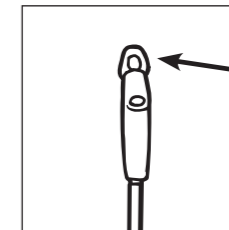

Use the storage hook to hang Vac anywhere.

HOW TO OPERATE

WARNING: This product is intended for dry pick up only. Do not attempt to vacuum up any liquids with this cleaner.

DIRT DEVIL SWIPES PART NO.
DDQC150

FOR BEST RESULTS, USE DIRT DEVIL DRY SWIPES MICROFIBRE PADS.

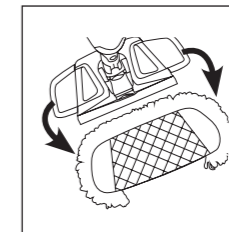

Slide one side in pocket and then the other.

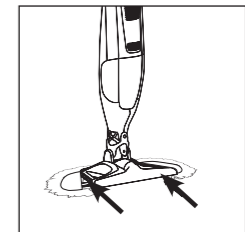

Use the Dirt Devil microfibre cloths to pick up fine debris like dirt, dust and pet hair. Use vacuum to suck up any left over debris. For best results, wash the microfibre cloth after every use.

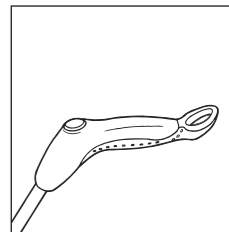

To turn vac on: Press and release the vac power button located in the handle. To turn vac off: Press and release the vac power button again.