



Product Spotlight Sheet

Reflecta-Shield Plus™

greenguide

features and benefits reference



Phone: 1300 308 165

Fax: 1300 308 164

Web: gibuildingsciences.com.au

Reflecta-Shield Plus™ the original

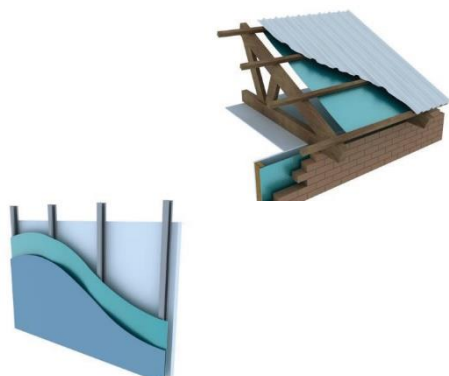

Reflecta-Shield Plus™ and other thermos-cellular insulation materials have now been used by the building industry for well over 20 years.

Initially designed as an alternative to fibrous insulation materials **Reflecta-Shield Plus™** has continually proven to outperform conventional insulation materials and demonstrate greater longevity under harsh Australian climate conditions.

Suitable for almost every building type commercial or domestic, **Reflecta-Shield Plus™** offers great performance benefits for almost every building application.

Performance Comparison of Reflecta-Shield Plus™ to Competing Insulation Materials				
Flat Metal Roof 0-5° & Flat Suspended Plasterboard Ceiling				
Insulation		Summer (Downwards)	Winter (Upwards)	Thermal Break
1*	GI Building Sciences™ Reflecta-Shield Plus™	RT 3.6	RT 1.2	0.10
2*	60mm Glasswool Roofing Blanket	RT 3.5	RT 2.1	0.20
3*	Kingspan Insulbreak 65	RT 3.2	RT 1.4	0.20

1*. Thermal calculations for GI products by James Fricker as per AS/NZS 4859.1&2 - Airspace 300mm

2*. Glasswool R Values source the Insulation Council of Australia & New Zealand Insulation Handbook V2, Jan 2015 - Airspace 300mm

3*. Kingspan R Values source Kingspan Section J Compliance Solutions Brochure Issue 2, October 2013 - Airspace Range 100 – 1200mm

Features – Fact vs Fiction

- 15 Year Warranty
- Suitable for use in Residential & Commercial Walls & Roofs
- Class 2 Vapour Barrier
- 20m x 1500mm Roll
- AS 1530.2 & AS/NZS 1530.3 Compliant
- Structure enables it and Other Cellular Materials to be easily installed

Key Benefits

- A Good medium for managing condensation
- 1500mm Wide reduces Wastage compared to the 1350mm Wide Foam Product
- Fully Recyclable
- Able to be Cut to Length for Major Projects
- Cost of Raw Materials More Stable than Foam ensuring Long Term Cost Competitiveness
- The Entry Level all-rounder suited to Commercial, Domestic or Shed Construction Projects

