

RYOBI®

RBJ254N

ORIGINAL INSTRUCTIONS

Jet Blower



Important!

It is essential that you read the instructions in this manual before assembling, operating, and maintaining the product.

Subject to technical modification.

Safety, performance, and dependability have been given top priority in the design of your jet blower.

INTENDED USE

The jet blower is only intended for use outdoors in dry and well-illuminated conditions.

The product is not intended to be used by children or persons with reduced physical, mental, or sensory capabilities.

The product is designed for blowing light debris, such as leaves, grass, and other garden refuse.

The product is not designed to suck in water or other liquids. Do not use the product for any other purpose.

GENERAL SAFETY WARNINGS

⚠ WARNING

Read all safety warnings and all instructions. Failure to follow the warnings and instructions may result in electric shock, fire, and/or serious injury. Save all warnings and instructions for future reference.

⚠ WARNING

Never allow children or people unfamiliar with these instructions to use the product. Local regulations may restrict the age of the operator.

- Some regions have regulations that restrict the use of the product. Check with your local authority for advice.
- Do not allow children or untrained individuals to use the product.
- Ensure before each use that all controls and safety devices function correctly. Do not use the product if the off switch does not stop the engine.
- Never start or run the engine in a closed or poorly ventilated area; breathing exhaust fumes can kill.
- Clear the work area before each use. Remove all objects such as rocks, broken glass, nails, wire, or string that can be blown a considerable distance by high velocity air.
- Wear hearing protection at all times while operating the product. The product is noisy, and permanent hearing injury may result if precautions to limit your exposure, reduce noise, and wear hearing protection are not strictly adhered to.
- Wear full eye protection at all times while operating the product. The manufacturer strongly suggests a full face mask or fully enclosed goggles. Normal spectacles or sunglasses are not adequate protection. Objects can be thrown at high speed by the powerful air jet at any time and may rebound from hard surfaces toward the operator.
- While operating the product, always wear substantial footwear and long trousers. Do not operate the product when barefoot or wearing open sandals. Avoid wearing clothing with loose fitting or that has hanging cords or ties.
- Do not wear loose clothing or jewellery that can be drawn into the air inlet. Secure long hair so it is above shoulder level to prevent entanglement in moving parts.
- Beware of thrown objects; keep all bystanders, children, and pets at least 15 m away from the work area.
- Operate the product only at reasonable hours – not early in the morning or late at night when people might be disturbed.
- Use rakes or brooms to loosen debris before operating the product.
- Never operate the product in an explosive atmosphere.
- Never use the product when you are tired, ill, or under the influence of alcohol, drugs, or medicine.
- Before each use, ensure that all controls and safety devices function correctly.
- Operate the product in a recommended position and only on a firm and level surface.
- Do not operate the product on a paved or gravel surface where ejected material could cause injury.
- Before each use, always inspect the housing for damage. Ensure that guards and handles are in place and properly secured. Replace worn or damaged components in sets to preserve balance. Replace damaged or unreadable labels.
- Keep all cooling air inlets clear of debris.
- Never operate the product while people,

especially children, or pets are nearby.

- Avoid using the product in bad weather conditions especially when there is a risk of lightning.
- Do not operate in poor lighting. The operator requires a clear view of the work area to identify potential hazards.
- Operating similar tools nearby increases both the risk of hearing injury and the potential for other persons to enter your working area.
- Always be sure of your footing on slopes. Walk, never run.
- Keep proper footing and balance. Do not overreach. Overreaching can result in loss of balance.
- Do not use on a ladder, rooftop, tree, or other unstable support. Stable footing on a solid surface enables better control of the blower in unexpected situations.
- Never use the product with defective guards or shields, or without safety devices in place.
- Do not modify the product in any way or use parts and accessories that are not recommended by the manufacturer.
- Remember to securely refit the fuel tank cap before starting the engine.
- Wipe away any fuel spillage. Move 9 m away from refuelling site before starting engine.
- To reduce the risk of injury associated with contacting rotating parts, always stop the engine, and make sure all moving parts have come to a complete stop before:
 - leaving the product unattended
 - clearing blockages or unclogging chute
 - checking, cleaning, or working on the product
 - inspecting the product after striking a foreign object
- Immediately stop the engine in an event of accident or breakdown. Do not operate the product again until it has been fully checked by an authorised service centre.
- The product is not intended for frequent use. It is for occasional use for general applications, such as blowing leaves, lawn clippings, etc. It is not intended for prolonged use. Prolonged periods of operation can cause circulatory problems to your hands due to vibration. For use in prolonged period, it is appropriate to use the product with an anti-vibration feature.

⚠ WARNING

If the product is dropped, suffers heavy impact or begins to vibrate abnormally, immediately stop the product and inspect for damage or identify the cause of the vibration. Any damage should be properly repaired or replaced by an authorised service centre.

⚠ WARNING

Your blower is fitted with a shoulder harness. Carefully adjust the harness to comfortably help to support the weight of the product and hang at your back with the bower tube at your right-hand side.

⚠ WARNING

Identify the quick release mechanism and practice using it before you start using the product. Its correct use may prevent serious injury in the case of an emergency. Never wear additional clothing over the harness or otherwise restrict access to the quick release mechanism.

- Do not touch the area around the silencer or engine of the product. These parts get hot during operation.
- Stop the engine and allow the product to cool down before refuelling.
- For refuelling and fuel mixing, chose an area that is well-ventilated, and is away from ignition sources, such as sparks or flames, and flammable materials.
- Remember to securely refit the fuel tank filler cap Do not smoke when mixing fuel or filling the fuel tank.
- Mix and store fuel in a container approved for fuel. Keep an appropriate type of fire extinguisher nearby for dealing with fuel fires.

BLOWER SAFETY WARNINGS

- Wear a face filter mask in dusty conditions to reduce the risk of injury associated with the inhalation of dust.
- Slightly dampen surfaces in dusty

conditions.

- Do not use the product near open windows.
- Use the full blower nozzle extension so that the air stream can work close to the ground and perform effectively.
- Do not point the blower nozzle in the direction of people or pets.
- Never place objects inside the blower tubes.
- Do not place the product on top of or near loose debris. Debris can be sucked into the intake vent, resulting in possible damage to the product.

TRANSPORTATION AND STORAGE

- Stop the engine and allow the product to cool down before storing or transporting.
- Clean all foreign material from the product.
- Drain all fuel from the tank into a container approved for petrol. Remember to properly replace and tighten the fuel cap.
- Run the engine until it stops. This will remove all fuel that could become stale and leave varnish and gum in the fuel system.
- Store the product in a cool, dry, and well-ventilated place that is inaccessible to children. Keep away from corrosive agents, such as garden chemicals and de-icing salts.
- Do not store outdoors.
- When transporting the product in a vehicle, secure it against movement or falling to prevent injury to persons or damage to the product.
- Abide by all government and local regulations for the safe storage and handling of petrol.

Short term (less than 1 month)

- Stop the engine and allow the product to cool down before storing or transporting.
- Clean all foreign material from the product.
- Store the product in a cool, dry, and well-ventilated place that is inaccessible to children.
- Keep away from corrosive agents such as garden chemicals and de-icing salts.
- Do not store outdoors.

MAINTENANCE

⚠ WARNING

When servicing, use only identical parts. Use of any other parts may create a hazard or cause product damage.

⚠ WARNING

Before inspecting, cleaning, or servicing the product, shut off engine and wait for all moving parts to stop. Failure to follow these instructions can result in serious personal injury or property damage.

⚠ WARNING

Do not at any time let brake fluids, petrol, petroleum-based products, penetrating lubricants, etc., come in contact with plastic parts. Chemicals can damage, weaken, or destroy plastic, which can result in serious personal injury.

- Avoid using solvents when cleaning plastic parts. Most plastics are susceptible to damage from various types of commercial solvents and may be damaged by their use. Use clean cloths to remove dirt, dust, lubricant, grease, etc.
- You can make adjustments and repairs described in this user manual. For other repairs, have the blower serviced by an authorised service dealer.
- Check all nuts, bolts, and screws at frequent intervals for proper tightness to ensure the product is in safe working condition. Any part that is damaged should be properly repaired or replaced by an authorised service centre.

CLEANING THE AIR FILTER

A wet or dirty air filter causes starting difficulty, loss of performance, and shorten the life span of the engine. The air filter should be checked and cleaned after 5 hours of operation. Inspect and clean more frequently if used in dusty dirty conditions.

For best performance, the air filter should be replaced every 25 hours or yearly.

To clean the air filter:

1. Press the air filter cover tab to open the air filter cover.
2. Remove the cover.
3. Lift the edge of the air filter carefully and peel it out.
4. Clean the air filter with a brush.
5. To reinstall the air filter cover, insert the tabs into the notches and lock into place.

NOTE: Make sure the filter is seated properly inside the cover. Installing the filter incorrectly will allow dirt to enter the engine, causing rapid engine wear.

CLEANING THE EXHAUST PORT, MUFFLER, AND SPARK ARRESTOR

NOTE: Depending on the type of fuel used, the type and amount of lubricant used, and/or your operating conditions, the exhaust port, muffler, and/or spark arrestor screen may become blocked with carbon deposits. If you notice a power loss with your petrol-powered product, you may need to remove these deposits to restore performance. We highly recommend that only qualified service technicians perform this service.

The spark arrestor must be cleaned or replaced every 50 hours or yearly to ensure proper performance of your product. Spark arrestors may be in different locations depending on the model purchased. Please contact your nearest service dealer for the location of the spark arrestor for your model.

⚠ WARNING

To avoid a fire hazard, never run the blower without the spark arrestor in place.

FUEL CAP

⚠ WARNING

A leaking fuel cap is a fire hazard and must be replaced immediately.

The fuel cap contains a sealing gasket and a check valve to allow air in. A clogged check valve will cause poor engine performance. If performance improves when the fuel cap is loosened, the check valve may be faulty. Replace fuel cap if required.

When refitting the fuel cap ensure it is not cross-threaded, otherwise it will leak.

FUEL FILTER

The fuel supplied to the engine is passed through a filter to remove any contaminants from entering the engine. Contaminants in the fuel can cause poor performance and damage to the engine.

The fuel filter is a non-serviceable item and, if needed, should be replaced by an authorised service centre.

SPARK PLUG REPLACEMENT

The product's engine uses a Champion RCJ6Y spark plug. Replace with a recommended every 25 hours or annually.

1. Remove the spark plug boot.
2. Loosen the spark plug by turning it counter-clockwise with a socket.
3. Remove the spark plug.
4. Inspect the new spark plug. The spark plug must be properly gapped and free of deposits in order to ensure proper engine operation. The correct gap is 0.025 in. (0.64 mm). To widen gap, if necessary, carefully bend the ground (top) electrode. To lessen gap, gently tap ground electrode on a hard surface.
5. Hand thread the new spark plug into the cylinder, turning it clockwise.
6. Tighten with a socket. Torque to 216 in.lb. (24.40 Nm) minimum, 264 in.lb. (29.82 Nm) maximum. Do not over-tighten.

⚠ WARNING

Be careful not to cross-thread the spark plug. Cross-threading will seriously damage the product.

RESIDUAL RISKS

Even when the product is used as prescribed, it is still impossible to completely eliminate certain residual risk factors. The following hazards may arise in use and the operator should pay special attention to avoid the following:

- Injury caused by vibration.
 - Always use the right tool for the job. Use designated handles and restrict working time and exposure.
- Hearing damage caused by exposure to noise.
 - Wear ear protection and limit exposure.

- Injury from flying objects from the blow tube airflow
 - Wear eye protection at all times.

RISK REDUCTION

It has been reported that vibrations from handheld tools may contribute to a condition called Raynaud's Syndrome in certain individuals. Symptoms may include tingling, numbness, and blanching of the fingers, usually apparent upon exposure to cold. Hereditary factors, exposure to cold and dampness, diet, smoking and work practices are all thought to contribute to the development of these symptoms. There are measures that can be taken by the operator to possibly reduce the effects of vibration:

- Keep your body warm in cold weather. When operating the product wear gloves to keep the hands and wrists warm. It is reported that cold weather is a major factor contributing to Raynaud's Syndrome.
- After each period of operation, exercise to increase blood circulation.
- Take frequent work breaks. Limit the amount of exposure per day.

If you experience any of the symptoms of this condition, immediately discontinue use and see your physician.

⚠ WARNING

Injuries may be caused, or aggravated, by prolonged use of a tool. When using any tool for prolonged periods, ensure you take regular breaks.

FEATURES

KNOW YOUR BLOWER

See figure 1

The safe use of the product requires an understanding of the information on the product and in this operator's manual as well as knowledge of the project you are attempting to do. Before use of the product, familiarise yourself with all operating features and safety rules.

BLOWER TUBE

The blower tubes can be assembled and installed on the main housing using no tools.

ENGINE

The blower has a powerful 25,4 cc engine with sufficient power to handle tough blowing.

CRUISE LEVER

The cruise lever feature allows the user to operate the blower without holding the throttle trigger. To slow the engine speed, push the cruise lever forward.

THROTTLE TRIGGER

The blower can be operated at any speed between idle and full throttle.

ASSEMBLY

UNPACKING

The product requires assembly.

- Carefully remove the product and any accessories from the box. Make sure that all items listed on the packing list are included.

⚠ WARNING

Do not use the product if any parts on the packing list are already assembled when you first open the box. The parts on the packing list are not assembled by the manufacturer and require customer installation. Use of a product that may have been improperly assembled could result in serious personal injury.

- Carefully inspect the product to make sure no breakage or damage occurred during shipping.
- Do not discard the packing material until you have carefully inspected and satisfactorily operated the product.
- If any parts are damaged or missing, please call your RYOBI service centre for assistance.

PACKING LIST

- Blower
- Blower tube
- Shoulder strap
- 2-cycle engine lubricant
- Operator's manual

NOTE: Read and remove all hang tags and store with your operator's manual.

⚠ WARNING

If any parts are damaged or missing, do not operate the product until the parts are replaced. Use of the product with damaged or missing parts could result in serious personal injury.

⚠ WARNING

Do not attempt to modify the product or create accessories not recommended for use with the product. Any such alteration or modification is misuse and could result in a hazardous condition leading to possible serious personal injury.

INSTALLING THE BLOWER TUBE

- Align raised tabs on reducer housing outlet to the slots on tube; slide together and tighten securely by twisting. Check tightness after initial use and retighten if needed.
- To remove the tube, rotate the tube and remove from the reducer housing outlet.

INSTALLING THE SHOULDER STRAP

When operating the product, you may wear a shoulder strap to provide additional support for the unit.

- Place shoulder strap over your right shoulder and attach shoulder strap clip to strap hanger. Adjust by sliding the front clip up or down.

NOTE: When properly adjusted, the blower should be supported by the shoulder strap about hip level.

OPERATION

⚠ WARNING

Do not allow familiarity with tools to make you careless. Remember that a careless fraction of a second is sufficient to inflict serious injury.

⚠ WARNING

Always wear eye protection with side shields marked to comply with standards, along with hearing protection. Failure to do so could result in serious injuries such as objects being thrown into your eyes.

FUELLING AND REFUELLING

MIXING THE FUEL

The product is powered by a 2-stroke engine and requires premixing petrol and 2-stroke oil. The mixture should be at a 50:1 ratio.

NOTE: We recommend you use RYOBI synthetic 2-stroke lubricant. Only use a quality synthetic 2-stroke lubricant in the product to ensure top performance and engine longevity.

NOTE: If using similar containers for different fuels, label the container with its contents and the date it was added.

TO MIX THE FUEL:

- Pre-mix unleaded petrol and 2-stroke engine lubricant in a clean container approved for petrol.
- The engine of the product is certified to operate on unleaded petrol intended for automotive use with an octane rating of 91 or higher.
- Do not use any type of pre-mixed petrol/lubricant from fuel service stations; this includes the pre-mixed petrol/lubricant intended for use in mopeds, motorcycles, etc.
- Avoid using ethanol fuels or fuels containing ethanol. The use of ethanol fuels may result in damage to the engine of the product.
- Use only synthetic 2-stroke lubricant. Do not use automotive lubricant or 2-stroke outboard lubricant.
- Mix 2% synthetic 2-stroke lubricant into the petrol. This is a 50:1 ratio.
- Mix the fuel thoroughly and also each time before fuelling.
- Mix in small quantities. Do not mix quantities larger than usable in a 30-day period. A synthetic 2-stroke lubricant containing a fuel stabiliser is recommended.



1 L	+	20 mL	=	} 50:1 (2%)
2 L	+	40 mL	=	
3 L	+	60 mL	=	
4 L	+	80 mL	=	
5 L	+	100 mL	=	

FILLING THE TANK

⚠ WARNING

Petrol is extremely flammable and explosive. A fire or explosion from petrol will burn you and others. Always shut off engine before fuelling. Never add fuel to a machine with a running or hot engine. Move at least 9 m from refuelling site before starting engine. Do not smoke and stay away from open flames and sparks. Failure to safely handle fuel could result in serious personal injury.

1. Clean the surface around the fuel cap to prevent contamination.
2. Loosen the fuel cap slowly.
3. Pour the fuel mixture carefully into the tank.
4. Clean and inspect the fuel cap gasket before replacing the fuel cap.
5. Replace the fuel cap and tighten it. Do not cross thread the fuel cap.
6. Wipe spilled fuel from the product.
7. Move at least 9m away from refuelling area before starting the product.

NOTE: It is normal for smoke to be emitted from a new engine during first use.

⚠ WARNING

Check for fuel leaks. A leaking fuel cap is a fire hazard and must be replaced immediately. If you find any leaks, correct the problem before using the product. Failure to do so could result in a fire that could cause serious personal injury.

STARTING AND STOPPING

To start a cold engine:

Blower should be placed on a flat, bare surface for starting.

1. Press the primer bulb 10 times.

NOTE: After the 7th press, fuel should be visible in the primer bulb. If it is not, continue to press the primer until you see fuel in the bulb.

2. Set the choke lever to the FULL CHOKE position.
 3. Set the cruise lever to the full throttle position.
 4. Pull the starter rope sharply until engine attempts to start. Do not pull the starter rope more than four (4) times.
 5. Set the choke lever to the HALF CHOKE position.
 6. Pull the starter rope sharply until the engine starts. Do not pull the starter rope more than six (6) times.
- NOTE:** If the engine does not start, return to the FULL CHOKE position and repeat the steps that follow.
7. Allow the engine to run for 10 seconds.
 8. Set the choke lever to the RUN position.

To start a warm engine:

1. Press the primer bulb 10 times.

NOTE: After the 7th press, fuel should be visible in the primer bulb. If it is not, continue to press the primer until you see fuel in the bulb.

2. Set the choke lever to the RUN position.
3. Set the cruise lever to the full throttle position to start a warm engine.
4. Pull the starter rope sharply until the engine starts. Do not pull the starter rope more than six (6) times.

To stop the engine:

To stop the engine, press the switch to the "stop" position.

OPERATING THE BLOWER

- Check your equipment before operation, especially the muffler, air intakes, and air filters.
- Use rakes and brooms to loosen debris before blowing.

⚠ WARNING

Never run the product without the blower tubes installed. Failure to follow these steps could result in possible serious injuries.

⚠ WARNING

Always wear eye protection with side shields marked to comply with standards, along with hearing protection. Failure to do so could result in objects being thrown into your eyes and other possible serious injuries.

1. Start the blower. Refer to “Starting and stopping” in this manual. Hold the blower with the handle in your right hand.

⚠ WARNING

Always hold the blower away from your body with the handle in your right hand when operating as a blower, keeping clearance between your body and the product. The muffler side of the blower should be away from your body. Any contact with the housing can result in burns and/or other serious personal injury.

⚠ WARNING

Do not place blower on top of or near loose debris or gravel. Debris may be sucked into blower intake vent resulting in possible damage to the product and could result in serious personal injury.

2. To keep from scattering debris, blow around the outer edges of a debris pile. Never blow directly into the centre of a pile.

NOTE: Operate power equipment at reasonable hours only; not early in the morning or late at night when people might be disturbed. Comply with the times listed in local ordinances.

NOTE: To reduce sound levels, limit the number of pieces of equipment used at any one time.

3. Operate blower at the lowest possible throttle speed to do the job.

NOTE: In dusty conditions, slightly dampen surfaces when water is available.

⚠ WARNING

Watch out for children, pets, open windows, or freshly washed cars, and blow debris safely away.

4. Use the sweeper nozzle so the air stream can work close to the ground.
5. After using blowers or other equipment, clean up. Dispose of debris properly.
6. Use the sweeper nozzle for everyday blowing operation. The nozzle allows for more area to be covered during the blowing operation.

CRUISE LEVER

The cruise lever can be used to operate the blower without holding the throttle trigger. This lever has three positions: idle, quiet mode, and full throttle.

To engage the cruise lever:

- Pull cruise lever back towards user, and stop at the desired throttle setting.
- To release the cruise lever, push cruise lever all the way towards the front of unit.

SYMBOLS ON THE PRODUCT



Safety alert



Please read the instructions carefully before using the product.



Wear eye protection.



Wear ear protection.



Warning! Hot surface.



Beware of thrown or flying objects. Keep all bystanders, especially children and pets, at least 15 m away from the operating area.



Do not run unit without tubes in place.



Risk of long hair being drawn into air inlet.



Risk of loose clothing being drawn into air intake.



To reduce the risk of injury or damage, avoid contact with any hot surface.



Beware of rotating fans. Keep hands and feet out of openings while the product is running.



Use unleaded petrol intended for motor vehicle use with an octane rating of 91 or higher.



Use 2-stroke oil for air cooled engines.



Mix the fuel mix thoroughly and also each time before refuelling.



To stop the product, press the switch to the "STOP" position.



Set throttle.



Press the primer bulb.



Pull the starter grip.



Run the engine at full throttle for 10 seconds.



Full choke position.



Half choke position.



Run position.



The bystander sound level is 76.5 dB(A) per ANSI B175.2.



Regulatory Compliance Mark (RCM). The product meets applicable regulatory requirements.



Waste electrical products should not be disposed of with household waste. Please recycle where facilities exist. Check with your local authority or retailer for recycling advice.

SYMBOLS IN THIS MANUAL



Note



Warning



Parts or accessories are sold separately

The following signal words and meanings are intended to explain the levels of risk associated with the product:

⚠ DANGER

Indicates an imminently hazardous situation, which, if not avoided, will result in death or serious injury.

⚠ WARNING

Indicates a potentially hazardous situation, which, if not avoided, could result in death or serious injury.

⚠ CAUTION

Indicates a potentially hazardous situation, which, if not avoided, may result in minor or moderate injury.

CAUTION

Without safety alert symbol

Indicates a situation that may result in property damage.

UNPACKING

RBJ254N

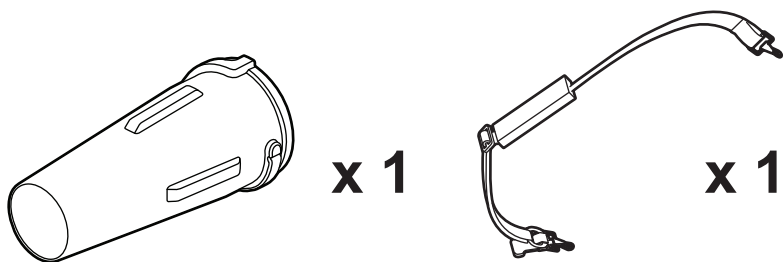
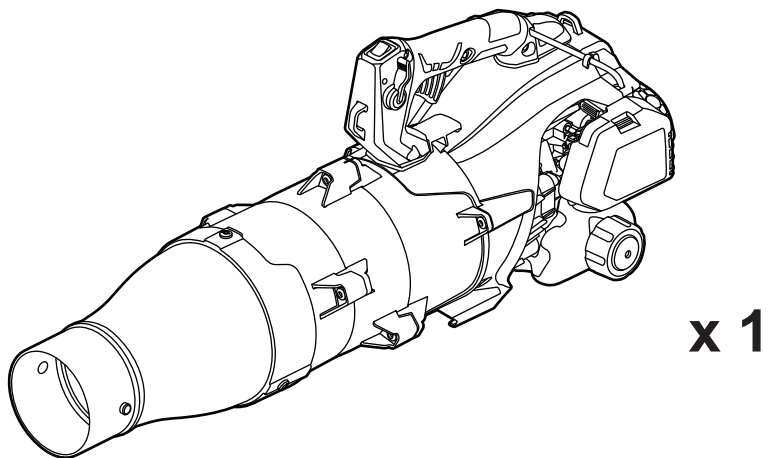

KNOW YOUR PRODUCT

1. On/Off switch
2. Cruise lever
3. Throttle trigger
4. Handle
5. Spark plug cap
6. Choke lever
7. Primer bulb
8. Shoulder strap
9. Starter grip and rope
10. Fuel tank
11. Fuel cap
12. Air filter cover
13. Blower tube

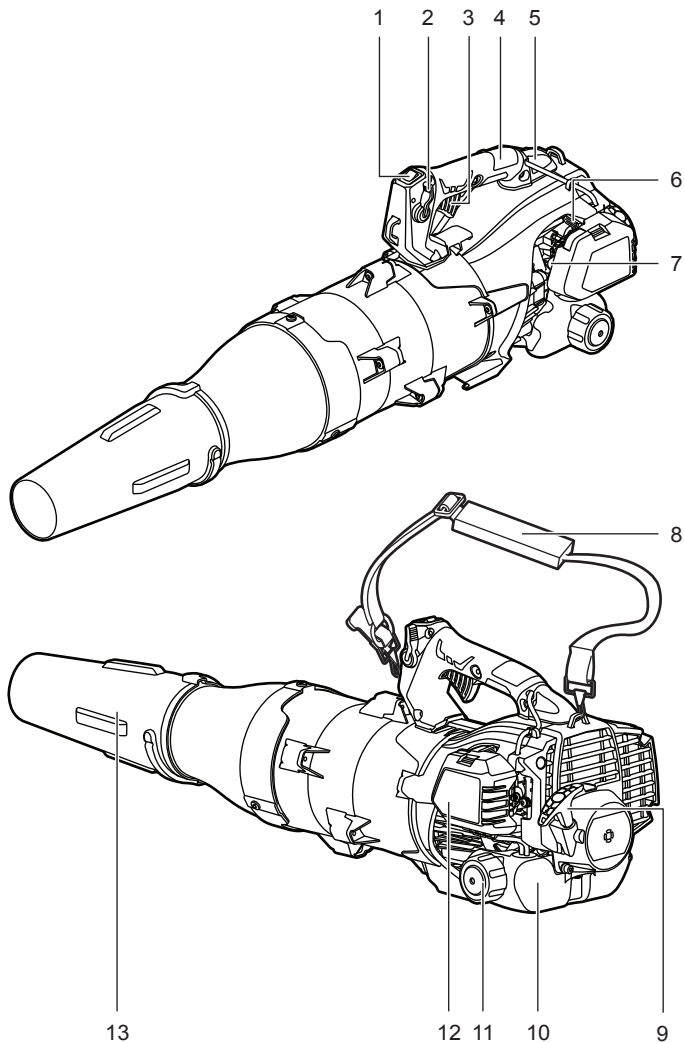

GETTING STARTED

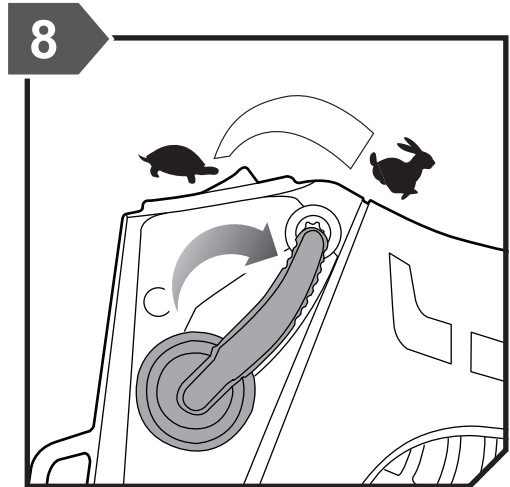
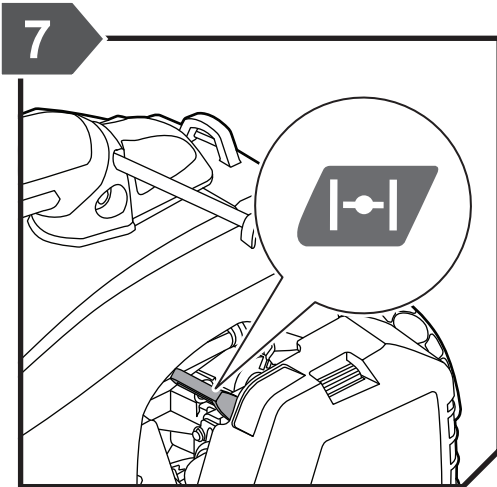
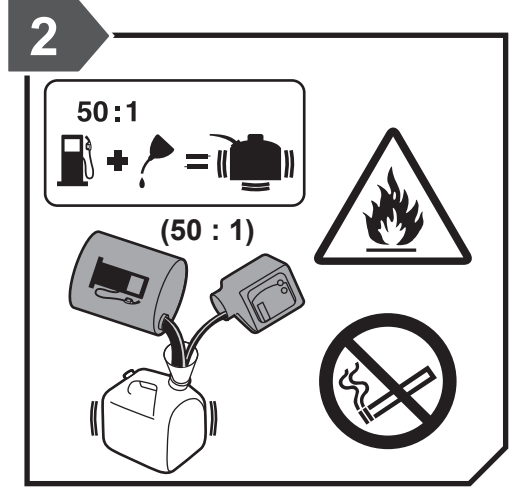
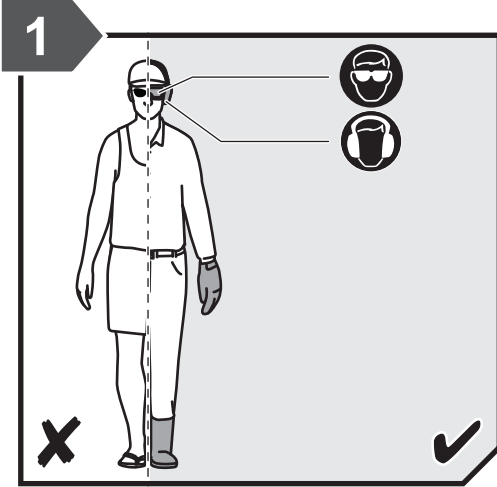

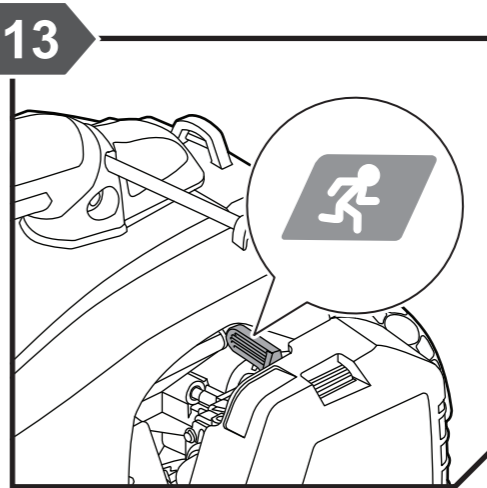
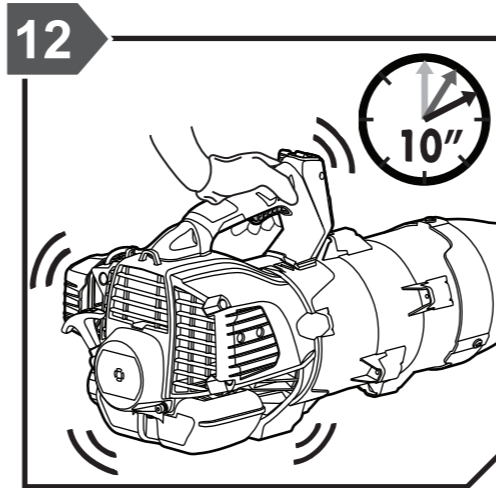
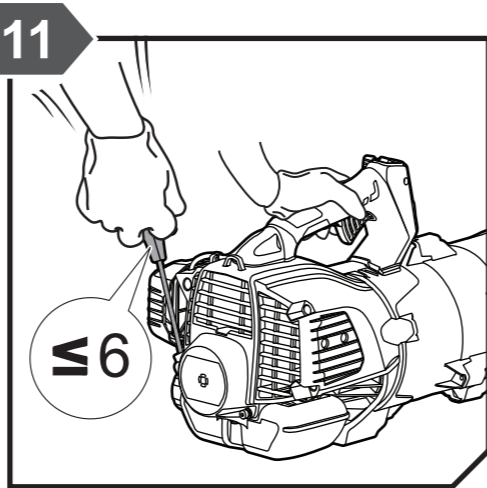
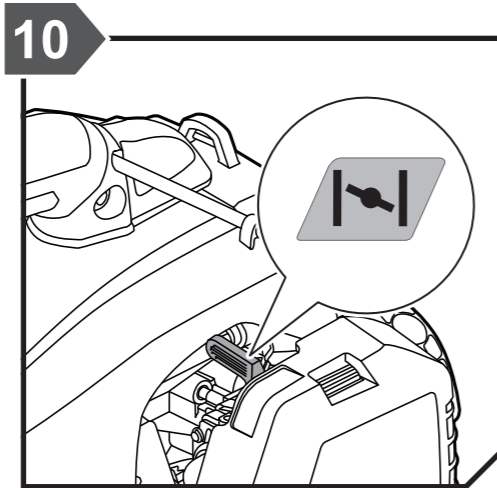
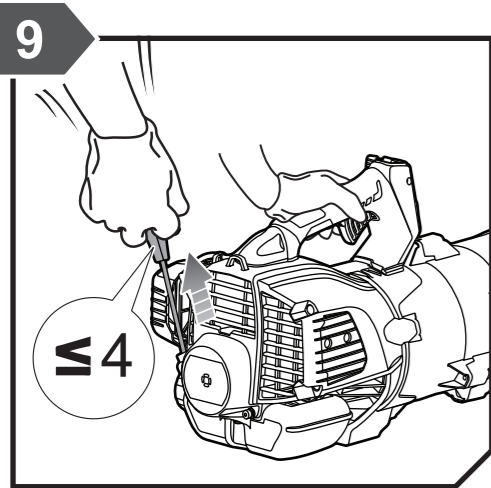
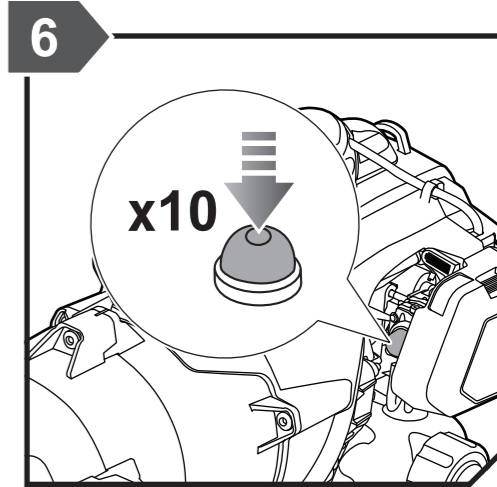
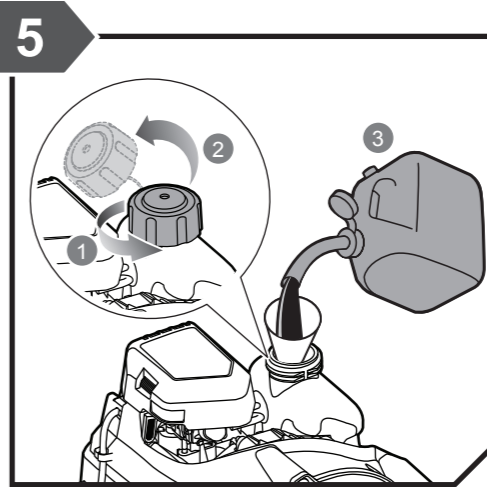
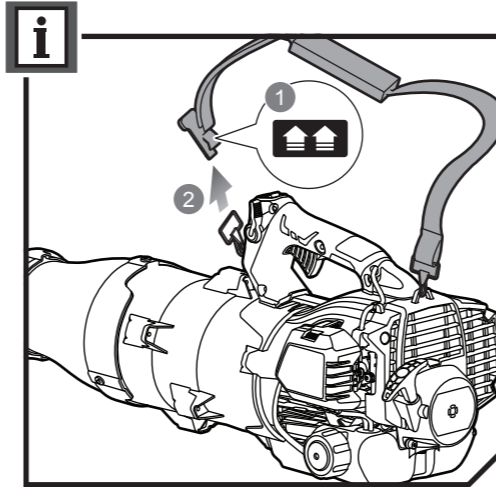
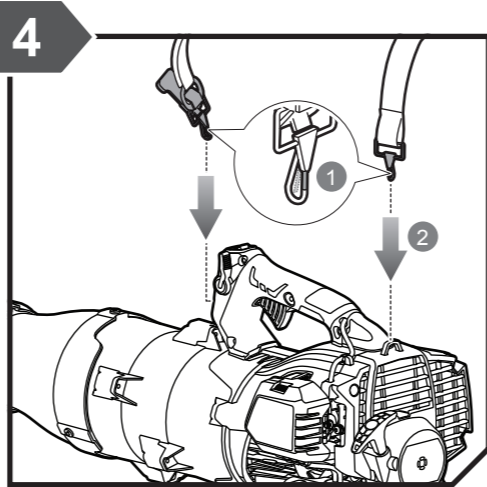
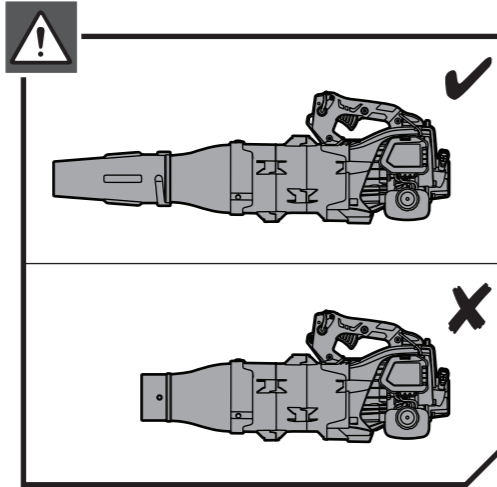
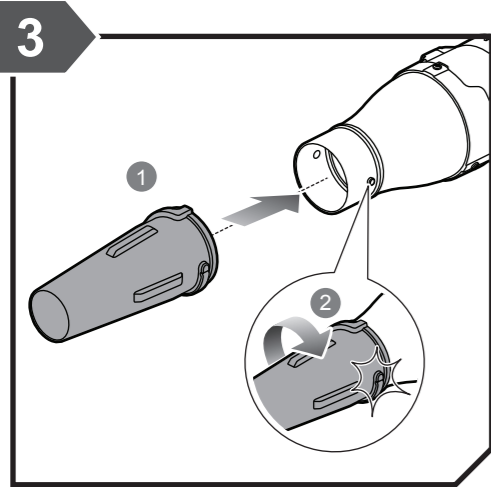

OVERVIEW

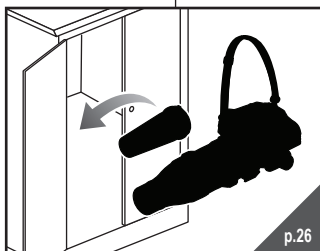
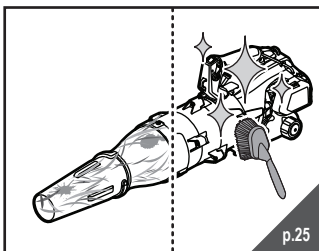
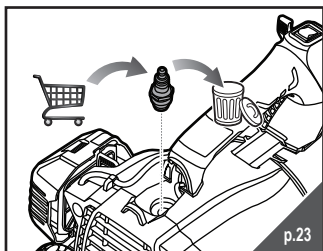
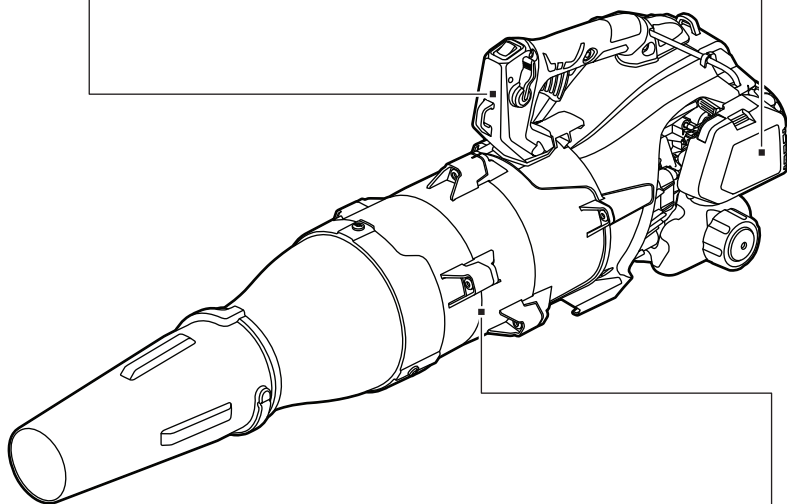
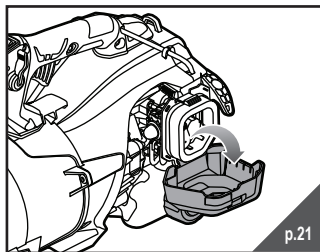
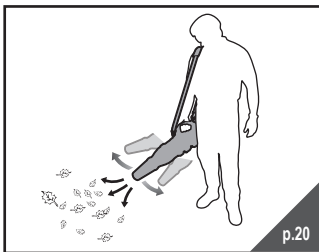
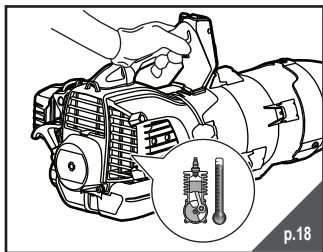

OPERATION

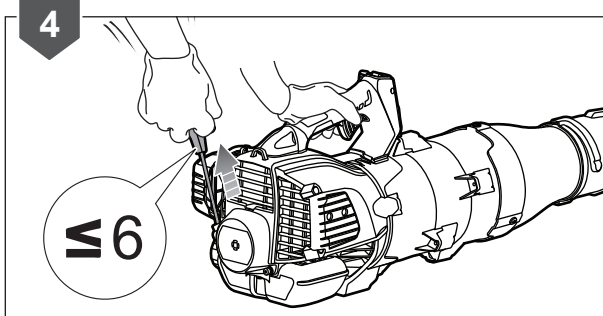
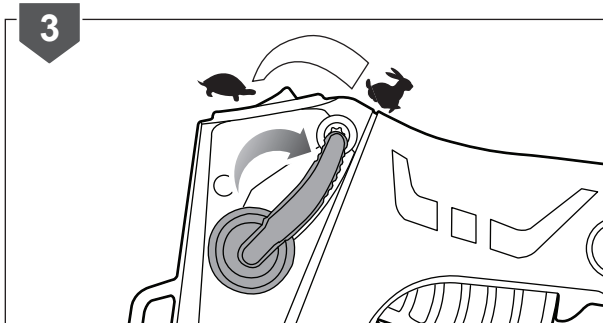
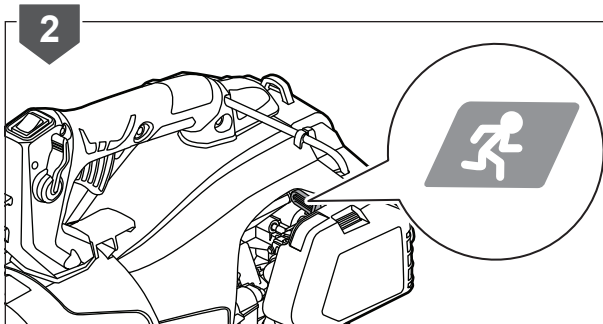
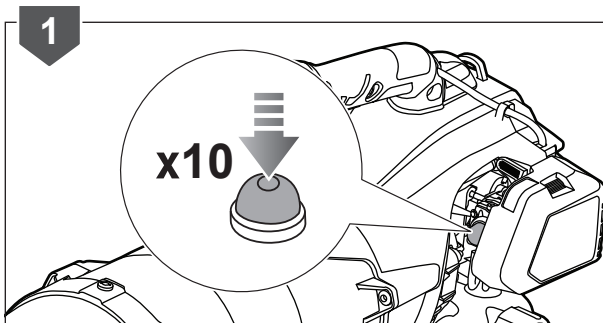
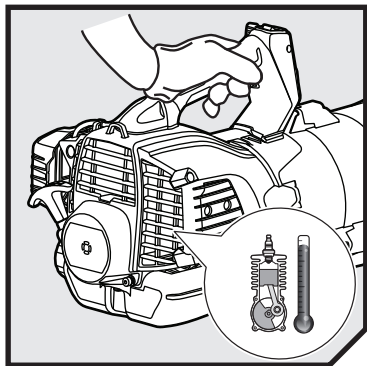

OPERATION

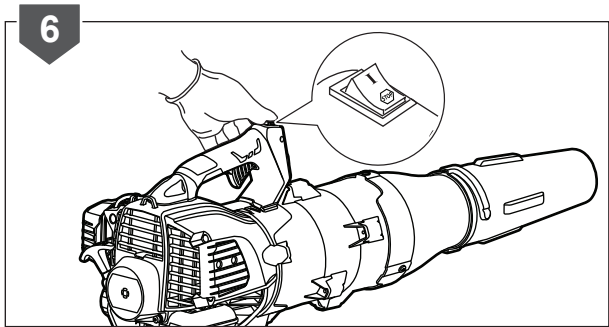
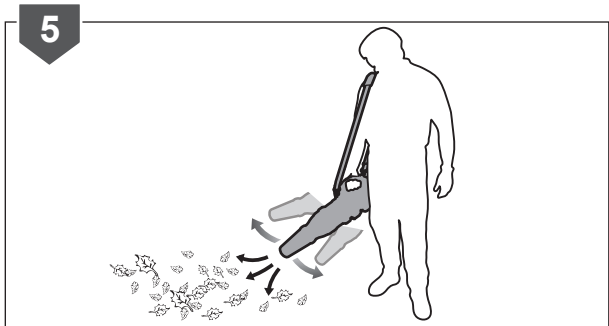

OPERATION

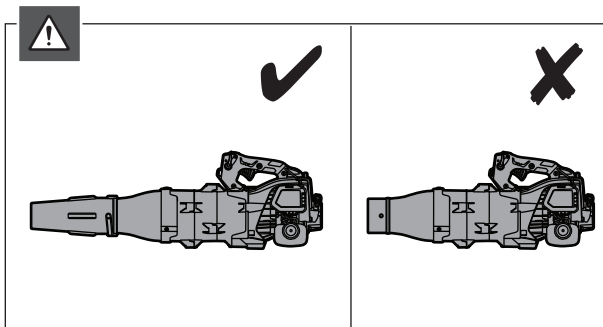
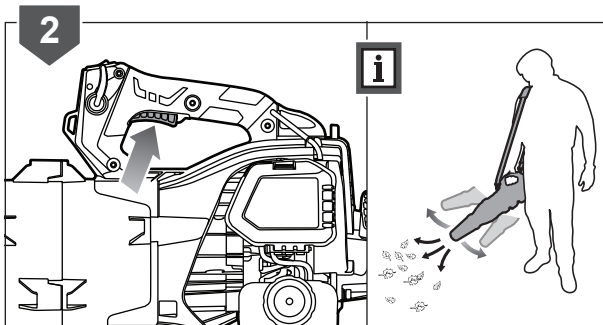
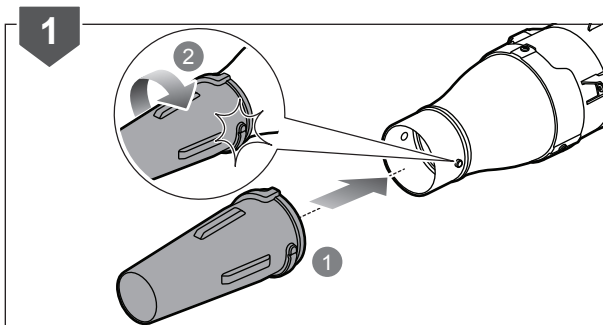
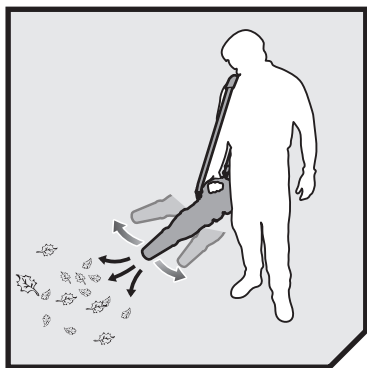

OPERATION

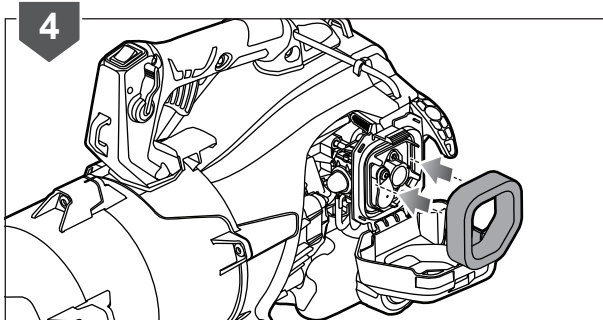
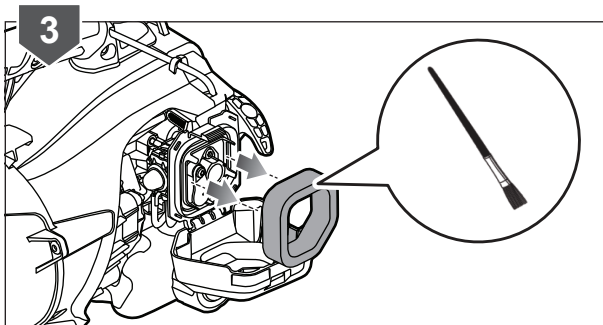
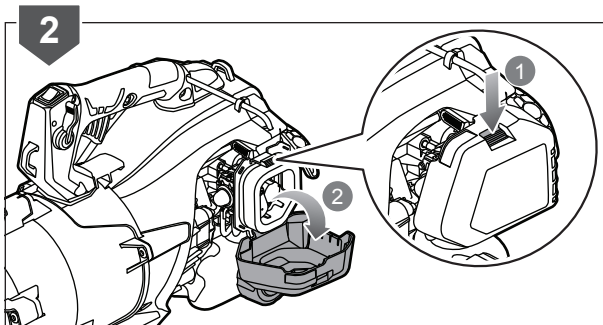
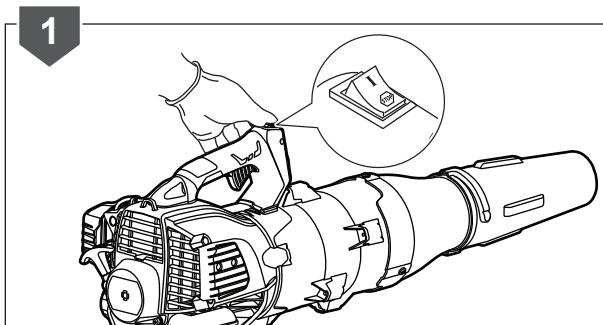
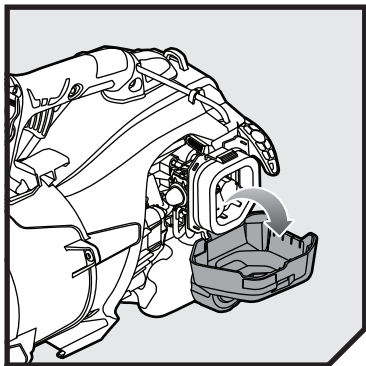

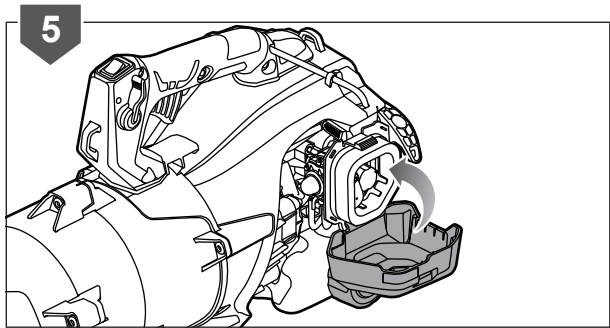

OPERATION

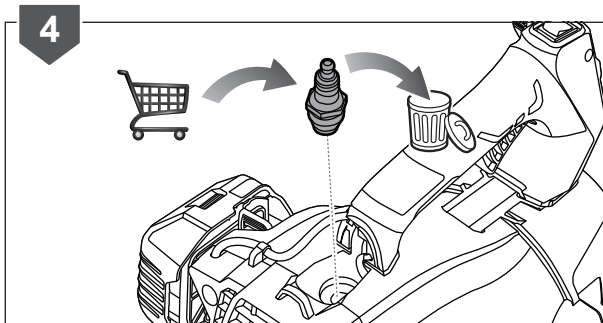
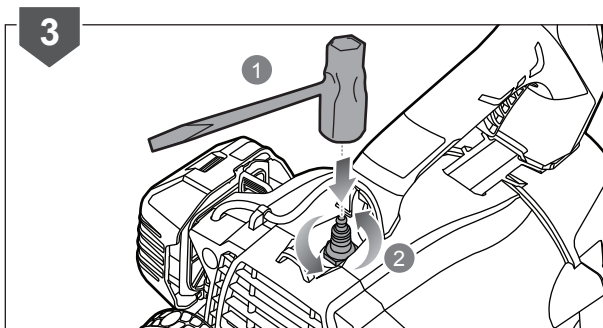
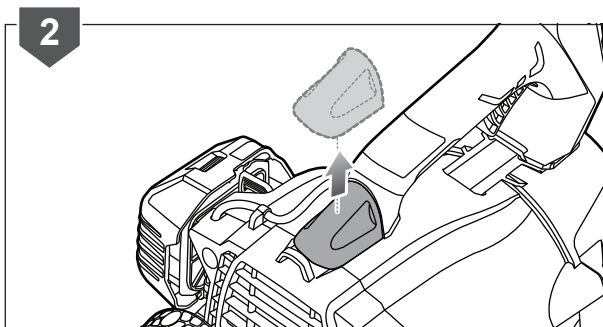
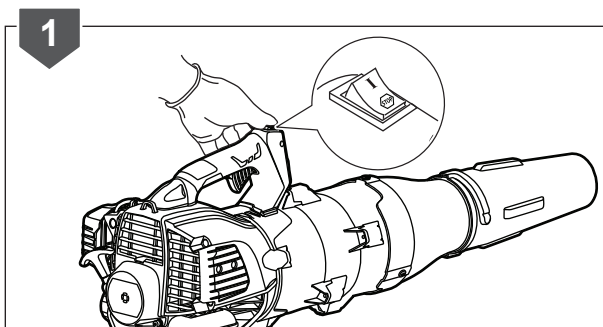

OPERATION

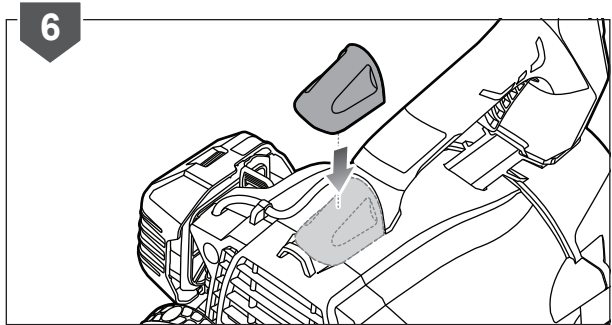
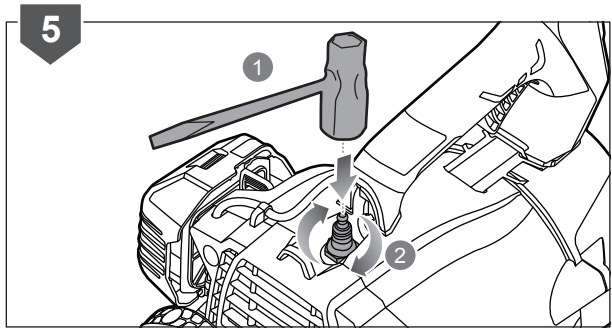

MAINTENANCE

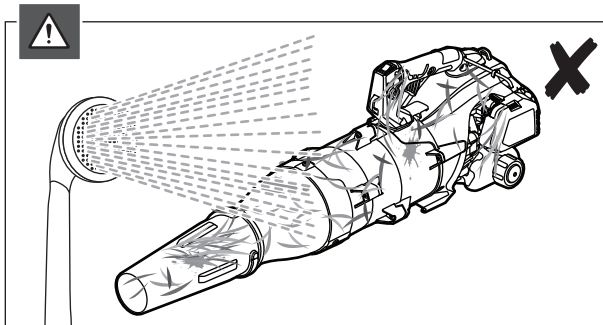
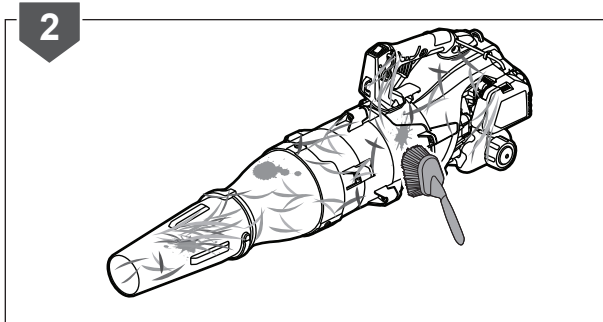
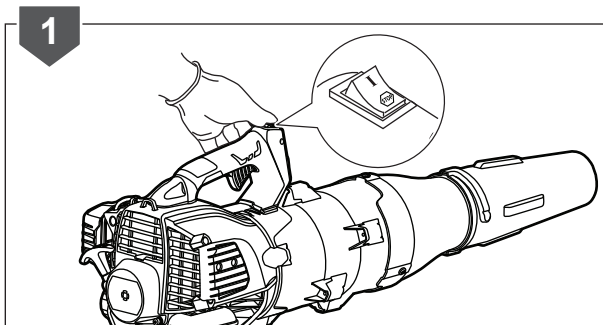
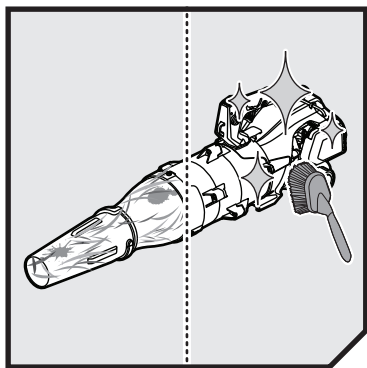

STORAGE

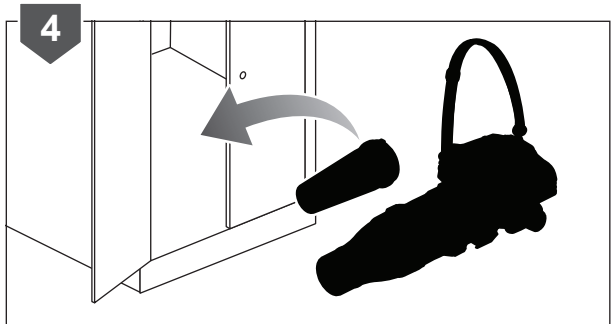
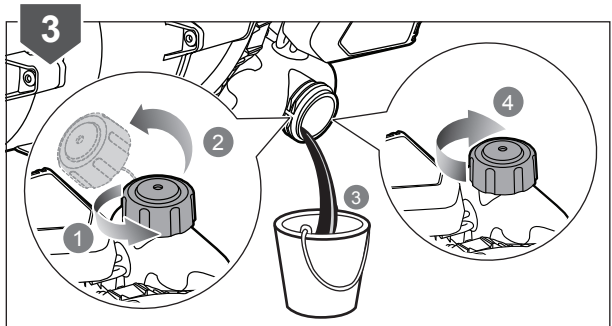
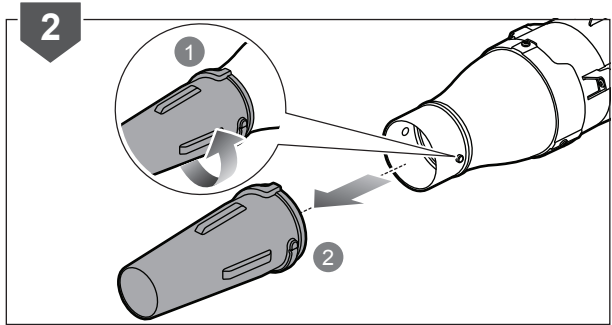
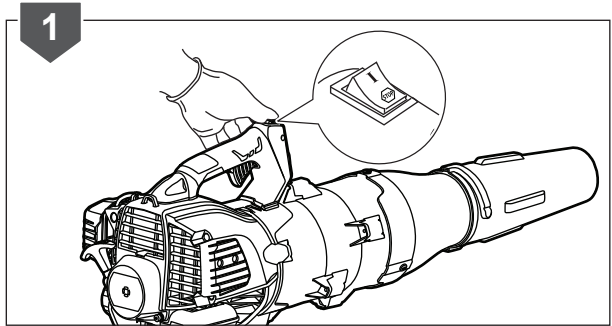
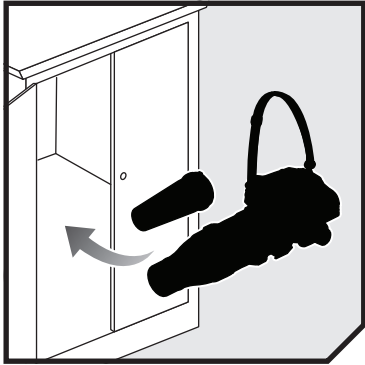

20170905v1

PRODUCT SPECIFICATIONS

Jet Blower

Model RBJ254N

Rated power 25.4 cc

Engine speed (max) 8800/min

Engine speed (idle) 3400-3800/min

Air velocity 257 km/h

Air volume 882 m³/hr

Weight (without fuel) 5.42 kg

Vibration

Idling 9.5 m/s²

Racing 18.9 m/s²

Equivalent vibration total value 17.8 m/s²

Sound

Bystander 76.5 dB

At the operator's ear 98.5 dB



Imported by:

Techtronic Industries Australia Pty Ltd
31 Gilby Road, Mount Waverley, VIC 3149
Melbourne, Australia

Techtronic Industries N.Z. Limited
2 Landing Drive, Mangere
Auckland, 2022, New Zealand