



Wireless Doorphone Intercom



INSTRUCTION MANUAL

DOORBELL OVERVIEW

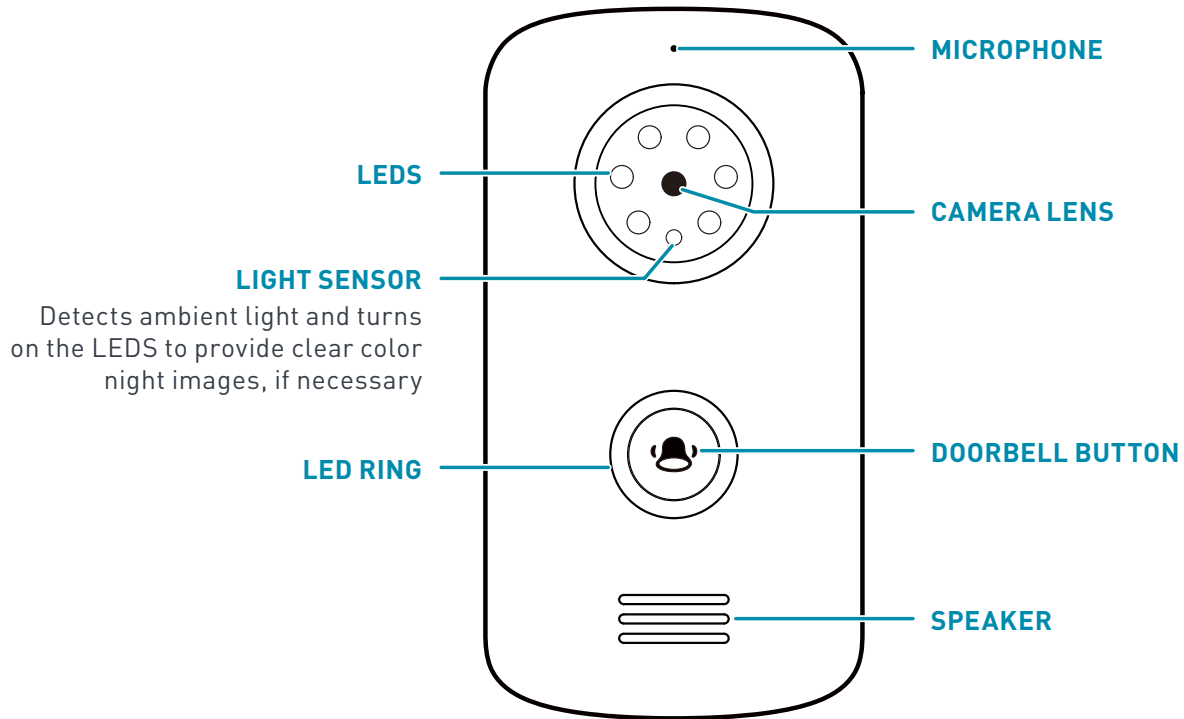

HANDSET OVERVIEW

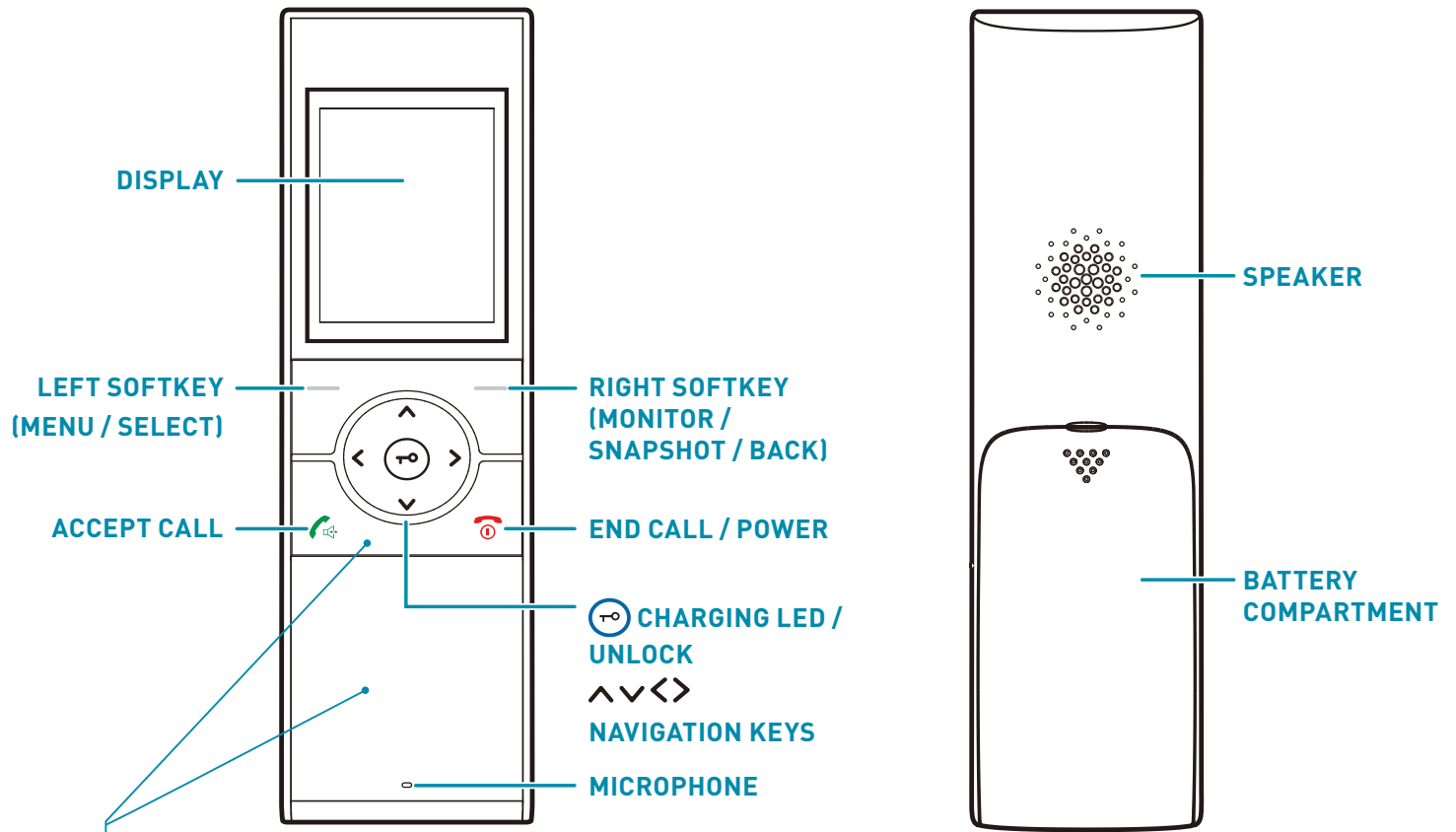

Carefully peel off the protective film.

INSTALLING THE HANDSET BATTERY

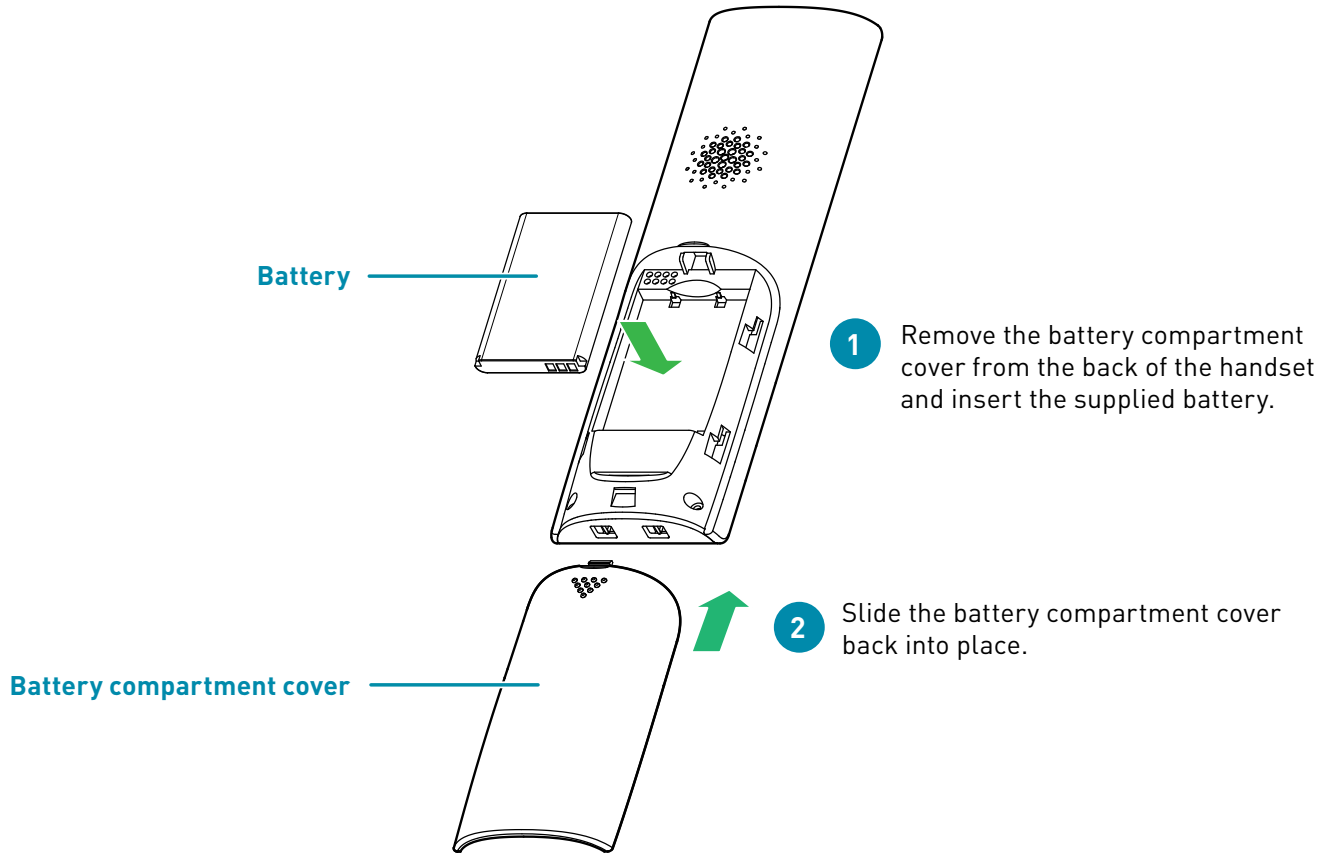

INSTALLING THE HANDSET CHARGER

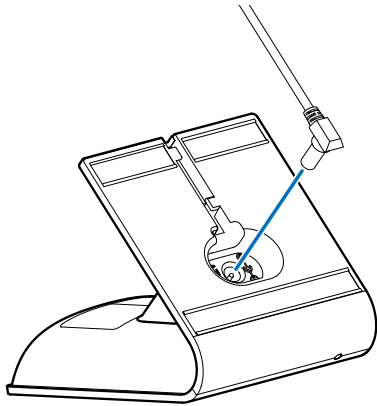

- 1 Plug the handset charger adapter into the socket marked DC12V underneath the handset charger.

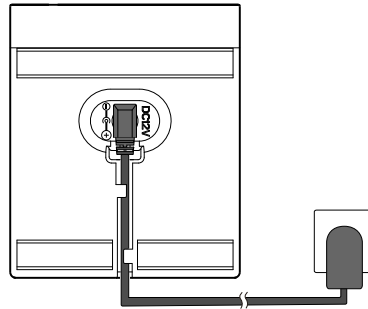

- 2 Plug the charger adapter into a power outlet and then switch on the power outlet.
Note: Make sure the power cord is fed through the slot on the charger so the charger can sit flush with a flat surface.

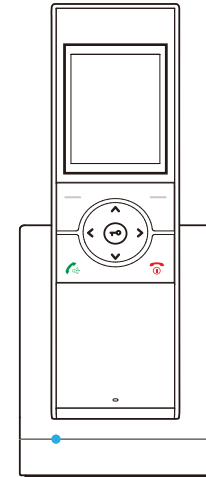

- 3 The LED on the handset charger lights up to indicate that it is powered. Place the handset on the charger to charge. The  LED is on when the handset is charging.
Note: Charge the handset for about 5 hours before first use.

INSTALLING THE DOORBELL

The doorbell can be powered using either a direct power connection with the power adapter supplied or two size "C" batteries (see next page).

Doorbell Power Adapter Connection

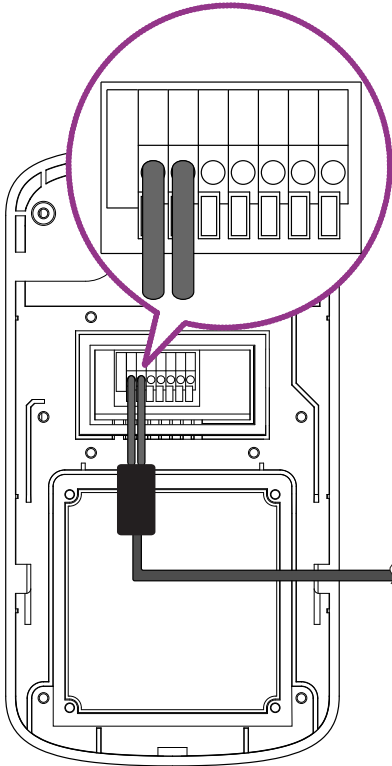

CAUTION - DO NOT SWITCH ON POWER SUPPLY UNTIL WIRES HAVE BEEN CONNECTED TO THE DOORBELL.

- 1 Insert the 2-wire cable on the end of Doorbell power adapter into the first two holes starting from the left on the green terminal block by pushing down the orange tab.
Note: It doesn't matter which wire goes into which hole.
- 2 Replace the terminal cover using the supplied screws.
- 3 Plug the power adapter into a power outlet, and then switch on the power outlet.

INSTALLING THE DOORBELL

Doorbell Battery Installation

You can also power the doorbell with two size "C" batteries for a fast, wire-free installation. Use premium quality alkaline batteries for long-lasting performance.

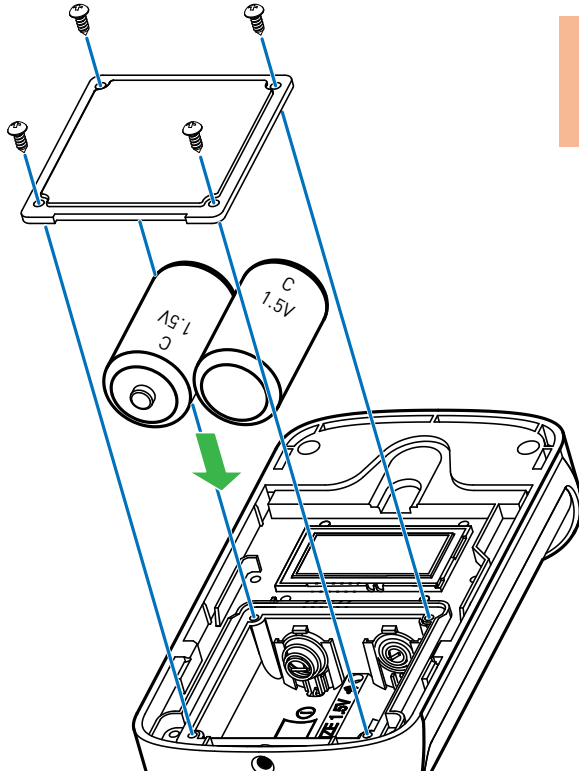

CAUTION - DO NOT USE BATTERIES AND MAINS POWER CONNECTION TOGETHER TO POWER DOORBELL. DOING SO MAY CAUSE THE BATTERIES TO SWELL OR EXPLODE.

- 1 Install two new "C" (1.5V) alkaline batteries following the polarity markings (+ and -) inside the battery compartment.
- 2 Replace the battery cover using the supplied screws.

Note: The doorbell will operate in Power Saving mode the first time batteries are installed. In Power Saving mode, you will not be able to use the handset's Monitor function which allows you to view live video from the doorbell at any time. To be able to use the handset's Monitor function, you need to change the battery setting on the doorbell. See ["Changing the Doorbell Battery Setting" on page 8.](#)

CHANGING THE DOORBELL BATTERY SETTING

If the doorbell is powered by batteries and you want to use the "Monitor" function on the handset, you will need to change the battery setting on the doorbell from Power Saving mode, which is the default, to Normal Power mode. In Normal Power mode, you may need to change batteries more often depending on how much the Monitor function (this drains the batteries more quickly) is utilized.

To change the doorbell battery setting to Normal Power mode:

- 1 Using a narrow tip object (such as a small screwdriver), press the **Register** button in the battery compartment of the doorbell for 3 seconds.
The LED ring lights up and then blinks, and you hear a beep.
- 2 Press the **Register** button again for 3 seconds until you hear 3 beeps. The doorbell is now operating in **Normal Power** mode.

To change the doorbell battery setting back to Power Saving mode:

- 1 Using a narrow tip object (such as a small screwdriver), press the **Register** button in the battery compartment of the doorbell for 3 seconds.
The LED ring lights up and then blinks, and you hear 3 beeps.
- 2 Press the **Register** button again for 3 seconds until you hear a beep. The doorbell is now operating in **Power Saving** mode.

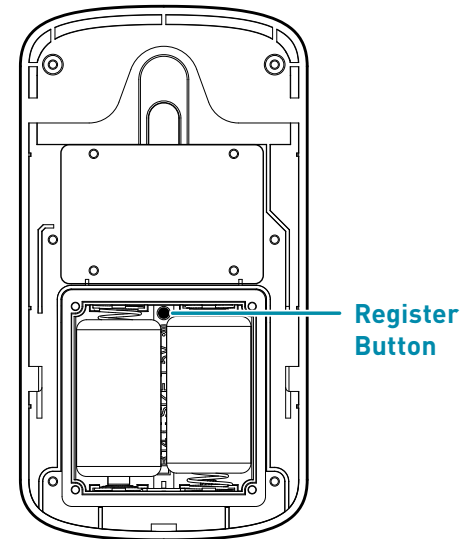

MOUNTING THE DOORBELL

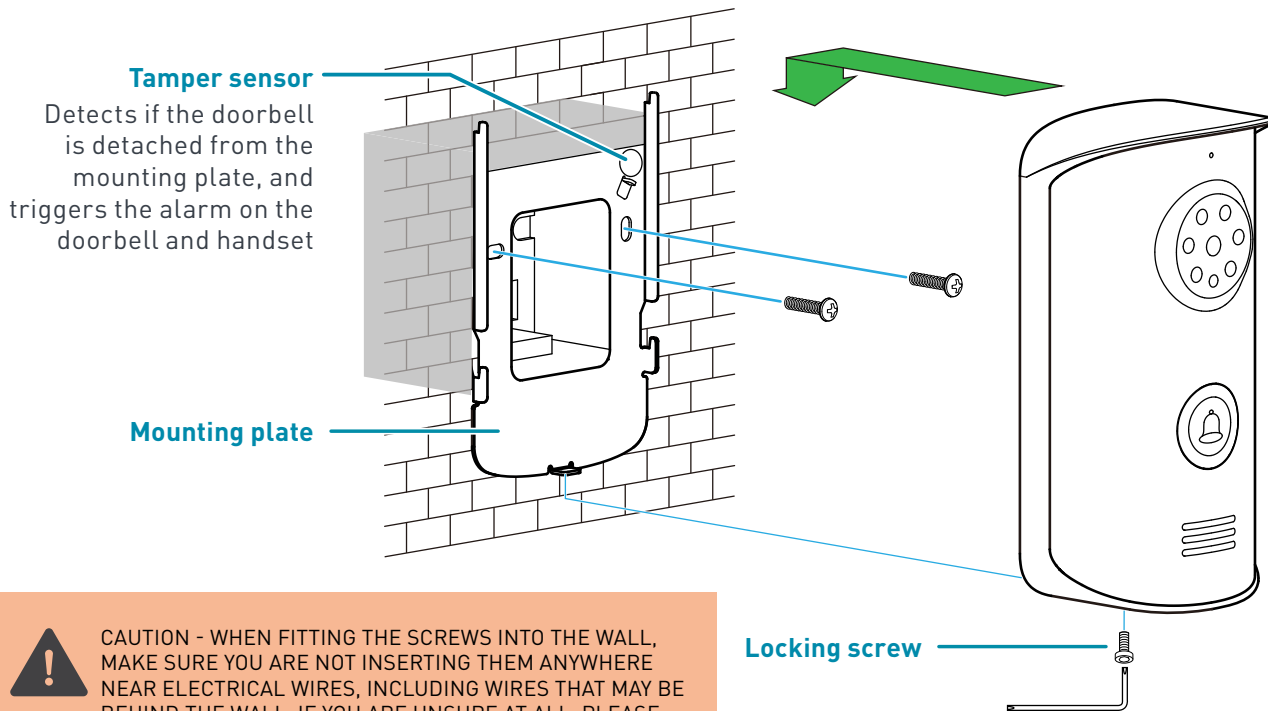

The ideal installation height of the doorbell is at about chest height, around 1.6m / 5.2ft from the ground. Before mounting the doorbell, make sure you test if the location you install the doorbell is in range.



CAUTION - WHEN FITTING THE SCREWS INTO THE WALL, MAKE SURE YOU ARE NOT INSERTING THEM ANYWHERE NEAR ELECTRICAL WIRES, INCLUDING WIRES THAT MAY BE BEHIND THE WALL. IF YOU ARE UNSURE AT ALL, PLEASE GET A PROFESSIONAL TO CHECK FIRST AND INSTALL THE SCREWS FOR YOU.

USING THE HANDSET

Turning the power on/off

- To power on, press and hold  for 1 second.
- To power off, press and hold  for 3 seconds.



Waking up the display

When the handset is idle after 15 seconds, the display turns off.

- To wake up the display, press any button on the handset.

Answering/Rejecting a call



When a visitor presses the button on the doorbell, the handset rings and shows live video from the doorbell camera.

- To answer the call, press . You can talk for up to 45 seconds before the call is automatically ended.
- To reject the call, press .

Using Monitor mode

Monitor mode allows you to view live video from the doorbell camera at any time and discreetly monitor the doorbell's surroundings.

Note: If the doorbell is powered by batteries, the Monitoring function will only work when the doorbell is operating in Normal Power mode. See "[Changing the Doorbell Battery Setting](#)" on page 8.

- To enter Monitor mode, press **Mon**.
Note: If you have 2 doorbells registered, you need to select which doorbell camera you want to view.
- In Monitor mode, you can start talking over the microphone by pressing .
- To stop monitoring and end the live video, press . Monitor mode will also automatically end after 45 seconds.

Turning off the alarm

If the tamper alarm is triggered, press  or  to turn off the alarm on the doorbell and handset.

USING THE HANDSET

Checking the handset battery level

You can check the  battery icon at the top right of the display for an indication of the charge remaining in the battery. When the battery icon is flashing red, the battery level is low and the handset should be charged immediately using the charger before it automatically powers off. For best performance, place the handset in the handset charger when not in use.

Using the menu

1. Press **Menu** to access the menu.
2. Press **^** or **v** to highlight a menu option.
3. Press **Select** to select.
4. Press **^**, **v**, **<** or **>** to adjust settings, and press **Select** to confirm and return to the previous menu.
5. Press **Back** to exit the menu.

Setting the date and time

Set up time and date accurately so that all your photo snapshots will have correct timestamps.

1. Press **Menu** to access the menu.
2. Press **^** or **v** to **Date & Time** and press **Select**.
3. Press **<** or **>** to choose the hour or minute, then press **^** or **v** to set the time. The time is in 24-hour format.
4. Press **<** or **>** to choose the year, month or day, then press **^** or **v** to set the date.
5. Press **Select** to confirm and return to the previous menu.

Taking a snapshot

During a call or Monitor mode, press the right softkey to manually take a snapshot and save it to the handset.

Note: You can also turn on the Auto Snapshot feature on the handset and have a snapshot taken automatically each time there is an incoming call. See "[Snap Set](#)" in "[The Handset Menu](#)" on page 12.

THE HANDSET MENU

Volume

Allows you to adjust the following volume settings:

- Talking Volume - The listening volume during a call.
- Ringing Volume - The volume of the ringtone.
- Ringing Time - The amount of time the handset rings when there is an incoming call.

Brightness

Allows you to adjust the brightness of the display.

Key Tone

Allows you to turn on or off the audible beep when a handset button is pressed.

Ring Tone



Allows you to change the ringtone that is played for an incoming call.

Snap Set

Allows you to turn on or off automatic snapshot of the live image shown on the display when there is an incoming call. It's recommended to turn this feature on so you know who rang the doorbell when you were not home or when you missed a call.

Note: The handset can store up to a maximum of 100 photos at a time. When its internal storage becomes full, the handset will delete the oldest snapshots to make space.

Snap Show

Allows you to view and manage snapshots taken by the handset. Press < or > to browse through the photos. The time and date are imprinted on the photos so you can quickly tell when they were captured. To delete a photo, browse to the photo, then press  and press  to confirm.

Date & Time

Allows you to adjust the date and time on the handset. See ["Setting the date and time" on page 11](#).

THE HANDSET MENU

Door Set

Allows you to manage the following doorbell settings:

- Volume - The speaker volume of the doorbell.
- Ring Time - The amount of time the doorbell chime rings when the doorbell button is pressed.
- Unlock Time - The amount of the time the door is unlocked when you press  on the handset, if an electric door strike is connected to the doorbell.



Language

Allows you to change the display language.

Wallpaper

Allows you to change the display wallpaper.

Register

The doorbell comes pre-registered to the handset out of the box. The wireless doorphone system supports up to two doorbells and two handsets. To register an additional doorbell to a handset, see [Appendix: "Registering a doorbell" on page 14](#). To deregister a doorbell, select the doorbell number, then press  and press  to confirm.

Version

Shows software version information.

PIR Settings

Feature is not available. The doorbell does not have a built-in motion sensor.

Reset

Allows you to reset the handset. This clears all settings to factory defaults and de-registers all doorbells. You will need to re-register the doorbell to the handset. See [Appendix: "Registering a doorbell" on page 14](#).

Registering a doorbell

The supplied doorbell and handset units are pre-registered. If, for some reason, the doorbell is not registered to the handset (you have reset the handset, for example), or if you have an additional doorbell to register, follow the steps below:

Doorbell

1. Using a narrow tip (such as a small screwdriver), press the **Register** button in the battery compartment of the doorbell for 3 seconds. The LED ring lights up and then blinks.

Handset

Within 60 seconds of pressing the **Register** button on the doorbell:

2. Press **Menu** to access the menu.
3. Press **^** or **v** to **Register** and press **Select**.
4. Press **^** or **v** to select which number (1 or 2) you want to assign to the doorbell. **Note:** If the doorbell is an additional unit, select "#2".
5. Press **√** to begin the registration process. Once registration is successful, the doorbell beeps once and its LED ring light turns solid then off. The handset exits the menu.

(Optional) Connecting an electric door strike

You can connect an electric door strike (sold separately) to the doorbell and unlock the door for your visitor using the handset by pressing . The following is general information on connecting an electric door strike to the doorbell. Please see the manual that comes with your electric door strike for specific installation information such as the DC power source required. Please note that the doorbell does not able to provide power to an electric door strike.

- Connect wires from your door strike to the "NC (normally close)" or "NO (normally open)" and COM holes on the green terminal block in the doorbell. Refer to the terminal cover of the doorbell for the location of the "NC"/"NO" (second/third from right) and "COM" (fourth from right) terminal holes.

Limited Warranty Terms & Conditions

Swann Communications warrants this product against defects in workmanship and material for a period of one (1) year from its original purchase date. You must present your receipt as proof of date of purchase for warranty validation. Any unit which proves defective during the stated period will be repaired without charge for parts or labour or replaced at the sole discretion of Swann. The end user is responsible for all freight charges incurred to send the product to Swann's repair centres. The end user is responsible for all shipping costs incurred when shipping from and to any country other than the country of origin.

The warranty does not cover any incidental, accidental or consequential damages arising from the use of or the inability to use this product. Any costs associated with the fitting or removal of this product by a tradesman or other person or any other costs associated with its use are the responsibility of the end user. This warranty applies to the original purchaser of the product only and is not transferable to any third party. Unauthorized end user or third party modifications to any component or evidence of misuse or abuse of the device will render all warranties void. By law some countries do not allow limitations on certain exclusions in this warranty. Where applicable by local laws, regulations and legal rights will take precedence.

For Australia: Our goods come with guarantees which cannot be excluded under Australian Consumer Law. You are entitled to a replacement or refund for a major failure and for compensation for any other reasonably foreseeable loss or damage. You are also entitled to have the goods repaired or replaced if the goods fail to be of acceptable quality and the failure does not amount to major failure.

FCC Statement

This device complies with part 15 of the FCC Rules. Operation is subject to the following two conditions: (1) This device may not cause harmful interference, and (2) This device must accept any interference received, including interference that may cause undesired operation.

WARNING: Modifications not approved by the party responsible for compliance could void user's authority to operate the equipment.

Power Supply Unit Label Safety Information



This symbol indicates this product is classified as Waste Electrical and Electronic Equipment (WEEE) in the European Union and should not be discarded with household waste. Other territories may vary.



Only for indoor use.



Power supply unit is double insulated.



Indicates the AC input range.



Indicates the DC output voltage and current.

WARNING: The socket-outlet shall be installed near the equipment and shall be easily accessible.

About This Manual

The content in this manual is for information purposes only and is subject to change without notice. While every effort is made to ensure that this manual is accurate and complete at the time of printing, no liability is assumed for any errors and omissions that may have occurred. For the latest version of this user manual, please visit: www.swann.com

Helpdesk / Technical Support Details

Telephone Helpdesk

USA & CANADA	1800 627 2799
AUSTRALIA	1800 788 210
NEW ZEALAND	0800 479 266
UK	0808 168 9031

Technical Support

All Countries E-mail: tech@swann.com

